

Michigan Department of  
Environment, Great Lakes, and Energy (EGLE)  
Community Water Supply

---

Weekly Program Update

May 28, 2020



All lines are muted during the webinar.



Submit your questions using the “**Question**” box in your Go To Webinar tool bar.

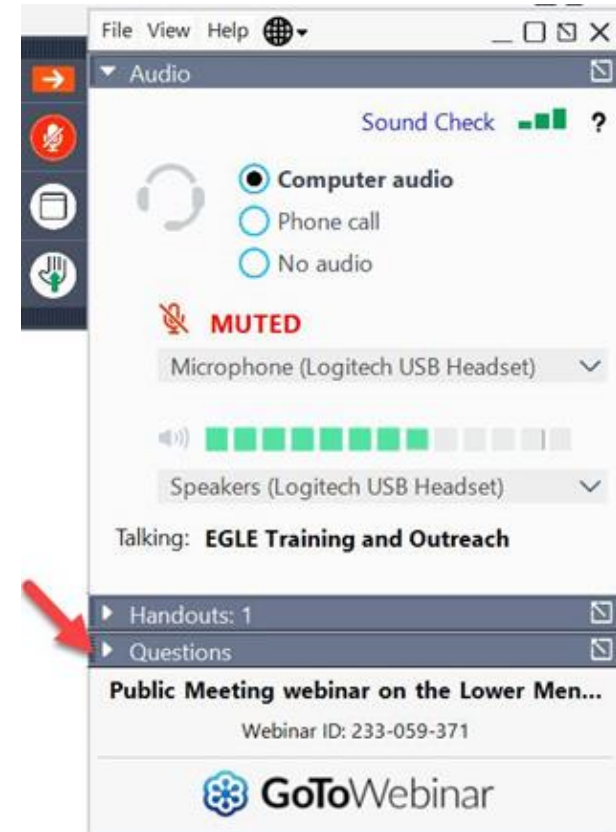

# Poll Question 1

# Q & A Panel

- Eric Oswald
  - Drinking Water and Environmental Health Division Director
- George Krisztian
  - DWEHD Assistant Director
- Brian Thurston
  - DWEHD Field Operations Section Manager
- Kris Philip
  - DWEHD Community Water Supply Section Manager

# Topics Covered Today

- Reminders & Resources
- EGLE Weekly Updates
- Poll Questions
- Q&A Session

# EGLE Update

- EGLE staff serving 1 layoff day per week through July 24 (half on Monday, half on Friday).
- In-person Visits:
  - DWEHD Field Operations Section (FOS) Standard Operating Procedures (SOP) updated to include additional safety precautions to protect water supply and DWEDH staff during in-person visits.
  - DWEHD has resumed critical in-person visits in the Marquette, Cadillac, and Bay City districts using updated SOP.
  - DWEHD will continue to evaluate and release additional districts to resume fieldwork.

# Operator Training & Certification Update

- May exams rescheduled to JULY 23, 2020
  - EGLE is currently processing responses to exam survey
  - Those choosing to take the exam will receive an official approval letter with exam date and location at a later date
  - Those not approved to take the exam have already been notified

# Operator Training & Certification (cont.)

- Operator Certification Renewals  
Due to COVID-related course cancellations...
  - Certifications that would have expired 4/15 extended to 7/15
  - Certifications expiring 7/15 have been extended to 10/15
  - If you already have sufficient CECs to renew, we encourage you to do so by your original renewal date
  - Future expiration reverts to original date (for example, those expiring 4/15/20 have until 7/15/20 to renew, but subsequent renewal date will be 4/15/23)
- Continuing Education Credits
  - Some courses converting to online, but CEC values may change
  - 150+ online courses available for CECs ([Michigan.gov/EGLEoperatortraining](https://Michigan.gov/EGLEoperatortraining))



# EGLE Lab Reminders

- In-person sample delivery and container pick-up resumed on Monday May 11, 2020 with call-ahead scheduling. Visit [Michigan.gov/EGLELab](https://Michigan.gov/EGLELab) for bottle [drop-off/pick-up guidance](#)
- Mail/package delivery to the lab continue as usual (daily)
- Pick-up of mail from the lab has been reduced to 3 days/week
  - Possible delay in delivery of test kits. Recommend ordering kits early.
  - Possible delay in receipt of mailed results. Recommend providing email address on sample request form for faster receipt of results.

# EO 2020-28: Restoring water service to occupied residences

- EO 2020-100 extends EO 2020-28 until the end of the states of emergency.
  - Requires restoration of service to occupied residences
  - Supplies that have conducted shut-offs within last year were required to submit information to [EGLE-Assist@Michigan.gov](mailto:EGLE-Assist@Michigan.gov) by April 12, 2020
  - Supplies that have not yet restored service to all occupied homes must submit an update every 30 days thereafter
  - Limited grant funding assistance available.  
Contact [EGLE-RestartGrants@michigan.gov](mailto:EGLE-RestartGrants@michigan.gov)
  - Homeowner flushing guidance available at [Michigan.gov/CommunityWater](https://Michigan.gov/CommunityWater)
  - EOs available at [Michigan.gov/Coronavirus](https://Michigan.gov/Coronavirus)

# General Online Resources

- Michigan Webpage: [Michigan.gov/Coronavirus](https://Michigan.gov/Coronavirus)
- EGLE CWS Webpage: [Michigan.gov/CommunityWater](https://Michigan.gov/CommunityWater), then ["COVID 19: Information for Water Operators"](#)
- EPA has established a website to assist water utilities: ["Water Utility Resources for the COVID-19 Pandemic"](#)

# Water Quality Within Buildings

Resources for managing building water quality following periods of low or no water use:

- [EGLE: School Flushing Guidance](#)
- [CDC: Guidance for Building Water Systems](#)
- [EPA: Maintaining or Restoring Water Quality in Buildings...](#)
- [ASDWA: COVID-19 Resources for Building Water Systems](#)
- [AWWA: Coronavirus Information, incl. Return to Service Guidance](#)
- [ESPRI: Flushing Guidance for Periods of Low or No Use](#)
- [Purdue: Water Quality in Low Occupancy and Shutdown Buildings](#)

# Supply Shortages

- EGLE will be sending operators-in-charge a brief survey about supply shortages/trends.
- This is in response to an inquiry by federal agencies regarding this issue.
- This will be sent from [EGLE@govsubscriptions.michigan.gov](mailto:EGLE@govsubscriptions.michigan.gov)
- Some have noted these messages are filtered as spam, so check your spam/junk email folder.

# Upcoming EGLE Training

- Lead and Copper Webinar Series for Operators
  - No cost
  - Session 1 - June 2
  - Session 2 - June 4
  - Sessions 1 & 2 cover different materials, attendees are encouraged to participate in both
  - Each webinar provides 0.1 CECs, but attendance of both sessions earns 0.3 CECs

# Upcoming EGLE Training (cont.)

- Small Systems Operator Webinars

- Session 1 – June 9
  - Session 2 – June 10
  - Session 3 – June 16
  - Session 4 – June 23
  - Session 5 – June 24
- Sessions cover different materials and attendees are encouraged to participate in all
  - Each session is worth 0.1 CEC

# NRWA/EPA Evaluation Tool for Small System Risk and Resilience Assessments under AWIA

- National Rural Water Association and the Environmental Protection Agency have partnered to create an evaluation tool to simplify compliance with the Risk and Resiliency requirements of the America's Water Infrastructure Act of 2018. All public drinking water systems serving 3,300 to 50,000 must complete this assessment by June 30, 2021 and this tool is available for your use. Attend this webinar for detailed training on how to utilize this valuable tool to keep your system in compliance and perform these valuable security checks to help you make sure of your system's security. This session will also cover some aspects of the Vulnerability Self-Assessment Tool (VSAT).
- Register for this training at:  
<https://register.gotowebinar.com/register/7764947235416133387>



# Q&A Session

- Submit questions using the "Question" box in your Go To Webinar tool bar.
- Questions will be compiled and posted to the Community Water COVID-19 website as a Q&A document.
- Between meetings, general programmatic questions/issues can be sent to:  
[EGLE-DWEHD-CWS@Michigan.gov](mailto:EGLE-DWEHD-CWS@Michigan.gov)

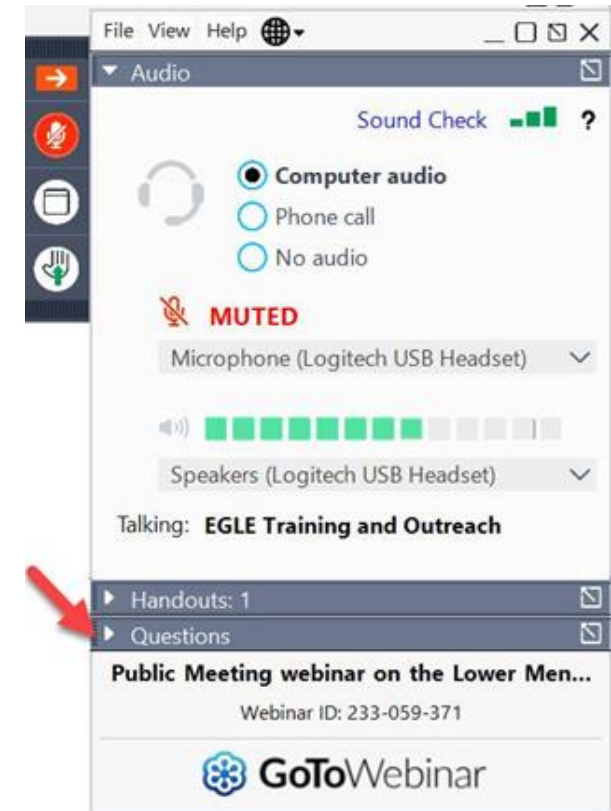

# Thank you for tuning in!

- Look for notification of future sessions
- Stay in contact with your district engineer and communicate any challenges you are facing
- Stay safe out there!