

Michigan Department of
Environment, Great Lakes, and Energy (EGLE)
Community Water Supply

Weekly Program Update

June 11, 2020



All lines are muted during the webinar.



Submit your questions using the “**Question**” box in your Go To Webinar tool bar.

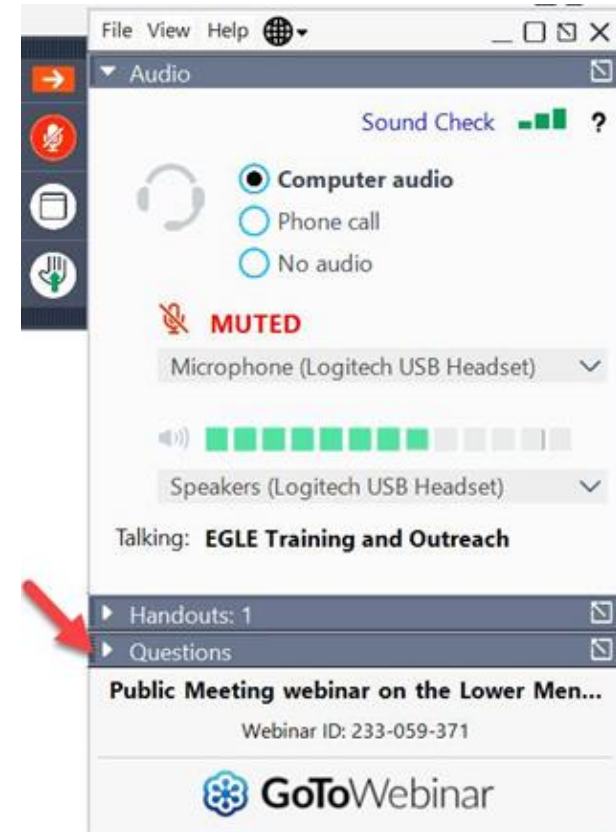

Poll Question 1

Q & A Panel

- Eric Oswald
 - Drinking Water and Environmental Health Division Director
- George Krisztian
 - DWEHD Assistant Director
- Brian Thurston
 - DWEHD Field Operations Section Manager
- Kris Philip
 - DWEHD Community Water Supply Section Manager

Topics Covered Today

- Reminders & Resources
- EGLE Weekly Updates
- Poll Questions
- Q&A Session

EGLE Update

- EGLE staff serving 1 layoff day per week through July 24 (half on Monday, half on Friday)
 - Permit review times will increase with the 20% cut in staff hours
 - Response time to inquiries may also increase
- In general, EGLE staff continue to telecommute
- In-person Visits:
 - DWEHD Field Operations Section (FOS) Standard Operating Procedures (SOP) updated to include additional safety precautions to protect water supply and DWEDH staff during in-person visits.
 - DWEHD has resumed in-person visits in all districts using updated SOP.

EGLE Field Work COVID-19 Procedures

Some considerations in DWEHD's current field work procedures:

- Perform as much work as possible remotely
- Face coverings are required by all parties in compliance with executive orders
- Verify lack of COVID-19 symptoms for water supply personnel and self (EGLE inspector) ahead of visit
- Do not shake hands and practice social distancing
- Do not touch facility equipment and try to avoid using rest rooms and break rooms
- Avoid exchanging physical materials, including paper handouts
- If the water supply is not comfortable with the visit, written documentation requesting deferment of the visit must be provided

Operator Training & Certification Update

- May exams rescheduled to JULY 23, 2020
 - Those choosing to take the exam will receive an official approval letter with exam date and location at a later date.
Letters will be sent no later than 15 days prior to the exam date.
 - Those not approved to take the exam have already been notified
 - EGLE is reviewing protocols for hosting exams, evaluating the need for additional sites to allow for social distancing, etc.
 - Face coverings are required to be worn during exam and at sites.

Upcoming EGLE Training (cont.)

- Small Systems Operator Webinars

- Session 1 – June 9 - past
- Session 2 – June 10 - past
- Session 3 – June 16
- Session 4 – June 23
- Session 5 – June 24
- Sessions cover different materials; attendees encouraged to participate in all; each session is worth 0.1 CEC

- Visit EGLE's [Calendar, Events and Training](#) page for other upcoming EGLE opportunities

EGLE Lab Reminders

- In-person sample delivery and container pick-up resumed on Monday May 11, 2020 with call-ahead scheduling. Visit Michigan.gov/EGLELab for bottle [drop-off/pick-up guidance](#)
- Mail/package delivery to the lab continue as usual (daily)
- Pick-up of mail from the lab has been reduced to 3 days/week
 - Possible delay in delivery of test kits. Recommend ordering kits early.
 - Possible delay in receipt of mailed results. Recommend providing email address on sample request form for faster receipt of results.

EO 2020-28: Restoring water service to occupied residences

- EO 2020-100 extends EO 2020-28 until the end of the states of emergency.
 - Requires restoration of service to occupied residences
 - Supplies that have conducted shut-offs within last year were required to submit information to EGLE-Assist@Michigan.gov by April 12, 2020
 - Supplies that have not yet restored service to all occupied homes must submit an update every 30 days thereafter
 - Limited grant funding assistance available.
Contact EGLE-RestartGrants@michigan.gov
 - Homeowner flushing guidance available at Michigan.gov/CommunityWater
 - EOs available at Michigan.gov/Coronavirus

General Online Resources

- Michigan Webpage: Michigan.gov/Coronavirus
- EGLE CWS Webpage: Michigan.gov/CommunityWater, then ["COVID 19: Information for Water Operators"](#)
- EPA has established a website to assist water utilities: ["Water Utility Resources for the COVID-19 Pandemic"](#)

General Online Resources (cont.)

- [MIOSHA COVID-19 Workplace Safety Guidance](#)
 - Provides guidance for various sectors
 - Includes factsheets, posters, and other guidance



Water Quality Within Buildings

Resources for managing building water quality following periods of low or no water use:

- [EGLE: School Flushing Guidance](#)
- [CDC: Guidance for Building Water Systems](#)
- [EPA: Maintaining or Restoring Water Quality in Buildings...](#)
- [ASDWA: COVID-19 Resources for Building Water Systems](#)
- [AWWA: Coronavirus Information, incl. Return to Service Guidance](#)
- [ESPRI: Flushing Guidance for Periods of Low or No Use](#)
- [Purdue: Water Quality in Low Occupancy and Shutdown Buildings](#)

Q&A Session

- Submit questions using the "Question" box in your Go To Webinar tool bar.
- Questions will be compiled and posted to the Community Water COVID-19 website as a Q&A document.
- Between meetings, general programmatic questions/issues can be sent to:
EGLE-DWEHD-CWS@Michigan.gov

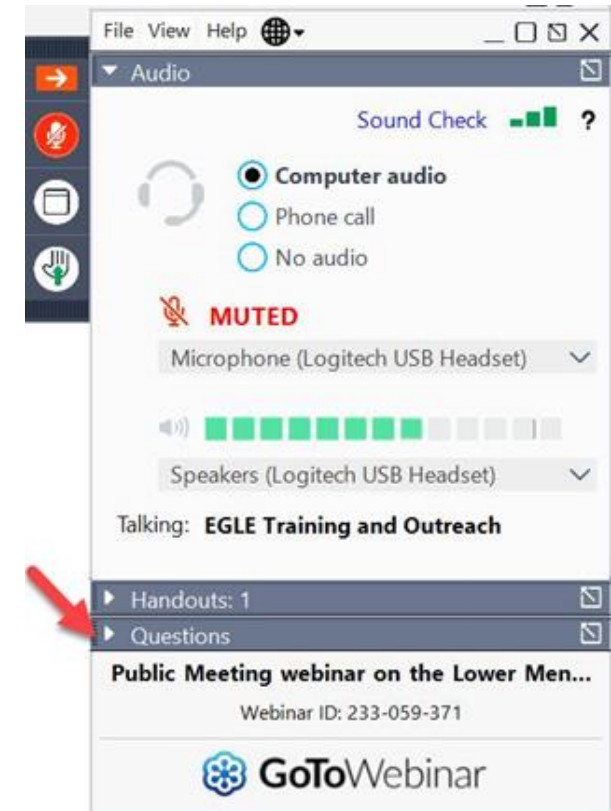

Thank you for tuning in!

- Look for notification of future sessions
- Stay in contact with your district engineer and communicate any challenges you are facing
- Stay safe out there!