

Michigan Department of
Environment, Great Lakes, and Energy (EGLE)
Community Water Supply

Monthly Program Update

August 20, 2020



All lines are muted during the webinar.



Submit your questions using the “**Question**” box in your Go To Webinar tool bar.

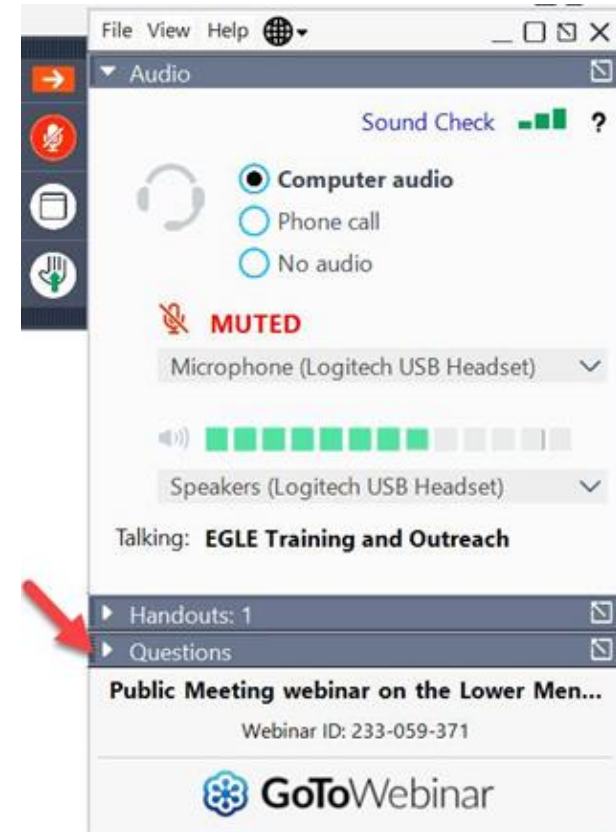

Poll Question 1

Q & A Panel

- Eric Oswald
 - Drinking Water and Environmental Health Division Director
- George Krisztian
 - DWEHD Assistant Division Director
- Brian Thurston
 - DWEHD Field Operations Section Manager
- Kris Philip
 - DWEHD Community Water Supply Section Manager

Topics Covered Today

- Reminders & Resources
- EGLE Updates
- Poll Questions
- Q&A Session

EGLE Update

- In general, EGLE staff continue to telework from home.
 - Remote water supply surveillance visits.
 - Remote sanitary survey visits, except facility inspection portion.
- In-person Visits:
 - DWEHD Field Operations Section (FOS) Standard Operating Procedures (SOP) updated to include additional safety precautions to protect water supply and DWEHD staff during in-person visits.
 - DWEHD continues program critical in-person visits in all districts using updated SOP.

EGLE Field Work COVID-19 Procedures

Some considerations in DWEHD's current field work procedures:

- Perform as much work as possible remotely
- **Face coverings required by all parties** in compliance with executive orders
- Verify lack of COVID-19 symptoms for water supply personnel and EGLE inspector ahead of visit
- Do not shake hands and practice social distancing
- Do not touch facility equipment and try to avoid using facility rest rooms and break rooms
- Avoid exchanging physical materials, including paper handouts
- If the water supply is not comfortable with the visit, written documentation requesting deferment of the visit must be provided

EGLE Lab Reminders

- In-person sample delivery and container pick-up available with call-ahead scheduling. Visit Michigan.gov/EGLELab for [bottle drop-off/pick-up guidance](#)
- Mail/package delivery to the lab continue as usual (daily)
- Pick-up of mail from the lab has been reduced to 3 days/week
 - Possible delay in delivery of test kits. Recommend ordering kits early.
 - Possible delay in receipt of mailed results. Recommend providing email address on sample request form for faster receipt of results.

General Online Resources

- Michigan Webpage: Michigan.gov/Coronavirus
- EGLE CWS Webpage: Michigan.gov/CommunityWater, then "[COVID 19: Information for Water Operators](#)"
- EPA has established a website to assist water utilities: "[Water Utility Resources for the COVID-19 Pandemic](#)"
- MIOSHA provides information for various sectors, including factsheets, posters, and other guidance: [MIOSHA COVID-19 Workplace Safety Guidance](#)



Water Quality Within Buildings

Resources for managing building water quality following periods of low or no water use:

- [EGLE: School Flushing Guidance](#)
- [CDC: Guidance for Building Water Systems](#)
- [EPA: Maintaining or Restoring Water Quality in Buildings...](#)
- [ASDWA: COVID-19 Resources for Building Water Systems](#)
- [AWWA: Coronavirus Information, incl. Return to Service Guidance](#)
- [ESPRI: Flushing Guidance for Periods of Low or No Use](#)
- [Purdue: Water Quality in Low Occupancy and Shutdown Buildings](#)

Restoring Water Service

- [EO 2020-144: Restoring water service to occupied residences](#)
 - Rescinds EO 2020-28
 - Extends requirement for restoration of water service through 12/31/2020
 - Requires restoration of service to occupied residences
 - Supplies that have not submitted a report meeting all requirements of Section 3 of EO 2020-28 must submit an update every 30 days until requirements met, submit information to EGLE-Assist@Michigan.gov
 - Limited grant funding assistance available. Contact EGLE-RestartGrants@michigan.gov
 - Homeowner flushing guidance available at Michigan.gov/CommunityWater
 - EOs available at Michigan.gov/Coronavirus under “Resources”

Water Utility Assistance Grant Program

- Senate Bill 690 - Water Assistance Program to assist qualified customers to pay water and sewer arrearages March 1 to end of States of Emergency
- Community action agencies will be working directly with water supplies that opt in
- Supplies have until **8/21** to opt in
- Email your interest by sharing your name and contact information with DHHS at MDHHS-BCAEO@michigan.gov
- **If funds are not available to support the 25% forgiveness portion of the program, no reductions by the water providers will be required.**

Poll Question 2

Operator Training & Certification Update

- November Operator Certification Exams
 - EGLE is planning to host fall exams
 - New COVID requirements may necessitate changes to usual procedures (potentially hosting over more than one day, hosting at different venues, etc.)
 - Masks, social distancing, health screening and other measures will be in place
 - Individuals will be notified of specific details closer to the exam date

Online Training Opportunities

- Visit Michigan.gov/EGLEoperatortraining
 - Approved EGLE online courses
 - Approved EPA online courses
 - 150+ other approved online courses
- Visit Michigan.gov/EGLEevents
 - For other EGLE events and training opportunities

PFAS Rules Update

PFAS Drinking Water Rules

- PFAS drinking water rules took effect August 3, 2020
- Rules establish maximum contaminant levels (MCLs) and corresponding requirements for 7 PFAS compounds
- Rules apply to community and nontransient noncommunity water supplies

PFAS MCLs

Regulated Contaminant	MCL (ng/L)
Perfluorononanoic acid (PFNA)	6
Perfluorooctanoic acid (PFOA)	8
Perfluorooctane sulfonic acid (PFOS)	16
Perfluorohexane sulfonic acid (PFHxS)	51
Hexafluoropropylene oxide dimer acid (HFPO-DA)*	370
Perfluorobutane sulfonic acid (PFBS)	420
Perfluorohexanoic acid (PFHxA)	400,000

* GenX Compound

PFAS Sampling

- Sampling conducted at each entry point to the distribution system
- Samples must be analyzed by a certified laboratory
- **Initial Monitoring Requirements**
 - **First Full Quarter** (collect between 10/1 and 12/31/2020)
 - Supplies with a result over 50% of an MCL*
 - Supplies with sampling points not previously sampled*
 - **Within 6 Months** (collect by 2/3/2021)
 - Supplies with results non-detect or less than or equal to 50% of the MCLs*

* Based on samples collected during 2018/2019 Statewide PFAS Survey

PFAS Sampling (cont.)

- **Ongoing monitoring frequency determined by results of initial sampling**
 - Results below reporting limits = annual monitoring
 - Results above reporting limits = quarterly monitoring

PFAS MCL Compliance Determination

MCL Compliance Based on Running Annual Average (RAA)

- Calculated using 4 consecutive quarter results*
- The initial result counts as the first quarter of the calculation
- If a confirmation sample was collected, it will be averaged with the initial result
- If any sample result causes the RAA to exceed the MCL, the supply is out of compliance immediately

* If a supply does not collect all required samples, compliance will be based on the running annual average of the samples collected.

PFAS Public Notification

Public Notification

- Noncompliance with a PFAS MCL requires Tier 2 public notification within 30 days
- Noncompliance with sampling requirements requires Tier 3 public notification within 12 months

PFAS Implementation

- Initial rule notification memo mailed/emailed to all supplies
- Supply-specific monitoring requirements will be mailed soon
- While waiting for your specific sampling requirements...
 - Visit Michigan.gov/PFASDrinkingWaterRules and familiarize yourself with the rules and sampling procedures
 - Select a laboratory and order bottles
 - Attend EGLE’s PFAS Webinar for operators
 - August 14, 2020 (past)
 - **August 25, 2020 at 10:00 am** - [register for Drinking Water PFAS Rule Training](#)

Q&A Session

- Submit questions using the "Question" box in your Go To Webinar tool bar.
- Questions will be compiled and posted to the Community Water COVID-19 website as a Q&A document.
- Between meetings, general programmatic questions/issues can be sent to:
EGLE-DWEHD-CWS@Michigan.gov

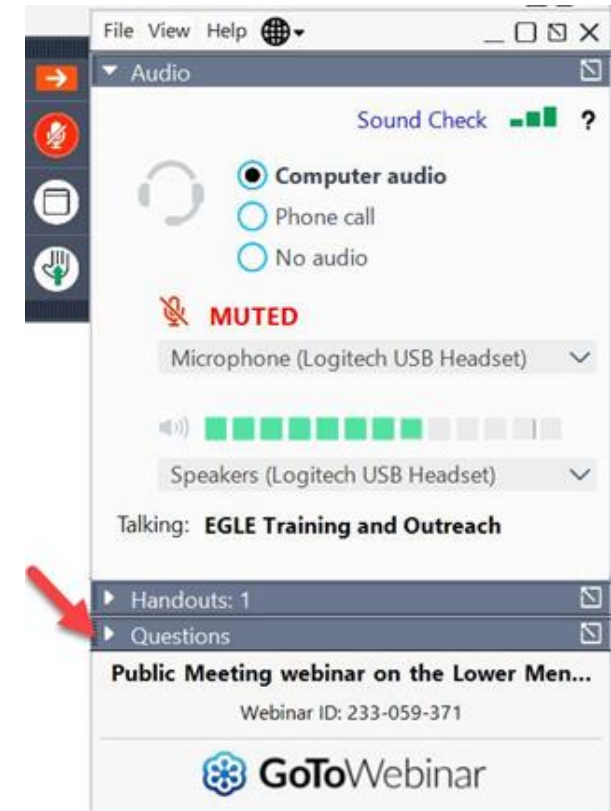

Thank you for tuning in!

- Look for notification of future sessions
- Stay in contact with your district engineer and communicate any challenges you are facing
- Stay safe out there!