

Michigan Department of
Environment, Great Lakes, and Energy
Oil, Gas and Minerals Division

PERMIT APPLICATIONS

2/3/2020 THRU 2/7/2020



Application Number Date Received Permittee Number Permittee Name Page 1

444 02/03/2020 5320 SAVOY ENERGY LP
920 HASTINGS STREET, SUITE A
PO BOX 1560
TRAVERSE CITY, MI49685-1560

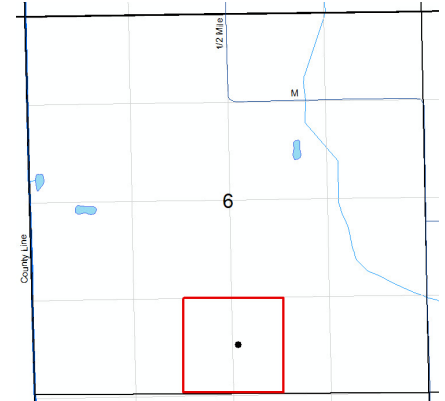

Prev Permit:

Well Name: FULLER 1-6

Well Type: OIL

Permit Type: Drill

H2S Present? No

Surface Owner: Fuller, Dennis M and
Roma J.

True Vertical Depth: 4000

Target Formation: TRENTON-BLACK
RIVER

Deepest Formation: PRAIRIE DU CHIEN

40-Acre Drilling Unit, E/2 SE/4
SW/4, W/2 SW/4 SE/4 Section 6

Location:	QT QT QT	Sec	Township	Range	Township Name	County	Feet From Section Line	Feet From DRLG Unit Line
SL:	NWSWSE	6	4S	8W	ATHENS	CALHOUN	719 S 2579 E	608 N 595 E
BHL:	NWSWSE	6	4S	8W	ATHENS	CALHOUN	719 S 2579 E	608 N 595 E

445 02/06/2020 5320 SAVOY ENERGY LP
920 HASTINGS STREET, SUITE A
PO BOX 1560
TRAVERSE CITY, MI49685-1560

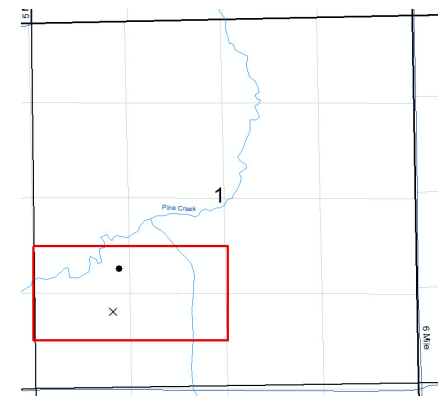

Prev Permit: 61469

Well Name: Wagley 1-1A

Well Type: OIL

Permit Type: Reentry

H2S Present? No

Surface Owner: Wagley, Susan M.

True Vertical Depth: 4000

Target Formation: TRENTON-BLACK
RIVER

Deepest Formation: PRAIRIE DU CHIEN

80-Acre R303 Drilling Unit, S/2
N/2 SW/4, N/2 S/2 SW/4
Section 1

Location:	QT QT QT	Sec	Township	Range	Township Name	County	Feet From Section Line	Feet From DRLG Unit Line
SL:	NESWSW	1	4S	8W	ATHENS	CALHOUN	1070 S 1054 W	
BHL:	SENWSW	1	4S	8W	ATHENS	CALHOUN	1535 S 1193 W	369 N 1193 W