

Michigan Department of
Environment, Great Lakes, and Energy
Oil, Gas and Minerals Division

PERMIT APPLICATIONS

2/10/2020 THRU 2/14/2020



Application Number

Date Received

Permittee
Number

Permittee
Name

Page 1

446 02/10/2020 5320 SAVOY ENERGY LP
920 HASTINGS STREET, SUITE A
PO BOX 1560
TRAVERSE CITY, MI49685-1560

Prev Permit:

Well Name: Wagley 1-2

Well Type: OIL

Permit Type: Drill

H2S Present? No

Surface Owner: Wagley, Susan M.

True Vertical Depth: 4000

Target Formation: TRENTON-BLACK
RIVER

Deepest Formation: PRAIRIE DU CHIEN

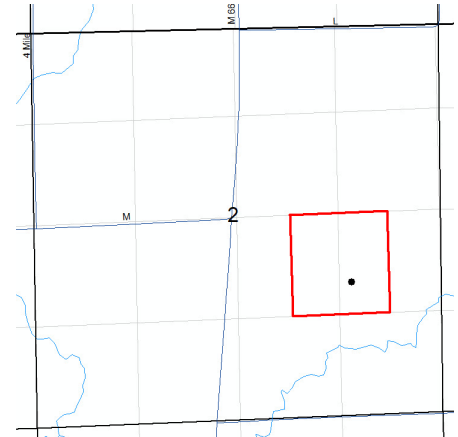

40-Acre Drilling Unit, E/2 NW/4
SE/4, W/2 NE/4 SE/4 Section 2

Location:	QT QT QT	Sec	Township	Range	Township Name	County	Feet From Section Line	Feet From DRLG Unit Line
SL:	SWNESE	2	4S	8W	ATHENS	CALHOUN	1782 S 1209 E	514 S 547 E
BHL:	SWNESE	2	4S	8W	ATHENS	CALHOUN	1782 S 1209 E	514 S 547 E

Michigan Department of
Environment, Great Lakes, and Energy
Oil, Gas and Minerals Division

PERMIT LIST

2/10/2020 THRU 2/14/2020



Permit Number Issue Date Permittee Number Permittee Name Page 1

61472 2/10/2020 5320 SAVOY ENERGY LP
920 HASTINGS STREET, SUITE A
PO BOX 1560
TRAVERSE CITY, MI49685-1560

API Well No: 21-025-62019-00-00

Prev Permit:

Well Name: Fuller 1-6

Well Type: Oil Well

Permit Type: Drill

H2S Present? No

Surface Owner: Fuller, Dennis M and
Roma J.

True Vertical Depth: 4000FT

Target Formation: TRENTON-BLACK
RIVER

Deepest Formation: PRAIRIE DU
CHIEN

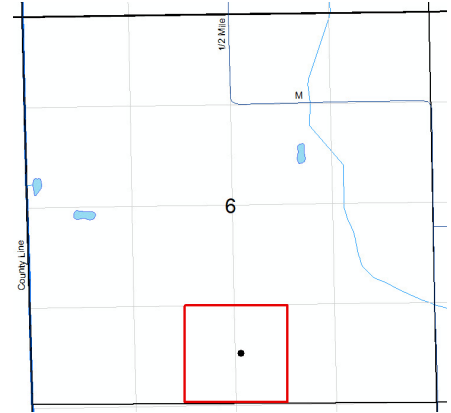

40-Acre Drilling Unit, E/2 SE/4
SW/4, W/2 SW/4 SE/4 Section 6

Location:	QT QT QT	Sec	Township	Range	Township Name	County	Feet From Section Line	Feet From DRLG Unit Line
SL:	NWSWSE	6	4S	8W	ATHENS	CALHOUN	719 S 2579 E	
BHL:	NWSWSE	6	4S	8W	ATHENS	CALHOUN	719 S 2579 E	608 N 595 E

Michigan Department of
 Environment, Great Lakes, and Energy
 Oil, Gas and Minerals Division
 Updated Permits
 2/10/2020 THRU 2/14/2020
EGLE

Permit Number Permittee Number Permittee Name

PLUGGING INSTRUCTIONS ISSUED:

24197 5951 PAN GAS STORAGE LLC DBA
 SOUTHWEST GAS

 1300 MAIN STREET
 HOUSTON, TX 77002

API Well Number: 21-093-24197-00-00

Well Name: SMITH, HERMAN J ET UX 1-2

Plug Inst. Issue Date: 2/11/2020

Location	QT QT QT	Sec	Township	Range	Township Name	County	Feet From Section Line	Feet From DRLG Unit
SL:	W2NWNE	2	2N	4E	MARION	LIVINGSTON	660 N 100 W	
BHL:	W2NWNE	2	2N	4E	MARION	LIVINGSTON	660 N 100 W	

Comment: App to P&A expires on 2/11/21

24202 5951 PAN GAS STORAGE LLC DBA
 SOUTHWEST GAS

 1300 MAIN STREET
 HOUSTON, TX 77002

API Well Number: 21-093-24202-00-00

Well Name: SCOTT, SHIRL ET UX 1-1

Plug Inst. Issue Date: 2/11/2020

Location	QT QT QT	Sec	Township	Range	Township Name	County	Feet From Section Line	Feet From DRLG Unit
SL:	S2NWNE	1	2N	4E	MARION	LIVINGSTON	990 N 660 W	
BHL:	S2NWNE	1	2N	4E	MARION	LIVINGSTON	990 N 660 W	

Comment: App to P&A expires on 2/11/21

Michigan Department of
 Environment, Great Lakes, and Energy
 Oil, Gas and Minerals Division
 Updated Permits
 2/10/2020 THRU 2/14/2020



Permit Number Permittee Number Permittee Name

24260 5951 PAN GAS STORAGE LLC DBA
 SOUTHWEST GAS

1300 MAIN STREET
 HOUSTON, TX 77002

API Well Number: 21-093-24260-00-00

Well Name: MINOR, FRANCIS N ET UX ET AL
 1-7

Plug Inst. Issue Date: 2/11/2020

Location	QT QT QT	Sec	Township	Range	Township Name	County	Feet From Section Line	Feet From DRLG Unit
SL:	NENENE	7	2N	5E	GENOA	LIVINGSTON	260 N 360 E	
BHL:	NENENE	7	2N	5E	GENOA	LIVINGSTON	260 N 360 E	

Comment: App to P&A expires on 2/11/21

26092 5951 PAN GAS STORAGE LLC DBA
 SOUTHWEST GAS

1300 MAIN STREET
 HOUSTON, TX 77002

API Well Number: 21-093-26092-00-00

Well Name: KUHNS 1-8

Plug Inst. Issue Date: 2/11/2020

Location	QT QT QT	Sec	Township	Range	Township Name	County	Feet From Section Line	Feet From DRLG Unit
SL:	SWSNW	8	2N	5E	GENOA	LIVINGSTON	70 S 1230 E	
BHL:	SWSNW	8	2N	5E	GENOA	LIVINGSTON	70 S 1230 E	

Comment: App to P&A expires on 2/11/21

Michigan Department of
 Environment, Great Lakes, and Energy
 Oil, Gas and Minerals Division
 Updated Permits
 2/10/2020 THRU 2/14/2020
EGL

Permit Number Permittee Number Permittee Name

26095 5951 PAN GAS STORAGE LLC DBA
 SOUTHWEST GAS

 1300 MAIN STREET
 HOUSTON, TX 77002

API Well Number: 21-093-26095-00-00

Well Name: WHITE 2-8

Plug Inst. Issue Date: 2/11/2020

Location	QT QT QT	Sec	Township	Range	Township Name	County	Feet From Section Line	Feet From DRLG Unit
SL:	CNSWSW	8	2N	5E	GENOA	LIVINGSTON	485 S 583 W	
BHL:	CNSWSW	8	2N	5E	GENOA	LIVINGSTON	485 S 583 W	

Comment: App to P&A expires on 2/11/21

26096 5951 PAN GAS STORAGE LLC DBA
 SOUTHWEST GAS

 1300 MAIN STREET
 HOUSTON, TX 77002

API Well Number: 21-093-26096-00-00

Well Name: MAHER 1-2

Plug Inst. Issue Date: 2/11/2020

Location	QT QT QT	Sec	Township	Range	Township Name	County	Feet From Section Line	Feet From DRLG Unit
SL:	SWNWNE	2	2N	4E	MARION	LIVINGSTON	1744 S 200 W	
BHL:	SWNWNE	2	2N	4E	MARION	LIVINGSTON	1744 S 200 W	

Comment: App to P&A expires on 2/11/21

Michigan Department of
 Environment, Great Lakes, and Energy
 Oil, Gas and Minerals Division
 Updated Permits
 2/10/2020 THRU 2/14/2020
EGLE

Permit Number Permittee Number Permittee Name

26111 5951 PAN GAS STORAGE LLC DBA
 SOUTHWEST GAS

 1300 MAIN STREET
 HOUSTON, TX 77002

API Well Number: 21-093-26111-00-00

Well Name: WHITE 1-8

Plug Inst. Issue Date: 2/11/2020

Location	QT QT QT	Sec	Township	Range	Township Name	County	Feet From Section Line	Feet From DRLG Unit
SL:	S2NWSW	8	2N	5E	GENOA	LIVINGSTON	809 N 553 W	
BHL:	S2NWSW	8	2N	5E	GENOA	LIVINGSTON	809 N 553 W	

Comment: App to P&A expires on 2/11/21

26815 5951 PAN GAS STORAGE LLC DBA
 SOUTHWEST GAS

 1300 MAIN STREET
 HOUSTON, TX 77002

API Well Number: 21-093-26815-00-00

Well Name: WITT 1-27

Plug Inst. Issue Date: 2/11/2020

Location	QT QT QT	Sec	Township	Range	Township Name	County	Feet From Section Line	Feet From DRLG Unit
SL:	CNSENW	27	3N	4E	HOWELL	LIVINGSTON	1917 N 1868 W	
BHL:	CNSENW	27	3N	4E	HOWELL	LIVINGSTON	1917 N 1868 W	

Comment: App to P&A expires on 2/11/21

Michigan Department of
 Environment, Great Lakes, and Energy
 Oil, Gas and Minerals Division
 Updated Permits
 2/10/2020 THRU 2/14/2020
EGLE

Permit Number Permittee Number Permittee Name

61463 40 MUSKEGON DEVELOPMENT COMPANY
 1425 S MISSION RD
 MOUNT PLEASANT, MI 48858

API Well Number: 21-113-62001-00-00

Well Name: CAMP BUCKEYE 1-1 True Vertical Depth: 3882

Plug Inst. Issue Date: 2/3/2020

Location	QT QT QT	Sec	Township	Range	Township Name	County	Feet From Section Line	Feet From DRLG Unit
SL:	NWSESE	1	21N	6W	CLAM UNION	MISSAUKEE	1147 S 1207 E	
BHL:	SWNWSE	1	21N	6W	CLAM UNION	MISSAUKEE	1788 S 2237 E	460 S 918 E

Comment: App to P&A expires on 2/3/21

50326 6361 RIVERSIDE ENERGY MICHIGAN LLC
 10691 EAST CARTER ROAD
 SUITE 201
 TRAVERSE CITY, MI 49684

API Well Number: 21-119-50326-00-00

Well Name: HILLMAN B4-19 SWD

Plug Inst. Issue Date: 2/11/2020

Location	QT QT QT	Sec	Township	Range	Township Name	County	Feet From Section Line	Feet From DRLG Unit
SL:	NESENE	19	31N	4E	HILLMAN	MONTMORENCY	1290 S 176 E	
BHL:	NESENE	19	31N	4E	HILLMAN	MONTMORENCY	1290 S 176 E	

Comment: App to P&A expires on 2/11/21

Michigan Department of
 Environment, Great Lakes, and Energy
 Oil, Gas and Minerals Division
 Updated Permits
 2/10/2020 THRU 2/14/2020
EGL

Permit Number Permittee Number Permittee Name

50775 6361 RIVERSIDE ENERGY MICHIGAN LLC
 10691 EAST CARTER ROAD
 SUITE 201
 TRAVERSE CITY, MI49684

API Well Number: 21-119-50775-00-00

Well Name: PONDEROSA CLUB 7-27

Plug Inst. Issue Date: 2/13/2020

Location	QT QT QT	Sec	Township	Range	Township Name	County	Feet From Section Line	Feet From DRLG Unit
SL:	NWSWNE	27	31N	2E	BRILEY	MONTMORENCY	722 S 362 W	
BHL:	NWSWNE	27	31N	2E	BRILEY	MONTMORENCY	722 S 362 W	

Comment: App to P&A expires on 2/13/21

52567 6361 RIVERSIDE ENERGY MICHIGAN LLC
 10691 EAST CARTER ROAD
 SUITE 201
 TRAVERSE CITY, MI49684

API Well Number: 21-119-52567-00-00

Well Name: STATE BRILEY & MOREAU 14-3

Plug Inst. Issue Date: 2/13/2020

Location	QT QT QT	Sec	Township	Range	Township Name	County	Feet From Section Line	Feet From DRLG Unit
SL:	NESESW	3	31N	2E	BRILEY	MONTMORENCY	840 S 460 E	
BHL:	NESESW	3	31N	2E	BRILEY	MONTMORENCY	840 S 460 E	

Comment: App to P&A expires on 2/13/21

Michigan Department of
 Environment, Great Lakes, and Energy
 Oil, Gas and Minerals Division
 Updated Permits
 2/10/2020 THRU 2/14/2020
EGLE

Permit Number Permittee Number Permittee Name

41641 6361 RIVERSIDE ENERGY MICHIGAN LLC
 10691 EAST CARTER ROAD
 SUITE 201
 TRAVERSE CITY, MI49684

API Well Number: 21-137-30873-01-00

Well Name: TOMASKI SWD 1-19

Plug Inst. Issue Date: 2/10/2020

Location	QT QT QT	Sec	Township	Range	Township Name	County	Feet From Section Line	Feet From DRLG Unit
SL:	SESESW	19	30N	1W	CHARLTON	OTSEGO	580 S 350 E	
BHL:	SESESW	19	30N	1W	CHARLTON	OTSEGO	580 S 350 E	

Comment: App to P&A expires on 2/10/21



Michigan Department of
 Environment, Great Lakes, and Energy
 Oil, Gas and Minerals Division
 Updated Permits
 2/10/2020 THRU 2/14/2020



Permit Number Permittee Number Permittee Name

RECORD OF WELL PLUGGING:

58221 100 APOLLO EXPLORATION AND
 DEVELOPMENT INC
 1710 E REMUS ROAD
 PO BOX 190
 MOUNT PLEASANT, MI 48804-0190

API Well Number: 21-073-58221-00-00

Well Name: REID 1-30

Plugging Date: 1/9/2020

Location	QT QT QT	Sec	Township	Range	Township Name	County	Feet From Section Line	Feet From DRLG Unit
SL:	NENENE	30	14N	5W	DEERFIELD	ISABELLA	230 N 330 E	1104 S 330 E
BHL:	NENENE	30	14N	5W	DEERFIELD	ISABELLA	230 N 330 E	1104 S 330 E

61463 40 MUSKEGON DEVELOPMENT
 COMPANY

 1425 S MISSION RD
 MOUNT PLEASANT, MI 48858

API Well Number: 21-113-62001-00-00

Well Name: CAMP BUCKEYE 1-1 True Vertical Depth: 3882

Plugging Date: 1/25/2020

Location	QT QT QT	Sec	Township	Range	Township Name	County	Feet From Section Line	Feet From DRLG Unit
SL:	NWSESE	1	21N	6W	CLAM UNION	MISSAUKEE	1147 S 1207 E	
BHL:	SWNWSE	1	21N	6W	CLAM UNION	MISSAUKEE	1788 S 2237 E	460 S 918 E

Michigan Department of
 Environment, Great Lakes, and Energy
 Oil, Gas and Minerals Division
 Updated Permits
 2/10/2020 THRU 2/14/2020
EGLE

Permit Number Permittee Number Permittee Name

APPLICATIONS TO CHANGE WELL STATUS:

61338 6418 W B OSBORN OIL AND GAS
 OPERATIONS LTD
 1250 NORTH EAST LOOP 410
 SUITE 600
 SAN ANTONIO, TX 78209

API Well Number: 21-117-61208-01-00

Well Name: WING 1-23A

True Vertical Depth: 2851

Approval Date: 2/4/2020

Location	QT QT QT	Sec	Township	Range	Township Name	County	Feet From Section Line	Feet From DRLG Unit
SL:	NWNWSW	23	11N	5W	FERRIS	MONTCALM	2318 S 430 W	
BHL:	NWNWSW	23	11N	5W	FERRIS	MONTCALM	2218 S 430 W	430 N 430 W

Proposed Rework: ACOWS to Continue Drilling - Straight Hole

Comment: ACOWS to deepen well F/ 2857' T/ 2865' in Traverse LS expires on 8/4/20