

Michigan Department of  
Environment, Great Lakes, and Energy  
Oil, Gas and Minerals Division

PERMIT APPLICATIONS

2/24/2020 THRU 2/28/2020



Application Number      Date Received      Permittee Number      Permittee Name      Page 1

449      02/26/2020      6498      WOLVERINE GAS AND OIL  
COMPANY OF MICHIGAN LLC  
ONE RIVERFRONT PLAZA  
55 CAMPAU, NW  
GRAND RAPIDS, MI 49503

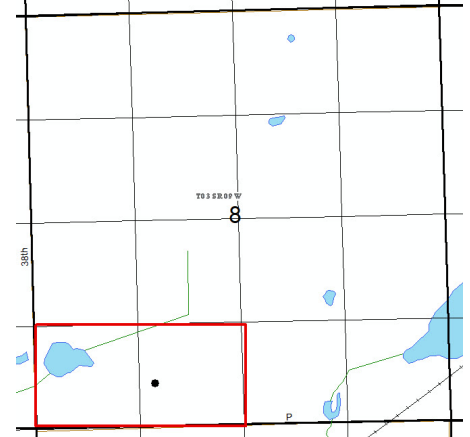

80-Acre R303 Drilling Unit, S/2 SW/4 Section 8

Prev Permit:

Well Name: Metty 8-1

Surface Owner: Duane and Marilyn Metty

Well Type: OIL

True Vertical Depth: 3930

Permit Type: Drill

Target Formation: TRENTON

H2S Present? Yes

Deepest Formation: GLENWOOD

Location:	QT QT QT	Sec	Township	Range	Township Name	County	Feet From Section Line	Feet From DRLG Unit Line
SL:	SWSESW	8	3S	9W	CLIMAX	KALAMAZOO	570 S 1553 W	570 S 1094 E
BHL:	SWSESW	8	3S	9W	CLIMAX	KALAMAZOO	570 S 1553 W	570 S 1094 E

455      02/25/2020      491      CONSUMERS ENERGY CO  
  
1945 W PARNALL RD  
JACKSON, MI 49201

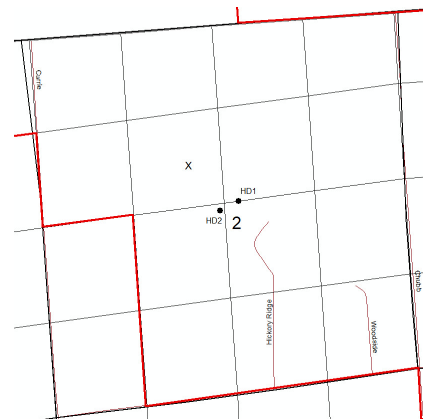

Northville Gas Storage Field, no drilling unit, non-producing well.

Prev Permit:

Well Name: NORTHVILLE N-303 HD1 & HD2

Surface Owner: CONSUMERS ENERGY COMPANY

Well Type: Gas Storage

True Vertical Depth: 3060

Permit Type: Drill

Target Formation: NIAGARAN

H2S Present? No

Deepest Formation: NIAGARAN

Location:	QT QT QT	Sec	Township	Range	Township Name	County	Feet From Section Line	Feet From DRLG Unit Line
SL:	SESESW	2	1S	7E	SALEM	WASHTENAW	1907 N 2083 W	
BHL:	NWNWSE	2	1S	7E	SALEM	WASHTENAW	2443 N 2344 W	206 N 17 E

Michigan Department of  
Environment, Great Lakes, and Energy  
Oil, Gas and Minerals Division

PERMIT APPLICATIONS

2/24/2020 THRU 2/28/2020



Application Number      Date Received      Permittee Number      Permittee Name      Page 2

456      02/26/2020      5320      SAVOY ENERGY LP  
920 HASTINGS STREET, SUITE A  
PO BOX 1560  
TRAVERSE CITY, MI 49685-1560

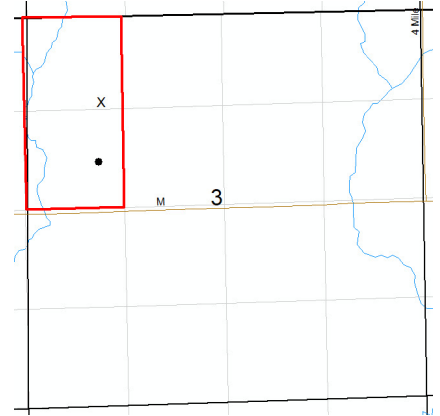

Prev Permit: 61470

Well Name: Replogle 3-3A

Well Type: OIL

Permit Type: Re-Entry

H2S Present? No

Surface Owner: Replogle, Charles L.  
and Lalita M.

True Vertical Depth: 4000

Target Formation: TRENTON-BLACK  
RIVER

Deepest Formation: PRAIRIE DU CHIEN

80-Acre R303 Drilling Unit, W/2 NW/4  
Section 3

Location:	QT QT QT	Sec	Township	Range	Township Name	County	Feet From Section Line	Feet From DRLG Unit Line
SL:	SENWNW	3	4S	8W	ATHENS	CALHOUN	1153 N 998 W	
BHL:	NESWNW	3	4S	8W	ATHENS	CALHOUN	1926 N 977 W	668 S 352 E

Michigan Department of  
Environment, Great Lakes, and Energy  
Oil, Gas and Minerals Division

PERMIT APPLICATIONS

2/24/2020 THRU 2/28/2020



Application Number

Date Received

Permittee  
Number

Permittee  
Name

Page 3

457                      02/28/2020                      5320                      SAVOY ENERGY LP  
920 HASTINGS STREET, SUITE A  
PO BOX 1560  
TRAVERSE CITY, MI 49685-1560

Prev Permit:

Well Name: Cramer 1-4

Well Type: OIL

Permit Type: Drill

H2S Present? No

Surface Owner: Cramer, Mark J.

True Vertical Depth: 4000

Target Formation: TRENTON-BLACK  
RIVER

Deepest Formation: PRAIRIE DU CHIEN

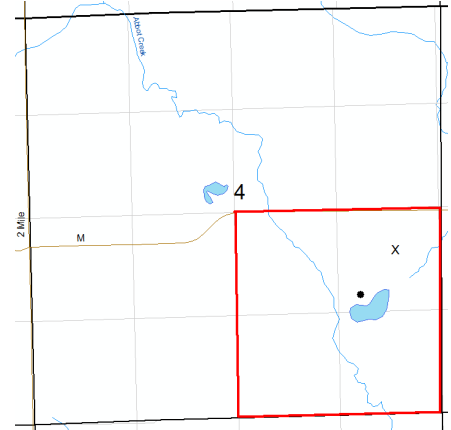

160-Acre R303 Drilling Unit, SE/4  
Section 4

Location:	QT QT QT	Sec	Township	Range	Township Name	County	Feet From Section Line	Feet From DRLG Unit Line
SL:	NENESE	4	4S	8W	ATHENS	CALHOUN	2036 S 595 E	
BHL:	SWNESE	4	4S	8W	ATHENS	CALHOUN	1458 S 1037 E	1065 N 1037 E

Michigan Department of  
Environment, Great Lakes, and Energy  
Oil, Gas and Minerals Division

PERMIT LIST

2/23/2020 THRU 2/29/2020



Permit Number      Issue Date      Permittee Number      Permittee Name      Page 1

61474      2/24/2020      5320      SAVOY ENERGY LP  
920 HASTINGS STREET, SUITE A  
PO BOX 1560  
TRAVERSE CITY, MI 49685-1560

API Well No: 21-025-62017-01-00

Prev Permit: 61469

Well Name: WAGLEY 1-1A

Well Type: Oil Well

Permit Type: Re-entry

H2S Present? No

Surface Owner: Wagley, Susan M.

True Vertical Depth: 4000FT

Target Formation: TRENTON-BLACK RIVER

Deepest Formation: PRAIRIE DU CHIEN

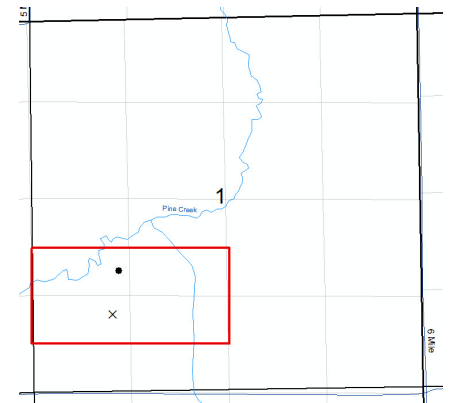

80-Acre R303 Drilling Unit, S/2 N/2 SW/4, N/2 S/2 SW/4 Section 1

Location:	QT QT QT	Sec	Township	Range	Township Name	County	Feet From Section Line	Feet From DRLG Unit Line
SL:	NESWSW	1	4S	8W	ATHENS	CALHOUN	1070 S 1054 W	
BHL:	SENWSW	1	4S	8W	ATHENS	CALHOUN	1535 S 1193 W	369 N 1193 W

61475      2/27/2020      6003      SUNOCO PARTNERS MARKETING AND TERMINALS LP

3807 WEST CHESTER PIKE  
NEWTOWN SQUARE, PA 19073

API Well No: 21-163-62001-00-00

Prev Permit:

Well Name: SUNOCO 11

Well Type: LPG Storage

Permit Type: Drill

H2S Present? No

Surface Owner: SUNOCO PARTNERS MARKETING & TERMINALS LP

True Vertical Depth: 1760FT

Target Formation: SALINA B SALT

Deepest Formation: SALINA B SALT

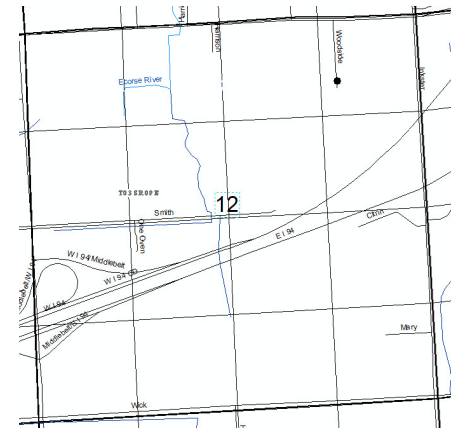

Hydrocarbon storage cavern, no drilling unit, non-producing well.

Location:	QT QT QT	Sec	Township	Range	Township Name	County	Feet From Section Line	Feet From DRLG Unit Line
SL:	SWNENE	12	3S	9E	ROMULUS	WAYNE	934 N 1182 E	
BHL:	SWNENE	12	3S	9E	ROMULUS	WAYNE	934 N 1182 E	

Michigan Department of  
Environment, Great Lakes, and Energy  
Oil, Gas and Minerals Division

PERMIT LIST

2/23/2020 THRU 2/29/2020



Permit Number	Issue Date	Permittee Number	Permittee Name	Page 2
---------------	------------	------------------	----------------	--------

61476      2/27/2020      6003      **SUNOCO PARTNERS MARKETING AND TERMINALS LP**  
  
3807 WEST CHESTER PIKE  
NEWTOWN SQUARE, PA 19073

API Well No: 21-163-62002-00-00

Prev Permit:

Well Name: SUNOCO 12

Well Type: LPG Storage

Permit Type: Drill

H2S Present? No

Surface Owner: SUNOCO PARTNERS MARKETING & TERMINALS LP  
True Vertical Depth: 1760FT  
Target Formation: SALINA B SALT  
Deepest Formation: SALINA B SALT

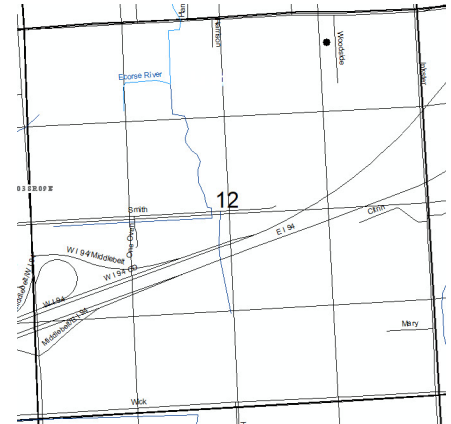

Hydrocarbon storage cavern, no drilling unit, non-producing well.

Location:	QT QT QT	Sec	Township	Range	Township Name	County	Feet From Section Line	Feet From DRLG Unit Line
SL:	NWNENE	12	3S	9E	ROMULUS	WAYNE	432 N 1223 E	
BHL:	NWNENE	12	3S	9E	ROMULUS	WAYNE	432 N 1223 E	

Michigan Department of  
 Environment, Great Lakes, and Energy  
 Oil, Gas and Minerals Division  
 Updated Permits  
 2/24/2020 THRU 2/28/2020  
**EGLE**

Permit Number      Permittee Number      Permittee Name

**RECORD OF WELL PLUGGING:**

15014            2950            LEASE MANAGEMENT INC  
 503 INDUSTRIAL AVE  
 PO BOX 290  
 MOUNT PLEASANT, MI 48804-0290

API Well Number: 21-113-15014-00-00

Well Name: MERRILL-PALMER-SCHOOL ET  
 AL 1

Plugging Date: 2/7/2020

Location	QT QT QT	Sec	Township	Range	Township Name	County	Feet From Section Line	Feet From DRLG Unit
SL:	CNSW	35	22N	6W	AETNA	MISSAUKEE	1320 S 1320 W	1320 S 1320 W
BHL:	CNSW	35	22N	6W	AETNA	MISSAUKEE	1320 S 1320 W	1320 S 1320 W