

Michigan Department of  
Environment, Great Lakes, and Energy  
Oil, Gas, and Minerals Division

PERMIT LIST

9/7/2020 THRU 9/11/2020



Permit Number	Issue Date	Permittee Number	Permittee Name
61496	9/9/2020	104	WEST BAY EXPLORATION COMPANY
API Well No: 21-035-62013-00-00			13685 S WEST BAYSHORE DR TRAVERSE CITY, MI 49684
Prev Permit:			Surface Owner: Sherman and Diane Little
Well Name: LITTLE 1-24			True Vertical Depth: 4150FT
Well Type: Oil Well			Target Formation: DUNDEE
Permit Type: Drill			Deepest Formation: DUNDEE
H2S Present? Yes			

Page 1

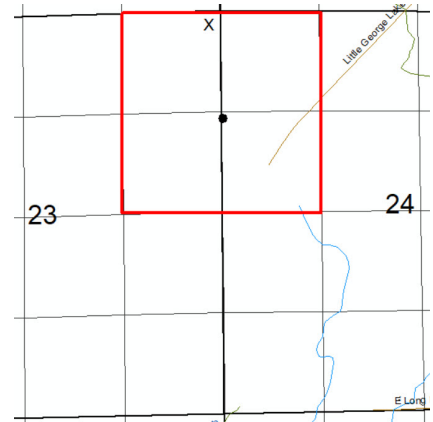

160-acre R303 Drilling Unit; E/2 NE/4 Sec 23, W/2 NW/4 Sec 24

Location:	QT QT QT	Sec	Township	Range	Township Name	County	Feet From Section Line	Feet From DRLG Unit Line
SL:	NENENE	23	20N	3W	FRANKLIN	CLARE	248 N 166 E	
BHL:	NWSWNW	24	20N	3W	FRANKLIN	CLARE	1370 N 0 W	1270 S 1336 E

Michigan Department of  
Environment, Great Lakes, and Energy  
Oil, Gas, and Minerals Division  
Updated Permits  
9/7/2020 THRU 9/11/2020



Permit Number      Permittee Number      Permittee Name

**PLUGGING INSTRUCTIONS ISSUED:**

30697                      5914                                      C M S GAS TRANSMISSION CO  
1 ENERGY PLAZA DR, EP1-420  
JACKSON, MI 49201-2276

API Well Number:    21-125-30697-00-00

Well Name:            MCGC LEONARD BDW 1

Plug Inst. Issue Date:    9/8/2020

Location	QT QT QT	Sec	Township	Range	Township Name	County	Feet From Section Line	Feet From DRLG Unit
SL:	NESENE	15	5N	11E	ADDISON	OAKLAND	1053 S 429 E	218 N 429 E
BHL:	NESENE	15	5N	11E	ADDISON	OAKLAND		

Comment:    App to P&A expires on 9/8/21

5506                      2545                                      UNION OIL CO OF CALIFORNIA  
2210 WEST PINE RIVER ROAD  
BRECENRIDGE, MI 48615-9611

API Well Number:    21-035-05506-00-00

Well Name:            BICKNELL, JAMES S 1-D

Plug Inst. Issue Date:    9/8/2020

Location	QT QT QT	Sec	Township	Range	Township Name	County	Feet From Section Line	Feet From DRLG Unit
SL:	S2SWNW	27	19N	6W	REDDING	CLARE	330 S 660 W	
BHL:	S2SWNW	27	19N	6W	REDDING	CLARE		

Comment:    App to Re-P&A expires on 9/8/21

Michigan Department of  
 Environment, Great Lakes, and Energy  
 Oil, Gas, and Minerals Division  
 Updated Permits  
 9/7/2020 THRU 9/11/2020



Permit Number      Permittee Number      Permittee Name

39298                      5914                      C M S GAS TRANSMISSION CO  
 1 ENERGY PLAZA DR, EP1-420  
 JACKSON, MI 49201-2276

API Well Number: 21-125-29864-01-00

Well Name: BELIAN ET AL 3-15 HD1                      True Vertical Depth: 4272

Plug Inst. Issue Date: 9/8/2020

Location	QT QT QT	Sec	Township	Range	Township Name	County	Feet From Section Line	Feet From DRLG Unit
SL:	SESENE	15	5N	11E	ADDISON	OAKLAND	327 S 325 E	
BHL:	NESENE	15	5N	11E	ADDISON	OAKLAND	1100 S 148 E	171 N 148 E

Comment: App to P&A expires on 9/8/21



Michigan Department of  
Environment, Great Lakes, and Energy  
Oil, Gas, and Minerals Division  
Updated Permits  
9/7/2020 THRU 9/11/2020



Permit Number      Permittee Number      Permittee Name

**RECORD OF WELL PLUGGING:**

10133      491      CONSUMERS ENERGY CO  
1945 W PARNALL RD  
JACKSON, MI 49201

API Well Number: 21-035-10133-00-00

Well Name: MICH GAS STORAGE 703

Plugging Date: 8/10/2020

Location	QT QT QT	Sec	Township	Range	Township Name	County	Feet From Section Line	Feet From DRLG Unit
SL:	CNNE	1	20N	6W	WINTERFIELD	CLARE	1320 N 1320 E	
BHL:		1	20N	6W	WINTERFIELD	CLARE	1320 N 1320 E	

55927      6361      RIVERSIDE ENERGY MICHIGAN LLC  
10691 EAST CARTER ROAD  
SUITE 201  
TRAVERSE CITY, MI 49684

API Well Number: 21-029-55927-00-00

Well Name: DESCHAMPS D3-34

Plugging Date: 9/1/2020

Location	QT QT QT	Sec	Township	Range	Township Name	County	Feet From Section Line	Feet From DRLG Unit
SL:	NWSWSE	34	32N	7W	SOUTH ARM	CHARLEVOIX	1275 S 2118 E	1275 S 481 W
BHL:	NWSWSE	34	32N	7W	SOUTH ARM	CHARLEVOIX		

Michigan Department of  
 Environment, Great Lakes, and Energy  
 Oil, Gas, and Minerals Division  
 Updated Permits  
 9/7/2020 THRU 9/11/2020



Permit Number      Permittee Number      Permittee Name

2343                      2298                      UNION OIL CO OF CALIFORNIA  
 2210 W. PINE RIVER RD.  
 BRECKENRIDGE, MI 48615

API Well Number: 21-111-02343-00-00

Well Name: ALEXANDER, C. D. 5

Plugging Date: 10/24/2019

Location	QT QT QT	Sec	Township	Range	Township Name	County	Feet From Section Line	Feet From DRLG Unit
SL:	NENENE	19	13N	1W	PORTER	MIDLAND	330 N 330 E	
BHL:	NENENE	19	13N	1W	PORTER	MIDLAND		

25546                      491                      CONSUMERS ENERGY CO  
 1945 W PARNALL RD  
 JACKSON, MI 49201

API Well Number: 21-099-25546-00-00

Well Name: CONSUMERS POWER COMPANY  
 R-103

Plugging Date: 8/17/2020

Location	QT QT QT	Sec	Township	Range	Township Name	County	Feet From Section Line	Feet From DRLG Unit
SL:	SESENW	36	5N	13E	ARMADA	MACOMB	330 S 180 E	
BHL:	SESENW	36	5N	13E	ARMADA	MACOMB	330 S 180 E	

Michigan Department of  
 Environment, Great Lakes, and Energy  
 Oil, Gas, and Minerals Division  
 Updated Permits  
 9/7/2020 THRU 9/11/2020



Permit Number      Permittee Number      Permittee Name

36758      5953      H L BROWN OPERATING LLC  
 300 WEST LOUISIANA  
 PO BOX 2237  
 MIDLAND, TX 79702

API Well Number: 21-007-36758-00-00

Well Name: SNOWPLOW 1-5

Plugging Date: 8/13/2020

Location	QT QT QT	Sec	Township	Range	Township Name	County	Feet From Section Line	Feet From DRLG Unit
SL:	SESWNW	5	29N	5E	OSSINEKE	ALPENA	467 S 1117 W	467 S 1117 W
BHL:	SESWNW	5	29N	5E	OSSINEKE	ALPENA		



Michigan Department of  
 Environment, Great Lakes, and Energy  
 Oil, Gas, and Minerals Division  
 Updated Permits  
 9/7/2020 THRU 9/11/2020



MICHIGAN DEPARTMENT OF  
 ENVIRONMENT, GREAT LAKES, AND ENERGY

Permit Number      Permittee Number      Permittee Name

**RECORD OF CHANGE OF WELL STATUS:**

12761                      491                      CONSUMERS ENERGY CO  
  
 1945 W PARNALL RD  
 JACKSON, MI 49201

API Well Number: 21-035-12761-00-00

Well Name: MICHIGAN GAS STORAGE CO  
 233

Change Date: 9/3/2020

Location	QT QT QT	Sec	Township	Range	Township Name	County	Feet From Section Line	Feet From DRLG Unit
SL:	CNNWSE	31	20N	6W	WINTERFIELD	CLARE	660 N 660 W	
BHL:	CNNWSE	31	20N	6W	WINTERFIELD	CLARE	660 N 660 W	

Proposed Rework: Reworked for Miscellaneous

Comment: Reworked for log, underream F/ 1316' T/ 1344', perf F/ 1294' T/ 1306', and return well to service.

21488                      491                      CONSUMERS ENERGY CO  
  
 1945 W PARNALL RD  
 JACKSON, MI 49201

API Well Number: 21-005-21488-00-00

Well Name: CONSUMERS POWER 17

Change Date: 7/3/2018

Location	QT QT QT	Sec	Township	Range	Township Name	County	Feet From Section Line	Feet From DRLG Unit
SL:	SWNWNE	16	4N	14W	OVERISEL	ALLEGAN	1240 N 75 W	
BHL:	SWNWNE	16	4N	14W	OVERISEL	ALLEGAN		

Proposed Rework: Reworked to Underreamed Open Hole

Comment: RCOWS for pull packer, log, underream, change tubing, and return well to service.

Michigan Department of  
 Environment, Great Lakes, and Energy  
 Oil, Gas, and Minerals Division  
 Updated Permits  
 9/7/2020 THRU 9/11/2020



MICHIGAN DEPARTMENT OF  
 ENVIRONMENT, GREAT LAKES, AND ENERGY

Permit Number      Permittee Number      Permittee Name

**TRANSFER OF OWNERSHIP:**

156                      8083                      CRESTWOOD SERVICES LLC  
 811 MAIN STREET  
 SUITE 3400  
 HOUSTON, TX 77006 USA

API Well Number: 21-081-00156-80-00

Well Name: ALTO PROPANE STORAGE FEE 2  
 SWD

Transfer Date: 9/11/2020

Previous Owner: PLAINS LPG SERVICES LP

Location	QT QT QT	Sec	Township	Range	Township Name	County	Feet From Section Line	Feet From DRLG Unit
SL:	NWNENW	3	5N	9W	BOWNE	KENT	370 N 670 E	
BHL:	NWNENW	3	5N	9W	BOWNE	KENT		

18162                      8083                      CRESTWOOD SERVICES LLC  
 811 MAIN STREET  
 SUITE 3400  
 HOUSTON, TX 77006 USA

API Well Number: 21-081-18162-00-00

Well Name: ALTO L P G STORAGE 2

Transfer Date: 9/11/2020

Previous Owner: PLAINS LPG SERVICES LP

Location	QT QT QT	Sec	Township	Range	Township Name	County	Feet From Section Line	Feet From DRLG Unit
SL:	NWNENW	3	5N	9W	BOWNE	KENT	542 N 1155 E	
BHL:	NWNENW	3	5N	9W	BOWNE	KENT		



Michigan Department of  
Environment, Great Lakes, and Energy  
Oil, Gas, and Minerals Division  
Updated Permits  
9/7/2020 THRU 9/11/2020



Permit Number      Permittee Number      Permittee Name

21780      8083      CRESTWOOD SERVICES LLC  
811 MAIN STREET  
SUITE 3400  
HOUSTON, TX 77006 USA

API Well Number: 21-081-21780-00-00

Well Name: ALTO L P G STORAGE 3

Transfer Date: 9/11/2020

Previous Owner: PLAINS LPG SERVICES LP

Location	QT QT QT	Sec	Township	Range	Township Name	County	Feet From Section Line	Feet From DRLG Unit
SL:	SWNENW	3	5N	9W	BOWNE	KENT	920 N 880 E	
BHL:	SWNENW	3	5N	9W	BOWNE	KENT		

29099      6310      CORE ENERGY LLC  
1011 NOTEWARE DRIVE  
TRAVERSE CITY, MI 49686

API Well Number: 21-137-29099-00-00

Well Name: STATE CHARLTON 1-28

Transfer Date: 9/11/2020

Previous Owner: LAMBDA ENERGY RESOURCES  
LLC

Location	QT QT QT	Sec	Township	Range	Township Name	County	Feet From Section Line	Feet From DRLG Unit
SL:	NENESE	28	31N	1W	CHARLTON	OTSEGO	330 N 385 E	990 S 385 E
BHL:	NENESE	28	31N	1W	CHARLTON	OTSEGO		

Michigan Department of  
 Environment, Great Lakes, and Energy  
 Oil, Gas, and Minerals Division  
 Updated Permits  
 9/7/2020 THRU 9/11/2020



MICHIGAN DEPARTMENT OF  
 ENVIRONMENT, GREAT LAKES, AND ENERGY

Permit Number      Permittee Number      Permittee Name

29144                  6310                  CORE ENERGY LLC  
  
 1011 NOTEWARE DRIVE  
 TRAVERSE CITY, MI 49686

API Well Number: 21-137-29144-00-00  
  
 Well Name: PLAGENS & VALEK 1-28  
  
 Transfer Date: 9/11/2020

Previous Owner: LAMBDA ENERGY RESOURCES  
 LLC

Location	QT QT QT	Sec	Township	Range	Township Name	County	Feet From Section Line	Feet From DRLG Unit
SL:	SWSESE	28	31N	1W	CHARLTON	OTSEGO	550 S 760 E	550 S 560 W
BHL:	SWSESE	28	31N	1W	CHARLTON	OTSEGO		

29433                  6310                  CORE ENERGY LLC  
  
 1011 NOTEWARE DRIVE  
 TRAVERSE CITY, MI 49686

API Well Number: 21-137-29433-00-00  
  
 Well Name: STATE CHARLTON 1-27                  True Vertical Depth: 5407  
  
 Transfer Date: 9/11/2020

Previous Owner: LAMBDA ENERGY RESOURCES  
 LLC

Location	QT QT QT	Sec	Township	Range	Township Name	County	Feet From Section Line	Feet From DRLG Unit
SL:	SWSWNW	27	31N	1W	CHARLTON	OTSEGO	200 S 200 W	
BHL:	SWSWNW	27	31N	1W	CHARLTON	OTSEGO	2046 N 615 W	543 S 615 W

Michigan Department of  
 Environment, Great Lakes, and Energy  
 Oil, Gas, and Minerals Division  
 Updated Permits  
 9/7/2020 THRU 9/11/2020



Permit Number      Permittee Number      Permittee Name

29489      8083      CRESTWOOD SERVICES LLC  
 811 MAIN STREET  
 SUITE 3400  
 HOUSTON, TX 77006 USA

API Well Number: 21-081-29489-00-00  
 Well Name: ALTO L P G STORAGE 4  
 Transfer Date: 9/11/2020  
 Previous Owner: PLAINS LPG SERVICES LP

Location	QT QT QT	Sec	Township	Range	Township Name	County	Feet From Section Line	Feet From DRLG Unit
SL:	NWNENW	3	5N	9W	BOWNE	KENT	300 N 945 E	
BHL:	NWNENW	3	5N	9W	BOWNE	KENT		

29490      8083      CRESTWOOD SERVICES LLC  
 811 MAIN STREET  
 SUITE 3400  
 HOUSTON, TX 77006 USA

API Well Number: 21-081-29490-00-00  
 Well Name: ALTO L P G STORAGE 5  
 Transfer Date: 9/11/2020  
 Previous Owner: PLAINS LPG SERVICES LP

Location	QT QT QT	Sec	Township	Range	Township Name	County	Feet From Section Line	Feet From DRLG Unit
SL:	N2N2NW	3	5N	9W	BOWNE	KENT	250 N 1295 W	
BHL:	N2N2NW	3	5N	9W	BOWNE	KENT	250 N 1295 W	

Michigan Department of  
 Environment, Great Lakes, and Energy  
 Oil, Gas, and Minerals Division  
 Updated Permits  
 9/7/2020 THRU 9/11/2020



Permit Number      Permittee Number      Permittee Name

29780                  6310                  CORE ENERGY LLC  
 1011 NOTEWARE DRIVE  
 TRAVERSE CITY, MI 49686

API Well Number: 21-137-29780-00-00  
 Well Name: AXFORD, HENRY W JR, ET UX 1-12  
 Transfer Date: 9/11/2020  
 Previous Owner: LAMBDA ENERGY RESOURCES LLC

Location	QT QT QT	Sec	Township	Range	Township Name	County	Feet From Section Line	Feet From DRLG Unit
SL:	NESWNW	12	31N	2W	DOVER	OTSEGO	971 S 777 W	971 S 543 E
BHL:	NESWNW	12	31N	2W	DOVER	OTSEGO		

29956                  6310                  CORE ENERGY LLC  
 1011 NOTEWARE DRIVE  
 TRAVERSE CITY, MI 49686

API Well Number: 21-137-29956-00-00  
 Well Name: STATE CHARLTON "A" 2-28                  True Vertical Depth: 5409  
 Transfer Date: 9/11/2020  
 Previous Owner: LAMBDA ENERGY RESOURCES LLC

Location	QT QT QT	Sec	Township	Range	Township Name	County	Feet From Section Line	Feet From DRLG Unit
SL:	NWNESE	28	31N	1W	CHARLTON	OTSEGO	573 N 725 E	
BHL:	NESWNE	28	31N	1W	CHARLTON	OTSEGO	599 S 585 W	599 S 735 E

Michigan Department of  
Environment, Great Lakes, and Energy  
Oil, Gas, and Minerals Division  
Updated Permits  
9/7/2020 THRU 9/11/2020



Permit Number      Permittee Number      Permittee Name

31592      8083      CRESTWOOD SERVICES LLC  
811 MAIN STREET  
SUITE 3400  
HOUSTON, TX 77006 USA

API Well Number: 21-081-31592-00-00  
Well Name: ALTO L P G STORAGE 6  
Transfer Date: 9/11/2020  
Previous Owner: PLAINS LPG SERVICES LP

Location	QT QT QT	Sec	Township	Range	Township Name	County	Feet From Section Line	Feet From DRLG Unit
SL:	NENWNW	3	5N	9W	BOWNE	KENT	250 N 895 W	
BHL:	NENWNW	3	5N	9W	BOWNE	KENT	250 N 895 W	

39318      6310      CORE ENERGY LLC  
1011 NOTEWARE DRIVE  
TRAVERSE CITY, MI 49686

API Well Number: 21-137-39318-00-00  
Well Name: STATE CHARLTON 3-33  
Transfer Date: 9/11/2020  
Previous Owner: LAMBDA ENERGY RESOURCES  
LLC

Location	QT QT QT	Sec	Township	Range	Township Name	County	Feet From Section Line	Feet From DRLG Unit
SL:	SESESE	33	31N	1W	CHARLTON	OTSEGO	460 S 561 E	460 S 561 E
BHL:	SESESE	33	31N	1W	CHARLTON	OTSEGO		

Michigan Department of  
 Environment, Great Lakes, and Energy  
 Oil, Gas, and Minerals Division  
 Updated Permits  
 9/7/2020 THRU 9/11/2020



MICHIGAN DEPARTMENT OF  
 ENVIRONMENT, GREAT LAKES, AND ENERGY

Permit Number      Permittee Number      Permittee Name

49097      6310      CORE ENERGY LLC  
 1011 NOTEWARE DRIVE  
 TRAVERSE CITY, MI 49686

API Well Number: 21-137-30772-02-00

Well Name: SCHOLLENBURGER & STATE      True Vertical Depth: 5925  
 CHARLTON 2-3B

Transfer Date: 9/11/2020

Previous Owner: LAMBDA ENERGY RESOURCES  
 LLC

Location	QT QT QT	Sec	Township	Range	Township Name	County	Feet From Section Line	Feet From DRLG Unit
SL:	NWNWNW	3	30N	1W	CHARLTON	OTSEGO	466 N 465 W	
BHL:	SENWNW	3	30N	1W	CHARLTON	OTSEGO	472 N 682 W	472 N 621 E

51208      6310      CORE ENERGY LLC  
 1011 NOTEWARE DRIVE  
 TRAVERSE CITY, MI 49686

API Well Number: 21-137-51208-00-00

Well Name: CHARLTON 4-28 SWD

Transfer Date: 9/11/2020

Previous Owner: LAMBDA ENERGY RESOURCES  
 LLC

Location	QT QT QT	Sec	Township	Range	Township Name	County	Feet From Section Line	Feet From DRLG Unit
SL:	NWSESE	28	31N	1W	CHARLTON	OTSEGO	848 S 845 E	
BHL:	NWSESE	28	31N	1W	CHARLTON	OTSEGO		