

Michigan Department of
 Environment, Great Lakes, and Energy
 Oil, Gas and Minerals Division
 PERMIT APPLICATIONS
 9/30/2019 THRU 10/4/2019

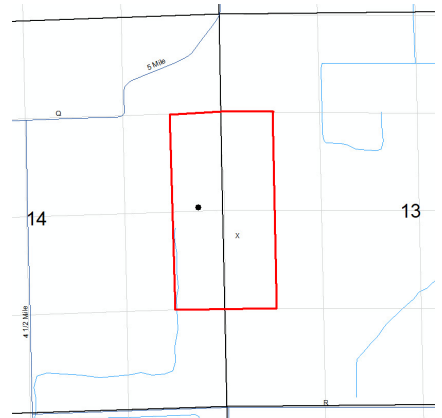

Application Number Date Received Permittee Number Permittee Name Page 1

417 10/04/2019 5320 SAVOY ENERGY LP
 920 HASTINGS STREET, SUITE A
 PO BOX 1560
 TRAVERSE CITY, MI49685-1560



Prev Permit: 61440

Well Name: Bottomley 1-13A

Surface Owner: Bottomley, Susan D.

Well Type: OIL

True Vertical Depth: 3828

Permit Type: Re-entry

Target Formation: TRENTON-BLACK RIVER

H2S Present? No

Deepest Formation: PRAIRIE DU CHIEN

80-acre R303 Drilling unit, E/2 SE/4 NE/4, E/2 NE/4 SE/4 Sec 14; W/2 SW/4 NW/4, W/2 NW/4 SW/4 Sec 13

Location:	QT QT QT	Sec	Township	Range	Township Name	County	Feet From Section Line	Feet From DRLG Unit Line
SL:	NWNWSW	13	4S	8W	ATHENS	CALHOUN	2276 S 110 W	
BHL:	SESENE	14	4S	8W	ATHENS	CALHOUN	2614 N 308 W	1281 N 355 W

Michigan Department of
 Environment, Great Lakes, and Energy
 Oil, Gas, and Minerals Division
 Updated Permits
 9/30/2019 THRU 10/04/2019
EGLE

Permit Number Permittee Number Permittee Name

PLUGGING INSTRUCTIONS ISSUED:

47941 5337 MIRACLE PETROLEUM LLC
 2780 GARFIELD RD NORTH
 PO BOX 6320
 TRAVERSE CITY, MI49686

API Well Number: 21-079-47805-01-00

Well Name: STATE GARFIELD 1-25A True Vertical Depth: 11373

Plug Inst. Issue Date: 9/30/2019

Location	QT QT QT	Sec	Township	Range	Township Name	County	Feet From Section Line	Feet From DRLG Unit
SL:	SEWNNE	25	25N	6W	GARFIELD	KALKASKA	1120 N 990 W	
BHL:	SEWNNW	30	25N	5W	GARFIELD	KALKASKA	1053 N 823 W	1587 S 1817 E

Comment: App to P&A Expires on 9/30/20

Michigan Department of
 Environment, Great Lakes, and Energy
 Oil, Gas, and Minerals Division
 Updated Permits
 9/30/2019 THRU 10/04/2019



Permit Number Permittee Number Permittee Name

RECORD OF WELL PLUGGING:

48738 6361 RIVERSIDE ENERGY MICHIGAN LLC
 10691 EAST CARTER ROAD
 SUITE 201
 TRAVERSE CITY, MI49684

API Well Number: 21-007-48738-00-00

Well Name: STATE OSSINEKE 2-3

Plugging Date: 9/16/2019

Location	QT QT QT	Sec	Township	Range	Township Name	County	Feet From Section Line	Feet From DRLG Unit
SL:	NENWNE	3	29N	6E	OSSINEKE	ALPENA	387 N 944 W	387 N 370 E

51068 6361 RIVERSIDE ENERGY MICHIGAN LLC
 10691 EAST CARTER ROAD
 SUITE 201
 TRAVERSE CITY, MI49684

API Well Number: 21-007-51068-00-00

Well Name: ELEVEN FORTY CLUB 1-4

Plugging Date: 9/16/2019

Location	QT QT QT	Sec	Township	Range	Township Name	County	Feet From Section Line	Feet From DRLG Unit
SL:	SENE NE	4	29N	6E	OSSINEKE	ALPENA	720 N 390 E	647 S 390 E

Michigan Department of
 Environment, Great Lakes, and Energy
 Oil, Gas, and Minerals Division
 Updated Permits
 9/30/2019 THRU 10/04/2019



Permit Number Permittee Number Permittee Name

51100 6361 RIVERSIDE ENERGY MICHIGAN LLC
 10691 EAST CARTER ROAD
 SUITE 201
 TRAVERSE CITY, MI49684

API Well Number: 21-007-51100-00-00

Well Name: ELEVEN FORTY CLUB 12-3

Plugging Date: 9/17/2019

Location	QT QT QT	Sec	Township	Range	Township Name	County	Feet From Section Line	Feet From DRLG Unit
SL:	NENWSW	3	29N	6E	OSSINEKE	ALPENA	660 N 1080 W	660 N 1080 W

51101 6361 RIVERSIDE ENERGY MICHIGAN LLC
 10691 EAST CARTER ROAD
 SUITE 201
 TRAVERSE CITY, MI49684

API Well Number: 21-007-51101-00-00

Well Name: HAHN 3-33

Plugging Date: 9/17/2019

Location	QT QT QT	Sec	Township	Range	Township Name	County	Feet From Section Line	Feet From DRLG Unit
SL:	NWNENW	33	30N	6E	GREEN	ALPENA	430 N 1010 E	430 N 1010 E

Michigan Department of
 Environment, Great Lakes, and Energy
 Oil, Gas, and Minerals Division
 Updated Permits
 9/30/2019 THRU 10/04/2019
EGLE

Permit Number Permittee Number Permittee Name

51102 6361 RIVERSIDE ENERGY MICHIGAN LLC
 10691 EAST CARTER ROAD
 SUITE 201
 TRAVERSE CITY, MI49684

API Well Number: 21-007-51102-00-00

Well Name: NEUMANN 3-3

Plugging Date: 9/16/2019

Location	QT QT QT	Sec	Township	Range	Township Name	County	Feet From Section Line	Feet From DRLG Unit
SL:	SWNENW	3	29N	6E	OSSINEKE	ALPENA	900 N 750 E	900 N 575 W

51108 6361 RIVERSIDE ENERGY MICHIGAN LLC
 10691 EAST CARTER ROAD
 SUITE 201
 TRAVERSE CITY, MI49684

API Well Number: 21-007-51108-00-00

Well Name: FURNISH 14-3

Plugging Date: 9/17/2019

Location	QT QT QT	Sec	Township	Range	Township Name	County	Feet From Section Line	Feet From DRLG Unit
SL:	SESESW	3	29N	6E	OSSINEKE	ALPENA	330 S 330 E	330 S 330 E

Michigan Department of
 Environment, Great Lakes, and Energy
 Oil, Gas, and Minerals Division
 Updated Permits
 9/30/2019 THRU 10/04/2019
EGLE

Permit Number Permittee Number Permittee Name

APPLICATIONS TO CHANGE WELL STATUS:

31148 7772 LAMBDA ENERGY RESOURCES LLC
 12012 Wickchester
 Suite 300
 Houston, TX 77055 USA

API Well Number: 21-055-31148-00-00

Well Name: PHOENIX PETROLEUM
 CORPORATION 2-28

Approval Date: 9/30/2019

Location	QT QT QT	Sec	Township	Range	Township Name	County	Feet From Section Line	Feet From DRLG Unit
SL:	NWNENW	28	25N	11W	MAYFIELD	GRAND TRAVERSE	83 N 1280 E	1232 S 1280 E

Proposed Rework: ACOWS to Acidize or Stimulate Current Formation

Comment: ACOWS to Add perfs and acidize in Niagaran; Expires 9/30/20

31826 7772 LAMBDA ENERGY RESOURCES LLC
 12012 Wickchester
 Suite 300
 Houston, TX 77055 USA

API Well Number: 21-101-31826-01-00

Well Name: CARPENTER ET AL 2-11 HD1

Approval Date: 7/22/2019

Location	QT QT QT	Sec	Township	Range	Township Name	County	Feet From Section Line	Feet From DRLG Unit
SL:		11	24N	13W	CLEON	MANISTEE	1605 S 1765 E	1605 N 849 W
BHL:	NESENE	11	24N	13W	CLEON	MANISTEE	1667 N 233 E	330 N 1558 E

Proposed Rework: ACOWS to Continue Drilling - HDH

Comment: Created API to drill HD1.

Michigan Department of
Environment, Great Lakes, and Energy
Oil, Gas, and Minerals Division
Updated Permits
9/30/2019 THRU 10/04/2019



Permit
Number

Permittee
Number

Permittee
Name

Page 6

TRANSFER OF OWNERSHIP:

TABLES FOLLOW THIS PAGE

Transfer Date	Previous Operator	New Operator	WellName	Permit	County	Township	Sec	Twp	TwpDir	Rng	RngDir
09/30/2019	RIVIERA OPERATING LLC	RIVERSIDE ENERGY MICHIGAN LLC	KLARICH ET AL A2-3	58484	ALCONA	CALEDONIA	3	28	N	6	E
09/30/2019	RIVIERA OPERATING LLC	RIVERSIDE ENERGY MICHIGAN LLC	STATE HAWES & REMINGTON B1-19 HD	57009	ALCONA	HAWES	19	27	N	8	E
09/30/2019	RIVIERA OPERATING LLC	RIVERSIDE ENERGY MICHIGAN LLC	STATE HAWES & REMINGTON B1-19 HD	57009	ALCONA	HAWES	19	27	N	8	E
09/30/2019	RIVIERA OPERATING LLC	RIVERSIDE ENERGY MICHIGAN LLC	STATE HAWES & REMINGTON B1-19 HD	57009	ALCONA	HAWES	19	27	N	8	E
09/30/2019	RIVIERA OPERATING LLC	RIVERSIDE ENERGY MICHIGAN LLC	GAISHIN B4-20	56868	ALCONA	HAWES	20	27	N	8	E
09/30/2019	RIVIERA OPERATING LLC	RIVERSIDE ENERGY MICHIGAN LLC	GAISHIN B4-20	56868	ALCONA	HAWES	20	27	N	8	E
09/30/2019	RIVIERA OPERATING LLC	RIVERSIDE ENERGY MICHIGAN LLC	JOHNSON D3-24 HD	56772	ALCONA	HAWES	24	27	N	7	E
09/30/2019	RIVIERA OPERATING LLC	RIVERSIDE ENERGY MICHIGAN LLC	JOHNSON D3-24 HD	56772	ALCONA	HAWES	24	27	N	7	E
09/30/2019	RIVIERA OPERATING LLC	RIVERSIDE ENERGY MICHIGAN LLC	JOHNSON D3-24 HD	56772	ALCONA	HAWES	24	27	N	7	E
09/30/2019	RIVIERA OPERATING LLC	RIVERSIDE ENERGY MICHIGAN LLC	JOHNSON D3-24 HD	56772	ALCONA	HAWES	24	27	N	7	E
09/30/2019	RIVIERA OPERATING LLC	RIVERSIDE ENERGY MICHIGAN LLC	JOHNSON D3-24 HD	56772	ALCONA	HAWES	24	27	N	7	E
09/30/2019	RIVIERA OPERATING LLC	RIVERSIDE ENERGY MICHIGAN LLC	JOHNSON D3-24 HD	56772	ALCONA	HAWES	24	27	N	7	E
09/30/2019	RIVIERA OPERATING LLC	RIVERSIDE ENERGY MICHIGAN LLC	SCHULTZ ET AL B3-6	54118	ALCONA	CALEDONIA	6	28	N	7	E
09/30/2019	RIVIERA OPERATING LLC	RIVERSIDE ENERGY MICHIGAN LLC	SCHULTZ ET AL B3-6	54118	ALCONA	CALEDONIA	6	28	N	7	E
09/30/2019	RIVIERA OPERATING LLC	RIVERSIDE ENERGY MICHIGAN LLC	OAKLAND HUNT CLUB B1-5	60206	ALCONA	MITCHELL	5	28	N	5	E
09/30/2019	RIVIERA OPERATING LLC	RIVERSIDE ENERGY MICHIGAN LLC	STATE CALEDONIA & DIEZ B2-7	59869	ALCONA	CALEDONIA	7	28	N	7	E
09/30/2019	RIVIERA OPERATING LLC	RIVERSIDE ENERGY MICHIGAN LLC	MARY A2-8	42088	ANTRIM	MANCELONA	8	29	N	5	W
09/30/2019	RIVIERA OPERATING LLC	RIVERSIDE ENERGY MICHIGAN LLC	STATE MANCELONA A4-8	42217	ANTRIM	MANCELONA	8	29	N	5	W
09/30/2019	RIVIERA OPERATING LLC	RIVERSIDE ENERGY MICHIGAN LLC	STATE CALEDONIA D1-8	59868	ALCONA	CALEDONIA	8	28	N	7	E
09/30/2019	RIVIERA OPERATING LLC	RIVERSIDE ENERGY MICHIGAN LLC	KLARICH ET AL B1-3	59594	ALCONA	CALEDONIA	3	28	N	6	E
09/30/2019	RIVIERA OPERATING LLC	RIVERSIDE ENERGY MICHIGAN LLC	STATE HAWES - STOCK D2-20	59592	ALCONA	HAWES	20	27	N	8	E
09/30/2019	RIVIERA OPERATING LLC	RIVERSIDE ENERGY MICHIGAN LLC	DAHL ET AL D3-7	59577	ALCONA	CALEDONIA	7	28	N	8	E
09/30/2019	RIVIERA OPERATING LLC	RIVERSIDE ENERGY MICHIGAN LLC	KOWALSKI ET AL C1-8	59571	ALCONA	CALEDONIA	8	28	N	8	E
09/30/2019	RIVIERA OPERATING LLC	RIVERSIDE ENERGY MICHIGAN LLC	STATE HAWES-BARCLAY C1-21	59484	ALCONA	HAWES	21	27	N	8	E
09/30/2019	RIVIERA OPERATING LLC	RIVERSIDE ENERGY MICHIGAN LLC	LOST LAKE WOODS ET AL D1-33	59447	ALCONA	ALCONA	33	28	N	8	E
09/30/2019	RIVIERA OPERATING LLC	RIVERSIDE ENERGY MICHIGAN LLC	STATE HAWES-WAIBEL A3-19	59435	ALCONA	HAWES	19	27	N	8	E
09/30/2019	RIVIERA OPERATING LLC	RIVERSIDE ENERGY MICHIGAN LLC	WEGHER A2-26	59434	ALCONA	HAWES	26	27	N	7	E
09/30/2019	RIVIERA OPERATING LLC	RIVERSIDE ENERGY MICHIGAN LLC	STATE HAWES-JURK B1-20	59433	ALCONA	HAWES	20	27	N	8	E
09/30/2019	RIVIERA OPERATING LLC	RIVERSIDE ENERGY MICHIGAN LLC	KOWALSKI ET AL A3-5	59407	ALCONA	CALEDONIA	5	28	N	7	E
09/30/2019	RIVIERA OPERATING LLC	RIVERSIDE ENERGY MICHIGAN LLC	STATE ALCONA ET AL B1-21	59405	ALCONA	ALCONA	21	28	N	7	E
09/30/2019	RIVIERA OPERATING LLC	RIVERSIDE ENERGY MICHIGAN LLC	HUBBARD ASSOCIATES A4-28	59404	ALCONA	ALCONA	28	28	N	7	E
09/30/2019	RIVIERA OPERATING LLC	RIVERSIDE ENERGY MICHIGAN LLC	STATE CALEDONIA ET AL C2-3	59401	ALCONA	CALEDONIA	3	28	N	7	E
09/30/2019	RIVIERA OPERATING LLC	RIVERSIDE ENERGY MICHIGAN LLC	KLARICH ET AL A2-3	58484	ALCONA	CALEDONIA	3	28	N	6	E
09/30/2019	RIVIERA OPERATING LLC	RIVERSIDE ENERGY MICHIGAN LLC	VINCENT CREEK D2-8	58203	ALCONA	HAWES	8	27	N	8	E
09/30/2019	RIVIERA OPERATING LLC	RIVERSIDE ENERGY MICHIGAN LLC	WHITE PINE A4-7	58201	ALCONA	HAWES	7	27	N	8	E
09/30/2019	RIVIERA OPERATING LLC	RIVERSIDE ENERGY MICHIGAN LLC	WHITE PINE A1-7	58200	ALCONA	HAWES	7	27	N	8	E
09/30/2019	RIVIERA OPERATING LLC	RIVERSIDE ENERGY MICHIGAN LLC	WHITE PINE B2-7	58199	ALCONA	HAWES	7	27	N	8	E
09/30/2019	RIVIERA OPERATING LLC	RIVERSIDE ENERGY MICHIGAN LLC	WHITE PINE A3-7	58198	ALCONA	HAWES	7	27	N	8	E
09/30/2019	RIVIERA OPERATING LLC	RIVERSIDE ENERGY MICHIGAN LLC	WHITE PINE B1-8	57889	ALCONA	HAWES	8	27	N	8	E
09/30/2019	RIVIERA OPERATING LLC	RIVERSIDE ENERGY MICHIGAN LLC	BROWN A2-6	57799	ALCONA	HAWES	6	27	N	8	E
09/30/2019	RIVIERA OPERATING LLC	RIVERSIDE ENERGY MICHIGAN LLC	MV B2-5	57792	ALCONA	HAWES	5	27	N	8	E
09/30/2019	RIVIERA OPERATING LLC	RIVERSIDE ENERGY MICHIGAN LLC	MACNEILL B4-6	57790	ALCONA	HAWES	6	27	N	8	E
09/30/2019	RIVIERA OPERATING LLC	RIVERSIDE ENERGY MICHIGAN LLC	BROWN B2-6	57773	ALCONA	HAWES	6	27	N	8	E
09/30/2019	RIVIERA OPERATING LLC	RIVERSIDE ENERGY MICHIGAN LLC	MACNEILL A1-5	57718	ALCONA	HAWES	5	27	N	8	E
09/30/2019	RIVIERA OPERATING LLC	RIVERSIDE ENERGY MICHIGAN LLC	LOST LAKE WOODS ASSOC. ET AL D2-27	57606	ALCONA	ALCONA	27	28	N	8	E
09/30/2019	RIVIERA OPERATING LLC	RIVERSIDE ENERGY MICHIGAN LLC	DIEZ A4-7	57582	ALCONA	CALEDONIA	7	28	N	7	E
09/30/2019	RIVIERA OPERATING LLC	RIVERSIDE ENERGY MICHIGAN LLC	LEONHARDT ET AL B4-2	57527	ALCONA	CALEDONIA	2	28	N	7	E
09/30/2019	RIVIERA OPERATING LLC	RIVERSIDE ENERGY MICHIGAN LLC	KORPUSIK ET AL B4-7	57526	ALCONA	CALEDONIA	7	28	N	8	E
09/30/2019	RIVIERA OPERATING LLC	RIVERSIDE ENERGY MICHIGAN LLC	LOST LAKE WOODS ASSOC ETAL C3-28	57524	ALCONA	ALCONA	28	28	N	8	E
09/30/2019	RIVIERA OPERATING LLC	RIVERSIDE ENERGY MICHIGAN LLC	HUBBARD ASSOCIATES B1-28	57103	ALCONA	ALCONA	28	28	N	7	E
09/30/2019	RIVIERA OPERATING LLC	RIVERSIDE ENERGY MICHIGAN LLC	INDISH ET AL D4-17	57102	ALCONA	CALEDONIA	17	28	N	7	E
09/30/2019	RIVIERA OPERATING LLC	RIVERSIDE ENERGY MICHIGAN LLC	VAN HAVERBECK C2-5	57101	ALCONA	CALEDONIA	5	28	N	7	E
09/30/2019	RIVIERA OPERATING LLC	RIVERSIDE ENERGY MICHIGAN LLC	STATE HAWES & REMINGTON B1-19 HD	57009	ALCONA	HAWES	19	27	N	8	E
09/30/2019	RIVIERA OPERATING LLC	RIVERSIDE ENERGY MICHIGAN LLC	LOST LAKE WOODS ASSOC ETAL D4-33	56904	ALCONA	ALCONA	33	28	N	8	E
09/30/2019	RIVIERA OPERATING LLC	RIVERSIDE ENERGY MICHIGAN LLC	LOST LAKE WOODS ASSOC ETAL D4-34	56903	ALCONA	ALCONA	34	28	N	8	E
09/30/2019	RIVIERA OPERATING LLC	RIVERSIDE ENERGY MICHIGAN LLC	LOST LAKE WOODS ASSOC ETAL B3-34	56902	ALCONA	ALCONA	34	28	N	8	E
09/30/2019	RIVIERA OPERATING LLC	RIVERSIDE ENERGY MICHIGAN LLC	LOST LAKE WOODS ASSOC ETAL D2-34	56901	ALCONA	ALCONA	34	28	N	8	E
09/30/2019	RIVIERA OPERATING LLC	RIVERSIDE ENERGY MICHIGAN LLC	LOST LAKE WOODS ASSOC ETAL C1-34	56900	ALCONA	ALCONA	34	28	N	8	E
09/30/2019	RIVIERA OPERATING LLC	RIVERSIDE ENERGY MICHIGAN LLC	LOST LAKE WOODS ASSOC ETAL C1-35	56899	ALCONA	ALCONA	35	28	N	8	E
09/30/2019	RIVIERA OPERATING LLC	RIVERSIDE ENERGY MICHIGAN LLC	GAISHIN B4-20	56868	ALCONA	HAWES	20	27	N	8	E
09/30/2019	RIVIERA OPERATING LLC	RIVERSIDE ENERGY MICHIGAN LLC	THREE BUCK B1-1 SWD	56862	ALCONA	MITCHELL	1	27	N	6	E
09/30/2019	RIVIERA OPERATING LLC	RIVERSIDE ENERGY MICHIGAN LLC	COMSTOCK B1-20 SWD	56860	ALCONA	HAWES	20	27	N	7	E
09/30/2019	RIVIERA OPERATING LLC	RIVERSIDE ENERGY MICHIGAN LLC	JOHNSON D3-24 HD	56772	ALCONA	HAWES	24	27	N	7	E
09/30/2019	RIVIERA OPERATING LLC	RIVERSIDE ENERGY MICHIGAN LLC	JOHNSON D3-24 HD	56772	ALCONA	HAWES	24	27	N	7	E

Transfer Date	Previous Operator	New Operator	WellName	Permit	County	Township	Sec	Twp	TwpDir	Rng	RngDir
09/30/2019	RIVIERA OPERATING LLC	RIVERSIDE ENERGY MICHIGAN LLC	GINTER ET AL C3-19	56355	ALCONA	ALCONA	19	28	N	7	E
09/30/2019	RIVIERA OPERATING LLC	RIVERSIDE ENERGY MICHIGAN LLC	STATE CALEDONIA & VAN HAVERBECK B3-8	56309	ALCONA	CALEDONIA	8	28	N	7	E
09/30/2019	RIVIERA OPERATING LLC	RIVERSIDE ENERGY MICHIGAN LLC	VAN HAVERBECK A3-8	56308	ALCONA	CALEDONIA	8	28	N	7	E
09/30/2019	RIVIERA OPERATING LLC	RIVERSIDE ENERGY MICHIGAN LLC	BUTLER TRUST & HALE A4-29	56290	ALCONA	ALCONA	29	28	N	7	E
09/30/2019	RIVIERA OPERATING LLC	RIVERSIDE ENERGY MICHIGAN LLC	STATE CALEDONIA D2-17	56289	ALCONA	CALEDONIA	17	28	N	7	E
09/30/2019	RIVIERA OPERATING LLC	RIVERSIDE ENERGY MICHIGAN LLC	LOSTLAKE WOOD ASSOC ET AL D2-33	56288	ALCONA	ALCONA	33	28	N	8	E
09/30/2019	RIVIERA OPERATING LLC	RIVERSIDE ENERGY MICHIGAN LLC	STATE ALCONA & BUTLER TRUST C3-21	56284	ALCONA	ALCONA	21	28	N	7	E
09/30/2019	RIVIERA OPERATING LLC	RIVERSIDE ENERGY MICHIGAN LLC	DUBUQUE & PAULSON D3-17	56264	ALCONA	CALEDONIA	17	28	N	8	E
09/30/2019	RIVIERA OPERATING LLC	RIVERSIDE ENERGY MICHIGAN LLC	RAMSEY B3-20	56263	ALCONA	ALCONA	20	28	N	8	E
09/30/2019	RIVIERA OPERATING LLC	RIVERSIDE ENERGY MICHIGAN LLC	STATE CALEDONIA D1-2	56260	ALCONA	CALEDONIA	2	28	N	7	E
09/30/2019	RIVIERA OPERATING LLC	RIVERSIDE ENERGY MICHIGAN LLC	STATE MITCHELL & WAGGONER C4-1	55427	ALCONA	MITCHELL	1	28	N	5	E
09/30/2019	RIVIERA OPERATING LLC	RIVERSIDE ENERGY MICHIGAN LLC	SUGDEN A1-4	55426	ALCONA	MITCHELL	4	28	N	5	E
09/30/2019	RIVIERA OPERATING LLC	RIVERSIDE ENERGY MICHIGAN LLC	SUGDEN B2-4	55425	ALCONA	MITCHELL	4	28	N	5	E
09/30/2019	RIVIERA OPERATING LLC	RIVERSIDE ENERGY MICHIGAN LLC	SUGDEN B4-5	55424	ALCONA	MITCHELL	5	28	N	5	E
09/30/2019	RIVIERA OPERATING LLC	RIVERSIDE ENERGY MICHIGAN LLC	STATE MITCHELL B2-8	55423	ALCONA	MITCHELL	8	28	N	5	E
09/30/2019	RIVIERA OPERATING LLC	RIVERSIDE ENERGY MICHIGAN LLC	STATE MITCHELL B4-8	55402	ALCONA	MITCHELL	8	28	N	5	E
09/30/2019	RIVIERA OPERATING LLC	RIVERSIDE ENERGY MICHIGAN LLC	STOKES PROPERTIES ET AL C4-11	54966	ALCONA	CALEDONIA	11	28	N	6	E
09/30/2019	RIVIERA OPERATING LLC	RIVERSIDE ENERGY MICHIGAN LLC	VAN TUYL TRUST & GRIFITH B3-11	54695	ALCONA	CALEDONIA	11	28	N	6	E
09/30/2019	RIVIERA OPERATING LLC	RIVERSIDE ENERGY MICHIGAN LLC	STOKES PROPERTIES ET AL D2-12	54694	ALCONA	CALEDONIA	12	28	N	6	E
09/30/2019	RIVIERA OPERATING LLC	RIVERSIDE ENERGY MICHIGAN LLC	MAIN & VAN TUYL TRUST D3-11	54692	ALCONA	CALEDONIA	11	28	N	6	E
09/30/2019	RIVIERA OPERATING LLC	RIVERSIDE ENERGY MICHIGAN LLC	RADER ET AL D1-11	54535	ALCONA	CALEDONIA	11	28	N	7	E
09/30/2019	RIVIERA OPERATING LLC	RIVERSIDE ENERGY MICHIGAN LLC	PETERSON & BURG A1-17	54189	ALCONA	CALEDONIA	17	28	N	8	E
09/30/2019	RIVIERA OPERATING LLC	RIVERSIDE ENERGY MICHIGAN LLC	MENDYKA ET AL D3-1	54185	ALCONA	CALEDONIA	1	28	N	7	E
09/30/2019	RIVIERA OPERATING LLC	RIVERSIDE ENERGY MICHIGAN LLC	CALEDONIA DEVELOPMENT ET AL C4-18	54119	ALCONA	CALEDONIA	18	28	N	7	E
09/30/2019	RIVIERA OPERATING LLC	RIVERSIDE ENERGY MICHIGAN LLC	SCHULTZ ET AL B3-6	54118	ALCONA	CALEDONIA	6	28	N	7	E
09/30/2019	RIVIERA OPERATING LLC	RIVERSIDE ENERGY MICHIGAN LLC	STOKES & YES DEER A4-2	54025	ALCONA	CALEDONIA	2	28	N	6	E
09/30/2019	RIVIERA OPERATING LLC	RIVERSIDE ENERGY MICHIGAN LLC	LOST LAKE WOODS ASSOC ET AL B2-31	54013	ALCONA	ALCONA	31	28	N	8	E
09/30/2019	RIVIERA OPERATING LLC	RIVERSIDE ENERGY MICHIGAN LLC	INDIAN CREEK RANCH & HIGHLAND D2-2	53906	ALCONA	MITCHELL	2	28	N	5	E
09/30/2019	RIVIERA OPERATING LLC	RIVERSIDE ENERGY MICHIGAN LLC	STATE MITCHELL D1-10	53879	ALCONA	MITCHELL	10	28	N	5	E
09/30/2019	RIVIERA OPERATING LLC	RIVERSIDE ENERGY MICHIGAN LLC	INDIAN CREEK RANCH A4-11	53878	ALCONA	MITCHELL	11	28	N	5	E
09/30/2019	RIVIERA OPERATING LLC	RIVERSIDE ENERGY MICHIGAN LLC	STOUTENBURG ET AL A3-9	53839	ALCONA	MITCHELL	9	28	N	5	E
09/30/2019	RIVIERA OPERATING LLC	RIVERSIDE ENERGY MICHIGAN LLC	SILVANI ET AL D4-11	53688	ALCONA	CALEDONIA	11	28	N	7	E
09/30/2019	RIVIERA OPERATING LLC	RIVERSIDE ENERGY MICHIGAN LLC	PAULSON, ET AL A2-17	53598	ALCONA	CALEDONIA	17	28	N	8	E
09/30/2019	RIVIERA OPERATING LLC	RIVERSIDE ENERGY MICHIGAN LLC	SCHULTZ A2-6	53589	ALCONA	CALEDONIA	6	28	N	7	E
09/30/2019	RIVIERA OPERATING LLC	RIVERSIDE ENERGY MICHIGAN LLC	KORPUSIK ET AL C4-7	53576	ALCONA	CALEDONIA	7	28	N	8	E
09/30/2019	RIVIERA OPERATING LLC	RIVERSIDE ENERGY MICHIGAN LLC	CORNELIUS ET AL B3-30	53572	ALCONA	ALCONA	30	28	N	8	E
09/30/2019	RIVIERA OPERATING LLC	RIVERSIDE ENERGY MICHIGAN LLC	CORNELIUS ET AL D1-30	53570	ALCONA	ALCONA	30	28	N	8	E
09/30/2019	RIVIERA OPERATING LLC	RIVERSIDE ENERGY MICHIGAN LLC	CORNELIUS, ET.AL. B4-14	53559	ALCONA	CALEDONIA	14	28	N	7	E
09/30/2019	RIVIERA OPERATING LLC	RIVERSIDE ENERGY MICHIGAN LLC	LOST LAKE WOODS ASSOC. ET AL C4-32	53555	ALCONA	ALCONA	32	28	N	8	E
09/30/2019	RIVIERA OPERATING LLC	RIVERSIDE ENERGY MICHIGAN LLC	EKMAN B4-10	53553	ALCONA	CALEDONIA	10	28	N	7	E
09/30/2019	RIVIERA OPERATING LLC	RIVERSIDE ENERGY MICHIGAN LLC	CONNORS & GEE ET AL B3-10	53498	ALCONA	MITCHELL	10	28	N	5	E
09/30/2019	RIVIERA OPERATING LLC	RIVERSIDE ENERGY MICHIGAN LLC	WERTH REAL ESTATE ET AL B3-1	53199	ALCONA	CALEDONIA	1	28	N	7	E
09/30/2019	RIVIERA OPERATING LLC	RIVERSIDE ENERGY MICHIGAN LLC	STATE MITCHELL C1-3	53147	ALCONA	MITCHELL	3	28	N	5	E
09/30/2019	RIVIERA OPERATING LLC	RIVERSIDE ENERGY MICHIGAN LLC	STATE MITCHELL & BIRKBECK ET AL D2-3	53063	ALCONA	MITCHELL	3	28	N	5	E
09/30/2019	RIVIERA OPERATING LLC	RIVERSIDE ENERGY MICHIGAN LLC	INDIAN CREEK RANCH B4-2	53047	ALCONA	MITCHELL	2	28	N	5	E
09/30/2019	RIVIERA OPERATING LLC	RIVERSIDE ENERGY MICHIGAN LLC	INDIAN CREEK RANCH C2-1	53046	ALCONA	MITCHELL	1	28	N	5	E
09/30/2019	RIVIERA OPERATING LLC	RIVERSIDE ENERGY MICHIGAN LLC	NORTH MICHIGAN LAND AND OIL 5-29 SWD	33040	OTSEGO	HAYES	29	29	N	4	W
09/30/2019	RIVIERA OPERATING LLC	RIVERSIDE ENERGY MICHIGAN LLC	TOTTEFF A2-1	41527	OTSEGO	CHESTER	1	29	N	2	W
09/30/2019	RIVIERA OPERATING LLC	RIVERSIDE ENERGY MICHIGAN LLC	TOTTEFF A1-1	41547	OTSEGO	CHESTER	1	29	N	2	W
09/30/2019	RIVIERA OPERATING LLC	RIVERSIDE ENERGY MICHIGAN LLC	TOTTEFF 3-1 HD1	41872	OTSEGO	CHESTER	1	29	N	2	W
09/30/2019	RIVIERA OPERATING LLC	RIVERSIDE ENERGY MICHIGAN LLC	WERNIG 2-1 HD1	41884	OTSEGO	CHESTER	1	29	N	2	W
09/30/2019	RIVIERA OPERATING LLC	RIVERSIDE ENERGY MICHIGAN LLC	WERNIG 6-1 HD1	41938	OTSEGO	CHESTER	1	29	N	2	W
09/30/2019	RIVIERA OPERATING LLC	RIVERSIDE ENERGY MICHIGAN LLC	WERNIG 7-1 HD1	41939	OTSEGO	CHESTER	1	29	N	2	W
09/30/2019	RIVIERA OPERATING LLC	RIVERSIDE ENERGY MICHIGAN LLC	HANSON C3-36	42356	OTSEGO	CHESTER	36	30	N	2	W
09/30/2019	RIVIERA OPERATING LLC	RIVERSIDE ENERGY MICHIGAN LLC	HANSON C2-36	42357	OTSEGO	CHESTER	36	30	N	2	W
09/30/2019	RIVIERA OPERATING LLC	RIVERSIDE ENERGY MICHIGAN LLC	TOTTEFF A3-1	42734	OTSEGO	CHESTER	1	29	N	2	W
09/30/2019	RIVIERA OPERATING LLC	RIVERSIDE ENERGY MICHIGAN LLC	WERNIG D3-1	42868	OTSEGO	CHESTER	1	29	N	2	W
09/30/2019	RIVIERA OPERATING LLC	RIVERSIDE ENERGY MICHIGAN LLC	WERNIG C2-1	42870	OTSEGO	CHESTER	1	29	N	2	W
09/30/2019	RIVIERA OPERATING LLC	RIVERSIDE ENERGY MICHIGAN LLC	TOTTEFF B2-1	43024	OTSEGO	CHESTER	1	29	N	2	W
09/30/2019	RIVIERA OPERATING LLC	RIVERSIDE ENERGY MICHIGAN LLC	TOTTEFF B1-1	43025	OTSEGO	CHESTER	1	29	N	2	W
09/30/2019	RIVIERA OPERATING LLC	RIVERSIDE ENERGY MICHIGAN LLC	WESLEY, ET AL A3-11	44121	OTSEGO	CHESTER	11	29	N	2	W
09/30/2019	RIVIERA OPERATING LLC	RIVERSIDE ENERGY MICHIGAN LLC	KARR, ET AL D3-2	44123	OTSEGO	CHESTER	2	29	N	2	W
09/30/2019	RIVIERA OPERATING LLC	RIVERSIDE ENERGY MICHIGAN LLC	GELOW A1-12	44132	OTSEGO	CHESTER	12	29	N	2	W
09/30/2019	RIVIERA OPERATING LLC	RIVERSIDE ENERGY MICHIGAN LLC	TOTTEFF B1-1	43025	OTSEGO	CHESTER	1	29	N	2	W

Transfer Date	Previous Operator	New Operator	WellName	Permit	County	Township	Sec	Twp	TwpDir	Rng	RngDir
09/30/2019	RIVIERA OPERATING LLC	RIVERSIDE ENERGY MICHIGAN LLC	HANSON C2-36	42357	OTSEGO	CHESTER	36	30	N	2	W
09/30/2019	RIVIERA OPERATING LLC	RIVERSIDE ENERGY MICHIGAN LLC	WERNIG 7-1 HD1	41939	OTSEGO	CHESTER	1	29	N	2	W
09/30/2019	RIVIERA OPERATING LLC	RIVERSIDE ENERGY MICHIGAN LLC	TOTEFF A2-1	41527	OTSEGO	CHESTER	1	29	N	2	W
09/30/2019	RIVIERA OPERATING LLC	RIVERSIDE ENERGY MICHIGAN LLC	CAROLIN 1-2A	41412	OTSEGO	CHESTER	2	29	N	2	W
09/30/2019	RIVIERA OPERATING LLC	RIVERSIDE ENERGY MICHIGAN LLC	CAROLIN 1-2A	41412	OTSEGO	CHESTER	2	29	N	2	W
09/30/2019	RIVIERA OPERATING LLC	RIVERSIDE ENERGY MICHIGAN LLC	CHICOREL 1-17	34002	OAKLAND	LYON	17	1	N	7	E
09/30/2019	RIVIERA OPERATING LLC	RIVERSIDE ENERGY MICHIGAN LLC	FELBER 1-8	33713	OAKLAND	LYON	8	1	N	7	E
09/30/2019	RIVIERA OPERATING LLC	RIVERSIDE ENERGY MICHIGAN LLC	TOTEFF A4-1A	47078	OTSEGO	CHESTER	1	29	N	2	W
09/30/2019	RIVIERA OPERATING LLC	RIVERSIDE ENERGY MICHIGAN LLC	WERNIG D4-1A	47081	OTSEGO	CHESTER	1	29	N	2	W
09/30/2019	RIVIERA OPERATING LLC	RIVERSIDE ENERGY MICHIGAN LLC	STATE OTSEGO LAKE (HEART LAKE) D4-29	48291	OTSEGO	OTSEGO LAKE	29	29	N	3	W
09/30/2019	RIVIERA OPERATING LLC	RIVERSIDE ENERGY MICHIGAN LLC	STATE OTSEGO LAKE (HEART LAKE) B4-29	48381	OTSEGO	OTSEGO LAKE	29	29	N	3	W
09/30/2019	RIVIERA OPERATING LLC	RIVERSIDE ENERGY MICHIGAN LLC	HEART LAKE B3-29	48383	OTSEGO	OTSEGO LAKE	29	29	N	3	W
09/30/2019	RIVIERA OPERATING LLC	RIVERSIDE ENERGY MICHIGAN LLC	WERNIG TWIN C4-1	59656	OTSEGO	CHESTER	1	29	N	2	W
09/30/2019	RIVIERA OPERATING LLC	RIVERSIDE ENERGY MICHIGAN LLC	GELOW B1-12R	59927	OTSEGO	CHESTER	12	29	N	2	W
09/30/2019	RIVIERA OPERATING LLC	RIVERSIDE ENERGY MICHIGAN LLC	OAKLAND HUNT CLUB D2-5	48497	ALCONA	MITCHELL	5	28	N	5	E
09/30/2019	RIVIERA OPERATING LLC	RIVERSIDE ENERGY MICHIGAN LLC	GAISHIN A3-20	48852	ALCONA	HAWES	20	27	N	8	E
09/30/2019	RIVIERA OPERATING LLC	RIVERSIDE ENERGY MICHIGAN LLC	WOIDKA A2-17	49211	ALCONA	CALEDONIA	17	28	N	7	E
09/30/2019	RIVIERA OPERATING LLC	RIVERSIDE ENERGY MICHIGAN LLC	LOST LAKE WOODS CLUB A2-26	49212	ALCONA	ALCONA	26	28	N	8	E
09/30/2019	RIVIERA OPERATING LLC	RIVERSIDE ENERGY MICHIGAN LLC	WILL D4-18	49259	ALCONA	CALEDONIA	18	28	N	8	E
09/30/2019	RIVIERA OPERATING LLC	RIVERSIDE ENERGY MICHIGAN LLC	MACDONALD B1-2	49667	ALCONA	CALEDONIA	2	28	N	7	E
09/30/2019	RIVIERA OPERATING LLC	RIVERSIDE ENERGY MICHIGAN LLC	ELLER A3-3	49670	ALCONA	CALEDONIA	3	28	N	7	E
09/30/2019	RIVIERA OPERATING LLC	RIVERSIDE ENERGY MICHIGAN LLC	VICKSTROM D1-1	49745	ALCONA	CALEDONIA	1	28	N	7	E
09/30/2019	RIVIERA OPERATING LLC	RIVERSIDE ENERGY MICHIGAN LLC	BECK A4-7	49748	ALCONA	CALEDONIA	7	28	N	8	E
09/30/2019	RIVIERA OPERATING LLC	RIVERSIDE ENERGY MICHIGAN LLC	RASMUSSEN D2-7	49749	ALCONA	CALEDONIA	7	28	N	8	E
09/30/2019	RIVIERA OPERATING LLC	RIVERSIDE ENERGY MICHIGAN LLC	WATZ RADIO INC A1-1	49753	ALCONA	CALEDONIA	1	28	N	7	E
09/30/2019	RIVIERA OPERATING LLC	RIVERSIDE ENERGY MICHIGAN LLC	SPISAK A4-1	49754	ALCONA	CALEDONIA	1	28	N	7	E
09/30/2019	RIVIERA OPERATING LLC	RIVERSIDE ENERGY MICHIGAN LLC	MACKENNON B2-7	49755	ALCONA	CALEDONIA	7	28	N	8	E
09/30/2019	RIVIERA OPERATING LLC	RIVERSIDE ENERGY MICHIGAN LLC	KLAVER & FELZKE C4-1	49758	ALCONA	CALEDONIA	1	28	N	7	E
09/30/2019	RIVIERA OPERATING LLC	RIVERSIDE ENERGY MICHIGAN LLC	KLEVE C4-2	49759	ALCONA	CALEDONIA	2	28	N	7	E
09/30/2019	RIVIERA OPERATING LLC	RIVERSIDE ENERGY MICHIGAN LLC	EBY A3-2	49760	ALCONA	CALEDONIA	2	28	N	7	E
09/30/2019	RIVIERA OPERATING LLC	RIVERSIDE ENERGY MICHIGAN LLC	DAMIANI A1-19	49887	ALCONA	ALCONA	19	28	N	8	E
09/30/2019	RIVIERA OPERATING LLC	RIVERSIDE ENERGY MICHIGAN LLC	LAFELDT C1-9	49897	ALCONA	CALEDONIA	9	28	N	8	E
09/30/2019	RIVIERA OPERATING LLC	RIVERSIDE ENERGY MICHIGAN LLC	STATE CALEDONIA B1-8	51499	ALCONA	CALEDONIA	8	28	N	7	E
09/30/2019	RIVIERA OPERATING LLC	RIVERSIDE ENERGY MICHIGAN LLC	COSTER & YOUNG C1-6	51501	ALCONA	MITCHELL	6	28	N	5	E
09/30/2019	RIVIERA OPERATING LLC	RIVERSIDE ENERGY MICHIGAN LLC	CALEDONIA DEVELOPMENT CORP D1-17	51502	ALCONA	CALEDONIA	17	28	N	7	E
09/30/2019	RIVIERA OPERATING LLC	RIVERSIDE ENERGY MICHIGAN LLC	DRY HOLE CLUB D1-6	51526	ALCONA	CALEDONIA	6	28	N	7	E
09/30/2019	RIVIERA OPERATING LLC	RIVERSIDE ENERGY MICHIGAN LLC	STOKES PROPERTIES & YES DEER CLUB C3-1	51527	ALCONA	CALEDONIA	1	28	N	6	E
09/30/2019	RIVIERA OPERATING LLC	RIVERSIDE ENERGY MICHIGAN LLC	WOIDKA TRUST B1-17	51528	ALCONA	CALEDONIA	17	28	N	7	E
09/30/2019	RIVIERA OPERATING LLC	RIVERSIDE ENERGY MICHIGAN LLC	DEGEN & MCCOY C2-8	51529	ALCONA	CALEDONIA	8	28	N	7	E
09/30/2019	RIVIERA OPERATING LLC	RIVERSIDE ENERGY MICHIGAN LLC	WOIDKA TRUST B3-17	51530	ALCONA	CALEDONIA	17	28	N	7	E
09/30/2019	RIVIERA OPERATING LLC	RIVERSIDE ENERGY MICHIGAN LLC	MATHEWSON, ET AL B2-5	51542	ALCONA	CALEDONIA	5	28	N	7	E
09/30/2019	RIVIERA OPERATING LLC	RIVERSIDE ENERGY MICHIGAN LLC	STOKES PROPERTIES & KLEIN A3-12	51543	ALCONA	CALEDONIA	12	28	N	6	E
09/30/2019	RIVIERA OPERATING LLC	RIVERSIDE ENERGY MICHIGAN LLC	MCCOY & WEINKAUF D3-8	51545	ALCONA	CALEDONIA	8	28	N	7	E
09/30/2019	RIVIERA OPERATING LLC	RIVERSIDE ENERGY MICHIGAN LLC	GEE D4-3	51583	ALCONA	MITCHELL	3	28	N	5	E
09/30/2019	RIVIERA OPERATING LLC	RIVERSIDE ENERGY MICHIGAN LLC	CALEDONIA DEVELOPMENT CORP. C2-18	51584	ALCONA	CALEDONIA	18	28	N	7	E
09/30/2019	RIVIERA OPERATING LLC	RIVERSIDE ENERGY MICHIGAN LLC	NOKLAND & KLEIN D4-12	51585	ALCONA	CALEDONIA	12	28	N	6	E
09/30/2019	RIVIERA OPERATING LLC	RIVERSIDE ENERGY MICHIGAN LLC	REYNOLDS & FAULKNER C4-19	51586	ALCONA	ALCONA	19	28	N	7	E
09/30/2019	RIVIERA OPERATING LLC	RIVERSIDE ENERGY MICHIGAN LLC	LUMAN, ET AL D2-1	51587	ALCONA	CALEDONIA	1	28	N	6	E
09/30/2019	RIVIERA OPERATING LLC	RIVERSIDE ENERGY MICHIGAN LLC	STATE CALEDONIA C3-3	51600	ALCONA	CALEDONIA	3	28	N	7	E
09/30/2019	RIVIERA OPERATING LLC	RIVERSIDE ENERGY MICHIGAN LLC	SCHULTZ ET AL B2-6	51609	ALCONA	CALEDONIA	6	28	N	7	E
09/30/2019	RIVIERA OPERATING LLC	RIVERSIDE ENERGY MICHIGAN LLC	CALEDONIA DEVELOPMENT CORP. D3-18	51610	ALCONA	CALEDONIA	18	28	N	7	E
09/30/2019	RIVIERA OPERATING LLC	RIVERSIDE ENERGY MICHIGAN LLC	STOKES PROPERTIES A4-1	51611	ALCONA	CALEDONIA	1	28	N	6	E
09/30/2019	RIVIERA OPERATING LLC	RIVERSIDE ENERGY MICHIGAN LLC	STOKES PROPERTIES B1-1	51612	ALCONA	CALEDONIA	1	28	N	6	E
09/30/2019	RIVIERA OPERATING LLC	RIVERSIDE ENERGY MICHIGAN LLC	WOIDKA TRUST A3-18	51615	ALCONA	CALEDONIA	18	28	N	7	E
09/30/2019	RIVIERA OPERATING LLC	RIVERSIDE ENERGY MICHIGAN LLC	WOIDKA TRUST A1-18	51616	ALCONA	CALEDONIA	18	28	N	7	E
09/30/2019	RIVIERA OPERATING LLC	RIVERSIDE ENERGY MICHIGAN LLC	STATE CALEDONIA & NOKLAND TRUST D2-7	51621	ALCONA	CALEDONIA	7	28	N	7	E
09/30/2019	RIVIERA OPERATING LLC	RIVERSIDE ENERGY MICHIGAN LLC	STATE CALEDONIA & L.L.W.A. D4-15	51744	ALCONA	CALEDONIA	15	28	N	8	E
09/30/2019	RIVIERA OPERATING LLC	RIVERSIDE ENERGY MICHIGAN LLC	LOST LAKE WOODS ASSOCIATION C2-15	51745	ALCONA	CALEDONIA	15	28	N	8	E
09/30/2019	RIVIERA OPERATING LLC	RIVERSIDE ENERGY MICHIGAN LLC	STATE CALEDONIA C4-7	51767	ALCONA	CALEDONIA	7	28	N	7	E
09/30/2019	RIVIERA OPERATING LLC	RIVERSIDE ENERGY MICHIGAN LLC	LOST LAKE WOODS ASSOCIATION C4-16	51787	ALCONA	CALEDONIA	16	28	N	8	E
09/30/2019	RIVIERA OPERATING LLC	RIVERSIDE ENERGY MICHIGAN LLC	LOST LAKE WOODS ASSOCIATION D3-16	51788	ALCONA	CALEDONIA	16	28	N	8	E
09/30/2019	RIVIERA OPERATING LLC	RIVERSIDE ENERGY MICHIGAN LLC	LOST LAKE WOODS ASSOC. ET AL B4-21	51790	ALCONA	ALCONA	21	28	N	8	E
09/30/2019	RIVIERA OPERATING LLC	RIVERSIDE ENERGY MICHIGAN LLC	LOST LAKE WOODS ASSOC. ET AL C1-27	51810	ALCONA	ALCONA	27	28	N	8	E
09/30/2019	RIVIERA OPERATING LLC	RIVERSIDE ENERGY MICHIGAN LLC	LOST LAKE WOODS ASSOC. ET AL D3-28	51811	ALCONA	ALCONA	28	28	N	8	E

Transfer Date	Previous Operator	New Operator	WellName	Permit	County	Township	Sec	Twp	TwpDir	Rng	RngDir
09/30/2019	RIVIERA OPERATING LLC	RIVERSIDE ENERGY MICHIGAN LLC	LOST LAKE WOODS ASSOC. ET AL A4-31	51812	ALCONA	ALCONA	31	28	N	8	E
09/30/2019	RIVIERA OPERATING LLC	RIVERSIDE ENERGY MICHIGAN LLC	LOST LAKE WOODS ASSOC. ET AL A2-32	51813	ALCONA	ALCONA	32	28	N	8	E
09/30/2019	RIVIERA OPERATING LLC	RIVERSIDE ENERGY MICHIGAN LLC	LOST LAKE WOODS ASSOC. ET AL A4-32	51814	ALCONA	ALCONA	32	28	N	8	E
09/30/2019	RIVIERA OPERATING LLC	RIVERSIDE ENERGY MICHIGAN LLC	LOST LAKE WOODS ASSOC. ET AL B2-21	51815	ALCONA	ALCONA	21	28	N	8	E
09/30/2019	RIVIERA OPERATING LLC	RIVERSIDE ENERGY MICHIGAN LLC	LOST LAKE WOODS ASSOC. ET AL D3-32	51817	ALCONA	ALCONA	32	28	N	8	E
09/30/2019	RIVIERA OPERATING LLC	RIVERSIDE ENERGY MICHIGAN LLC	LOST LAKE WOODS ASSOC. ET AL B2-32	51818	ALCONA	ALCONA	32	28	N	8	E
09/30/2019	RIVIERA OPERATING LLC	RIVERSIDE ENERGY MICHIGAN LLC	BUTLER C4-20	51849	ALCONA	ALCONA	20	28	N	7	E
09/30/2019	RIVIERA OPERATING LLC	RIVERSIDE ENERGY MICHIGAN LLC	LOST LAKE WOODS ASSOC. ET AL A1-22	52132	ALCONA	ALCONA	22	28	N	8	E
09/30/2019	RIVIERA OPERATING LLC	RIVERSIDE ENERGY MICHIGAN LLC	REYNOLDS & CALEDONIA DEV. CORP. A3-19	52183	ALCONA	ALCONA	19	28	N	7	E
09/30/2019	RIVIERA OPERATING LLC	RIVERSIDE ENERGY MICHIGAN LLC	LONG B2-20	52357	ALCONA	ALCONA	20	28	N	7	E
09/30/2019	RIVIERA OPERATING LLC	RIVERSIDE ENERGY MICHIGAN LLC	LOST LAKE WOODS ASSOC. ET AL C3-27	52457	ALCONA	ALCONA	27	28	N	8	E
09/30/2019	RIVIERA OPERATING LLC	RIVERSIDE ENERGY MICHIGAN LLC	LOST LAKE WOODS ASSOC. ET AL A4-27	52460	ALCONA	ALCONA	27	28	N	8	E
09/30/2019	RIVIERA OPERATING LLC	RIVERSIDE ENERGY MICHIGAN LLC	SANFORD & SHARBONEAU ET AL A2-2	53010	ALCONA	MITCHELL	2	28	N	5	E
09/30/2019	RIVIERA OPERATING LLC	RIVERSIDE ENERGY MICHIGAN LLC	MILLER C2-2	53011	ALCONA	MITCHELL	2	28	N	5	E
09/30/2019	RIVIERA OPERATING LLC	RIVERSIDE ENERGY MICHIGAN LLC	INDIAN CREEK RANCH ET AL A2-1	53045	ALCONA	MITCHELL	1	28	N	5	E
09/30/2019	RIVIERA OPERATING LLC	RIVERSIDE ENERGY MICHIGAN LLC	INDIAN CREEK RANCH C2-1	53046	ALCONA	MITCHELL	1	28	N	5	E
09/30/2019	RIVIERA OPERATING LLC	RIVERSIDE ENERGY MICHIGAN LLC	INDIAN CREEK RANCH B4-2	53047	ALCONA	MITCHELL	2	28	N	5	E
09/30/2019	RIVIERA OPERATING LLC	RIVERSIDE ENERGY MICHIGAN LLC	STATE MITCHELL & BIRKBECK ET AL D2-3	53063	ALCONA	MITCHELL	3	28	N	5	E
09/30/2019	RIVIERA OPERATING LLC	RIVERSIDE ENERGY MICHIGAN LLC	STATE MITCHELL C1-3	53147	ALCONA	MITCHELL	3	28	N	5	E
09/30/2019	RIVIERA OPERATING LLC	RIVERSIDE ENERGY MICHIGAN LLC	WERTH REAL ESTATE ET AL B3-1	53199	ALCONA	CALEDONIA	1	28	N	7	E
09/30/2019	RIVIERA OPERATING LLC	RIVERSIDE ENERGY MICHIGAN LLC	RUDE & JESS ET AL A2-6	53200	ALCONA	CALEDONIA	6	28	N	8	E
09/30/2019	RIVIERA OPERATING LLC	RIVERSIDE ENERGY MICHIGAN LLC	CONNORS & GEE ET AL B3-10	53498	ALCONA	MITCHELL	10	28	N	5	E
09/30/2019	RIVIERA OPERATING LLC	RIVERSIDE ENERGY MICHIGAN LLC	EKMAN B4-10	53553	ALCONA	CALEDONIA	10	28	N	7	E
09/30/2019	RIVIERA OPERATING LLC	RIVERSIDE ENERGY MICHIGAN LLC	LOST LAKE WOODS ASSOC. ET AL C4-32	53555	ALCONA	ALCONA	32	28	N	8	E
09/30/2019	RIVIERA OPERATING LLC	RIVERSIDE ENERGY MICHIGAN LLC	CORNELIUS, ET.AL. B4-14	53559	ALCONA	CALEDONIA	14	28	N	7	E
09/30/2019	RIVIERA OPERATING LLC	RIVERSIDE ENERGY MICHIGAN LLC	CORNELIUS ET AL D1-30	53570	ALCONA	ALCONA	30	28	N	8	E
09/30/2019	RIVIERA OPERATING LLC	RIVERSIDE ENERGY MICHIGAN LLC	CORNELIUS ET AL B3-30	53572	ALCONA	ALCONA	30	28	N	8	E
09/30/2019	RIVIERA OPERATING LLC	RIVERSIDE ENERGY MICHIGAN LLC	KORPUSIK ET AL C4-7	53576	ALCONA	CALEDONIA	7	28	N	8	E
09/30/2019	RIVIERA OPERATING LLC	RIVERSIDE ENERGY MICHIGAN LLC	SCHULTZ A2-6	53589	ALCONA	CALEDONIA	6	28	N	7	E
09/30/2019	RIVIERA OPERATING LLC	RIVERSIDE ENERGY MICHIGAN LLC	PAULSON, ET AL A2-17	53598	ALCONA	CALEDONIA	17	28	N	8	E
09/30/2019	RIVIERA OPERATING LLC	RIVERSIDE ENERGY MICHIGAN LLC	SILVANI ET AL D4-11	53688	ALCONA	CALEDONIA	11	28	N	7	E
09/30/2019	RIVIERA OPERATING LLC	RIVERSIDE ENERGY MICHIGAN LLC	STOUTENBURG ET AL A3-9	53839	ALCONA	MITCHELL	9	28	N	5	E
09/30/2019	RIVIERA OPERATING LLC	RIVERSIDE ENERGY MICHIGAN LLC	STATE MITCHELL & CONNERS D3-10	53840	ALCONA	MITCHELL	10	28	N	5	E
09/30/2019	RIVIERA OPERATING LLC	RIVERSIDE ENERGY MICHIGAN LLC	INDIAN CREEK RANCH A4-11	53878	ALCONA	MITCHELL	11	28	N	5	E
09/30/2019	RIVIERA OPERATING LLC	RIVERSIDE ENERGY MICHIGAN LLC	STATE MITCHELL D1-10	53879	ALCONA	MITCHELL	10	28	N	5	E
09/30/2019	RIVIERA OPERATING LLC	RIVERSIDE ENERGY MICHIGAN LLC	INDIAN CREEK RANCH & HIGHLAND D2-2	53906	ALCONA	MITCHELL	2	28	N	5	E
09/30/2019	RIVIERA OPERATING LLC	RIVERSIDE ENERGY MICHIGAN LLC	LOST LAKE WOODS ASSOC ET AL B2-31	54013	ALCONA	ALCONA	31	28	N	8	E
09/30/2019	RIVIERA OPERATING LLC	RIVERSIDE ENERGY MICHIGAN LLC	STOKES & YES DEER A4-2	54025	ALCONA	CALEDONIA	2	28	N	6	E
09/30/2019	RIVIERA OPERATING LLC	RIVERSIDE ENERGY MICHIGAN LLC	SCHULTZ ET AL B3-6	54118	ALCONA	CALEDONIA	6	28	N	7	E
09/30/2019	RIVIERA OPERATING LLC	RIVERSIDE ENERGY MICHIGAN LLC	SCHULTZ ET AL B3-6	54118	ALCONA	CALEDONIA	6	28	N	7	E
09/30/2019	RIVIERA OPERATING LLC	RIVERSIDE ENERGY MICHIGAN LLC	SCHULTZ ET AL B3-6	54118	ALCONA	CALEDONIA	6	28	N	7	E
09/30/2019	RIVIERA OPERATING LLC	RIVERSIDE ENERGY MICHIGAN LLC	CALEDONIA DEVELOPMENT ET AL C4-18	54119	ALCONA	CALEDONIA	18	28	N	7	E
09/30/2019	RIVIERA OPERATING LLC	RIVERSIDE ENERGY MICHIGAN LLC	MENDYKA ET AL D3-1	54185	ALCONA	CALEDONIA	1	28	N	7	E
09/30/2019	RIVIERA OPERATING LLC	RIVERSIDE ENERGY MICHIGAN LLC	PETERSON & BURG A1-17	54189	ALCONA	CALEDONIA	17	28	N	8	E
09/30/2019	RIVIERA OPERATING LLC	RIVERSIDE ENERGY MICHIGAN LLC	RADER ET AL D1-11	54535	ALCONA	CALEDONIA	11	28	N	7	E
09/30/2019	RIVIERA OPERATING LLC	RIVERSIDE ENERGY MICHIGAN LLC	MAIN & VAN TUYL TRUST D3-11	54692	ALCONA	CALEDONIA	11	28	N	6	E
10/01/2019	RIVIERA OPERATING LLC	RIVERSIDE ENERGY MICHIGAN LLC	STATE MANCELONA I B3-8	46474	ANTRIM	MANCELONA	8	29	N	5	W
10/01/2019	RIVIERA OPERATING LLC	RIVERSIDE ENERGY MICHIGAN LLC	MANCELONA I D1-17	47003	ANTRIM	MANCELONA	17	29	N	5	W
10/01/2019	RIVIERA OPERATING LLC	RIVERSIDE ENERGY MICHIGAN LLC	STATE MANCELONA I A3-7	47013	ANTRIM	MANCELONA	7	29	N	5	W
10/01/2019	RIVIERA OPERATING LLC	RIVERSIDE ENERGY MICHIGAN LLC	STATE MANCELONA I B1-7	47014	ANTRIM	MANCELONA	7	29	N	5	W
10/01/2019	RIVIERA OPERATING LLC	RIVERSIDE ENERGY MICHIGAN LLC	STATE MANCELONA I C3-7	47016	ANTRIM	MANCELONA	7	29	N	5	W
10/01/2019	RIVIERA OPERATING LLC	RIVERSIDE ENERGY MICHIGAN LLC	STATE MANCELONA I B1-16	47060	ANTRIM	MANCELONA	16	29	N	5	W
10/01/2019	RIVIERA OPERATING LLC	RIVERSIDE ENERGY MICHIGAN LLC	STATE MANCELONA I D1-16	47061	ANTRIM	MANCELONA	16	29	N	5	W
10/01/2019	RIVIERA OPERATING LLC	RIVERSIDE ENERGY MICHIGAN LLC	STATE MANCELONA I D2-17	47062	ANTRIM	MANCELONA	17	29	N	5	W
10/01/2019	RIVIERA OPERATING LLC	RIVERSIDE ENERGY MICHIGAN LLC	STATE MANCELONA I D4-17	47063	ANTRIM	MANCELONA	17	29	N	5	W
10/01/2019	RIVIERA OPERATING LLC	RIVERSIDE ENERGY MICHIGAN LLC	LAKES OF THE NORTH D1-14	47136	ANTRIM	MANCELONA	14	29	N	5	W
10/01/2019	RIVIERA OPERATING LLC	RIVERSIDE ENERGY MICHIGAN LLC	STATE MANCELONA I A3-16	47190	ANTRIM	MANCELONA	16	29	N	5	W
10/01/2019	RIVIERA OPERATING LLC	RIVERSIDE ENERGY MICHIGAN LLC	MANCELONA I D1-5	47191	ANTRIM	MANCELONA	5	29	N	5	W
10/01/2019	RIVIERA OPERATING LLC	RIVERSIDE ENERGY MICHIGAN LLC	MANCELONA I C4-5	47193	ANTRIM	MANCELONA	5	29	N	5	W
10/01/2019	RIVIERA OPERATING LLC	RIVERSIDE ENERGY MICHIGAN LLC	MANCELONA I B3-5	47195	ANTRIM	MANCELONA	5	29	N	5	W
10/01/2019	RIVIERA OPERATING LLC	RIVERSIDE ENERGY MICHIGAN LLC	MANCELONA I D2-18	47272	ANTRIM	MANCELONA	18	29	N	5	W
10/01/2019	RIVIERA OPERATING LLC	RIVERSIDE ENERGY MICHIGAN LLC	STATE MANCELONA I C3-6	47288	ANTRIM	MANCELONA	6	29	N	5	W
10/01/2019	RIVIERA OPERATING LLC	RIVERSIDE ENERGY MICHIGAN LLC	STATE MANCELONA I D1-6	47299	ANTRIM	MANCELONA	6	29	N	5	W
10/01/2019	RIVIERA OPERATING LLC	RIVERSIDE ENERGY MICHIGAN LLC	STATE MANCELONA I B4-6	47300	ANTRIM	MANCELONA	6	29	N	5	W

Transfer Date	Previous Operator	New Operator	WellName	Permit	County	Township	Sec	Twp	TwpDir	Rng	RngDir
10/01/2019	RIVIERA OPERATING LLC	RIVERSIDE ENERGY MICHIGAN LLC	STATE MANCELONA I B2-6	47301	ANTRIM	MANCELONA	6	29	N	5	W
10/01/2019	RIVIERA OPERATING LLC	RIVERSIDE ENERGY MICHIGAN LLC	STATE MANCELONA I A3-6	47302	ANTRIM	MANCELONA	6	29	N	5	W
10/01/2019	RIVIERA OPERATING LLC	RIVERSIDE ENERGY MICHIGAN LLC	MANCELONA I B2-18	47336	ANTRIM	MANCELONA	18	29	N	5	W
10/01/2019	RIVIERA OPERATING LLC	RIVERSIDE ENERGY MICHIGAN LLC	LAKES OF THE NORTH D3-9	47369	ANTRIM	MANCELONA	9	29	N	5	W
10/01/2019	RIVIERA OPERATING LLC	RIVERSIDE ENERGY MICHIGAN LLC	STATE MANCELONA I B1-6	47390	ANTRIM	MANCELONA	6	29	N	5	W
10/01/2019	RIVIERA OPERATING LLC	RIVERSIDE ENERGY MICHIGAN LLC	STATE MANCELONA (BIJOU) C3-1	48516	ANTRIM	MANCELONA	1	29	N	6	W
10/01/2019	RIVIERA OPERATING LLC	RIVERSIDE ENERGY MICHIGAN LLC	STATE MANCELONA (BIJOU) D1-1	48517	ANTRIM	MANCELONA	1	29	N	6	W
10/01/2019	RIVIERA OPERATING LLC	RIVERSIDE ENERGY MICHIGAN LLC	STATE MANCELONA (BIJOU) B1-12	48518	ANTRIM	MANCELONA	12	29	N	6	W
10/01/2019	RIVIERA OPERATING LLC	RIVERSIDE ENERGY MICHIGAN LLC	STATE MANCELONA (BIJOU) B3-11	48535	ANTRIM	MANCELONA	11	29	N	6	W
10/01/2019	RIVIERA OPERATING LLC	RIVERSIDE ENERGY MICHIGAN LLC	STATE MANCELONA (BIJOU) A3-12	48536	ANTRIM	MANCELONA	12	29	N	6	W
10/01/2019	RIVIERA OPERATING LLC	RIVERSIDE ENERGY MICHIGAN LLC	STATE MANCELONA (BIJOU) A3-1	48571	ANTRIM	MANCELONA	1	29	N	6	W
10/01/2019	RIVIERA OPERATING LLC	RIVERSIDE ENERGY MICHIGAN LLC	BIJOU B2-1	48572	ANTRIM	MANCELONA	1	29	N	6	W
10/01/2019	RIVIERA OPERATING LLC	RIVERSIDE ENERGY MICHIGAN LLC	BIJOU B1-14	48574	ANTRIM	MANCELONA	14	29	N	6	W
10/01/2019	RIVIERA OPERATING LLC	RIVERSIDE ENERGY MICHIGAN LLC	BIJOU C3-15	48577	ANTRIM	MANCELONA	15	29	N	6	W
10/01/2019	RIVIERA OPERATING LLC	RIVERSIDE ENERGY MICHIGAN LLC	BIJOU B4-15	48578	ANTRIM	MANCELONA	15	29	N	6	W
10/01/2019	RIVIERA OPERATING LLC	RIVERSIDE ENERGY MICHIGAN LLC	STATE MANCELONA (BIJOU) B2-12	48581	ANTRIM	MANCELONA	12	29	N	6	W
10/01/2019	RIVIERA OPERATING LLC	RIVERSIDE ENERGY MICHIGAN LLC	STATE MANCELONA (BIJOU) A2-11	48638	ANTRIM	MANCELONA	11	29	N	6	W
10/01/2019	RIVIERA OPERATING LLC	RIVERSIDE ENERGY MICHIGAN LLC	STATE MANCELONA (BIJOU) D1-13	48654	ANTRIM	MANCELONA	13	29	N	6	W
10/01/2019	RIVIERA OPERATING LLC	RIVERSIDE ENERGY MICHIGAN LLC	LAKES OF THE NORTH C4-9	49398	ANTRIM	MANCELONA	9	29	N	5	W
10/01/2019	RIVIERA OPERATING LLC	RIVERSIDE ENERGY MICHIGAN LLC	LAKES OF THE NORTH D4-9	49399	ANTRIM	MANCELONA	9	29	N	5	W
10/01/2019	RIVIERA OPERATING LLC	RIVERSIDE ENERGY MICHIGAN LLC	MANCELONA I A1-5	49454	ANTRIM	MANCELONA	5	29	N	5	W
10/01/2019	RIVIERA OPERATING LLC	RIVERSIDE ENERGY MICHIGAN LLC	STATE MANCELONA B2-16	49713	ANTRIM	MANCELONA	16	29	N	5	W
10/01/2019	RIVIERA OPERATING LLC	RIVERSIDE ENERGY MICHIGAN LLC	STATE MANCELONA D2-6	49714	ANTRIM	MANCELONA	6	29	N	5	W
10/01/2019	RIVIERA OPERATING LLC	RIVERSIDE ENERGY MICHIGAN LLC	STATE MANCELONA B2-7	49715	ANTRIM	MANCELONA	7	29	N	5	W
10/01/2019	RIVIERA OPERATING LLC	RIVERSIDE ENERGY MICHIGAN LLC	BIJOU C4-14	50231	ANTRIM	MANCELONA	14	29	N	6	W
10/01/2019	RIVIERA OPERATING LLC	RIVERSIDE ENERGY MICHIGAN LLC	STATE MANCELONA B4-12	57024	ANTRIM	MANCELONA	12	29	N	6	W
10/01/2019	RIVIERA OPERATING LLC	RIVERSIDE ENERGY MICHIGAN LLC	STATE MANCELONA C1-1	57025	ANTRIM	MANCELONA	1	29	N	6	W
10/01/2019	RIVIERA OPERATING LLC	RIVERSIDE ENERGY MICHIGAN LLC	BIJOU EAST B4-13	57026	ANTRIM	MANCELONA	13	29	N	6	W
10/01/2019	RIVIERA OPERATING LLC	RIVERSIDE ENERGY MICHIGAN LLC	TOONS 5 A3-5	57039	ANTRIM	MANCELONA	5	29	N	5	W
10/01/2019	RIVIERA OPERATING LLC	RIVERSIDE ENERGY MICHIGAN LLC	TOONS 5 C2-5	57040	ANTRIM	MANCELONA	5	29	N	5	W
10/01/2019	RIVIERA OPERATING LLC	RIVERSIDE ENERGY MICHIGAN LLC	TOONS MANCELONA WEST B4-18	57085	ANTRIM	MANCELONA	18	29	N	5	W
10/01/2019	RIVIERA OPERATING LLC	RIVERSIDE ENERGY MICHIGAN LLC	BIJOU WEST A1-14	57091	ANTRIM	MANCELONA	14	29	N	6	W
10/01/2019	RIVIERA OPERATING LLC	RIVERSIDE ENERGY MICHIGAN LLC	BIJOU WEST D2-14	57092	ANTRIM	MANCELONA	14	29	N	6	W
10/01/2019	RIVIERA OPERATING LLC	RIVERSIDE ENERGY MICHIGAN LLC	BIJOU WEST A3-15	57093	ANTRIM	MANCELONA	15	29	N	6	W
10/01/2019	RIVIERA OPERATING LLC	RIVERSIDE ENERGY MICHIGAN LLC	BIJOU WEST D4-15	57104	ANTRIM	MANCELONA	15	29	N	6	W
10/01/2019	RIVIERA OPERATING LLC	RIVERSIDE ENERGY MICHIGAN LLC	STATE MANCELONA B4-8	57171	ANTRIM	MANCELONA	8	29	N	5	W
10/01/2019	RIVIERA OPERATING LLC	RIVERSIDE ENERGY MICHIGAN LLC	MAURER C1-36	46689	MONTMORENCY	LOUD	36	29	N	3	E
10/01/2019	RIVIERA OPERATING LLC	RIVERSIDE ENERGY MICHIGAN LLC	SOUTHWORTH A4-36	46690	MONTMORENCY	LOUD	36	29	N	3	E
10/01/2019	RIVIERA OPERATING LLC	RIVERSIDE ENERGY MICHIGAN LLC	BIXEL C1-35	46691	MONTMORENCY	LOUD	35	29	N	3	E
10/01/2019	RIVIERA OPERATING LLC	RIVERSIDE ENERGY MICHIGAN LLC	ZELK D3-34	46692	MONTMORENCY	LOUD	34	29	N	3	E
10/01/2019	RIVIERA OPERATING LLC	RIVERSIDE ENERGY MICHIGAN LLC	ERNST D1-34	46693	MONTMORENCY	LOUD	34	29	N	3	E
10/01/2019	RIVIERA OPERATING LLC	RIVERSIDE ENERGY MICHIGAN LLC	ZELK C3-34	46694	MONTMORENCY	LOUD	34	29	N	3	E
10/01/2019	RIVIERA OPERATING LLC	RIVERSIDE ENERGY MICHIGAN LLC	ZELK C3-34	46694	MONTMORENCY	LOUD	34	29	N	3	E
10/01/2019	RIVIERA OPERATING LLC	RIVERSIDE ENERGY MICHIGAN LLC	ZELK C3-34	46694	MONTMORENCY	LOUD	34	29	N	3	E
10/01/2019	RIVIERA OPERATING LLC	RIVERSIDE ENERGY MICHIGAN LLC	ZELK C3-34	46694	MONTMORENCY	LOUD	34	29	N	3	E
10/01/2019	RIVIERA OPERATING LLC	RIVERSIDE ENERGY MICHIGAN LLC	ZELK C3-34	46694	MONTMORENCY	LOUD	34	29	N	3	E
10/01/2019	RIVIERA OPERATING LLC	RIVERSIDE ENERGY MICHIGAN LLC	ZELK C3-34	46694	MONTMORENCY	LOUD	34	29	N	3	E
10/01/2019	RIVIERA OPERATING LLC	RIVERSIDE ENERGY MICHIGAN LLC	ZELK C3-34	46694	MONTMORENCY	LOUD	34	29	N	3	E
10/01/2019	RIVIERA OPERATING LLC	RIVERSIDE ENERGY MICHIGAN LLC	STATE LOUD D2-26	46702	MONTMORENCY	LOUD	26	29	N	3	E
10/01/2019	RIVIERA OPERATING LLC	RIVERSIDE ENERGY MICHIGAN LLC	STATE LOUD D4-26	46703	MONTMORENCY	LOUD	26	29	N	3	E
10/01/2019	RIVIERA OPERATING LLC	RIVERSIDE ENERGY MICHIGAN LLC	STATE LOUD B2-35	46706	MONTMORENCY	LOUD	35	29	N	3	E
10/01/2019	RIVIERA OPERATING LLC	RIVERSIDE ENERGY MICHIGAN LLC	STATE LOUD B4-35	46707	MONTMORENCY	LOUD	35	29	N	3	E
10/01/2019	RIVIERA OPERATING LLC	RIVERSIDE ENERGY MICHIGAN LLC	STATE LOUD C3-35	46708	MONTMORENCY	LOUD	35	29	N	3	E
10/01/2019	RIVIERA OPERATING LLC	RIVERSIDE ENERGY MICHIGAN LLC	STATE LOUD D4-35	46709	MONTMORENCY	LOUD	35	29	N	3	E
10/01/2019	RIVIERA OPERATING LLC	RIVERSIDE ENERGY MICHIGAN LLC	SAMP C2-12	46720	MONTMORENCY	LOUD	12	29	N	3	E
10/01/2019	RIVIERA OPERATING LLC	RIVERSIDE ENERGY MICHIGAN LLC	SOUTHWORTH B3-36	46783	MONTMORENCY	LOUD	36	29	N	3	E
10/01/2019	RIVIERA OPERATING LLC	RIVERSIDE ENERGY MICHIGAN LLC	COOLE B1-9	46784	MONTMORENCY	LOUD	9	29	N	3	E
10/01/2019	RIVIERA OPERATING LLC	RIVERSIDE ENERGY MICHIGAN LLC	STATE LOUD A4-24	46785	MONTMORENCY	LOUD	24	29	N	3	E
10/01/2019	RIVIERA OPERATING LLC	RIVERSIDE ENERGY MICHIGAN LLC	POPPLE FLATS D3-4	46786	MONTMORENCY	LOUD	4	29	N	3	E
10/01/2019	RIVIERA OPERATING LLC	RIVERSIDE ENERGY MICHIGAN LLC	STATE LOUD D4-27	46895	MONTMORENCY	LOUD	27	29	N	3	E
10/01/2019	RIVIERA OPERATING LLC	RIVERSIDE ENERGY MICHIGAN LLC	CLUB 15 C3-12	46910	MONTMORENCY	ALBERT	12	29	N	1	E
10/01/2019	RIVIERA OPERATING LLC	RIVERSIDE ENERGY MICHIGAN LLC	CLUB 15 A3-12	46911	MONTMORENCY	ALBERT	12	29	N	1	E

Transfer Date	Previous Operator	New Operator	WellName	Permit	County	Township	Sec	Twp	TwpDir	Rng	RngDir
10/01/2019	RIVIERA OPERATING LLC	RIVERSIDE ENERGY MICHIGAN LLC	SMITH B3-11	46912	MONTMORENCY	ALBERT	11	29	N	1	E
10/01/2019	RIVIERA OPERATING LLC	RIVERSIDE ENERGY MICHIGAN LLC	STATE ALBERT & NEWELL C3-3	46913	MONTMORENCY	ALBERT	3	29	N	1	E
10/01/2019	RIVIERA OPERATING LLC	RIVERSIDE ENERGY MICHIGAN LLC	ARMSTRONG C2-2	46914	MONTMORENCY	ALBERT	2	29	N	1	E
10/01/2019	RIVIERA OPERATING LLC	RIVERSIDE ENERGY MICHIGAN LLC	ERWIN D4-36	47088	MONTMORENCY	LOUD	36	29	N	3	E
10/01/2019	RIVIERA OPERATING LLC	RIVERSIDE ENERGY MICHIGAN LLC	GUTHRIE D1-1	47212	MONTMORENCY	ALBERT	1	29	N	1	E
10/01/2019	RIVIERA OPERATING LLC	RIVERSIDE ENERGY MICHIGAN LLC	STATE ALBERT A2-15	47232	MONTMORENCY	ALBERT	15	29	N	1	E
10/01/2019	RIVIERA OPERATING LLC	RIVERSIDE ENERGY MICHIGAN LLC	STATE LOUD D2-27	47254	MONTMORENCY	LOUD	27	29	N	3	E
10/01/2019	RIVIERA OPERATING LLC	RIVERSIDE ENERGY MICHIGAN LLC	STATE LOUD A2-34	47255	MONTMORENCY	LOUD	34	29	N	3	E
10/01/2019	RIVIERA OPERATING LLC	RIVERSIDE ENERGY MICHIGAN LLC	JOY ESTATE D4-13	47856	MONTMORENCY	LOUD	13	29	N	3	E
10/01/2019	RIVIERA OPERATING LLC	RIVERSIDE ENERGY MICHIGAN LLC	STATE ALBERT A2-12	48008	MONTMORENCY	ALBERT	12	29	N	2	E
10/01/2019	RIVIERA OPERATING LLC	RIVERSIDE ENERGY MICHIGAN LLC	STATE ALBERT A4-13	48078	MONTMORENCY	ALBERT	13	29	N	2	E
10/01/2019	RIVIERA OPERATING LLC	RIVERSIDE ENERGY MICHIGAN LLC	STATE ALBERT D2-12	48475	MONTMORENCY	ALBERT	12	29	N	2	E
10/01/2019	RIVIERA OPERATING LLC	RIVERSIDE ENERGY MICHIGAN LLC	ZEIDLER 1-25	40817	OTSEGO	CHARLTON	25	30	N	1	W
10/01/2019	RIVIERA OPERATING LLC	RIVERSIDE ENERGY MICHIGAN LLC	ZEIDLER B2-25	41743	OTSEGO	CHARLTON	25	30	N	1	W
10/01/2019	RIVIERA OPERATING LLC	RIVERSIDE ENERGY MICHIGAN LLC	THIES, WILLIAM, ET AL 1-2	42935	OTSEGO	CHESTER	2	30	N	2	W
10/01/2019	RIVIERA OPERATING LLC	RIVERSIDE ENERGY MICHIGAN LLC	ZECKZER, RONALD 1-12	42936	OTSEGO	CHESTER	12	30	N	2	W
10/01/2019	RIVIERA OPERATING LLC	RIVERSIDE ENERGY MICHIGAN LLC	THIES, WILLIAM, ET AL 2-2	42937	OTSEGO	CHESTER	2	30	N	2	W
10/01/2019	RIVIERA OPERATING LLC	RIVERSIDE ENERGY MICHIGAN LLC	KIDDER, HAROLD, ET AL 1-1	42941	OTSEGO	CHESTER	1	30	N	2	W
10/01/2019	RIVIERA OPERATING LLC	RIVERSIDE ENERGY MICHIGAN LLC	CLARK, HELEN B., ET AL 1-1	42942	OTSEGO	CHESTER	1	30	N	2	W
10/01/2019	RIVIERA OPERATING LLC	RIVERSIDE ENERGY MICHIGAN LLC	CONSUMERS POWER, ET AL C1-12	44130	OTSEGO	CHESTER	12	29	N	2	W
10/01/2019	RIVIERA OPERATING LLC	RIVERSIDE ENERGY MICHIGAN LLC	A.G.I. INC., ET AL D1-12	44131	OTSEGO	CHESTER	12	29	N	2	W
10/01/2019	RIVIERA OPERATING LLC	RIVERSIDE ENERGY MICHIGAN LLC	MERCURY EXPLORATION CO A2-20	44976	OTSEGO	HAYES	20	29	N	4	W
10/01/2019	RIVIERA OPERATING LLC	RIVERSIDE ENERGY MICHIGAN LLC	MERCURY EXPLORATION CO A4-21	44977	OTSEGO	HAYES	21	29	N	4	W
10/01/2019	RIVIERA OPERATING LLC	RIVERSIDE ENERGY MICHIGAN LLC	MERCURY EXPLORATION CO A2-21	44978	OTSEGO	HAYES	21	29	N	4	W
10/01/2019	RIVIERA OPERATING LLC	RIVERSIDE ENERGY MICHIGAN LLC	MERCURY EXPLORATION CO C2-21	44979	OTSEGO	HAYES	21	29	N	4	W
10/01/2019	RIVIERA OPERATING LLC	RIVERSIDE ENERGY MICHIGAN LLC	MERCURY EXPLORATION CO A2-29	44980	OTSEGO	HAYES	29	29	N	4	W
10/01/2019	RIVIERA OPERATING LLC	RIVERSIDE ENERGY MICHIGAN LLC	MERCURY EXPLORATION CO A4-29	44981	OTSEGO	HAYES	29	29	N	4	W
10/01/2019	RIVIERA OPERATING LLC	RIVERSIDE ENERGY MICHIGAN LLC	MERCURY EXPLORATION CO A4-20	44982	OTSEGO	HAYES	20	29	N	4	W
10/01/2019	RIVIERA OPERATING LLC	RIVERSIDE ENERGY MICHIGAN LLC	MERCURY EXPLORATION CO C2-20	44983	OTSEGO	HAYES	20	29	N	4	W
10/01/2019	RIVIERA OPERATING LLC	RIVERSIDE ENERGY MICHIGAN LLC	MERCURY EXPLORATION CO C4-20	44984	OTSEGO	HAYES	20	29	N	4	W
10/01/2019	RIVIERA OPERATING LLC	RIVERSIDE ENERGY MICHIGAN LLC	MERCURY EXPLORATION CO C3-21	45081	OTSEGO	HAYES	21	29	N	4	W
10/01/2019	RIVIERA OPERATING LLC	RIVERSIDE ENERGY MICHIGAN LLC	FREDERIC II D2-33	45283	OTSEGO	HAYES	33	29	N	4	W
10/01/2019	RIVIERA OPERATING LLC	RIVERSIDE ENERGY MICHIGAN LLC	FREDERIC II A1-33	45284	OTSEGO	HAYES	33	29	N	4	W
10/01/2019	RIVIERA OPERATING LLC	RIVERSIDE ENERGY MICHIGAN LLC	FREDERIC II C4-29	45286	OTSEGO	HAYES	29	29	N	4	W
10/01/2019	RIVIERA OPERATING LLC	RIVERSIDE ENERGY MICHIGAN LLC	FREDERIC II B1-28	45287	OTSEGO	HAYES	28	29	N	4	W
10/01/2019	RIVIERA OPERATING LLC	RIVERSIDE ENERGY MICHIGAN LLC	FREDERIC II A2-28	45288	OTSEGO	HAYES	28	29	N	4	W
10/01/2019	RIVIERA OPERATING LLC	RIVERSIDE ENERGY MICHIGAN LLC	FREDERIC II A4-28	45289	OTSEGO	HAYES	28	29	N	4	W
10/01/2019	RIVIERA OPERATING LLC	RIVERSIDE ENERGY MICHIGAN LLC	FREDERIC II C1-29	45290	OTSEGO	HAYES	29	29	N	4	W
10/01/2019	RIVIERA OPERATING LLC	RIVERSIDE ENERGY MICHIGAN LLC	STATE HAYES C2-32	45344	OTSEGO	HAYES	32	29	N	4	W
10/01/2019	RIVIERA OPERATING LLC	RIVERSIDE ENERGY MICHIGAN LLC	FREDERIC III B3-33	45396	OTSEGO	HAYES	33	29	N	4	W
10/01/2019	RIVIERA OPERATING LLC	RIVERSIDE ENERGY MICHIGAN LLC	FREDERIC III A4-33	45397	OTSEGO	HAYES	33	29	N	4	W
10/01/2019	RIVIERA OPERATING LLC	RIVERSIDE ENERGY MICHIGAN LLC	STATE HAYES A2-34	45403	OTSEGO	HAYES	34	29	N	4	W
10/01/2019	RIVIERA OPERATING LLC	RIVERSIDE ENERGY MICHIGAN LLC	FREDERIC III C4-34	45404	OTSEGO	HAYES	34	29	N	4	W
10/01/2019	RIVIERA OPERATING LLC	RIVERSIDE ENERGY MICHIGAN LLC	FREDERIC III A4-34	45405	OTSEGO	HAYES	34	29	N	4	W
10/01/2019	RIVIERA OPERATING LLC	RIVERSIDE ENERGY MICHIGAN LLC	FREDERIC III D1-34	45406	OTSEGO	HAYES	34	29	N	4	W
10/01/2019	RIVIERA OPERATING LLC	RIVERSIDE ENERGY MICHIGAN LLC	FREDERIC III C2-34	45408	OTSEGO	HAYES	34	29	N	4	W
10/01/2019	RIVIERA OPERATING LLC	RIVERSIDE ENERGY MICHIGAN LLC	STATE HAYES A3-35	45410	OTSEGO	HAYES	35	29	N	4	W
10/01/2019	RIVIERA OPERATING LLC	RIVERSIDE ENERGY MICHIGAN LLC	WERNIG TWIN D2-1A	58933	OTSEGO	CHESTER	1	29	N	2	W
10/01/2019	RIVIERA OPERATING LLC	RIVERSIDE ENERGY MICHIGAN LLC	STATE HAYES B1-35	45411	OTSEGO	HAYES	35	29	N	4	W
10/01/2019	RIVIERA OPERATING LLC	RIVERSIDE ENERGY MICHIGAN LLC	STATE HAYES D1-35	45412	OTSEGO	HAYES	35	29	N	4	W
10/01/2019	RIVIERA OPERATING LLC	RIVERSIDE ENERGY MICHIGAN LLC	STATE HAYES (FREDERIC III) D3-26	45634	OTSEGO	HAYES	26	29	N	4	W
10/01/2019	RIVIERA OPERATING LLC	RIVERSIDE ENERGY MICHIGAN LLC	STATE HAYES (FREDERIC III) D1-26	45635	OTSEGO	HAYES	26	29	N	4	W
10/01/2019	RIVIERA OPERATING LLC	RIVERSIDE ENERGY MICHIGAN LLC	STATE HAYES (FREDERIC III) B4-26	45636	OTSEGO	HAYES	26	29	N	4	W
10/01/2019	RIVIERA OPERATING LLC	RIVERSIDE ENERGY MICHIGAN LLC	STATE HAYES (FREDERIC III) B2-26	45637	OTSEGO	HAYES	26	29	N	4	W
10/01/2019	RIVIERA OPERATING LLC	RIVERSIDE ENERGY MICHIGAN LLC	STATE HAYES (FREDERIC III) A1-26	45638	OTSEGO	HAYES	26	29	N	4	W
10/01/2019	RIVIERA OPERATING LLC	RIVERSIDE ENERGY MICHIGAN LLC	STATE HAYES (FREDERIC III) B3-35	45639	OTSEGO	HAYES	35	29	N	4	W
10/01/2019	RIVIERA OPERATING LLC	RIVERSIDE ENERGY MICHIGAN LLC	CLARK, HELEN ET AL C1-1	45767	OTSEGO	CHESTER	1	30	N	2	W
10/01/2019	RIVIERA OPERATING LLC	RIVERSIDE ENERGY MICHIGAN LLC	KIDDER, HAROLD C2-1	45768	OTSEGO	CHESTER	1	30	N	2	W
10/01/2019	RIVIERA OPERATING LLC	RIVERSIDE ENERGY MICHIGAN LLC	ANNAMAY GODIN TRUST B3-11	45773	OTSEGO	CHESTER	11	30	N	2	W
10/01/2019	RIVIERA OPERATING LLC	RIVERSIDE ENERGY MICHIGAN LLC	GODIN TRUST C1-11	45774	OTSEGO	CHESTER	11	30	N	2	W
10/01/2019	RIVIERA OPERATING LLC	RIVERSIDE ENERGY MICHIGAN LLC	GODIN TRUST C4-11	45776	OTSEGO	CHESTER	11	30	N	2	W
10/01/2019	RIVIERA OPERATING LLC	RIVERSIDE ENERGY MICHIGAN LLC	GODIN TRUST D1-11	45777	OTSEGO	CHESTER	11	30	N	2	W
10/01/2019	RIVIERA OPERATING LLC	RIVERSIDE ENERGY MICHIGAN LLC	GODIN TRUST D3-11	45779	OTSEGO	CHESTER	11	30	N	2	W
10/01/2019	RIVIERA OPERATING LLC	RIVERSIDE ENERGY MICHIGAN LLC	KELLY A2-12	45781	OTSEGO	CHESTER	12	30	N	2	W

Transfer Date	Previous Operator	New Operator	WellName	Permit	County	Township	Sec	Twp	TwpDir	Rng	RngDir
10/01/2019	RIVIERA OPERATING LLC	RIVERSIDE ENERGY MICHIGAN LLC	KELLY B2-12	45783	OTSEGO	CHESTER	12	30	N		2 W
10/01/2019	RIVIERA OPERATING LLC	RIVERSIDE ENERGY MICHIGAN LLC	COMFORT D2-12	45786	OTSEGO	CHESTER	12	30	N		2 W
10/01/2019	RIVIERA OPERATING LLC	RIVERSIDE ENERGY MICHIGAN LLC	WOLFE TRUSTS B3-14	45791	OTSEGO	CHESTER	14	30	N		2 W
10/01/2019	RIVIERA OPERATING LLC	RIVERSIDE ENERGY MICHIGAN LLC	GUTHRIE TRUST A3-15	45792	OTSEGO	CHESTER	15	30	N		2 W
10/01/2019	RIVIERA OPERATING LLC	RIVERSIDE ENERGY MICHIGAN LLC	FREDERIC III C4-33	45820	OTSEGO	HAYES	33	29	N		4 W
10/01/2019	RIVIERA OPERATING LLC	RIVERSIDE ENERGY MICHIGAN LLC	FREDERIC III D3-34	45821	OTSEGO	HAYES	34	29	N		4 W
10/01/2019	RIVIERA OPERATING LLC	RIVERSIDE ENERGY MICHIGAN LLC	FREDERIC II D1-32	46004	OTSEGO	HAYES	32	29	N		4 W
10/01/2019	RIVIERA OPERATING LLC	RIVERSIDE ENERGY MICHIGAN LLC	FREDERIC I D3-21	46099	OTSEGO	HAYES	21	29	N		4 W
10/01/2019	RIVIERA OPERATING LLC	RIVERSIDE ENERGY MICHIGAN LLC	FREDERIC I B3-20	46245	OTSEGO	HAYES	20	29	N		4 W
10/01/2019	RIVIERA OPERATING LLC	RIVERSIDE ENERGY MICHIGAN LLC	THOMAS LAKE I D4-27	46559	OTSEGO	HAYES	27	30	N		4 W
10/01/2019	RIVIERA OPERATING LLC	RIVERSIDE ENERGY MICHIGAN LLC	THOMAS LAKE I C3-26	46561	OTSEGO	HAYES	26	30	N		4 W
10/01/2019	RIVIERA OPERATING LLC	RIVERSIDE ENERGY MICHIGAN LLC	THOMAS LAKE I A3-34	46564	OTSEGO	HAYES	34	30	N		4 W
10/01/2019	RIVIERA OPERATING LLC	RIVERSIDE ENERGY MICHIGAN LLC	STATE HAYES (FREDERIC VIII) A3-30	46605	OTSEGO	HAYES	30	29	N		4 W
10/01/2019	RIVIERA OPERATING LLC	RIVERSIDE ENERGY MICHIGAN LLC	FREDERIC VIII A4-30	46606	OTSEGO	HAYES	30	29	N		4 W
10/01/2019	RIVIERA OPERATING LLC	RIVERSIDE ENERGY MICHIGAN LLC	FREDERIC VIII A3-19	46619	OTSEGO	HAYES	19	29	N		4 W
10/01/2019	RIVIERA OPERATING LLC	RIVERSIDE ENERGY MICHIGAN LLC	FREDERIC VIII C3-19	46620	OTSEGO	HAYES	19	29	N		4 W
10/01/2019	RIVIERA OPERATING LLC	RIVERSIDE ENERGY MICHIGAN LLC	FREDERIC VIII A4-19	46636	OTSEGO	HAYES	19	29	N		4 W
10/01/2019	RIVIERA OPERATING LLC	RIVERSIDE ENERGY MICHIGAN LLC	FREDERIC VIII C4-18	46664	OTSEGO	HAYES	18	29	N		4 W
10/01/2019	RIVIERA OPERATING LLC	RIVERSIDE ENERGY MICHIGAN LLC	FREDERIC VIII B3-18	46665	OTSEGO	HAYES	18	29	N		4 W
10/01/2019	RIVIERA OPERATING LLC	RIVERSIDE ENERGY MICHIGAN LLC	FREDERIC VIII A4-18	46666	OTSEGO	HAYES	18	29	N		4 W
10/01/2019	RIVIERA OPERATING LLC	RIVERSIDE ENERGY MICHIGAN LLC	FREDERIC VIII D3-18	46667	OTSEGO	HAYES	18	29	N		4 W
10/01/2019	RIVIERA OPERATING LLC	RIVERSIDE ENERGY MICHIGAN LLC	LAKES OF THE NORTH C1-6	46680	OTSEGO	HAYES	6	29	N		4 W
10/01/2019	RIVIERA OPERATING LLC	RIVERSIDE ENERGY MICHIGAN LLC	EBLING A4-9	46958	OTSEGO	HAYES	9	30	N		4 W
10/01/2019	RIVIERA OPERATING LLC	RIVERSIDE ENERGY MICHIGAN LLC	FREDERIC I B4-21	47105	OTSEGO	HAYES	21	29	N		4 W
10/01/2019	RIVIERA OPERATING LLC	RIVERSIDE ENERGY MICHIGAN LLC	FREDERIC II D3-29	47106	OTSEGO	HAYES	29	29	N		4 W
10/01/2019	RIVIERA OPERATING LLC	RIVERSIDE ENERGY MICHIGAN LLC	THOMAS LAKE I B3-22	47334	OTSEGO	HAYES	22	30	N		4 W
10/01/2019	RIVIERA OPERATING LLC	RIVERSIDE ENERGY MICHIGAN LLC	THOMAS LAKE I B2-22	47339	OTSEGO	HAYES	22	30	N		4 W
10/01/2019	RIVIERA OPERATING LLC	RIVERSIDE ENERGY MICHIGAN LLC	THOMAS LAKE I A4-21	47343	OTSEGO	HAYES	21	30	N		4 W
10/01/2019	RIVIERA OPERATING LLC	RIVERSIDE ENERGY MICHIGAN LLC	WOLF C4-3	47356	OTSEGO	CHESTER	3	30	N		2 W
10/01/2019	RIVIERA OPERATING LLC	RIVERSIDE ENERGY MICHIGAN LLC	WOLF A4-10	47357	OTSEGO	CHESTER	10	30	N		2 W
10/01/2019	RIVIERA OPERATING LLC	RIVERSIDE ENERGY MICHIGAN LLC	LAKES OF THE NORTH B1-6	47370	OTSEGO	HAYES	6	29	N		4 W
10/01/2019	RIVIERA OPERATING LLC	RIVERSIDE ENERGY MICHIGAN LLC	LAKES OF THE NORTH B4-6	47388	OTSEGO	HAYES	6	29	N		4 W
10/01/2019	RIVIERA OPERATING LLC	RIVERSIDE ENERGY MICHIGAN LLC	THOMAS LAKE I D3-16	47393	OTSEGO	HAYES	16	30	N		4 W
10/01/2019	RIVIERA OPERATING LLC	RIVERSIDE ENERGY MICHIGAN LLC	LAKES OF THE NORTH B2-6	47510	OTSEGO	HAYES	6	29	N		4 W
10/01/2019	RIVIERA OPERATING LLC	RIVERSIDE ENERGY MICHIGAN LLC	WILD WEST D4-4	47804	OTSEGO	HAYES	4	30	N		4 W
10/01/2019	RIVIERA OPERATING LLC	RIVERSIDE ENERGY MICHIGAN LLC	THOMAS LAKE I A4-16	48146	OTSEGO	HAYES	16	30	N		4 W
10/01/2019	RIVIERA OPERATING LLC	RIVERSIDE ENERGY MICHIGAN LLC	WILD WEST B1-5	48204	OTSEGO	HAYES	5	30	N		4 W
10/01/2019	RIVIERA OPERATING LLC	RIVERSIDE ENERGY MICHIGAN LLC	WILD WEST D1-5	48206	OTSEGO	HAYES	5	30	N		4 W
10/01/2019	RIVIERA OPERATING LLC	RIVERSIDE ENERGY MICHIGAN LLC	WILD WEST D4-5	48207	OTSEGO	HAYES	5	30	N		4 W
10/01/2019	RIVIERA OPERATING LLC	RIVERSIDE ENERGY MICHIGAN LLC	WILD WEST D3-4	48210	OTSEGO	HAYES	4	30	N		4 W
10/01/2019	RIVIERA OPERATING LLC	RIVERSIDE ENERGY MICHIGAN LLC	WILD WEST D2-9	48211	OTSEGO	HAYES	9	30	N		4 W
10/01/2019	RIVIERA OPERATING LLC	RIVERSIDE ENERGY MICHIGAN LLC	WILD WEST D2-3	48215	OTSEGO	HAYES	3	30	N		4 W
10/01/2019	RIVIERA OPERATING LLC	RIVERSIDE ENERGY MICHIGAN LLC	STATE OTSEGO LAKE (HEART LAKE) A4-29	48290	OTSEGO	OTSEGO LAKE	29	29	N		3 W
10/01/2019	RIVIERA OPERATING LLC	RIVERSIDE ENERGY MICHIGAN LLC	HEART LAKE D3-29	48382	OTSEGO	OTSEGO LAKE	29	29	N		3 W
10/01/2019	RIVIERA OPERATING LLC	RIVERSIDE ENERGY MICHIGAN LLC	CARGAS C2-2	48591	OTSEGO	CHESTER	2	30	N		2 W
10/01/2019	RIVIERA OPERATING LLC	RIVERSIDE ENERGY MICHIGAN LLC	WILD WEST B1-10	49121	OTSEGO	HAYES	10	30	N		4 W
10/01/2019	RIVIERA OPERATING LLC	RIVERSIDE ENERGY MICHIGAN LLC	CLASSICS B4-10	49188	OTSEGO	CHESTER	10	30	N		2 W
10/01/2019	RIVIERA OPERATING LLC	RIVERSIDE ENERGY MICHIGAN LLC	CLASSICS A2-13	49189	OTSEGO	CHESTER	13	30	N		2 W
10/01/2019	RIVIERA OPERATING LLC	RIVERSIDE ENERGY MICHIGAN LLC	CLASSICS A1-11	49190	OTSEGO	CHESTER	11	30	N		2 W
10/01/2019	RIVIERA OPERATING LLC	RIVERSIDE ENERGY MICHIGAN LLC	CLASSICS C3-14	49191	OTSEGO	CHESTER	14	30	N		2 W
10/01/2019	RIVIERA OPERATING LLC	RIVERSIDE ENERGY MICHIGAN LLC	THOMAS LAKE D2-33	50352	OTSEGO	HAYES	33	30	N		4 W
10/01/2019	RIVIERA OPERATING LLC	RIVERSIDE ENERGY MICHIGAN LLC	THOMAS LAKE D1-29	50354	OTSEGO	HAYES	29	30	N		4 W
10/01/2019	RIVIERA OPERATING LLC	RIVERSIDE ENERGY MICHIGAN LLC	THOMAS LAKE D3-29	50408	OTSEGO	HAYES	29	30	N		4 W
10/01/2019	RIVIERA OPERATING LLC	RIVERSIDE ENERGY MICHIGAN LLC	THOMAS LAKE A2-33	50409	OTSEGO	HAYES	33	30	N		4 W
10/01/2019	RIVIERA OPERATING LLC	RIVERSIDE ENERGY MICHIGAN LLC	THOMAS LAKE C2-33	50411	OTSEGO	HAYES	33	30	N		4 W
10/01/2019	RIVIERA OPERATING LLC	RIVERSIDE ENERGY MICHIGAN LLC	STATE HAYES (THOMAS LAKE) D4-33	50529	OTSEGO	HAYES	33	30	N		4 W
10/01/2019	RIVIERA OPERATING LLC	RIVERSIDE ENERGY MICHIGAN LLC	THOMAS LAKE A1-26	51420	OTSEGO	HAYES	26	30	N		4 W
10/01/2019	RIVIERA OPERATING LLC	RIVERSIDE ENERGY MICHIGAN LLC	THOMAS LAKE A3-26	51421	OTSEGO	HAYES	26	30	N		4 W
10/01/2019	RIVIERA OPERATING LLC	RIVERSIDE ENERGY MICHIGAN LLC	THOMAS LAKE B4-26	51422	OTSEGO	HAYES	26	30	N		4 W
10/01/2019	RIVIERA OPERATING LLC	RIVERSIDE ENERGY MICHIGAN LLC	CARGAS C1-2	51838	OTSEGO	CHESTER	2	30	N		2 W
10/01/2019	RIVIERA OPERATING LLC	RIVERSIDE ENERGY MICHIGAN LLC	THOMAS LAKE B1-32	51890	OTSEGO	HAYES	32	30	N		4 W
10/01/2019	RIVIERA OPERATING LLC	RIVERSIDE ENERGY MICHIGAN LLC	WILD WEST B4-4	52607	OTSEGO	HAYES	4	30	N		4 W
10/01/2019	RIVIERA OPERATING LLC	RIVERSIDE ENERGY MICHIGAN LLC	LONE PINE D2-13	53052	OTSEGO	HAYES	13	30	N		4 W
10/01/2019	RIVIERA OPERATING LLC	RIVERSIDE ENERGY MICHIGAN LLC	MARTENSON ET AL D3-11A	53613	OTSEGO	CHESTER	11	29	N		2 W

Transfer Date	Previous Operator	New Operator	WellName	Permit	County	Township	Sec	Twp	TwpDir	Rng	RngDir
10/01/2019	RIVIERA OPERATING LLC	RIVERSIDE ENERGY MICHIGAN LLC	WILD WEST D4-3	56841	OTSEGO	HAYES	3	30	N	4	W
10/01/2019	RIVIERA OPERATING LLC	RIVERSIDE ENERGY MICHIGAN LLC	WILD WEST C3-4	56842	OTSEGO	HAYES	4	30	N	4	W
10/01/2019	RIVIERA OPERATING LLC	RIVERSIDE ENERGY MICHIGAN LLC	WILD WEST C4-9	56844	OTSEGO	HAYES	9	30	N	4	W
10/01/2019	RIVIERA OPERATING LLC	RIVERSIDE ENERGY MICHIGAN LLC	WILD WEST D3-9	56845	OTSEGO	HAYES	9	30	N	4	W
10/01/2019	RIVIERA OPERATING LLC	RIVERSIDE ENERGY MICHIGAN LLC	WILD WEST C2-9	56884	OTSEGO	HAYES	9	30	N	4	W
10/01/2019	RIVIERA OPERATING LLC	RIVERSIDE ENERGY MICHIGAN LLC	THOMAS LAKE NORTH B2-16	57265	OTSEGO	HAYES	16	30	N	4	W
10/01/2019	RIVIERA OPERATING LLC	RIVERSIDE ENERGY MICHIGAN LLC	FREDERIC 1 B2-21	57456	OTSEGO	HAYES	21	29	N	4	W
10/01/2019	RIVIERA OPERATING LLC	RIVERSIDE ENERGY MICHIGAN LLC	FREDERIC 1 D3-20	57457	OTSEGO	HAYES	20	29	N	4	W
10/01/2019	RIVIERA OPERATING LLC	RIVERSIDE ENERGY MICHIGAN LLC	WESLEY A4-11	57985	OTSEGO	CHESTER	11	29	N	2	W
10/01/2019	RIVIERA OPERATING LLC	RIVERSIDE ENERGY MICHIGAN LLC	THOMAS LAKE NORTH D1-16	58260	OTSEGO	HAYES	16	30	N	4	W
10/02/2019	BENCHLEY DONALD P AND BENCHLEY JEFFREY P	BAILER AND DESHAW	BENCHLEY 3-22	38191	ARENAC	ADAMS	22	19	N	3	E
10/02/2019	BENCHLEY DONALD P AND BENCHLEY JEFFREY P	BAILER AND DESHAW	BENCHLEY 1-22	37529	ARENAC	ADAMS	22	19	N	3	E
10/02/2019	BENCHLEY DONALD P AND BENCHLEY JEFFREY P	BAILER AND DESHAW	BENCHLEY 2-22	37530	ARENAC	ADAMS	22	19	N	3	E
10/02/2019	BENCHLEY DONALD P AND BENCHLEY JEFFREY P	BAILER AND DESHAW	BENCHLEY 3-19	39978	ARENAC	DEEP RIVER	19	19	N	4	E
10/02/2019	BENCHLEY DONALD P AND BENCHLEY JEFFREY P	BAILER AND DESHAW	ADAMS, NEIL 1-19	40038	ARENAC	DEEP RIVER	19	19	N	4	E
10/02/2019	BENCHLEY DONALD P AND BENCHLEY JEFFREY P	BAILER AND DESHAW	FISK 1-23	37262	ARENAC	ADAMS	23	19	N	3	E
10/02/2019	BENCHLEY DONALD P AND BENCHLEY JEFFREY P	BAILER AND DESHAW	BENCHLEY, DONALD 1-24	40102	ARENAC	ADAMS	24	19	N	3	E
10/02/2019	BENCHLEY DONALD P AND BENCHLEY JEFFREY P	BAILER AND DESHAW	VAUGHN ET AL 1-14	37181	ARENAC	LINCOLN	14	18	N	4	E
10/02/2019	RIVIERA OPERATING LLC	RIVERSIDE ENERGY MICHIGAN LLC	STATE HAWES & REMINGTON B1-19 HD	57009	ALCONA	HAWES	19	27	N	8	E
10/02/2019	RIVIERA OPERATING LLC	RIVERSIDE ENERGY MICHIGAN LLC	STATE HAWES & REMINGTON B1-19 HD	57009	ALCONA	HAWES	19	27	N	8	E
10/02/2019	RIVIERA OPERATING LLC	RIVERSIDE ENERGY MICHIGAN LLC	STATE HAWES & REMINGTON B1-19 HD	57009	ALCONA	HAWES	19	27	N	8	E
10/02/2019	RIVIERA OPERATING LLC	RIVERSIDE ENERGY MICHIGAN LLC	STATE HAWES & REMINGTON B1-19 HD	57009	ALCONA	HAWES	19	27	N	8	E
10/02/2019	RIVIERA OPERATING LLC	RIVERSIDE ENERGY MICHIGAN LLC	STATE HAWES & REMINGTON B1-19 HD	57009	ALCONA	HAWES	19	27	N	8	E
10/02/2019	RIVIERA OPERATING LLC	RIVERSIDE ENERGY MICHIGAN LLC	STATE HAWES & REMINGTON B1-19 HD	57009	ALCONA	HAWES	19	27	N	8	E
10/02/2019	RIVIERA OPERATING LLC	RIVERSIDE ENERGY MICHIGAN LLC	STATE HAWES & REMINGTON B1-19 HD	57009	ALCONA	HAWES	19	27	N	8	E
10/02/2019	RIVIERA OPERATING LLC	RIVERSIDE ENERGY MICHIGAN LLC	STATE HAWES & REMINGTON B1-19 HD	57009	ALCONA	HAWES	19	27	N	8	E
10/02/2019	RIVIERA OPERATING LLC	RIVERSIDE ENERGY MICHIGAN LLC	GAISHIN B4-20	56868	ALCONA	HAWES	20	27	N	8	E
10/02/2019	RIVIERA OPERATING LLC	RIVERSIDE ENERGY MICHIGAN LLC	GAISHIN B4-20	56868	ALCONA	HAWES	20	27	N	8	E
10/02/2019	RIVIERA OPERATING LLC	RIVERSIDE ENERGY MICHIGAN LLC	GAISHIN B4-20	56868	ALCONA	HAWES	20	27	N	8	E
10/02/2019	RIVIERA OPERATING LLC	RIVERSIDE ENERGY MICHIGAN LLC	JOHNSON D3-24 HD	56772	ALCONA	HAWES	24	27	N	7	E
10/02/2019	RIVIERA OPERATING LLC	RIVERSIDE ENERGY MICHIGAN LLC	JOHNSON D3-24 HD	56772	ALCONA	HAWES	24	27	N	7	E
10/02/2019	RIVIERA OPERATING LLC	RIVERSIDE ENERGY MICHIGAN LLC	JOHNSON D3-24 HD	56772	ALCONA	HAWES	24	27	N	7	E
10/02/2019	RIVIERA OPERATING LLC	RIVERSIDE ENERGY MICHIGAN LLC	JOHNSON D3-24 HD	56772	ALCONA	HAWES	24	27	N	7	E
10/02/2019	RIVIERA OPERATING LLC	RIVERSIDE ENERGY MICHIGAN LLC	JOHNSON D3-24 HD	56772	ALCONA	HAWES	24	27	N	7	E
10/02/2019	RIVIERA OPERATING LLC	RIVERSIDE ENERGY MICHIGAN LLC	JOHNSON D3-24 HD	56772	ALCONA	HAWES	24	27	N	7	E
10/02/2019	RIVIERA OPERATING LLC	RIVERSIDE ENERGY MICHIGAN LLC	SCHULTZ ET AL B3-6	54118	ALCONA	CALEDONIA	6	28	N	7	E
10/02/2019	RIVIERA OPERATING LLC	RIVERSIDE ENERGY MICHIGAN LLC	SCHULTZ ET AL B3-6	54118	ALCONA	CALEDONIA	6	28	N	7	E
10/02/2019	RIVIERA OPERATING LLC	RIVERSIDE ENERGY MICHIGAN LLC	SCHULTZ ET AL B3-6	54118	ALCONA	CALEDONIA	6	28	N	7	E
10/02/2019	RIVIERA OPERATING LLC	RIVERSIDE ENERGY MICHIGAN LLC	STATE MITCHELL A3-8	60202	ALCONA	MITCHELL	8	28	N	5	E
10/02/2019	RIVIERA OPERATING LLC	RIVERSIDE ENERGY MICHIGAN LLC	SKIBA & OAKLAND HUNT CLUB C1-4	60203	ALCONA	MITCHELL	4	28	N	5	E
10/02/2019	RIVIERA OPERATING LLC	RIVERSIDE ENERGY MICHIGAN LLC	OAKLAND HUNT CLUB C4-6	60204	ALCONA	MITCHELL	6	28	N	5	E
10/02/2019	RIVIERA OPERATING LLC	RIVERSIDE ENERGY MICHIGAN LLC	OAKLAND HUNT CLUB C1-5	60205	ALCONA	MITCHELL	5	28	N	5	E
10/02/2019	RIVIERA OPERATING LLC	RIVERSIDE ENERGY MICHIGAN LLC	STATE SANBORN & WADE 1-28A	47576	ALPENA	SANBORN	28	29	N	9	E
10/02/2019	RIVIERA OPERATING LLC	RIVERSIDE ENERGY MICHIGAN LLC	STATE MITCHELL ET AL B2-9	60201	ALCONA	MITCHELL	9	28	N	5	E
10/02/2019	RIVIERA OPERATING LLC	RIVERSIDE ENERGY MICHIGAN LLC	COSTER ET AL B2-6	60200	ALCONA	MITCHELL	6	28	N	5	E
10/02/2019	RIVIERA OPERATING LLC	RIVERSIDE ENERGY MICHIGAN LLC	STATE MITCHELL & CHABOT C2-10	60199	ALCONA	MITCHELL	10	28	N	5	E
10/02/2019	RIVIERA OPERATING LLC	RIVERSIDE ENERGY MICHIGAN LLC	STATE MITCHELL & OAKLAND HUNT CLUB A1-8	59937	ALCONA	MITCHELL	8	28	N	5	E
10/02/2019	RIVIERA OPERATING LLC	RIVERSIDE ENERGY MICHIGAN LLC	STATE HAWES & REMINGTON B1-19 HD	57009	ALCONA	HAWES	19	27	N	8	E
10/02/2019	RIVIERA OPERATING LLC	RIVERSIDE ENERGY MICHIGAN LLC	STATE HAWES & REMINGTON B1-19 HD	57009	ALCONA	HAWES	19	27	N	8	E
10/02/2019	RIVIERA OPERATING LLC	RIVERSIDE ENERGY MICHIGAN LLC	STATE HAWES & REMINGTON B1-19 HD	57009	ALCONA	HAWES	19	27	N	8	E
10/02/2019	RIVIERA OPERATING LLC	RIVERSIDE ENERGY MICHIGAN LLC	GAISHIN B4-20	56868	ALCONA	HAWES	20	27	N	8	E
10/02/2019	RIVIERA OPERATING LLC	RIVERSIDE ENERGY MICHIGAN LLC	GAISHIN B4-20	56868	ALCONA	HAWES	20	27	N	8	E
10/02/2019	RIVIERA OPERATING LLC	RIVERSIDE ENERGY MICHIGAN LLC	JOHNSON D3-24 HD	56772	ALCONA	HAWES	24	27	N	7	E
10/02/2019	RIVIERA OPERATING LLC	RIVERSIDE ENERGY MICHIGAN LLC	JOHNSON D3-24 HD	56772	ALCONA	HAWES	24	27	N	7	E
10/02/2019	RIVIERA OPERATING LLC	RIVERSIDE ENERGY MICHIGAN LLC	SCHULTZ ET AL B3-6	54118	ALCONA	CALEDONIA	6	28	N	7	E
10/02/2019	RIVIERA OPERATING LLC	RIVERSIDE ENERGY MICHIGAN LLC	SCHULTZ ET AL B3-6	54118	ALCONA	CALEDONIA	6	28	N	7	E
10/02/2019	RIVIERA OPERATING LLC	RIVERSIDE ENERGY MICHIGAN LLC	INDIAN CREEK RANCH ET AL A2-1	53045	ALCONA	MITCHELL	1	28	N	5	E
10/02/2019	RIVIERA OPERATING LLC	RIVERSIDE ENERGY MICHIGAN LLC	MILLER C2-2	53011	ALCONA	MITCHELL	2	28	N	5	E
10/02/2019	RIVIERA OPERATING LLC	RIVERSIDE ENERGY MICHIGAN LLC	SANFORD & SHARBONEAU ET AL A2-2	53010	ALCONA	MITCHELL	2	28	N	5	E
10/02/2019	RIVIERA OPERATING LLC	RIVERSIDE ENERGY MICHIGAN LLC	LOST LAKE WOODS ASSOC. ET AL A4-27	52460	ALCONA	ALCONA	27	28	N	8	E
10/02/2019	RIVIERA OPERATING LLC	RIVERSIDE ENERGY MICHIGAN LLC	LOST LAKE WOODS ASSOC. ET AL C3-27	52457	ALCONA	ALCONA	27	28	N	8	E

Transfer Date	Previous Operator	New Operator	WellName	Permit	County	Township	Sec	Twp	TwpDir	Rng	RngDir
10/02/2019	RIVIERA OPERATING LLC	RIVERSIDE ENERGY MICHIGAN LLC	LONG B2-20	52357	ALCONA	ALCONA	20	28	N	7	E
10/02/2019	RIVIERA OPERATING LLC	RIVERSIDE ENERGY MICHIGAN LLC	REYNOLDS & CALEDONIA DEV. CORP. A3-19	52183	ALCONA	ALCONA	19	28	N	7	E
10/02/2019	RIVIERA OPERATING LLC	RIVERSIDE ENERGY MICHIGAN LLC	LOST LAKE WOODS ASSOC. ET AL A1-22	52132	ALCONA	ALCONA	22	28	N	8	E
10/02/2019	RIVIERA OPERATING LLC	RIVERSIDE ENERGY MICHIGAN LLC	BUTLER C4-20	51849	ALCONA	ALCONA	20	28	N	7	E
10/02/2019	RIVIERA OPERATING LLC	RIVERSIDE ENERGY MICHIGAN LLC	STATE MANCELONA ET AL D2-7	57125	ANTRIM	MANCELONA	7	29	N	5	W
10/02/2019	RIVIERA OPERATING LLC	RIVERSIDE ENERGY MICHIGAN LLC	PETERSON D1-13	60210	ANTRIM	TORCH LAKE	13	30	N	9	W
10/02/2019	RIVIERA OPERATING LLC	RIVERSIDE ENERGY MICHIGAN LLC	PETERSEN D3-12	60209	ANTRIM	TORCH LAKE	12	30	N	9	W
10/02/2019	RIVIERA OPERATING LLC	RIVERSIDE ENERGY MICHIGAN LLC	AMOS C4-14	60208	ANTRIM	TORCH LAKE	14	30	N	9	W
10/02/2019	RIVIERA OPERATING LLC	RIVERSIDE ENERGY MICHIGAN LLC	ALTONEN A1-13	60207	ANTRIM	TORCH LAKE	13	30	N	9	W
10/02/2019	RIVIERA OPERATING LLC	RIVERSIDE ENERGY MICHIGAN LLC	AMOS A2-14 HD1	58742	ANTRIM	TORCH LAKE	14	30	N	9	W
10/02/2019	RIVIERA OPERATING LLC	RIVERSIDE ENERGY MICHIGAN LLC	AMOS B1-14 HD1	58741	ANTRIM	TORCH LAKE	14	30	N	9	W
10/02/2019	RIVIERA OPERATING LLC	RIVERSIDE ENERGY MICHIGAN LLC	HUBBELL A4-14	58740	ANTRIM	TORCH LAKE	14	30	N	9	W
10/02/2019	RIVIERA OPERATING LLC	RIVERSIDE ENERGY MICHIGAN LLC	AMOS B4-14	58739	ANTRIM	TORCH LAKE	14	30	N	9	W
10/02/2019	RIVIERA OPERATING LLC	RIVERSIDE ENERGY MICHIGAN LLC	MCLACHLAN C3-13	58734	ANTRIM	TORCH LAKE	13	30	N	9	W
10/02/2019	RIVIERA OPERATING LLC	RIVERSIDE ENERGY MICHIGAN LLC	MCLACHLAN D3-13	58733	ANTRIM	TORCH LAKE	13	30	N	9	W
10/02/2019	RIVIERA OPERATING LLC	RIVERSIDE ENERGY MICHIGAN LLC	PETERSEN C3-12	58722	ANTRIM	TORCH LAKE	12	30	N	9	W
10/02/2019	RIVIERA OPERATING LLC	RIVERSIDE ENERGY MICHIGAN LLC	BRILEY B3-29	47086	MONTMORENCY	BRILEY	29	30	N	2	E
10/02/2019	RIVIERA OPERATING LLC	RIVERSIDE ENERGY MICHIGAN LLC	STATE AVERY A4-36	48828	MONTMORENCY	AVERY	36	30	N	3	E
10/02/2019	RIVIERA OPERATING LLC	RIVERSIDE ENERGY MICHIGAN LLC	STATE BRILEY A1-29	48947	MONTMORENCY	BRILEY	29	30	N	2	E
10/02/2019	RIVIERA OPERATING LLC	RIVERSIDE ENERGY MICHIGAN LLC	STATE BRILEY & JACKSON ET AL A4-29	53609	MONTMORENCY	BRILEY	29	30	N	2	E
10/02/2019	RIVIERA OPERATING LLC	RIVERSIDE ENERGY MICHIGAN LLC	ROSEN TRUST ET AL C3-20	55258	MONTMORENCY	BRILEY	20	30	N	2	E
10/02/2019	RIVIERA OPERATING LLC	RIVERSIDE ENERGY MICHIGAN LLC	ROSEN TRUST ET AL D4-20	55259	MONTMORENCY	BRILEY	20	30	N	2	E
10/02/2019	RIVIERA OPERATING LLC	RIVERSIDE ENERGY MICHIGAN LLC	STATE BRILEY & ROSEN TRUST C1-21	55278	MONTMORENCY	BRILEY	21	30	N	2	E
10/02/2019	RIVIERA OPERATING LLC	RIVERSIDE ENERGY MICHIGAN LLC	STATE BRILEY TWIN B1-29	57863	MONTMORENCY	BRILEY	29	30	N	2	E
10/02/2019	RIVIERA OPERATING LLC	RIVERSIDE ENERGY MICHIGAN LLC	STATE BRILEY A2-29	57997	MONTMORENCY	BRILEY	29	30	N	2	E
10/02/2019	RIVIERA OPERATING LLC	RIVERSIDE ENERGY MICHIGAN LLC	ZEIDLER C1-25	41765	OTSEGO	CHARLTON	25	30	N	1	W
10/02/2019	RIVIERA OPERATING LLC	RIVERSIDE ENERGY MICHIGAN LLC	ZEIDLER D2-25	41790	OTSEGO	CHARLTON	25	30	N	1	W
10/02/2019	RIVIERA OPERATING LLC	RIVERSIDE ENERGY MICHIGAN LLC	KOBYLCZAK A3-27	41796	OTSEGO	CHARLTON	27	30	N	1	W
10/02/2019	RIVIERA OPERATING LLC	RIVERSIDE ENERGY MICHIGAN LLC	TOLLMAN B2-27	41797	OTSEGO	CHARLTON	27	30	N	1	W
10/02/2019	RIVIERA OPERATING LLC	RIVERSIDE ENERGY MICHIGAN LLC	ZEIDLER C3-25 HD1	41861	OTSEGO	CHARLTON	25	30	N	1	W
10/02/2019	RIVIERA OPERATING LLC	RIVERSIDE ENERGY MICHIGAN LLC	ZEIDLER D4-26	42290	OTSEGO	CHARLTON	26	30	N	1	W
10/02/2019	RIVIERA OPERATING LLC	RIVERSIDE ENERGY MICHIGAN LLC	ZEIDLER B4-26	42341	OTSEGO	CHARLTON	26	30	N	1	W
10/02/2019	RIVIERA OPERATING LLC	RIVERSIDE ENERGY MICHIGAN LLC	FRANKE B2-26	42392	OTSEGO	CHARLTON	26	30	N	1	W
10/02/2019	RIVIERA OPERATING LLC	RIVERSIDE ENERGY MICHIGAN LLC	FRANKE A1-26	42393	OTSEGO	CHARLTON	26	30	N	1	W
10/02/2019	RIVIERA OPERATING LLC	RIVERSIDE ENERGY MICHIGAN LLC	WENDT D4-25	42487	OTSEGO	CHARLTON	25	30	N	1	W
10/02/2019	RIVIERA OPERATING LLC	RIVERSIDE ENERGY MICHIGAN LLC	THOMAS D3-25	42488	OTSEGO	CHARLTON	25	30	N	1	W
10/02/2019	RIVIERA OPERATING LLC	RIVERSIDE ENERGY MICHIGAN LLC	HIME A3-36	42489	OTSEGO	CHARLTON	25	30	N	1	W
10/02/2019	RIVIERA OPERATING LLC	RIVERSIDE ENERGY MICHIGAN LLC	SADOWSKI A4-36	42490	OTSEGO	CHARLTON	25	30	N	1	W
10/02/2019	RIVIERA OPERATING LLC	RIVERSIDE ENERGY MICHIGAN LLC	FREDERIC II C4-28	45291	OTSEGO	HAYES	28	29	N	4	W
10/02/2019	RIVIERA OPERATING LLC	RIVERSIDE ENERGY MICHIGAN LLC	SADOWSKI A4-36	42490	OTSEGO	CHARLTON	25	30	N	1	W
10/02/2019	RIVIERA OPERATING LLC	RIVERSIDE ENERGY MICHIGAN LLC	FRANKE B2-26	42392	OTSEGO	CHARLTON	26	30	N	1	W
10/02/2019	RIVIERA OPERATING LLC	RIVERSIDE ENERGY MICHIGAN LLC	ZEIDLER D4-26	42290	OTSEGO	CHARLTON	26	30	N	1	W
10/02/2019	RIVIERA OPERATING LLC	RIVERSIDE ENERGY MICHIGAN LLC	ZEIDLER C3-25 HD1	41861	OTSEGO	CHARLTON	25	30	N	1	W
10/02/2019	RIVIERA OPERATING LLC	RIVERSIDE ENERGY MICHIGAN LLC	TOLLMAN B2-27	41797	OTSEGO	CHARLTON	27	30	N	1	W
10/02/2019	RIVIERA OPERATING LLC	RIVERSIDE ENERGY MICHIGAN LLC	THOMAS LAKE I D4-26	46560	OTSEGO	HAYES	26	30	N	4	W
10/02/2019	RIVIERA OPERATING LLC	RIVERSIDE ENERGY MICHIGAN LLC	LAKES OF THE NORTH D1-30	46681	OTSEGO	HAYES	30	30	N	4	W
10/02/2019	RIVIERA OPERATING LLC	RIVERSIDE ENERGY MICHIGAN LLC	LAKES OF THE NORTH B1-31	46682	OTSEGO	HAYES	31	30	N	4	W
10/02/2019	RIVIERA OPERATING LLC	RIVERSIDE ENERGY MICHIGAN LLC	LAKES OF THE NORTH D1-31	46683	OTSEGO	HAYES	31	30	N	4	W
10/02/2019	RIVIERA OPERATING LLC	RIVERSIDE ENERGY MICHIGAN LLC	THOMAS LAKE I C3-34	47333	OTSEGO	HAYES	34	30	N	4	W
10/02/2019	RIVIERA OPERATING LLC	RIVERSIDE ENERGY MICHIGAN LLC	THOMAS LAKE I A3-22	47340	OTSEGO	HAYES	22	30	N	4	W
10/02/2019	RIVIERA OPERATING LLC	RIVERSIDE ENERGY MICHIGAN LLC	STATE HAYES (THOMAS LAKE I) D4-34	47350	OTSEGO	HAYES	34	30	N	4	W
10/02/2019	RIVIERA OPERATING LLC	RIVERSIDE ENERGY MICHIGAN LLC	STATE HAYES (THOMAS LAKE I) D2-26	47351	OTSEGO	HAYES	26	30	N	4	W
10/02/2019	RIVIERA OPERATING LLC	RIVERSIDE ENERGY MICHIGAN LLC	STATE HAYES (THOMAS LAKE I) D1-26	47352	OTSEGO	HAYES	26	30	N	4	W
10/02/2019	RIVIERA OPERATING LLC	RIVERSIDE ENERGY MICHIGAN LLC	THOMAS LAKE I C4-16	47392	OTSEGO	HAYES	16	30	N	4	W
10/02/2019	RIVIERA OPERATING LLC	RIVERSIDE ENERGY MICHIGAN LLC	WILD WEST C1-3	47803	OTSEGO	HAYES	3	30	N	4	W
10/02/2019	RIVIERA OPERATING LLC	RIVERSIDE ENERGY MICHIGAN LLC	THOMAS LAKE I B4-27	48132	OTSEGO	HAYES	27	30	N	4	W
10/02/2019	RIVIERA OPERATING LLC	RIVERSIDE ENERGY MICHIGAN LLC	THOMAS LAKE I A4-27	48133	OTSEGO	HAYES	27	30	N	4	W
10/02/2019	RIVIERA OPERATING LLC	RIVERSIDE ENERGY MICHIGAN LLC	THOMAS LAKE I B4-21	48134	OTSEGO	HAYES	21	30	N	4	W
10/02/2019	RIVIERA OPERATING LLC	RIVERSIDE ENERGY MICHIGAN LLC	STATE HAYES (THOMAS LAKE I) B4-34	48135	OTSEGO	HAYES	34	30	N	4	W
10/02/2019	RIVIERA OPERATING LLC	RIVERSIDE ENERGY MICHIGAN LLC	THOMAS LAKE I C2-16	48153	OTSEGO	HAYES	16	30	N	4	W
10/02/2019	RIVIERA OPERATING LLC	RIVERSIDE ENERGY MICHIGAN LLC	WILD WEST C3-3	48202	OTSEGO	HAYES	3	30	N	4	W
10/02/2019	RIVIERA OPERATING LLC	RIVERSIDE ENERGY MICHIGAN LLC	WILD WEST C1-4	48203	OTSEGO	HAYES	4	30	N	4	W
10/02/2019	RIVIERA OPERATING LLC	RIVERSIDE ENERGY MICHIGAN LLC	WILD WEST C2-5	48205	OTSEGO	HAYES	5	30	N	4	W
10/02/2019	RIVIERA OPERATING LLC	RIVERSIDE ENERGY MICHIGAN LLC	WILD WEST B1-9	48208	OTSEGO	HAYES	9	30	N	4	W

Transfer Date	Previous Operator	New Operator	WellName	Permit	County	Township	Sec	Twp	TwpDir	Rng	RngDir
10/02/2019	RIVIERA OPERATING LLC	RIVERSIDE ENERGY MICHIGAN LLC	WILD WEST D1-33	48212	OTSEGO	ELMIRA	33	31	N	4	W
10/02/2019	RIVIERA OPERATING LLC	RIVERSIDE ENERGY MICHIGAN LLC	WILD WEST D3-33	48213	OTSEGO	ELMIRA	33	31	N	4	W
10/02/2019	RIVIERA OPERATING LLC	RIVERSIDE ENERGY MICHIGAN LLC	WILD WEST D4-33	48214	OTSEGO	ELMIRA	33	31	N	4	W
10/02/2019	RIVIERA OPERATING LLC	RIVERSIDE ENERGY MICHIGAN LLC	WILD WEST B3-9	49120	OTSEGO	HAYES	9	30	N	4	W
10/02/2019	RIVIERA OPERATING LLC	RIVERSIDE ENERGY MICHIGAN LLC	LONE PINE B1-13	49143	OTSEGO	HAYES	13	30	N	4	W
10/02/2019	RIVIERA OPERATING LLC	RIVERSIDE ENERGY MICHIGAN LLC	LONE PINE A1-13	49144	OTSEGO	HAYES	13	30	N	4	W
10/02/2019	RIVIERA OPERATING LLC	RIVERSIDE ENERGY MICHIGAN LLC	LONE PINE D3-13	49145	OTSEGO	HAYES	13	30	N	4	W
10/02/2019	RIVIERA OPERATING LLC	RIVERSIDE ENERGY MICHIGAN LLC	STATE HAYES (THOMAS LAKE) C1-34	49184	OTSEGO	HAYES	34	30	N	4	W
10/02/2019	RIVIERA OPERATING LLC	RIVERSIDE ENERGY MICHIGAN LLC	THOMAS LAKE B4-35	49830	OTSEGO	HAYES	35	30	N	4	W
10/02/2019	RIVIERA OPERATING LLC	RIVERSIDE ENERGY MICHIGAN LLC	THOMAS LAKE C2-14	50039	OTSEGO	HAYES	14	30	N	4	W
10/02/2019	RIVIERA OPERATING LLC	RIVERSIDE ENERGY MICHIGAN LLC	THOMAS LAKE A1-23	50040	OTSEGO	HAYES	23	30	N	4	W
10/02/2019	RIVIERA OPERATING LLC	RIVERSIDE ENERGY MICHIGAN LLC	THOMAS LAKE A4-23	50041	OTSEGO	HAYES	23	30	N	4	W
10/02/2019	RIVIERA OPERATING LLC	RIVERSIDE ENERGY MICHIGAN LLC	THOMAS LAKE B4-23	50042	OTSEGO	HAYES	23	30	N	4	W
10/02/2019	RIVIERA OPERATING LLC	RIVERSIDE ENERGY MICHIGAN LLC	STATE HAYES (THOMAS LAKE) B1-23	50051	OTSEGO	HAYES	23	30	N	4	W
10/02/2019	RIVIERA OPERATING LLC	RIVERSIDE ENERGY MICHIGAN LLC	THOMAS LAKE D2-34	50350	OTSEGO	HAYES	34	30	N	4	W
10/02/2019	RIVIERA OPERATING LLC	RIVERSIDE ENERGY MICHIGAN LLC	THOMAS LAKE A1-34	50351	OTSEGO	HAYES	34	30	N	4	W
10/02/2019	RIVIERA OPERATING LLC	RIVERSIDE ENERGY MICHIGAN LLC	THOMAS LAKE D1-28	50407	OTSEGO	HAYES	28	30	N	4	W
10/02/2019	RIVIERA OPERATING LLC	RIVERSIDE ENERGY MICHIGAN LLC	THOMAS LAKE A3-33	50410	OTSEGO	HAYES	33	30	N	4	W
10/02/2019	RIVIERA OPERATING LLC	RIVERSIDE ENERGY MICHIGAN LLC	STATE HAYES (THOMAS LAKE) D2-27	50531	OTSEGO	HAYES	27	30	N	4	W
10/02/2019	RIVIERA OPERATING LLC	RIVERSIDE ENERGY MICHIGAN LLC	THOMAS LAKE B2-26	51423	OTSEGO	HAYES	26	30	N	4	W
10/02/2019	RIVIERA OPERATING LLC	RIVERSIDE ENERGY MICHIGAN LLC	THOMAS LAKE D2-28	51841	OTSEGO	HAYES	28	30	N	4	W
10/02/2019	RIVIERA OPERATING LLC	RIVERSIDE ENERGY MICHIGAN LLC	GUMP B3-24HD1	51844	OTSEGO	HAYES	24	30	N	4	W
10/02/2019	RIVIERA OPERATING LLC	RIVERSIDE ENERGY MICHIGAN LLC	WILD WEST A2-9	56843	OTSEGO	HAYES	9	30	N	4	W
10/02/2019	RIVIERA OPERATING LLC	RIVERSIDE ENERGY MICHIGAN LLC	WILD WEST D1-10	56846	OTSEGO	HAYES	10	30	N	4	W
10/02/2019	RIVIERA OPERATING LLC	RIVERSIDE ENERGY MICHIGAN LLC	WILD WEST D1-4	56883	OTSEGO	HAYES	4	30	N	4	W
10/02/2019	RIVIERA OPERATING LLC	RIVERSIDE ENERGY MICHIGAN LLC	THOMAS LAKE ARROWHEAD B4-33	57266	OTSEGO	HAYES	33	30	N	4	W
10/02/2019	RIVIERA OPERATING LLC	RIVERSIDE ENERGY MICHIGAN LLC	PETERSON B1-17	49898	ALCONA	CALEDONIA	17	28	N	8	E
10/02/2019	RIVIERA OPERATING LLC	RIVERSIDE ENERGY MICHIGAN LLC	PAULSON B3-17	49899	ALCONA	CALEDONIA	17	28	N	8	E
10/02/2019	RIVIERA OPERATING LLC	RIVERSIDE ENERGY MICHIGAN LLC	SWANSINGER D2-17	49900	ALCONA	CALEDONIA	17	28	N	8	E
10/02/2019	RIVIERA OPERATING LLC	RIVERSIDE ENERGY MICHIGAN LLC	LANCEWICZ A3-19	49901	ALCONA	ALCONA	19	28	N	8	E
10/02/2019	RIVIERA OPERATING LLC	RIVERSIDE ENERGY MICHIGAN LLC	STEVENS C2-19	49902	ALCONA	ALCONA	19	28	N	8	E
10/02/2019	RIVIERA OPERATING LLC	RIVERSIDE ENERGY MICHIGAN LLC	WOOD B1-20	49903	ALCONA	ALCONA	20	28	N	8	E
10/02/2019	RIVIERA OPERATING LLC	RIVERSIDE ENERGY MICHIGAN LLC	LAFFELDT C2-8	49904	ALCONA	CALEDONIA	8	28	N	8	E
10/02/2019	RIVIERA OPERATING LLC	RIVERSIDE ENERGY MICHIGAN LLC	KELLY C4-19	49971	ALCONA	ALCONA	19	28	N	8	E
10/02/2019	RIVIERA OPERATING LLC	RIVERSIDE ENERGY MICHIGAN LLC	RASMUSSEN C1-7	50048	ALCONA	CALEDONIA	7	28	N	8	E
10/02/2019	RIVIERA OPERATING LLC	RIVERSIDE ENERGY MICHIGAN LLC	MOORE C1-18	50050	ALCONA	CALEDONIA	18	28	N	8	E
10/02/2019	RIVIERA OPERATING LLC	RIVERSIDE ENERGY MICHIGAN LLC	WAGGONER B4-1	53497	ALCONA	MITCHELL	1	28	N	5	E
10/02/2019	RIVIERA OPERATING LLC	RIVERSIDE ENERGY MICHIGAN LLC	SCHULTZ ET AL B3-6	54118	ALCONA	CALEDONIA	6	28	N	7	E
10/02/2019	RIVIERA OPERATING LLC	RIVERSIDE ENERGY MICHIGAN LLC	SCHULTZ ET AL B3-6	54118	ALCONA	CALEDONIA	6	28	N	7	E
10/02/2019	RIVIERA OPERATING LLC	RIVERSIDE ENERGY MICHIGAN LLC	SCHULTZ ET AL B3-6	54118	ALCONA	CALEDONIA	6	28	N	7	E
10/02/2019	RIVIERA OPERATING LLC	RIVERSIDE ENERGY MICHIGAN LLC	SCHULTZ ET AL B3-6	54118	ALCONA	CALEDONIA	6	28	N	7	E
10/02/2019	RIVIERA OPERATING LLC	RIVERSIDE ENERGY MICHIGAN LLC	SCHULTZ ET AL B3-6	54118	ALCONA	CALEDONIA	6	28	N	7	E
10/02/2019	RIVIERA OPERATING LLC	RIVERSIDE ENERGY MICHIGAN LLC	STOKES PROPERTIES ET AL D2-12	54694	ALCONA	CALEDONIA	12	28	N	6	E
10/02/2019	RIVIERA OPERATING LLC	RIVERSIDE ENERGY MICHIGAN LLC	VAN TUYL TRUST & GRIFITH B3-11	54695	ALCONA	CALEDONIA	11	28	N	6	E
10/02/2019	RIVIERA OPERATING LLC	RIVERSIDE ENERGY MICHIGAN LLC	STOKES PROPERTIES ET AL C4-11	54966	ALCONA	CALEDONIA	11	28	N	6	E
10/02/2019	RIVIERA OPERATING LLC	RIVERSIDE ENERGY MICHIGAN LLC	STATE MITCHELL B4-8	55402	ALCONA	MITCHELL	8	28	N	5	E
10/02/2019	RIVIERA OPERATING LLC	RIVERSIDE ENERGY MICHIGAN LLC	STATE MITCHELL B2-8	55423	ALCONA	MITCHELL	8	28	N	5	E
10/02/2019	RIVIERA OPERATING LLC	RIVERSIDE ENERGY MICHIGAN LLC	SUGDEN B4-5	55424	ALCONA	MITCHELL	5	28	N	5	E
10/02/2019	RIVIERA OPERATING LLC	RIVERSIDE ENERGY MICHIGAN LLC	SUGDEN B2-4	55425	ALCONA	MITCHELL	4	28	N	5	E
10/02/2019	RIVIERA OPERATING LLC	RIVERSIDE ENERGY MICHIGAN LLC	SUGDEN A1-4	55426	ALCONA	MITCHELL	4	28	N	5	E
10/02/2019	RIVIERA OPERATING LLC	RIVERSIDE ENERGY MICHIGAN LLC	STATE MITCHELL & WAGGONER C4-1	55427	ALCONA	MITCHELL	1	28	N	5	E
10/02/2019	RIVIERA OPERATING LLC	RIVERSIDE ENERGY MICHIGAN LLC	STATE CALEDONIA D1-2	56260	ALCONA	CALEDONIA	2	28	N	7	E
10/02/2019	RIVIERA OPERATING LLC	RIVERSIDE ENERGY MICHIGAN LLC	RAMSEY B3-20	56263	ALCONA	ALCONA	20	28	N	8	E
10/02/2019	RIVIERA OPERATING LLC	RIVERSIDE ENERGY MICHIGAN LLC	DUBUQUE & PAULSON D3-17	56264	ALCONA	CALEDONIA	17	28	N	8	E
10/02/2019	RIVIERA OPERATING LLC	RIVERSIDE ENERGY MICHIGAN LLC	STATE ALCONA & BUTLER TRUST C3-21	56284	ALCONA	ALCONA	21	28	N	7	E
10/02/2019	RIVIERA OPERATING LLC	RIVERSIDE ENERGY MICHIGAN LLC	LOSTLAKE WOOD ASSOC ET AL D2-33	56288	ALCONA	ALCONA	33	28	N	8	E
10/02/2019	RIVIERA OPERATING LLC	RIVERSIDE ENERGY MICHIGAN LLC	STATE CALEDONIA D2-17	56289	ALCONA	CALEDONIA	17	28	N	7	E
10/02/2019	RIVIERA OPERATING LLC	RIVERSIDE ENERGY MICHIGAN LLC	BUTLER TRUST & HALE A4-29	56290	ALCONA	ALCONA	29	28	N	7	E
10/02/2019	RIVIERA OPERATING LLC	RIVERSIDE ENERGY MICHIGAN LLC	VAN HAVERBECK A3-8	56308	ALCONA	CALEDONIA	8	28	N	7	E
10/02/2019	RIVIERA OPERATING LLC	RIVERSIDE ENERGY MICHIGAN LLC	STATE CALEDONIA & VAN HAVERBECK B3-8	56309	ALCONA	CALEDONIA	8	28	N	7	E
10/02/2019	RIVIERA OPERATING LLC	RIVERSIDE ENERGY MICHIGAN LLC	GINTER ET AL C3-19	56355	ALCONA	ALCONA	19	28	N	7	E
10/02/2019	RIVIERA OPERATING LLC	RIVERSIDE ENERGY MICHIGAN LLC	JOHNSON D3-24 HD	56772	ALCONA	HAWES	24	27	N	7	E
10/02/2019	RIVIERA OPERATING LLC	RIVERSIDE ENERGY MICHIGAN LLC	JOHNSON D3-24 HD	56772	ALCONA	HAWES	24	27	N	7	E

Transfer Date	Previous Operator	New Operator	WellName	Permit	County	Township	Sec	Twp	TwpDir	Rng	RngDir
10/02/2019	RIVIERA OPERATING LLC	RIVERSIDE ENERGY MICHIGAN LLC	WHITE PINE A4-7	58201	ALCONA	HAWES	7	27	N	8	E
10/02/2019	RIVIERA OPERATING LLC	RIVERSIDE ENERGY MICHIGAN LLC	VINCENT CREEK D2-8	58203	ALCONA	HAWES	8	27	N	8	E
10/02/2019	RIVIERA OPERATING LLC	RIVERSIDE ENERGY MICHIGAN LLC	BUCZEK A4-22	58411	ALCONA	HAWES	22	27	N	8	E
10/02/2019	RIVIERA OPERATING LLC	RIVERSIDE ENERGY MICHIGAN LLC	KLARICH ET AL A2-3	58484	ALCONA	CALEDONIA	3	28	N	6	E
10/02/2019	RIVIERA OPERATING LLC	RIVERSIDE ENERGY MICHIGAN LLC	KLARICH ET AL A2-3	58484	ALCONA	CALEDONIA	3	28	N	6	E
10/02/2019	RIVIERA OPERATING LLC	RIVERSIDE ENERGY MICHIGAN LLC	KLARICH ET AL A2-3	58484	ALCONA	CALEDONIA	3	28	N	6	E
10/02/2019	RIVIERA OPERATING LLC	RIVERSIDE ENERGY MICHIGAN LLC	KLARICH ET AL A2-3	58484	ALCONA	CALEDONIA	3	28	N	6	E
10/02/2019	RIVIERA OPERATING LLC	RIVERSIDE ENERGY MICHIGAN LLC	REMINGTON C2-18	59287	ALCONA	HAWES	18	27	N	8	E
10/02/2019	RIVIERA OPERATING LLC	RIVERSIDE ENERGY MICHIGAN LLC	MATHIAK ET AL A2-11	59399	ALCONA	CALEDONIA	11	28	N	7	E
10/02/2019	RIVIERA OPERATING LLC	RIVERSIDE ENERGY MICHIGAN LLC	WERNER ET AL A4-11	59400	ALCONA	CALEDONIA	11	28	N	7	E
10/02/2019	RIVIERA OPERATING LLC	RIVERSIDE ENERGY MICHIGAN LLC	STATE CALEDONIA ET AL C2-3	59401	ALCONA	CALEDONIA	3	28	N	7	E
10/02/2019	RIVIERA OPERATING LLC	RIVERSIDE ENERGY MICHIGAN LLC	HUBBARD ASSOCIATES A4-28	59404	ALCONA	ALCONA	28	28	N	7	E
10/02/2019	RIVIERA OPERATING LLC	RIVERSIDE ENERGY MICHIGAN LLC	STATE ALCONA ET AL B1-21	59405	ALCONA	ALCONA	21	28	N	7	E
10/02/2019	RIVIERA OPERATING LLC	RIVERSIDE ENERGY MICHIGAN LLC	KOWALSKI ET AL A3-5	59407	ALCONA	CALEDONIA	5	28	N	7	E
10/02/2019	RIVIERA OPERATING LLC	RIVERSIDE ENERGY MICHIGAN LLC	STATE HAWES-JURK B1-20	59433	ALCONA	HAWES	20	27	N	8	E
10/02/2019	RIVIERA OPERATING LLC	RIVERSIDE ENERGY MICHIGAN LLC	WEGHER A2-26	59434	ALCONA	HAWES	26	27	N	7	E
10/02/2019	RIVIERA OPERATING LLC	RIVERSIDE ENERGY MICHIGAN LLC	STATE HAWES-WAIBEL A3-19	59435	ALCONA	HAWES	19	27	N	8	E
10/02/2019	RIVIERA OPERATING LLC	RIVERSIDE ENERGY MICHIGAN LLC	STATE HAWES-BARCLAY C1-21	59484	ALCONA	HAWES	21	27	N	8	E
10/02/2019	RIVIERA OPERATING LLC	RIVERSIDE ENERGY MICHIGAN LLC	KOWALSKI ET AL C1-8	59571	ALCONA	CALEDONIA	8	28	N	8	E
10/02/2019	RIVIERA OPERATING LLC	RIVERSIDE ENERGY MICHIGAN LLC	DAHL ET AL D3-7	59577	ALCONA	CALEDONIA	7	28	N	8	E
10/02/2019	RIVIERA OPERATING LLC	RIVERSIDE ENERGY MICHIGAN LLC	STATE HAWES - STOCK D2-20	59592	ALCONA	HAWES	20	27	N	8	E
10/02/2019	RIVIERA OPERATING LLC	RIVERSIDE ENERGY MICHIGAN LLC	KLARICH ET AL B1-3	59594	ALCONA	CALEDONIA	3	28	N	6	E
10/02/2019	RIVIERA OPERATING LLC	RIVERSIDE ENERGY MICHIGAN LLC	STATE CALEDONIA D1-8	59868	ALCONA	CALEDONIA	8	28	N	7	E
10/02/2019	RIVIERA OPERATING LLC	RIVERSIDE ENERGY MICHIGAN LLC	STATE CALEDONIA & DIEZ B2-7	59869	ALCONA	CALEDONIA	7	28	N	7	E
10/02/2019	RIVIERA OPERATING LLC	RIVERSIDE ENERGY MICHIGAN LLC	STATE MITCHELL & OAKLAND HUNT CLUB A1-8	59937	ALCONA	MITCHELL	8	28	N	5	E
10/02/2019	RIVIERA OPERATING LLC	RIVERSIDE ENERGY MICHIGAN LLC	STATE MITCHELL & CHABOT C2-10	60199	ALCONA	MITCHELL	10	28	N	5	E
10/02/2019	RIVIERA OPERATING LLC	RIVERSIDE ENERGY MICHIGAN LLC	COSTER ET AL B2-6	60200	ALCONA	MITCHELL	6	28	N	5	E
10/02/2019	RIVIERA OPERATING LLC	RIVERSIDE ENERGY MICHIGAN LLC	SKIBA & OAKLAND HUNT CLUB C1-4	60203	ALCONA	MITCHELL	4	28	N	5	E
10/02/2019	RIVIERA OPERATING LLC	RIVERSIDE ENERGY MICHIGAN LLC	OAKLAND HUNT CLUB C4-6	60204	ALCONA	MITCHELL	6	28	N	5	E
10/02/2019	RIVIERA OPERATING LLC	RIVERSIDE ENERGY MICHIGAN LLC	OAKLAND HUNT CLUB C1-5	60205	ALCONA	MITCHELL	5	28	N	5	E
10/02/2019	RIVIERA OPERATING LLC	RIVERSIDE ENERGY MICHIGAN LLC	OAKLAND HUNT CLUB B1-5	60206	ALCONA	MITCHELL	5	28	N	5	E
10/03/2019	RIVERSIDE ENERGY MICHIGAN LLC	MUZYL OIL CORP	STATE GREENWOOD A4-4	58256	OSCODA	GREENWOOD	4	28	N	1	E
10/03/2019	RIVERSIDE ENERGY MICHIGAN LLC	MUZYL OIL CORP	TAYLOR B3-4	59281	OSCODA	GREENWOOD	4	28	N	1	E
10/03/2019	RIVIERA OPERATING LLC	RIVERSIDE ENERGY MICHIGAN LLC	TOWNSEND B1-20	48363	ALPENA	OSSINEKE	20	29	N	6	E
10/03/2019	RIVIERA OPERATING LLC	RIVERSIDE ENERGY MICHIGAN LLC	STATE OSSINEKE A3-26	48364	ALPENA	OSSINEKE	26	29	N	6	E
10/03/2019	RIVIERA OPERATING LLC	RIVERSIDE ENERGY MICHIGAN LLC	BADER D1-29	48442	ALPENA	OSSINEKE	29	29	N	6	E
10/03/2019	RIVIERA OPERATING LLC	RIVERSIDE ENERGY MICHIGAN LLC	STATE OSSINEKE A1-36	48489	ALPENA	OSSINEKE	36	29	N	6	E
10/03/2019	RIVIERA OPERATING LLC	RIVERSIDE ENERGY MICHIGAN LLC	BROAD A1-22	48499	ALPENA	OSSINEKE	22	29	N	5	E
10/03/2019	RIVIERA OPERATING LLC	RIVERSIDE ENERGY MICHIGAN LLC	BIANCHINI A1-33	48500	ALPENA	OSSINEKE	33	29	N	5	E
10/03/2019	RIVIERA OPERATING LLC	RIVERSIDE ENERGY MICHIGAN LLC	SADDLER C1-10	48984	ALPENA	OSSINEKE	10	29	N	6	E
10/03/2019	RIVIERA OPERATING LLC	RIVERSIDE ENERGY MICHIGAN LLC	STATE OSSINEKE B4-15	49048	ALPENA	OSSINEKE	15	29	N	6	E
10/03/2019	RIVIERA OPERATING LLC	RIVERSIDE ENERGY MICHIGAN LLC	STATE OSSINEKE B4-15	49048	ALPENA	OSSINEKE	15	29	N	6	E
10/03/2019	RIVIERA OPERATING LLC	RIVERSIDE ENERGY MICHIGAN LLC	STATE OSSINEKE B4-15	49048	ALPENA	OSSINEKE	15	29	N	6	E
10/03/2019	RIVIERA OPERATING LLC	RIVERSIDE ENERGY MICHIGAN LLC	STATE OSSINEKE B4-15	49048	ALPENA	OSSINEKE	15	29	N	6	E
10/03/2019	RIVIERA OPERATING LLC	RIVERSIDE ENERGY MICHIGAN LLC	STATE BRILEY B1-34	45389	MONTMORENCY	BRILEY	34	30	N	2	E
10/03/2019	RIVIERA OPERATING LLC	RIVERSIDE ENERGY MICHIGAN LLC	STATE BRILEY B3-32	45584	MONTMORENCY	BRILEY	32	30	N	2	E
10/03/2019	RIVIERA OPERATING LLC	RIVERSIDE ENERGY MICHIGAN LLC	BRILEY D2-28	46993	MONTMORENCY	BRILEY	28	30	N	2	E
10/03/2019	RIVIERA OPERATING LLC	RIVERSIDE ENERGY MICHIGAN LLC	BRILEY B1-28	46994	MONTMORENCY	BRILEY	28	30	N	2	E
10/03/2019	RIVIERA OPERATING LLC	RIVERSIDE ENERGY MICHIGAN LLC	BRILEY D1-27	46995	MONTMORENCY	BRILEY	27	30	N	2	E
10/03/2019	RIVIERA OPERATING LLC	RIVERSIDE ENERGY MICHIGAN LLC	STATE BRILEY C4-28	47021	MONTMORENCY	BRILEY	28	30	N	2	E
10/03/2019	RIVIERA OPERATING LLC	RIVERSIDE ENERGY MICHIGAN LLC	STATE BRILEY D2-33	47023	MONTMORENCY	BRILEY	33	30	N	2	E
10/03/2019	RIVIERA OPERATING LLC	RIVERSIDE ENERGY MICHIGAN LLC	STATE BRILEY D1-22	47084	MONTMORENCY	BRILEY	22	30	N	2	E
10/03/2019	RIVIERA OPERATING LLC	RIVERSIDE ENERGY MICHIGAN LLC	STATE BRILEY D3-22	47085	MONTMORENCY	BRILEY	22	30	N	2	E
10/03/2019	RIVIERA OPERATING LLC	RIVERSIDE ENERGY MICHIGAN LLC	BRILEY B3-34	47326	MONTMORENCY	BRILEY	34	30	N	2	E
10/03/2019	RIVIERA OPERATING LLC	RIVERSIDE ENERGY MICHIGAN LLC	STATE BRILEY B2-27	47407	MONTMORENCY	BRILEY	27	30	N	2	E
10/03/2019	RIVIERA OPERATING LLC	RIVERSIDE ENERGY MICHIGAN LLC	STATE BRILEY D4-29	47420	MONTMORENCY	BRILEY	29	30	N	2	E
10/03/2019	RIVIERA OPERATING LLC	RIVERSIDE ENERGY MICHIGAN LLC	STATE BRILEY & NAVARRE D2-21	48739	MONTMORENCY	BRILEY	21	30	N	2	E
10/03/2019	RIVIERA OPERATING LLC	RIVERSIDE ENERGY MICHIGAN LLC	BROOKER D4-21	48740	MONTMORENCY	BRILEY	21	30	N	2	E
10/03/2019	RIVIERA OPERATING LLC	RIVERSIDE ENERGY MICHIGAN LLC	STATE BRILEY D4-30	48795	MONTMORENCY	BRILEY	30	30	N	2	E
10/03/2019	RIVIERA OPERATING LLC	RIVERSIDE ENERGY MICHIGAN LLC	STATE BRILEY B3-28	48796	MONTMORENCY	BRILEY	28	30	N	2	E
10/03/2019	RIVIERA OPERATING LLC	RIVERSIDE ENERGY MICHIGAN LLC	STATE AVERY D2-35	48837	MONTMORENCY	AVERY	35	30	N	3	E
10/03/2019	RIVIERA OPERATING LLC	RIVERSIDE ENERGY MICHIGAN LLC	STATE BRILEY C2-34	48860	MONTMORENCY	BRILEY	34	30	N	2	E
10/03/2019	RIVIERA OPERATING LLC	RIVERSIDE ENERGY MICHIGAN LLC	STATE LOUD A2-2	50298	MONTMORENCY	LOUD	2	29	N	3	E
10/03/2019	RIVIERA OPERATING LLC	RIVERSIDE ENERGY MICHIGAN LLC	ROSEN MINERAL TRUST ET AL C3-1	53876	MONTMORENCY	ALBERT	1	29	N	1	E

Transfer Date	Previous Operator	New Operator	WellName	Permit	County	Township	Sec	Twp	TwpDir	Rng	RngDir
10/03/2019	RIVIERA OPERATING LLC	RIVERSIDE ENERGY MICHIGAN LLC	STATE ALBERT & PAFFI A1-13	54704	MONTMORENCY	ALBERT	13	29	N	1	E
10/03/2019	RIVIERA OPERATING LLC	RIVERSIDE ENERGY MICHIGAN LLC	ROSEN TRUST & KING B1-1	54726	MONTMORENCY	ALBERT	1	29	N	1	E
10/03/2019	RIVIERA OPERATING LLC	RIVERSIDE ENERGY MICHIGAN LLC	STATE ALBERT C3-11	55224	MONTMORENCY	ALBERT	11	29	N	2	E
10/03/2019	RIVIERA OPERATING LLC	RIVERSIDE ENERGY MICHIGAN LLC	WILSON A4-32	55555	MONTMORENCY	ALBERT	32	29	N	1	E
10/03/2019	RIVIERA OPERATING LLC	RIVERSIDE ENERGY MICHIGAN LLC	PAFFI ET AL C2-11	55644	MONTMORENCY	ALBERT	11	29	N	1	E
10/03/2019	RIVIERA OPERATING LLC	RIVERSIDE ENERGY MICHIGAN LLC	STATE ALBERT & SMITH D3-2	55647	MONTMORENCY	ALBERT	2	29	N	1	E
10/03/2019	RIVIERA OPERATING LLC	RIVERSIDE ENERGY MICHIGAN LLC	SAWYER ET AL D1-2	55648	MONTMORENCY	ALBERT	2	29	N	1	E
10/03/2019	RIVIERA OPERATING LLC	RIVERSIDE ENERGY MICHIGAN LLC	DICHTEL A1-12	55731	MONTMORENCY	ALBERT	12	29	N	1	E
10/03/2019	RIVIERA OPERATING LLC	RIVERSIDE ENERGY MICHIGAN LLC	STATE ALBERT A2-10	55739	MONTMORENCY	ALBERT	10	29	N	1	E
10/03/2019	RIVIERA OPERATING LLC	RIVERSIDE ENERGY MICHIGAN LLC	STATE ALBERT B1-10	55740	MONTMORENCY	ALBERT	10	29	N	1	E
10/03/2019	RIVIERA OPERATING LLC	RIVERSIDE ENERGY MICHIGAN LLC	ARMSTRONG & KING B2-2	55923	MONTMORENCY	ALBERT	2	29	N	1	E
10/03/2019	RIVIERA OPERATING LLC	RIVERSIDE ENERGY MICHIGAN LLC	NEWELL ET AL C4-3	56478	MONTMORENCY	ALBERT	3	29	N	1	E
10/03/2019	RIVIERA OPERATING LLC	RIVERSIDE ENERGY MICHIGAN LLC	STATE ALBERT D3-3	56479	MONTMORENCY	ALBERT	3	29	N	1	E
10/03/2019	RIVIERA OPERATING LLC	RIVERSIDE ENERGY MICHIGAN LLC	VAN DORN ET AL D3-10	56480	MONTMORENCY	ALBERT	10	29	N	1	E
10/03/2019	RIVIERA OPERATING LLC	RIVERSIDE ENERGY MICHIGAN LLC	STATE BRILEY D3-34 HD	57614	MONTMORENCY	BRILEY	33	30	N	2	E
10/03/2019	RIVIERA OPERATING LLC	RIVERSIDE ENERGY MICHIGAN LLC	STATE BRILEY D3-34 HD	57614	MONTMORENCY	BRILEY	33	30	N	2	E
10/03/2019	RIVIERA OPERATING LLC	RIVERSIDE ENERGY MICHIGAN LLC	STATE BRILEY TWIN D1-22	57859	MONTMORENCY	BRILEY	22	30	N	2	E
10/03/2019	RIVIERA OPERATING LLC	RIVERSIDE ENERGY MICHIGAN LLC	STATE BRILEY TWIN D1-22	57859	MONTMORENCY	BRILEY	22	30	N	2	E
10/03/2019	RIVIERA OPERATING LLC	RIVERSIDE ENERGY MICHIGAN LLC	STATE GREENWOOD B2-5	45846	OSCODA	GREENWOOD	5	28	N	1	E
10/03/2019	RIVIERA OPERATING LLC	RIVERSIDE ENERGY MICHIGAN LLC	STATE GREENWOOD B2-6	45847	OSCODA	GREENWOOD	6	28	N	1	E
10/03/2019	RIVIERA OPERATING LLC	RIVERSIDE ENERGY MICHIGAN LLC	NORWAY HUNT CLUB A1-13	45977	OSCODA	CLINTON	13	28	N	4	E
10/03/2019	RIVIERA OPERATING LLC	RIVERSIDE ENERGY MICHIGAN LLC	STATE GREENWOOD 3-7	46377	OSCODA	GREENWOOD	7	28	N	1	E
10/03/2019	RIVIERA OPERATING LLC	RIVERSIDE ENERGY MICHIGAN LLC	MARTIN D4-5	47111	OSCODA	GREENWOOD	5	28	N	1	E
10/03/2019	RIVIERA OPERATING LLC	RIVERSIDE ENERGY MICHIGAN LLC	WALTER MACHINE B2-8	47112	OSCODA	GREENWOOD	8	28	N	1	E
10/03/2019	RIVIERA OPERATING LLC	RIVERSIDE ENERGY MICHIGAN LLC	WALTER MACHINE B4-8	47113	OSCODA	GREENWOOD	8	28	N	1	E
10/03/2019	RIVIERA OPERATING LLC	RIVERSIDE ENERGY MICHIGAN LLC	NEUMANN D4-8	47115	OSCODA	GREENWOOD	8	28	N	1	E
10/03/2019	RIVIERA OPERATING LLC	RIVERSIDE ENERGY MICHIGAN LLC	STATE GREENWOOD D1-5	47142	OSCODA	GREENWOOD	5	28	N	1	E
10/03/2019	RIVIERA OPERATING LLC	RIVERSIDE ENERGY MICHIGAN LLC	STATE GREENWOOD D1-8	47144	OSCODA	GREENWOOD	8	28	N	1	E
10/03/2019	RIVIERA OPERATING LLC	RIVERSIDE ENERGY MICHIGAN LLC	STATE GREENWOOD C4-7	47175	OSCODA	GREENWOOD	7	28	N	1	E
10/03/2019	RIVIERA OPERATING LLC	RIVERSIDE ENERGY MICHIGAN LLC	BOYCHUCK B4-5	57742	OSCODA	GREENWOOD	5	28	N	1	E
10/03/2019	RIVIERA OPERATING LLC	RIVERSIDE ENERGY MICHIGAN LLC	FRANKE D2-26	42757	OTSEGO	CHARLTON	26	30	N	1	W
10/03/2019	RIVIERA OPERATING LLC	RIVERSIDE ENERGY MICHIGAN LLC	TOLLMAN C2-27	42758	OTSEGO	CHARLTON	27	30	N	1	W
10/03/2019	RIVIERA OPERATING LLC	RIVERSIDE ENERGY MICHIGAN LLC	FRANKE C1-26	42759	OTSEGO	CHARLTON	26	30	N	1	W
10/03/2019	RIVIERA OPERATING LLC	RIVERSIDE ENERGY MICHIGAN LLC	KOBYLCZAK D3-27	42760	OTSEGO	CHARLTON	27	30	N	1	W
10/03/2019	RIVIERA OPERATING LLC	RIVERSIDE ENERGY MICHIGAN LLC	STATE CHARLTON B1-36	42761	OTSEGO	CHARLTON	36	30	N	1	W
10/03/2019	RIVIERA OPERATING LLC	RIVERSIDE ENERGY MICHIGAN LLC	STATE CHARLTON B2-36	42790	OTSEGO	CHARLTON	36	30	N	1	W
10/03/2019	RIVIERA OPERATING LLC	RIVERSIDE ENERGY MICHIGAN LLC	STATE CHARLTON B2-36	42790	OTSEGO	CHARLTON	36	30	N	1	W
10/03/2019	RIVIERA OPERATING LLC	RIVERSIDE ENERGY MICHIGAN LLC	STATE CHARLTON B1-36	42761	OTSEGO	CHARLTON	36	30	N	1	W
10/03/2019	RIVIERA OPERATING LLC	RIVERSIDE ENERGY MICHIGAN LLC	KOBYLCZAK D3-27	42760	OTSEGO	CHARLTON	27	30	N	1	W
10/03/2019	RIVIERA OPERATING LLC	RIVERSIDE ENERGY MICHIGAN LLC	FRANKE D2-26	42757	OTSEGO	CHARLTON	26	30	N	1	W
10/03/2019	RIVIERA OPERATING LLC	RIVERSIDE ENERGY MICHIGAN LLC	KOBYLCZAK D2-22	45796	OTSEGO	CHARLTON	22	30	N	1	W
10/03/2019	RIVIERA OPERATING LLC	RIVERSIDE ENERGY MICHIGAN LLC	STANGOR LAND COMPANY A1-25	45797	OTSEGO	CHARLTON	25	30	N	1	W
10/03/2019	RIVIERA OPERATING LLC	RIVERSIDE ENERGY MICHIGAN LLC	STANGOR LAND COMPANY A2-25	45798	OTSEGO	CHARLTON	25	30	N	1	W
10/03/2019	RIVIERA OPERATING LLC	RIVERSIDE ENERGY MICHIGAN LLC	HANSEN D2-23	45799	OTSEGO	CHARLTON	23	30	N	1	W
10/03/2019	RIVIERA OPERATING LLC	RIVERSIDE ENERGY MICHIGAN LLC	HANSEN C1-23	45800	OTSEGO	CHARLTON	23	30	N	1	W
10/03/2019	RIVIERA OPERATING LLC	RIVERSIDE ENERGY MICHIGAN LLC	MOORE C3-18	50053	ALCONA	CALEDONIA	18	28	N	8	E
10/03/2019	RIVIERA OPERATING LLC	RIVERSIDE ENERGY MICHIGAN LLC	WILL D1-18	50054	ALCONA	CALEDONIA	18	28	N	8	E
10/03/2019	RIVIERA OPERATING LLC	RIVERSIDE ENERGY MICHIGAN LLC	HANSEN, ET AL A4-20	50055	ALCONA	ALCONA	20	28	N	8	E
10/03/2019	RIVIERA OPERATING LLC	RIVERSIDE ENERGY MICHIGAN LLC	KOWALSKI D3-2	50374	ALCONA	CALEDONIA	2	28	N	7	E
10/03/2019	RIVIERA OPERATING LLC	RIVERSIDE ENERGY MICHIGAN LLC	PAULSON A4-17	50375	ALCONA	CALEDONIA	17	28	N	8	E
10/03/2019	RIVIERA OPERATING LLC	RIVERSIDE ENERGY MICHIGAN LLC	GEROW A1-12	50394	ALCONA	CALEDONIA	12	28	N	7	E
10/03/2019	RIVIERA OPERATING LLC	RIVERSIDE ENERGY MICHIGAN LLC	STATE MITCHELL & WHITE B1-2	50707	ALCONA	MITCHELL	2	28	N	5	E
10/03/2019	RIVIERA OPERATING LLC	RIVERSIDE ENERGY MICHIGAN LLC	SURE HORN CLUB C2-4	50709	ALCONA	MITCHELL	4	28	N	5	E
10/03/2019	RIVIERA OPERATING LLC	RIVERSIDE ENERGY MICHIGAN LLC	OAKLAND HUNT CLUB A1-5	50710	ALCONA	MITCHELL	5	28	N	5	E
10/03/2019	RIVIERA OPERATING LLC	RIVERSIDE ENERGY MICHIGAN LLC	COSTER & YOUNG, ET AL A1-6	50711	ALCONA	MITCHELL	6	28	N	5	E
10/03/2019	RIVIERA OPERATING LLC	RIVERSIDE ENERGY MICHIGAN LLC	OAKLAND HUNT CLUB A3-6	50712	ALCONA	MITCHELL	6	28	N	5	E
10/03/2019	RIVIERA OPERATING LLC	RIVERSIDE ENERGY MICHIGAN LLC	OAKLAND HUNT CLUB A3-5	50769	ALCONA	MITCHELL	5	28	N	5	E
10/03/2019	RIVIERA OPERATING LLC	RIVERSIDE ENERGY MICHIGAN LLC	OAKLAND HUNT CLUB B2-5	50770	ALCONA	MITCHELL	5	28	N	5	E
10/03/2019	RIVIERA OPERATING LLC	RIVERSIDE ENERGY MICHIGAN LLC	OAKLAND HUNT CLUB D4-5	50771	ALCONA	MITCHELL	5	28	N	5	E
10/03/2019	RIVIERA OPERATING LLC	RIVERSIDE ENERGY MICHIGAN LLC	OAKLAND HUNT CLUB C3-6	50772	ALCONA	MITCHELL	6	28	N	5	E
10/03/2019	RIVIERA OPERATING LLC	RIVERSIDE ENERGY MICHIGAN LLC	WERNER B3-11	50783	ALCONA	CALEDONIA	11	28	N	7	E
10/03/2019	RIVIERA OPERATING LLC	RIVERSIDE ENERGY MICHIGAN LLC	JACK B1-11	50784	ALCONA	CALEDONIA	11	28	N	7	E
10/03/2019	RIVIERA OPERATING LLC	RIVERSIDE ENERGY MICHIGAN LLC	BADER & BUCK RIDGE CLUB D4-4	50797	ALCONA	MITCHELL	4	28	N	5	E

Transfer Date	Previous Operator	New Operator	WellName	Permit	County	Township	Sec	Twp	TwpDir	Rng	RngDir
10/03/2019	RIVIERA OPERATING LLC	RIVERSIDE ENERGY MICHIGAN LLC	STATE MITCHELL A3-3	50827	ALCONA	MITCHELL	3	28	N	5	E
10/03/2019	RIVIERA OPERATING LLC	RIVERSIDE ENERGY MICHIGAN LLC	STATE MITCHELL A3-4	50828	ALCONA	MITCHELL	4	28	N	5	E
10/03/2019	RIVIERA OPERATING LLC	RIVERSIDE ENERGY MICHIGAN LLC	STATE MITCHELL & GETTEL C3-3	50836	ALCONA	MITCHELL	3	28	N	5	E
10/03/2019	RIVIERA OPERATING LLC	RIVERSIDE ENERGY MICHIGAN LLC	STATE MITCHELL B4-4	50933	ALCONA	MITCHELL	4	28	N	5	E
10/03/2019	RIVIERA OPERATING LLC	RIVERSIDE ENERGY MICHIGAN LLC	STATE CALEDONIA & ZULL & YOUNGER C2-2	51272	ALCONA	CALEDONIA	2	28	N	7	E
10/03/2019	RIVIERA OPERATING LLC	RIVERSIDE ENERGY MICHIGAN LLC	SCHULTZ A4-6	51364	ALCONA	CALEDONIA	6	28	N	7	E
10/03/2019	RIVIERA OPERATING LLC	RIVERSIDE ENERGY MICHIGAN LLC	ENGBERG D1-5	51365	ALCONA	CALEDONIA	5	28	N	7	E
10/03/2019	RIVIERA OPERATING LLC	RIVERSIDE ENERGY MICHIGAN LLC	CASCADDEN C4-6	51366	ALCONA	CALEDONIA	6	28	N	7	E
10/03/2019	RIVIERA OPERATING LLC	RIVERSIDE ENERGY MICHIGAN LLC	STATE CALEDONIA & PEREGOY A3-10	51367	ALCONA	CALEDONIA	10	28	N	7	E
10/03/2019	RIVIERA OPERATING LLC	RIVERSIDE ENERGY MICHIGAN LLC	STATE MITCHELL A2-3	51445	ALCONA	MITCHELL	3	28	N	5	E
10/03/2019	RIVIERA OPERATING LLC	RIVERSIDE ENERGY MICHIGAN LLC	DRY HOLE CLUB B1-7	51497	ALCONA	CALEDONIA	7	28	N	7	E
10/03/2019	RIVIERA OPERATING LLC	RIVERSIDE ENERGY MICHIGAN LLC	DRY HOLE CLUB A3-7	51498	ALCONA	CALEDONIA	7	28	N	7	E
10/03/2019	RIVIERA OPERATING LLC	RIVERSIDE ENERGY MICHIGAN LLC	LOST LAKE WOODS ASSOC. ET AL D4-31	51819	ALCONA	ALCONA	31	28	N	8	E
10/03/2019	RIVIERA OPERATING LLC	RIVERSIDE ENERGY MICHIGAN LLC	LOST LAKE WOODS ASSOCIATION D1-15	51821	ALCONA	CALEDONIA	15	28	N	8	E
10/03/2019	RIVIERA OPERATING LLC	RIVERSIDE ENERGY MICHIGAN LLC	LOST LAKE WOODS ASSOC. ET AL A4-29	51826	ALCONA	ALCONA	29	28	N	8	E
10/03/2019	RIVIERA OPERATING LLC	RIVERSIDE ENERGY MICHIGAN LLC	LOST LAKE WOODS ASSOC. ET AL C3-31	51827	ALCONA	ALCONA	31	28	N	8	E
10/03/2019	RIVIERA OPERATING LLC	RIVERSIDE ENERGY MICHIGAN LLC	LOST LAKE WOODS ASSOC. ET AL C3-29	51828	ALCONA	ALCONA	29	28	N	8	E
10/03/2019	RIVIERA OPERATING LLC	RIVERSIDE ENERGY MICHIGAN LLC	LOST LAKE WOODS ASSOC. ET AL D1-28	51829	ALCONA	ALCONA	28	28	N	8	E
10/03/2019	RIVIERA OPERATING LLC	RIVERSIDE ENERGY MICHIGAN LLC	LOST LAKE WOODS ASSOC. ET AL B2-28	51830	ALCONA	ALCONA	28	28	N	8	E
10/03/2019	RIVIERA OPERATING LLC	RIVERSIDE ENERGY MICHIGAN LLC	LOST LAKE WOODS ASSOC. ET AL A3-28	51831	ALCONA	ALCONA	28	28	N	8	E
10/03/2019	RIVIERA OPERATING LLC	RIVERSIDE ENERGY MICHIGAN LLC	LOST LAKE WOODS ASSOC. ET AL B3-33	51833	ALCONA	ALCONA	33	28	N	8	E
10/03/2019	RIVIERA OPERATING LLC	RIVERSIDE ENERGY MICHIGAN LLC	LOST LAKE WOODS ASSOC. ET AL A4-33	51834	ALCONA	ALCONA	33	28	N	8	E
10/03/2019	RIVIERA OPERATING LLC	RIVERSIDE ENERGY MICHIGAN LLC	LOST LAKE WOODS ASSOC. ET AL A1-31	51842	ALCONA	ALCONA	31	28	N	8	E
10/03/2019	RIVIERA OPERATING LLC	RIVERSIDE ENERGY MICHIGAN LLC	CORNELIUS D3-30	53214	ALCONA	ALCONA	30	28	N	8	E
10/03/2019	RIVIERA OPERATING LLC	RIVERSIDE ENERGY MICHIGAN LLC	STATE CALEDONIA D2-11	53221	ALCONA	CALEDONIA	11	28	N	7	E
10/03/2019	RIVIERA OPERATING LLC	RIVERSIDE ENERGY MICHIGAN LLC	BUCK AND HENDRICKS ET AL A1-29	53222	ALCONA	ALCONA	29	28	N	8	E
10/03/2019	RIVIERA OPERATING LLC	RIVERSIDE ENERGY MICHIGAN LLC	SHATTUCK D2-29	53223	ALCONA	ALCONA	29	28	N	8	E
10/03/2019	RIVIERA OPERATING LLC	RIVERSIDE ENERGY MICHIGAN LLC	WILL B3-29	53238	ALCONA	ALCONA	29	28	N	8	E
10/03/2019	RIVIERA OPERATING LLC	RIVERSIDE ENERGY MICHIGAN LLC	ULCH & HYLAND B1-11	53483	ALCONA	MITCHELL	11	28	N	5	E
10/03/2019	RIVIERA OPERATING LLC	RIVERSIDE ENERGY MICHIGAN LLC	STATE MITCHELL & ULCH B4-11	53484	ALCONA	MITCHELL	11	28	N	5	E
10/03/2019	RIVIERA OPERATING LLC	RIVERSIDE ENERGY MICHIGAN LLC	CHABOT & GEE ET AL B1-10	53485	ALCONA	MITCHELL	10	28	N	5	E
10/03/2019	RIVIERA OPERATING LLC	RIVERSIDE ENERGY MICHIGAN LLC	ERNST D4-1	53494	ALCONA	MITCHELL	1	28	N	5	E
10/03/2019	RIVIERA OPERATING LLC	RIVERSIDE ENERGY MICHIGAN LLC	INDIAN CREEK RANCH A2-12	53495	ALCONA	MITCHELL	12	28	N	5	E
10/03/2019	RIVIERA OPERATING LLC	RIVERSIDE ENERGY MICHIGAN LLC	INDIAN CREEK RANCH D3-2	53496	ALCONA	MITCHELL	2	28	N	5	E
10/03/2019	RIVIERA OPERATING LLC	RIVERSIDE ENERGY MICHIGAN LLC	LOST LAKE WOODS ET AL D1-33	59447	ALCONA	ALCONA	33	28	N	8	E
10/03/2019	RIVIERA OPERATING LLC	RIVERSIDE ENERGY MICHIGAN LLC	STATE MITCHELL ET AL B2-9	60201	ALCONA	MITCHELL	9	28	N	5	E
10/03/2019	RIVIERA OPERATING LLC	RIVERSIDE ENERGY MICHIGAN LLC	STATE MITCHELL A3-8	60202	ALCONA	MITCHELL	8	28	N	5	E
10/03/2019	RIVIERA OPERATING LLC	RIVERSIDE ENERGY MICHIGAN LLC	STATE OSSINEKE B4-15	49048	ALPENA	OSSINEKE	15	29	N	6	E
10/03/2019	RIVIERA OPERATING LLC	RIVERSIDE ENERGY MICHIGAN LLC	STATE OSSINEKE B4-15	49048	ALPENA	OSSINEKE	15	29	N	6	E
10/03/2019	RIVIERA OPERATING LLC	RIVERSIDE ENERGY MICHIGAN LLC	STATE OSSINEKE B4-15	49048	ALPENA	OSSINEKE	15	29	N	6	E
10/03/2019	RIVIERA OPERATING LLC	RIVERSIDE ENERGY MICHIGAN LLC	STATE OSSINEKE B4-15	49048	ALPENA	OSSINEKE	15	29	N	6	E
10/04/2019	BUCKY LTD	BAILER AND DESHAW	BENCHLEY 2-19	38865	ARENAC	DEEP RIVER	19	19	N	4	E
10/04/2019	BUCKY LTD	BAILER AND DESHAW	ACKERMAN 1-29	34163	ARENAC	DEEP RIVER	29	19	N	4	E
10/04/2019	BUCKY LTD	BAILER AND DESHAW	MILLER LOUIE 1-19	34958	ARENAC	DEEP RIVER	19	19	N	4	E
10/04/2019	BUCKY LTD	BAILER AND DESHAW	BENCHLEY 2-30	38943	ARENAC	DEEP RIVER	30	19	N	4	E
10/04/2019	BUCKY LTD	BAILER AND DESHAW	MILNE, ARTHUR 1-19	40062	ARENAC	DEEP RIVER	19	19	N	4	E
10/04/2019	BUCKY LTD	BAILER AND DESHAW	MARSH, CLARA 2-24	40170	ARENAC	ADAMS	24	19	N	3	E
10/04/2019	RIVERSIDE ENERGY MICHIGAN LLC	MUZYL OIL CORP	JUSZCZYK D2-33	58246	MONTMORENCY	ALBERT	33	29	N	1	E
10/04/2019	RIVERSIDE ENERGY MICHIGAN LLC	MUZYL OIL CORP	CHAPOTON B1-33	59403	MONTMORENCY	ALBERT	33	29	N	1	E
10/04/2019	RIVERSIDE ENERGY MICHIGAN LLC	MUZYL OIL CORP	EWING C1-33	58234	MONTMORENCY	ALBERT	33	29	N	1	E
10/04/2019	RIVERSIDE ENERGY MICHIGAN LLC	MUZYL OIL CORP	RENDER D4-33	58247	MONTMORENCY	ALBERT	33	29	N	1	E
10/04/2019	RIVERSIDE ENERGY MICHIGAN LLC	MUZYL OIL CORP	EWING C1-33 SWD	58441	MONTMORENCY	ALBERT	33	29	N	1	E
10/04/2019	RIVERSIDE ENERGY MICHIGAN LLC	MUZYL OIL CORP	CHAPOTON B3-33 HD1	59973	MONTMORENCY	ALBERT	33	29	N	1	E
10/04/2019	RIVIERA OPERATING LLC	RIVERSIDE ENERGY MICHIGAN LLC	MORRISON A2-11	58723	ANTRIM	TORCH LAKE	11	30	N	9	W
10/04/2019	RIVIERA OPERATING LLC	RIVERSIDE ENERGY MICHIGAN LLC	STATE BRILEY B1-26	47019	MONTMORENCY	BRILEY	26	30	N	2	E
10/04/2019	RIVIERA OPERATING LLC	RIVERSIDE ENERGY MICHIGAN LLC	STATE BRILEY D1-26	47020	MONTMORENCY	BRILEY	26	30	N	2	E
10/04/2019	RIVIERA OPERATING LLC	RIVERSIDE ENERGY MICHIGAN LLC	STATE BRILEY B3-27	47422	MONTMORENCY	BRILEY	27	30	N	2	E
10/04/2019	RIVIERA OPERATING LLC	RIVERSIDE ENERGY MICHIGAN LLC	STATE BRILEY D3-27	47425	MONTMORENCY	BRILEY	27	30	N	2	E
10/04/2019	RIVIERA OPERATING LLC	RIVERSIDE ENERGY MICHIGAN LLC	STATE BRILEY D3-26	48140	MONTMORENCY	BRILEY	26	30	N	2	E
10/04/2019	RIVIERA OPERATING LLC	RIVERSIDE ENERGY MICHIGAN LLC	STATE BRILEY A3-26	48141	MONTMORENCY	BRILEY	26	30	N	2	E
10/04/2019	RIVIERA OPERATING LLC	RIVERSIDE ENERGY MICHIGAN LLC	WEBORG & KLEIN A4-3	50534	MONTMORENCY	LOUD	3	29	N	3	E
10/04/2019	RIVIERA OPERATING LLC	RIVERSIDE ENERGY MICHIGAN LLC	STATE AVERY A3-36	50750	MONTMORENCY	AVERY	36	30	N	3	E
10/04/2019	RIVIERA OPERATING LLC	RIVERSIDE ENERGY MICHIGAN LLC	DEROUCHE, ET AL A3-35	50751	MONTMORENCY	AVERY	35	30	N	3	E
10/04/2019	RIVIERA OPERATING LLC	RIVERSIDE ENERGY MICHIGAN LLC	STATE AVERY C4-35	50752	MONTMORENCY	AVERY	35	30	N	3	E

Transfer Date	Previous Operator	New Operator	WellName	Permit	County	Township	Sec	Twp	TwpDir	Rng	RngDir
10/04/2019	RIVIERA OPERATING LLC	RIVERSIDE ENERGY MICHIGAN LLC	STATE LOUD & WECK A3-2	50754	MONTMORENCY	LOUD	2	29	N	3	E
10/04/2019	RIVIERA OPERATING LLC	RIVERSIDE ENERGY MICHIGAN LLC	STATE AVERY & MITCHELL A1-36	50781	MONTMORENCY	AVERY	36	30	N	3	E
10/04/2019	RIVIERA OPERATING LLC	RIVERSIDE ENERGY MICHIGAN LLC	STATE AVERY A2-35	50860	MONTMORENCY	AVERY	35	30	N	3	E
10/04/2019	RIVIERA OPERATING LLC	RIVERSIDE ENERGY MICHIGAN LLC	STATE ALBERT A1-13	53507	MONTMORENCY	ALBERT	13	29	N	2	E
10/04/2019	RIVIERA OPERATING LLC	RIVERSIDE ENERGY MICHIGAN LLC	STATE ALBERT D1-13	53508	MONTMORENCY	ALBERT	13	29	N	2	E
10/04/2019	RIVIERA OPERATING LLC	RIVERSIDE ENERGY MICHIGAN LLC	STATE ALBERT B1-11	53524	MONTMORENCY	ALBERT	11	29	N	2	E
10/04/2019	RIVIERA OPERATING LLC	RIVERSIDE ENERGY MICHIGAN LLC	STATE BRILEY & HEPPNER B2-26 HD	53536	MONTMORENCY	BRILEY	26	30	N	2	E
10/04/2019	RIVIERA OPERATING LLC	RIVERSIDE ENERGY MICHIGAN LLC	STATE BRILEY & HEPPNER B2-26 HD	53536	MONTMORENCY	BRILEY	26	30	N	2	E
10/04/2019	RIVIERA OPERATING LLC	RIVERSIDE ENERGY MICHIGAN LLC	STATE BRILEY & HEPPNER B2-26 HD	53536	MONTMORENCY	BRILEY	26	30	N	2	E
10/04/2019	RIVIERA OPERATING LLC	RIVERSIDE ENERGY MICHIGAN LLC	STATE BRILEY B3-33	53604	MONTMORENCY	BRILEY	33	30	N	2	E
10/04/2019	RIVIERA OPERATING LLC	RIVERSIDE ENERGY MICHIGAN LLC	STATE BRILEY B4-23	53605	MONTMORENCY	BRILEY	23	30	N	2	E
10/04/2019	RIVIERA OPERATING LLC	RIVERSIDE ENERGY MICHIGAN LLC	STATE LOUD & USA C1-5	53608	MONTMORENCY	LOUD	5	29	N	3	E
10/04/2019	RIVIERA OPERATING LLC	RIVERSIDE ENERGY MICHIGAN LLC	LOCKWOOD LAKE RANCH A2-13	53618	MONTMORENCY	LOUD	13	29	N	3	E
10/04/2019	RIVIERA OPERATING LLC	RIVERSIDE ENERGY MICHIGAN LLC	BLUE LAKE CLUB C1-22	53620	MONTMORENCY	LOUD	22	29	N	3	E
10/04/2019	RIVIERA OPERATING LLC	RIVERSIDE ENERGY MICHIGAN LLC	STATE LOUD & BLUE LAKE D3-22	53621	MONTMORENCY	LOUD	22	29	N	3	E
10/04/2019	RIVIERA OPERATING LLC	RIVERSIDE ENERGY MICHIGAN LLC	STATE LOUD & SOHN LINEN A4-10	53632	MONTMORENCY	LOUD	10	29	N	3	E
10/04/2019	RIVIERA OPERATING LLC	RIVERSIDE ENERGY MICHIGAN LLC	STATE LOUD & BENAC C4-1	53633	MONTMORENCY	LOUD	1	29	N	3	E
10/04/2019	RIVIERA OPERATING LLC	RIVERSIDE ENERGY MICHIGAN LLC	STATE LOUD B3-3	53641	MONTMORENCY	LOUD	3	29	N	3	E
10/04/2019	RIVIERA OPERATING LLC	RIVERSIDE ENERGY MICHIGAN LLC	TERRA ENERGY ET AL D4-33	53642	MONTMORENCY	BRILEY	33	30	N	2	E
10/04/2019	RIVIERA OPERATING LLC	RIVERSIDE ENERGY MICHIGAN LLC	RIGATO & ERNST B1-34	53877	MONTMORENCY	LOUD	34	29	N	3	E
10/04/2019	RIVIERA OPERATING LLC	RIVERSIDE ENERGY MICHIGAN LLC	STATE ALBERT C4-12	53916	MONTMORENCY	ALBERT	12	29	N	2	E
10/04/2019	RIVIERA OPERATING LLC	RIVERSIDE ENERGY MICHIGAN LLC	STATE ALBERT & WEBER C4-13	53948	MONTMORENCY	ALBERT	13	29	N	2	E
10/04/2019	RIVIERA OPERATING LLC	RIVERSIDE ENERGY MICHIGAN LLC	STATE ALBERT D3-32	54610	MONTMORENCY	ALBERT	32	29	N	1	E
10/04/2019	RIVIERA OPERATING LLC	RIVERSIDE ENERGY MICHIGAN LLC	JANSMA A2-18	54703	MONTMORENCY	ALBERT	18	29	N	2	E
10/04/2019	RIVIERA OPERATING LLC	RIVERSIDE ENERGY MICHIGAN LLC	GHLARDI & JANSMA A4-13	54705	MONTMORENCY	ALBERT	13	29	N	1	E
10/04/2019	RIVIERA OPERATING LLC	RIVERSIDE ENERGY MICHIGAN LLC	STATE LOUD A2-36	54841	MONTMORENCY	LOUD	36	29	N	3	E
10/04/2019	RIVIERA OPERATING LLC	RIVERSIDE ENERGY MICHIGAN LLC	STATE LOUD & FRYE B4-25	55218	MONTMORENCY	LOUD	25	29	N	3	E
10/04/2019	RIVIERA OPERATING LLC	RIVERSIDE ENERGY MICHIGAN LLC	HAYES & HEPPNER C2-25	55219	MONTMORENCY	LOUD	25	29	N	3	E
10/04/2019	RIVIERA OPERATING LLC	RIVERSIDE ENERGY MICHIGAN LLC	STATE ALBERT C3-13	55225	MONTMORENCY	ALBERT	13	29	N	2	E
10/04/2019	RIVIERA OPERATING LLC	RIVERSIDE ENERGY MICHIGAN LLC	STATE BRILEY A4-27	55272	MONTMORENCY	BRILEY	27	30	N	2	E
10/04/2019	RIVIERA OPERATING LLC	RIVERSIDE ENERGY MICHIGAN LLC	STATE BRILEY C4-27	55273	MONTMORENCY	BRILEY	27	30	N	2	E
10/04/2019	RIVIERA OPERATING LLC	RIVERSIDE ENERGY MICHIGAN LLC	STATE BRILEY A3-32	55281	MONTMORENCY	BRILEY	32	30	N	2	E
10/04/2019	RIVIERA OPERATING LLC	RIVERSIDE ENERGY MICHIGAN LLC	GUIMOND ET AL C3-9	55305	MONTMORENCY	LOUD	9	29	N	3	E
10/04/2019	RIVIERA OPERATING LLC	RIVERSIDE ENERGY MICHIGAN LLC	VAN OCHTEN ET AL B4-15	55308	MONTMORENCY	LOUD	15	29	N	3	E
10/04/2019	RIVIERA OPERATING LLC	RIVERSIDE ENERGY MICHIGAN LLC	STATE ALBERT B4-11	55319	MONTMORENCY	ALBERT	11	29	N	2	E
10/04/2019	RIVIERA OPERATING LLC	RIVERSIDE ENERGY MICHIGAN LLC	STATE LOUD B2-23	56553	MONTMORENCY	LOUD	23	29	N	3	E
10/04/2019	RIVIERA OPERATING LLC	RIVERSIDE ENERGY MICHIGAN LLC	STATE LOUD B2-23	56553	MONTMORENCY	LOUD	23	29	N	3	E
10/04/2019	RIVIERA OPERATING LLC	RIVERSIDE ENERGY MICHIGAN LLC	STATE LOUD B2-23	56553	MONTMORENCY	LOUD	23	29	N	3	E
10/04/2019	RIVIERA OPERATING LLC	RIVERSIDE ENERGY MICHIGAN LLC	STATE BRILEY TWIN B1-26	57865	MONTMORENCY	BRILEY	26	30	N	2	E
10/04/2019	RIVIERA OPERATING LLC	RIVERSIDE ENERGY MICHIGAN LLC	STATE BRILEY TWIN B1-26	57865	MONTMORENCY	BRILEY	26	30	N	2	E
10/04/2019	RIVIERA OPERATING LLC	RIVERSIDE ENERGY MICHIGAN LLC	STATE BRILEY TWIN B1-26	57865	MONTMORENCY	BRILEY	26	30	N	2	E
10/04/2019	RIVIERA OPERATING LLC	RIVERSIDE ENERGY MICHIGAN LLC	STATE BRILEY TWIN D3-27	57867	MONTMORENCY	BRILEY	27	30	N	2	E
10/04/2019	RIVIERA OPERATING LLC	RIVERSIDE ENERGY MICHIGAN LLC	STATE BRILEY TWIN D3-27	57867	MONTMORENCY	BRILEY	27	30	N	2	E
10/04/2019	RIVIERA OPERATING LLC	RIVERSIDE ENERGY MICHIGAN LLC	STATE BRILEY TWIN D3-27	57867	MONTMORENCY	BRILEY	27	30	N	2	E
10/04/2019	RIVIERA OPERATING LLC	RIVERSIDE ENERGY MICHIGAN LLC	ZEIDLER D4-26	42290	OTSEGO	CHARLTON	26	30	N	1	W
10/04/2019	RIVIERA OPERATING LLC	RIVERSIDE ENERGY MICHIGAN LLC	ZEIDLER D4-26	42290	OTSEGO	CHARLTON	26	30	N	1	W
10/04/2019	RIVIERA OPERATING LLC	RIVERSIDE ENERGY MICHIGAN LLC	VON REIS B4-34	45065	OTSEGO	CHARLTON	34	31	N	1	W
10/04/2019	RIVIERA OPERATING LLC	RIVERSIDE ENERGY MICHIGAN LLC	MARSTRAND B1-34	44426	OTSEGO	CHARLTON	34	31	N	1	W
10/04/2019	RIVIERA OPERATING LLC	RIVERSIDE ENERGY MICHIGAN LLC	EWING C1-33	58234	MONTMORENCY	ALBERT	33	29	N	1	E
10/04/2019	RIVIERA OPERATING LLC	RIVERSIDE ENERGY MICHIGAN LLC	JUSZCZYK D2-33	58246	MONTMORENCY	ALBERT	33	29	N	1	E
10/04/2019	RIVIERA OPERATING LLC	RIVERSIDE ENERGY MICHIGAN LLC	RENDER D4-33	58247	MONTMORENCY	ALBERT	33	29	N	1	E