

Michigan Department of
Environment, Great Lakes, and Energy
Oil, Gas and Minerals Division

PERMIT LIST

10/5/2020 THRU 10/9/2020



Permit Number	Issue Date	Permittee Number	Permittee Name
---------------	------------	------------------	----------------

61500 10/8/2020 5320 SAVOY ENERGY LP
920 HASTINGS STREET, SUITE A
PO BOX 1560
TRAVERSE CITY, MI 49685-1560

API Well No: 21-025-62020-01-00

Prev Permit: 61473

Well Name: WAGLEY 1-2A

Surface Owner: Wagley, Susan M

Well Type: Oil Well

True Vertical Depth: 3900FT

Permit Type: Deepen

Target Formation: TRENTON-BLACK RIVER

H2S Present? No

Deepest Formation: GLENWOOD

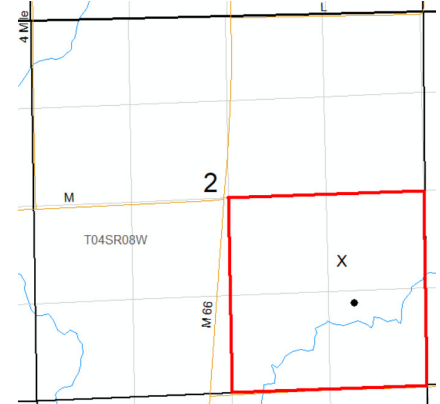

160-Acre R303 Drilling Unit,
SE/4 Sec. 2

Location:	QT QT QT	Sec	Township	Range	Township Name	County	Feet From Section Line	Feet From DRLG Unit Line
SL:	SWNESE	2	4S	8W	ATHENS	CALHOUN	1782 S 1209 E	
BHL:	NWSESE	2	4S	8W	ATHENS	CALHOUN	1106 S 963 E	1106 S 963 E

Michigan Department of
Environment, Great Lakes, and Energy
Oil, Gas and Minerals Division
Updated Permits
10/5/2020 THRU 10/9/2020



Permit Number Permittee Number Permittee Name

PLUGGING INSTRUCTIONS ISSUED:

54708 4605 SCHMUDE OIL INC
2150 S AIRPORT RD WEST SUITE B
PO BOX 1008
TRAVERSE CITY, MI 49685-1008

API Well Number: 21-025-30587-02-00

Well Name: JAMES COLLINS ET AL 1-HD2 True Vertical Depth: 2868

Plug Inst. Issue Date: 10/1/2020

Location	QT QT QT	Sec	Township	Range	Township Name	County	Feet From Section Line	Feet From DRLG Unit
SL:	NENWSW	18	1S	6W	CONVIS	CALHOUN	2150 S 660 W	
BHL:	NENWSW	18	1S	6W	CONVIS	CALHOUN	2534 S 757 W	1229 S 503 E

Comment: App to P&A expires on 10/23/20

55921 6361 RIVERSIDE ENERGY MICHIGAN LLC
10691 EAST CARTER ROAD
SUITE 201
TRAVERSE CITY, MI 49684

API Well Number: 21-009-55921-00-00

Well Name: CENTRAL M 1-7 SWD

Plug Inst. Issue Date: 9/27/2020

Location	QT QT QT	Sec	Township	Range	Township Name	County	Feet From Section Line	Feet From DRLG Unit
SL:	NENWNW	7	31N	7W	ECHO	ANTRIM	577 N 1164 W	
BHL:	NENWNW	7	31N	7W	ECHO	ANTRIM		

Comment: App to P&A expires on 9/27/21

Michigan Department of
Environment, Great Lakes, and Energy
Oil, Gas and Minerals Division
Updated Permits
10/5/2020 THRU 10/9/2020



Permit Number Permittee Number Permittee Name

60247 5320 SAVOY ENERGY LP
920 HASTINGS STREET, SUITE A
PO BOX 1560
TRAVERSE CITY, MI 49685-1560

API Well Number: 21-091-60247-00-00

Well Name: THOMPSON 2-22

Plug Inst. Issue Date: 10/1/2020

Location	QT QT QT	Sec	Township	Range	Township Name	County	Feet From Section Line	Feet From DRLG Unit
SL:	NENWSW	22	6S	3E	ADRIAN	LENAWEE	2105 S 687 W	550 N 660 E
BHL:	NENWSW	22	6S	3E	ADRIAN	LENAWEE		

Comment: App to P&A expires on 12/31/20

60639 5320 SAVOY ENERGY LP
920 HASTINGS STREET, SUITE A
PO BOX 1560
TRAVERSE CITY, MI 49685-1560

API Well Number: 21-091-60347-01-00

Well Name: THOMPSON 3-22A HD1 True Vertical Depth: 3289

Plug Inst. Issue Date: 10/1/2020

Location	QT QT QT	Sec	Township	Range	Township Name	County	Feet From Section Line	Feet From DRLG Unit
SL:	NWSESW	22	6S	3E	ADRIAN	LENAWEE	996 S 1361 W	
BHL:	NENWSW	22	6S	3E	ADRIAN	LENAWEE	2226 S 1012 W	429 N 337 E

Comment: App to P&A expires on 12/31/20

Michigan Department of
Environment, Great Lakes, and Energy
Oil, Gas and Minerals Division
Updated Permits
10/5/2020 THRU 10/9/2020



Permit Number Permittee Number Permittee Name

RECORD OF WELL PLUGGING:

43485 40 MUSKEGON DEVELOPMENT
COMPANY

1425 S MISSION RD
MOUNT PLEASANT, MI 48858

API Well Number: 21-137-43485-00-00

Well Name: HAHN C4-24

Plugging Date: 8/18/2020

Location	QT QT QT	Sec	Township	Range	Township Name	County	Feet From Section Line	Feet From DRLG Unit
SL:	NWNESE	24	30N	1W	CHARLTON	OTSEGO	430 N 969 E	430 N 330 W
BHL:	NWNESE	24	30N	1W	CHARLTON	OTSEGO		

43486 40 MUSKEGON DEVELOPMENT
COMPANY

1425 S MISSION RD
MOUNT PLEASANT, MI 48858

API Well Number: 21-137-43486-00-00

Well Name: HAHN 24 SWD

Plugging Date: 9/14/2020

Location	QT QT QT	Sec	Township	Range	Township Name	County	Feet From Section Line	Feet From DRLG Unit
SL:	NWNESE	24	30N	1W	CHARLTON	OTSEGO	362 N 959 E	
BHL:	NWNESE	24	30N	1W	CHARLTON	OTSEGO		

Michigan Department of
 Environment, Great Lakes, and Energy
 Oil, Gas and Minerals Division
 Updated Permits
 10/5/2020 THRU 10/9/2020



Permit Number Permittee Number Permittee Name

43488 40 MUSKEGON DEVELOPMENT COMPANY
 1425 S MISSION RD
 MOUNT PLEASANT, MI 48858

API Well Number: 21-137-43488-00-00

Well Name: THEIS A3-25

Plugging Date: 8/17/2020

Location	QT QT QT	Sec	Township	Range	Township Name	County	Feet From Section Line	Feet From DRLG Unit
SL:	SEWNWE	25	30N	1W	CHARLTON	OTSEGO	859 N 953 W	460 S 345 E
BHL:	SEWNWE	25	30N	1W	CHARLTON	OTSEGO		

43490 40 MUSKEGON DEVELOPMENT COMPANY
 1425 S MISSION RD
 MOUNT PLEASANT, MI 48858

API Well Number: 21-137-43490-00-00

Well Name: HAHN D4-24

Plugging Date: 8/13/2020

Location	QT QT QT	Sec	Township	Range	Township Name	County	Feet From Section Line	Feet From DRLG Unit
SL:	SWSESE	24	30N	1W	CHARLTON	OTSEGO	500 S 650 E	500 S 640 W
BHL:	SWSESE	24	30N	1W	CHARLTON	OTSEGO		

Michigan Department of
Environment, Great Lakes, and Energy
Oil, Gas and Minerals Division
Updated Permits
10/5/2020 THRU 10/9/2020



Permit Number Permittee Number Permittee Name

43491 40 MUSKEGON DEVELOPMENT COMPANY
1425 S MISSION RD
MOUNT PLEASANT, MI 48858

API Well Number: 21-137-43491-00-00

Well Name: HAHN D2-24

True Vertical Depth: 1621

Plugging Date: 8/10/2020

Location	QT QT QT	Sec	Township	Range	Township Name	County	Feet From Section Line	Feet From DRLG Unit
SL:	NESESW	24	30N	1W	CHARLTON	OTSEGO	740 S 390 E	
BHL:	SESESW	24	30N	1W	CHARLTON	OTSEGO	522 S 652 E	522 S 652 E

43492 40 MUSKEGON DEVELOPMENT COMPANY
1425 S MISSION RD
MOUNT PLEASANT, MI 48858

API Well Number: 21-137-43492-00-00

Well Name: HAHN D1-24

Plugging Date: 8/11/2020

Location	QT QT QT	Sec	Township	Range	Township Name	County	Feet From Section Line	Feet From DRLG Unit
SL:	SWSWSW	24	30N	1W	CHARLTON	OTSEGO	330 S 430 W	330 S 430 W
BHL:	SWSWSW	24	30N	1W	CHARLTON	OTSEGO		

Michigan Department of
Environment, Great Lakes, and Energy
Oil, Gas and Minerals Division
Updated Permits
10/5/2020 THRU 10/9/2020



Permit Number Permittee Number Permittee Name

43493 40 MUSKEGON DEVELOPMENT COMPANY
1425 S MISSION RD
MOUNT PLEASANT, MI 48858

API Well Number: 21-137-43493-00-00

Well Name: HAHN C2-24

True Vertical Depth: 1620

Plugging Date: 8/10/2020

Location	QT QT QT	Sec	Township	Range	Township Name	County	Feet From Section Line	Feet From DRLG Unit
SL:	SENE SW	24	30N	1W	CHARLTON	OTSEGO	1306 N 628 E	
BHL:	SENE SW	24	30N	1W	CHARLTON	OTSEGO	877 N 624 E	443 S 624 E

43494 40 MUSKEGON DEVELOPMENT COMPANY
1425 S MISSION RD
MOUNT PLEASANT, MI 48858

API Well Number: 21-137-43494-00-00

Well Name: HAHN C1-24

Plugging Date: 8/11/2020

Location	QT QT QT	Sec	Township	Range	Township Name	County	Feet From Section Line	Feet From DRLG Unit
SL:	SWNWSW	24	30N	1W	CHARLTON	OTSEGO	978 N 345 W	330 S 345 W
BHL:	SWNWSW	24	30N	1W	CHARLTON	OTSEGO		

Michigan Department of
Environment, Great Lakes, and Energy
Oil, Gas and Minerals Division
Updated Permits
10/5/2020 THRU 10/9/2020



Permit Number Permittee Number Permittee Name

43495 40 MUSKEGON DEVELOPMENT COMPANY
1425 S MISSION RD
MOUNT PLEASANT, MI 48858

API Well Number: 21-137-43495-00-00

Well Name: KESKINE B4-24

Plugging Date: 8/17/2020

Location	QT QT QT	Sec	Township	Range	Township Name	County	Feet From Section Line	Feet From DRLG Unit
SL:	SWSENE	24	30N	1W	CHARLTON	OTSEGO	500 S 800 E	500 S 505 W
BHL:	SWSENE	24	30N	1W	CHARLTON	OTSEGO		

43496 40 MUSKEGON DEVELOPMENT COMPANY
1425 S MISSION RD
MOUNT PLEASANT, MI 48858

API Well Number: 21-137-43496-00-00

Well Name: BRILEY D4-23

Plugging Date: 8/12/2020

Location	QT QT QT	Sec	Township	Range	Township Name	County	Feet From Section Line	Feet From DRLG Unit
SL:	SWSESE	23	30N	1W	CHARLTON	OTSEGO	330 S 883 E	330 S 430 W
BHL:	SWSESE	23	30N	1W	CHARLTON	OTSEGO		

Michigan Department of
Environment, Great Lakes, and Energy
Oil, Gas and Minerals Division
Updated Permits
10/5/2020 THRU 10/9/2020



Permit Number Permittee Number Permittee Name

44772 40 MUSKEGON DEVELOPMENT COMPANY
1425 S MISSION RD
MOUNT PLEASANT, MI 48858

API Well Number: 21-137-44772-00-00

Well Name: LARSON B3-24

Plugging Date: 8/14/2020

Location	QT QT QT	Sec	Township	Range	Township Name	County	Feet From Section Line	Feet From DRLG Unit
SL:	NWSWNE	24	30N	1W	CHARLTON	OTSEGO	820 S 486 W	486 N 486 W
BHL:	NWSWNE	24	30N	1W	CHARLTON	OTSEGO		

44774 40 MUSKEGON DEVELOPMENT COMPANY
1425 S MISSION RD
MOUNT PLEASANT, MI 48858

API Well Number: 21-137-44774-00-00

Well Name: MEYER A3-24

Plugging Date: 8/14/2020

Location	QT QT QT	Sec	Township	Range	Township Name	County	Feet From Section Line	Feet From DRLG Unit
SL:	SEWNNE	24	30N	1W	CHARLTON	OTSEGO	860 N 690 W	445 S 621 E
BHL:	SEWNNE	24	30N	1W	CHARLTON	OTSEGO		

Michigan Department of
Environment, Great Lakes, and Energy
Oil, Gas and Minerals Division
Updated Permits
10/5/2020 THRU 10/9/2020



Permit Number Permittee Number Permittee Name

44775 40 MUSKEGON DEVELOPMENT COMPANY

1425 S MISSION RD
MOUNT PLEASANT, MI 48858

API Well Number: 21-137-44775-00-00

Well Name: HAHN C3-24

True Vertical Depth: 1735

Plugging Date: 8/13/2020

Location	QT QT QT	Sec	Township	Range	Township Name	County	Feet From Section Line	Feet From DRLG Unit
SL:	SEWSE	24	30N	1W	CHARLTON	OTSEGO	919 N 857 W	
BHL:	SWNWSE	24	30N	1W	CHARLTON	OTSEGO	677 N 476 W	629 S 476 W

46109 40 MUSKEGON DEVELOPMENT COMPANY

1425 S MISSION RD
MOUNT PLEASANT, MI 48858

API Well Number: 21-137-46109-00-00

Well Name: BRILEY C3-23

Plugging Date: 8/12/2020

Location	QT QT QT	Sec	Township	Range	Township Name	County	Feet From Section Line	Feet From DRLG Unit
SL:	SWNWSE	23	30N	1W	CHARLTON	OTSEGO	979 N 430 W	330 S 430 W
BHL:	SWNWSE	23	30N	1W	CHARLTON	OTSEGO		

Michigan Department of
Environment, Great Lakes, and Energy
Oil, Gas and Minerals Division
Updated Permits
10/5/2020 THRU 10/9/2020



Permit Number Permittee Number Permittee Name

46362 40 MUSKEGON DEVELOPMENT COMPANY
1425 S MISSION RD
MOUNT PLEASANT, MI 48858

API Well Number: 21-135-46362-00-00

Well Name: SNIDER C1-12

Plugging Date: 9/22/2020

Location	QT QT QT	Sec	Township	Range	Township Name	County	Feet From Section Line	Feet From DRLG Unit
SL:	NENWSW	12	28N	3E	CLINTON	OSCODA	330 N 744 W	330 N 660 E
BHL:	NENWSW	12	28N	3E	CLINTON	OSCODA		

46379 40 MUSKEGON DEVELOPMENT COMPANY
1425 S MISSION RD
MOUNT PLEASANT, MI 48858

API Well Number: 21-135-46379-00-00

Well Name: BLASKA B3-10

Plugging Date: 9/23/2020

Location	QT QT QT	Sec	Township	Range	Township Name	County	Feet From Section Line	Feet From DRLG Unit
SL:	NESWNE	10	28N	3E	CLINTON	OSCODA	670 S 917 W	644 N 363 E
BHL:	NESWNE	10	28N	3E	CLINTON	OSCODA		

Michigan Department of
Environment, Great Lakes, and Energy
Oil, Gas and Minerals Division
Updated Permits
10/5/2020 THRU 10/9/2020



Permit Number Permittee Number Permittee Name

51250 40 MUSKEGON DEVELOPMENT COMPANY
1425 S MISSION RD
MOUNT PLEASANT, MI 48858

API Well Number: 21-135-51250-00-00

Well Name: CLINTON A3-13

Plugging Date: 9/21/2020

Location	QT QT QT	Sec	Township	Range	Township Name	County	Feet From Section Line	Feet From DRLG Unit
SL:	NWNWNE	13	28N	3E	CLINTON	OSCODA	330 N 330 W	330 N 330 W
BHL:	NWNWNE	13	28N	3E	CLINTON	OSCODA		

51251 40 MUSKEGON DEVELOPMENT COMPANY
1425 S MISSION RD
MOUNT PLEASANT, MI 48858

API Well Number: 21-135-51251-00-00

Well Name: CLINTON D4-11

Plugging Date: 9/22/2020

Location	QT QT QT	Sec	Township	Range	Township Name	County	Feet From Section Line	Feet From DRLG Unit
SL:	SWSESE	11	28N	3E	CLINTON	OSCODA	330 S 998 E	330 S 330 W
BHL:	SWSESE	11	28N	3E	CLINTON	OSCODA		

Michigan Department of
 Environment, Great Lakes, and Energy
 Oil, Gas and Minerals Division
 Updated Permits
 10/5/2020 THRU 10/9/2020



Permit Number Permittee Number Permittee Name

51254 40 MUSKEGON DEVELOPMENT
 COMPANY

 1425 S MISSION RD
 MOUNT PLEASANT, MI 48858

API Well Number: 21-135-51254-00-00

Well Name: CLINTON D2-11

Plugging Date: 9/23/2020

Location	QT QT QT	Sec	Township	Range	Township Name	County	Feet From Section Line	Feet From DRLG Unit
SL:	SWSESW	11	28N	3E	CLINTON	OSCODA	650 S 998 E	650 S 330 W
BHL:	SWSESW	11	28N	3E	CLINTON	OSCODA		

51255 40 MUSKEGON DEVELOPMENT
 COMPANY

 1425 S MISSION RD
 MOUNT PLEASANT, MI 48858

API Well Number: 21-135-51255-00-00

Well Name: CLINTON C3-12

Plugging Date: 9/21/2020

Location	QT QT QT	Sec	Township	Range	Township Name	County	Feet From Section Line	Feet From DRLG Unit
SL:	NWNWSE	12	28N	3E	CLINTON	OSCODA	330 N 330 W	330 N 330 W
BHL:	NWNWSE	12	28N	3E	CLINTON	OSCODA		

Michigan Department of
Environment, Great Lakes, and Energy
Oil, Gas and Minerals Division
Updated Permits
10/5/2020 THRU 10/9/2020



Permit Number Permittee Number Permittee Name

51710 40 MUSKEGON DEVELOPMENT COMPANY

1425 S MISSION RD
MOUNT PLEASANT, MI 48858

API Well Number: 21-135-51710-00-00

Well Name: CLINTON C1-1

Plugging Date: 9/25/2020

Location	QT QT QT	Sec	Township	Range	Township Name	County	Feet From Section Line	Feet From DRLG Unit
SL:	NENWSW	1	28N	3E	CLINTON	OSCODA	330 N 1173 W	330 N 1173 W
BHL:	NENWSW	1	28N	3E	CLINTON	OSCODA		

51712 40 MUSKEGON DEVELOPMENT COMPANY

1425 S MISSION RD
MOUNT PLEASANT, MI 48858

API Well Number: 21-135-51712-00-00

Well Name: CLINTON A3-11

Plugging Date: 9/23/2020

Location	QT QT QT	Sec	Township	Range	Township Name	County	Feet From Section Line	Feet From DRLG Unit
SL:	SENWNE	11	28N	3E	CLINTON	OSCODA	660 N 1319 W	658 S 1319 W
BHL:	SENWNE	11	28N	3E	CLINTON	OSCODA		

Michigan Department of
Environment, Great Lakes, and Energy
Oil, Gas and Minerals Division
Updated Permits
10/5/2020 THRU 10/9/2020



Permit Number Permittee Number Permittee Name

53071 40 MUSKEGON DEVELOPMENT COMPANY

1425 S MISSION RD
MOUNT PLEASANT, MI 48858

API Well Number: 21-135-53071-00-00

Well Name: ROZENBOOM B2-14

Plugging Date: 9/17/2020

Location	QT QT QT	Sec	Township	Range	Township Name	County	Feet From Section Line	Feet From DRLG Unit
SL:	SWSNW	14	28N	3E	CLINTON	OSCODA	548 S 1029 E	548 S 1029 E
BHL:	SWSNW	14	28N	3E	CLINTON	OSCODA		

53072 40 MUSKEGON DEVELOPMENT COMPANY

1425 S MISSION RD
MOUNT PLEASANT, MI 48858

API Well Number: 21-135-53072-00-00

Well Name: CLINTON B4-14

Plugging Date: 9/16/2020

Location	QT QT QT	Sec	Township	Range	Township Name	County	Feet From Section Line	Feet From DRLG Unit
SL:	SWSNE	14	28N	3E	CLINTON	OSCODA	532 S 1212 E	532 S 1212 E
BHL:	SWSNE	14	28N	3E	CLINTON	OSCODA		

Michigan Department of
Environment, Great Lakes, and Energy
Oil, Gas and Minerals Division
Updated Permits
10/5/2020 THRU 10/9/2020



Permit Number Permittee Number Permittee Name

53073 40 MUSKEGON DEVELOPMENT
COMPANY

1425 S MISSION RD
MOUNT PLEASANT, MI 48858

API Well Number: 21-135-53073-00-00

Well Name: STEELE D3-14

Plugging Date: 9/16/2020

Location	QT QT QT	Sec	Township	Range	Township Name	County	Feet From Section Line	Feet From DRLG Unit
SL:	NWSWSE	14	28N	3E	CLINTON	OSCODA	996 S 430 W	996 S 430 W
BHL:	NWSWSE	14	28N	3E	CLINTON	OSCODA		

53074 40 MUSKEGON DEVELOPMENT
COMPANY

1425 S MISSION RD
MOUNT PLEASANT, MI 48858

API Well Number: 21-135-53074-00-00

Well Name: STATE CLINTON B1-13

Plugging Date: 9/17/2020

Location	QT QT QT	Sec	Township	Range	Township Name	County	Feet From Section Line	Feet From DRLG Unit
SL:	NESWNW	13	28N	3E	CLINTON	OSCODA	1168 S 897 W	1168 S 500 E
BHL:	NESWNW	13	28N	3E	CLINTON	OSCODA		

Michigan Department of
Environment, Great Lakes, and Energy
Oil, Gas and Minerals Division
Updated Permits
10/5/2020 THRU 10/9/2020



Permit Number Permittee Number Permittee Name

53075 40 MUSKEGON DEVELOPMENT
COMPANY

1425 S MISSION RD
MOUNT PLEASANT, MI 48858

API Well Number: 21-135-53075-00-00

Well Name: LAMOUREUX C1-13

Plugging Date: 9/15/2020

Location	QT QT QT	Sec	Township	Range	Township Name	County	Feet From Section Line	Feet From DRLG Unit
SL:	SWNWSW	13	28N	3E	CLINTON	OSCODA	918 N 430 W	918 N 430 W
BHL:	SWNWSW	13	28N	3E	CLINTON	OSCODA		

53076 40 MUSKEGON DEVELOPMENT
COMPANY

1425 S MISSION RD
MOUNT PLEASANT, MI 48858

API Well Number: 21-135-53076-00-00

Well Name: STATE CLINTON C3-13

Plugging Date: 9/15/2020

Location	QT QT QT	Sec	Township	Range	Township Name	County	Feet From Section Line	Feet From DRLG Unit
SL:	SWNWSE	13	28N	3E	CLINTON	OSCODA	990 N 330 W	990 N 330 W
BHL:	SWNWSE	13	28N	3E	CLINTON	OSCODA		

Michigan Department of
Environment, Great Lakes, and Energy
Oil, Gas and Minerals Division
Updated Permits
10/5/2020 THRU 10/9/2020



Permit Number Permittee Number Permittee Name

54940 6312 ARBOR OPERATING LLC
333 West Grandview Parkway
Suite 401
TRAVERSE CITY, MI 49684

API Well Number: 21-137-54940-00-00

Well Name: LOSHAW D4-28

Plugging Date: 7/13/2020

Location	QT QT QT	Sec	Township	Range	Township Name	County	Feet From Section Line	Feet From DRLG Unit
SL:	NESESE	28	32N	3W	CORWITH	OTSEGO	962 S 580 E	352 N 580 E
BHL:	NESESE	28	32N	3W	CORWITH	OTSEGO	962 S 580 E	352 N 580 E

61030 5280 JORDAN DEVELOPMENT COMPANY
LLC

1503 GARFIELD RD NORTH
TRAVERSE CITY, MI 49696

API Well Number: 21-079-61030-00-00

Well Name: STATE BLUE LAKE 7-1 HD1 True Vertical Depth: 6498

Plugging Date: 9/17/2020

Location	QT QT QT	Sec	Township	Range	Township Name	County	Feet From Section Line	Feet From DRLG Unit
SL:	NESWNE	1	28N	5W	BLUE LAKE	KALKASKA	1804 N 1633 E	
BHL:	NENENE	1	28N	5W	BLUE LAKE	KALKASKA	598 N 536 E	598 N 536 E

Michigan Department of
 Environment, Great Lakes, and Energy
 Oil, Gas and Minerals Division
 Updated Permits
 10/5/2020 THRU 10/9/2020



Permit Number Permittee Number Permittee Name

APPLICATIONS TO CHANGE WELL STATUS:

20667 80 BAILER AND DESHAW
 PO BOX 366
 KAWKAWLIN, MI 48631

API Well Number: 21-157-20667-00-00

Well Name: MURPHY, HARRISON ET AL A-1

Approval Date: 9/28/2020

Location	QT QT QT	Sec	Township	Range	Township Name	County	Feet From Section Line	Feet From DRLG Unit
SL:	SWNWSE	30	10N	7E	ARBELA	TUSCOLA	990 N 330 W	990 N 330 W
BHL:	SWNWSE	30	10N	7E	ARBELA	TUSCOLA		

Proposed Rework: ACOWS to squeeze cement

Comment: ACOWS to cement casing annulus for brine disposal conversion expires 9/28/21



Michigan Department of
 Environment, Great Lakes, and Energy
 Oil, Gas and Minerals Division
 Updated Permits
 10/5/2020 THRU 10/9/2020



MICHIGAN DEPARTMENT OF
 ENVIRONMENT, GREAT LAKES, AND ENERGY

Permit Number: 20798
 Permittee Number: 80
 Permittee Name: BAILER AND DESHAW
 PO BOX 366
 KAWKAWLIN, MI 48631

API Well Number: 21-145-20798-00-00

Well Name: WOLOHAN EST B-1

Approval Date: 9/28/2020

Location	QT QT QT	Sec	Township	Range	Township Name	County	Feet From Section Line	Feet From DRLG Unit
SL:	E2NWSE	19	10N	6E	BIRCH RUN	SAGINAW	755 N 920 W	755 N 400 E
BHL:	E2NWSE	19	10N	6E	BIRCH RUN	SAGINAW		

Proposed Rework: ACOWS to squeeze cement

Comment: ACOWS to cement casing annulus for conversion to brine disposal well expires 9/28/21

Permit Number: 29713
 Permittee Number: 6371
 Permittee Name: BREITBURN OPERATING LIMITED PARTNERSHIP
 1111 BAGBY STREET, SUITE 1600
 HOUSTON, TX 77002

API Well Number: 21-137-29713-00-00

Well Name: NORTH MICHIGAN LAND AND OIL CO 3-29

Approval Date: 9/22/2020

Location	QT QT QT	Sec	Township	Range	Township Name	County	Feet From Section Line	Feet From DRLG Unit
SL:	SWSWNE	29	29N	4W	HAYES	OTSEGO	499 S 107 W	499 S 1213 E
BHL:	SWSWNE	29	29N	4W	HAYES	OTSEGO		

Proposed Rework: Temporarily Abandoned

Comment: ACOWS for TA expires on 9/22/21

Michigan Department of
Environment, Great Lakes, and Energy
Oil, Gas and Minerals Division
Updated Permits
10/5/2020 THRU 10/9/2020



Permit Number Permittee Number Permittee Name

29963 6325 MICHIGAN GAS UTILITIES CORP
899 S TELEGRAPH RD
MONROE, MI 48161

API Well Number: 21-025-29963-00-00

Well Name: MYMACHOD, ALEX & MARY 3-13

Approval Date: 10/1/2020

Location	QT QT QT	Sec	Township	Range	Township Name	County	Feet From Section Line	Feet From DRLG Unit
SL:	NENWSE	13	1S	5W	LEE	CALHOUN	334 N 1133 W	334 N 1133 W
BHL:	NENWSE	13	1S	5W	LEE	CALHOUN		

Proposed Rework: Temporarily Abandoned

Comment: ACOWS for TA expires on 11/12/21; ACOWS states that well will be converted into an observation well toward end of TA period.

43172 6371 BREITBURN OPERATING LIMITED
PARTNERSHIP
1111 BAGBY STREET, SUITE 1600
HOUSTON, TX 77002

API Well Number: 21-137-43172-00-00

Well Name: WINTER 4-33

Approval Date: 9/23/2020

Location	QT QT QT	Sec	Township	Range	Township Name	County	Feet From Section Line	Feet From DRLG Unit
SL:	SWNESW	33	31N	2W	DOVER	OTSEGO	790 N 730 E	530 S 550 W
BHL:	SWNESW	33	31N	2W	DOVER	OTSEGO		

Proposed Rework: Temporarily Abandoned

Comment: ACOWS for TA expires on 9/23/21

Michigan Department of
 Environment, Great Lakes, and Energy
 Oil, Gas and Minerals Division
 Updated Permits
 10/5/2020 THRU 10/9/2020



MICHIGAN DEPARTMENT OF
 ENVIRONMENT, GREAT LAKES, AND ENERGY

Permit Number Permittee Number Permittee Name

43176 6371 BREITBURN OPERATING LIMITED
 PARTNERSHIP
 1111 BAGBY STREET, SUITE 1600
 HOUSTON, TX 77002

API Well Number: 21-137-43176-00-00

Well Name: WINTER 3-33

Approval Date: 9/23/2020

Location	QT QT QT	Sec	Township	Range	Township Name	County	Feet From Section Line	Feet From DRLG Unit
SL:	NESESW	33	31N	2W	DOVER	OTSEGO	750 S 400 E	565 N 400 E
BHL:	NESESW	33	31N	2W	DOVER	OTSEGO		

Proposed Rework: Temporarily Abandoned

Comment: ACOWS for TA expires on 9/23/21

43364 6371 BREITBURN OPERATING LIMITED
 PARTNERSHIP
 1111 BAGBY STREET, SUITE 1600
 HOUSTON, TX 77002

API Well Number: 21-137-43364-00-00

Well Name: BERSCHBACH 1-33

Approval Date: 9/23/2020

Location	QT QT QT	Sec	Township	Range	Township Name	County	Feet From Section Line	Feet From DRLG Unit
SL:	SWSWSW	33	31N	2W	DOVER	OTSEGO	525 S 570 W	525 S 570 W
BHL:	SWSWSW	33	31N	2W	DOVER	OTSEGO		

Proposed Rework: Temporarily Abandoned

Comment: ACOWS for TA expires on 9/23/21

Michigan Department of
Environment, Great Lakes, and Energy
Oil, Gas and Minerals Division
Updated Permits
10/5/2020 THRU 10/9/2020



Permit Number Permittee Number Permittee Name

43591 6371 BREITBURN OPERATING LIMITED
PARTNERSHIP
1111 BAGBY STREET, SUITE 1600
HOUSTON, TX 77002

API Well Number: 21-137-43591-00-00

Well Name: COGSWELL C1-27

Approval Date: 9/23/2020

Location	QT QT QT	Sec	Township	Range	Township Name	County	Feet From Section Line	Feet From DRLG Unit
SL:	SWNWSW	27	30N	4W	HAYES	OTSEGO	808 N 538 W	512 S 538 W
BHL:	SWNWSW	27	30N	4W	HAYES	OTSEGO		

Proposed Rework: Temporarily Abandoned

Comment: ACOWS for TA expires on 9/23/21

43878 6371 BREITBURN OPERATING LIMITED
PARTNERSHIP
1111 BAGBY STREET, SUITE 1600
HOUSTON, TX 77002

API Well Number: 21-137-43878-00-00

Well Name: KLEE 1-32

Approval Date: 9/23/2020

Location	QT QT QT	Sec	Township	Range	Township Name	County	Feet From Section Line	Feet From DRLG Unit
SL:	SENWSE	32	31N	2W	DOVER	OTSEGO	660 N 800 W	600 S 500 E
BHL:	SENWSE	32	31N	2W	DOVER	OTSEGO		

Proposed Rework: Temporarily Abandoned

Comment: ACOWS for TA expires on 9/23/21

Michigan Department of
 Environment, Great Lakes, and Energy
 Oil, Gas and Minerals Division
 Updated Permits
 10/5/2020 THRU 10/9/2020



MICHIGAN DEPARTMENT OF
 ENVIRONMENT, GREAT LAKES, AND ENERGY

Permit Number Permittee Number Permittee Name

43880 6371 BREITBURN OPERATING LIMITED
 PARTNERSHIP
 1111 BAGBY STREET, SUITE 1600
 HOUSTON, TX 77002

API Well Number: 21-137-43880-00-00

Well Name: TASKEY 3-34

Approval Date: 9/23/2020

Location	QT QT QT	Sec	Township	Range	Township Name	County	Feet From Section Line	Feet From DRLG Unit
SL:	SESESW	34	31N	2W	DOVER	OTSEGO	660 S 630 E	660 S 630 E
BHL:	SESESW	34	31N	2W	DOVER	OTSEGO		

Proposed Rework: Temporarily Abandoned

Comment: ACOWS for TA expires on 9/23/21

43881 6371 BREITBURN OPERATING LIMITED
 PARTNERSHIP
 1111 BAGBY STREET, SUITE 1600
 HOUSTON, TX 77002

API Well Number: 21-137-43881-00-00

Well Name: WOLF 2-32

Approval Date: 9/23/2020

Location	QT QT QT	Sec	Township	Range	Township Name	County	Feet From Section Line	Feet From DRLG Unit
SL:	SESWSE	32	31N	2W	DOVER	OTSEGO	580 S 680 W	580 S 640 E
BHL:	SESWSE	32	31N	2W	DOVER	OTSEGO		

Proposed Rework: Temporarily Abandoned

Comment: ACOWS for TA expires on 9/23/21

Michigan Department of
 Environment, Great Lakes, and Energy
 Oil, Gas and Minerals Division
 Updated Permits
 10/5/2020 THRU 10/9/2020



MICHIGAN DEPARTMENT OF
 ENVIRONMENT, GREAT LAKES, AND ENERGY

Permit Number Permittee Number Permittee Name

43883 6371 BREITBURN OPERATING LIMITED
 PARTNERSHIP
 1111 BAGBY STREET, SUITE 1600
 HOUSTON, TX 77002

API Well Number: 21-137-43883-00-00

Well Name: KOZLOWSKI 4-32

Approval Date: 9/23/2020

Location	QT QT QT	Sec	Township	Range	Township Name	County	Feet From Section Line	Feet From DRLG Unit
SL:	NWSESE	32	31N	2W	DOVER	OTSEGO	770 S 940 E	530 N 390 W
BHL:	NWSESE	32	31N	2W	DOVER	OTSEGO		

Proposed Rework: Temporarily Abandoned

Comment: ACOWS for TA expires on 9/23/21

43884 6371 BREITBURN OPERATING LIMITED
 PARTNERSHIP
 1111 BAGBY STREET, SUITE 1600
 HOUSTON, TX 77002

API Well Number: 21-137-43884-00-00

Well Name: KOBYLINSKI 5-33

Approval Date: 9/23/2020

Location	QT QT QT	Sec	Township	Range	Township Name	County	Feet From Section Line	Feet From DRLG Unit
SL:	SWSWSE	33	31N	2W	DOVER	OTSEGO	575 S 630 W	575 S 630 W
BHL:	SWSWSE	33	31N	2W	DOVER	OTSEGO		

Proposed Rework: Temporarily Abandoned

Comment: ACOWS for TA expires on 9/23/21

Michigan Department of
 Environment, Great Lakes, and Energy
 Oil, Gas and Minerals Division
 Updated Permits
 10/5/2020 THRU 10/9/2020



MICHIGAN DEPARTMENT OF
 ENVIRONMENT, GREAT LAKES, AND ENERGY

Permit Number Permittee Number Permittee Name

44362 6371 BREITBURN OPERATING LIMITED
 PARTNERSHIP
 1111 BAGBY STREET, SUITE 1600
 HOUSTON, TX 77002

API Well Number: 21-137-44362-00-00

Well Name: KUBACKI 12-36

Approval Date: 9/23/2020

Location	QT QT QT	Sec	Township	Range	Township Name	County	Feet From Section Line	Feet From DRLG Unit
SL:	NENWSW	36	31N	2W	DOVER	OTSEGO	340 N 976 W	340 N 340 E
BHL:	NENWSW	36	31N	2W	DOVER	OTSEGO		

Proposed Rework: Temporarily Abandoned

Comment: ACOWS for TA expires on 9/23/21

44372 6371 BREITBURN OPERATING LIMITED
 PARTNERSHIP
 1111 BAGBY STREET, SUITE 1600
 HOUSTON, TX 77002

API Well Number: 21-137-44372-00-00

Well Name: SADDLER 15-35

Approval Date: 9/23/2020

Location	QT QT QT	Sec	Township	Range	Township Name	County	Feet From Section Line	Feet From DRLG Unit
SL:	SESWSE	35	31N	2W	DOVER	OTSEGO	366 S 949 W	366 S 365 E
BHL:	SESWSE	35	31N	2W	DOVER	OTSEGO		

Proposed Rework: Temporarily Abandoned

Comment: ACOWS for TA expire on 9/23/21

Michigan Department of
Environment, Great Lakes, and Energy
Oil, Gas and Minerals Division
Updated Permits
10/5/2020 THRU 10/9/2020



Permit Number Permittee Number Permittee Name

45323 6371 BREITBURN OPERATING LIMITED
PARTNERSHIP
1111 BAGBY STREET, SUITE 1600
HOUSTON, TX 77002

API Well Number: 21-137-45323-00-00

Well Name: BROWN 7-34

Approval Date: 9/23/2020

Location	QT QT QT	Sec	Township	Range	Township Name	County	Feet From Section Line	Feet From DRLG Unit
SL:	NESWNE	34	31N	2W	DOVER	OTSEGO	971 S 967 W	345 N 346 E
BHL:	NESWNE	34	31N	2W	DOVER	OTSEGO		

Proposed Rework: Temporarily Abandoned

Comment: ACOWS for TA expires on 9/23/21

45349 6371 BREITBURN OPERATING LIMITED
PARTNERSHIP
1111 BAGBY STREET, SUITE 1600
HOUSTON, TX 77002

API Well Number: 21-137-45349-00-00

Well Name: STATE DOVER 6-36

Approval Date: 9/23/2020

Location	QT QT QT	Sec	Township	Range	Township Name	County	Feet From Section Line	Feet From DRLG Unit
SL:	SWSNW	36	31N	2W	DOVER	OTSEGO	640 S 880 E	640 S 430 W
BHL:	SWSNW	36	31N	2W	DOVER	OTSEGO		

Proposed Rework: Temporarily Abandoned

Comment: ACOWS for TA expires on 9/23/21

Michigan Department of
 Environment, Great Lakes, and Energy
 Oil, Gas and Minerals Division
 Updated Permits
 10/5/2020 THRU 10/9/2020



MICHIGAN DEPARTMENT OF
 ENVIRONMENT, GREAT LAKES, AND ENERGY

Permit Number Permittee Number Permittee Name

46626 6371 BREITBURN OPERATING LIMITED
 PARTNERSHIP
 1111 BAGBY STREET, SUITE 1600
 HOUSTON, TX 77002

API Well Number: 21-137-46626-04-00

Well Name: SMOLARZ 2-8 HD1

True Vertical Depth: 1169

Approval Date: 9/23/2020

Location	QT QT QT	Sec	Township	Range	Township Name	County	Feet From Section Line	Feet From DRLG Unit
SL:	NWNWNE	8	31N	3W	LIVINGSTON	OTSEGO	576 N 2134 E	
BHL:	SENWNE	8	31N	3W	LIVINGSTON	OTSEGO	972 N 1709 E	972 N 927 W

Proposed Rework: Temporarily Abandoned

Comment: ACOWS for TA expires on 9/23/21

53461 6371 BREITBURN OPERATING LIMITED
 PARTNERSHIP
 1111 BAGBY STREET, SUITE 1600
 HOUSTON, TX 77002

API Well Number: 21-137-53461-00-00

Well Name: FONTINALIS CLUB C4-2

Approval Date: 9/23/2020

Location	QT QT QT	Sec	Township	Range	Township Name	County	Feet From Section Line	Feet From DRLG Unit
SL:	SWNESE	2	31N	3W	LIVINGSTON	OTSEGO	1650 S 700 E	330 S 620 W
BHL:	SWNESE	2	31N	3W	LIVINGSTON	OTSEGO		

Proposed Rework: Temporarily Abandoned

Comment: ACOWS for TA expires on 9/23/21

Michigan Department of
Environment, Great Lakes, and Energy
Oil, Gas and Minerals Division
Updated Permits
10/5/2020 THRU 10/9/2020



Permit Number Permittee Number Permittee Name

57620 6371 BREITBURN OPERATING LIMITED
PARTNERSHIP
1111 BAGBY STREET, SUITE 1600
HOUSTON, TX 77002

API Well Number: 21-079-57620-00-00

Well Name: STATE GARFIELD D1-10

Approval Date: 9/23/2020

Location	QT QT QT	Sec	Township	Range	Township Name	County	Feet From Section Line	Feet From DRLG Unit
SL:	NWSWSW	10	25N	5W	GARFIELD	KALKASKA	989 S 330 W	330 N 330 W
BHL:	NWSWSW	10	25N	5W	GARFIELD	KALKASKA		

Proposed Rework: Temporarily Abandoned

Comment: ACOWS for TA expires on 3/31/24

57677 6371 BREITBURN OPERATING LIMITED
PARTNERSHIP
1111 BAGBY STREET, SUITE 1600
HOUSTON, TX 77002

API Well Number: 21-079-57677-00-00

Well Name: STATE GARFIELD B3-9 HDL True Vertical Depth: 2248

Approval Date: 9/23/2020

Location	QT QT QT	Sec	Township	Range	Township Name	County	Feet From Section Line	Feet From DRLG Unit
SL:	NWSWNE	9	25N	5W	GARFIELD	KALKASKA	1380 N 2553 E	
BHL:	NWNWNW	9	25N	5W	GARFIELD	KALKASKA	53 N 412 W	

Proposed Rework: Temporarily Abandoned

Comment: ACOWS for TA expires on 3/31/22

Michigan Department of
Environment, Great Lakes, and Energy
Oil, Gas and Minerals Division
Updated Permits
10/5/2020 THRU 10/9/2020



Permit Number Permittee Number Permittee Name

58819 6371 BREITBURN OPERATING LIMITED
PARTNERSHIP
1111 BAGBY STREET, SUITE 1600
HOUSTON, TX 77002

API Well Number: 21-079-58819-00-00

Well Name: STATE GARFIELD (DRZ3) C4-9

Approval Date: 9/23/2020

Location	QT QT QT	Sec	Township	Range	Township Name	County	Feet From Section Line	Feet From DRLG Unit
SL:	NWNESE	9	25N	5W	GARFIELD	KALKASKA	2283 S 972 E	355 N 355 W
BHL:	NWNESE	9	25N	5W	GARFIELD	KALKASKA		

Proposed Rework: Temporarily Abandoned

Comment: ACOWS for TA expires on 3/31/23

59157 6371 BREITBURN OPERATING LIMITED
PARTNERSHIP
1111 BAGBY STREET, SUITE 1600
HOUSTON, TX 77002

API Well Number: 21-039-59157-00-00

Well Name: STATE BEAVER CREEK (DRZ3)
D4-27

Approval Date: 9/23/2020

Location	QT QT QT	Sec	Township	Range	Township Name	County	Feet From Section Line	Feet From DRLG Unit
SL:	NWSESE	27	25N	4W	BEAVER CREEK	CRAWFORD	669 S 1162 E	
BHL:	NWSESE	27	25N	4W	BEAVER CREEK	CRAWFORD		

Proposed Rework: Temporarily Abandoned

Comment: ACOWS for TA expires on 3/31/22

Michigan Department of
Environment, Great Lakes, and Energy
Oil, Gas and Minerals Division
Updated Permits
10/5/2020 THRU 10/9/2020



Permit Number Permittee Number Permittee Name

59158 6371 BREITBURN OPERATING LIMITED
PARTNERSHIP
1111 BAGBY STREET, SUITE 1600
HOUSTON, TX 77002

API Well Number: 21-039-59158-00-00

Well Name: STATE BEAVER CREEK (DRZ3)
B2-29

Approval Date: 9/23/2020

Location	QT QT QT	Sec	Township	Range	Township Name	County	Feet From Section Line	Feet From DRLG Unit
SL:	SWSENW	29	25N	4W	BEAVER CREEK	CRAWFORD	1981 N 1659 W	
BHL:	SWSENW	29	25N	4W	BEAVER CREEK	CRAWFORD		

Proposed Rework: Temporarily Abandoned

Comment: ACOWS for TA expires on 3/31/24

59180 6371 BREITBURN OPERATING LIMITED
PARTNERSHIP
1111 BAGBY STREET, SUITE 1600
HOUSTON, TX 77002

API Well Number: 21-079-59180-00-00

Well Name: STATE GARFIELD (RICHFIELD)
D3-9

Approval Date: 9/23/2020

Location	QT QT QT	Sec	Township	Range	Township Name	County	Feet From Section Line	Feet From DRLG Unit
SL:	NWSWSE	9	25N	5W	GARFIELD	KALKASKA	934 S 2246 E	383 N 410 W
BHL:	NWSWSE	9	25N	5W	GARFIELD	KALKASKA		

Proposed Rework: Temporarily Abandoned

Comment: ACOWS for TA expires on 3/31/22

Michigan Department of
Environment, Great Lakes, and Energy
Oil, Gas and Minerals Division
Updated Permits
10/5/2020 THRU 10/9/2020



Permit Number Permittee Number Permittee Name

59182 6371 BREITBURN OPERATING LIMITED
PARTNERSHIP
1111 BAGBY STREET, SUITE 1600
HOUSTON, TX 77002

API Well Number: 21-079-59182-00-00

Well Name: STATE GARFIELD (RICHFIELD)
D2-9

Approval Date: 9/23/2020

Location	QT QT QT	Sec	Township	Range	Township Name	County	Feet From Section Line	Feet From DRLG Unit
SL:	NWSESW	9	25N	5W	GARFIELD	KALKASKA	990 S 1655 W	330 N 330 W
BHL:	NWSESW	9	25N	5W	GARFIELD	KALKASKA		

Proposed Rework: Temporarily Abandoned

Comment: ACOWS for TA expires on 3/31/24

59219 6371 BREITBURN OPERATING LIMITED
PARTNERSHIP
1111 BAGBY STREET, SUITE 1600
HOUSTON, TX 77002

API Well Number: 21-079-59219-00-00

Well Name: STATE GARFIELD (RICHFIELD)
A3-8

Approval Date: 9/23/2020

Location	QT QT QT	Sec	Township	Range	Township Name	County	Feet From Section Line	Feet From DRLG Unit
SL:	NWNWNE	8	25N	5W	GARFIELD	KALKASKA	455 N 2300 E	455 N 355 W
BHL:	NWNWNE	8	25N	5W	GARFIELD	KALKASKA		

Proposed Rework: Temporarily Abandoned

Comment: ACOWS for TA expires on 3/31/22

Michigan Department of
Environment, Great Lakes, and Energy
Oil, Gas and Minerals Division
Updated Permits
10/5/2020 THRU 10/9/2020



Permit Number Permittee Number Permittee Name

59222 6371 BREITBURN OPERATING LIMITED
PARTNERSHIP
1111 BAGBY STREET, SUITE 1600
HOUSTON, TX 77002

API Well Number: 21-079-59222-00-00

Well Name: STATE GARFIELD (RICHFIELD)
B3-8

Approval Date: 9/23/2020

Location	QT QT QT	Sec	Township	Range	Township Name	County	Feet From Section Line	Feet From DRLG Unit
SL:	NWSWNE	8	25N	5W	GARFIELD	KALKASKA	1654 N 2204 E	330 N 450 W
BHL:	NWSWNE	8	25N	5W	GARFIELD	KALKASKA		

Proposed Rework: Temporarily Abandoned

Comment: ACOWS for TA expires on 3/31/23

60565 6371 BREITBURN OPERATING LIMITED
PARTNERSHIP
1111 BAGBY STREET, SUITE 1600
HOUSTON, TX 77002

API Well Number: 21-039-60565-00-00

Well Name: STATE BEAVER CREEK (DRZ3) True Vertical Depth: 4230
A3-7

Approval Date: 9/23/2020

Location	QT QT QT	Sec	Township	Range	Township Name	County	Feet From Section Line	Feet From DRLG Unit
SL:	SWNENW	7	25N	4W	BEAVER CREEK	CRAWFORD	660 N 1616 W	
BHL:	SWNWNE	7	25N	4W	BEAVER CREEK	CRAWFORD	666 N 2125 E	666 N 2125 E

Proposed Rework: Temporarily Abandoned

Comment: ACOWS for TA expires on 3/31/24

Michigan Department of
Environment, Great Lakes, and Energy
Oil, Gas and Minerals Division
Updated Permits
10/5/2020 THRU 10/9/2020



Permit Number Permittee Number Permittee Name

RECORD OF CHANGE OF WELL STATUS:

12593 491 CONSUMERS ENERGY CO

1945 W PARNALL RD
JACKSON, MI 49201

API Well Number: 21-133-12593-00-00

Well Name: MICHIGAN GAS STORAGE CO
200

Change Date: 10/5/2018

Location	QT QT QT	Sec	Township	Range	Township Name	County	Feet From Section Line	Feet From DRLG Unit
SL:	CNNENE	36	20N	7W	MARION	OSCEOLA	660 N 660 E	
BHL:	CNNENE	36	20N	7W	MARION	OSCEOLA	660 N 660 E	

Proposed Rework: Reworked to Underreamed Open Hole

Comment: Reworked to log, underream, and return well to service.

12755 491 CONSUMERS ENERGY CO

1945 W PARNALL RD
JACKSON, MI 49201

API Well Number: 21-035-12755-00-00

Well Name: MICHIGAN GAS STORAGE CO
227

Change Date: 9/4/2018

Location	QT QT QT	Sec	Township	Range	Township Name	County	Feet From Section Line	Feet From DRLG Unit
SL:	CNNESW	31	20N	6W	WINTERFIELD	CLARE	660 N 660 E	
BHL:	CNNESW	31	20N	6W	WINTERFIELD	CLARE	660 N 660 E	

Proposed Rework: Reworked to Underreamed Open Hole

Comment: Reworked to clean hole, log, underream, and return well to service.

Michigan Department of
Environment, Great Lakes, and Energy
Oil, Gas and Minerals Division
Updated Permits
10/5/2020 THRU 10/9/2020



Permit Number Permittee Number Permittee Name

12760 491 CONSUMERS ENERGY CO
1945 W PARNALL RD
JACKSON, MI 49201

API Well Number: 21-035-12760-00-00

Well Name: MICHIGAN GAS STORAGE CO
232

Change Date: 9/22/2020

Location	QT QT QT	Sec	Township	Range	Township Name	County	Feet From Section Line	Feet From DRLG Unit
SL:	CNSWSW	31	20N	6W	WINTERFIELD	CLARE	660 S 530 W	
BHL:	CNSWSW	31	20N	6W	WINTERFIELD	CLARE	660 S 530 W	

Proposed Rework: Reworked for Miscellaneous

Comment: Reworked to pull plug, clean well, log, perf, underream, and return well to service.

12819 491 CONSUMERS ENERGY CO
1945 W PARNALL RD
JACKSON, MI 49201

API Well Number: 21-035-12819-00-00

Well Name: MICHIGAN GAS STORAGE CO
237

Change Date: 5/17/2018

Location	QT QT QT	Sec	Township	Range	Township Name	County	Feet From Section Line	Feet From DRLG Unit
SL:	CNNENE	29	20N	6W	WINTERFIELD	CLARE	660 N 660 E	
BHL:	CNNENE	29	20N	6W	WINTERFIELD	CLARE	660 N 660 E	

Proposed Rework: Reworked to Underreamed Open Hole

Comment: Reworked to clean hole, log, underream, and return well to service.

Michigan Department of
Environment, Great Lakes, and Energy
Oil, Gas and Minerals Division
Updated Permits
10/5/2020 THRU 10/9/2020



Permit Number Permittee Number Permittee Name

13088 491 CONSUMERS ENERGY CO
1945 W PARNALL RD
JACKSON, MI 49201

API Well Number: 21-035-13088-00-00

Well Name: MICHIGAN GAS STORAGE CO
258

Change Date: 12/12/2017

Location	QT QT QT	Sec	Township	Range	Township Name	County	Feet From Section Line	Feet From DRLG Unit
SL:	CNSENW	1	20N	6W	WINTERFIELD	CLARE	660 S 660 E	
BHL:	CNSENW	1	20N	6W	WINTERFIELD	CLARE	660 S 660 E	

Proposed Rework: Reworked to Underreamed Open Hole

Comment: Reworked to log, underream, and return to service.

13131 491 CONSUMERS ENERGY CO
1945 W PARNALL RD
JACKSON, MI 49201

API Well Number: 21-035-13131-00-00

Well Name: MICHIGAN GAS STORAGE CO
266

Change Date: 11/3/2017

Location	QT QT QT	Sec	Township	Range	Township Name	County	Feet From Section Line	Feet From DRLG Unit
SL:	CNNESW	34	20N	6W	WINTERFIELD	CLARE	660 N 660 E	
BHL:	CNNESW	34	20N	6W	WINTERFIELD	CLARE	660 N 660 E	

Proposed Rework: Reworked to Underreamed Open Hole

Comment: Reworked to pull packer, clean out hole, log, underream, and return well to service.

Michigan Department of
Environment, Great Lakes, and Energy
Oil, Gas and Minerals Division
Updated Permits
10/5/2020 THRU 10/9/2020



Permit Number Permittee Number Permittee Name

13132 491 CONSUMERS ENERGY CO
1945 W PARNALL RD
JACKSON, MI 49201

API Well Number: 21-035-13132-00-00

Well Name: MICHIGAN GAS STORAGE CO
267

Change Date: 10/19/2018

Location	QT QT QT	Sec	Township	Range	Township Name	County	Feet From Section Line	Feet From DRLG Unit
SL:	CNSES	34	20N	6W	WINTERFIELD	CLARE	660 S 660 E	
BHL:	CNSES	34	20N	6W	WINTERFIELD	CLARE	660 S 660 E	

Proposed Rework: Reworked to Underreamed Open Hole

Comment: Reworked to clean well, log, underream, and return well to service.

13182 491 CONSUMERS ENERGY CO
1945 W PARNALL RD
JACKSON, MI 49201

API Well Number: 21-035-13182-00-00

Well Name: MICHIGAN GAS STORAGE CO
274

Change Date: 5/22/2018

Location	QT QT QT	Sec	Township	Range	Township Name	County	Feet From Section Line	Feet From DRLG Unit
SL:	CNNWN	2	19N	6W	REDDING	CLARE	660 N 660 W	
BHL:	CNNWN	2	19N	6W	REDDING	CLARE	660 N 660 W	

Proposed Rework: Reworked to Underreamed Open Hole

Comment: Reworked to mill packer, pull packer, log, underream, and return well to service.

Michigan Department of
Environment, Great Lakes, and Energy
Oil, Gas and Minerals Division
Updated Permits
10/5/2020 THRU 10/9/2020



Permit Number Permittee Number Permittee Name

13184 491 CONSUMERS ENERGY CO
1945 W PARNALL RD
JACKSON, MI 49201

API Well Number: 21-035-13184-00-00

Well Name: MICHIGAN GAS STORAGE CO
276

Change Date: 11/19/2018

Location	QT QT QT	Sec	Township	Range	Township Name	County	Feet From Section Line	Feet From DRLG Unit
SL:	CNNESE	33	20N	6W	WINTERFIELD	CLARE	660 N 660 E	
BHL:	CNNESE	33	20N	6W	WINTERFIELD	CLARE	660 N 660 E	

Proposed Rework: Reworked to Underreamed Open Hole

Comment: Reworked to pull packer, clean out well, log well, underream, set packer, and return well to service.

13250 491 CONSUMERS ENERGY CO
1945 W PARNALL RD
JACKSON, MI 49201

API Well Number: 21-035-13250-00-00

Well Name: MICHIGAN GAS STORAGE CO
294

Change Date: 8/25/2017

Location	QT QT QT	Sec	Township	Range	Township Name	County	Feet From Section Line	Feet From DRLG Unit
SL:	CNSWNW	31	20N	6W	WINTERFIELD	CLARE	660 S 660 W	
BHL:	CNSWNW	31	20N	6W	WINTERFIELD	CLARE	660 S 660 W	

Proposed Rework: Reworked to Underreamed Open Hole

Comment: Reworked to pull packer, clean well, underream, log, run tubing, and return well to service.

Michigan Department of
 Environment, Great Lakes, and Energy
 Oil, Gas and Minerals Division
 Updated Permits
 10/5/2020 THRU 10/9/2020



MICHIGAN DEPARTMENT OF
 ENVIRONMENT, GREAT LAKES, AND ENERGY

Permit Number Permittee Number Permittee Name

13268 491 CONSUMERS ENERGY CO
 1945 W PARNALL RD
 JACKSON, MI 49201

API Well Number: 21-035-13268-00-00

Well Name: MGSC 299

Change Date: 12/20/2018

Location	QT QT QT	Sec	Township	Range	Township Name	County	Feet From Section Line	Feet From DRLG Unit
SL:	CNSWNW	33	20N	6W	WINTERFIELD	CLARE	660 S 660 W	
BHL:	CNSWNW	33	20N	6W	WINTERFIELD	CLARE	660 S 660 W	

Proposed Rework: Reworked to Underreamed Open Hole

Comment: Reworked to pull packer, clean well, log, set bridge plug @ 1235', pull tubing, underream, set packer, and return well to service.

13425 491 CONSUMERS ENERGY CO
 1945 W PARNALL RD
 JACKSON, MI 49201

API Well Number: 21-035-13425-00-00

Well Name: MICHIGAN GAS STORAGE CO
 325

Change Date: 7/15/2019

Location	QT QT QT	Sec	Township	Range	Township Name	County	Feet From Section Line	Feet From DRLG Unit
SL:	CNSWNW	30	20N	6W	WINTERFIELD	CLARE	660 S 660 W	
BHL:	CNSWNW	30	20N	6W	WINTERFIELD	CLARE	660 S 660 W	

Proposed Rework: Reworked to Underreamed Open Hole

Comment: Reworked to clean well, log, underream, and return well to service.

Michigan Department of
Environment, Great Lakes, and Energy
Oil, Gas and Minerals Division
Updated Permits
10/5/2020 THRU 10/9/2020



Permit Number Permittee Number Permittee Name

13427 491 CONSUMERS ENERGY CO
1945 W PARNALL RD
JACKSON, MI 49201

API Well Number: 21-035-13427-00-00

Well Name: MICHIGAN GAS STORAGE CO
331

Change Date: 3/7/2019

Location	QT QT QT	Sec	Township	Range	Township Name	County	Feet From Section Line	Feet From DRLG Unit
SL:	CNNWNW	30	20N	6W	WINTERFIELD	CLARE	595 N 735 W	
BHL:	CNNWNW	30	20N	6W	WINTERFIELD	CLARE	595 N 735 W	

Proposed Rework: Reworked to Underreamed Open Hole

Comment: Reworked to clean well, underream, and return well to service.

13583 491 CONSUMERS ENERGY CO
1945 W PARNALL RD
JACKSON, MI 49201

API Well Number: 21-035-13583-00-00

Well Name: MICHIGAN GAS STORAGE CO
337

Change Date: 7/31/2017

Location	QT QT QT	Sec	Township	Range	Township Name	County	Feet From Section Line	Feet From DRLG Unit
SL:	CNNENW	20	20N	6W	WINTERFIELD	CLARE	660 N 660 E	
BHL:	CNNENW	20	20N	6W	WINTERFIELD	CLARE	660 N 660 E	

Proposed Rework: Reworked to Underreamed Open Hole

Comment: Reworked to clean well, log, underream, and return well to service.

Michigan Department of
Environment, Great Lakes, and Energy
Oil, Gas and Minerals Division
Updated Permits
10/5/2020 THRU 10/9/2020



Permit Number Permittee Number Permittee Name

13927 491 CONSUMERS ENERGY CO

1945 W PARNALL RD
JACKSON, MI 49201

API Well Number: 21-035-13927-00-00

Well Name: MICHIGAN GAS STORAGE CO
340

Change Date: 12/5/2017

Location	QT QT QT	Sec	Township	Range	Township Name	County	Feet From Section Line	Feet From DRLG Unit
SL:	CNSWSW	16	20N	5W	SUMMERFIELD	CLARE	660 S 660 W	
BHL:	CNSWSW	16	20N	5W	SUMMERFIELD	CLARE	660 S 660 W	

Proposed Rework: Reworked to Underreamed Open Hole

Comment: Reworked to clean well, log, underream, and return well to service.

13928 491 CONSUMERS ENERGY CO

1945 W PARNALL RD
JACKSON, MI 49201

API Well Number: 21-035-13928-00-00

Well Name: MICHIGAN GAS STORAGE CO
341

Change Date: 12/11/2017

Location	QT QT QT	Sec	Township	Range	Township Name	County	Feet From Section Line	Feet From DRLG Unit
SL:	CNSES	16	20N	5W	SUMMERFIELD	CLARE	660 S 660 E	
BHL:	CNSES	16	20N	5W	SUMMERFIELD	CLARE	660 S 660 E	

Proposed Rework: Reworked to Underreamed Open Hole

Comment: Reworked to clean well, log, underream, and return well to service.

Michigan Department of
Environment, Great Lakes, and Energy
Oil, Gas and Minerals Division
Updated Permits
10/5/2020 THRU 10/9/2020



Permit Number Permittee Number Permittee Name

14058 491 CONSUMERS ENERGY CO
1945 W PARNALL RD
JACKSON, MI 49201

API Well Number: 21-035-14058-00-00

Well Name: MICHIGAN GAS STORAGE CO
365

Change Date: 2/13/2019

Location	QT QT QT	Sec	Township	Range	Township Name	County	Feet From Section Line	Feet From DRLG Unit
SL:	CSSENW	2	20N	6W	WINTERFIELD	CLARE	500 S 660 E	
BHL:	CSSENW	2	20N	6W	WINTERFIELD	CLARE	500 S 660 E	

Proposed Rework: Reworked to Underreamed Open Hole

Comment: Reworked to remove packer, clean well, underream, and return well to service.

14087 491 CONSUMERS ENERGY CO
1945 W PARNALL RD
JACKSON, MI 49201

API Well Number: 21-035-14087-00-00

Well Name: MICHIGAN GAS STORAGE CO
368

Change Date: 7/17/2019

Location	QT QT QT	Sec	Township	Range	Township Name	County	Feet From Section Line	Feet From DRLG Unit
SL:	NWNWNE	3	20N	6W	WINTERFIELD	CLARE	1980 S 660 W	
BHL:	NWNWNE	3	20N	6W	WINTERFIELD	CLARE		

Proposed Rework: Reworked to Underreamed Open Hole

Comment: Reworked to clean well, log, replace wellhead, underream, and return well to service.

Michigan Department of
Environment, Great Lakes, and Energy
Oil, Gas and Minerals Division
Updated Permits
10/5/2020 THRU 10/9/2020



Permit Number Permittee Number Permittee Name

14172 491 CONSUMERS ENERGY CO
1945 W PARNALL RD
JACKSON, MI 49201

API Well Number: 21-133-14172-00-00

Well Name: MICHIGAN GAS STORAGE CO
376

Change Date: 1/22/2019

Location	QT QT QT	Sec	Township	Range	Township Name	County	Feet From Section Line	Feet From DRLG Unit
SL:	CNNENE	25	20N	7W	MARION	OSCEOLA	660 N 660 E	
BHL:	CNNENE	25	20N	7W	MARION	OSCEOLA	660 N 660 E	

Proposed Rework: Reworked to Underreamed Open Hole

Comment: Reworked to log, underream, and return well to service.

14197 491 CONSUMERS ENERGY CO
1945 W PARNALL RD
JACKSON, MI 49201

API Well Number: 21-035-14197-00-00

Well Name: MICHIGAN GAS STORAGE CO
383

Change Date: 6/4/2018

Location	QT QT QT	Sec	Township	Range	Township Name	County	Feet From Section Line	Feet From DRLG Unit
SL:	CNNWSW	2	20N	6W	WINTERFIELD	CLARE	535 N 660 W	
BHL:	CNNWSW	2	20N	6W	WINTERFIELD	CLARE	535 N 660 W	

Proposed Rework: Reworked to Underreamed Open Hole

Comment: Reworked to pull packer, clean well, log, underream, replace packer, and return well to service.

Michigan Department of
Environment, Great Lakes, and Energy
Oil, Gas and Minerals Division
Updated Permits
10/5/2020 THRU 10/9/2020



Permit Number Permittee Number Permittee Name

14882 491 CONSUMERS ENERGY CO
1945 W PARNALL RD
JACKSON, MI 49201

API Well Number: 21-035-14882-00-00

Well Name: MICH GAS STORAGE 412

Change Date: 6/1/2018

Location	QT QT QT	Sec	Township	Range	Township Name	County	Feet From Section Line	Feet From DRLG Unit
SL:	CNNESW	8	20N	5W	SUMMERFIELD	CLARE	660 N 660 E	
BHL:	CNNESW	8	20N	5W	SUMMERFIELD	CLARE	660 N 660 E	

Proposed Rework: Reworked to Underreamed Open Hole

Comment: Reworked to clean well, log, underream, and return well to service.

20620 491 CONSUMERS ENERGY CO
1945 W PARNALL RD
JACKSON, MI 49201

API Well Number: 21-035-20620-00-00

Well Name: M G S C 906

Change Date: 8/2/2017

Location	QT QT QT	Sec	Township	Range	Township Name	County	Feet From Section Line	Feet From DRLG Unit
SL:	SESWNW	30	20N	6W	WINTERFIELD	CLARE	100 S 1220 W	
BHL:	SESWNW	30	20N	6W	WINTERFIELD	CLARE	100 S 1220 W	

Proposed Rework: Reworked to Underreamed Open Hole

Comment: Reworked to clean well, log, underream, and return well to service.

Michigan Department of
Environment, Great Lakes, and Energy
Oil, Gas and Minerals Division
Updated Permits
10/5/2020 THRU 10/9/2020



Permit Number Permittee Number Permittee Name

20653 491 CONSUMERS ENERGY CO
1945 W PARNALL RD
JACKSON, MI 49201

API Well Number: 21-035-20653-00-00

Well Name: M G S C 915

Change Date: 8/7/2017

Location	QT QT QT	Sec	Township	Range	Township Name	County	Feet From Section Line	Feet From DRLG Unit
SL:	SESESW	21	20N	6W	WINTERFIELD	CLARE	100 S 100 E	
BHL:	SESESW	21	20N	6W	WINTERFIELD	CLARE	100 S 100 E	

Proposed Rework: Reworked to Underreamed Open Hole

Comment: Reworked to clean well, log, underream, and return well to service.

20658 491 CONSUMERS ENERGY CO
1945 W PARNALL RD
JACKSON, MI 49201

API Well Number: 21-035-20658-00-00

Well Name: M G S C 925

Change Date: 3/8/2019

Location	QT QT QT	Sec	Township	Range	Township Name	County	Feet From Section Line	Feet From DRLG Unit
SL:	NENENW	34	20N	6W	WINTERFIELD	CLARE	100 N 100 E	
BHL:	NENENW	34	20N	6W	WINTERFIELD	CLARE	100 N 100 E	

Proposed Rework: Reworked to Underreamed Open Hole

Comment: Reworked to clean well, log, underream, replace tubing, and return well to service.

Michigan Department of
Environment, Great Lakes, and Energy
Oil, Gas and Minerals Division
Updated Permits
10/5/2020 THRU 10/9/2020



Permit Number Permittee Number Permittee Name

20963 491 CONSUMERS ENERGY CO
1945 W PARNALL RD
JACKSON, MI 49201

API Well Number: 21-035-20963-00-00

Well Name: M G S C 939

Change Date: 12/13/2018

Location	QT QT QT	Sec	Township	Range	Township Name	County	Feet From Section Line	Feet From DRLG Unit
SL:	SENE SW	1	20N	6W	WINTERFIELD	CLARE	1220 N 100 E	
BHL:	SENE SW	1	20N	6W	WINTERFIELD	CLARE	1220 N 100 E	

Proposed Rework: Reworked to Underreamed Open Hole

Comment: Reworked to clean well, log, underream, and return well to service.

20983 491 CONSUMERS ENERGY CO
1945 W PARNALL RD
JACKSON, MI 49201

API Well Number: 21-035-20983-00-00

Well Name: MGSC 959

Change Date: 9/22/2020

Location	QT QT QT	Sec	Township	Range	Township Name	County	Feet From Section Line	Feet From DRLG Unit
SL:	SESWNW	33	20N	6W	WINTERFIELD	CLARE	100 S 1320 W	
BHL:	SESWNW	33	20N	6W	WINTERFIELD	CLARE	100 S 1320 W	

Proposed Rework: Reworked to Underreamed Open Hole

Comment: Reworked to pull tubing, clean well, log, underream, install tubing, and return well to service.

Michigan Department of
Environment, Great Lakes, and Energy
Oil, Gas and Minerals Division
Updated Permits
10/5/2020 THRU 10/9/2020



Permit Number Permittee Number Permittee Name

21469 491 CONSUMERS ENERGY CO
1945 W PARNALL RD
JACKSON, MI 49201

API Well Number: 21-005-21469-00-00

Well Name: CONSUMERS POWER 27

Change Date: 8/2/2018

Location	QT QT QT	Sec	Township	Range	Township Name	County	Feet From Section Line	Feet From DRLG Unit
SL:	NEESE	15	4N	14W	OVERISEL	ALLEGAN	1170 S 75 E	
BHL:	NEESE	15	4N	14W	OVERISEL	ALLEGAN		

Proposed Rework: Reworked to Underreamed Open Hole

Comment: Reworked to log, underream, and return well to service.

21480 491 CONSUMERS ENERGY CO
1945 W PARNALL RD
JACKSON, MI 49201

API Well Number: 21-005-21480-00-00

Well Name: CONSUMERS POWER 21

Change Date: 7/9/2018

Location	QT QT QT	Sec	Township	Range	Township Name	County	Feet From Section Line	Feet From DRLG Unit
SL:	NENESE	16	4N	14W	OVERISEL	ALLEGAN	50 N 75 E	
BHL:	NENESE	16	4N	14W	OVERISEL	ALLEGAN	50 N 75 E	

Proposed Rework: Reworked to Underreamed Open Hole

Comment: Reworked to log, pull bridge plug, clean hole, underream, run tubing, and return well to service.

Michigan Department of
 Environment, Great Lakes, and Energy
 Oil, Gas and Minerals Division
 Updated Permits
 10/5/2020 THRU 10/9/2020



MICHIGAN DEPARTMENT OF
 ENVIRONMENT, GREAT LAKES, AND ENERGY

Permit Number: 23136
 Permittee Number: 491
 Permittee Name: CONSUMERS ENERGY CO
 1945 W PARNALL RD
 JACKSON, MI 49201

API Well Number: 21-005-23136-00-00
 Well Name: CONSUMERS POWER 290
 Change Date: 6/21/2018

Location	QT QT QT	Sec	Township	Range	Township Name	County	Feet From Section Line	Feet From DRLG Unit
SL:	E2SE	27	4N	14W	OVERISEL	ALLEGAN	660 S 537 E	
BHL:	E2SE	27	4N	14W	OVERISEL	ALLEGAN	660 S 537 E	

Proposed Rework: Reworked to Underreamed Open Hole
 Comment: Reworked to log, underream, install tubing, and return well to service.

Permit Number: 23137
 Permittee Number: 491
 Permittee Name: CONSUMERS ENERGY CO
 1945 W PARNALL RD
 JACKSON, MI 49201

API Well Number: 21-005-23137-00-00
 Well Name: CONSUMERS POWER 289
 Change Date: 7/17/2018

Location	QT QT QT	Sec	Township	Range	Township Name	County	Feet From Section Line	Feet From DRLG Unit
SL:	CNSWNW	27	4N	14W	OVERISEL	ALLEGAN	660 S 654 W	
BHL:	CNSWNW	27	4N	14W	OVERISEL	ALLEGAN	660 S 654 W	

Proposed Rework: Reworked to Underreamed Open Hole
 Comment: Reworked to log, underream, and return well to service.

Michigan Department of
Environment, Great Lakes, and Energy
Oil, Gas and Minerals Division
Updated Permits
10/5/2020 THRU 10/9/2020



Permit Number Permittee Number Permittee Name

23154 491 CONSUMERS ENERGY CO
1945 W PARNALL RD
JACKSON, MI 49201

API Well Number: 21-005-23154-00-00

Well Name: CONSUMERS POWER 283

Change Date: 6/26/2018

Location	QT QT QT	Sec	Township	Range	Township Name	County	Feet From Section Line	Feet From DRLG Unit
SL:	N2SWSE	22	4N	14W	OVERISEL	ALLEGAN	680 S 660 W	
BHL:	N2SWSE	22	4N	14W	OVERISEL	ALLEGAN		

Proposed Rework: Reworked to Underreamed Open Hole

Comment: reworked to log, pull plug, underream, and return well to service.

23163 491 CONSUMERS ENERGY CO
1945 W PARNALL RD
JACKSON, MI 49201

API Well Number: 21-005-23163-00-00

Well Name: CONSUMERS POWER 270

Change Date: 6/27/2018

Location	QT QT QT	Sec	Township	Range	Township Name	County	Feet From Section Line	Feet From DRLG Unit
SL:	NWSENE	21	4N	14W	OVERISEL	ALLEGAN	720 S 665 E	
BHL:	NWSENE	21	4N	14W	OVERISEL	ALLEGAN		

Proposed Rework: Reworked to Underreamed Open Hole

Comment: Reworked to log, underream, install tubing, and return well to service.

Michigan Department of
Environment, Great Lakes, and Energy
Oil, Gas and Minerals Division
Updated Permits
10/5/2020 THRU 10/9/2020



Permit Number Permittee Number Permittee Name

23237 491 CONSUMERS ENERGY CO
1945 W PARNALL RD
JACKSON, MI 49201

API Well Number: 21-005-23237-00-00

Well Name: CONSUMERS POWER CO 281

Change Date: 6/22/2018

Location	QT QT QT	Sec	Township	Range	Township Name	County	Feet From Section Line	Feet From DRLG Unit
SL:	NESWSW	22	4N	14W	OVERISEL	ALLEGAN	700 S 690 W	
BHL:	NESWSW	22	4N	14W	OVERISEL	ALLEGAN	700 S 690 W	

Proposed Rework: Reworked to Underreamed Open Hole

Comment: Reworked to mill and pull old tubing, log, underream, install tubing, and return well to service.

23331 491 CONSUMERS ENERGY CO
1945 W PARNALL RD
JACKSON, MI 49201

API Well Number: 21-005-23331-00-00

Well Name: CONSUMERS POWER CO 259

Change Date: 8/2/2018

Location	QT QT QT	Sec	Township	Range	Township Name	County	Feet From Section Line	Feet From DRLG Unit
SL:	S2NESW	14	4N	14W	OVERISEL	ALLEGAN	695 N 660 E	
BHL:	S2NESW	14	4N	14W	OVERISEL	ALLEGAN		

Proposed Rework: Reworked to Underreamed Open Hole

Comment: Reworked to pull plug, clean well, underream, install tubing, perform MIT, and return well to ser

Michigan Department of
 Environment, Great Lakes, and Energy
 Oil, Gas and Minerals Division
 Updated Permits
 10/5/2020 THRU 10/9/2020



MICHIGAN DEPARTMENT OF
 ENVIRONMENT, GREAT LAKES, AND ENERGY

Permit Number Permittee Number Permittee Name

24217 491 CONSUMERS ENERGY CO
 1945 W PARNALL RD
 JACKSON, MI 49201

API Well Number: 21-005-24217-00-00
 Well Name: CONSUMERS POWER CO S-307
 Change Date: 5/22/2019

Location	QT QT QT	Sec	Township	Range	Township Name	County	Feet From Section Line	Feet From DRLG Unit
SL:	N2N2NW	23	4N	13W	SALEM	ALLEGAN	100 N 1320 E	
BHL:	N2N2NW	23	4N	13W	SALEM	ALLEGAN		

Proposed Rework: Reworked for Miscellaneous Comment: Reworked to pull tubing, log, perform MIT, plugback 16' to 2765', reset packer at 2686', pump acid, and return well to service.

31148 7772 LAMBDA ENERGY RESOURCES LLC
 12012 Wickchester
 Suite 300
 Houston, TX 77055 USA

API Well Number: 21-055-31148-00-00
 Well Name: PHOENIX PETROLEUM CORPORATION 2-28
 Change Date: 10/10/2019

Location	QT QT QT	Sec	Township	Range	Township Name	County	Feet From Section Line	Feet From DRLG Unit
SL:	NWNENW	28	25N	11W	MAYFIELD	GRAND TRAVERSE	83 N 1280 E	1232 S 1280 E
BHL:	NWNENW	28	25N	11W	MAYFIELD	GRAND TRAVERSE		

Proposed Rework: Reworked for Miscellaneous Comment: Reworked to add perfs and acidize in the Niagaran.

Michigan Department of
 Environment, Great Lakes, and Energy
 Oil, Gas and Minerals Division
 Updated Permits
 10/5/2020 THRU 10/9/2020



MICHIGAN DEPARTMENT OF
 ENVIRONMENT, GREAT LAKES, AND ENERGY

Permit Number Permittee Number Permittee Name

61116 5320 SAVOY ENERGY LP
 920 HASTINGS STREET, SUITE A
 PO BOX 1560
 TRAVERSE CITY, MI 49685-1560

API Well Number: 21-091-60877-01-00

Well Name: DAY 3-27A

True Vertical Depth: 3139

Change Date: 9/1/2020

Location	QT QT QT	Sec	Township	Range	Township Name	County	Feet From Section Line	Feet From DRLG Unit
SL:	NESESW	27	6S	3E	ADRIAN	LENAWEE	737 S 2258 W	
BHL:	NWSWSE	27	6S	3E	ADRIAN	LENAWEE	859 S 2085 E	470 N 585 W

Proposed Rework: Reworked to Continue Drilling - Straight Hole

Comment: Reworked to deepen directional slant to 3451' in the Trenton (same formation) and acidize.

