

Michigan Department of
Environment, Great Lakes, and Energy
Oil, Gas and Minerals Division

PERMIT LIST

10/7/2019 THRU 10/11/2019



Permit Number Issue Date Permittee Number Permittee Name Page 1

61453 10/9/2019 40 MUSKEGON DEVELOPMENT COMPANY
1425 S MISSION RD
MOUNT PLEASANT, MI 48858

API Well No: 21-129-62002-00-00

Prev Permit:

Well Name: STATE FOSTER RCU 3-28

Well Type: Oil Well

Permit Type: Drill

H2S Present? Yes

Surface Owner: State of Michigan

True Vertical Depth: 4650FT

Target Formation: RICHFIELD

Deepest Formation: SYLVANIA

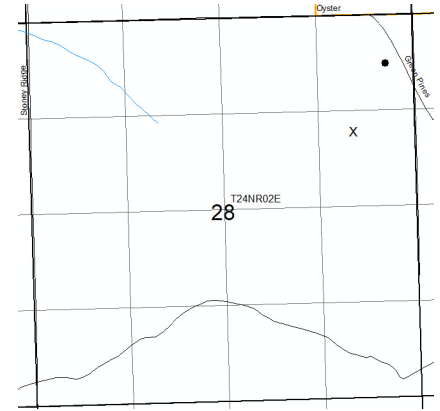

Rose City Unit, Order 197-6

Location:	QT QT QT	Sec	Township	Range	Township Name	County	Feet From Section Line	Feet From DRLG Unit Line
SL:	NWSENE	28	24N	2E	FOSTER	OGEMAW	1686 N 907 E	
BHL:	SENESE	28	24N	2E	FOSTER	OGEMAW	723 N 370 E	

61454 10/10/2019 104 WEST BAY EXPLORATION COMPANY
13685 S WEST BAYSHORE DR
TRAVERSE CITY, MI 49684

API Well No: 21-035-62012-01-00

Prev Permit: 61417

Well Name: CLARE NORTHERN 1-23A

Well Type: Oil Well

Permit Type: Deepen

H2S Present? Yes

Surface Owner: Clare Northern Group LLC

True Vertical Depth: 3848FT

Target Formation: DUNDEE

Deepest Formation: DUNDEE

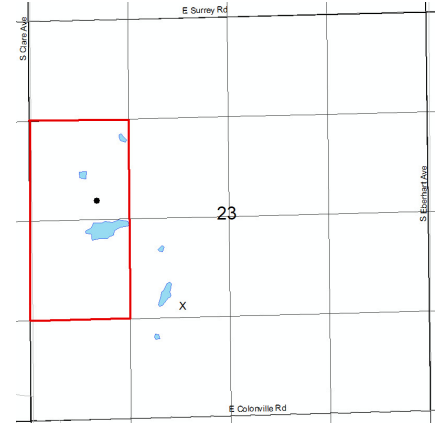

S.O. 03-2019, 80-acre Drilling unit

Location:	QT QT QT	Sec	Township	Range	Township Name	County	Feet From Section Line	Feet From DRLG Unit Line
SL:	SENESE	23	17N	4W	GRANT	CLARE	1462 S 2006 W	
BHL:	SESWNW	23	17N	4W	GRANT	CLARE	2400 N 900 W	1078 N 421 E

Michigan Department of
Environment, Great Lakes, and Energy

Oil, Gas, and Minerals Division

Updated Permits

10/7/2019 THRU 10/11/2019



Permit Number Permittee Number Permittee Name

RECORD OF WELL PLUGGING:

48738 6361 RIVERSIDE ENERGY MICHIGAN LLC
10691 EAST CARTER ROAD
SUITE 201
TRAVERSE CITY, MI49684

API Well Number: 21-007-48738-00-00

Well Name: STATE OSSINEKE 2-3

Plugging Date: 9/16/2019

Location	QT QT QT	Sec	Township	Range	Township Name	County	Feet From Section Line	Feet From DRLG Unit
SL:	NENWNE	3	29N	6E	OSSINEKE	ALPENA	387 N 944 W	387 N 370 E

Michigan Department of
Environment, Great Lakes, and Energy
Oil, Gas, and Minerals Division
Updated Permits
10/7/2019 THRU 10/11/2019



Permit
Number

Permittee
Number

Permittee
Name

Page 2

TRANSFER OF OWNERSHIP:

TABLES FOLLOW THIS PAGE

Transfer Date	Previous Operator	New Operator	WellName	Permit	County	TwpNm	Sec	Twp	TwpDir	Rng	RngDir
10/07/2019	RIVIERA OPERATING LLC	RIVERSIDE ENERGY MICHIGAN LLC	GUTHRIE TRUST B3-15	45794	OTSEGO	CHESTER	15	30	N	2	W
10/07/2019	RIVIERA OPERATING LLC	RIVERSIDE ENERGY MICHIGAN LLC	STATE BRILEY A4-34	59903	MONTMORENCY	BRILEY	34	30	N	2	E
10/07/2019	RIVIERA OPERATING LLC	RIVERSIDE ENERGY MICHIGAN LLC	TOTEFF 3-1 HD1	41872	OTSEGO	CHESTER	1	29	N	2	W
10/07/2019	RIVIERA OPERATING LLC	RIVERSIDE ENERGY MICHIGAN LLC	WERNIG 2-1 HD1	41884	OTSEGO	CHESTER	1	29	N	2	W
10/07/2019	RIVIERA OPERATING LLC	RIVERSIDE ENERGY MICHIGAN LLC	WERNIG 6-1 HD1	41938	OTSEGO	CHESTER	1	29	N	2	W
10/07/2019	RIVIERA OPERATING LLC	RIVERSIDE ENERGY MICHIGAN LLC	NORTH MICHIGAN LAND AND OIL 4-29A SWD	33212	OTSEGO	HAYES	29	29	N	4	W
10/07/2019	RIVIERA OPERATING LLC	RIVERSIDE ENERGY MICHIGAN LLC	DOVER 1-36 SWD	31220	OTSEGO	DOVER	36	31	N	2	W
10/07/2019	RIVIERA OPERATING LLC	RIVERSIDE ENERGY MICHIGAN LLC	STATE BRILEY ET AL A4-28	57998	MONTMORENCY	BRILEY	28	30	N	2	E
10/07/2019	RIVIERA OPERATING LLC	RIVERSIDE ENERGY MICHIGAN LLC	U S A BRILEY ET AL D3-28	57994	MONTMORENCY	BRILEY	28	30	N	2	E
10/07/2019	RIVIERA OPERATING LLC	RIVERSIDE ENERGY MICHIGAN LLC	STATE BRILEY TWIN B3-27	57866	MONTMORENCY	BRILEY	27	30	N	2	E
10/07/2019	RIVIERA OPERATING LLC	RIVERSIDE ENERGY MICHIGAN LLC	STATE BRILEY TWIN B2-22	57864	MONTMORENCY	BRILEY	22	30	N	2	E
10/07/2019	RIVIERA OPERATING LLC	RIVERSIDE ENERGY MICHIGAN LLC	TERRA ENERGY ET AL TWIN D4-33	57862	MONTMORENCY	BRILEY	33	30	N	2	E
10/07/2019	RIVIERA OPERATING LLC	RIVERSIDE ENERGY MICHIGAN LLC	U S A STATE BRILEY ET AL TWIN D1-27	57861	MONTMORENCY	BRILEY	27	30	N	2	E
10/07/2019	RIVIERA OPERATING LLC	RIVERSIDE ENERGY MICHIGAN LLC	STATE BRILEY TWIN D3-22	57858	MONTMORENCY	BRILEY	22	30	N	2	E
10/07/2019	RIVIERA OPERATING LLC	RIVERSIDE ENERGY MICHIGAN LLC	JOY TWIN A4-18	57857	MONTMORENCY	RUST	18	29	N	4	E
10/07/2019	RIVIERA OPERATING LLC	RIVERSIDE ENERGY MICHIGAN LLC	JOY TWIN A4-18 HD1	57857	MONTMORENCY	RUST	18	29	N	4	E
10/07/2019	RIVIERA OPERATING LLC	RIVERSIDE ENERGY MICHIGAN LLC	JOY TWIN A4-18 HD2	57857	MONTMORENCY	RUST	18	29	N	4	E
10/07/2019	RIVIERA OPERATING LLC	RIVERSIDE ENERGY MICHIGAN LLC	JOY TWIN A2-18	57856	MONTMORENCY	RUST	18	29	N	4	E
10/07/2019	RIVIERA OPERATING LLC	RIVERSIDE ENERGY MICHIGAN LLC	JOY TWIN C1-8	57855	MONTMORENCY	RUST	8	29	N	4	E
10/07/2019	RIVIERA OPERATING LLC	RIVERSIDE ENERGY MICHIGAN LLC	JOY TWIN B3-7	57854	MONTMORENCY	RUST	7	29	N	4	E
10/07/2019	RIVIERA OPERATING LLC	RIVERSIDE ENERGY MICHIGAN LLC	STATE RUST TWIN B2-19	57853	MONTMORENCY	RUST	19	29	N	4	E
10/07/2019	RIVIERA OPERATING LLC	RIVERSIDE ENERGY MICHIGAN LLC	U S A BRILEY & COCKING B4-28	57441	MONTMORENCY	BRILEY	28	30	N	2	E
10/07/2019	RIVIERA OPERATING LLC	RIVERSIDE ENERGY MICHIGAN LLC	STATE ALBERT A4-10	56560	MONTMORENCY	ALBERT	10	29	N	1	E
10/07/2019	RIVIERA OPERATING LLC	RIVERSIDE ENERGY MICHIGAN LLC	STATE LOUD B3-24	56554	MONTMORENCY	LOUD	24	29	N	3	E
10/07/2019	RIVIERA OPERATING LLC	RIVERSIDE ENERGY MICHIGAN LLC	KAMINSKE TRUST & CUMPER C3-16	56536	MONTMORENCY	LOUD	16	29	N	3	E
10/07/2019	RIVIERA OPERATING LLC	RIVERSIDE ENERGY MICHIGAN LLC	SPEER ET AL C2-16	56535	MONTMORENCY	LOUD	16	29	N	3	E
10/07/2019	RIVIERA OPERATING LLC	RIVERSIDE ENERGY MICHIGAN LLC	STATE BRILEY ET AL C1-23	56531	MONTMORENCY	BRILEY	23	30	N	2	E
10/07/2019	RIVIERA OPERATING LLC	RIVERSIDE ENERGY MICHIGAN LLC	GAWLAS & EDMONDS A1-35	56149	MONTMORENCY	LOUD	35	29	N	3	E
10/07/2019	RIVIERA OPERATING LLC	RIVERSIDE ENERGY MICHIGAN LLC	ERWIN & MAURER C3-36	55830	MONTMORENCY	LOUD	36	29	N	3	E
10/07/2019	RIVIERA OPERATING LLC	RIVERSIDE ENERGY MICHIGAN LLC	STATE LOUD C3-26	55829	MONTMORENCY	LOUD	26	29	N	3	E
10/07/2019	RIVIERA OPERATING LLC	RIVERSIDE ENERGY MICHIGAN LLC	PAFFI ET AL D4-11	55820	MONTMORENCY	ALBERT	11	29	N	1	E
10/07/2019	RIVIERA OPERATING LLC	RIVERSIDE ENERGY MICHIGAN LLC	PAFFI ET AL D2-11	55646	MONTMORENCY	ALBERT	11	29	N	1	E
10/07/2019	RIVIERA OPERATING LLC	RIVERSIDE ENERGY MICHIGAN LLC	PAFFI ET AL C4-11	55645	MONTMORENCY	ALBERT	11	29	N	1	E
10/07/2019	RIVIERA OPERATING LLC	RIVERSIDE ENERGY MICHIGAN LLC	STATE LOUD C4-22	55569	MONTMORENCY	LOUD	22	29	N	3	E
10/07/2019	RIVIERA OPERATING LLC	RIVERSIDE ENERGY MICHIGAN LLC	STATE LOUD & USA C1-8	55529	MONTMORENCY	LOUD	8	29	N	3	E
10/07/2019	RIVIERA OPERATING LLC	RIVERSIDE ENERGY MICHIGAN LLC	STATE LOUD D3-8	55504	MONTMORENCY	LOUD	8	29	N	3	E
10/07/2019	RIVIERA OPERATING LLC	RIVERSIDE ENERGY MICHIGAN LLC	STATE LOUD B2-10	55503	MONTMORENCY	LOUD	10	29	N	3	E
10/07/2019	RIVIERA OPERATING LLC	RIVERSIDE ENERGY MICHIGAN LLC	U S A LOUD D2-5	55502	MONTMORENCY	LOUD	5	29	N	3	E
10/07/2019	RIVIERA OPERATING LLC	RIVERSIDE ENERGY MICHIGAN LLC	CUMPER ET AL C4-9	55501	MONTMORENCY	LOUD	9	29	N	3	E
10/07/2019	RIVIERA OPERATING LLC	RIVERSIDE ENERGY MICHIGAN LLC	MYCKOWIAK TRUST ET AL D2-19	55389	MONTMORENCY	RUST	19	29	N	4	E
10/07/2019	RIVIERA OPERATING LLC	RIVERSIDE ENERGY MICHIGAN LLC	JOY B4-7	55379	MONTMORENCY	RUST	7	29	N	4	E
10/07/2019	RIVIERA OPERATING LLC	RIVERSIDE ENERGY MICHIGAN LLC	STATE RUST & MORRIS C1-19	55367	MONTMORENCY	RUST	19	29	N	4	E
10/07/2019	RIVIERA OPERATING LLC	RIVERSIDE ENERGY MICHIGAN LLC	JOY B4-19	55366	MONTMORENCY	RUST	19	29	N	4	E
10/07/2019	RIVIERA OPERATING LLC	RIVERSIDE ENERGY MICHIGAN LLC	RIVERSIDE ENERGY MICHIGAN LLC	55365	MONTMORENCY	RUST	19	29	N	4	E
10/07/2019	RIVIERA OPERATING LLC	RIVERSIDE ENERGY MICHIGAN LLC	JOY C4-18	55364	MONTMORENCY	RUST	18	29	N	4	E
10/07/2019	RIVIERA OPERATING LLC	RIVERSIDE ENERGY MICHIGAN LLC	JOY C1-18	55363	MONTMORENCY	RUST	18	29	N	4	E
10/07/2019	RIVIERA OPERATING LLC	RIVERSIDE ENERGY MICHIGAN LLC	JOY B2-18	55362	MONTMORENCY	RUST	18	29	N	4	E
10/07/2019	RIVIERA OPERATING LLC	RIVERSIDE ENERGY MICHIGAN LLC	JOY D4-7	55361	MONTMORENCY	RUST	7	29	N	4	E
10/07/2019	RIVIERA OPERATING LLC	RIVERSIDE ENERGY MICHIGAN LLC	JOY D1-7	55360	MONTMORENCY	RUST	7	29	N	4	E
10/07/2019	RIVIERA OPERATING LLC	RIVERSIDE ENERGY MICHIGAN LLC	JOY B2-7	55359	MONTMORENCY	RUST	7	29	N	4	E
10/07/2019	RIVIERA OPERATING LLC	RIVERSIDE ENERGY MICHIGAN LLC	JOY B1-7	55358	MONTMORENCY	RUST	7	29	N	4	E
10/07/2019	RIVIERA OPERATING LLC	RIVERSIDE ENERGY MICHIGAN LLC	STATE ALBERT C4-11	55343	MONTMORENCY	ALBERT	11	29	N	2	E
10/07/2019	RIVIERA OPERATING LLC	RIVERSIDE ENERGY MICHIGAN LLC	MCMURPHY ET AL A2-28	55324	MONTMORENCY	BRILEY	28	30	N	2	E
10/07/2019	RIVIERA OPERATING LLC	RIVERSIDE ENERGY MICHIGAN LLC	STATE ALBERT B2-13	55323	MONTMORENCY	ALBERT	13	29	N	2	E
10/07/2019	RIVIERA OPERATING LLC	RIVERSIDE ENERGY MICHIGAN LLC	STATE ALBERT D3-12	55322	MONTMORENCY	ALBERT	12	29	N	2	E

Transfer Date	Previous Operator	New Operator	WellName	Permit	County	TwpNm	Sec	Twp	TwpDir	Rng	RngDir
10/07/2019	RIVIERA OPERATING LLC	RIVERSIDE ENERGY MICHIGAN LLC	STATE ALBERT B2-12	55321	MONTMORENCY	ALBERT	12	29	N		2 E
10/07/2019	RIVIERA OPERATING LLC	RIVERSIDE ENERGY MICHIGAN LLC	STATE ALBERT A3-11	55320	MONTMORENCY	ALBERT	11	29	N		2 E
10/07/2019	RIVIERA OPERATING LLC	RIVERSIDE ENERGY MICHIGAN LLC	STATE BRILEY B4-32	55280	MONTMORENCY	BRILEY	32	30	N		2 E
10/07/2019	RIVIERA OPERATING LLC	RIVERSIDE ENERGY MICHIGAN LLC	STATE BRILEY A2-26	55279	MONTMORENCY	BRILEY	26	30	N		2 E
10/07/2019	RIVIERA OPERATING LLC	RIVERSIDE ENERGY MICHIGAN LLC	STATE BRILEY A2-27	55277	MONTMORENCY	BRILEY	27	30	N		2 E
10/07/2019	RIVIERA OPERATING LLC	RIVERSIDE ENERGY MICHIGAN LLC	STATE BRILEY A2-34	55276	MONTMORENCY	BRILEY	34	30	N		2 E
10/07/2019	RIVIERA OPERATING LLC	RIVERSIDE ENERGY MICHIGAN LLC	STATE BRILEY C4-29	55275	MONTMORENCY	BRILEY	29	30	N		2 E
10/07/2019	RIVIERA OPERATING LLC	RIVERSIDE ENERGY MICHIGAN LLC	STATE BRILEY B4-22	55274	MONTMORENCY	BRILEY	22	30	N		2 E
10/07/2019	RIVIERA OPERATING LLC	RIVERSIDE ENERGY MICHIGAN LLC	HENRY B JOY III TRUST B3-18	53653	MONTMORENCY	RUST	18	29	N		4 E
10/07/2019	RIVIERA OPERATING LLC	RIVERSIDE ENERGY MICHIGAN LLC	HENRY B JOY III TRUST A2-18	53652	MONTMORENCY	RUST	18	29	N		4 E
10/07/2019	RIVIERA OPERATING LLC	RIVERSIDE ENERGY MICHIGAN LLC	STATE BRILEY A4-23	48952	MONTMORENCY	BRILEY	23	30	N		2 E
10/07/2019	RIVIERA OPERATING LLC	RIVERSIDE ENERGY MICHIGAN LLC	STATE BRILEY B1-23	48812	MONTMORENCY	BRILEY	23	30	N		2 E
10/07/2019	RIVIERA OPERATING LLC	RIVERSIDE ENERGY MICHIGAN LLC	STATE BRILEY B2-22	48800	MONTMORENCY	BRILEY	22	30	N		2 E
10/07/2019	RIVIERA OPERATING LLC	RIVERSIDE ENERGY MICHIGAN LLC	BRILEY D1-23	47329	MONTMORENCY	BRILEY	23	30	N		2 E
10/07/2019	RIVIERA OPERATING LLC	RIVERSIDE ENERGY MICHIGAN LLC	WILDWOOD CLUB B1-6	47217	MONTMORENCY	RUST	6	29	N		4 E
10/07/2019	RIVIERA OPERATING LLC	RIVERSIDE ENERGY MICHIGAN LLC	PICCININI C2-6	47215	MONTMORENCY	RUST	6	29	N		4 E
10/07/2019	RIVIERA OPERATING LLC	RIVERSIDE ENERGY MICHIGAN LLC	WILDWOOD CLUB A2-6	47214	MONTMORENCY	RUST	6	29	N		4 E
10/07/2019	RIVIERA OPERATING LLC	RIVERSIDE ENERGY MICHIGAN LLC	STATE BRILEY B3-22	47083	MONTMORENCY	BRILEY	22	30	N		2 E
10/07/2019	RIVIERA OPERATING LLC	RIVERSIDE ENERGY MICHIGAN LLC	STATE RUST D1-19	47043	MONTMORENCY	RUST	19	29	N		4 E
10/07/2019	RIVIERA OPERATING LLC	RIVERSIDE ENERGY MICHIGAN LLC	LOCKWOOD LAKE RANCH A4-18	46878	MONTMORENCY	RUST	18	29	N		4 E
10/07/2019	RIVIERA OPERATING LLC	RIVERSIDE ENERGY MICHIGAN LLC	LOCKWOOD LAKE RANCH C4-19	46877	MONTMORENCY	RUST	19	29	N		4 E
10/07/2019	RIVIERA OPERATING LLC	RIVERSIDE ENERGY MICHIGAN LLC	LOCKWOOD LAKE RANCH A3-19	46876	MONTMORENCY	RUST	19	29	N		4 E
10/07/2019	RIVIERA OPERATING LLC	RIVERSIDE ENERGY MICHIGAN LLC	LOCKWOOD LAKE RANCH C1-7	46769	MONTMORENCY	RUST	7	29	N		4 E
10/07/2019	RIVIERA OPERATING LLC	RIVERSIDE ENERGY MICHIGAN LLC	LOCKWOOD LAKE RANCH B3-7	46768	MONTMORENCY	RUST	7	29	N		4 E
10/07/2019	RIVIERA OPERATING LLC	RIVERSIDE ENERGY MICHIGAN LLC	LOCKWOOD LAKE RANCH A4-7	46767	MONTMORENCY	RUST	7	29	N		4 E
10/07/2019	RIVIERA OPERATING LLC	RIVERSIDE ENERGY MICHIGAN LLC	LOCKWOOD LAKE RANCH D2-18	46766	MONTMORENCY	RUST	18	29	N		4 E
10/07/2019	RIVIERA OPERATING LLC	RIVERSIDE ENERGY MICHIGAN LLC	LOCKWOOD LAKE RANCH C1-8	46765	MONTMORENCY	RUST	8	29	N		4 E
10/07/2019	RIVIERA OPERATING LLC	RIVERSIDE ENERGY MICHIGAN LLC	TOONS 15 C4-15	58176	ANTRIM	MANCELONA	15	29	N		5 W
10/07/2019	RIVIERA OPERATING LLC	RIVERSIDE ENERGY MICHIGAN LLC	TOONS 15 B4-15	58175	ANTRIM	MANCELONA	15	29	N		5 W
10/07/2019	RIVIERA OPERATING LLC	RIVERSIDE ENERGY MICHIGAN LLC	BIJOU WEST D1-15	57094	ANTRIM	MANCELONA	15	29	N		6 W
10/07/2019	RIVIERA OPERATING LLC	RIVERSIDE ENERGY MICHIGAN LLC	BIJOU EAST D3-12	57028	ANTRIM	MANCELONA	12	29	N		6 W
10/07/2019	RIVIERA OPERATING LLC	RIVERSIDE ENERGY MICHIGAN LLC	BIJOU A1-1	50655	ANTRIM	MANCELONA	1	29	N		6 W
10/07/2019	RIVIERA OPERATING LLC	RIVERSIDE ENERGY MICHIGAN LLC	STATE MANCELONA (BIJOU) B1-13	49095	ANTRIM	MANCELONA	13	29	N		6 W
10/07/2019	RIVIERA OPERATING LLC	RIVERSIDE ENERGY MICHIGAN LLC	BIJOU A3-14	49091	ANTRIM	MANCELONA	14	29	N		6 W
10/07/2019	RIVIERA OPERATING LLC	RIVERSIDE ENERGY MICHIGAN LLC	BIJOU C1-15	48576	ANTRIM	MANCELONA	15	29	N		6 W
10/07/2019	RIVIERA OPERATING LLC	RIVERSIDE ENERGY MICHIGAN LLC	STATE MANCELONA I A3-15	48145	ANTRIM	MANCELONA	15	29	N		5 W
10/07/2019	RIVIERA OPERATING LLC	RIVERSIDE ENERGY MICHIGAN LLC	MANCELONA I B2-5	47194	ANTRIM	MANCELONA	5	29	N		5 W
10/07/2019	RIVIERA OPERATING LLC	RIVERSIDE ENERGY MICHIGAN LLC	MANCELONA I D3-5	47192	ANTRIM	MANCELONA	5	29	N		5 W
10/08/2019	RIVIERA OPERATING LLC	RIVERSIDE ENERGY MICHIGAN LLC	VALEK ET AL A1-34	58130	OTSEGO	CHARLTON	34	31	N		1 W
10/08/2019	RIVIERA OPERATING LLC	RIVERSIDE ENERGY MICHIGAN LLC	HOWARD TRUST C1-35	58099	OTSEGO	CHARLTON	35	31	N		1 W
10/08/2019	RIVIERA OPERATING LLC	NU ENERGY OPERATING INC	MARSTRAND 1-27A	50161	OTSEGO	CHARLTON	27	31	N		1 W
10/08/2019	RIVIERA OPERATING LLC	RIVERSIDE ENERGY MICHIGAN LLC	TOTEFF A2-1	41527	OTSEGO	CHESTER	1	29	N		2 W
10/08/2019	RIVIERA OPERATING LLC	RIVERSIDE ENERGY MICHIGAN LLC	TOTEFF A1-1	41547	OTSEGO	CHESTER	1	29	N		2 W
10/08/2019	RIVIERA OPERATING LLC	RIVERSIDE ENERGY MICHIGAN LLC	STATE MONTMORENCY D2-26	57146	MONTMORENCY	MONTMORENCY	26	32	N		2 E
10/08/2019	RIVIERA OPERATING LLC	RIVERSIDE ENERGY MICHIGAN LLC	STATE MONTMORENCY ETAL C3-26	57144	MONTMORENCY	MONTMORENCY	26	32	N		2 E
10/08/2019	RIVIERA OPERATING LLC	RIVERSIDE ENERGY MICHIGAN LLC	STATE MONTMORENCY C1-26	57143	MONTMORENCY	MONTMORENCY	26	32	N		2 E
10/08/2019	RIVIERA OPERATING LLC	RIVERSIDE ENERGY MICHIGAN LLC	COLE CREEK HUNTING CLUB D1-30	55370	MONTMORENCY	RUST	30	29	N		4 E
10/08/2019	RIVIERA OPERATING LLC	RIVERSIDE ENERGY MICHIGAN LLC	STATE RUST & COLE CREEK B2-30	55369	MONTMORENCY	RUST	30	29	N		4 E
10/08/2019	RIVIERA OPERATING LLC	RIVERSIDE ENERGY MICHIGAN LLC	STATE RUST D1-20	47226	MONTMORENCY	RUST	20	29	N		4 E
10/08/2019	RIVIERA OPERATING LLC	RIVERSIDE ENERGY MICHIGAN LLC	COLE CREEK C2-30	47216	MONTMORENCY	RUST	30	29	N		4 E
10/08/2019	RIVIERA OPERATING LLC	RIVERSIDE ENERGY MICHIGAN LLC	STATE RUST C3-20	47089	MONTMORENCY	RUST	20	29	N		4 E
10/08/2019	RIVIERA OPERATING LLC	RIVERSIDE ENERGY MICHIGAN LLC	STATE RUST D3-20	47042	MONTMORENCY	RUST	20	29	N		4 E
10/09/2019	RIVIERA OPERATING LLC	RIVERSIDE ENERGY MICHIGAN LLC	LOCKWOOD LAKE RANCH D4-18	45610	MONTMORENCY	RUST	18	29	N		4 E
10/09/2019	RIVIERA OPERATING LLC	RIVERSIDE ENERGY MICHIGAN LLC	LOCKWOOD LAKE RANCH B1-18	45609	MONTMORENCY	RUST	18	29	N		4 E
10/09/2019	RIVIERA OPERATING LLC	RIVERSIDE ENERGY MICHIGAN LLC	STATE MANCELONA A4-8	42217	ANTRIM	MANCELONA	8	29	N		5 W

Transfer Date	Previous Operator	New Operator	WellName	Permit	County	TwpNm	Sec	Twp	TwpDir	Rng	RngDir
10/09/2019	RIVIERA OPERATING LLC	RIVERSIDE ENERGY MICHIGAN LLC	MARY A2-8	42088	ANTRIM	MANCELONA	8	29	N		5 W
10/09/2019	RIVIERA OPERATING LLC	NU ENERGY OPERATING INC	MARSTRAND 5-34B	47909	OTSEGO	CHARLTON	34	31	N		1 W
10/09/2019	RIVIERA OPERATING LLC	NU ENERGY OPERATING INC	MARSTRAND 4-34	38878	OTSEGO	CHARLTON	34	31	N		1 W
10/09/2019	RIVIERA OPERATING LLC	NU ENERGY OPERATING INC	MARSTRAND 6-34 HD1	52298	OTSEGO	CHARLTON	34	31	N		1 W
10/09/2019	RIVIERA OPERATING LLC	NU ENERGY OPERATING INC	MARSTRAND 1-34	29792	OTSEGO	CHARLTON	34	31	N		1 W
10/09/2019	RIVIERA OPERATING LLC	NU ENERGY OPERATING INC	MARSTRAND 1-34 HD1	29792	OTSEGO	CHARLTON	34	31	N		1 W
10/09/2019	RIVIERA OPERATING LLC	RIVERSIDE ENERGY MICHIGAN LLC	MARSTRAND B1-34	44426	OTSEGO	CHARLTON	34	31	N		1 W
10/09/2019	RIVIERA OPERATING LLC	RIVERSIDE ENERGY MICHIGAN LLC	WERNIG 7-1 HD1	41939	OTSEGO	CHESTER	1	29	N		2 W
10/09/2019	RIVIERA OPERATING LLC	RIVERSIDE ENERGY MICHIGAN LLC	FREDERIC III A2-34 SWD	45409	OTSEGO	HAYES	34	29	N		4 W
10/09/2019	RIVIERA OPERATING LLC	RIVERSIDE ENERGY MICHIGAN LLC	MARSTRAND 1-34 SWD	44423	OTSEGO	CHARLTON	34	31	N		1 W
10/09/2019	RIVIERA OPERATING LLC	RIVERSIDE ENERGY MICHIGAN LLC	HANSEN 1-26 SWD	42081	OTSEGO	CHARLTON	26	30	N		1 W
10/09/2019	RIVIERA OPERATING LLC	RIVERSIDE ENERGY MICHIGAN LLC	TOTEFF 1-1 SWD	42272	OTSEGO	CHESTER	1	29	N		2 W
10/09/2019	RIVIERA OPERATING LLC	RIVERSIDE ENERGY MICHIGAN LLC	MARTENSON 1-11 SWD	44120	OTSEGO	CHESTER	11	29	N		2 W
10/09/2019	RIVIERA OPERATING LLC	RIVERSIDE ENERGY MICHIGAN LLC	VON REIS D4-27	45487	OTSEGO	CHARLTON	27	31	N		1 W
10/09/2019	RIVIERA OPERATING LLC	RIVERSIDE ENERGY MICHIGAN LLC	VON REIS D3-34	45486	OTSEGO	CHARLTON	34	31	N		1 W
10/09/2019	RIVIERA OPERATING LLC	RIVERSIDE ENERGY MICHIGAN LLC	VON REIS D1-34	45485	OTSEGO	CHARLTON	34	31	N		1 W
10/09/2019	RIVIERA OPERATING LLC	RIVERSIDE ENERGY MICHIGAN LLC	VON REIS C1-34	45484	OTSEGO	CHARLTON	34	31	N		1 W
10/09/2019	RIVIERA OPERATING LLC	RIVERSIDE ENERGY MICHIGAN LLC	FOUR-FORTY CLUB C3-35	45483	OTSEGO	CHARLTON	35	31	N		1 W
10/09/2019	RIVIERA OPERATING LLC	RIVERSIDE ENERGY MICHIGAN LLC	VON REIS C1-27	45482	OTSEGO	CHARLTON	27	31	N		1 W
10/09/2019	RIVIERA OPERATING LLC	RIVERSIDE ENERGY MICHIGAN LLC	FOUR-FORTY CLUB D3-35	45481	OTSEGO	CHARLTON	35	31	N		1 W
10/09/2019	RIVIERA OPERATING LLC	RIVERSIDE ENERGY MICHIGAN LLC	HOWARD D2-35	45480	OTSEGO	CHARLTON	35	31	N		1 W
10/09/2019	RIVIERA OPERATING LLC	RIVERSIDE ENERGY MICHIGAN LLC	HOWARD D1-35	45479	OTSEGO	CHARLTON	35	31	N		1 W
10/09/2019	RIVIERA OPERATING LLC	RIVERSIDE ENERGY MICHIGAN LLC	HOWARD B2-35	45068	OTSEGO	CHARLTON	35	31	N		1 W
10/09/2019	RIVIERA OPERATING LLC	RIVERSIDE ENERGY MICHIGAN LLC	FOUR-FORTY CLUB A3-35	45067	OTSEGO	CHARLTON	35	31	N		1 W
10/09/2019	RIVIERA OPERATING LLC	RIVERSIDE ENERGY MICHIGAN LLC	VON REIS D3-27	45066	OTSEGO	CHARLTON	27	31	N		1 W
10/09/2019	RIVIERA OPERATING LLC	RIVERSIDE ENERGY MICHIGAN LLC	HOWARD A2-35	45042	OTSEGO	CHARLTON	35	31	N		1 W
10/09/2019	RIVIERA OPERATING LLC	RIVERSIDE ENERGY MICHIGAN LLC	HOWARD A1-35	45041	OTSEGO	CHARLTON	35	31	N		1 W
10/09/2019	RIVIERA OPERATING LLC	RIVERSIDE ENERGY MICHIGAN LLC	VALEK 13-27	44942	OTSEGO	CHARLTON	27	31	N		1 W
10/09/2019	RIVIERA OPERATING LLC	RIVERSIDE ENERGY MICHIGAN LLC	MARSTRAND B3-34	44496	OTSEGO	CHARLTON	34	31	N		1 W
10/09/2019	RIVIERA OPERATING LLC	RIVERSIDE ENERGY MICHIGAN LLC	MARSTRAND A3-34	44425	OTSEGO	CHARLTON	34	31	N		1 W
10/09/2019	RIVIERA OPERATING LLC	RIVERSIDE ENERGY MICHIGAN LLC	MARSTRAND B2-34	44424	OTSEGO	CHARLTON	34	31	N		1 W
10/09/2019	RIVIERA OPERATING LLC	RIVERSIDE ENERGY MICHIGAN LLC	WESLEY, ET AL A3-11	44121	OTSEGO	CHESTER	11	29	N		2 W
10/09/2019	RIVIERA OPERATING LLC	RIVERSIDE ENERGY MICHIGAN LLC	TOTEFF B1-1	43025	OTSEGO	CHESTER	1	29	N		2 W
10/09/2019	RIVIERA OPERATING LLC	RIVERSIDE ENERGY MICHIGAN LLC	TOTEFF B2-1	43024	OTSEGO	CHESTER	1	29	N		2 W
10/09/2019	RIVIERA OPERATING LLC	RIVERSIDE ENERGY MICHIGAN LLC	WERNIG C2-1	42870	OTSEGO	CHESTER	1	29	N		2 W
10/09/2019	RIVIERA OPERATING LLC	RIVERSIDE ENERGY MICHIGAN LLC	WERNIG D3-1	42868	OTSEGO	CHESTER	1	29	N		2 W
10/10/2019	RIVIERA OPERATING LLC	RIVERSIDE ENERGY MICHIGAN LLC	STOCKING & HEPPNER C1-25	60243	MONTMORENCY	LOUD	25	29	N		3 E
10/10/2019	RIVIERA OPERATING LLC	RIVERSIDE ENERGY MICHIGAN LLC	JOY ET AL & FRYE D4-24	60242	MONTMORENCY	LOUD	24	29	N		3 E
10/10/2019	RIVIERA OPERATING LLC	RIVERSIDE ENERGY MICHIGAN LLC	VANOCHTEN ET AL B2-15	60241	MONTMORENCY	LOUD	15	29	N		3 E
10/10/2019	RIVIERA OPERATING LLC	RIVERSIDE ENERGY MICHIGAN LLC	COOLE ET AL D2-9	60240	MONTMORENCY	LOUD	9	29	N		3 E
10/10/2019	RIVIERA OPERATING LLC	RIVERSIDE ENERGY MICHIGAN LLC	STATE LOUD A3-5	46457	MONTMORENCY	LOUD	5	29	N		3 E
10/10/2019	RIVIERA OPERATING LLC	RIVERSIDE ENERGY MICHIGAN LLC	STATE ALBERT A1-11	46344	MONTMORENCY	ALBERT	11	29	N		2 E
10/10/2019	RIVIERA OPERATING LLC	RIVERSIDE ENERGY MICHIGAN LLC	SMITH A2-17	46135	MONTMORENCY	LOUD	17	29	N		3 E
10/10/2019	RIVIERA OPERATING LLC	RIVERSIDE ENERGY MICHIGAN LLC	KLEIN C1-1	45910	MONTMORENCY	LOUD	1	29	N		3 E
10/10/2019	RIVIERA OPERATING LLC	RIVERSIDE ENERGY MICHIGAN LLC	STATE LOUD C2-23	45461	MONTMORENCY	LOUD	23	29	N		3 E
10/10/2019	RIVIERA OPERATING LLC	RIVERSIDE ENERGY MICHIGAN LLC	HEPPNER B1-11	45460	MONTMORENCY	LOUD	11	29	N		3 E
10/11/2019	TIGER DEVELOPMENT LLC	MISSAUKEE OIL & GAS CO LLC	STATE GARFIELD & TIGER 4-14	58105	KALKASKA	GARFIELD	14	25	N		6 W
10/11/2019	TIGER DEVELOPMENT LLC	MISSAUKEE OIL & GAS CO LLC	STATE GARFIELD & TIGER 3-14	56147	KALKASKA	GARFIELD	15	25	N		6 W
10/11/2019	RIVIERA OPERATING LLC	RIVERSIDE ENERGY MICHIGAN LLC	NORDYKE & DENT D2-14	60239	MONTMORENCY	LOUD	14	29	N		3 E
10/11/2019	RIVIERA OPERATING LLC	RIVERSIDE ENERGY MICHIGAN LLC	STATE LOUD & HAYES D2-25	59924	MONTMORENCY	LOUD	25	29	N		3 E
10/11/2019	RIVIERA OPERATING LLC	RIVERSIDE ENERGY MICHIGAN LLC	RAINBOW LODGE D4-12	59888	MONTMORENCY	LOUD	12	29	N		3 E
10/11/2019	RIVIERA OPERATING LLC	RIVERSIDE ENERGY MICHIGAN LLC	STATE LOUD A3-26	59851	MONTMORENCY	LOUD	26	29	N		3 E
10/11/2019	RIVIERA OPERATING LLC	RIVERSIDE ENERGY MICHIGAN LLC	STATE LOUD D1-23	59850	MONTMORENCY	LOUD	23	29	N		3 E
10/11/2019	RIVIERA OPERATING LLC	RIVERSIDE ENERGY MICHIGAN LLC	STATE LOUD A1-34 HD1	59111	MONTMORENCY	LOUD	34	29	N		3 E
10/11/2019	RIVIERA OPERATING LLC	RIVERSIDE ENERGY MICHIGAN LLC	STATE LOUD C3-27 HD1	59067	MONTMORENCY	LOUD	26	29	N		3 E

Transfer Date	Previous Operator	New Operator	WellName	Permit	County	TwpNm	Sec	Twp	TwpDir	Rng	RngDir
10/11/2019	RIVIERA OPERATING LLC	RIVERSIDE ENERGY MICHIGAN LLC	SOUTHWORTH C4-36 HD1	59066	MONTMORENCY	LOUD	36	29	N	3	E
10/11/2019	RIVIERA OPERATING LLC	RIVERSIDE ENERGY MICHIGAN LLC	STATE LOUD A4-27 HD1	59059	MONTMORENCY	LOUD	27	29	N	3	E
10/11/2019	RIVIERA OPERATING LLC	RIVERSIDE ENERGY MICHIGAN LLC	STATE ALBERT B2-31	58642	MONTMORENCY	ALBERT	31	29	N	1	E
10/11/2019	RIVIERA OPERATING LLC	RIVERSIDE ENERGY MICHIGAN LLC	GHILARDI & JANSMA ET AL A4-13 HD	58532	MONTMORENCY	ALBERT	13	29	N	1	E
10/11/2019	RIVIERA OPERATING LLC	RIVERSIDE ENERGY MICHIGAN LLC	STATE ALBERT C2-10	58433	MONTMORENCY	ALBERT	10	29	N	1	E
10/11/2019	RIVIERA OPERATING LLC	RIVERSIDE ENERGY MICHIGAN LLC	STATE LOUD B4-8	58304	MONTMORENCY	LOUD	8	29	N	3	E
10/11/2019	RIVIERA OPERATING LLC	RIVERSIDE ENERGY MICHIGAN LLC	BURR OAKS CLUB ET AL A1-9	58217	MONTMORENCY	LOUD	9	29	N	3	E
10/11/2019	RIVIERA OPERATING LLC	RIVERSIDE ENERGY MICHIGAN LLC	STATE LOUD A2-22	58150	MONTMORENCY	LOUD	22	29	N	3	E
10/11/2019	RIVIERA OPERATING LLC	RIVERSIDE ENERGY MICHIGAN LLC	DUMA TRUST ET AL C2-15	58098	MONTMORENCY	LOUD	15	29	N	3	E
10/11/2019	RIVIERA OPERATING LLC	RIVERSIDE ENERGY MICHIGAN LLC	KLEIN ET AL A3-12	58097	MONTMORENCY	LOUD	12	29	N	3	E
10/11/2019	RIVIERA OPERATING LLC	RIVERSIDE ENERGY MICHIGAN LLC	KLEIN ET AL D2-1	58096	MONTMORENCY	LOUD	1	29	N	3	E
10/11/2019	RIVIERA OPERATING LLC	RIVERSIDE ENERGY MICHIGAN LLC	U S A & STATE LOUD TWIN A1-8	57930	MONTMORENCY	LOUD	8	29	N	3	E
10/11/2019	RIVIERA OPERATING LLC	RIVERSIDE ENERGY MICHIGAN LLC	STATE ALBERT TWIN A2-12	57928	MONTMORENCY	ALBERT	12	29	N	2	E
10/11/2019	RIVIERA OPERATING LLC	RIVERSIDE ENERGY MICHIGAN LLC	STATE ALBERT TWIN A1-13	57927	MONTMORENCY	ALBERT	13	29	N	2	E
10/11/2019	RIVIERA OPERATING LLC	RIVERSIDE ENERGY MICHIGAN LLC	ROSEN TRUST & KING TWIN B1-1	57926	MONTMORENCY	ALBERT	1	29	N	1	E
10/11/2019	RIVIERA OPERATING LLC	RIVERSIDE ENERGY MICHIGAN LLC	STATE LOUD & BLUE LAKE TWIN D3-22	57925	MONTMORENCY	LOUD	22	29	N	3	E
10/11/2019	RIVIERA OPERATING LLC	RIVERSIDE ENERGY MICHIGAN LLC	MAYNERICH ET AL TWIN B4-4	57924	MONTMORENCY	LOUD	4	29	N	3	E
10/11/2019	RIVIERA OPERATING LLC	RIVERSIDE ENERGY MICHIGAN LLC	MAYNERICH ET AL TWIN B4-4 HD1	57924	MONTMORENCY	LOUD	4	29	N	3	E
10/11/2019	RIVIERA OPERATING LLC	RIVERSIDE ENERGY MICHIGAN LLC	MAYNERICH ET AL TWIN B4-4 HD2	57924	MONTMORENCY	LOUD	4	29	N	3	E
10/11/2019	RIVIERA OPERATING LLC	RIVERSIDE ENERGY MICHIGAN LLC	SMITH TWIN C3-17	57923	MONTMORENCY	LOUD	17	29	N	3	E
10/11/2019	RIVIERA OPERATING LLC	RIVERSIDE ENERGY MICHIGAN LLC	BURR OAKS CLUB B4-5	57351	MONTMORENCY	LOUD	5	29	N	3	E
10/11/2019	RIVIERA OPERATING LLC	RIVERSIDE ENERGY MICHIGAN LLC	BURR OAKS CLUB A3-4	57350	MONTMORENCY	LOUD	4	29	N	3	E
10/11/2019	RIVIERA OPERATING LLC	RIVERSIDE ENERGY MICHIGAN LLC	MONTMORENCY ROD & GUN CLUB B3-35	57268	MONTMORENCY	MONTMORENCY	35	32	N	2	E
10/11/2019	RIVIERA OPERATING LLC	RIVERSIDE ENERGY MICHIGAN LLC	STATE LOUD A3-35	57249	MONTMORENCY	LOUD	35	29	N	3	E
10/11/2019	RIVIERA OPERATING LLC	RIVERSIDE ENERGY MICHIGAN LLC	STATE ALBERT B1-13	56785	MONTMORENCY	ALBERT	13	29	N	1	E
10/11/2019	RIVIERA OPERATING LLC	RIVERSIDE ENERGY MICHIGAN LLC	STATE ALBERT A2-13	56784	MONTMORENCY	ALBERT	13	29	N	1	E
10/11/2019	RIVIERA OPERATING LLC	RIVERSIDE ENERGY MICHIGAN LLC	STATE ALBERT B3-14	56777	MONTMORENCY	ALBERT	14	29	N	1	E
10/11/2019	RIVIERA OPERATING LLC	RIVERSIDE ENERGY MICHIGAN LLC	STATE ALBERT B4-14	56776	MONTMORENCY	ALBERT	14	29	N	1	E
10/11/2019	RIVIERA OPERATING LLC	RIVERSIDE ENERGY MICHIGAN LLC	STATE LOUD & KOWALSKY B3-34	56690	MONTMORENCY	LOUD	34	29	N	3	E
10/11/2019	RIVIERA OPERATING LLC	RIVERSIDE ENERGY MICHIGAN LLC	STATE MONTMORENCY D2-35	56557	MONTMORENCY	MONTMORENCY	35	32	N	2	E
10/11/2019	RIVIERA OPERATING LLC	RIVERSIDE ENERGY MICHIGAN LLC	STATE LOUD B2-23	56553	MONTMORENCY	LOUD	23	29	N	3	E
10/11/2019	RIVIERA OPERATING LLC	RIVERSIDE ENERGY MICHIGAN LLC	STATE LOUD B2-23 SUMP	56553	MONTMORENCY	LOUD	23	29	N	3	E
10/11/2019	RIVIERA OPERATING LLC	RIVERSIDE ENERGY MICHIGAN LLC	STATE LOUD B2-23 HD1	56553	MONTMORENCY	LOUD	23	29	N	3	E
10/11/2019	RIVIERA OPERATING LLC	RIVERSIDE ENERGY MICHIGAN LLC	STATE RUST A1-31	50753	MONTMORENCY	RUST	31	30	N	4	E
10/11/2019	RIVIERA OPERATING LLC	RIVERSIDE ENERGY MICHIGAN LLC	STATE LOUD C3-3	46593	MONTMORENCY	LOUD	3	29	N	3	E
10/11/2019	RIVIERA OPERATING LLC	RIVERSIDE ENERGY MICHIGAN LLC	STATE LOUD A1-8	46459	MONTMORENCY	LOUD	8	29	N	3	E