

Michigan Department of  
Environment, Great Lakes, and Energy  
Oil, Gas and Minerals Division

PERMIT LIST

10/14/2019 THRU 10/18/2019



Permit Number      Issue Date      Permittee Number      Permittee Name      Page 1

61455      10/14/2019      6418      W B OSBORN OIL AND GAS OPERATIONS LTD  
1250 NORTH EAST LOOP 410  
SUITE 600  
SAN ANTONIO, TX 78209

API Well No: 21-107-62004-00-00

Prev Permit:

Well Name: MCNEILLY 1-3

Surface Owner: Kevin McNeilly

Well Type: Oil Well

True Vertical Depth: 4100FT

Permit Type: Drill

Target Formation: DUNDEE

H2S Present? Yes

Deepest Formation: DUNDEE

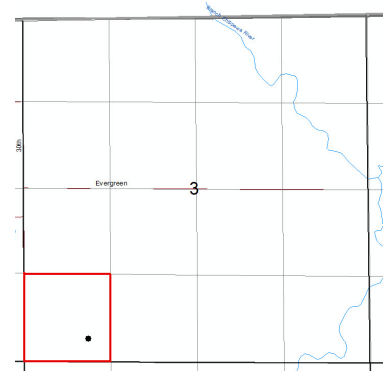

40-Acre drilling unit, SW/4 SW/4, Section 3

Location:	QT QT QT	Sec	Township	Range	Township Name	County	Feet From Section Line	Feet From DRLG Unit Line
SL:	SESWSW	3	16N	7W	FORK	MECOSTA	330 S 980 W	
BHL:	SESWSW	3	16N	7W	FORK	MECOSTA	330 S 980 W	330 S 340 E

61456      10/15/2019      40      MUSKEGON DEVELOPMENT COMPANY  
1425 S MISSION RD  
MOUNT PLEASANT, MI 48858

API Well No: 21-129-62003-00-00

Prev Permit:

Well Name: STATE FOSTER RCU 2-28

Surface Owner: State of Michigan

Well Type: Oil Well

True Vertical Depth: 4586FT

Permit Type: Drill

Target Formation: RICHFIELD

H2S Present? Yes

Deepest Formation: SYLVANIA

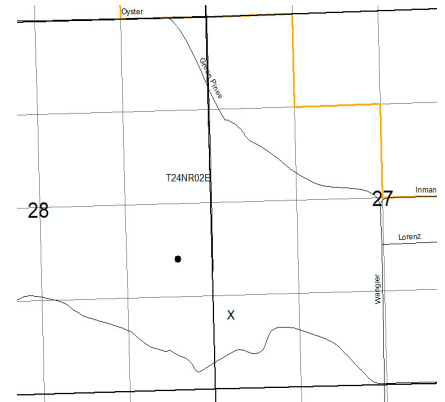

Rose City Unit, Order 197-6

Location:	QT QT QT	Sec	Township	Range	Township Name	County	Feet From Section Line	Feet From DRLG Unit Line
SL:	NWSWSW	27	24N	2E	ROSE	OGEMAW	1001 S 234 W	
BHL:	SENESE	28	24N	2E	FOSTER	OGEMAW	1796 S 547 E	

Michigan Department of  
Environment, Great Lakes, and Energy  
Oil, Gas and Minerals Division

PERMIT LIST

10/14/2019 THRU 10/18/2019



Permit Number      Issue Date      Permittee Number      Permittee Name      Page 2

61457      10/15/2019      40      MUSKEGON DEVELOPMENT COMPANY  
1425 S MISSION RD  
MOUNT PLEASANT, MI 48858

API Well No: 21-129-62004-00-00

Prev Permit:

Well Name: STATE ROSE RCU 2-27

Surface Owner: State of Michigan

Well Type: Oil Well

True Vertical Depth: 4595FT

Permit Type: Drill

Target Formation: RICHFIELD

H2S Present? Yes

Deepest Formation: SYLVANIA

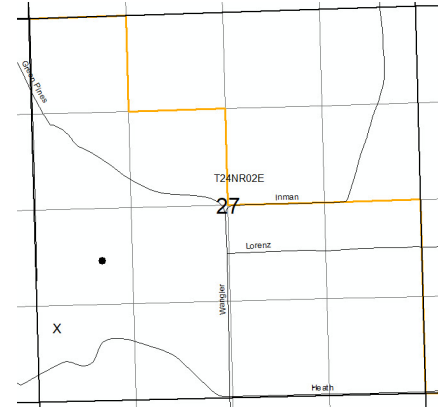

Rose City Unit, Order 197-6

Location:	QT QT QT	Sec	Township	Range	Township Name	County	Feet From Section Line	Feet From DRLG Unit Line
SL:	NWSWSW	27	24N	2E	ROSE	OGEMAW	1012 S 257 W	
BHL:	SENWSW	27	24N	2E	ROSE	OGEMAW	1928 S 898 W	

61458      10/16/2019      5320      SAVOY ENERGY LP  
920 HASTINGS STREET, SUITE A  
PO BOX 1560  
TRAVERSE CITY, MI49685-1560

API Well No: 21-025-62013-01-00

Prev Permit: 61440

Well Name: BOTTOMLEY 1-13A

Surface Owner: Bottomley, Susan D.

Well Type: Oil Well

True Vertical Depth: 3828FT

Permit Type: Deepen

Target Formation: TRENTON-BLACK RIVER

H2S Present? No

Deepest Formation: PRAIRIE DU CHIEN

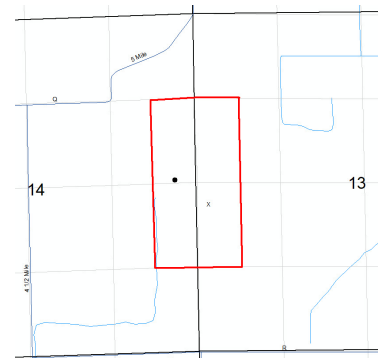

80-acre R303 Drilling unit, E/2 SE/4 NE/4, E/2 NE/4 SE/4 Sec 14; W/2 SW/4 NW/4, W/2 NW/4 SW/4 Sec 13

Location:	QT QT QT	Sec	Township	Range	Township Name	County	Feet From Section Line	Feet From DRLG Unit Line
SL:	NWNWSW	13	4S	8W	ATHENS	CALHOUN	2276 S 110 W	
BHL:	SESENE	14	4S	8W	ATHENS	CALHOUN	2614 N 308 E	1281 N 355 W

Michigan Department of  
 Environment, Great Lakes, and Energy  
 Oil, Gas, and Minerals Division  
 Updated Permits  
 10/14/2019 THRU 10/18/2019  
**EGLE**

Permit Number      Permittee Number      Permittee Name

**PLUGGING INSTRUCTIONS ISSUED:**

55921      6361      RIVERSIDE ENERGY MICHIGAN LLC  
 10691 EAST CARTER ROAD  
 SUITE 201  
 TRAVERSE CITY, MI49684

API Well Number: 21-009-55921-00-00

Well Name: CENTRAL M 1-7 SWD

Plug Inst. Issue Date: 9/27/2019

Location	QT QT QT	Sec	Township	Range	Township Name	County	Feet From Section Line	Feet From DRLG Unit
SL:	NENWNW	7	31N	7W	ECHO	ANTRIM	577 N 1164 W	

Comment: App to P&A expires 9/27/20

51072      6361      RIVERSIDE ENERGY MICHIGAN LLC  
 10691 EAST CARTER ROAD  
 SUITE 201  
 TRAVERSE CITY, MI49684

API Well Number: 21-029-51072-00-00

Well Name: EDWARDS A1-32

Plug Inst. Issue Date: 10/8/2019

Location	QT QT QT	Sec	Township	Range	Township Name	County	Feet From Section Line	Feet From DRLG Unit
SL:	SENWNW	32	32N	6W	WILSON	CHARLEVOIX	892 N 740 W	422 S 564 E

Comment: App to P&A expires on 10/8/20

Michigan Department of  
 Environment, Great Lakes, and Energy  
 Oil, Gas, and Minerals Division  
 Updated Permits  
 10/14/2019 THRU 10/18/2019  
**EGLE**

Permit Number      Permittee Number      Permittee Name

9708                      491                      CONSUMERS ENERGY CO  
 1945 W PARNALL RD  
 JACKSON, MI 49201

API Well Number: 21-035-09708-00-00

Well Name: MICHIGAN GAS STORAGE CO  
 658

Plug Inst. Issue Date: 10/9/2019

Location	QT QT QT	Sec	Township	Range	Township Name	County	Feet From Section Line	Feet From DRLG Unit
SL:	CNNE	34	20N	6W	WINTERFIELD	CLARE	1320 S 1320 W	1320 N 1320 E

Comment: App to P&A Expires on 10/9/20

11979                      491                      CONSUMERS ENERGY CO  
 1945 W PARNALL RD  
 JACKSON, MI 49201

API Well Number: 21-035-11979-00-00

Well Name: M G S C 815

Plug Inst. Issue Date: 10/3/2019

Location	QT QT QT	Sec	Township	Range	Township Name	County	Feet From Section Line	Feet From DRLG Unit
SL:	CNNW	12	20N	6W	WINTERFIELD	CLARE	1320 N 1320 W	1320 S 1320 E

Comment: App to P&A expires on 10/3/20

Michigan Department of  
 Environment, Great Lakes, and Energy  
 Oil, Gas, and Minerals Division  
 Updated Permits  
 10/14/2019 THRU 10/18/2019  
**EGLE**

Permit Number      Permittee Number      Permittee Name

14327      491      CONSUMERS ENERGY CO  
 1945 W PARNALL RD  
 JACKSON, MI 49201

API Well Number: 21-035-14327-00-00

Well Name: MICHIGAN GAS STORAGE CO  
 401

Plug Inst. Issue Date: 10/9/2019

Location	QT QT QT	Sec	Township	Range	Township Name	County	Feet From Section Line	Feet From DRLG Unit
SL:	CNNWSW	35	20N	6W	WINTERFIELD	CLARE	660 N 660 W	660 N 660 W

Comment: App to P&A expires on 10/9/20

15228      491      CONSUMERS ENERGY CO  
 1945 W PARNALL RD  
 JACKSON, MI 49201

API Well Number: 21-035-15228-00-00

Well Name: MICH GAS STORAGE 436

Plug Inst. Issue Date: 10/9/2019

Location	QT QT QT	Sec	Township	Range	Township Name	County	Feet From Section Line	Feet From DRLG Unit
SL:	CNNENE	6	19N	6W	REDDING	CLARE	660 N 660 E	660 N 660 E

Comment: App to P&A Expires on 10/9/20

Michigan Department of  
 Environment, Great Lakes, and Energy  
 Oil, Gas, and Minerals Division  
 Updated Permits  
 10/14/2019 THRU 10/18/2019  
**EGLE**

Permit Number      Permittee Number      Permittee Name

20656      491      CONSUMERS ENERGY CO  
 1945 W PARNALL RD  
 JACKSON, MI 49201

API Well Number: 21-035-20656-00-00

Well Name: M G S C 918

Plug Inst. Issue Date: 10/9/2019

Location	QT QT QT	Sec	Township	Range	Township Name	County	Feet From Section Line	Feet From DRLG Unit
SL:	SENE SW	28	20N	6W	WINTERFIELD	CLARE	1220 N 100 E	100 S 100 E

Comment: App to P&A expires on 10/9/20



Michigan Department of  
 Environment, Great Lakes, and Energy  
 Oil, Gas, and Minerals Division  
 Updated Permits  
 10/14/2019 THRU 10/18/2019  
**EGLE**

Permit Number      Permittee Number      Permittee Name

**RECORD OF WELL PLUGGING:**

61416      5320      SAVOY ENERGY LP  
 920 HASTINGS STREET, SUITE A  
 PO BOX 1560  
 TRAVERSE CITY, MI49685-1560

API Well Number: 21-025-62007-01-00

Well Name: TRAISTER 1-21A

Plugging Date: 8/23/2019

Location	QT QT QT	Sec	Township	Range	Township Name	County	Feet From Section Line	Feet From DRLG Unit
SL:	NESWNE	21	3S	8W	LEROY	CALHOUN	1730 N 1970 E	930 S 700 W
BHL:	NENESW	21	3S	8W	LEROY	CALHOUN	2608 S 2539 W	1284 S 536 W

12756      491      CONSUMERS ENERGY CO  
 1945 W PARNALL RD  
 JACKSON, MI 49201

API Well Number: 21-035-12756-00-00

Well Name: MICHIGAN GAS STORAGE CO  
 228

Plugging Date: 9/4/2019

Location	QT QT QT	Sec	Township	Range	Township Name	County	Feet From Section Line	Feet From DRLG Unit
SL:	CNNWSW	31	20N	6W	WINTERFIELD	CLARE	660 N 530 W	660 N 530 W

Michigan Department of  
 Environment, Great Lakes, and Energy  
 Oil, Gas, and Minerals Division  
 Updated Permits  
 10/14/2019 THRU 10/18/2019  
**EGLE**

Permit Number      Permittee Number      Permittee Name

13216      491      CONSUMERS ENERGY CO  
 1945 W PARNALL RD  
 JACKSON, MI 49201

API Well Number: 21-035-13216-00-00

Well Name: MICHIGAN GAS STORAGE CO  
 283

Plugging Date: 9/3/2019

Location	QT QT QT	Sec	Township	Range	Township Name	County	Feet From Section Line	Feet From DRLG Unit
SL:	CNSESE	30	20N	6W	WINTERFIELD	CLARE	660 S 660 E	660 S 660 E

36667      7772      LAMBDA ENERGY RESOURCES LLC  
 12012 Wickchester  
 Suite 300  
 Houston, TX 77055 USA

API Well Number: 21-099-36476-01-00

Well Name: OAK RIDGE GOLF ET AL 2-36A

Plugging Date: 9/9/2019

Location	QT QT QT	Sec	Township	Range	Township Name	County	Feet From Section Line	Feet From DRLG Unit
SL:	NENWNE	36	4N	14E	LENOX	MACOMB	460 N 903 W	
BHL:	SENWNE	36	4N	14E	LENOX	MACOMB	916 N 918 W	404 S 402 E



Michigan Department of  
 Environment, Great Lakes, and Energy  
 Oil, Gas, and Minerals Division  
 Updated Permits  
 10/14/2019 THRU 10/18/2019  
**EGLE**

Permit Number      Permittee Number      Permittee Name

47665      7772      LAMBDA ENERGY RESOURCES LLC  
 12012 Wickchester  
 Suite 300  
 Houston, TX 77055 USA

API Well Number: 21-099-36744-02-00

Well Name: CRONN ET AL 4-36B      True Vertical Depth: 2775

Plugging Date: 9/16/2019

Location	QT QT QT	Sec	Township	Range	Township Name	County	Feet From Section Line	Feet From DRLG Unit
SL:	NENWSE	36	4N	14E	LENOX	MACOMB	330 N 737 W	
BHL:	SESWNE	36	4N	14E	LENOX	MACOMB	425 S 753 W	1745 S 753 W

57063      5509      NORTHSTAR ENERGY LLC  
 1203 EAST 33RD STREET  
 SUITE 200  
 TULSA, OK 74105

API Well Number: 21-119-57063-00-00

Well Name: BLACK RIVER RANCH A1-22  
 SWD

Plugging Date: 9/20/2019

Location	QT QT QT	Sec	Township	Range	Township Name	County	Feet From Section Line	Feet From DRLG Unit
SL:	SWNWNW	22	32N	1E	MONTMORENCY	MONTMORENCY	1052 N 233 W	

Michigan Department of  
 Environment, Great Lakes, and Energy  
 Oil, Gas, and Minerals Division  
 Updated Permits  
 10/14/2019 THRU 10/18/2019  
**EGLE**

Permit Number      Permittee Number      Permittee Name

57932      5509      NORTHSTAR ENERGY LLC  
 1203 EAST 33RD STREET  
 SUITE 200  
 TULSA, OK 74105

API Well Number: 21-119-57932-00-00

Well Name: STATE MONTMORENCY C4-22

Plugging Date: 9/20/2019

Location	QT QT QT	Sec	Township	Range	Township Name	County	Feet From Section Line	Feet From DRLG Unit
SL:	SENESE	22	32N	1E	MONTMORENCY	MONTMORENCY	1664 S 421 E	347 S 421 E

57968      5509      NORTHSTAR ENERGY LLC  
 1203 EAST 33RD STREET  
 SUITE 200  
 TULSA, OK 74105

API Well Number: 21-119-57968-00-00

Well Name: STATE MONTMORENCY D4-22

Plugging Date: 9/20/2019

Location	QT QT QT	Sec	Township	Range	Township Name	County	Feet From Section Line	Feet From DRLG Unit
SL:	SESESE	22	32N	1E	MONTMORENCY	MONTMORENCY	336 S 483 E	336 S 483 E

Michigan Department of  
 Environment, Great Lakes, and Energy  
 Oil, Gas, and Minerals Division  
 Updated Permits  
 10/14/2019 THRU 10/18/2019  
**EGLE**

Permit Number      Permittee Number      Permittee Name

58214      5509      NORTHSTAR ENERGY LLC  
 1203 EAST 33RD STREET  
 SUITE 200  
 TULSA, OK 74105

API Well Number: 21-119-58214-00-00

Well Name: STATE MONTMORENCY D2-22

Plugging Date: 9/20/2019

Location	QT QT QT	Sec	Township	Range	Township Name	County	Feet From Section Line	Feet From DRLG Unit
SL:	SESESW	22	32N	1E	MONTMORENCY	MONTMORENCY	341 S 2310 W	341 S 343 E



Michigan Department of  
 Environment, Great Lakes, and Energy  
 Oil, Gas, and Minerals Division  
 Updated Permits  
 10/14/2019 THRU 10/18/2019  
**EGL**

Permit Number      Permittee Number      Permittee Name

**PERMIT TERMINATIONS:**

61272            104                    WEST BAY EXPLORATION COMPANY  
 13685 S WEST BAYSHORE DR  
 TRAVERSE CITY, MI49684

API Well Number: 21-051-62012-00-00

Well Name: EASTMAN 1-29

Termination Date: 10/6/2019

Location	QT QT QT	Sec	Township	Range	Township Name	County	Feet From Section Line	Feet From DRLG Unit
SL:	NWNWNW	29	20N	2W	SHERMAN	GLADWIN	461 N 159 W	
BHL:	SWNWNW	29	20N	2W	SHERMAN	GLADWIN	670 N 660 W	667 S 660 W



Permit Number      Permittee Number      Permittee Name

---

**TRANSFER OF OWNERSHIP:**

TABLES FOLLOW THIS PAGE

Transfer Date	Previous Operator	New Operator	WellName	Permit No.	County	TwpNm	Sec	Twp	TwpDir	Rng	RngDir
10/15/2019	RIVIERA OPERATING LLC	RIVERSIDE ENERGY MI LLC	LOCKWOOD LAKE RANCH C2-13	45611	MONTMORENCY	LOUD	13	29	N	3	E
10/15/2019	RIVIERA OPERATING LLC	RIVERSIDE ENERGY MI LLC	SHERIDAN CREEK 1-11 SWD	45385	MONTMORENCY	ALBERT	11	29	N	1	E
10/15/2019	RIVIERA OPERATING LLC	RIVERSIDE ENERGY MI LLC	DUMA 4-15	44824	MONTMORENCY	LOUD	15	29	N	3	E
10/15/2019	RIVIERA OPERATING LLC	RIVERSIDE ENERGY MI LLC	STATE OSSINEKE A4-36	49072	ALPENA	OSSINEKE	36	29	N	6	E
10/15/2019	RIVIERA OPERATING LLC	RIVERSIDE ENERGY MI LLC	STATE OSSINEKE B4-15	49048	ALPENA	OSSINEKE	15	29	N	6	E
10/15/2019	RIVIERA OPERATING LLC	RIVERSIDE ENERGY MI LLC	STATE OSSINEKE B4-15	49048	ALPENA	OSSINEKE	15	29	N	6	E
10/15/2019	RIVIERA OPERATING LLC	RIVERSIDE ENERGY MI LLC	STATE OSSINEKE B4-15	49048	ALPENA	OSSINEKE	15	29	N	6	E
10/15/2019	RIVIERA OPERATING LLC	RIVERSIDE ENERGY MI LLC	STATE OSSINEKE B4-15	49048	ALPENA	OSSINEKE	15	29	N	6	E
10/15/2019	RIVIERA OPERATING LLC	RIVERSIDE ENERGY MI LLC	BADER C2-30	49016	ALPENA	OSSINEKE	30	29	N	6	E
10/15/2019	RIVIERA OPERATING LLC	RIVERSIDE ENERGY MI LLC	SULLIVAN C1-18	49014	ALPENA	OSSINEKE	18	29	N	6	E
10/15/2019	RIVIERA OPERATING LLC	RIVERSIDE ENERGY MI LLC	WALLACE HUNTING CLUB C2-17	49011	ALPENA	OSSINEKE	17	29	N	6	E
10/15/2019	RIVIERA OPERATING LLC	RIVERSIDE ENERGY MI LLC	TOWNSEND A2-29	49009	ALPENA	OSSINEKE	29	29	N	6	E
10/15/2019	RIVIERA OPERATING LLC	RIVERSIDE ENERGY MI LLC	STATE OSSINEKE C2-25	49007	ALPENA	OSSINEKE	25	29	N	6	E
10/15/2019	RIVIERA OPERATING LLC	RIVERSIDE ENERGY MI LLC	STATE OSSINEKE A1-23	49004	ALPENA	OSSINEKE	23	29	N	6	E
10/15/2019	RIVIERA OPERATING LLC	RIVERSIDE ENERGY MI LLC	STATE OSSINEKE D2-11	49002	ALPENA	OSSINEKE	11	29	N	6	E
10/15/2019	RIVIERA OPERATING LLC	RIVERSIDE ENERGY MI LLC	SORENSEN B2-30	49000	ALPENA	OSSINEKE	30	29	N	6	E
10/15/2019	RIVIERA OPERATING LLC	RIVERSIDE ENERGY MI LLC	STATE OSSINEKE C3-36	48964	ALPENA	OSSINEKE	36	29	N	6	E
10/15/2019	RIVIERA OPERATING LLC	RIVERSIDE ENERGY MI LLC	STATE OSSINEKE C3-26	48913	ALPENA	OSSINEKE	26	29	N	6	E
10/15/2019	RIVIERA OPERATING LLC	RIVERSIDE ENERGY MI LLC	STATE OSSINEKE D2-14	48911	ALPENA	OSSINEKE	14	29	N	6	E
10/15/2019	RIVIERA OPERATING LLC	RIVERSIDE ENERGY MI LLC	STATE OSSINEKE A3-14	48909	ALPENA	OSSINEKE	14	29	N	6	E
10/15/2019	RIVIERA OPERATING LLC	RIVERSIDE ENERGY MI LLC	MRGC A4-35	57626	MONTMORENCY	MONTMORENCY	35	32	N	2	E
10/15/2019	RIVIERA OPERATING LLC	RIVERSIDE ENERGY MI LLC	STATE MONTMORENCY A2-36	57393	MONTMORENCY	MONTMORENCY	36	32	N	2	E
10/15/2019	RIVIERA OPERATING LLC	RIVERSIDE ENERGY MI LLC	STATE MONTMORENCY C1-25	57308	MONTMORENCY	MONTMORENCY	25	32	N	2	E
10/15/2019	RIVIERA OPERATING LLC	RIVERSIDE ENERGY MI LLC	STATE MONTMORENCY B3-36	57155	MONTMORENCY	MONTMORENCY	36	32	N	2	E
10/15/2019	RIVIERA OPERATING LLC	RIVERSIDE ENERGY MI LLC	STATE MONTMORENCY B1-36	57154	MONTMORENCY	MONTMORENCY	36	32	N	2	E
10/15/2019	RIVIERA OPERATING LLC	RIVERSIDE ENERGY MI LLC	STATE MONTMORENCY ETAL C4-26	57145	MONTMORENCY	MONTMORENCY	26	32	N	2	E
10/15/2019	RIVIERA OPERATING LLC	RIVERSIDE ENERGY MI LLC	BADER B2-29	49073	ALPENA	OSSINEKE	29	29	N	6	E
10/15/2019	RIVIERA OPERATING LLC	RIVERSIDE ENERGY MI LLC	STATE OSSINEKE D4-15	49049	ALPENA	OSSINEKE	15	29	N	6	E
10/15/2019	RIVIERA OPERATING LLC	RIVERSIDE ENERGY MI LLC	TIBOR ET AL D3-9	49034	ALPENA	OSSINEKE	9	29	N	6	E
10/15/2019	RIVIERA OPERATING LLC	RIVERSIDE ENERGY MI LLC	AVENDT B2-18	49012	ALPENA	OSSINEKE	18	29	N	6	E
10/15/2019	RIVIERA OPERATING LLC	RIVERSIDE ENERGY MI LLC	BADER C4-30	49010	ALPENA	OSSINEKE	30	29	N	6	E
10/15/2019	RIVIERA OPERATING LLC	RIVERSIDE ENERGY MI LLC	WILD C4-19	49008	ALPENA	OSSINEKE	19	29	N	6	E
10/15/2019	RIVIERA OPERATING LLC	RIVERSIDE ENERGY MI LLC	STATE OSSINEKE D4-11	49003	ALPENA	OSSINEKE	11	29	N	6	E
10/15/2019	RIVIERA OPERATING LLC	RIVERSIDE ENERGY MI LLC	ANDOR A3-19	49001	ALPENA	OSSINEKE	19	29	N	6	E
10/15/2019	RIVIERA OPERATING LLC	RIVERSIDE ENERGY MI LLC	STATE OSSINEKE C4-14	48933	ALPENA	OSSINEKE	14	29	N	6	E
10/15/2019	RIVIERA OPERATING LLC	RIVERSIDE ENERGY MI LLC	STATE OSSINEKE B2-26	48912	ALPENA	OSSINEKE	26	29	N	6	E
10/15/2019	RIVIERA OPERATING LLC	RIVERSIDE ENERGY MI LLC	STATE OSSINEKE A3-10	48908	ALPENA	OSSINEKE	10	29	N	6	E
10/16/2019	RIVIERA OPERATING LLC	RIVERSIDE ENERGY MI LLC	BROAD C1-22	49381	ALPENA	OSSINEKE	22	29	N	5	E
10/16/2019	RIVIERA OPERATING LLC	RIVERSIDE ENERGY MI LLC	AMLLOTTE A4-24	49294	ALPENA	OSSINEKE	24	29	N	5	E
10/16/2019	RIVIERA OPERATING LLC	RIVERSIDE ENERGY MI LLC	LOG CABIN HUNTING CLUB A4-23	49293	ALPENA	OSSINEKE	23	29	N	5	E
10/16/2019	RIVIERA OPERATING LLC	RIVERSIDE ENERGY MI LLC	GEROW D4-34	49260	ALPENA	OSSINEKE	34	29	N	7	E
10/16/2019	RIVIERA OPERATING LLC	RIVERSIDE ENERGY MI LLC	SEGUIN 7-13	49225	ALPENA	OSSINEKE	13	29	N	7	E
10/16/2019	RIVIERA OPERATING LLC	RIVERSIDE ENERGY MI LLC	STATE OSSINEKE C4-10	49122	ALPENA	OSSINEKE	10	29	N	6	E
10/16/2019	RIVIERA OPERATING LLC	RIVERSIDE ENERGY MI LLC	STATE OSSINEKE D1-2	49117	ALPENA	OSSINEKE	2	29	N	6	E
10/16/2019	RIVIERA OPERATING LLC	RIVERSIDE ENERGY MI LLC	BROAD B1-27	49583	ALPENA	OSSINEKE	27	29	N	5	E
10/16/2019	RIVIERA OPERATING LLC	RIVERSIDE ENERGY MI LLC	BROAD B1-27	49583	ALPENA	OSSINEKE	27	29	N	5	E
10/16/2019	RIVIERA OPERATING LLC	RIVERSIDE ENERGY MI LLC	BROAD B1-27	49583	ALPENA	OSSINEKE	27	29	N	5	E
10/16/2019	RIVIERA OPERATING LLC	RIVERSIDE ENERGY MI LLC	BROAD B1-27	49583	ALPENA	OSSINEKE	27	29	N	5	E

Transfer Date	Previous Operator	New Operator	WellName	Permit No.	County	TwpNm	Sec	Twp	TwpDir	Rng	RngDir
10/16/2019	RIVIERA OPERATING LLC	RIVERSIDE ENERGY MI LLC	BROAD B1-27	49583	ALPENA	OSSINEKE	27	29	N	5	E
10/16/2019	RIVIERA OPERATING LLC	RIVERSIDE ENERGY MI LLC	MOUSSEAU C1-29	49554	ALPENA	OSSINEKE	29	29	N	7	E
10/16/2019	RIVIERA OPERATING LLC	RIVERSIDE ENERGY MI LLC	DEGEN C3-32	49552	ALPENA	OSSINEKE	32	29	N	7	E
10/16/2019	RIVIERA OPERATING LLC	RIVERSIDE ENERGY MI LLC	RAINKO D4-11	49548	ALPENA	OSSINEKE	11	29	N	5	E
10/16/2019	RIVIERA OPERATING LLC	RIVERSIDE ENERGY MI LLC	STATE OSSINEKE B2-25	49431	ALPENA	OSSINEKE	25	29	N	5	E
10/16/2019	RIVIERA OPERATING LLC	RIVERSIDE ENERGY MI LLC	STATE OSSINEKE B2-25	49431	ALPENA	OSSINEKE	25	29	N	5	E
10/16/2019	RIVIERA OPERATING LLC	RIVERSIDE ENERGY MI LLC	STATE OSSINEKE B2-25	49431	ALPENA	OSSINEKE	25	29	N	5	E
10/16/2019	RIVIERA OPERATING LLC	RIVERSIDE ENERGY MI LLC	LISKE C1-33	49407	ALPENA	OSSINEKE	33	29	N	7	E
10/16/2019	RIVIERA OPERATING LLC	RIVERSIDE ENERGY MI LLC	BECKER A3-32	49405	ALPENA	OSSINEKE	32	29	N	7	E
10/16/2019	RIVIERA OPERATING LLC	RIVERSIDE ENERGY MI LLC	BROAD D4-23	49384	ALPENA	OSSINEKE	23	29	N	5	E
10/16/2019	RIVIERA OPERATING LLC	RIVERSIDE ENERGY MI LLC	BROAD B2-23	49382	ALPENA	OSSINEKE	23	29	N	5	E
10/16/2019	RIVIERA OPERATING LLC	RIVERSIDE ENERGY MI LLC	BROAD D2-14	49380	ALPENA	OSSINEKE	14	29	N	5	E
10/16/2019	RIVIERA OPERATING LLC	RIVERSIDE ENERGY MI LLC	LOG CABIN HUNTING CLUB D2-24	49295	ALPENA	OSSINEKE	24	29	N	5	E
10/16/2019	RIVIERA OPERATING LLC	RIVERSIDE ENERGY MI LLC	STATE OSSINEKE B4-22	49132	ALPENA	OSSINEKE	22	29	N	6	E
10/16/2019	RIVIERA OPERATING LLC	RIVERSIDE ENERGY MI LLC	STATE OSSINEKE B4-22	49132	ALPENA	OSSINEKE	22	29	N	6	E
10/16/2019	RIVIERA OPERATING LLC	RIVERSIDE ENERGY MI LLC	STATE OSSINEKE B4-22	49132	ALPENA	OSSINEKE	22	29	N	6	E
10/16/2019	RIVIERA OPERATING LLC	RIVERSIDE ENERGY MI LLC	STATE OSSINEKE B4-22	49132	ALPENA	OSSINEKE	22	29	N	6	E
10/16/2019	RIVIERA OPERATING LLC	RIVERSIDE ENERGY MI LLC	STATE OSSINEKE C4-3	49118	ALPENA	OSSINEKE	3	29	N	6	E
10/17/2019	RIVIERA OPERATING LLC	RIVERSIDE ENERGY MI LLC	STATE OSSINEKE C4-26	49703	ALPENA	OSSINEKE	26	29	N	5	E
10/17/2019	RIVIERA OPERATING LLC	RIVERSIDE ENERGY MI LLC	SOLO C2-27	49641	ALPENA	OSSINEKE	27	29	N	7	E
10/17/2019	RIVIERA OPERATING LLC	RIVERSIDE ENERGY MI LLC	ELLSWORTH A2-35	49639	ALPENA	OSSINEKE	35	29	N	7	E
10/17/2019	RIVIERA OPERATING LLC	RIVERSIDE ENERGY MI LLC	BLEWETT C4-27	49635	ALPENA	OSSINEKE	27	29	N	7	E
10/17/2019	RIVIERA OPERATING LLC	RIVERSIDE ENERGY MI LLC	MAUS A4-35	49633	ALPENA	OSSINEKE	35	29	N	7	E
10/17/2019	RIVIERA OPERATING LLC	RIVERSIDE ENERGY MI LLC	BROAD A1-3	49588	ALPENA	OSSINEKE	3	29	N	5	E
10/18/2019	RIVIERA OPERATING LLC	RIVERSIDE ENERGY MI LLC	WERTH D1-9	52716	ALPENA	WILSON	9	30	N	7	E
10/18/2019	RIVIERA OPERATING LLC	RIVERSIDE ENERGY MI LLC	WERTH A1-16	52695	ALPENA	WILSON	16	30	N	7	E
10/18/2019	RIVIERA OPERATING LLC	RIVERSIDE ENERGY MI LLC	ZBYTOWSKI A4-8	52674	ALPENA	WILSON	8	30	N	7	E
10/18/2019	RIVIERA OPERATING LLC	RIVERSIDE ENERGY MI LLC	ZBYTOWSKI B3-9	52648	ALPENA	WILSON	9	30	N	7	E
10/18/2019	RIVIERA OPERATING LLC	RIVERSIDE ENERGY MI LLC	PEASLEY C3-8	52646	ALPENA	WILSON	8	30	N	7	E
10/18/2019	RIVIERA OPERATING LLC	RIVERSIDE ENERGY MI LLC	CHEATHAM D1-16	52639	ALPENA	WILSON	16	30	N	7	E
10/18/2019	RIVIERA OPERATING LLC	RIVERSIDE ENERGY MI LLC	STOKES PROPERTIES C4-17	52389	ALPENA	OSSINEKE	17	29	N	7	E
10/18/2019	RIVIERA OPERATING LLC	RIVERSIDE ENERGY MI LLC	STOKES PROPERTIES & KLEVE A2-16	52383	ALPENA	OSSINEKE	16	29	N	7	E
10/18/2019	RIVIERA OPERATING LLC	RIVERSIDE ENERGY MI LLC	BROAD A3-26	51699	ALPENA	OSSINEKE	26	29	N	5	E
10/18/2019	RIVIERA OPERATING LLC	RIVERSIDE ENERGY MI LLC	TRELF A 16-4	51478	ALPENA	WILSON	4	30	N	7	E
10/18/2019	RIVIERA OPERATING LLC	RIVERSIDE ENERGY MI LLC	SCHOOKS & MITCHELL C4-29	51337	ALPENA	OSSINEKE	29	29	N	7	E
10/18/2019	RIVIERA OPERATING LLC	RIVERSIDE ENERGY MI LLC	STATE OSSINEKE D2-36	51323	ALPENA	OSSINEKE	36	29	N	6	E
10/18/2019	RIVIERA OPERATING LLC	RIVERSIDE ENERGY MI LLC	SPARKS A3-35	51321	ALPENA	OSSINEKE	35	29	N	6	E
10/18/2019	RIVIERA OPERATING LLC	RIVERSIDE ENERGY MI LLC	AMLLOTTE D2-19	51317	ALPENA	OSSINEKE	19	29	N	6	E
10/18/2019	RIVIERA OPERATING LLC	RIVERSIDE ENERGY MI LLC	BECK, ET AL B1-35	51106	ALPENA	OSSINEKE	35	29	N	5	E
10/18/2019	RIVIERA OPERATING LLC	RIVERSIDE ENERGY MI LLC	BROAD B3-15	51040	ALPENA	OSSINEKE	15	29	N	5	E
10/18/2019	RIVIERA OPERATING LLC	RIVERSIDE ENERGY MI LLC	BROAD D3-3	51038	ALPENA	OSSINEKE	3	29	N	5	E
10/18/2019	RIVIERA OPERATING LLC	RIVERSIDE ENERGY MI LLC	TRAILS END CLUB C1-26	51032	ALPENA	OSSINEKE	26	29	N	6	E
10/18/2019	RIVIERA OPERATING LLC	RIVERSIDE ENERGY MI LLC	SIEGERT C3-30	50879	ALPENA	OSSINEKE	30	29	N	7	E
10/18/2019	RIVIERA OPERATING LLC	RIVERSIDE ENERGY MI LLC	BROAD B3-34	50744	ALPENA	OSSINEKE	34	29	N	5	E
10/18/2019	RIVIERA OPERATING LLC	RIVERSIDE ENERGY MI LLC	SANDY & ROE HUNTING CLUB C3-31	50742	ALPENA	OSSINEKE	31	29	N	5	E
10/18/2019	RIVIERA OPERATING LLC	RIVERSIDE ENERGY MI LLC	SOMMERFELD & MELVILLE D4-32	50740	ALPENA	OSSINEKE	32	29	N	5	E
10/18/2019	RIVIERA OPERATING LLC	RIVERSIDE ENERGY MI LLC	MAIN HUNTING CLUB C1-32	50738	ALPENA	OSSINEKE	32	29	N	5	E
10/18/2019	RIVIERA OPERATING LLC	RIVERSIDE ENERGY MI LLC	SOMMERFELD & MELVILLE A3-32	50736	ALPENA	OSSINEKE	32	29	N	5	E

Transfer Date	Previous Operator	New Operator	WellName	Permit No.	County	TwpNm	Sec	Twp	TwpDir	Rng	RngDir
10/18/2019	RIVIERA OPERATING LLC	RIVERSIDE ENERGY MI LLC	STATE MITCHELL & DOCTORS CLUB D4-33	50733	ALPENA	OSSINEKE	33	29	N	5	E
10/18/2019	RIVIERA OPERATING LLC	RIVERSIDE ENERGY MI LLC	HOFFER D1-35	50401	ALPENA	OSSINEKE	35	29	N	5	E
10/18/2019	RIVIERA OPERATING LLC	RIVERSIDE ENERGY MI LLC	BROAD D3-27	50399	ALPENA	OSSINEKE	27	29	N	5	E
10/18/2019	RIVIERA OPERATING LLC	RIVERSIDE ENERGY MI LLC	RUMBLES C1-34	50339	ALPENA	OSSINEKE	34	29	N	7	E
10/18/2019	RIVIERA OPERATING LLC	RIVERSIDE ENERGY MI LLC	DOCTORS CLUB C4-28	50017	ALPENA	OSSINEKE	28	29	N	5	E
10/18/2019	RIVIERA OPERATING LLC	RIVERSIDE ENERGY MI LLC	DOCTORS CLUB C1-28	49968	ALPENA	OSSINEKE	28	29	N	5	E
10/18/2019	RIVIERA OPERATING LLC	RIVERSIDE ENERGY MI LLC	BIANCHINI D1-33	49966	ALPENA	OSSINEKE	33	29	N	5	E
10/18/2019	RIVIERA OPERATING LLC	RIVERSIDE ENERGY MI LLC	DOCTORS CLUB A3-33	49964	ALPENA	OSSINEKE	33	29	N	5	E
10/18/2019	RIVIERA OPERATING LLC	RIVERSIDE ENERGY MI LLC	WITTER D4-35	49869	ALPENA	OSSINEKE	35	29	N	6	E
10/18/2019	RIVIERA OPERATING LLC	RIVERSIDE ENERGY MI LLC	STATE OSSINEKE D4-24	49707	ALPENA	OSSINEKE	24	29	N	5	E