

Michigan Department of  
Environment, Great Lakes, and Energy  
Oil, Gas and Minerals Division

PERMIT LIST

10/21/2019 THRU 10/25/2019



Permit Number      Issue Date      Permittee Number      Permittee Name      Page 1

61459      10/23/2019      4934      FEDERATED OIL AND GAS  
PROPERTIES INC  
12719 S WEST BAY SHORE DR #5  
PO BOX 946  
TRAVERSE CITY, MI49684

API Well No: 21-141-62287-00-00

Prev Permit:

Well Name: STATE ALLIS & HYDE 1-18

Well Type: Oil Well

Permit Type: Drill

H2S Present? No

Surface Owner: HYDE, CLIFFORD,  
JERILYNN, JUSTIN, MELISSA,

True Vertical Depth: 3750FT

Target Formation: NIAGARAN BROWN

Deepest Formation: NIAGARAN GRAY

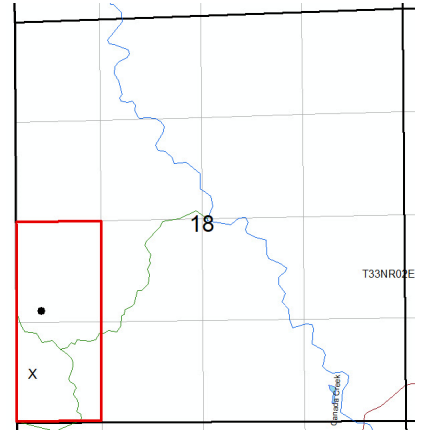

80-Acre Drilling Unit, W/2  
SW/4, Section 18

Location:	QT QT QT	Sec	Township	Range	Township Name	County	Feet From Section Line	Feet From DRLG Unit Line
SL:	SWSWSW	18	33N	2E	ALLIS	PRESQUE ISLE	617 S 203 W	
BHL:	SWNWSW	18	33N	2E	ALLIS	PRESQUE ISLE	1511 S 369 W	1126 N 369 W

Michigan Department of  
 Environment, Great Lakes, and Energy  
 Oil, Gas, and Minerals Division  
 Updated Permits  
 10/21/2019 THRU 10/25/2019  
**EGLE**

Permit Number      Permittee Number      Permittee Name

**PLUGGING INSTRUCTIONS ISSUED:**

17691            491                            CONSUMERS ENERGY CO  
 1945 W PARNALL RD  
 JACKSON, MI 49201

API Well Number: 21-113-17691-00-00

Well Name: M G S C 157

Plug Inst. Issue Date: 10/22/2019

Location	QT QT QT	Sec	Township	Range	Township Name	County	Feet From Section Line	Feet From DRLG Unit
SL:	CNENE	19	21N	7W	RIVERSIDE	MISSAUKEE	660 N 660 E	660 N 660 E

Comment: App to P&A expires on 10/22/20



Michigan Department of  
 Environment, Great Lakes, and Energy  
 Oil, Gas, and Minerals Division  
 Updated Permits  
 10/21/2019 THRU 10/25/2019  
**EGLE**

Permit Number      Permittee Number      Permittee Name

**RECORD OF WELL PLUGGING:**

36629      7772      LAMBDA ENERGY RESOURCES LLC  
 12012 Wickchester  
 Suite 300  
 Houston, TX 77055 USA

API Well Number: 21-099-36629-00-00

Well Name: MURMYLUK & STATE LENOX 3-36

Plugging Date: 9/20/2019

Location	QT QT QT	Sec	Township	Range	Township Name	County	Feet From Section Line	Feet From DRLG Unit
SL:	N2SENE	36	4N	14E	LENOX	MACOMB	1026 S 682 E	
BHL:	NWSENE	36	4N	14E	LENOX	MACOMB	953 S 976 E	367 N 344 W

37378      7772      LAMBDA ENERGY RESOURCES LLC  
 12012 Wickchester  
 Suite 300  
 Houston, TX 77055 USA

API Well Number: 21-099-37378-00-00

Well Name: MARCEREAU ET AL 6-36

Plugging Date: 9/26/2019

Location	QT QT QT	Sec	Township	Range	Township Name	County	Feet From Section Line	Feet From DRLG Unit
SL:	NENESW	36	4N	14E	LENOX	MACOMB	466 N 140 E	
BHL:	SESENW	36	4N	14E	LENOX	MACOMB	404 S 474 E	404 S 474 E

Michigan Department of  
 Environment, Great Lakes, and Energy  
 Oil, Gas, and Minerals Division  
 Updated Permits  
 10/21/2019 THRU 10/25/2019  
**EGL**

Permit Number      Permittee Number      Permittee Name

60901      6312      ARBOR OPERATING LLC  
 333 West Grandview Parkway  
 Suite 401  
 TRAVERSE CITY, MI49684

API Well Number: 21-115-60840-01-00

Well Name: RHINESS 1-6HD1

True Vertical Depth: 2085

Plugging Date: 9/14/2019

Location	QT QT QT	Sec	Township	Range	Township Name	County	Feet From Section Line	Feet From DRLG Unit
SL:	NESWNE	6	7S	6E	SUMMERFIELD	MONROE	1505 N 1962 E	
BHL:	NWNWNE	6	7S	6E	SUMMERFIELD	MONROE	531 N 2274 E	531 N 963 E

61355      6312      ARBOR OPERATING LLC  
 333 West Grandview Parkway  
 Suite 401  
 TRAVERSE CITY, MI49684

API Well Number: 21-115-60840-02-00

Well Name: RHINESS 1-6HD2

Plugging Date: 9/14/2019

Location	QT QT QT	Sec	Township	Range	Township Name	County	Feet From Section Line	Feet From DRLG Unit
SL:	NESWNE	6	7S	6E	SUMMERFIELD	MONROE	1505 N 1962 E	
BHL:	SWNWNE	6	7S	6E	SUMMERFIELD	MONROE	787 N 2315 E	787 N 341 W

Michigan Department of  
 Environment, Great Lakes, and Energy  
 Oil, Gas, and Minerals Division  
 Updated Permits  
 10/21/2019 THRU 10/25/2019  
**EGL**

Permit Number      Permittee Number      Permittee Name

46175            25                            DELTA OIL CO INC  
 125 WINDSOR DR STE 101  
 OAK BROOK, IL 60523

API Well Number: 21-119-46175-00-00  
 Well Name: STATE MONTMORENCY B4-33  
 Plugging Date: 8/7/2019

Location	QT QT QT	Sec	Township	Range	Township Name	County	Feet From Section Line	Feet From DRLG Unit
SL:	SESENE	33	32N	1E	MONTMORENCY	MONTMORENCY	550 S 485 E	550 S 485 E

47118            25                            DELTA OIL CO INC  
 125 WINDSOR DR STE 101  
 OAK BROOK, IL 60523

API Well Number: 21-119-47118-00-00  
 Well Name: STATE MONTMORENCY B1-33  
 Plugging Date: 7/24/2019

Location	QT QT QT	Sec	Township	Range	Township Name	County	Feet From Section Line	Feet From DRLG Unit
SL:	NWSWNW	33	32N	1E	MONTMORENCY	MONTMORENCY	832 S 437 W	473 N 437 W

Michigan Department of  
 Environment, Great Lakes, and Energy  
 Oil, Gas, and Minerals Division  
 Updated Permits  
 10/21/2019 THRU 10/25/2019  
**EGL**

Permit Number      Permittee Number      Permittee Name

47400            25                            DELTA OIL CO INC  
 125 WINDSOR DR STE 101  
 OAK BROOK, IL 60523

API Well Number: 21-119-47400-00-00  
 Well Name: STATE MONTMORENCY C2-33  
 Plugging Date: 7/26/2019

Location	QT QT QT	Sec	Township	Range	Township Name	County	Feet From Section Line	Feet From DRLG Unit
SL:	NWNESW	33	32N	1E	MONTMORENCY	MONTMORENCY	341 N 664 E	341 N 637 W

47403            25                            DELTA OIL CO INC  
 125 WINDSOR DR STE 101  
 OAK BROOK, IL 60523

API Well Number: 21-119-47403-00-00  
 Well Name: STATE MONTMORENCY C1-34  
 Plugging Date: 8/1/2019

Location	QT QT QT	Sec	Township	Range	Township Name	County	Feet From Section Line	Feet From DRLG Unit
SL:	NWNWSW	34	32N	1E	MONTMORENCY	MONTMORENCY	337 N 575 W	337 N 575 W

Michigan Department of  
 Environment, Great Lakes, and Energy  
 Oil, Gas, and Minerals Division  
 Updated Permits  
 10/21/2019 THRU 10/25/2019  
**EGL**

Permit Number      Permittee Number      Permittee Name

47616            25                            DELTA OIL CO INC  
 125 WINDSOR DR STE 101  
 OAK BROOK, IL 60523

API Well Number: 21-119-47616-00-00

Well Name: MASTERS B1-29

Plugging Date: 7/30/2019

Location	QT QT QT	Sec	Township	Range	Township Name	County	Feet From Section Line	Feet From DRLG Unit
SL:	SESWNW	29	32N	1E	MONTMORENCY	MONTMORENCY	339 S 901 W	339 S 436 E

47617            25                            DELTA OIL CO INC  
 125 WINDSOR DR STE 101  
 OAK BROOK, IL 60523

API Well Number: 21-119-47617-00-00

Well Name: RACK & FIN C4-32

Plugging Date: 8/15/2019

Location	QT QT QT	Sec	Township	Range	Township Name	County	Feet From Section Line	Feet From DRLG Unit
SL:	SENESE	32	32N	1E	MONTMORENCY	MONTMORENCY	813 N 655 E	497 S 655 E

Michigan Department of  
 Environment, Great Lakes, and Energy  
 Oil, Gas, and Minerals Division  
 Updated Permits  
 10/21/2019 THRU 10/25/2019  
**EGLE**

Permit Number      Permittee Number      Permittee Name

47660                  25                          DELTA OIL CO INC  
 125 WINDSOR DR STE 101  
 OAK BROOK, IL 60523

API Well Number: 21-119-47660-00-00

Well Name: STATE MONTMORENCY D4-32

Plugging Date: 8/13/2019

Location	QT QT QT	Sec	Township	Range	Township Name	County	Feet From Section Line	Feet From DRLG Unit
SL:	SESESE	32	32N	1E	MONTMORENCY	MONTMORENCY	612 S 516 E	612 S 516 E



Michigan Department of  
 Environment, Great Lakes, and Energy  
 Oil, Gas, and Minerals Division  
 Updated Permits  
 10/21/2019 THRU 10/25/2019  
**EGL**

Permit Number      Permittee Number      Permittee Name

**PERMIT TERMINATIONS:**

61185                  6582                  INTERSTATE EXPLORATIONS LLC  
 1331 LAMAR STREET, STE 1370  
 HOUSTON, TX 77010

API Well Number: 21-045-61185-00-00

Well Name: DOW 1-19

Termination Date: 10/24/2019

Location	QT QT QT	Sec	Township	Range	Township Name	County	Feet From Section Line	Feet From DRLG Unit
SL:	NESWSW	19	4N	5W	ROXAND	EATON	671 S 1043 W	651 N 356 E



Michigan Department of  
 Environment, Great Lakes, and Energy  
 Oil, Gas, and Minerals Division  
 Updated Permits  
 10/21/2019 THRU 10/25/2019  
**EGL**

Permit Number      Permittee Number      Permittee Name

**BOTTOM HOLE LOCATION CORRECTIONS:**

61371      6498      WOLVERINE GAS AND OIL  
 COMPANY OF MICHIGAN LLC  
 ONE RIVERFRONT PLAZA  
 55 CAMPAU, NW  
 GRAND RAPIDS, MI 49503

API Well Number: 21-077-62017-00-00

Well Name: SCHAU 26-1

Correction Date: 10/25/2019

Location	QT QT QT	Sec	Township	Range	Township Name	County	Feet From Section Line	Feet From DRLG Unit
SL:	NESESE	26	3S	10W	PAVILION	KALAMAZOO	952 S 631 E	
BHL:	NWSESE	26	3S	10W	PAVILION	KALAMAZOO	773 S 827 E	547 N 501 W





Permit Number      Permittee Number      Permittee Name

---

**TRANSFER OF OWNERSHIP:**

TABLES FOLLOW THIS PAGE

Transfer Date	Previous Operator	New Operator	WellName	Permit	County	TwpNm	Sec	Twp	TwpDir	Rng	RngDir
10/22/2019	RIVIERA OPERATING LLC	RIVERSIDE ENERGY MI LLC	WHITE PINE HUNTING CLUB B4-26	49385	ALPENA	OSSINEKE	26	29	N	5	E
10/22/2019	RIVIERA OPERATING LLC	RIVERSIDE ENERGY MI LLC	SCHULTZ A3-31	49404	ALPENA	OSSINEKE	31	29	N	7	E
10/22/2019	RIVIERA OPERATING LLC	RIVERSIDE ENERGY MI LLC	COOK D1-32	49406	ALPENA	OSSINEKE	32	29	N	7	E
10/22/2019	RIVIERA OPERATING LLC	RIVERSIDE ENERGY MI LLC	BROAD D1-22	49409	ALPENA	OSSINEKE	22	29	N	5	E
10/22/2019	RIVIERA OPERATING LLC	RIVERSIDE ENERGY MI LLC	GOLF TAM C2-11	49429	ALPENA	OSSINEKE	11	29	N	5	E
10/22/2019	RIVIERA OPERATING LLC	RIVERSIDE ENERGY MI LLC	SCHALKOFSKE A3-30	49541	ALPENA	OSSINEKE	30	29	N	7	E
10/22/2019	RIVIERA OPERATING LLC	RIVERSIDE ENERGY MI LLC	GOLF TAM D2-11	49549	ALPENA	OSSINEKE	11	29	N	5	E
10/22/2019	RIVIERA OPERATING LLC	RIVERSIDE ENERGY MI LLC	YANKOVITCH A1-33	49551	ALPENA	OSSINEKE	33	29	N	7	E
10/22/2019	RIVIERA OPERATING LLC	RIVERSIDE ENERGY MI LLC	RITTHALER A1-32	49553	ALPENA	OSSINEKE	32	29	N	7	E
10/22/2019	RIVIERA OPERATING LLC	RIVERSIDE ENERGY MI LLC	KOSLOSKI C4-19	49556	ALPENA	OSSINEKE	19	29	N	7	E
10/22/2019	RIVIERA OPERATING LLC	RIVERSIDE ENERGY MI LLC	STATE OSSINEKE B2-14	49585	ALPENA	OSSINEKE	14	29	N	5	E
10/22/2019	RIVIERA OPERATING LLC	RIVERSIDE ENERGY MI LLC	BROAD D1-15	49589	ALPENA	OSSINEKE	15	29	N	5	E
10/22/2019	RIVIERA OPERATING LLC	RIVERSIDE ENERGY MI LLC	TOLAN B2-36	49632	ALPENA	OSSINEKE	36	29	N	7	E
10/22/2019	RIVIERA OPERATING LLC	RIVERSIDE ENERGY MI LLC	NOBLE A1-34	49634	ALPENA	OSSINEKE	34	29	N	7	E
10/22/2019	RIVIERA OPERATING LLC	RIVERSIDE ENERGY MI LLC	WAGNER C2-35	49638	ALPENA	OSSINEKE	35	29	N	7	E
10/22/2019	RIVIERA OPERATING LLC	RIVERSIDE ENERGY MI LLC	BARTZ B4-34	49640	ALPENA	OSSINEKE	34	29	N	7	E
10/22/2019	RIVIERA OPERATING LLC	RIVERSIDE ENERGY MI LLC	DONAJKOWSKI C2-26	49643	ALPENA	OSSINEKE	26	29	N	7	E
10/22/2019	RIVIERA OPERATING LLC	RIVERSIDE ENERGY MI LLC	STATE OSSINEKE A2-24	49704	ALPENA	OSSINEKE	24	29	N	5	E
10/22/2019	RIVIERA OPERATING LLC	RIVERSIDE ENERGY MI LLC	STATE OSSINEKE D2-24	49867	ALPENA	OSSINEKE	24	29	N	6	E
10/22/2019	RIVIERA OPERATING LLC	RIVERSIDE ENERGY MI LLC	LISKE B1-28	49876	ALPENA	OSSINEKE	28	29	N	7	E
10/22/2019	RIVIERA OPERATING LLC	RIVERSIDE ENERGY MI LLC	BROAD B1-34	49965	ALPENA	OSSINEKE	34	29	N	5	E
10/22/2019	RIVIERA OPERATING LLC	RIVERSIDE ENERGY MI LLC	DOCTORS CLUB C3-33	49967	ALPENA	OSSINEKE	33	29	N	5	E
10/22/2019	RIVIERA OPERATING LLC	RIVERSIDE ENERGY MI LLC	DOCTORS CLUB C2-28	49969	ALPENA	OSSINEKE	28	29	N	5	E
10/22/2019	RIVIERA OPERATING LLC	RIVERSIDE ENERGY MI LLC	STATE OSSINEKE C4-35	50093	ALPENA	OSSINEKE	35	29	N	7	E
10/22/2019	RIVIERA OPERATING LLC	RIVERSIDE ENERGY MI LLC	STATE OSSINEKE A3-18	50393	ALPENA	OSSINEKE	18	29	N	6	E
10/22/2019	RIVIERA OPERATING LLC	RIVERSIDE ENERGY MI LLC	STATE OSSINEKE A4-30	50681	ALPENA	OSSINEKE	30	29	N	6	E
10/22/2019	RIVIERA OPERATING LLC	RIVERSIDE ENERGY MI LLC	DOCTORS CLUB & BROAD D1-27	50734	ALPENA	OSSINEKE	27	29	N	5	E
10/22/2019	RIVIERA OPERATING LLC	RIVERSIDE ENERGY MI LLC	BEYER D4-21	54306	ALPENA	WILSON	21	30	N	7	E
10/22/2019	RIVIERA OPERATING LLC	RIVERSIDE ENERGY MI LLC	STATE OSSINEKE & ZIEBARTH B4-9	54207	ALPENA	OSSINEKE	9	29	N	6	E
10/22/2019	RIVIERA OPERATING LLC	RIVERSIDE ENERGY MI LLC	STATE OSSINEKE & SADDLER D1-10	54190	ALPENA	OSSINEKE	10	29	N	6	E
10/22/2019	RIVIERA OPERATING LLC	RIVERSIDE ENERGY MI LLC	STATE OSSINEKE B2-25	54123	ALPENA	OSSINEKE	25	29	N	6	E
10/22/2019	RIVIERA OPERATING LLC	RIVERSIDE ENERGY MI LLC	STATE OSSINEKE & LUDEMAN D2-30	54015	ALPENA	OSSINEKE	30	29	N	7	E
10/22/2019	RIVIERA OPERATING LLC	RIVERSIDE ENERGY MI LLC	STATE OSSINEKE B2-31	54014	ALPENA	OSSINEKE	31	29	N	7	E
10/22/2019	RIVIERA OPERATING LLC	RIVERSIDE ENERGY MI LLC	CERNAT & GEROW D2-34	53987	ALPENA	OSSINEKE	34	29	N	7	E
10/22/2019	RIVIERA OPERATING LLC	RIVERSIDE ENERGY MI LLC	BROAD A2-27	53908	ALPENA	OSSINEKE	27	29	N	5	E
10/22/2019	RIVIERA OPERATING LLC	RIVERSIDE ENERGY MI LLC	BROAD BROTHERS A2-34	53903	ALPENA	OSSINEKE	34	29	N	5	E
10/22/2019	RIVIERA OPERATING LLC	RIVERSIDE ENERGY MI LLC	BECK & KLEIN ET AL C3-35	53892	ALPENA	OSSINEKE	35	29	N	5	E
10/22/2019	RIVIERA OPERATING LLC	RIVERSIDE ENERGY MI LLC	BROWN 4-24	53875	ALPENA	OSSINEKE	24	29	N	7	E
10/22/2019	RIVIERA OPERATING LLC	RIVERSIDE ENERGY MI LLC	STATE OSSINEKE & TIMM 16-2	53787	ALPENA	OSSINEKE	2	29	N	7	E
10/22/2019	RIVIERA OPERATING LLC	RIVERSIDE ENERGY MI LLC	BIANCHINI B1-33	53631	ALPENA	OSSINEKE	33	29	N	5	E
10/22/2019	RIVIERA OPERATING LLC	RIVERSIDE ENERGY MI LLC	STATE OSSINEKE D1-17	53597	ALPENA	OSSINEKE	17	29	N	6	E
10/22/2019	RIVIERA OPERATING LLC	RIVERSIDE ENERGY MI LLC	STATE OSSINEKE B4-36	53593	ALPENA	OSSINEKE	36	29	N	6	E
10/22/2019	RIVIERA OPERATING LLC	RIVERSIDE ENERGY MI LLC	STATE OSSINEKE & AMLLOTTE C4-24	53591	ALPENA	OSSINEKE	24	29	N	5	E
10/22/2019	RIVIERA OPERATING LLC	RIVERSIDE ENERGY MI LLC	STATE OSSINEKE & LOG CABIN B1-24	53590	ALPENA	OSSINEKE	24	29	N	5	E
10/22/2019	RIVIERA OPERATING LLC	RIVERSIDE ENERGY MI LLC	FERGUSON, ET. AL. B2-27	53558	ALPENA	OSSINEKE	27	29	N	7	E
10/22/2019	RIVIERA OPERATING LLC	RIVERSIDE ENERGY MI LLC	STATE OSSINEKE & CHRISTOLOVEON B2-30	53556	ALPENA	OSSINEKE	30	29	N	7	E
10/22/2019	RIVIERA OPERATING LLC	RIVERSIDE ENERGY MI LLC	GALEA & TRAILS END CAMP, ET AL B2-35HD	53554	ALPENA	OSSINEKE	35	29	N	6	E
10/22/2019	RIVIERA OPERATING LLC	RIVERSIDE ENERGY MI LLC	GALEA & TRAILS END CAMP, ET AL B2-35HD1	53554	ALPENA	OSSINEKE	35	29	N	6	E
10/22/2019	RIVIERA OPERATING LLC	RIVERSIDE ENERGY MI LLC	GALEA & TRAILS END CAMP, ET AL B2-35HD2	53554	ALPENA	OSSINEKE	35	29	N	6	E
10/22/2019	RIVIERA OPERATING LLC	RIVERSIDE ENERGY MI LLC	HALE C2-16	53552	ALPENA	OSSINEKE	16	29	N	7	E
10/22/2019	RIVIERA OPERATING LLC	RIVERSIDE ENERGY MI LLC	KLEIN & GREENFIELD D3-26 HD	53537	ALPENA	OSSINEKE	26	29	N	5	E
10/22/2019	RIVIERA OPERATING LLC	RIVERSIDE ENERGY MI LLC	KLEIN & GREENFIELD D3-26 HD1	53537	ALPENA	OSSINEKE	26	29	N	5	E

Transfer Date	Previous Operator	New Operator	WellName	Permit	County	TwpNm	Sec	Twp	TwpDir	Rng	RngDir
10/22/2019	RIVIERA OPERATING LLC	RIVERSIDE ENERGY MI LLC	KLEIN & GREENFIELD D3-26 HD2	53537	ALPENA	OSSINEKE	26	29	N	5	E
10/22/2019	RIVIERA OPERATING LLC	RIVERSIDE ENERGY MI LLC	KLEIN A4-35	53513	ALPENA	OSSINEKE	35	29	N	5	E
10/22/2019	RIVIERA OPERATING LLC	RIVERSIDE ENERGY MI LLC	WERTH A2-17	53414	ALPENA	WILSON	17	30	N	7	E
10/22/2019	RIVIERA OPERATING LLC	RIVERSIDE ENERGY MI LLC	STATE OSSINEKE C2-24	53264	ALPENA	OSSINEKE	24	29	N	6	E
10/22/2019	RIVIERA OPERATING LLC	RIVERSIDE ENERGY MI LLC	STATE OSSINEKE D2-13	53250	ALPENA	OSSINEKE	13	29	N	6	E
10/22/2019	RIVIERA OPERATING LLC	RIVERSIDE ENERGY MI LLC	STATE OSSINEKE & DUNKEL TR ET AL D1-20	53164	ALPENA	OSSINEKE	20	29	N	6	E
10/22/2019	RIVIERA OPERATING LLC	RIVERSIDE ENERGY MI LLC	STATE OSSINEKE/WALLACE HUNT CLUB B2-17	53162	ALPENA	OSSINEKE	17	29	N	6	E
10/22/2019	RIVIERA OPERATING LLC	RIVERSIDE ENERGY MI LLC	DUNKEL TRUST ET AL C3-20HDS	53126	ALPENA	OSSINEKE	20	29	N	6	E
10/22/2019	RIVIERA OPERATING LLC	RIVERSIDE ENERGY MI LLC	BROAD B4-22	53123	ALPENA	OSSINEKE	22	29	N	5	E
10/22/2019	RIVIERA OPERATING LLC	RIVERSIDE ENERGY MI LLC	BROAD B2-22	53099	ALPENA	OSSINEKE	22	29	N	5	E
10/22/2019	RIVIERA OPERATING LLC	RIVERSIDE ENERGY MI LLC	STATE OSSINEKE A3-31	53066	ALPENA	OSSINEKE	31	29	N	6	E
10/22/2019	RIVIERA OPERATING LLC	RIVERSIDE ENERGY MI LLC	STATE OSSINEKE D1-30	53065	ALPENA	OSSINEKE	30	29	N	6	E
10/22/2019	RIVIERA OPERATING LLC	RIVERSIDE ENERGY MI LLC	STATE OSSINEKE & DUNKEL TRUST ET AL A3-20	53064	ALPENA	OSSINEKE	20	29	N	6	E
10/22/2019	RIVIERA OPERATING LLC	RIVERSIDE ENERGY MI LLC	WITTER ET AL C3-35	53054	ALPENA	OSSINEKE	35	29	N	6	E
10/22/2019	RIVIERA OPERATING LLC	RIVERSIDE ENERGY MI LLC	STATE OSSINEKE B2-19	52985	ALPENA	OSSINEKE	19	29	N	6	E
10/22/2019	RIVIERA OPERATING LLC	RIVERSIDE ENERGY MI LLC	RITTHALER B1-32	52888	ALPENA	OSSINEKE	32	29	N	7	E
10/22/2019	RIVIERA OPERATING LLC	RIVERSIDE ENERGY MI LLC	BARTZ & MILLER D2-20	52815	ALPENA	OSSINEKE	20	29	N	7	E
10/22/2019	RIVIERA OPERATING LLC	RIVERSIDE ENERGY MI LLC	SOMMERFELD & MELVILLE B3-32	50737	ALPENA	OSSINEKE	32	29	N	5	E
10/22/2019	RIVIERA OPERATING LLC	RIVERSIDE ENERGY MI LLC	MAIN HUNTING CLUB D2-32	50739	ALPENA	OSSINEKE	32	29	N	5	E
10/22/2019	RIVIERA OPERATING LLC	RIVERSIDE ENERGY MI LLC	CARLSON C1-31	50741	ALPENA	OSSINEKE	31	29	N	5	E
10/22/2019	RIVIERA OPERATING LLC	RIVERSIDE ENERGY MI LLC	BROAD & KLEIN A4-34	50743	ALPENA	OSSINEKE	34	29	N	5	E
10/22/2019	RIVIERA OPERATING LLC	RIVERSIDE ENERGY MI LLC	STOKES PROPERTIES INC D4-20	50880	ALPENA	OSSINEKE	20	29	N	7	E
10/22/2019	RIVIERA OPERATING LLC	RIVERSIDE ENERGY MI LLC	STATE OSSINEKE B4-25	51034	ALPENA	OSSINEKE	25	29	N	6	E
10/22/2019	RIVIERA OPERATING LLC	RIVERSIDE ENERGY MI LLC	BROAD B3-10	51039	ALPENA	OSSINEKE	10	29	N	5	E
10/22/2019	RIVIERA OPERATING LLC	RIVERSIDE ENERGY MI LLC	BROAD C2-3	51041	ALPENA	OSSINEKE	3	29	N	5	E
10/22/2019	RIVIERA OPERATING LLC	RIVERSIDE ENERGY MI LLC	BECK, ET AL D4-35	51109	ALPENA	OSSINEKE	35	29	N	5	E
10/22/2019	RIVIERA OPERATING LLC	RIVERSIDE ENERGY MI LLC	SCHALKOFSKI B4-32	51316	ALPENA	OSSINEKE	32	29	N	7	E
10/22/2019	RIVIERA OPERATING LLC	RIVERSIDE ENERGY MI LLC	SCHALKOFSKI B4-32SUMP	51316	ALPENA	OSSINEKE	32	29	N	7	E
10/22/2019	RIVIERA OPERATING LLC	RIVERSIDE ENERGY MI LLC	SCHALKOFSKI B4-32HD1	51316	ALPENA	OSSINEKE	32	29	N	7	E
10/22/2019	RIVIERA OPERATING LLC	RIVERSIDE ENERGY MI LLC	TIMM C4-26	51318	ALPENA	OSSINEKE	26	29	N	7	E
10/22/2019	RIVIERA OPERATING LLC	RIVERSIDE ENERGY MI LLC	BATES D2-21	51322	ALPENA	OSSINEKE	21	29	N	7	E
10/22/2019	RIVIERA OPERATING LLC	RIVERSIDE ENERGY MI LLC	STATE OSSINEKE & ABBOTT B1-13	51336	ALPENA	OSSINEKE	13	29	N	6	E
10/22/2019	RIVIERA OPERATING LLC	RIVERSIDE ENERGY MI LLC	STATE OSSINEKE A1-14	51345	ALPENA	OSSINEKE	14	29	N	6	E
10/22/2019	RIVIERA OPERATING LLC	RIVERSIDE ENERGY MI LLC	PERKINS & DONAJOWSKI D4-27	51575	ALPENA	OSSINEKE	27	29	N	7	E
10/22/2019	RIVIERA OPERATING LLC	RIVERSIDE ENERGY MI LLC	MANNING C2-17	52388	ALPENA	OSSINEKE	17	29	N	7	E
10/22/2019	RIVIERA OPERATING LLC	RIVERSIDE ENERGY MI LLC	STOKES PROPERTIES B2-9	52390	ALPENA	OSSINEKE	9	29	N	7	E
10/22/2019	RIVIERA OPERATING LLC	RIVERSIDE ENERGY MI LLC	KING B1-9	52642	ALPENA	WILSON	9	30	N	7	E
10/22/2019	RIVIERA OPERATING LLC	RIVERSIDE ENERGY MI LLC	PEASLEY A2-8	52647	ALPENA	WILSON	8	30	N	7	E
10/22/2019	RIVIERA OPERATING LLC	RIVERSIDE ENERGY MI LLC	ZBYTOWSKI C1-9	52649	ALPENA	WILSON	9	30	N	7	E
10/22/2019	RIVIERA OPERATING LLC	RIVERSIDE ENERGY MI LLC	WERTH B3-17	52677	ALPENA	WILSON	17	30	N	7	E
10/22/2019	RIVIERA OPERATING LLC	RIVERSIDE ENERGY MI LLC	WERTH D4-8	52715	ALPENA	WILSON	8	30	N	7	E
10/22/2019	RIVIERA OPERATING LLC	RIVERSIDE ENERGY MI LLC	WERTH A3-17	52740	ALPENA	WILSON	17	30	N	7	E
10/22/2019	RIVIERA OPERATING LLC	RIVERSIDE ENERGY MI LLC	STATE OSSINEKE A3-25	53592	ALPENA	OSSINEKE	25	29	N	5	E
10/22/2019	RIVIERA OPERATING LLC	RIVERSIDE ENERGY MI LLC	MANCELONA I D1-4	46469	ANTRIM	MANCELONA	4	29	N	5	W
10/22/2019	RIVIERA OPERATING LLC	RIVERSIDE ENERGY MI LLC	STATE MANCELONA I B3-8	46474	ANTRIM	MANCELONA	8	29	N	5	W
10/22/2019	RIVIERA OPERATING LLC	RIVERSIDE ENERGY MI LLC	ZEIDLER A4-26	45801	OTSEGO	CHARLTON	26	30	N	1	W
10/22/2019	RIVIERA OPERATING LLC	RIVERSIDE ENERGY MI LLC	DOLLAR LAKE 1-31 SWD	45725	MONTMORENCY	ALBERT	31	29	N	1	E
10/22/2019	RIVIERA OPERATING LLC	RIVERSIDE ENERGY MI LLC	STATE ALBERT 1-13 SWD	46349	MONTMORENCY	ALBERT	13	29	N	2	E
10/23/2019	RIVIERA OPERATING LLC	RIVERSIDE ENERGY MI LLC	GLANCY A3-2	55800	ALPENA	WILSON	2	30	N	6	E
10/23/2019	RIVIERA OPERATING LLC	RIVERSIDE ENERGY MI LLC	BAKER A1-1	55791	ALPENA	WILSON	1	30	N	6	E
10/23/2019	RIVIERA OPERATING LLC	RIVERSIDE ENERGY MI LLC	RATZ A3-35	55780	ALPENA	WILSON	35	30	N	7	E
10/23/2019	RIVIERA OPERATING LLC	RIVERSIDE ENERGY MI LLC	TINNEFELD B4-24	55776	ALPENA	OSSINEKE	24	29	N	7	E

Transfer Date	Previous Operator	New Operator	WellName	Permit	County	TwpNm	Sec	Twp	TwpDir	Rng	RngDir
10/23/2019	RIVIERA OPERATING LLC	RIVERSIDE ENERGY MI LLC	ACRC D3-35	55775	ALPENA	WILSON	35	31	N		6 E
10/23/2019	RIVIERA OPERATING LLC	RIVERSIDE ENERGY MI LLC	BAKER B1-1	55774	ALPENA	WILSON	1	30	N		6 E
10/23/2019	RIVIERA OPERATING LLC	RIVERSIDE ENERGY MI LLC	ACRC C3-35	55773	ALPENA	WILSON	35	31	N		6 E
10/23/2019	RIVIERA OPERATING LLC	RIVERSIDE ENERGY MI LLC	SAMP A2-20	55763	ALPENA	WILSON	20	30	N		7 E
10/23/2019	RIVIERA OPERATING LLC	RIVERSIDE ENERGY MI LLC	ELLER B1-19	55760	ALPENA	SANBORN	19	29	N		8 E
10/23/2019	RIVIERA OPERATING LLC	RIVERSIDE ENERGY MI LLC	RIVERSIDE ENERGY D2-13	55759	ALPENA	OSSINEKE	13	29	N		7 E
10/23/2019	RIVIERA OPERATING LLC	RIVERSIDE ENERGY MI LLC	KEEN D3-13	55758	ALPENA	OSSINEKE	13	29	N		7 E
10/23/2019	RIVIERA OPERATING LLC	RIVERSIDE ENERGY MI LLC	KOLLIEN A1-13	55757	ALPENA	OSSINEKE	13	29	N		7 E
10/23/2019	RIVIERA OPERATING LLC	RIVERSIDE ENERGY MI LLC	KOLLIEN B2-13	55756	ALPENA	OSSINEKE	13	29	N		7 E
10/23/2019	RIVIERA OPERATING LLC	RIVERSIDE ENERGY MI LLC	LISKE B4-14	55702	ALPENA	OSSINEKE	14	29	N		7 E
10/23/2019	RIVIERA OPERATING LLC	RIVERSIDE ENERGY MI LLC	KIRSCHNER B2-14	55701	ALPENA	OSSINEKE	14	29	N		7 E
10/23/2019	RIVIERA OPERATING LLC	RIVERSIDE ENERGY MI LLC	ARTHUR A4-36	55700	ALPENA	WILSON	36	30	N		7 E
10/23/2019	RIVIERA OPERATING LLC	RIVERSIDE ENERGY MI LLC	BAKER D2-25	55694	ALPENA	WILSON	25	30	N		7 E
10/23/2019	RIVIERA OPERATING LLC	RIVERSIDE ENERGY MI LLC	KLARICH B3-23 SWD	55634	ALPENA	OSSINEKE	23	29	N		7 E
10/23/2019	RIVIERA OPERATING LLC	RIVERSIDE ENERGY MI LLC	KIRSCHNER A1-14	55631	ALPENA	OSSINEKE	14	29	N		7 E
10/23/2019	RIVIERA OPERATING LLC	RIVERSIDE ENERGY MI LLC	BRUSKE A4-13	55630	ALPENA	OSSINEKE	13	29	N		7 E
10/23/2019	RIVIERA OPERATING LLC	RIVERSIDE ENERGY MI LLC	RIVERSIDE ENERGY C1-13	55629	ALPENA	OSSINEKE	13	29	N		7 E
10/23/2019	RIVIERA OPERATING LLC	RIVERSIDE ENERGY MI LLC	GOLDER C1-28	55609	ALPENA	WILSON	28	30	N		7 E
10/23/2019	RIVIERA OPERATING LLC	RIVERSIDE ENERGY MI LLC	EPLEY C4-24	55590	ALPENA	OSSINEKE	24	29	N		7 E
10/23/2019	RIVIERA OPERATING LLC	RIVERSIDE ENERGY MI LLC	STATE OSSINEKE A1-36	55588	ALPENA	OSSINEKE	36	29	N		7 E
10/23/2019	RIVIERA OPERATING LLC	RIVERSIDE ENERGY MI LLC	GLANCY D3-2	55580	ALPENA	WILSON	2	30	N		6 E
10/23/2019	RIVIERA OPERATING LLC	RIVERSIDE ENERGY MI LLC	STATE OSSINEKE & WILKE A2-26	55519	ALPENA	OSSINEKE	26	29	N		7 E
10/23/2019	RIVIERA OPERATING LLC	RIVERSIDE ENERGY MI LLC	STATE OSSINEKE & LISKE A3-36	55513	ALPENA	OSSINEKE	36	29	N		7 E
10/23/2019	RIVIERA OPERATING LLC	RIVERSIDE ENERGY MI LLC	OSBORN C1-26	55512	ALPENA	OSSINEKE	26	29	N		7 E
10/23/2019	RIVIERA OPERATING LLC	RIVERSIDE ENERGY MI LLC	GRZESKOWIAK D4-2	55511	ALPENA	WILSON	2	30	N		6 E
10/23/2019	RIVIERA OPERATING LLC	RIVERSIDE ENERGY MI LLC	STATE OSSINEKE & SALAMON B1-25	55510	ALPENA	OSSINEKE	25	29	N		7 E
10/23/2019	RIVIERA OPERATING LLC	RIVERSIDE ENERGY MI LLC	STATE OSSINEKE & ORTLIEB C4-36	55492	ALPENA	OSSINEKE	36	29	N		7 E
10/23/2019	RIVIERA OPERATING LLC	RIVERSIDE ENERGY MI LLC	STATE OSSINEKE & COCHRAN A1-25	55485	ALPENA	OSSINEKE	25	29	N		7 E
10/23/2019	RIVIERA OPERATING LLC	RIVERSIDE ENERGY MI LLC	LEE D1-31	55484	ALPENA	SANBORN	31	29	N		8 E
10/23/2019	RIVIERA OPERATING LLC	RIVERSIDE ENERGY MI LLC	RONDEAU C1-30	55481	ALPENA	SANBORN	30	29	N		8 E
10/23/2019	RIVIERA OPERATING LLC	RIVERSIDE ENERGY MI LLC	STATE OSSINEKE B2-25	55469	ALPENA	OSSINEKE	25	29	N		7 E
10/23/2019	RIVIERA OPERATING LLC	RIVERSIDE ENERGY MI LLC	STATE OSSINEKE B3-25	55468	ALPENA	OSSINEKE	25	29	N		7 E
10/23/2019	RIVIERA OPERATING LLC	RIVERSIDE ENERGY MI LLC	STATE OSSINEKE & EAGLE B4-25	55467	ALPENA	OSSINEKE	25	29	N		7 E
10/23/2019	RIVIERA OPERATING LLC	RIVERSIDE ENERGY MI LLC	STATE OSSINEKE D3-36	55466	ALPENA	OSSINEKE	36	29	N		7 E
10/23/2019	RIVIERA OPERATING LLC	RIVERSIDE ENERGY MI LLC	RABEAU A3-7	55463	ALPENA	WILSON	7	30	N		7 E
10/23/2019	RIVIERA OPERATING LLC	RIVERSIDE ENERGY MI LLC	STATE SANBORN & LACROSS D1-30	55462	ALPENA	SANBORN	30	29	N		8 E
10/23/2019	RIVIERA OPERATING LLC	RIVERSIDE ENERGY MI LLC	STATE OSSINEKE B4-26	55461	ALPENA	OSSINEKE	26	29	N		7 E
10/23/2019	RIVIERA OPERATING LLC	RIVERSIDE ENERGY MI LLC	ARMSTRONG B4-12	55456	ALPENA	WILSON	12	30	N		6 E
10/23/2019	RIVIERA OPERATING LLC	RIVERSIDE ENERGY MI LLC	WIECZORKOWSKI A4-12	55437	ALPENA	WILSON	12	30	N		6 E
10/23/2019	RIVIERA OPERATING LLC	RIVERSIDE ENERGY MI LLC	ZBYTOWSKI D1-2	55436	ALPENA	WILSON	2	30	N		6 E
10/23/2019	RIVIERA OPERATING LLC	RIVERSIDE ENERGY MI LLC	STATE OSSINEKE & BRILINSKI A4-33	55432	ALPENA	OSSINEKE	33	29	N		5 E
10/23/2019	RIVIERA OPERATING LLC	RIVERSIDE ENERGY MI LLC	STATE OSSINEKE D4-34	55431	ALPENA	OSSINEKE	34	29	N		5 E
10/23/2019	RIVIERA OPERATING LLC	RIVERSIDE ENERGY MI LLC	MAIN & HEALY C3-32	55430	ALPENA	OSSINEKE	32	29	N		5 E
10/23/2019	RIVIERA OPERATING LLC	RIVERSIDE ENERGY MI LLC	BRILINSKI ET AL B4-33	55429	ALPENA	OSSINEKE	33	29	N		5 E
10/23/2019	RIVIERA OPERATING LLC	RIVERSIDE ENERGY MI LLC	BECK & KLEIN B2-35	55428	ALPENA	OSSINEKE	35	29	N		5 E
10/23/2019	RIVIERA OPERATING LLC	RIVERSIDE ENERGY MI LLC	ZARSKIE A2-7	55420	ALPENA	WILSON	7	30	N		7 E
10/23/2019	RIVIERA OPERATING LLC	RIVERSIDE ENERGY MI LLC	SANDY ROE HUNT CLUB C4-31	55401	ALPENA	OSSINEKE	31	29	N		5 E
10/23/2019	RIVIERA OPERATING LLC	RIVERSIDE ENERGY MI LLC	MARWEDE D3-20	55063	ALPENA	WILSON	20	30	N		7 E
10/23/2019	RIVIERA OPERATING LLC	RIVERSIDE ENERGY MI LLC	CENTALA D4-16	55062	ALPENA	WILSON	16	30	N		7 E
10/23/2019	RIVIERA OPERATING LLC	RIVERSIDE ENERGY MI LLC	JABS D4-20	54871	ALPENA	WILSON	20	30	N		7 E
10/23/2019	RIVIERA OPERATING LLC	RIVERSIDE ENERGY MI LLC	WOLF CREEK LAND CO A2-28	54851	ALPENA	OSSINEKE	28	29	N		6 E
10/23/2019	RIVIERA OPERATING LLC	RIVERSIDE ENERGY MI LLC	STATE OSSINEKE & SCHULTZ C3-31	54756	ALPENA	OSSINEKE	31	29	N		7 E

Transfer Date	Previous Operator	New Operator	WellName	Permit	County	TwpNm	Sec	Twp	TwpDir	Rng	RngDir
10/23/2019	RIVIERA OPERATING LLC	RIVERSIDE ENERGY MI LLC	BEYER D2-21	54713	ALPENA	WILSON	21	30	N	7	E
10/23/2019	RIVIERA OPERATING LLC	RIVERSIDE ENERGY MI LLC	ZIELASKOWSKI B3-20	54697	ALPENA	WILSON	20	30	N	7	E
10/23/2019	RIVIERA OPERATING LLC	RIVERSIDE ENERGY MI LLC	HARTFIELD A3-33	54649	ALPENA	OSSINEKE	33	29	N	6	E
10/23/2019	RIVIERA OPERATING LLC	RIVERSIDE ENERGY MI LLC	JENKINS FAMILY LTD D2-28	54647	ALPENA	OSSINEKE	28	29	N	6	E
10/23/2019	RIVIERA OPERATING LLC	RIVERSIDE ENERGY MI LLC	HARTFIELD B3-33	54646	ALPENA	OSSINEKE	33	29	N	6	E
10/23/2019	RIVIERA OPERATING LLC	RIVERSIDE ENERGY MI LLC	KLARICH A1-34	54645	ALPENA	OSSINEKE	34	29	N	6	E
10/23/2019	RIVIERA OPERATING LLC	RIVERSIDE ENERGY MI LLC	BIRCH HILL HUNTING CLUB C3-21	54644	ALPENA	OSSINEKE	21	29	N	6	E
10/23/2019	RIVIERA OPERATING LLC	RIVERSIDE ENERGY MI LLC	BIRCH HILL HUNTING CLUB B3-21	54643	ALPENA	OSSINEKE	21	29	N	6	E
10/23/2019	RIVIERA OPERATING LLC	RIVERSIDE ENERGY MI LLC	BIRCH HILL HUNTING CLUB D2-27	54642	ALPENA	OSSINEKE	27	29	N	6	E
10/23/2019	RIVIERA OPERATING LLC	RIVERSIDE ENERGY MI LLC	BIRCH HILL HUNTING CLUB B4-28	54641	ALPENA	OSSINEKE	28	29	N	6	E
10/23/2019	RIVIERA OPERATING LLC	RIVERSIDE ENERGY MI LLC	BIRCH HILL HUNTING CLUB D3-21	54640	ALPENA	OSSINEKE	21	29	N	6	E
10/23/2019	RIVIERA OPERATING LLC	RIVERSIDE ENERGY MI LLC	KLARICH D4-28	54639	ALPENA	OSSINEKE	28	29	N	6	E
10/23/2019	RIVIERA OPERATING LLC	RIVERSIDE ENERGY MI LLC	KLARICH C1-27	54637	ALPENA	OSSINEKE	27	29	N	6	E
10/23/2019	RIVIERA OPERATING LLC	RIVERSIDE ENERGY MI LLC	BIRCH HILL HUNTING CLUB A3-28	54636	ALPENA	OSSINEKE	28	29	N	6	E
10/23/2019	RIVIERA OPERATING LLC	RIVERSIDE ENERGY MI LLC	LEE B1-31	54534	ALPENA	SANBORN	31	29	N	8	E
10/23/2019	RIVIERA OPERATING LLC	RIVERSIDE ENERGY MI LLC	SIESS C1-15	54508	ALPENA	WILSON	15	30	N	7	E
10/23/2019	RIVIERA OPERATING LLC	RIVERSIDE ENERGY MI LLC	LISKE A1-22	54312	ALPENA	WILSON	22	30	N	7	E
10/23/2019	RIVIERA OPERATING LLC	RIVERSIDE ENERGY MI LLC	ACRC A2-11	55439	ALPENA	WILSON	11	30	N	6	E
10/23/2019	RIVIERA OPERATING LLC	RIVERSIDE ENERGY MI LLC	LAKES OF THE NORTH D1-2	46635	ANTRIM	MANCELONA	2	29	N	5	W
10/23/2019	RIVIERA OPERATING LLC	RIVERSIDE ENERGY MI LLC	LAKES OF THE NORTH B1-2	46684	ANTRIM	MANCELONA	2	29	N	5	W
10/23/2019	RIVIERA OPERATING LLC	RIVERSIDE ENERGY MI LLC	MANCELONA I C4-13	46884	ANTRIM	MANCELONA	13	29	N	6	W
10/24/2019	RIVIERA OPERATING LLC	RIVERSIDE ENERGY MI LLC	WOLOSZYK B3-3	55881	ALPENA	WILSON	3	30	N	6	E
10/24/2019	RIVIERA OPERATING LLC	RIVERSIDE ENERGY MI LLC	WOLOSZYK A3-3	55819	ALPENA	WILSON	3	30	N	6	E
10/24/2019	RIVIERA OPERATING LLC	RIVERSIDE ENERGY MI LLC	ROBBINS A3-26	55808	ALPENA	OSSINEKE	26	29	N	7	E
10/24/2019	RIVIERA OPERATING LLC	RIVERSIDE ENERGY MI LLC	NYE C1-7	55801	ALPENA	WILSON	7	30	N	7	E
10/24/2019	RIVIERA OPERATING LLC	RIVERSIDE ENERGY MI LLC	NYE C1-7HD	55801	ALPENA	WILSON	7	30	N	7	E
10/24/2019	RIVIERA OPERATING LLC	RIVERSIDE ENERGY MI LLC	MANCELONA I D4-13	46885	ANTRIM	MANCELONA	13	29	N	6	W
10/24/2019	RIVIERA OPERATING LLC	RIVERSIDE ENERGY MI LLC	MANCELONA I C2-4	46989	ANTRIM	MANCELONA	4	29	N	5	W
10/24/2019	RIVIERA OPERATING LLC	RIVERSIDE ENERGY MI LLC	MANCELONA I C4-4	46990	ANTRIM	MANCELONA	4	29	N	5	W
10/24/2019	RIVIERA OPERATING LLC	RIVERSIDE ENERGY MI LLC	MANCELONA I B1-4	46992	ANTRIM	MANCELONA	4	29	N	5	W
10/24/2019	RIVIERA OPERATING LLC	RIVERSIDE ENERGY MI LLC	MANCELONA I D1-17	47003	ANTRIM	MANCELONA	17	29	N	5	W
10/24/2019	RIVIERA OPERATING LLC	RIVERSIDE ENERGY MI LLC	STATE MANCELONA I D1-8	47004	ANTRIM	MANCELONA	8	29	N	5	W
10/24/2019	RIVIERA OPERATING LLC	RIVERSIDE ENERGY MI LLC	STATE MANCELONA I D2-8	47005	ANTRIM	MANCELONA	8	29	N	5	W
10/24/2019	RIVIERA OPERATING LLC	RIVERSIDE ENERGY MI LLC	STATE MANCELONA I A3-7	47013	ANTRIM	MANCELONA	7	29	N	5	W
10/24/2019	RIVIERA OPERATING LLC	RIVERSIDE ENERGY MI LLC	STATE MANCELONA I B1-7	47014	ANTRIM	MANCELONA	7	29	N	5	W
10/24/2019	RIVIERA OPERATING LLC	RIVERSIDE ENERGY MI LLC	STATE MANCELONA I B4-7	47015	ANTRIM	MANCELONA	7	29	N	5	W
10/24/2019	RIVIERA OPERATING LLC	RIVERSIDE ENERGY MI LLC	STATE MANCELONA I C3-7	47016	ANTRIM	MANCELONA	7	29	N	5	W
10/24/2019	RIVIERA OPERATING LLC	RIVERSIDE ENERGY MI LLC	STATE MANCELONA I D1-7	47017	ANTRIM	MANCELONA	7	29	N	5	W
10/24/2019	RIVIERA OPERATING LLC	RIVERSIDE ENERGY MI LLC	STATE MANCELONA I A1-15	47055	ANTRIM	MANCELONA	15	29	N	5	W
10/24/2019	RIVIERA OPERATING LLC	RIVERSIDE ENERGY MI LLC	STATE MANCELONA I C2-15	47057	ANTRIM	MANCELONA	15	29	N	5	W
10/24/2019	RIVIERA OPERATING LLC	RIVERSIDE ENERGY MI LLC	STATE MANCELONA I D1-15	47058	ANTRIM	MANCELONA	15	29	N	5	W
10/24/2019	RIVIERA OPERATING LLC	RIVERSIDE ENERGY MI LLC	STATE MANCELONA I A1-16	47059	ANTRIM	MANCELONA	16	29	N	5	W
10/24/2019	RIVIERA OPERATING LLC	RIVERSIDE ENERGY MI LLC	STATE MANCELONA I B1-16	47060	ANTRIM	MANCELONA	16	29	N	5	W
10/24/2019	RIVIERA OPERATING LLC	RIVERSIDE ENERGY MI LLC	STATE MANCELONA I D1-16	47061	ANTRIM	MANCELONA	16	29	N	5	W
10/24/2019	RIVIERA OPERATING LLC	RIVERSIDE ENERGY MI LLC	STATE MANCELONA I D2-17	47062	ANTRIM	MANCELONA	17	29	N	5	W
10/24/2019	RIVIERA OPERATING LLC	RIVERSIDE ENERGY MI LLC	STATE MANCELONA I D4-17	47063	ANTRIM	MANCELONA	17	29	N	5	W
10/24/2019	RIVIERA OPERATING LLC	RIVERSIDE ENERGY MI LLC	LAKES OF THE NORTH A2-14	47097	ANTRIM	MANCELONA	14	29	N	5	W
10/24/2019	RIVIERA OPERATING LLC	RIVERSIDE ENERGY MI LLC	LAKES OF THE NORTH D3-3	47098	ANTRIM	MANCELONA	3	29	N	5	W
10/24/2019	RIVIERA OPERATING LLC	RIVERSIDE ENERGY MI LLC	LAKES OF THE NORTH D1-3	47099	ANTRIM	MANCELONA	3	29	N	5	W
10/24/2019	RIVIERA OPERATING LLC	RIVERSIDE ENERGY MI LLC	LAKES OF THE NORTH B2-11	47133	ANTRIM	MANCELONA	11	29	N	5	W
10/24/2019	RIVIERA OPERATING LLC	RIVERSIDE ENERGY MI LLC	LAKES OF THE NORTH D1-14	47136	ANTRIM	MANCELONA	14	29	N	5	W
10/24/2019	RIVIERA OPERATING LLC	RIVERSIDE ENERGY MI LLC	LAKES OF THE NORTH B1-14	47145	ANTRIM	MANCELONA	14	29	N	5	W

Transfer Date	Previous Operator	New Operator	WellName	Permit	County	TwpNm	Sec	Twp	TwpDir	Rng	RngDir
10/24/2019	RIVIERA OPERATING LLC	RIVERSIDE ENERGY MI LLC	LAKES OF THE NORTH C3-14	47146	ANTRIM	MANCELONA	14	29	N	5	W
10/24/2019	RIVIERA OPERATING LLC	RIVERSIDE ENERGY MI LLC	STATE MANCELONA I A3-16	47190	ANTRIM	MANCELONA	16	29	N	5	W
10/24/2019	RIVIERA OPERATING LLC	RIVERSIDE ENERGY MI LLC	MANCELONA I D1-5	47191	ANTRIM	MANCELONA	5	29	N	5	W
10/24/2019	RIVIERA OPERATING LLC	RIVERSIDE ENERGY MI LLC	MANCELONA I D3-5	47192	ANTRIM	MANCELONA	5	29	N	5	W
10/24/2019	RIVIERA OPERATING LLC	RIVERSIDE ENERGY MI LLC	MANCELONA I C4-5	47193	ANTRIM	MANCELONA	5	29	N	5	W
10/24/2019	RIVIERA OPERATING LLC	RIVERSIDE ENERGY MI LLC	MANCELONA I B2-5	47194	ANTRIM	MANCELONA	5	29	N	5	W
10/24/2019	RIVIERA OPERATING LLC	RIVERSIDE ENERGY MI LLC	MANCELONA I B3-5	47195	ANTRIM	MANCELONA	5	29	N	5	W
10/24/2019	RIVIERA OPERATING LLC	RIVERSIDE ENERGY MI LLC	LAKES OF THE NORTH C2-2	47227	ANTRIM	MANCELONA	2	29	N	5	W
10/24/2019	RIVIERA OPERATING LLC	RIVERSIDE ENERGY MI LLC	LAKES OF THE NORTH A1-3	47228	ANTRIM	MANCELONA	3	29	N	5	W
10/24/2019	RIVIERA OPERATING LLC	RIVERSIDE ENERGY MI LLC	LAKES OF THE NORTH A2-11	47229	ANTRIM	MANCELONA	11	29	N	5	W
10/24/2019	RIVIERA OPERATING LLC	RIVERSIDE ENERGY MI LLC	LAKES OF THE NORTH C2-11	47230	ANTRIM	MANCELONA	11	29	N	5	W
10/24/2019	RIVIERA OPERATING LLC	RIVERSIDE ENERGY MI LLC	LAKES OF THE NORTH C4-14	47231	ANTRIM	MANCELONA	14	29	N	5	W
10/24/2019	RIVIERA OPERATING LLC	RIVERSIDE ENERGY MI LLC	STATE MANCELONA I C4-16	47267	ANTRIM	MANCELONA	16	29	N	5	W
10/25/2019	RIVIERA OPERATING LLC	RIVERSIDE ENERGY MI LLC	BROAD C2-15	55929	ALPENA	OSSINEKE	15	29	N	5	E
10/25/2019	RIVIERA OPERATING LLC	RIVERSIDE ENERGY MI LLC	BROAD D4-15	55930	ALPENA	OSSINEKE	15	29	N	5	E
10/25/2019	RIVIERA OPERATING LLC	RIVERSIDE ENERGY MI LLC	BROAD D4-10	55939	ALPENA	OSSINEKE	10	29	N	5	E
10/25/2019	RIVIERA OPERATING LLC	RIVERSIDE ENERGY MI LLC	BROAD B4-10	56006	ALPENA	OSSINEKE	10	29	N	5	E
10/25/2019	RIVIERA OPERATING LLC	RIVERSIDE ENERGY MI LLC	KOLLIEN B4-8	56131	ALPENA	SANBORN	8	29	N	8	E
10/25/2019	RIVIERA OPERATING LLC	RIVERSIDE ENERGY MI LLC	ELLER A2-24	56168	ALPENA	OSSINEKE	24	29	N	7	E
10/25/2019	RIVIERA OPERATING LLC	RIVERSIDE ENERGY MI LLC	GEROW A1-12	56192	ALPENA	OSSINEKE	12	29	N	7	E
10/25/2019	RIVIERA OPERATING LLC	RIVERSIDE ENERGY MI LLC	HAKEN A4-12	56193	ALPENA	OSSINEKE	12	29	N	7	E
10/25/2019	RIVIERA OPERATING LLC	RIVERSIDE ENERGY MI LLC	MONETTE C1-33	56100	ALPENA	GREEN	33	31	N	6	E
10/25/2019	RIVIERA OPERATING LLC	RIVERSIDE ENERGY MI LLC	STONE A2-36	55945	ALPENA	WILSON	36	30	N	7	E
10/25/2019	RIVIERA OPERATING LLC	RIVERSIDE ENERGY MI LLC	LAURIN D1-12	55924	ALPENA	WILSON	12	30	N	6	E
10/25/2019	RIVIERA OPERATING LLC	RIVERSIDE ENERGY MI LLC	GEROW B2-2	55883	ALPENA	WILSON	2	30	N	6	E
10/25/2019	RIVIERA OPERATING LLC	RIVERSIDE ENERGY MI LLC	STATE MANCELONA I D3-16	47268	ANTRIM	MANCELONA	16	29	N	5	W
10/25/2019	RIVIERA OPERATING LLC	RIVERSIDE ENERGY MI LLC	STATE MANCELONA I C1-18	47270	ANTRIM	MANCELONA	18	29	N	5	W
10/25/2019	RIVIERA OPERATING LLC	RIVERSIDE ENERGY MI LLC	MANCELONA I C3-18	47271	ANTRIM	MANCELONA	18	29	N	5	W
10/25/2019	RIVIERA OPERATING LLC	RIVERSIDE ENERGY MI LLC	MANCELONA I D2-18	47272	ANTRIM	MANCELONA	18	29	N	5	W
10/25/2019	RIVIERA OPERATING LLC	RIVERSIDE ENERGY MI LLC	STATE MANCELONA I C3-6	47288	ANTRIM	MANCELONA	6	29	N	5	W
10/25/2019	RIVIERA OPERATING LLC	RIVERSIDE ENERGY MI LLC	STATE MANCELONA I D1-6	47299	ANTRIM	MANCELONA	6	29	N	5	W
10/25/2019	RIVIERA OPERATING LLC	RIVERSIDE ENERGY MI LLC	STATE MANCELONA I B4-6	47300	ANTRIM	MANCELONA	6	29	N	5	W
10/25/2019	RIVIERA OPERATING LLC	RIVERSIDE ENERGY MI LLC	STATE MANCELONA I B2-6	47301	ANTRIM	MANCELONA	6	29	N	5	W
10/25/2019	RIVIERA OPERATING LLC	RIVERSIDE ENERGY MI LLC	STATE MANCELONA I A3-6	47302	ANTRIM	MANCELONA	6	29	N	5	W
10/25/2019	RIVIERA OPERATING LLC	RIVERSIDE ENERGY MI LLC	MANCELONA I B2-18	47336	ANTRIM	MANCELONA	18	29	N	5	W
10/25/2019	RIVIERA OPERATING LLC	RIVERSIDE ENERGY MI LLC	LAKES OF THE NORTH A4-3	47363	ANTRIM	MANCELONA	3	29	N	5	W
10/25/2019	RIVIERA OPERATING LLC	RIVERSIDE ENERGY MI LLC	LAKES OF THE NORTH A1-10	47365	ANTRIM	MANCELONA	10	29	N	5	W
10/25/2019	RIVIERA OPERATING LLC	RIVERSIDE ENERGY MI LLC	LAKES OF THE NORTH A3-2	47366	ANTRIM	MANCELONA	2	29	N	5	W
10/25/2019	RIVIERA OPERATING LLC	RIVERSIDE ENERGY MI LLC	LAKES OF THE NORTH D3-9	47369	ANTRIM	MANCELONA	9	29	N	5	W
10/25/2019	RIVIERA OPERATING LLC	RIVERSIDE ENERGY MI LLC	STATE MANCELONA I B1-6	47390	ANTRIM	MANCELONA	6	29	N	5	W
10/25/2019	RIVIERA OPERATING LLC	RIVERSIDE ENERGY MI LLC	STATE MANCELONA I A3-15	48145	ANTRIM	MANCELONA	15	29	N	5	W
10/25/2019	RIVIERA OPERATING LLC	RIVERSIDE ENERGY MI LLC	STATE MANCELONA (BIJOU) C3-1	48516	ANTRIM	MANCELONA	1	29	N	6	W
10/25/2019	RIVIERA OPERATING LLC	RIVERSIDE ENERGY MI LLC	STATE MANCELONA (BIJOU) D1-1	48517	ANTRIM	MANCELONA	1	29	N	6	W
10/25/2019	RIVIERA OPERATING LLC	RIVERSIDE ENERGY MI LLC	STATE MANCELONA (BIJOU) B1-12	48518	ANTRIM	MANCELONA	12	29	N	6	W
10/25/2019	RIVIERA OPERATING LLC	RIVERSIDE ENERGY MI LLC	STATE MANCELONA (BIJOU) B3-11	48535	ANTRIM	MANCELONA	11	29	N	6	W
10/25/2019	RIVIERA OPERATING LLC	RIVERSIDE ENERGY MI LLC	STATE MANCELONA (BIJOU) A3-12	48536	ANTRIM	MANCELONA	12	29	N	6	W
10/25/2019	RIVIERA OPERATING LLC	RIVERSIDE ENERGY MI LLC	STATE MANCELONA (BIJOU) A3-13	48537	ANTRIM	MANCELONA	13	29	N	6	W
10/25/2019	RIVIERA OPERATING LLC	RIVERSIDE ENERGY MI LLC	BIJOU C4-11	48569	ANTRIM	MANCELONA	11	29	N	6	W
10/25/2019	RIVIERA OPERATING LLC	RIVERSIDE ENERGY MI LLC	STATE MANCELONA (BIJOU) A3-1	48571	ANTRIM	MANCELONA	1	29	N	6	W
10/25/2019	RIVIERA OPERATING LLC	RIVERSIDE ENERGY MI LLC	BIJOU B2-1	48572	ANTRIM	MANCELONA	1	29	N	6	W
10/25/2019	RIVIERA OPERATING LLC	RIVERSIDE ENERGY MI LLC	BIJOU B1-14	48574	ANTRIM	MANCELONA	14	29	N	6	W
10/25/2019	RIVIERA OPERATING LLC	RIVERSIDE ENERGY MI LLC	BIJOU C1-15	48576	ANTRIM	MANCELONA	15	29	N	6	W



Transfer Date	Previous Operator	New Operator	WellName	Permit	County	TwpNm	Sec	Twp	TwpDir	Rng	RngDir
10/25/2019	RIVIERA OPERATING LLC	RIVERSIDE ENERGY MI LLC	BIJOU C3-15	48577	ANTRIM	MANCELONA	15	29	N	6	W
10/25/2019	RIVIERA OPERATING LLC	RIVERSIDE ENERGY MI LLC	BIJOU B4-15	48578	ANTRIM	MANCELONA	15	29	N	6	W
10/25/2019	RIVIERA OPERATING LLC	RIVERSIDE ENERGY MI LLC	STATE MANCELONA (BIJOU) B2-12	48581	ANTRIM	MANCELONA	12	29	N	6	W
10/25/2019	RIVIERA OPERATING LLC	RIVERSIDE ENERGY MI LLC	STATE MANCELONA (BIJOU) A2-11	48638	ANTRIM	MANCELONA	11	29	N	6	W
10/25/2019	RIVIERA OPERATING LLC	RIVERSIDE ENERGY MI LLC	STATE MANCELONA (BIJOU) D1-13	48654	ANTRIM	MANCELONA	13	29	N	6	W
10/25/2019	RIVIERA OPERATING LLC	RIVERSIDE ENERGY MI LLC	STATE MANCELONA (BIJOU) D2-11	48701	ANTRIM	MANCELONA	11	29	N	6	W
10/25/2019	RIVIERA OPERATING LLC	RIVERSIDE ENERGY MI LLC	STATE MANCELONA (BIJOU) B1-15	48810	ANTRIM	MANCELONA	15	29	N	6	W
10/25/2019	RIVIERA OPERATING LLC	RIVERSIDE ENERGY MI LLC	LAKES OF THE NORTH D3-11	49038	ANTRIM	MANCELONA	11	29	N	5	W
10/25/2019	RIVIERA OPERATING LLC	RIVERSIDE ENERGY MI LLC	LAKES OF THE NORTH D2-13	49039	ANTRIM	MANCELONA	13	29	N	5	W
10/25/2019	RIVIERA OPERATING LLC	RIVERSIDE ENERGY MI LLC	LAKES OF THE NORTH B4-10	49040	ANTRIM	MANCELONA	10	29	N	5	W
10/25/2019	RIVIERA OPERATING LLC	RIVERSIDE ENERGY MI LLC	BIJOU A3-14	49091	ANTRIM	MANCELONA	14	29	N	6	W
10/25/2019	RIVIERA OPERATING LLC	RIVERSIDE ENERGY MI LLC	STATE MANCELONA (BIJOU) B1-13	49095	ANTRIM	MANCELONA	13	29	N	6	W
10/25/2019	RIVIERA OPERATING LLC	RIVERSIDE ENERGY MI LLC	LAKES OF THE NORTH A4-11	49133	ANTRIM	MANCELONA	11	29	N	5	W
10/25/2019	RIVIERA OPERATING LLC	RIVERSIDE ENERGY MI LLC	LAKES OF THE NORTH C4-9	49398	ANTRIM	MANCELONA	9	29	N	5	W
10/25/2019	RIVIERA OPERATING LLC	RIVERSIDE ENERGY MI LLC	LAKES OF THE NORTH D4-9	49399	ANTRIM	MANCELONA	9	29	N	5	W
10/25/2019	RIVIERA OPERATING LLC	RIVERSIDE ENERGY MI LLC	MANCELONA I B3-4	49452	ANTRIM	MANCELONA	4	29	N	5	W
10/25/2019	RIVIERA OPERATING LLC	RIVERSIDE ENERGY MI LLC	MANCELONA I D3-4	49453	ANTRIM	MANCELONA	4	29	N	5	W
10/25/2019	RIVIERA OPERATING LLC	RIVERSIDE ENERGY MI LLC	MANCELONA I A1-5	49454	ANTRIM	MANCELONA	5	29	N	5	W
10/25/2019	RIVIERA OPERATING LLC	RIVERSIDE ENERGY MI LLC	MANCELONA I C1-8	49455	ANTRIM	MANCELONA	8	29	N	5	W
10/25/2019	RIVIERA OPERATING LLC	RIVERSIDE ENERGY MI LLC	MANCELONA I B1-15	49456	ANTRIM	MANCELONA	15	29	N	5	W
10/25/2019	RIVIERA OPERATING LLC	RIVERSIDE ENERGY MI LLC	LAKES OF THE NORTH D3-14	49654	ANTRIM	MANCELONA	14	29	N	5	W
10/25/2019	RIVIERA OPERATING LLC	RIVERSIDE ENERGY MI LLC	STATE MANCELONA B2-16	49713	ANTRIM	MANCELONA	16	29	N	5	W
10/25/2019	RIVIERA OPERATING LLC	RIVERSIDE ENERGY MI LLC	STATE MANCELONA D2-6	49714	ANTRIM	MANCELONA	6	29	N	5	W
10/25/2019	RIVIERA OPERATING LLC	RIVERSIDE ENERGY MI LLC	STATE MANCELONA B2-7	49715	ANTRIM	MANCELONA	7	29	N	5	W
10/25/2019	RIVIERA OPERATING LLC	RIVERSIDE ENERGY MI LLC	BIJOU C4-14	50231	ANTRIM	MANCELONA	14	29	N	6	W
10/25/2019	RIVIERA OPERATING LLC	RIVERSIDE ENERGY MI LLC	BIJOU A1-1	50655	ANTRIM	MANCELONA	1	29	N	6	W
10/25/2019	RIVIERA OPERATING LLC	RIVERSIDE ENERGY MI LLC	BIJOU D1-12	52590	ANTRIM	MANCELONA	12	29	N	6	W
10/25/2019	RIVIERA OPERATING LLC	RIVERSIDE ENERGY MI LLC	STATE MANCELONA B4-12	57024	ANTRIM	MANCELONA	12	29	N	6	W
10/25/2019	RIVIERA OPERATING LLC	RIVERSIDE ENERGY MI LLC	STATE MANCELONA C1-1	57025	ANTRIM	MANCELONA	1	29	N	6	W
10/25/2019	RIVIERA OPERATING LLC	RIVERSIDE ENERGY MI LLC	BIJOU EAST B4-13	57026	ANTRIM	MANCELONA	13	29	N	6	W
10/25/2019	RIVIERA OPERATING LLC	RIVERSIDE ENERGY MI LLC	BIJOU EAST D3-13	57027	ANTRIM	MANCELONA	13	29	N	6	W
10/25/2019	RIVIERA OPERATING LLC	RIVERSIDE ENERGY MI LLC	BIJOU EAST D3-12	57028	ANTRIM	MANCELONA	12	29	N	6	W
10/25/2019	RIVIERA OPERATING LLC	RIVERSIDE ENERGY MI LLC	TOONS 5 A3-5	57039	ANTRIM	MANCELONA	5	29	N	5	W
10/25/2019	RIVIERA OPERATING LLC	RIVERSIDE ENERGY MI LLC	TOONS 5 C2-5	57040	ANTRIM	MANCELONA	5	29	N	5	W
10/25/2019	RIVIERA OPERATING LLC	RIVERSIDE ENERGY MI LLC	STATE MANCELONA D4-7	57084	ANTRIM	MANCELONA	7	29	N	5	W
10/25/2019	RIVIERA OPERATING LLC	RIVERSIDE ENERGY MI LLC	TOONS MANCELONA WEST B4-18	57085	ANTRIM	MANCELONA	18	29	N	5	W
10/25/2019	RIVIERA OPERATING LLC	RIVERSIDE ENERGY MI LLC	BIJOU WEST A1-14	57091	ANTRIM	MANCELONA	14	29	N	6	W
10/25/2019	RIVIERA OPERATING LLC	RIVERSIDE ENERGY MI LLC	BIJOU WEST D2-14	57092	ANTRIM	MANCELONA	14	29	N	6	W
10/25/2019	RIVIERA OPERATING LLC	RIVERSIDE ENERGY MI LLC	STATE BRILEY D1-29	47022	MONTMORENCY	BRILEY	29	30	N	2	E
10/25/2019	RIVIERA OPERATING LLC	RIVERSIDE ENERGY MI LLC	STATE BRILEY B1-29	47798	MONTMORENCY	BRILEY	29	30	N	2	E
10/25/2019	RIVIERA OPERATING LLC	RIVERSIDE ENERGY MI LLC	SAMP, ROBERT L C3-3	48187	MONTMORENCY	RUST	3	29	N	4	E
10/25/2019	RIVIERA OPERATING LLC	RIVERSIDE ENERGY MI LLC	SAMP, ROBERT L B2-3	48188	MONTMORENCY	RUST	3	29	N	4	E
10/25/2019	RIVIERA OPERATING LLC	RIVERSIDE ENERGY MI LLC	PHARO & BIXEL D3-35	56684	MONTMORENCY	LOUD	35	29	N	3	E
10/25/2019	RIVIERA OPERATING LLC	RIVERSIDE ENERGY MI LLC	PHARO & BIXEL D3-35SUMP	56684	MONTMORENCY	LOUD	35	29	N	3	E
10/25/2019	RIVIERA OPERATING LLC	RIVERSIDE ENERGY MI LLC	PHARO & BIXEL D3-35HD1	56684	MONTMORENCY	LOUD	35	29	N	3	E
10/25/2019	RIVIERA OPERATING LLC	RIVERSIDE ENERGY MI LLC	STATE BRILEY TWIN D1-22	57859	MONTMORENCY	BRILEY	22	30	N	2	E
10/25/2019	RIVIERA OPERATING LLC	RIVERSIDE ENERGY MI LLC	STATE BRILEY TWIN D1-22SUMP	57859	MONTMORENCY	BRILEY	22	30	N	2	E
10/25/2019	RIVIERA OPERATING LLC	RIVERSIDE ENERGY MI LLC	STATE BRILEY TWIN D1-22HD1	57859	MONTMORENCY	BRILEY	22	30	N	2	E
10/25/2019	RIVIERA OPERATING LLC	RIVERSIDE ENERGY MI LLC	STATE BRILEY TWIN B1-26	57865	MONTMORENCY	BRILEY	26	30	N	2	E
10/25/2019	RIVIERA OPERATING LLC	RIVERSIDE ENERGY MI LLC	STATE BRILEY TWIN B1-26HD1	57865	MONTMORENCY	BRILEY	26	30	N	2	E
10/25/2019	RIVIERA OPERATING LLC	RIVERSIDE ENERGY MI LLC	STATE BRILEY TWIN B1-26HD2	57865	MONTMORENCY	BRILEY	26	30	N	2	E
10/25/2019	RIVIERA OPERATING LLC	RIVERSIDE ENERGY MI LLC	STATE BRILEY TWIN D3-27	57867	MONTMORENCY	BRILEY	27	30	N	2	E

Transfer Date	Previous Operator	New Operator	WellName	Permit	County	TwpNm	Sec	Twp	TwpDir	Rng	RngDir
10/25/2019	RIVIERA OPERATING LLC	RIVERSIDE ENERGY MI LLC	STATE BRILEY TWIN D3-27SUMP	57867	MONTMORENCY	BRILEY	27	30	N	2	E
10/25/2019	RIVIERA OPERATING LLC	RIVERSIDE ENERGY MI LLC	STATE BRILEY TWIN D3-27HD1	57867	MONTMORENCY	BRILEY	27	30	N	2	E
10/25/2019	RIVIERA OPERATING LLC	RIVERSIDE ENERGY MI LLC	STATE BRILEY TWIN D3-27HD2	57867	MONTMORENCY	BRILEY	27	30	N	2	E
10/25/2019	RIVIERA OPERATING LLC	RIVERSIDE ENERGY MI LLC	MAYNERICH ET AL TWIN B4-4	57924	MONTMORENCY	LOUD	4	29	N	3	E
10/25/2019	RIVIERA OPERATING LLC	RIVERSIDE ENERGY MI LLC	MAYNERICH ET AL TWIN B4-4HD1	57924	MONTMORENCY	LOUD	4	29	N	3	E
10/25/2019	RIVIERA OPERATING LLC	RIVERSIDE ENERGY MI LLC	MAYNERICH ET AL TWIN B4-4HD2	57924	MONTMORENCY	LOUD	4	29	N	3	E