

Michigan Department of  
Environment, Great Lakes, and Energy  
Oil, Gas and Minerals Division

PERMIT LIST

11/23/2020 THRU 11/27/2020



Permit Number	Issue Date	Permittee Number	Permittee Name
61510	11/25/2020	6310	CORE ENERGY LLC
API Well No: 21-137-62007-00-00			1011 NOTEWARE DRIVE TRAVERSE CITY, MI 49686
Prev Permit:			Surface Owner: BELDEN & BLAKE CORPORATION
Well Name: STATE CHARLTON 4-27			True Vertical Depth: 5457FT
Well Type: Oil Well			Target Formation: NIAGARAN BROWN
Permit Type: Drill			Deepest Formation: NIAGARAN GRAY
H2S Present? No			

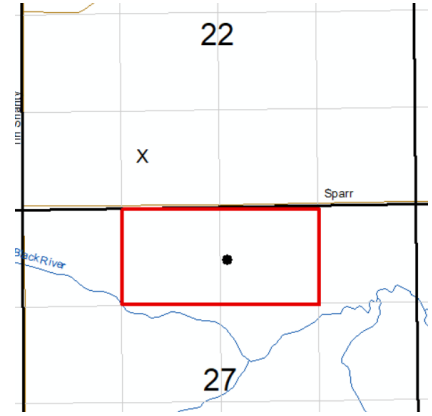

80-Acre Drilling Unit, NE/4 NW  
NW/4 NE/4 Section 27

Location:	QT QT QT	Sec	Township	Range	Township Name	County	Feet From Section Line	Feet From DRLG Unit Line
SL:	SWSESW	22	31N	1W	CHARLTON	OTSEGO	585 S 1594 W	
BHL:	NWNWNE	27	31N	1W	CHARLTON	OTSEGO	591 N 2492 E	686 S 1178 E



Michigan Department of  
 Environment, Great Lakes, and Energy  
 Oil, Gas and Minerals Division  
 Updated Permits  
 11/23/2020 THRU 11/27/2020



Permit Number      Permittee Number      Permittee Name

61407      4267      MICHIGAN GEOSEARCH INC  
 P.O BOX 8907  
 RENO, NV 89507

API Well Number: 21-147-62000-00-00

Well Name: BISHOP 1-24

Plug Inst. Issue Date: 11/18/2020

Location	QT QT QT	Sec	Township	Range	Township Name	County	Feet From Section Line	Feet From DRLG Unit
SL:	SWNENE	24	6N	14E	RILEY	SAINT CLAIR	1066 N 1007 E	1066 N 1007 E
BHL:	SWNENE	24	6N	14E	RILEY	SAINT CLAIR	1066 N 1007 E	1066 N 1007 E

Comment: App to P&A expires on 11/18/21



Michigan Department of  
 Environment, Great Lakes, and Energy  
 Oil, Gas and Minerals Division  
 Updated Permits  
 11/23/2020 THRU 11/27/2020



Permit Number      Permittee Number      Permittee Name

**RECORD OF WELL PLUGGING:**

53461      6371      BREITBURN OPERATING LIMITED  
 PARTNERSHIP  
 1111 BAGBY STREET, SUITE 1600  
 HOUSTON, TX 77002

API Well Number: 21-137-53461-00-00

Well Name: FONTINALIS CLUB C4-2

Plugging Date: 11/12/2020

Location	QT QT QT	Sec	Township	Range	Township Name	County	Feet From Section Line	Feet From DRLG Unit
SL:	SWNESE	2	31N	3W	LIVINGSTON	OTSEGO	1650 S 700 E	330 S 620 W
BHL:	SWNESE	2	31N	3W	LIVINGSTON	OTSEGO	1650 S 700 E	330 S 620 W



Michigan Department of  
Environment, Great Lakes, and Energy  
Oil, Gas and Minerals Division  
Updated Permits  
11/23/2020 THRU 11/27/2020



Permit Number      Permittee Number      Permittee Name

**RECORD OF CHANGE OF WELL STATUS:**

59996      104      WEST BAY EXPLORATION COMPANY  
13685 S WEST BAYSHORE DR  
TRAVERSE CITY, MI 49684

API Well Number: 21-075-59996-01-00

Well Name: WEST BAY 1-22 HD1      True Vertical Depth: 4237

Change Date: 9/1/2020

Location	QT QT QT	Sec	Township	Range	Township Name	County	Feet From Section Line	Feet From DRLG Unit
SL:	NWSESW	22	4S	2E	JACKSON	NORVELL	750 S 1400 W	
BHL:	NWNESW	22	4S	2E	JACKSON	NORVELL	2299 S 1737 W	335 N 879 E

Proposed Rework:      Reworked to Continue Drilling - HDH      Comment: Reworked to plugback to 3863' MD and drill HD1.

60077      104      WEST BAY EXPLORATION COMPANY  
13685 S WEST BAYSHORE DR  
TRAVERSE CITY, MI 49684

API Well Number: 21-075-60077-01-00

Well Name: HAYSTEAD 2-9 HD1      True Vertical Depth: 4172

Change Date: 8/7/2020

Location	QT QT QT	Sec	Township	Range	Township Name	County	Feet From Section Line	Feet From DRLG Unit
SL:	NESESW	9	4S	2E	NORVELL	JACKSON	1650 N 2293 W	
BHL:	NENENE	8	4S	2E	NORVELL	JACKSON	330 N 640 E	330 N 679 W

Proposed Rework:      Reworked to Continue Drilling - HDH      Comment: Reworked to plugback, mill new window, drill HDH, stimulate, and test new zone within the upper Trenton.

