

Michigan Department of  
Environment, Great Lakes, and Energy  
Oil, Gas and Minerals Division

PERMIT APPLICATIONS

1/27/2020 THRU 1/31/2020



Application Number      Date Received      Permittee Number      Permittee Name      Page 1

439      01/29/2020      LAMBDA ENERGY  
RESOURCES LLC  
12012 WICKCHESTER  
SUITE 300  
HOUSTON, TX 77055

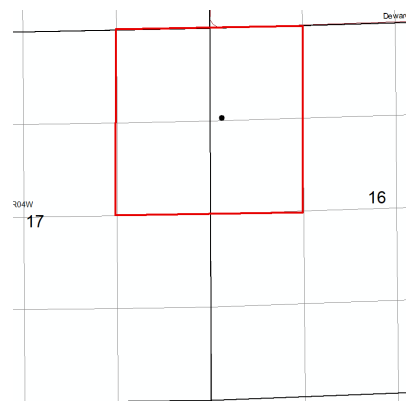

Prev Permit:

Well Name: State Frederic 3-16

Surface Owner: State of Michigan

Well Type: OIL

True Vertical Depth: 7440

Permit Type: Drill

Target Formation: NIAGARAN

H2S Present? Yes

Deepest Formation: NIAGARAN

160-Acre R303 Drilling Unit, E/2 NE/4  
Section 17, W/2 NW/4 Section 16

Location:	QT QT QT	Sec	Township	Range	Township Name	County	Feet From Section Line	Feet From DRLG Unit Line
SL:	SWNWNW	16	28N	4W	FREDERIC	CRAWFORD	1286 N 158 W	1286 N 1168 E
BHL:	SWNWNW	16	28N	4W	FREDERIC	CRAWFORD	1286 N 158 W	1286 N 1168 E

435      01/30/2020      6498

WOLVERINE GAS AND OIL  
COMPANY OF MICHIGAN LLC  
ONE RIVERFRONT PLAZA  
55 CAMPAU, NW  
GRAND RAPIDS, MI 49503

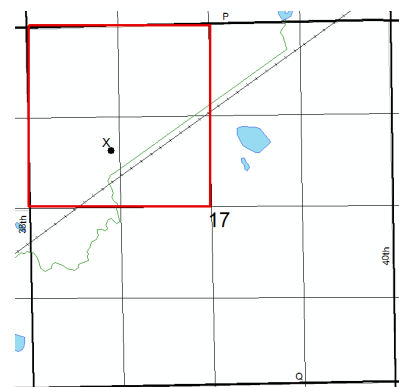

Prev Permit:

Well Name: Orosz 17-1

Surface Owner: Mari Lynn Orosz

Well Type: OIL

True Vertical Depth: 3910

Permit Type: Drill

Target Formation: TRENTON

H2S Present? Yes

Deepest Formation: GLENWOOD

160-Acre Drilling Unit with  
statutory pooling, NW/4 Section 17  
(Cause No. 01-2020)

Location:	QT QT QT	Sec	Township	Range	Township Name	County	Feet From Section Line	Feet From DRLG Unit Line
SL:	NESWNW	17	3S	9W	CLIMAX	KALAMAZOO	1686 N 1166 W	1686 N 1166 W
BHL:	NESWNW	17	3S	9W	CLIMAX	KALAMAZOO	1813 N 1253 W	836 S 1253 W

Michigan Department of  
Environment, Great Lakes, and Energy  
Oil, Gas and Minerals Division

PERMIT LIST

1/27/2020 THRU 1/31//2020



Permit Number      Issue Date      Permittee Number      Permittee Name      Page 1

61471      1/30/2020      6498      WOLVERINE GAS AND OIL  
COMPANY OF MICHIGAN LLC  
ONE RIVERFRONT PLAZA  
55 CAMPAU, NW  
GRAND RAPIDS, MI 49503

API Well No: 21-077-62025-00-00

Prev Permit:

Well Name: McMichael 8-2

Surface Owner: Mike M. McMichael  
Rev. Trust

Well Type: Oil Well

True Vertical Depth: 3975FT

Permit Type: Drill

Target Formation: TRENTON

H2S Present? Yes

Deepest Formation: GLENWOOD

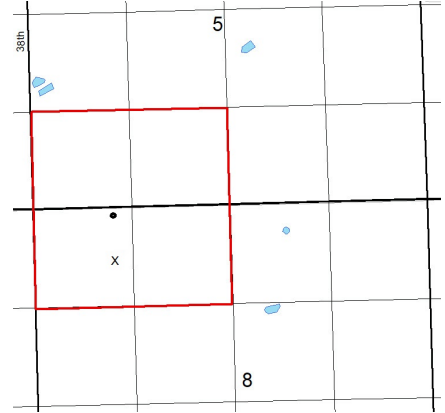

160-Acre R303 Drilling Unit, S/2  
SW/4 Section 5, N/2 NW/4 Section 8

Location:	QT QT QT	Sec	Township	Range	Township Name	County	Feet From Section Line	Feet From DRLG Unit Line
SL:	NENWNW	8	3S	9W	CLIMAX	KALAMAZOO	657 N 1171 W	
BHL:	NENWNW	8	3S	9W	CLIMAX	KALAMAZOO	156 N 1191 W	1172 S 1191 W

Michigan Department of  
Environment, Great Lakes, and Energy  
Oil, Gas and Minerals Division

UPDATED PERMITS

1/27/2020 THRU 1/31/2020



Permit Number      Permittee Number      Permittee Name

**PLUGGING INSTRUCTIONS ISSUED:**

29728                      5095                      OMIMEX ENERGY INC  
  
7950 JOHN T. WHITE ROAD  
FT WORTH, TX 76120

API Well Number: 21-055-29728-00-00

Well Name: BRINK, LAWRENCE K, ET AL 1-3

Plug Inst. Issue Date: 1/24/2020

Location	QT QT QT	Sec	Township	Range	Township Name	County	Feet From Section Line	Feet From DRLG Unit
SL:	NWSWNW	3	25N	12W	GRANT	GRAND TRAVERSE	788 S 615 W	532 N 705 E
BHL:	NWSWNW	3	25N	12W	GRANT	GRAND TRAVERSE	788 S 615 W	532 N 705 E

Comment: App to P&A expires on 1/24/21

---