

<ul style="list-style-type: none"> Aperture Monitoring Well Aperture Surface Water Staff Gauge 1,4-Dioxane Isoconcentration Contour # 1,4-Dioxane Concentration (#/l) Data Not Used 	<ul style="list-style-type: none"> Observation Well Purge Well/Slump Monitoring Well Peat Monitoring Well Peat Monitoring Well
--	---

1,4-Dioxane Isoconcentration Map
 Marshy Area - Peat (April 2020 - September 2020)

Gelman Sciences, Scio Twp., Washtenaw County, Michigan

DRAWN BY	DATE
saml	10/13/2020
PROJECT NO.	SCALE
806500	1:960
FILE LOCATION	
H:\GIS\2020\10-13-2020\806500_Peat_Consolidated_2020\Peat_1014-Dioxane_Isoconcentration_Map_1013-2020.dwg	
SOURCES	
FWS, MGL, Gelman Sciences	

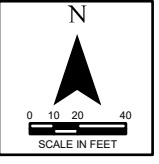



+	Plugged or Abandoned
+	Potentiometric Surface Contours
+	Unit C3 & SW Property
+	Other Items
+	Potentiometric Surface Elevation
+	Data Not Used
+	Compliance Monitoring Well
+	Soil Boring
+	Artesian Well
+	Extraction Well
+	Injection Well
+	Monitor Well
+	Production Well
+	Current/Former Drinking Water Well
+	SW & C3 Extraction Well Operating During Sampling

Potentiometric Surface Map
 Southwest Property (September 25, 2020)
 Gelman Sciences, Scio Twp., Washtenaw County, Michigan

DRAWN BY	DATE
saml	10/19/2020
PROJECT NO.	SCALE
806500	1:1,560
FILE LOCATION	
M:\Projects\806500-810000\806500_Pail Corp\CAD\2020\Final_10-19-2020_Pail and Project\2020\October\1020_SW_PSC.pdf	
SOURCES	
FIM, NGDL, Gelman Sciences, © OpenStreetMap (and) contributors, CC-BY-SA	

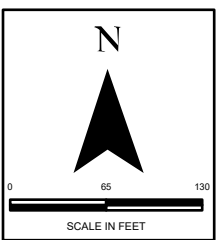

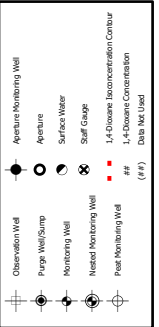
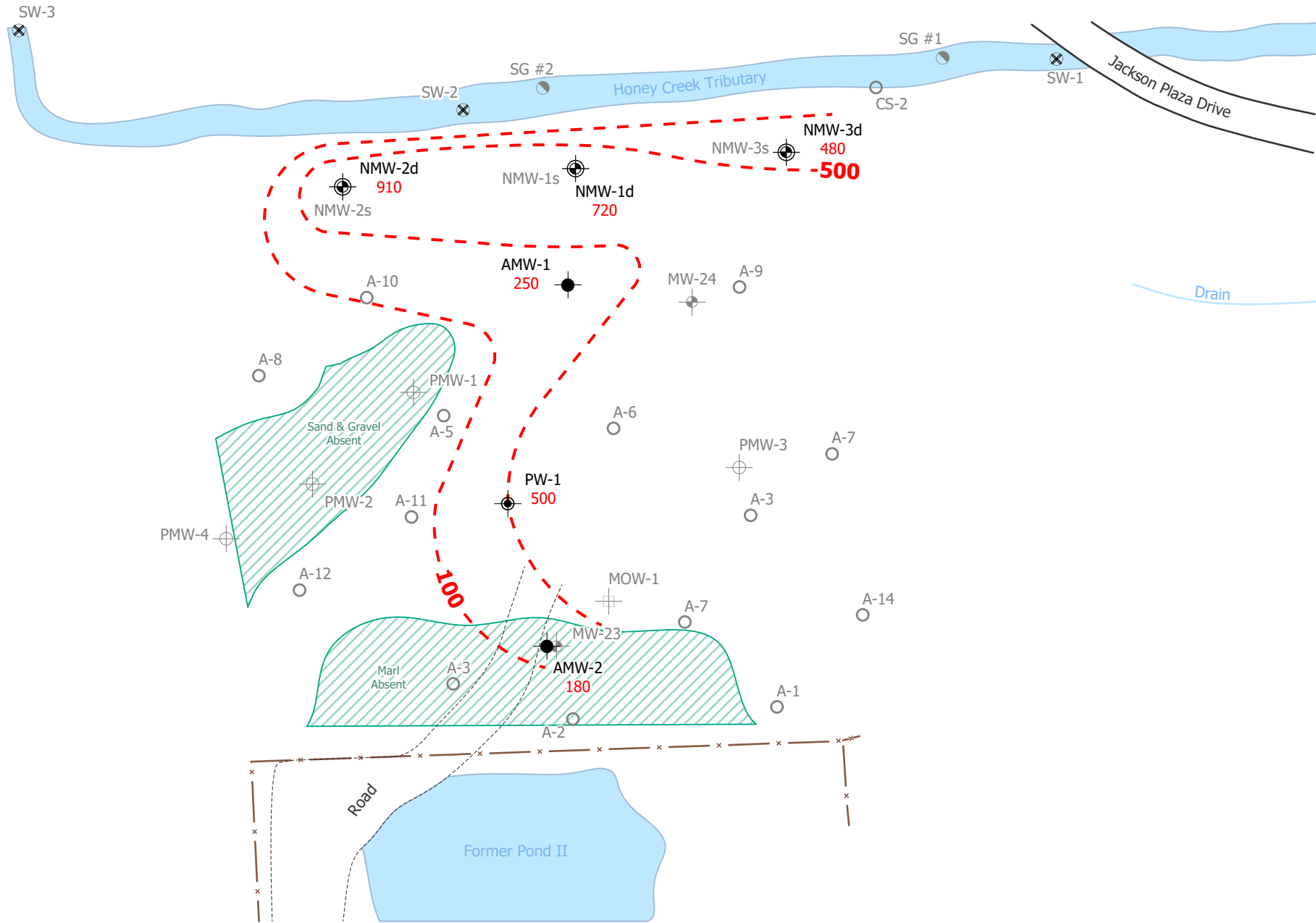

1,4-Dioxane Isoconcentration Map
 Marshy Area - Sand (April 2020 - September 2020)
 Gelman Sciences, Scio Twp., Washtenaw County, Michigan

DRAWN BY	DATE
saml	10/13/2020
PROJECT NO.	SCALE
806500	1:960
FILE LOCATION	
H:\GIS\2020\10-13-2020\806500_Prel_Conc\1,4-Dioxane_Isoconcentration_Map_Sand_ScIO_10132020.dwg	
SOURCES	
FWS, MGLL, Gelman Sciences	

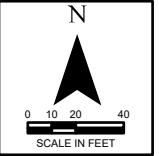

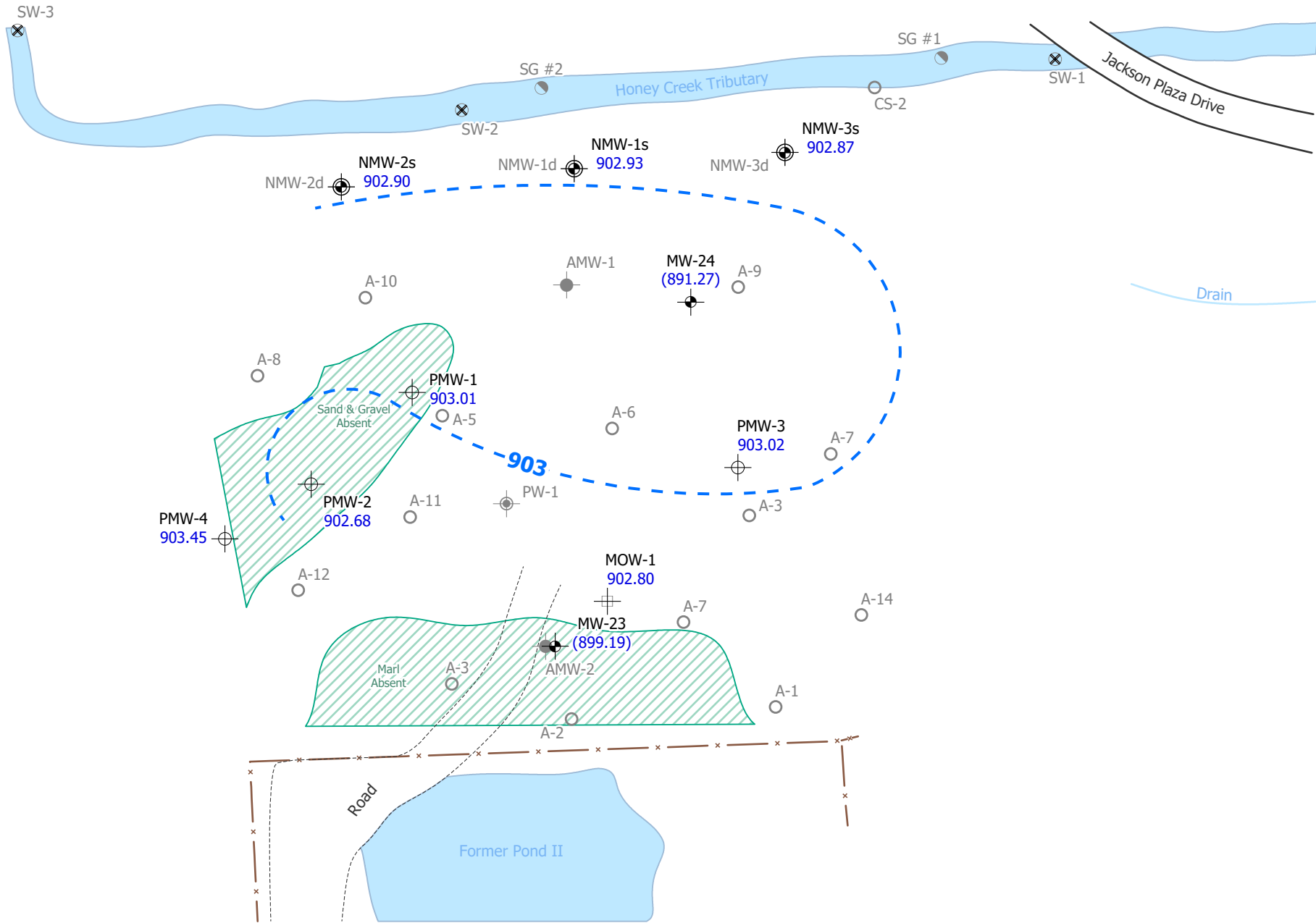

<ul style="list-style-type: none"> Observation Well Purge Well/Slump Monitoring Well Neared Monitoring Well Peat Monitoring Well 	<ul style="list-style-type: none"> Aperture Monitoring Well Aperture Surface Water Staff Gauge Potentiometric Surface Control #1 Data Not Used (#1)
---	---

Potentiometric Surface Map
Marshy Area - Peat (September 25, 2020)
Gelman Sciences, Scio Twp., Washtenaw County, Michigan

DRAWN BY saml	DATE 10/13/2020
PROJECT NO. 806500	SCALE 1:960
FILE LOCATION H:\GIS\806500\806500_Peat_Cover\CD 2020\Peat_1018\Peat_Surfaces 2020\October\2020_Peat_PSC.dwg	
SOURCES FWS, MGL, Gelman Sciences	

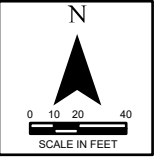



Well Type

- + Artesian Well
- + Extraction Well
- + Injection Well
- + Monitor Well
- + Production Well
- + Current/Former Drinking Water Well
- + SW & C3 Extraction Well Operating During Sampling
- + Soil Boring

1,4-Dioxane Isoconcentration Contours

- - - SW Property
- - - Other Farms
- - - Potentiometric Surface Elevation
- - - Data Not Used
- - - Compliance Monitoring Well

Legend

- + Flipped or Abandoned
- + 1,4-Dioxane Isoconcentration Contours
- + SW Property
- + Other Farms
- + Potentiometric Surface Elevation
- + Data Not Used
- + Compliance Monitoring Well
- + Soil Boring

1,4-Dioxane Isoconcentration Map

Southwest Property (April 2020 - September 2020)

Gelman Sciences, Scio Twp., Washtenaw County, Michigan

DRAWN BY sami	DATE 10/13/2020
PROJECT NO. 806500	SCALE 1:1,560
FILE LOCATION M:\Projects\806500-810000\806500_Pail_Corp\CAD\2020\FIG_16_08_Piles_and_Projects\2020\October\1020_SW_ISO.pdf	
SOURCES FIM, HGL, Gelman Sciences, © OpenStreetMap (and contributors), CC-BY-SA	

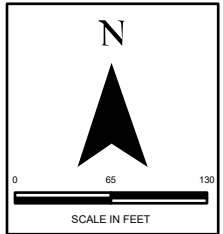

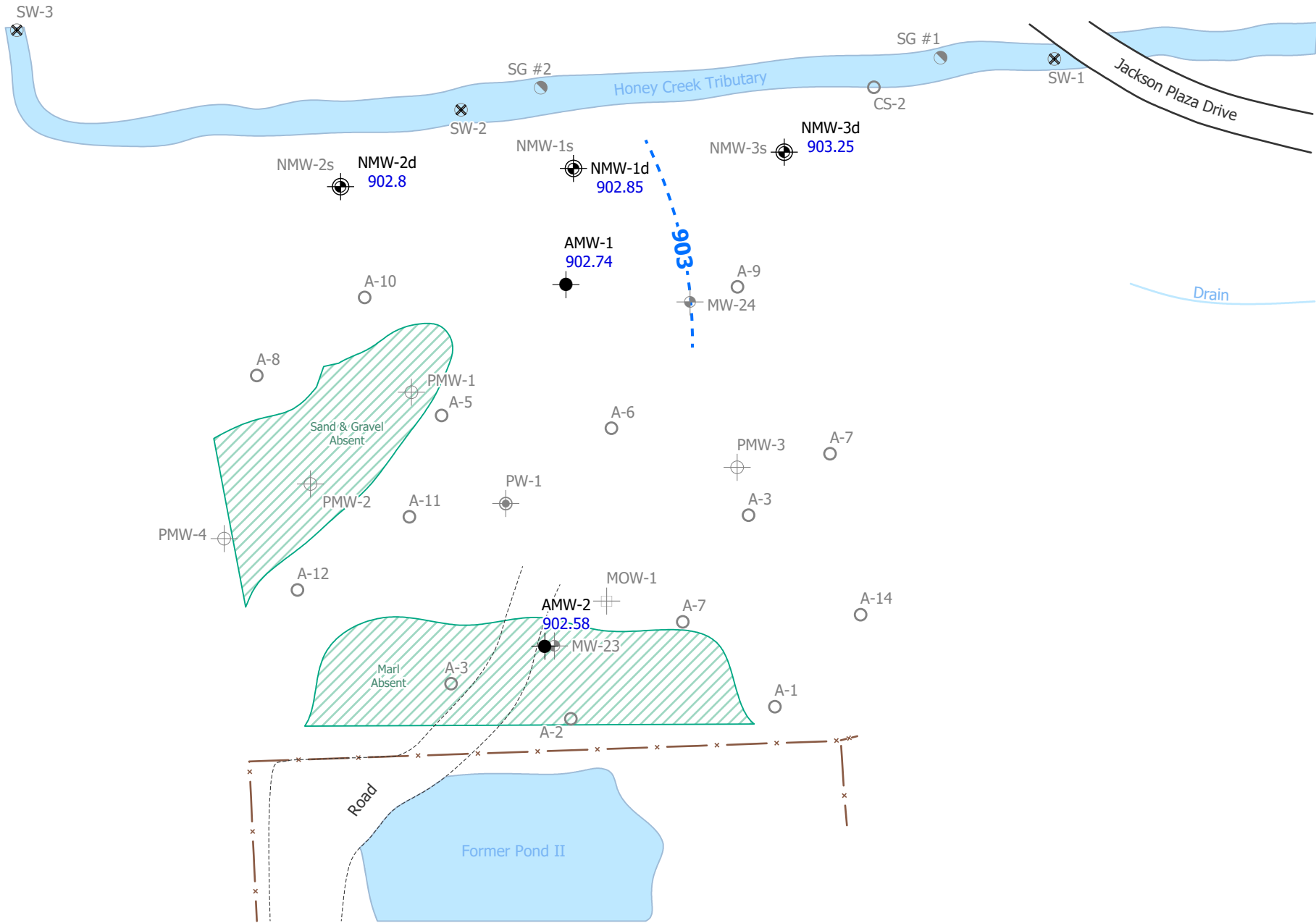

Legend

- Auger Monitoring Well
- Aperture
- Surface Water
- Staff Gauge
- Potentiometric Surface Control #1
- Potentiometric Surface Control #2
- Data Not Used
- Observation Well
- Pump Well/Sump
- Monitoring Well
- Nested Monitoring Well
- Feet Monitoring Well

Potentiometric Surface Map
 Marshy Area - Sand (September 25, 2020)

Gelman Sciences, Scio Twp., Washtenaw County, Michigan

DRAWN BY	DATE
saml	10/13/2020
PROJECT NO.	SCALE
806500	1:960
FILE LOCATION <small>H:\proj\806500\806500_Potential\806500_Potential_Sand_PSC.dwg 2020\9-25-2020\806500_Potential\806500_Potential_Sand_PSC.dwg</small>	
SOURCES <small>P.V. MGLL, Gelman Sciences</small>	

