

<ul style="list-style-type: none"> ● Aperture Monitoring Well ○ Aperture ○ Surface Water ○ Staff Gauge ○ 1,4-Dioxane Isoconcentration Contour ○ #1 ○ Data Not Used (N/A) 	<ul style="list-style-type: none"> ⊕ Observation Well ⊕ Pump Well/Slump ⊕ Monitoring Well ⊕ Nested Monitoring Well ⊕ Peat Monitoring Well
---	--

1,4-Dioxane Isoconcentration Map
 Marshy Area - Peat (April 2019 - September 2019)

Gelman Sciences, Scio Twp., Washtenaw County, Michigan

DRAWN BY	DATE
saml	10/11/2019
PROJECT NO.	SCALE
806500	1:960
FILE LOCATION <small>H:\GIS\806500\806500_Peat copy1.dwg 2019\Peat - 1,4-Dioxane Isoconcentration 2019\October 2019_Peat_SG.dwg</small>	
SOURCES <small>PVI, MGL, Gelman Sciences</small>	

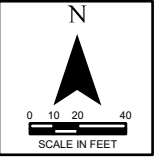

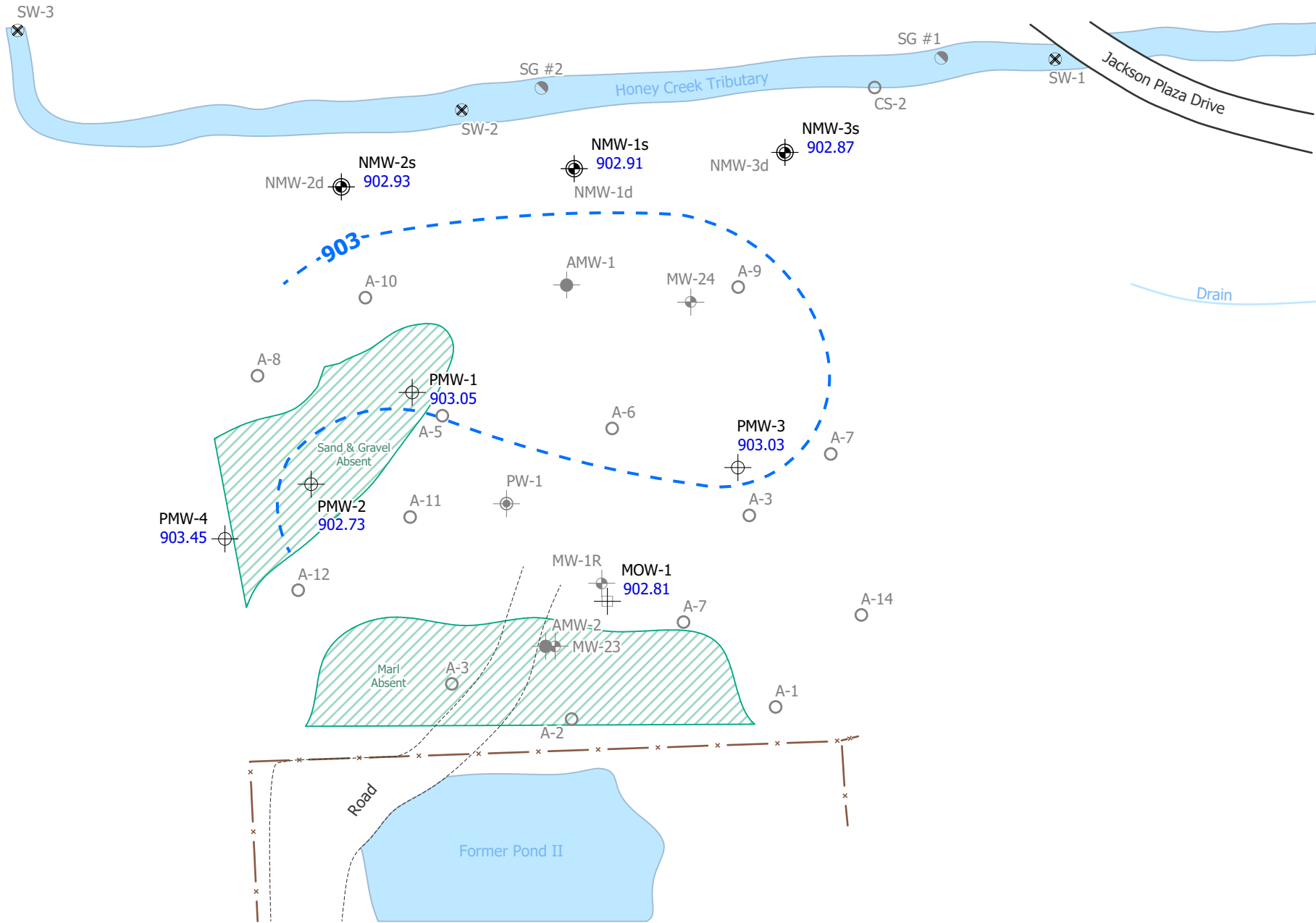

Legend:

- Aqueous Monitoring Well
- Aperture
- Surface Water
- Staff Gauge
- Potentiometric Surface Contour
- # Potentiometric Elevation (ft)
- Data Not Used
- Observation Well
- Pump Well/Sump
- Monitoring Well
- Neared Monitoring Well
- Piezometer Well

Potentiometric Surface Map
Marshy Area - Peat (September 25, 2019)

Gelman Sciences, Scio Twp., Washtenaw County, Michigan

DRAWN BY	DATE
saml	10/15/2019
PROJECT NO.	SCALE
806500	1:960
FILE LOCATION H:\GIS\2019\09\25\20190925_Peat_Courtesy\20190925_1048_Peat_Surface_Map\20190925_1048_Peat_PSC.dwg	
SOURCES FWS, MGLL, Gelman Sciences	

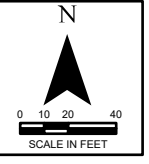

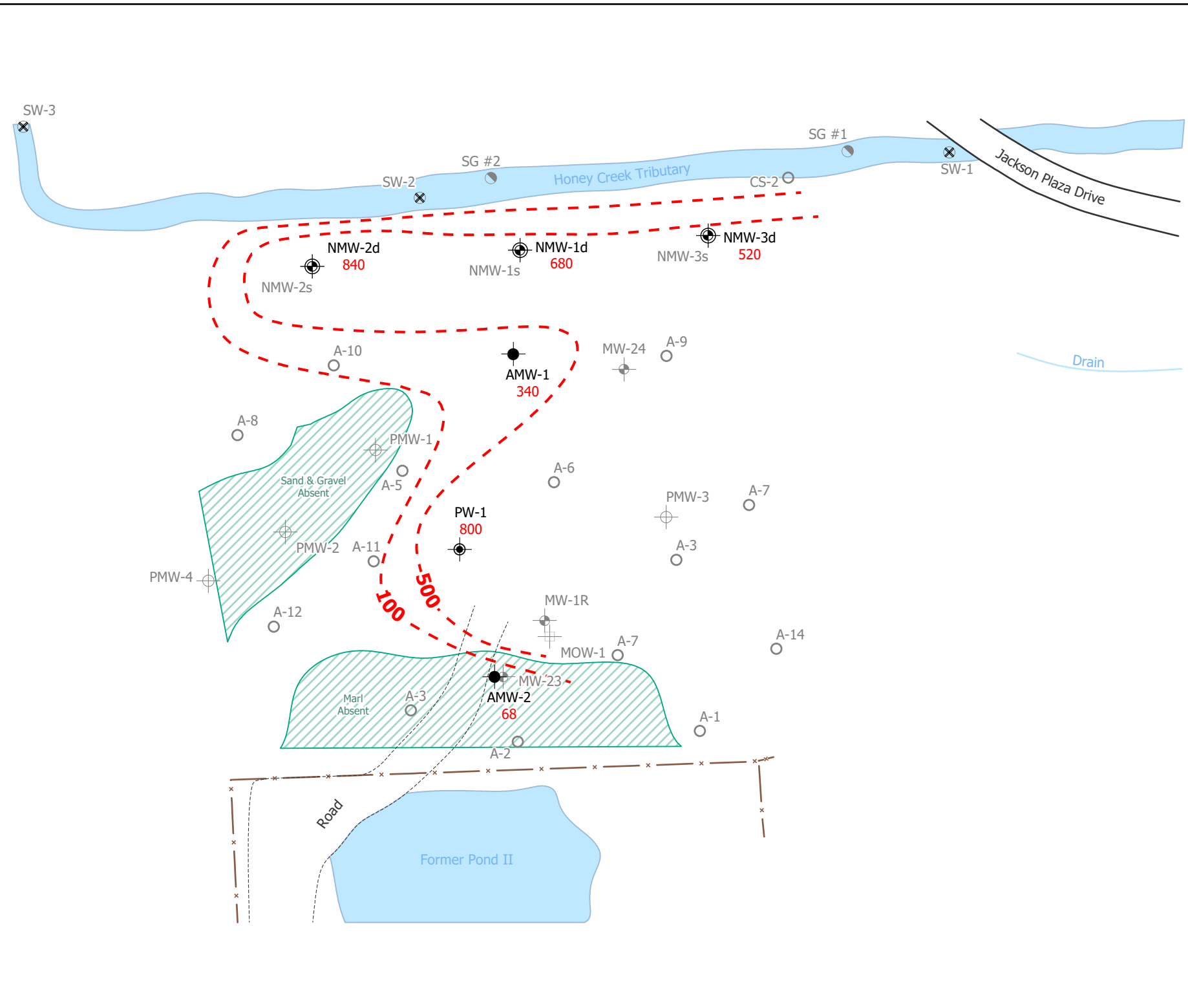

● Aperture Monitoring Well
○ Aperture
○ Surface Water
○ Staff Gauge
○ 1,4-Dioxane Isoconcentration Contour
○ #1
○ Data Not Used (N/A)
○ Observation Well
○ Pump Well/Sump
○ Monitoring Well
○ Nested Monitoring Well
○ Feet Monitoring Well

1,4-Dioxane Isoconcentration Map

Marshy Area - Sand (April 2019 - September 2019)

Gelman Sciences, Scio Twp., Washtenaw County, Michigan

DRAWN BY	DATE
saml	10/11/2019
PROJECT NO.	SCALE
806500	1:960
FILE LOCATION K:\p\806500\806500\000000 Plot Copy\CAD 2020\Figs - 1088 Revised Plotting 2019\October\1021_SAND_ISO.pdf	
SOURCES P.W. MGLL, Gelman Sciences	

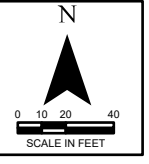

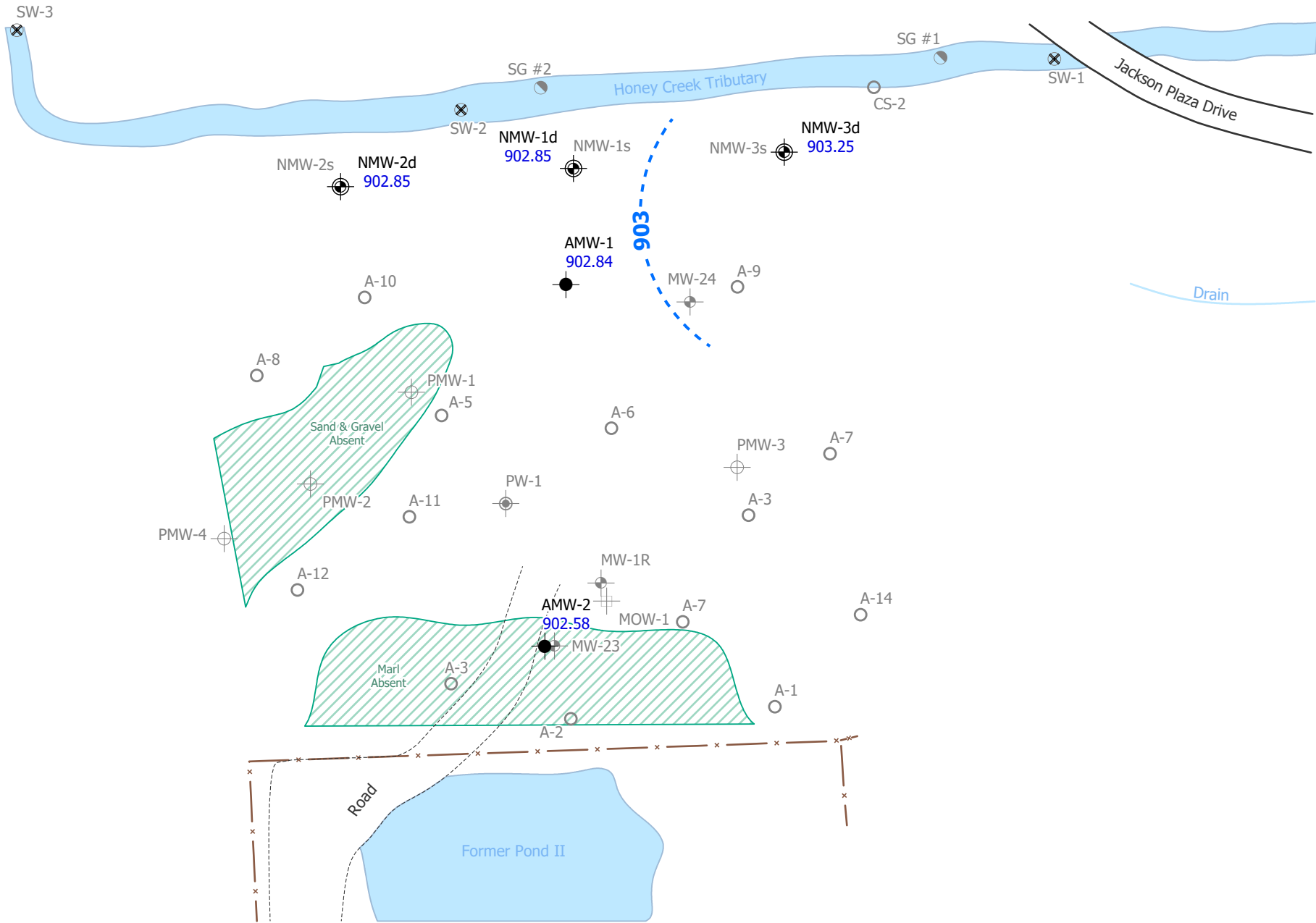

<ul style="list-style-type: none"> Observation Well Purge Well/Slump Monitoring Well Neared Monitoring Well Feet Monitoring Well 	<ul style="list-style-type: none"> Aperture Monitoring Well Aperture Surface Water Staff Gauge Potentiometric Surface Contour #1 Data Not Used (#1)
---	---

Potentiometric Surface Map
Marshy Area - Sand (September 25, 2019)
Gelman Sciences, Scio Twp., Washtenaw County, Michigan

DRAWN BY	DATE
saml	10/15/2019
PROJECT NO.	SCALE
806500	1:960
FILE LOCATION H:\09-085010-001001000000_Potential Copy1\CD 2019\09-25-19\09-25-19_Potential Map_SAND_PSC.DWG	
SOURCES FWS, MGLL, Gelman Sciences	

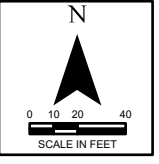



Well Type

- + Abandoned Well
- + Artesian Well
- + Extraction Well
- + Injection Well
- + Monitor Well
- + Production Well
- + Current/Former Drinking Water Well
- + SW & C3 Extraction Well Operating During Sampling
- + Soil Boring

1,4-Dioxane Isoconcentration Contours

- Unit C3 SW Property
- Other Farms
- Potentiometric Surface Elevation
- Data Not Used
- Compliance Monitoring Well

1,4-Dioxane Isoconcentration Map
Southwest Property (April 2019 - September 2019)
Gelman Sciences, Scio Twp., Washtenaw County, Michigan

DRAWN BY sami	DATE 10/17/2019
PROJECT NO. 806500	SCALE 1:1,560

FILE LOCATION
M:\Projects\806500-810000\806500_Pail Corp\CAD\2009\FIG_1648_Plate_and_Projects\2019\October\0419_SW_ISO.pdf

SOURCES
FIM, HGDL, Gelman Sciences, © OpenStreetMap (and) contributors, CC-BY-SA

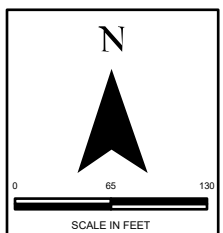



+	Plugged or Abandoned
+	Potentiometric Surface Contours
+	Potentiometric Surface Elevation
+	Unit C3 & SW Property
+	Other Items
+	Potentiometric Surface Elevation
+	Data Not Used
+	Compliance Monitoring Well
+	Soil Boring
+	Artesian Well
+	Extraction Well
+	Injection Well
+	Monitor Well
+	Production Well
+	Current/Former Drinking Water Well
+	SW & C3 Extraction Well Operating During Sampling

Potentiometric Surface Map
Southwest Property (September 25, 2019)
Gelman Sciences, Scio Twp., Washtenaw County, Michigan

DRAWN BY	DATE
saml	10/17/2019
PROJECT NO.	SCALE
806500	1:1,560
FILE LOCATION	
M:\Projects\806500-810000\806500_Pail Corp\CAD	
2009\FINAL_10-08-19\806500_Pail Corp\Projects	
2019\October\1019_SW_PSC.pdf	
SOURCES	
FIM, NGDL, Gelman Sciences, © OpenStreetMap (and) contributors, CC-BY-SA	

