

Independent Citizens Redistricting Commission
July 29, 2021 Meeting Public Comment

Date of Submission: Monday, July 26, 2021 12:22 PM
Method of Submission: Email To <Redistricting@Michigan.gov>
Name: John Klusinske
Subject: Redistricting

From John Klusinske

Please submit this to the Redistricting Commission in lieu of my submitting a map. Confirmation of submission would be appreciated.

Thanks

On Monday, July 26, 2021, 11:16 AM, J K [REDACTED] wrote:

The concept of applying “Community of Interest” to redistricting is gerrymandering in another form, executed by different people and simply serves different interests at the expense of the best interests of all. Politic’d bartered cluster representatives would only equal less unrepresentative government than we currently have. There is absolutely nothing wrong with accepting the reality that people characterized as “communities” are in themselves diverse. Voting as individuals is what voting is in a healthy democracy is. Let people find for themselves issue by issue who they share common interests and perspectives with. Do not set up and reinforce unhealthy competitive politics and disunity versus encouraging cooperation. Just draw an X over the state map and use an algorithm to create equally populated districts from the mid point of the X clockwise radiating out. Something so simple would restore failing faith in government as not being a fixed game. It would prompt eclectic candidacies from eclectic districts. Nothing is perfect but at least the short comings would be randomized by the simplicity. No one would know going in and in the future what the districts maybe and exploit them as easily as politically. Throw in open primaries, preference voting, and campaign finance reform and perhaps more people could watch or read the news without so much frustration.

Date of Submission: Saturday, July 24, 2021 3:19 PM
Method of Submission: Email To <Redistricting@Michigan.gov>
Name: Lorenz_marilyn
Subject: Map requested from Marilyn Lorenz

Sent from Yahoo Mail for ipad

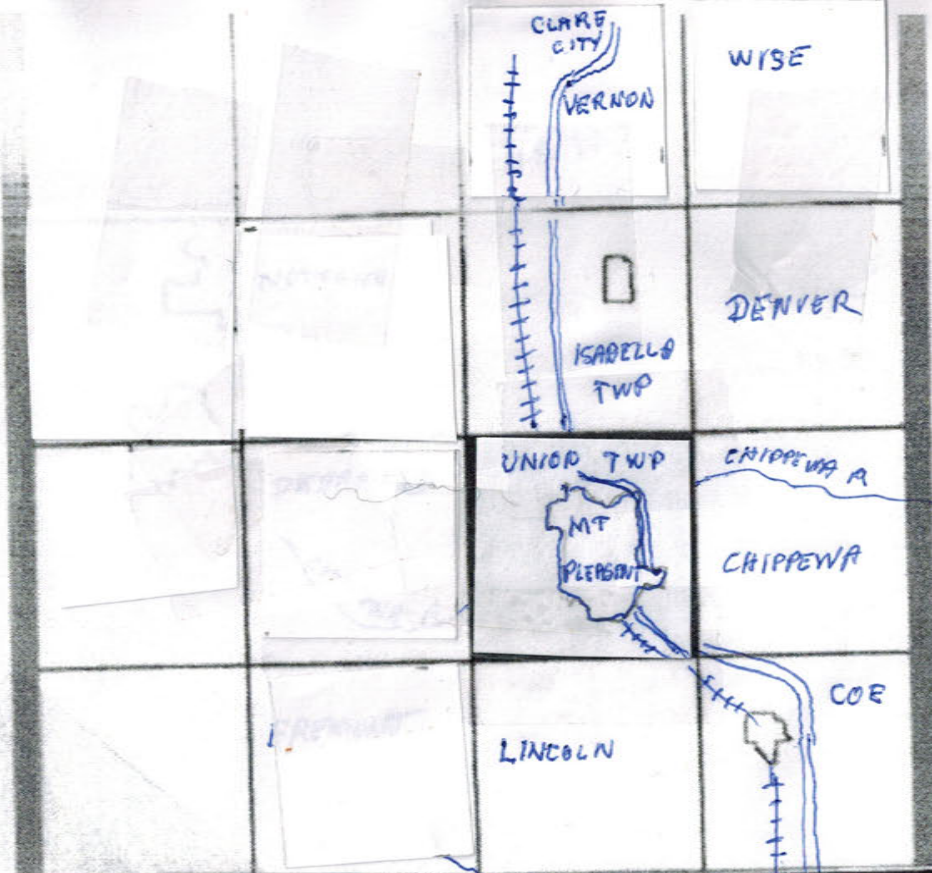

ISABELLA COUNTY

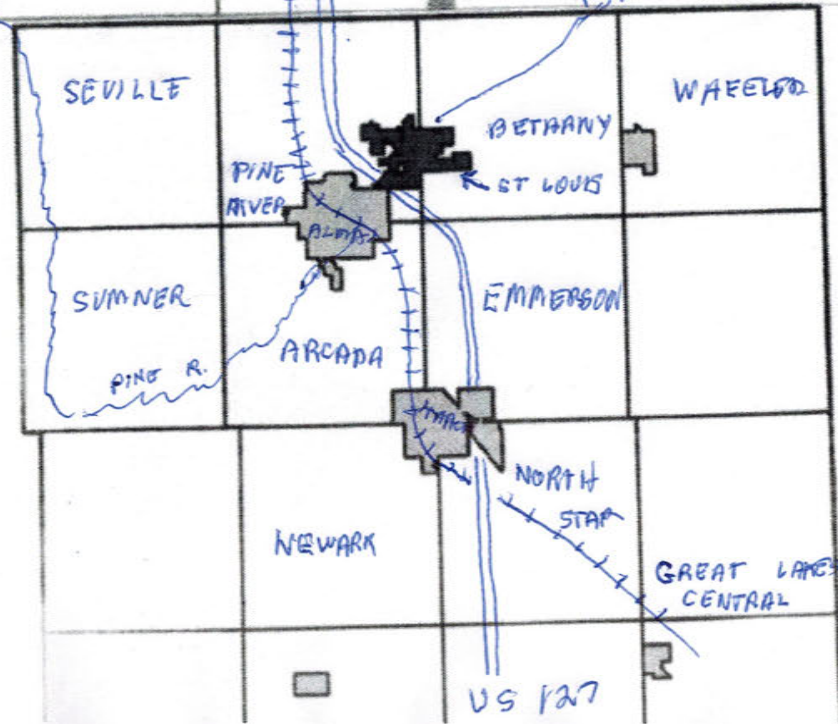

GRATIOT COUNTY

Kathleen E. Lutes

[REDACTED]
Presque Isle, MI 49777

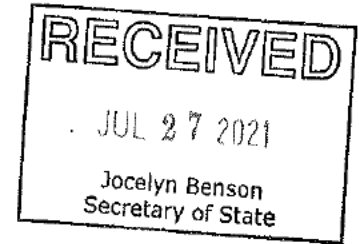

July 23, 2021

Citizens Redistricting Commission

P.O. Box 30318

Lansing MI 48909

RE: MI Redistricting - Communities of Interest

Dear Commissioners,

It is my understanding that the Commission is seeking input from Michigan residents regarding redistricting and its impact on our communities. As a resident of Presque Isle County, which is located on the northeastern shore of the state's lower peninsula, I assure you this county is quite distinct from those of others in MI. In fact, there is not a single traffic light in PI County!

By choice, my husband and I live in the Presque Isle Township where there is more wildlife than people, more trees than buildings, more trails than roads. There are no streetlights, no sidewalks, no super-stores. In the winter, two places are open: the post office and the library.

Our rural County boasts of 3 historic lighthouses, 4 state parks, numerous State-forest campgrounds, the largest waterfall in the lower peninsula, many karst formations of underground rivers and sinkholes, the world's largest open-pit limestone quarry, and 72 miles of magnificent Lake Huron shoreline. Natural resources abound.

The sounds of frogs croaking, birds singing, squirrels chattering, and coyotes howling fill the air. Deer, raccoons, porcupines, possums, snakes (and an occasional skunk or bear) are free to roam our piece of paradise.

Citizens Redistricting Commission

Page 2

Year-round residents are few and far between yet reliable neighbors look after each other and are very involved in our community through the Presque Isle Community Men's Club, the Presque Isle Women's Club, the Presque Isle Harbor Association, the Grand Lake Association, the Presque Isle Township Museum Society, the Presque Isle County Sportsman's Club, and more. Our community is defined by its neighborhood associations, natural features, historic and lakeshore significance.

Commissioners, life "in the forests of MI" is not for everyone, thus it is imperative that our elected representatives understand, respect, protect, and cherish this unique lifestyle. The redistricting map must be drawn accordingly. Thank you.

Sincerely,

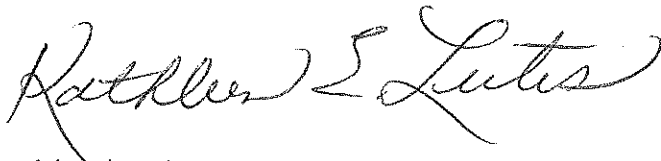
A handwritten signature in cursive script that reads "Kathleen E. Lutes". The signature is written in black ink and is positioned above the printed name.

Kathleen E. Lutes

July 7, 2021

MICRC
P.O. Box 30318
Lansing, Michigan 48909

To Whom It May Concern:

Please find enclosed a map outlining my Community of Interest, which includes MorningSide, the community in which I live, as well as East English Village, Cornerstone Village, and Grosse Pointe Park, Grosse Pointe city, and Grosse Pointe Farms.

I consider these a COI because MorningSide, East English Village, and Cornerstone share a common development corporation as well as common institutions and problems economically and socially. The named Grosse Pointes are also part of my COI because we share a common border in Mack Avenue and therefore a common bus line on Mack. In addition, many residents of MorningSide, EEV, and Cornerstone often shop at stores in the Grosse Pointes. Some on the Detroit side of Mack send their kids to St. Clare of Montefalco, on the Grosse Pointe side of Mack. I also frequently take walks in Grosse Pointe Park and GP Farms.

There have historically been tensions between our Detroit neighborhoods and the Grosse Pointes, and we need to build bridges and find more ways to cooperate. This is one way to do it.

Sincerely,



Susan Newell

Detroit, MI 48224

DETROIT, MI AND VIC

GROSSE
POINTE
SHORES

GROSSE
POINTE
FARMS

GROSSE POINTE

GROSSE
POINTE
PARK

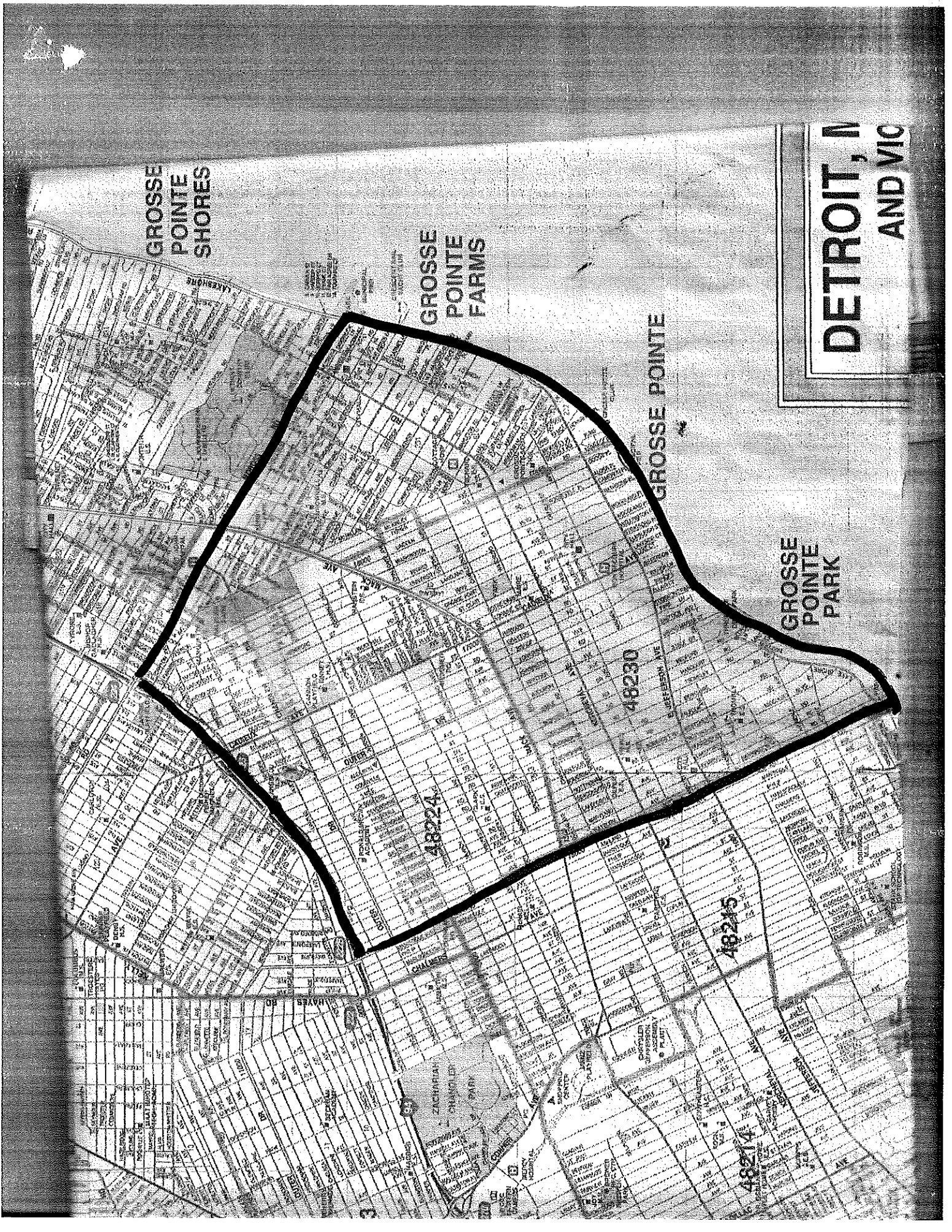

Public Testimony for Independent Redistricting Commission

Dear Commission,

We are grateful you are accepting public comment. My family lives in Holland in Allegan County. We ask you to make a Senate District that includes all of Allegan and Van Buren counties, and the Holland region in Ottawa County. The church communities, tourism, manufacturing base, and agriculture industries all fit together well in an Allegan, Van Buren and Holland area district.

The local governments work together, environmental challenges are the same, and these areas are enjoying a growth in diversity, particularly among the Hispanic community.

Please do not put Allegan, Holland, or Van Buren with Berrien, Cass, Grand Rapids or Muskegon. Allegan, Holland and Van Buren are unique inland, shoreline counties that are a community of interest.

Sincerely,

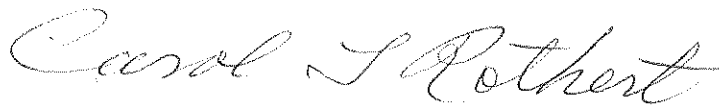

Carol Lynn Rothert
Holland in Allegan County

[Faint, illegible text at the bottom of the page, possibly bleed-through or a watermark.]

Public Comment for Redistricting Commission

Dear Commissioners:

Thank you for accepting public comment; we are grateful to have a voice in this process. My wife and I live in Holland in Allegan County. We ask you to make a Senate District that includes all of Allegan and Van Buren counties, and the Holland region in Ottawa County. These areas fit together because they have the same tourism, manufacturing, and agriculture economic interests. Additionally, these communities work together, with Allegan and Van Buren linking up on many governmental and non-profit activities, along with the Holland region. With the education links, a similar rural makeup with small towns combination, large and growing Hispanic population, and costal tourism cities, an Allegan, Van Buren and Holland area Senate district would best serve the diverse interests of our community.

None of these areas belong with the border counties of Berrien/Cass, the Muskegon area, or the Grand Rapids suburbs.

Sincerely,



Matthew Rothert
Holland in Allegan County

Public Comment for Citizens Independent Redistricting Commission

Dear Commissioners,

Thank you for public comment. My family lives in Fennville in Allegan County. As you make Senate District maps, please join Allegan and Van Buren counties. I'm a farmer and the link and similarities between Allegan and Van Buren are important; both possess:

- Heavy agriculture presence.
- Same infrastructure and environmental challenges.
- Many manufacturing and tourism businesses.
- Schools of approximately the same size.
- Rural areas and small/mid-size towns.
- Growing Hispanic population that will have more political power if, for example, Allegan, Van Buren, and Holland are joined together.

Members of my family are in each of these communities on almost a daily basis. Please avoid mapping Allegan or Van Buren in with Berrien or Cass counties or linking our shoreline communities with Muskegon. Allegan, Van Buren and Holland make much more sense for our Senate representation.

Thank you,



Eric Morrow
Fennville in Allegan County

Public Comment for Independent Citizens Redistricting Commission

Dear Commissioners,

Thank you for serving on the commission. I grew up in Allegan County, worked for telecommunications, agriculture, and assisted living businesses, and I respectfully ask that Allegan and Van Buren counties remain in the same Senate District. Our counties are linked up with similar economic interests, farms, small towns, schools, public policy priorities, and that is reflected as our county governments and non-profits collaborate across county lines. My wife and I frequently spend time in Van Buren County, from the restaurants and ice cream shops in South Haven to the farm areas and friends in other parts of Van Buren. Allegan and Van Buren is definitely a community of interest, and if you need more population to create a Senate district, my top recommendations are either the Holland area in Ottawa County or Barry County. Thank you.

Sincerely,

Don Wicks

Holland, MI 49423
Laketown Township

Written Testimony to Michigan Independent Citizens Redistricting Commission

Dear Commissioners,

I am a long-time resident of Saugatuck in Allegan County, having worked in the health care and furniture manufacturing sectors. As you develop Senate maps, please place together Allegan and Van Buren Counties, along with the City of Holland. Allegan and Van Buren face similar circumstances with agriculture, manufacturing and tourist-based economic sectors and consist of predominantly rural areas with small towns. Access to high-speed internet and environmental issues are similar across this region, along with similar economic and education challenges make Allegan and Van Buren counties a natural fit. The City of Holland and nearby communities combine well with Allegan and Van Buren as they are in the same media market, possess the same tourism and environmental issues, and people from these areas frequently work and visit throughout this district.

Thanks for your consideration.

Sincerely,



Betty Jones

City of Saugatuck in Allegan County

Dear Commissioners,

Please consider this my public testimony:

My wife and I live on the shoreline in Allegan County. We ask you join Allegan and Van Buren counties together in the Senate District you create. Allegan and Van Buren are very similar, with many farms, tourism businesses, small-to-mid size K-12 schools, infrastructure needs, and environmental challenges. By joining our counties together, we will have the strongest possible Senate representation for the issues that matter in our area.

Please do not combine Allegan or Van Buren with Berrien or Cass County and somehow link us to Muskegon. We would like a Senator who understands our local issues and lives nearby, and that is accomplished by joining Allegan and Van Buren counties together in the senate.

Sincerely,

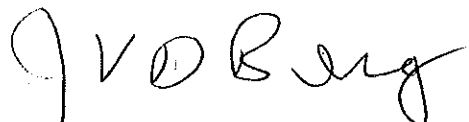
A handwritten signature in black ink that reads "J VanDenBerg". The signature is written in a cursive style with a large initial "J" and "V".

Jack VanDenBerg
Fennville in Allegan County