

99211A.DWG 6-12-00 (99211-MM)

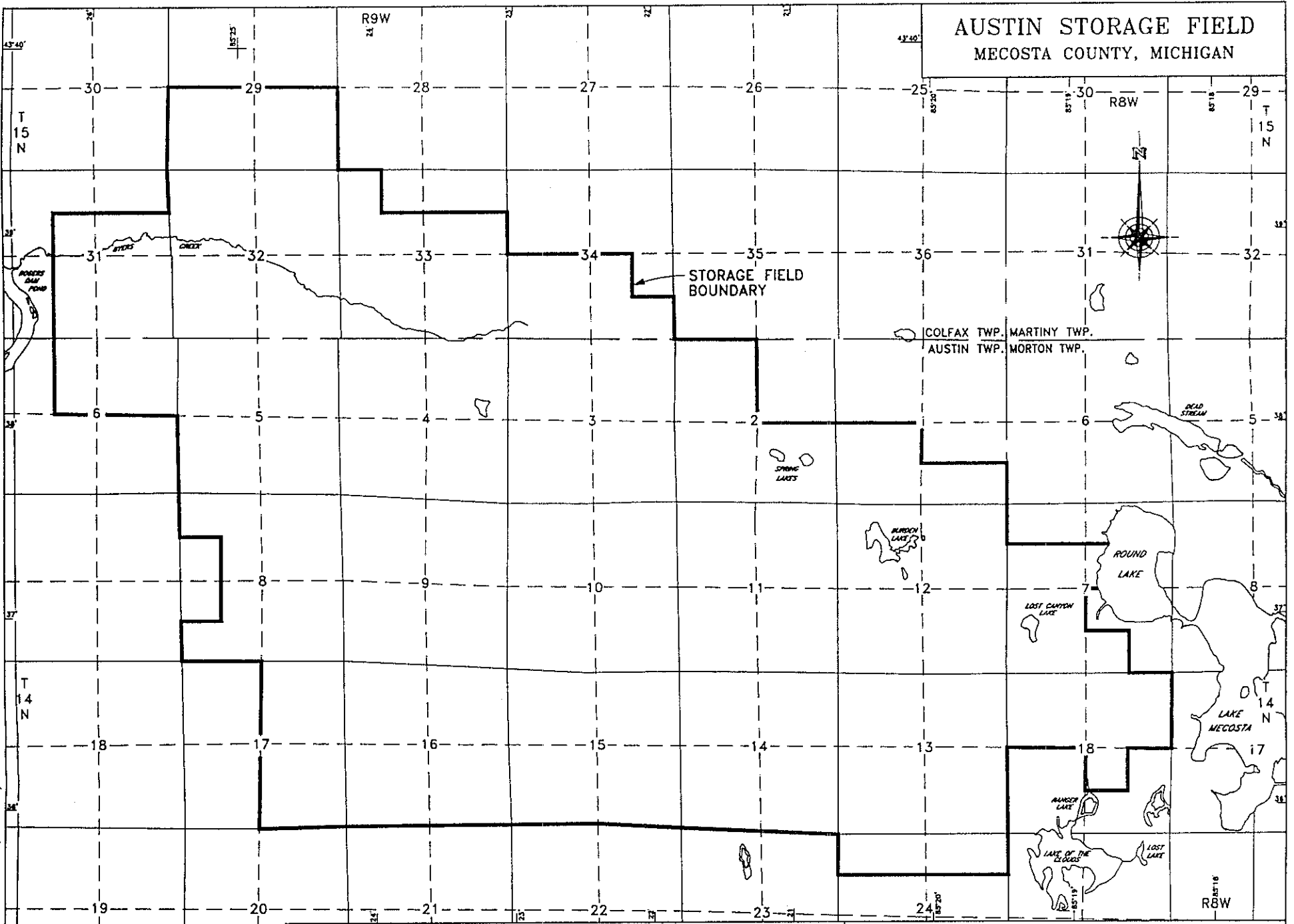

**AUSTIN STORAGE FIELD**  
MECOSTA COUNTY, MICHIGAN

STORAGE FIELD BOUNDARY

- ✦ DRY HOLE
- \* GAS PRODUCING OR STORAGE WELL
- ⊕ GAS OBSERVATION WELL (STRAY)
- △ PARMA OBSERVATION WELL
- \* PLUGGED AND ABANDONED HOLES

AUSTIN STORAGE FIELD BOUNDARY

**MID MICHIGAN GAS STORAGE COMPANY**

-RESERVOIR ENGINEERING DEPARTMENT-  
DRAWN BY -EH DATE 11-18-99

