



Statewide GIS Users Meeting  
February 1, 2018

# City of Hastings Riverside Cemetery

Ed Dempsey, GISP

# Project Overview

- Privately owned cemetery established in 1870
- Riverside Cemetery Foundation faced bankruptcy
- Cemetery Millage passed in 2014
  - Operating capital
  - Capital Improvements
  - Record keeping
- “Get our data online.”



MAP  
OF THE  
3rd Addition  
To  
RIVERSIDE CEMETERY  
HASTINGS

F. E. Skeels  
Surveyor

Numbering oddities in the Third Addition

1. There are two blocks numbered 10 and two numbered 13 in Area "Q".
2. Block number 7 appears to be missing from Area "Q".
3. Block 56 appears to have not been labeled as such in Area "Q".
4. Block 67 is missing from Area "Q".
5. Blocks 82-86 inclusive are missing from Area "Q".
6. Blocks 94-106 inclusive are missing from Area "Q".
7. In Area "R", near block 68, there are 6-7 unnumbered blocks.
8. In Area "R", there is a Block 98 between Blocks 31 and 32.





Search



Drawing Order

- Layers
  - Section
  - Blocks
  - Lots
  - Plots

Hastings\_6in\_Mosaic.sid

- RGB
- Red: Band\_1
  - Green: Band\_2
  - Blue: Band\_3



OBJECTID	6497
Cemetery	RIVERSIDE
Section	NORTH
Block	N
Lot	013
Plot	11
Concatenated ID RIVERSIDE-NORTH-N-013-11	



Object Explorer

Connect

- [-] EDEMPSEY7\SQLEXPRESS14 (SQL Server 12.0.5571 - PN\edempsey)
  - [-] Databases
    - [-] System Databases
    - [-] D009Hastings
    - [-] D009Hastings\_2017\_10\_24
      - [-] Database Diagrams
      - [-] Tables
      - [-] Views
        - [-] System Views
        - [-] **dbo.Plot\_Occupant**
        - [-] dbo.Plot\_Owner
        - [-] dbo.Plot\_Status
      - [-] Synonyms
      - [-] Programmability
      - [-] Service Broker
      - [-] Storage
      - [-] Security
    - [-] Security
    - [-] Server Objects
    - [-] Replication
    - [-] Management

EDEMPSEY7\SQLEXP...bo.Plot\_Occupant\* X

Occupant

- id
- Name
- FormerName
- FormerAddress1
- FormerAddress2
- FormerCity
- FormerState
- FormerZip
- BirthDate
- BirthPlace
- BirthState
- Veteran

Column	Alias	Table	Outp...	Sort Type	Sort Or
plotID		Occupant	<input checked="" type="checkbox"/>		
Name		Occupant	<input checked="" type="checkbox"/>		
FormerName		Occupant	<input checked="" type="checkbox"/>		

```
SELECT plotID, Name, FormerName, BirthDate, BirthPlace, BirthState, Veteran, Branch
FROM dbo.Occupant
```



Contents

Search

Drawing Order

- Layers
  - Section
  - Blocks
  - Lots
  - Plots
- Status
  - Available
  - Unavailable
  - Occupied
  - Sold
- Hastings\_6in\_Mosaic.sid
- RGB
  - Red: Band\_1
  - Green: Band\_2
  - Blue: Band\_3

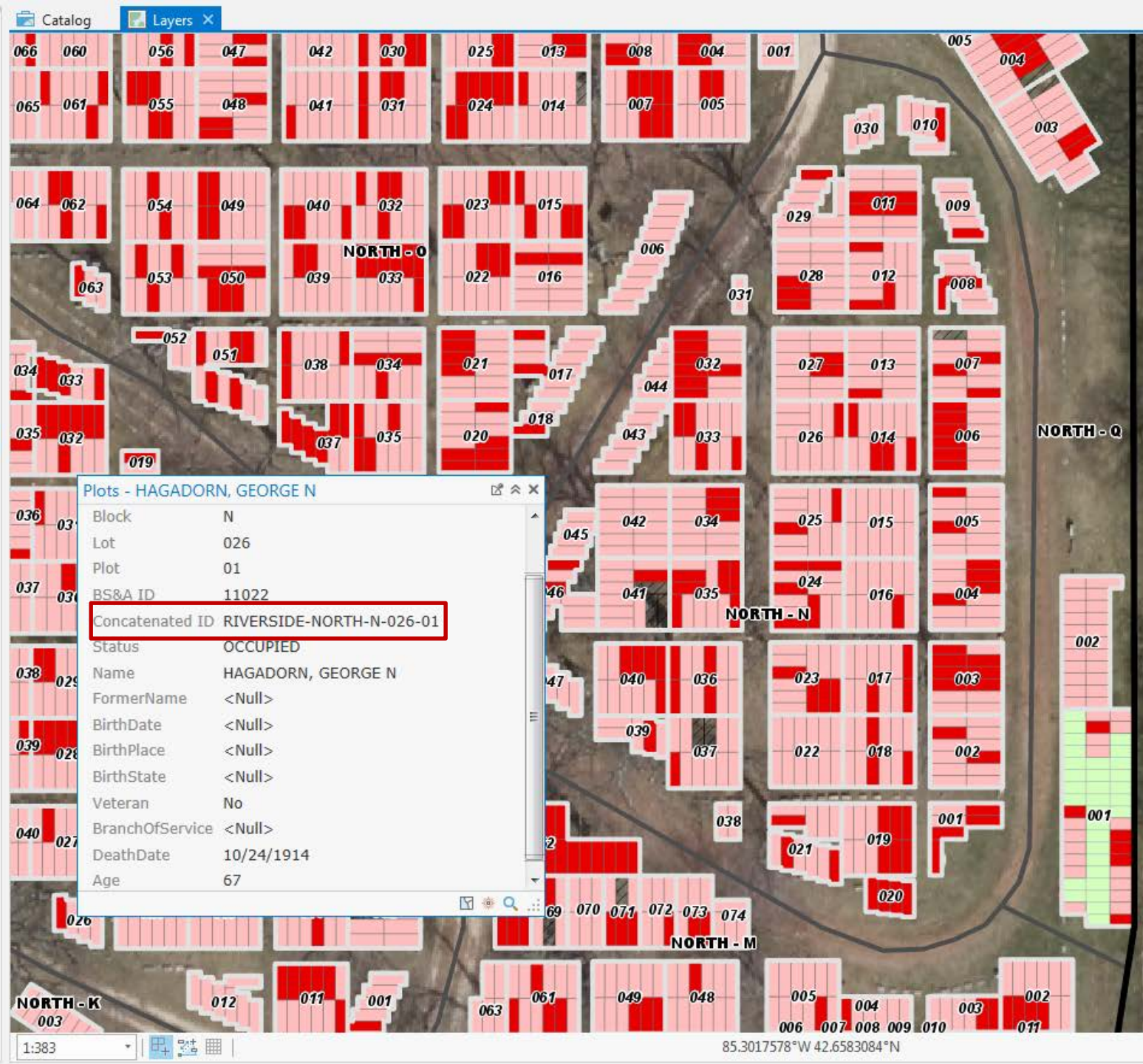

# Famous Hastings Residents

- Kim Sigler, Michigan Governor 1947 to 1949
- Albert Decatur Kniskern, Brigadier General, French American War
- Charles “Lady” Baldwin

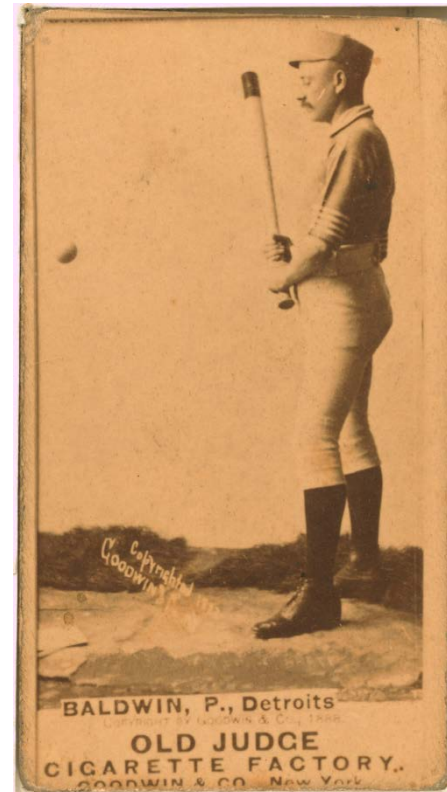



# Demo

- <http://arcg.is/2CAMXk9>