

# CAMP OTTAWA CORRECTIONAL FACILITY

## IRON COUNTY, MICHIGAN

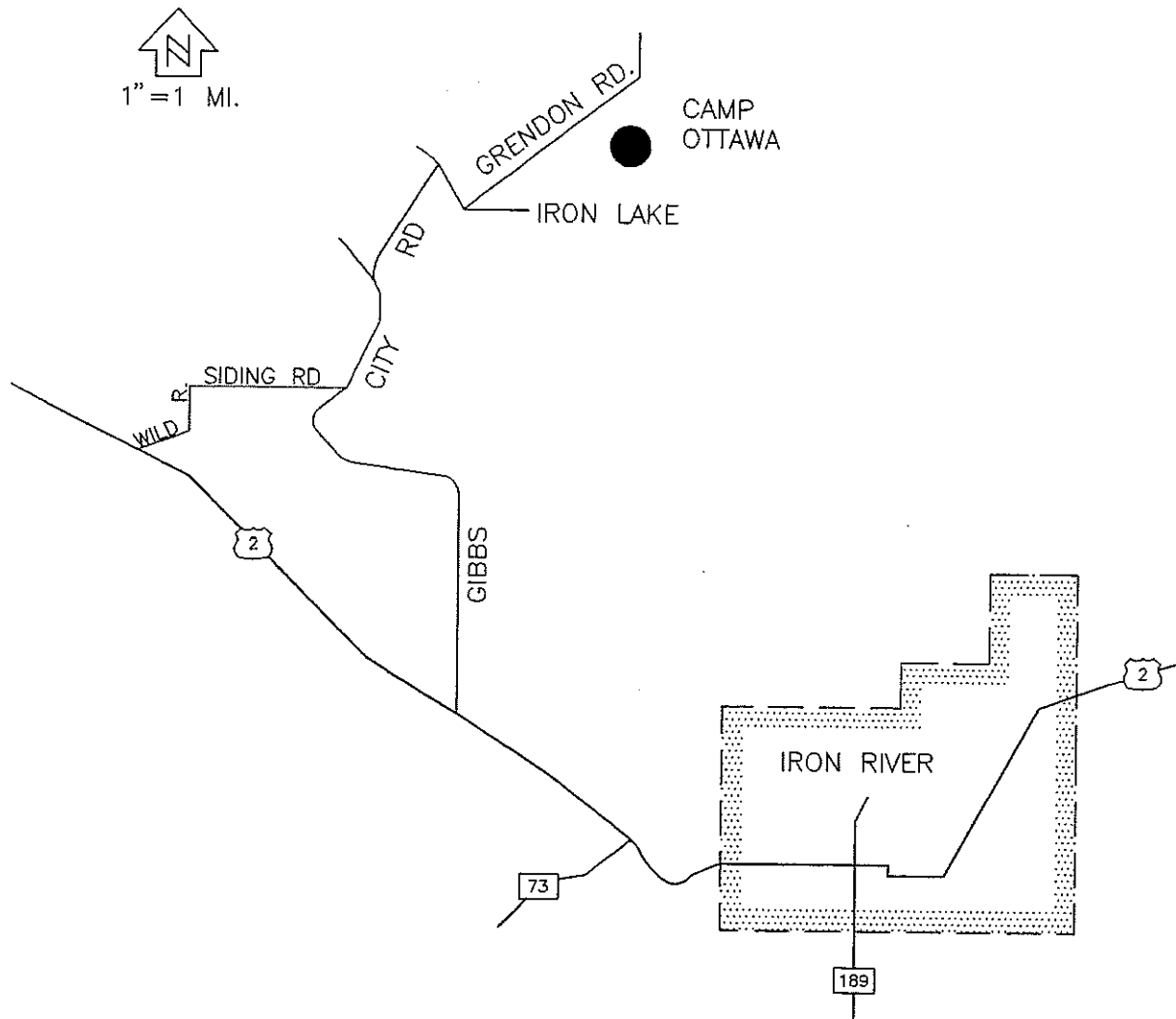

# CAMP OTTAWA CORRECTIONAL FACILITY IRON COUNTY, MICHIGAN

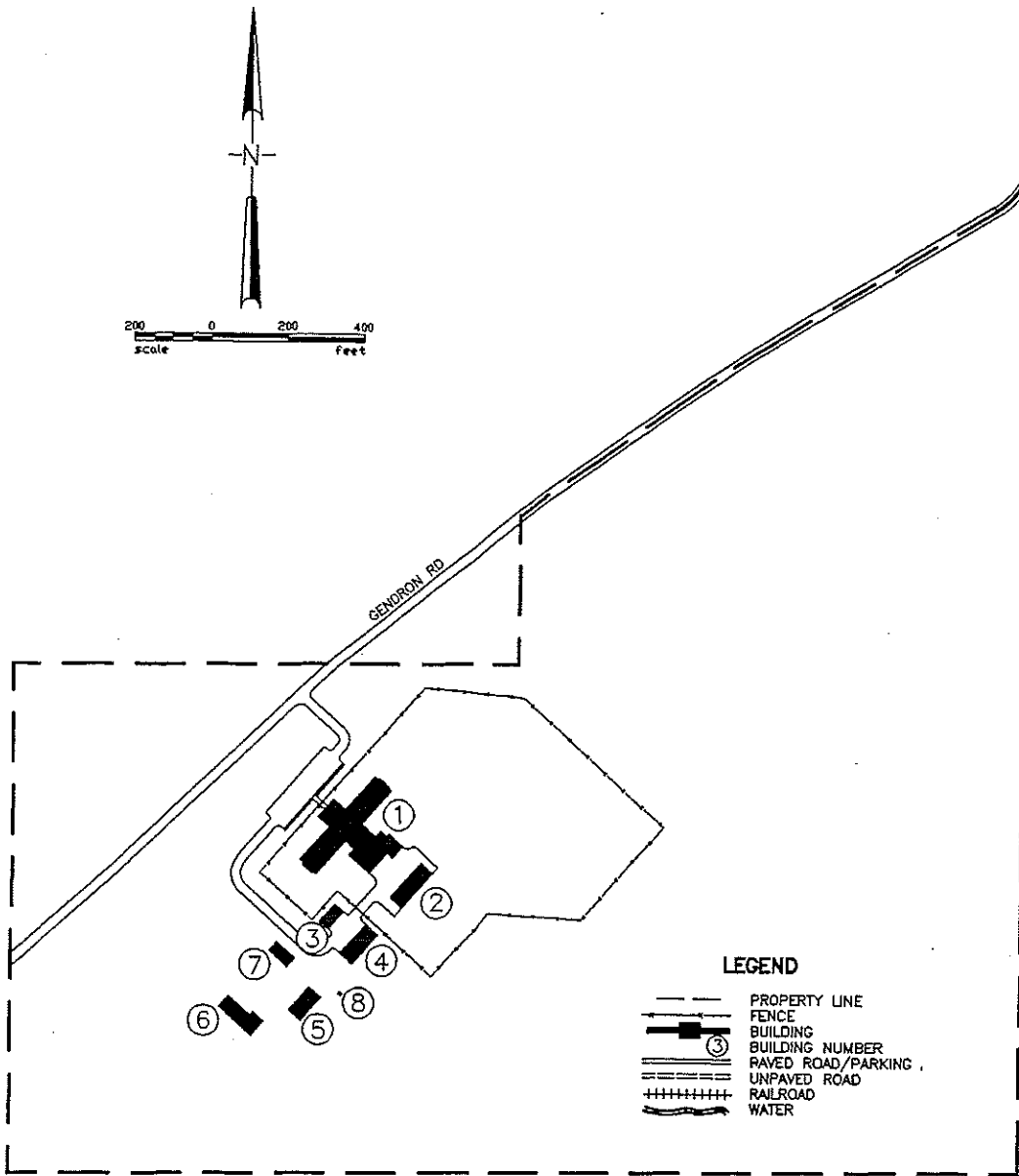

STATE of MICHIGAN  
DEPARTMENT of MANAGEMENT and BUDGET  
**OFFICE OF FACILITIES**  
LANSING, MICHIGAN 48909

# CAMP OTTAWA CORRECTIONAL FACILITY

## Iron County, Michigan

Number	Name	Function	Year Constructed or improved	Gross Area (Sq. Ft.)	Gross Volume (Cu. Ft.)	Barrier Free
1	Admin/Housing	Admin/Housing	1990	39,000	351,000	
2	Wood Storage	Storage	1990	4,800	38,400	
3	Maintenance	Services	1990	1,800	16,200	
4	Carport	Vehicle Parking	1990	4,000	40,000	
5	Dimension Mill	MSI	1995	3,200	44,800	
6	Saw Mill	MSI	1995	3,132	37,584	
7	Office/Carpenter Shop	MSI	1996	1,716	18,876	
8	Wood Boiler	MSI	1995	<u>48</u>	<u>336</u>	
				57,696	547,196	

April 1996