



MICHIGAN DEPARTMENT OF ENVIRONMENT, GREAT LAKES, AND ENERGY

Drinking Water and Environmental Health Division

DRINKING WATER LEAD AND COPPER SAMPLING INSTRUCTIONS FOR SITES WITHOUT LEAD SERVICE LINES

The Michigan Safe Drinking Water Act, 1976 PA 399, as amended (Act 399), R 325.10710a(2) which details sample collection methods for lead and copper monitoring in tap water.

Dear Resident:

This sampling is required by the federal and state Safe Drinking Water Acts and is being accomplished with the cooperation of homeowners, residents, and water system customers.

It is important that you read these instructions completely before sampling. This will allow the Michigan Department of Environment, Great Lakes, and Energy (EGLE) to obtain an accurate measurement of the lead and copper in your drinking water. This sample should represent the water and the faucet where you typically consume water.

1. Water must remain motionless in the pipes for at least six hours before sampling. Therefore, the most convenient times to sample may be early morning, after school, or after returning from work.

DO NOT intentionally or systematically run water before the start of the six-hour period.

DO NOT use any water in the house during the minimum six-hour period.

2. Select an unfiltered/untreated faucet in the **KITCHEN SINK** or **BATHROOM SINK** that has been commonly used for drinking in the past few weeks.

DO NOT sample from a laundry sink, bathtub, hose, or outdoor faucet as these samples do not represent water that you typically consume.

DO NOT use a faucet with a filter unless you turn the filter off.

DO NOT use a faucet that is connected to a home water treatment device like a water softener, iron filter, or reverse osmosis.

DO NOT remove or clean the aerator immediately before sampling.

3. Open the sample bottle and be careful not to touch the inside of the bottle or the cap. Place the open sample bottle below the faucet and then turn on the **COLD-WATER** tap. If you have a single handle faucet, turn it fully to the **COLD** side. Fill the sample bottle to the neck with the "first draw" of **COLD** water.

4. Tightly cap the sample bottle and place it in the sample kit provided. Review the sample kit label to ensure all information contained on the label is complete and correct.

5. Complete the information on pages 3 and 4.
6. Place your completed form with the bottle inside the sample kit and arrange for pick-up according to the instructions provided by your water department.

Thank you for your help. Your water supply will send your individual results within 30 days of receiving them from the laboratory. A summary of your water supply's lead and copper results will be provided in the annual water quality report that will be available by July 1 of next year.

If you have questions, please call:

Water Supplier: _____

Manager or Water Operator: _____

SAMPLE COLLECTION RECORD

THE FOLLOWING INFORMATION IS TO BE COMPLETED BY THE RESIDENT/CUSTOMER

1. Which faucet did you use to fill the bottle?

- Kitchen Sink Bathroom Sink Other (not an option for residential sites)

If you selected OTHER, please describe the faucet you used.

2. When was the water in the house last used before sampling?

Date _____ Time _____ AM PM

3. When did you fill the bottle (should be at least 6 hours from when the water was last used)?

Date _____ Time _____ AM PM

Home water treatment information:

If your home has a water softener, filter, reverse osmosis, or iron removal treatment device, it may be changing your water quality and lead levels. If you have questions about treatment devices in your home, talk to your water system representative **before** collecting your water samples.

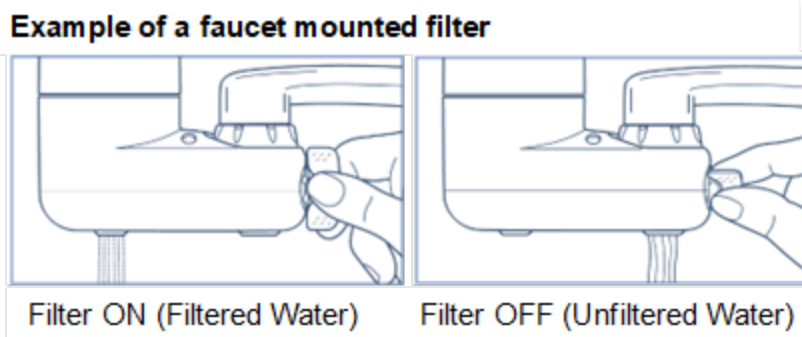

4. Is there a faucet mounted filter or reverse osmosis device on the faucet?

- YES NO

If you selected Yes, did you bypass or turn the device off **BEFORE** collecting the sample (unfiltered water)?

- YES NO

Remember to turn the device on **AFTER** collecting the sample to resume filtering the water.

5. Is there a whole house treatment device such as a water softener, sediment filter, or iron removal device **OR** any other kind of treatment?

- YES NO OTHER: _____

If you selected Yes, please discuss with your water supply representative how to bypass this device or choose a different faucet within your home.

Did you bypass the device?

- YES NO

I have read the Drinking Water Lead and Copper Sampling Instructions and have taken the tap water sample in accordance with the directions.

Printed Name

Date

Sample Collection Address

Signature

If you need this information in an alternate format, contact EGLE-Accessibility@Michigan.gov or call 800-662-9278.

EGLE does not discriminate on the basis of race, sex, religion, age, national origin, color, marital status, disability, political beliefs, height, weight, genetic information, or sexual orientation in the administration of any of its programs or activities, and prohibits intimidation and retaliation, as required by applicable laws and regulations. Questions or concerns should be directed to the Nondiscrimination Compliance Coordinator at EGLE-NondiscriminationCC@Michigan.gov or 517-249-0906.

This form and its contents are subject to the Freedom of Information Act and may be released to the public.