

User:AKENS Spec:PIRNE STANDARD File:J:\4065031\Source Identity Report\September 2009 Final\Figures\dwg\FIG 5A\_GSWA\_SHC\_A.DWG Scale:1:1 Date:06/29/2010 Time:13:20 Layout:34x22

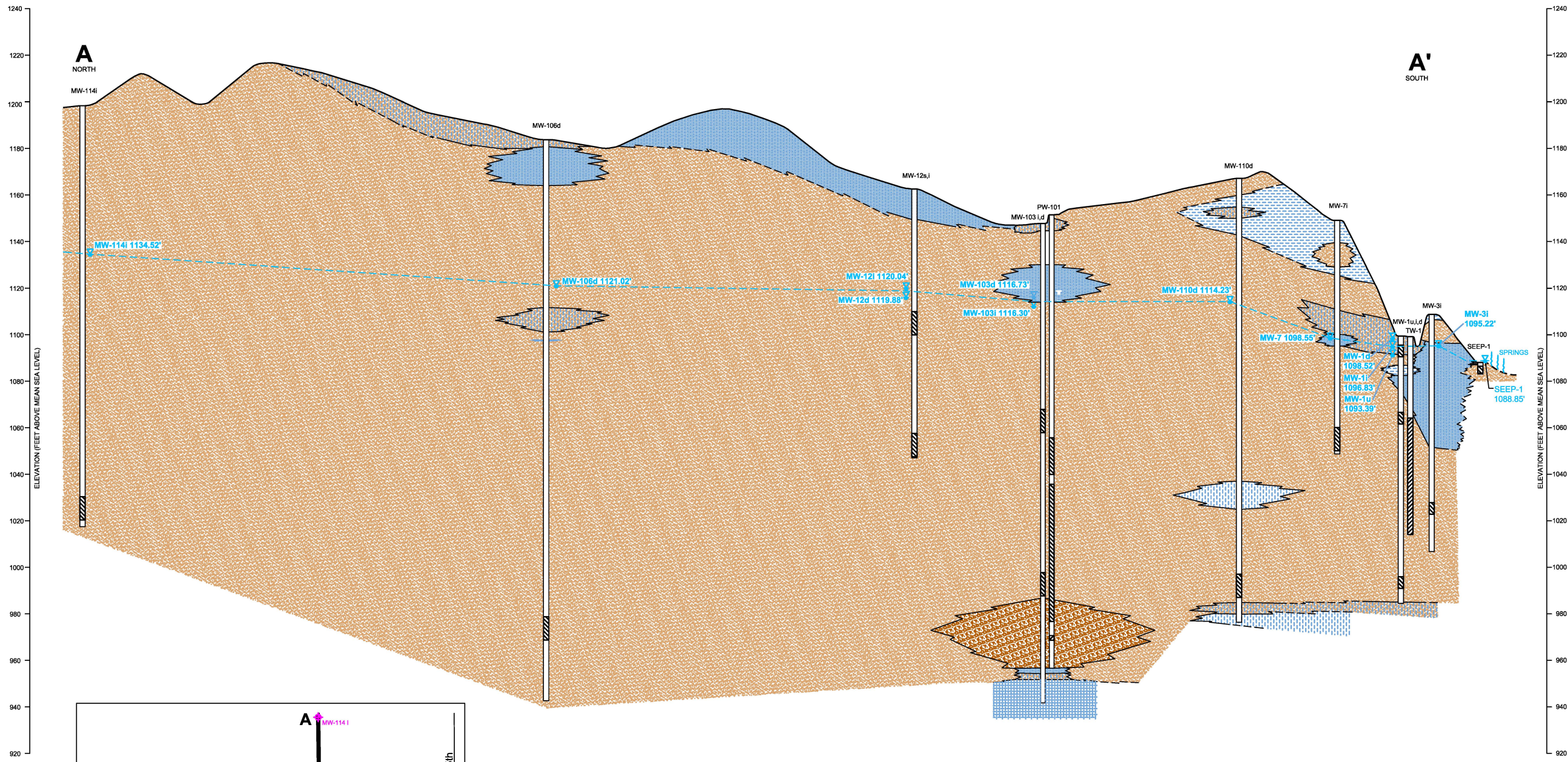

- LEGEND**
- SANDS WITH DISCONTINUOUS CLAY, SILT AND GRAVEL LAYERS 5 FEET THICK OR LESS
  - SILT
  - SILTY SAND
  - SILT AND CLAY
  - GRAVEL OR SAND WITH GRAVEL
  - CLAY
  - CLAYEY SAND
  - PEAT
  - INFERRED POTENTIOMETRIC SURFACE
  - STATIC WATER LEVEL MEASURED 10/29/02
  - SCREENED INTERVAL

- NOTES**
1. GEOLOGIC CROSS SECTION IS INTERPRETATION OF FIELD DATA.
  2. PRODUCTION WELL PW-101 LITHOLOGY BASED ON MW-103D BORING LOG.

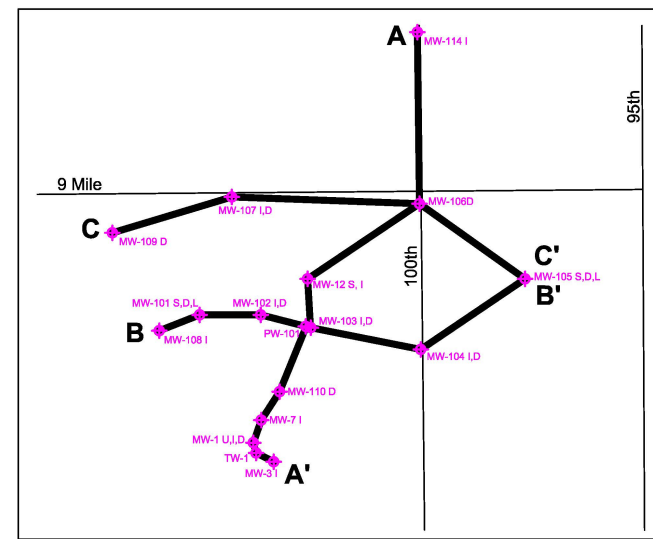

ATTACHMENT 4A

NOVEMBER 2015



NESTLE WATERS NORTH AMERICA  
WHITE PINE SPRING PROJECT  
OSCEOLA TOWNSHIP, MICHIGAN  
STRATIGRAPHIC CROSS SECTION A-A'