

WHAT TO DO AFTER AN EMERGENCY REPAIR ON A SERVICE LINE WITH LEAD OR GPCL MATERIALS

You have or had to do an emergency repair on a service line that has lead or galvanized previously connected to lead (GPCL) materials. Now what?

Required Actions by Water Supply



Resident(s) and owner(s) must be notified that their home or building is served by a service line that has a lead or GPCL portion **within 30 days** of determination

- Required pursuant to R325.11604(c)(5)
- [Guidance](#) and [template letter](#)



Collect lead and copper samples **within 72 hours**. These samples must be collected according to the lead and copper compliance sampling procedure (1st and 5th liter method)

- Required pursuant to R325.10604f(5)(c)(iii) and R325.10604f(6)(e)(iv)
- [Sampling infographic](#) and [video](#)

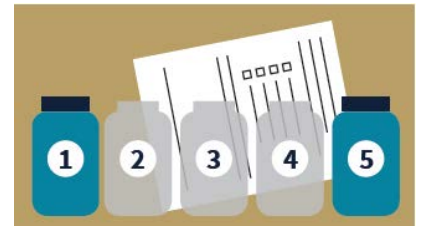

Report results to the resident(s) and owner(s) **within 3 business days** of receiving them

- Required pursuant to R325.10604f(5)(c)(iii) and R325.10604f(6)(e)(iv)
- [Consumer Notice](#)
- Sources of additional information or enclosures
 - [Lead in Drinking Water](#)
 - [Michigan.gov/MiLeadSafe](#)



Make sure this service line remains on the system's inventory for full replacement and report on the all-emergency partial replacements to the department annually on the form linked below.

- Required pursuant to R325.10604f(5)(b) or R325.10604f(6)(b)
- [Annual Service Line Replacement Report Form](#)

Recommended Actions for Water Supply

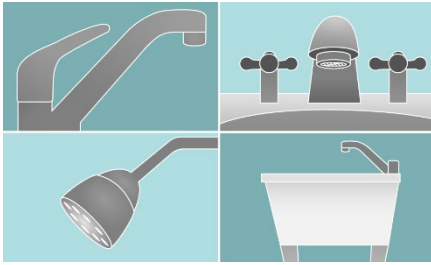

Flush the home to properly remove particulate.

- [Guidance on Flushing your Whole Home Plumbing System](#) and [video](#)
- [Guidance on Flushing Appliances that Use Water for Consumption](#)



Clean aerators.

[Guidance on Cleaning Your Aerators](#)



Provide a water filter certified to reduce lead or bottled water until samples have been collected and analyzed.

- [How to use your pitcher filter](#)
- [How to use your faucet filter](#)

EGLE does not discriminate on the basis of race, sex, religion, age, national origin, color, marital status, disability, political beliefs, height, weight, genetic information, or sexual orientation in the administration of any of its programs or activities, and prohibits intimidation and retaliation, as required by applicable laws and regulations.

To request this material in an alternative format, contact EGLE-Accessibility@Michigan.gov or call 800-662-9278.