

Michigan Department of
Environment, Great Lakes, and Energy (EGLE)
Community Water Supply

Quarterly Program Update

January 21, 2021



All lines are muted during the webinar.



Submit your questions using the “**Question**” box in your Go To Webinar tool bar.

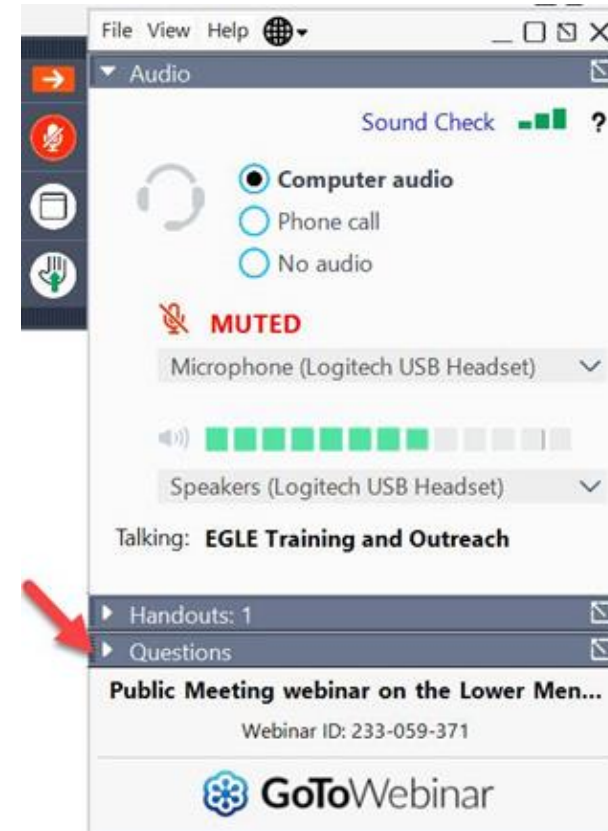

Poll Question 1

Q & A Panel

- Eric Oswald
 - Drinking Water and Environmental Health Division Director
- George Krisztian
 - DWEHD Assistant Division Director
- Brian Thurston
 - DWEHD Field Operations Section Manager
- Kris Philip
 - DWEHD Community Water Supply Section Manager

Topics Covered Today

- EGLE Updates
- Reminders & Resources
- Poll Questions
- Q&A Session

EGLE Update

- In general, EGLE staff continue to telework from home.
 - Remote water supply surveillance visits
 - Remote sanitary surveys, except facility inspection portion
- In-person Visits:
 - DWEHD Field Operations Section (FOS) Standard Operating Procedures (SOP) updated to include additional safety precautions to protect water supply and DWEHD staff during in-person visits
 - DWEHD continues program critical in-person visits in all districts using updated SOP

EGLE Field Work COVID-19 Procedures

Some considerations in DWEHD's current field work procedures:

- Perform as much work as possible remotely
- **Face coverings required by EGLE and WATER SUPPLY staff**
- Verify lack of COVID-19 symptoms for water supply personnel and EGLE inspector ahead of visit
- Do not shake hands and practice social distancing
- Do not touch facility equipment and try to avoid using facility rest rooms and break rooms
- Avoid exchanging physical materials, including paper handouts
- **We need water supply cooperation to keep EGLE and supply personnel safe and to keep MI WTPs reliably staffed**

Operator Training & Certification Update

Spring 2021 Examinations Moved to Summer

- Spring exams, usually held in May, **will be held in JULY 2021**
- Reduces health risks by allowing additional time for COVID vaccinations

2021 Operator Training

- EGLE 2021 training calendar will be posted soon
- EGLE and other technical assistance providers continue to expand online training opportunities
- Visit Michigan.gov/EGLEoperatortraining for a list of approved courses and other OTCU information

Executive Orders & Other Laws

- Executive Order requiring masks and limiting gatherings replaced by [DHHS Epidemic Order](#)
 - [All DHHS Epidemic Orders](#) can be found at [Michigan.gov/Coronavirus](https://www.michigan.gov/Coronavirus)
- Water service restoration
 - [Senate Bill 241](#) signed December 22, 2020, created the Water Shutoff Restoration Act
 - Prohibits water shutoffs due to nonpayment and mandates service be restored to residences where shutoffs have occurred, in most circumstances, through March 31, 2021
 - Ensures every occupied residence has access to clean running water so that they can regularly hand-wash consistent with CDC guidance to prevent spread of COVID-19
 - [Reporting requirements for systems that have used water shutoffs as a remedy for nonpayment since December 22, 2019, starting January 21, 2021.](#)

General Online Resources

- Michigan Webpage: Michigan.gov/Coronavirus
- EGLE CWS Webpage: Michigan.gov/CommunityWater, then "[COVID 19: Information for Water Operators](#)"
- EPA has established a website to assist water utilities: "[Water Utility Resources for the COVID-19 Pandemic](#)"
- MIOSHA provides information for various sectors, including factsheets, posters, and other guidance: [MIOSHA COVID-19 Workplace Safety Guidance](#)



Water Quality Within Buildings

Resources for managing building water quality following periods of low or no water use:

- [EGLE: School Flushing Guidance](#)
- [CDC: Guidance for Building Water Systems](#)
- [EPA: Maintaining or Restoring Water Quality in Buildings...](#)
- [ASDWA: COVID-19 Resources for Building Water Systems](#)
- [AWWA: Coronavirus Information, incl. Return to Service Guidance](#)
- [ESPRI: Flushing Guidance for Periods of Low or No Use](#)
- [Purdue: Water Quality in Low Occupancy and Shutdown Buildings](#)
- [AWWA/IAPMO: Responding to Water Stagnation in Buildings with Reduced or No Water Use](#)

Poll Question 2

MI Clean Water Funding

- Governor's program invests in protecting public health, environment and the economy.
- \$500 million total commitment towards Michigan's water infrastructure needs
 - \$207 million for Drinking Water Investments
 - \$293 million for Clean Water Investments
- Grant programs used in conjunction with State Revolving Fund (SRF) financing can help maximize impact in communities

MI Clean Water Funding

- Drinking Water Funding Objectives
 - Protect citizens, especially children, by removing lead service lines in communities that can least afford to do this critical work
 - Help communities assess their systems and develop plans that help efficiently ensure they are always delivering high quality drinking water
 - Invest in communities struggling with PFAS contamination by funding improvements at treatment plants and running lines to neighborhoods with contaminated wells
- \$207 Million for Drinking Water
 - \$102 million - Disadvantaged Community Lead Service Line Replacement Program
 - \$37.5 million - Drinking Water Asset Management Grants
 - \$25 million - Consolidation and Contamination Risk Reduction Grants
 - \$35 million - Drinking Water Infrastructure Grants
 - \$7.5 million - Affordability and Planning Grants
- Program details and application are posted on EGLE internet - www.michigan.gov/eglegrantsandloans

Drinking Water Asset Management (DWAM) Grants

- Program focuses on helping communities inventory their infrastructure and efficiently plan for the ongoing management of their critical assets.
- Over 300 grant applications were received by the 1/1/2021 deadline identifying more than \$136 Million in DWAM needs.
- Anticipated grant awards by 3/15/2021.

Consolidation & Contamination Risk Reduction (C2R2) Grant

- The C2R2 grant is available to drinking water systems for projects that remove or reduce PFAS or other contaminants, as defined under state or federal drinking water regulations, or efforts to consolidate systems or connect private residential wells to a local municipal system.
- There is \$25 million available, with a maximum grant award per applicant of \$5 million.
- [Applications](#) are due by January 31, 2021, for the initial round. Applications will continue to be accepted until funding is exhausted.

Affordability and Planning (AP) Grant

- The AP grants will assist communities with addressing affordability and planning needs.
- There is \$7.5 million total funding available.
- Grants will be awarded based on a competitive process up to \$500,000 per applicant or \$2 million if an applicant is applying on behalf of multiple community water supplies.
- [Applications](#) will be accepted from December 1, 2020 through January 31, 2021.

Drinking Water State Revolving Fund (DWSRF) and associated grants.

- Both below grants will be administered through the DWSRF Process.
 - Disadvantaged Community Lead Service Line Replacement Program - \$102 Million
 - Drinking Water Infrastructure (DWI) Grants - \$35 Million
 - Projects must be identified in the Community's Asset Management Plan and/or Capital Improvements Plan to be eligible for the DWI grant.
- [Intent-to-Apply form](#) is due by January 31, 2021 for year 2022 consideration

Source Water Protection Grants

- To provide matching funds to public water supply systems for the development and implementation of a source water protection program to help prevent drinking water sources from becoming contaminated.
- These funds can be used to develop a Surface Water Intake Protection Program for systems utilizing surface water or to develop a Wellhead Protection Program for those systems that use groundwater sources.
- Applications are to be postmarked or delivered by June 15 annually.
- More grant information: www.michigan.gov/whp

MI Clean Water Funding

Funding Resources:

- www.michigan.gov/eglegrantsandloans
- www.michigan.gov/DWSRF

Poll Question 3

Online Drinking Water Concern System

- The [Office of the Clean Water Public Advocate](#) hosts the new [online Drinking Water Concern System](#)
- One of the primary responsibilities outlined in EO 2019-06 was the need to establish a statewide drinking water reporting system to collect and analyze drinking water quality concerns received by EGLE.
- EGLE online drinking water concern system launched October 2020.
- The online system will provide Michigan residents an additional channel to submit water quality concerns to EGLE or their Local Health Department (LHD).

Important Reminders for Supplies

Important Certification Due Dates

Risk Assessment

Population served $\geq 100,000$	Population served 50,000-99,999	Population served 3,301-49,999
March 31, 2020	December 31, 2020	June 30, 2021

ERP

- Certify ERP not later than 6 months after completion of the risk assessment

2020 DRINKING WATER INFRASTRUCTURE NEEDS SURVEY AND ASSESSMENTS (DWINSA)

- The pandemic led to rollout delays from EPA
- DWINSA Surveys were emailed to water supplies earlier this week
- DWINSA Survey forms will also be mailed directly to water supplies from EGLE.
- Completed DWINSA surveys need to be submitted back to EGLE for review and submission to EPA.
 - 1st Target: To have 1/3 of the completed DWINSA returned to EGLE by February 28, 2021

PFAS Rules Update

- PFAS drinking water rules took effect August 3, 2020
- Rules establish maximum contaminant levels (MCLs) and corresponding requirements for 7 PFAS compounds
- Rules apply to community and nontransient noncommunity water supplies
- Initial monitoring is underway
 - Initial quarterly monitoring period ended 12/31/2020
 - Initial 6-month monitoring period ends 2/3/2021

PFAS Rules Update (cont.)

- EGLE and DHHS are working with water supplies whose PFAS results are at a level of concern
- Visit Michigan.gov/PFASDrinkingWaterRules for:
 - Rule information and overview documents
 - Certified laboratory lists
 - Sampling procedure documents and video

Federal LCRR

- Federal Lead and Copper Rule Revisions published Jan 15, 2021
- Generally, supplies must comply with new requirements by January 16, 2024 (3 years from publication date)
- Timeline for Michigan Rule Changes
 - Within 3 Years of January 15, 2021
 - Stakeholder Meetings
 - New Administration
- Key Differences
 - School/daycare testing, trigger level, sampling, tiering criteria, find-and-fix, small system flexibility, outreach
- For now, supplies should **continue following current Michigan Lead and Copper Rule requirements**

Q&A Session

- Submit questions using the "Question" box in your Go To Webinar tool bar.
- Questions will be compiled and posted to the Community Water COVID-19 website as a Q&A document.
- Between meetings, general programmatic questions/issues can be sent to:
EGLE-DWEHD-CWS@Michigan.gov

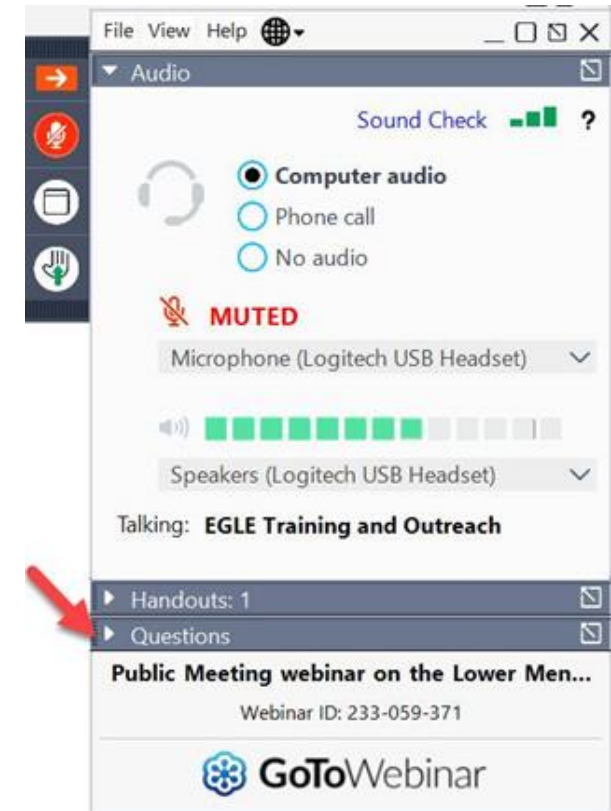

Thank you for tuning in!

- Look for notification of future sessions
- Stay in contact with your district engineer and communicate any challenges you are facing
- Stay safe out there!