



RICK SNYDER  
GOVERNOR

STATE OF MICHIGAN  
DEPARTMENT OF ENVIRONMENTAL QUALITY  
LANSING



KEITH CREAGH  
DIRECTOR

May 23, 2016

Mr. Eli Bromley, Wastewater Technician  
Village of Baldwin Septage Waste Receiving Facility  
P.O. Box 339  
Baldwin, Michigan 49304

Dear Mr. Bromley:

SUBJECT: Village of Baldwin Septage Waste Receiving Facility  
Amended Operating Plan Approval

Review of the Village of Baldwin Septage Waste Receiving Facility (Baldwin), septage waste receiving facility's (SWRF) amended operating plan (plan) by the Department of Environmental Quality (DEQ), Office of Drinking Water and Municipal Assistance (ODWMA) is complete.

The plan is approved and meets the requirements outlined in Section 11715b of Part 117, Septage Waste Servicers, of the Natural Resources and Environmental Protection Act, 1994 PA 451, as amended. The plan will be posted on the Septage Waste Program website at [www.michigan.gov/deqseptage](http://www.michigan.gov/deqseptage).

Be advised that the Baldwin SWRF must operate in accordance with the approved plan. If a change in operations, fee pricing or other conditions is anticipated, please file an amendment to the plan at least 30 days prior to the proposed date for implementation.

If you have any questions regarding this matter, please contact me at 517-780-7874; [campbellm4@michigan.gov](mailto:campbellm4@michigan.gov); or DEQ, ODWMA, 301 E. Louis Glick Highway, Jackson, Michigan 49201-1556.

Sincerely,

Matthew Campbell  
Environmental Quality Specialist  
Septage Waste Program Coordinator  
Environmental Health Section  
Office of Drinking Water  
and Municipal Assistance

cc: Lenn Todd, President of the Village of Baldwin  
Tom Reichard, Environmental Health Director, District Health No. 10  
Janice Heuer, DEQ

## VILLAGE OF BALDWIN WASTEWATER TREATMENT PLANT

### Septage Waster Receiving Facility Operating Plan Revised May 12, 2016

<b>Facility Location:</b>	Baldwin Wastewater Treatment Plant (WWTP) 7514 Grove Street Baldwin, MI 49304
<b>Facility Contact:</b>	Adam Philipp, Operations Specialist Plant Phone: 231-745-9460
<b>Receiving Location:</b>	<b>Primary Location</b> - WWTP EQ tank #1 fine bar screen box. <b>Alternate location</b> - Pump Station at Circle Drive and US-10, 1 mile north of the WWTP.
<b>Hours of Operation:</b>	7:00 AM to 7:00 PM., seven days a week, excluding holidays. Septage receipt is by Permit only, all Permits must be obtained at WWTP, and approved by Operator in advance of arrival at the receiving location.
<b>Waste Categories:</b>	Only trucked domestic septage from licensed haulers is accepted at this facility. <b>Unacceptable wastes</b> include, but are not limited to portable toilet and recreation vehicle waste, food establishment septage, and grease trap waste.
<b>Fee Structure:</b>	Current rate: \$0.05/gallon (\$50 per 1,000 gallons) Rates are subject to change and current rates should be confirmed with the WWTP Operations Specialist.
<b>Service Area:</b>	The primary service area is the area defined as a 15 mile radius from the WWTP (see enclosed Figure 1). The Baldwin WWTP will accept septage waste from outside the 15 mile radius on a case-by-case basis only.
<b>Other Conditions:</b>	Septage acceptance is contingent upon acceptable plant operation and discharge limits. In the interest of protecting the treatment processes and preventing plant overload of organic or inorganic parameters, the WWTP reserves the right to refuse any septage waste without advance notice.
<b>Facility Capacity:</b>	

	Daily Average	Daily Maximum
<b>Hydraulic Loading</b>		
Design Capacity	287,500 gpd	
Current	140,000 gpd	
Reserve	242,500 gpd	237,500 gpd
Septage	9,000 gpd	14,000 gpd
<b>Organic Loading (BOD 5)</b>		
Design Capacity	1,000 lb/day	
Current	175 lb/day	
Safety Factor	335 lb/day	6S lb/day
Septage	490 lb/day	760 lb/day
gpd	gallons per day	
BOD 5	5-day biochemical oxygen demand	
Lb/day	pounds per day	

## VILLAGE OF BALDWIN WASTEWATER TREATMENT PLANT

### Septage Waster Receiving Facility Operating Plan Revised May 12, 2016

#### Septage Solids and Debris Handling:

**Primary site**, septage is fine screened through a 3' by 4' box screen directly into the #1 EQ tank at the WWTP.

**Alternate site**, septage is coarse screened at the pumping station. The wastewater is then pumped to the plant via two submersible wastewater pumps and 10-inch discharge piping. From there, inline macerators reduce the size of the solids before the wastewater enters the Equalization (EQ) tanks.

Heavier solids such as inorganic material settle out in the EQ tanks prior to the wastewater being pumped to the WWTP. Organic and other solids that make it to the sequencing batch reactor. (SBR) process settle out the SBR tank, are collected, and ultimately pumped to the sludge storage tanks.

#### Spill Management:

**Primary** - Tanker truck loads are typically 2,000 to 2,500 gallons. A hauler parks the tanker truck next to the south side of the EQ tanks on the designated driveway. Driver discharges their load by connecting their drain hose to a 4" female camlock connection attached to the fine screen box. This box is mounted on top of the wall in the southwest corner of the #1 EQ tank. Screened septage flows out the bottom of box directly into EQ #1 for entry to the treatment processes. In the event of any mishap, this box is self contained and will overflow into EQ #1 preventing any septage from getting outside its designated containment area. Upon completion of septage discharge, screened material generated from an individual load is retrieved by the hauler using an onsite fabricated rake, allowed to dewater in that portion of the screen box, and raked into a designated container for proper disposal offsite.

**Alternate** - A hauler discharges the load directly into the hatch located in the concrete slab overtopping the pumping station wet well. The hose from the truck is placed in the open hatch and the hauler opens the valve discharge septage at the controlled rate. As mentioned above, the pumping station has been retrofitted with a screen of ¼-inch diameter openings. Screening generated from an individual load are retrieved by the hauler using an onsite fabricated rake, are bagged, and then taken offsite by the hauler for proper disposal.

Figure 2 shows the proposed containment area for unloading septage. The entrance road to the pumping station is asphalt, approximately 12 feet wide. Adjacent to the wet well, two asphalt curbs, approximately 6 inches in height and approximately 40 feet apart, will be constructed. The existing road edges between an unloading tanker truck of approximately 1,800 gallons. Both curbs are ramped such that an easy diameter catch basin will be located within this curbed area and used to collect and pump clean storm water which to pump in the event of a major spill. The likelihood of the tanker losing its entire load is remote. At the hatch, the end of the of the truck's discharge hose is placed on top of the screen and the hatch provides enough weight to secure the pipe from moving. Minor spills from everyday unloading will be periodically washed into the catch basin and pumped to the wet well.

#### Public Notice:

The enclosed public notices were published in the local newspaper, *Lake County Star*, on March 5 and 12, 2009 with identical notices published again March 19 and 26, 2009. The comment period was open through April 17, 2009. Any comments received were forwarded to the Michigan Department of Environmental Quality (MDEQ).

Copies of the enclosed Letter of Notification were sent on February 3, 2009, to the following authorities located within the service area. The comment period was open for 30 days. Any comments received were forwarded to the MDEQ.

**Campbell, Matthew (DEQ)**

---

**From:** Heuer, Janice (DEQ)  
**Sent:** Tuesday, May 03, 2016 3:40 PM  
**To:** 'bromleyeli@gmail.com'; Campbell, Matthew (DEQ)  
**Subject:** baldwin septage receiving

I'm writing to document that the DEQ Cadillac District Office will not be requiring a Part 41 for the septage receiving changes at the Village of Baldwin Wastewater Treatment plant. The project will not require changes to the treatment process and will discharge into existing facilities. Thank you for your attention to these matters.

# **VILLAGE OF BALDWIN WASTEWATER TREATMENT PLANT**

## **Septage Waste Receiving Facility Operating Plan**

### Village/Townships

- Village of Baldwin - 887 East Seventh Street, P.O. Box 339, Baldwin, MI 49304
- Cherry Valley Township - 5850 South Kings Highway, Chase, MI 49304
- Home Township - 11253 North Walnut Avenue, Bitely, MI 49309
- Lake Township - 15580 South Star Lake Drive, Baldwin, MI 49304
- Lilley Township - 10722 North Bingham Avenue, Bitely, MI 49309
- Pleasant Plains Township - 885 Eighth Street, Baldwin, MI 49304
- Sweetwater Township - 9991 West Wingleton Road, Branch, MI 49402
- Troy Township - 10350 North Dickenson Avenue, Walkerville, MI 49459
- Webber Township - 2286 West Springtime Street, Baldwin, MI 49304
- Yates Township - 473 East Baldwin, P.O. Box 115, Idlewild, MI 49642



Thursday, March 5, 2009

LAKE COUNTY STAR

**ADVERTISE HERE!**  
Call your local Media  
Consultant today!!

## Village of Baldwin PUBLIC NOTICE

The Village of Baldwin Wastewater Treatment Plant has been required to develop a Septage Waste Receiving Facility Operating Plan because it accepts hauled septage waste. A copy of this plan is available for review at the Treatment Plant, 7544 Grove Street in Baldwin, between 8 am and 4 pm, M-F. Written comments will be accepted until April 17, 2009 at the following address:

Baldwin Village Hall  
P.O. Box 339  
Baldwin, MI 49304

## MICHIGAN DEPARTMENT OF NATURAL RESOURCES STATE NATURAL RIVER ZONING REVIEW BOARD WEBB TOWNSHIP RIVER

### NOTICE OF VARIANCE APPLICATIONS

Notice is hereby given that any application for a variance from the Webb Township River Zoning Ordinance will be considered by the Zoning Review Board.

Application to: Mark McKeon, 11515 14th Ave.

Property Address: 4581 West Main Street, Suite 101

Proposed Action: To use the property for a retail store.

The Zoning Review Board will hold a public hearing on the application for a variance from the Webb Township River Zoning Ordinance on the following date and time: **Monday, March 16, 2009, 7:00 PM**. The hearing will be held at the Webb Township Board Room, 11515 14th Ave., Baldwin, MI 49304. The purpose of the hearing is to allow the public to express their views on the application for a variance from the Webb Township River Zoning Ordinance.

### For the record:

1. A 192-foot long building with a total area of 11,500 square feet, located at 4581 West Main Street, Suite 101, Baldwin, MI 49304. The building is currently used as a retail store.
2. A variance is being requested from the Webb Township River Zoning Ordinance, which requires that buildings along the river be used for residential purposes only.
3. A variance is being requested from the Webb Township River Zoning Ordinance, which requires that buildings along the river be used for residential purposes only.

The variance is being requested from the Webb Township River Zoning Ordinance, which requires that buildings along the river be used for residential purposes only.

1. A variance is being requested from the Webb Township River Zoning Ordinance, which requires that buildings along the river be used for residential purposes only.
2. A variance is being requested from the Webb Township River Zoning Ordinance, which requires that buildings along the river be used for residential purposes only.

The variance is being requested from the Webb Township River Zoning Ordinance, which requires that buildings along the river be used for residential purposes only.

1. A variance is being requested from the Webb Township River Zoning Ordinance, which requires that buildings along the river be used for residential purposes only.
2. A variance is being requested from the Webb Township River Zoning Ordinance, which requires that buildings along the river be used for residential purposes only.

The variance is being requested from the Webb Township River Zoning Ordinance, which requires that buildings along the river be used for residential purposes only.

1. A variance is being requested from the Webb Township River Zoning Ordinance, which requires that buildings along the river be used for residential purposes only.
2. A variance is being requested from the Webb Township River Zoning Ordinance, which requires that buildings along the river be used for residential purposes only.

The variance is being requested from the Webb Township River Zoning Ordinance, which requires that buildings along the river be used for residential purposes only.

1. A variance is being requested from the Webb Township River Zoning Ordinance, which requires that buildings along the river be used for residential purposes only.
2. A variance is being requested from the Webb Township River Zoning Ordinance, which requires that buildings along the river be used for residential purposes only.

The variance is being requested from the Webb Township River Zoning Ordinance, which requires that buildings along the river be used for residential purposes only.

1. A variance is being requested from the Webb Township River Zoning Ordinance, which requires that buildings along the river be used for residential purposes only.
2. A variance is being requested from the Webb Township River Zoning Ordinance, which requires that buildings along the river be used for residential purposes only.

The variance is being requested from the Webb Township River Zoning Ordinance, which requires that buildings along the river be used for residential purposes only.

1. A variance is being requested from the Webb Township River Zoning Ordinance, which requires that buildings along the river be used for residential purposes only.
2. A variance is being requested from the Webb Township River Zoning Ordinance, which requires that buildings along the river be used for residential purposes only.

The variance is being requested from the Webb Township River Zoning Ordinance, which requires that buildings along the river be used for residential purposes only.

1. A variance is being requested from the Webb Township River Zoning Ordinance, which requires that buildings along the river be used for residential purposes only.
2. A variance is being requested from the Webb Township River Zoning Ordinance, which requires that buildings along the river be used for residential purposes only.

The variance is being requested from the Webb Township River Zoning Ordinance, which requires that buildings along the river be used for residential purposes only.

1. A variance is being requested from the Webb Township River Zoning Ordinance, which requires that buildings along the river be used for residential purposes only.
2. A variance is being requested from the Webb Township River Zoning Ordinance, which requires that buildings along the river be used for residential purposes only.

The variance is being requested from the Webb Township River Zoning Ordinance, which requires that buildings along the river be used for residential purposes only.

1. A variance is being requested from the Webb Township River Zoning Ordinance, which requires that buildings along the river be used for residential purposes only.
2. A variance is being requested from the Webb Township River Zoning Ordinance, which requires that buildings along the river be used for residential purposes only.

The variance is being requested from the Webb Township River Zoning Ordinance, which requires that buildings along the river be used for residential purposes only.

# Girl Scouts enjoy educational opportunity

**GRAND RAPIDS** — In this historic era of women's political leadership, Girl Scouts of Michigan Shave to Shine and The White House Project are joining forces to educate young women about the skills needed to run for elected office and explore the campaign trail leading to the White House.

Participants will hear from local women leaders about their own paths and will leave the training with an action plan and a campaign plan as well as a My President Girl Scout patch. The \$3 registration fee includes the patch, training supplies and snacks.

The five-hour training across educational topics about the history of women's leadership, build the skills needed to run for elected office and explore the campaign trail leading to the White House.

Participants will hear from local women leaders about their own paths and will leave the training with an action plan and a campaign plan as well as a My President Girl Scout patch. The \$3 registration fee includes the patch, training supplies and snacks.

Training will be provided for

potential female Presidential candidates eligible to run for office in the year 2012 and beyond, as well as young women planning to lead a political life from 1 to 5 p.m. on Saturday, March 7, at Faith United Church of Christ, 3290 Walker Avenue, Grand Rapids.

The My President Run for Shave to Shine workshop presented by Girl Scouts of Michigan Shave to Shine and The White House Project.

Girl Scouts of Michigan Shave to Shine provides a girl-centered, fun-filled quality leadership experience in partnership with Shave to Shine that marks the arrival of a new fast-changing world and ensures a lifelong connection with Girl Scouts. Through 50 counties in Western and Northern Michigan, GSMTS partners with community and industry to Girl Scout principles of inclusion and diversity to serve as the primary organization for girls.

The White House Project, a national nonpartisan political organization, works to advance a richly diverse, critical mass of women with leadership positions on to and including the U.S. Presidency. For more information please visit: www.whitehouseproject.org.

## PUBLIC HEARING

The Intermodal Surface Transportation Efficiency Local Task Force for Lake County will meet on March 18, 2009 at 9:00 a.m. in the conference room of the Village Hall in Baldwin at 620 Washington St. in Baldwin, MI.

Projects using Surface Package funds will be discussed and prioritized. Please submit written comments before March 13, 2009.

Gary Truxton  
Lake County Road Commission  
P.O. Box 790  
Baldwin, MI 49304  
231-745-1866

# NOTICE

Webber Township Planning and Zoning Commission weather guidelines. When Baldwin Schools close because the roads are considered unsafe or impassable, any meeting of the Webber Township Planning and Zoning Commission scheduled for that evening, will be postponed until the following Monday for the same time, effective immediately.

Webber Township Planning & Zoning Commission  
Ruth Riley  
Secretary

## LAKE TOWNSHIP ZONING BOARD OF APPEALS NOTICE OF PUBLIC HEARING

**NAME OF APPLICANT:** City of Baldwin  
**ADDRESS:** 11715 14th Ave., Baldwin, MI 49304  
**ADDRESS OF PROPERTY:** 11715 14th Ave., Baldwin, MI 49304  
**PROPERTY TAX:** 11715 14th Ave., Baldwin, MI 49304  
**HEARING WILL BE HELD AT:** LAKE TOWNSHIP ZONING BOARD OF APPEALS  
**DATE OF HEARING:** March 18, 2009  
**TIME OF HEARING:** 7:00 PM

**TYPE OF VARIANCE:** ZONING VARIANCE  
Applicant is requesting a zoning variance to allow a 16 x 20 foot addition to the existing building at 11715 14th Ave., Baldwin, MI 49304. The applicant is requesting a zoning variance to allow a 16 x 20 foot addition to the existing building at 11715 14th Ave., Baldwin, MI 49304.

**IF YOU ARE NOT ABLE TO ATTEND THIS HEARING AND YOU WISH TO BE HEARD, PLEASE SUBMIT YOUR COMMENTS BY:**

**CONTACT PERSON:** Gary Truxton  
**PHONE:** 231-745-1866  
**EMAIL:** gtruxton@lctrc.com

**COMMENTS MUST BE RECEIVED BY:** March 18, 2009, 5:00 PM

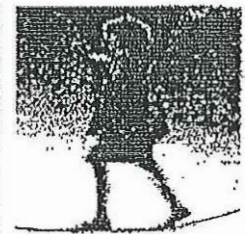

## Don't Put Your Baby's Health On The Line.

It's a common belief that babies are born with a clean slate. But the truth is, many babies are born with health problems that can be prevented or treated early. That's why it's so important to get your baby's health checked out as soon as possible. The good news is, there are many ways to keep your baby healthy and happy. So don't wait. Get your baby's health checked out today.

**Get Medical Care Early**  
**Call 1-800-311-2229**  
**Confidential**

For more information, visit us online at [www.getcareearly.org](http://www.getcareearly.org)

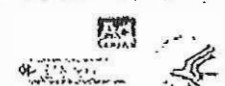



**ftc&h**  
 engineers  
 scientists  
 architects  
 constructors

fishbeck, thompson,  
 carr & huber, inc.

Hard copy is  
 intended to be  
 8.5x11" when  
 plotted. Scale(s)  
 indicated and  
 graphic quality may  
 not be accurate for  
 any other size.

**Village of Baldwin**  
 Baldwin, Michigan  
 Septage Waste Receiving Facility Operating Plan

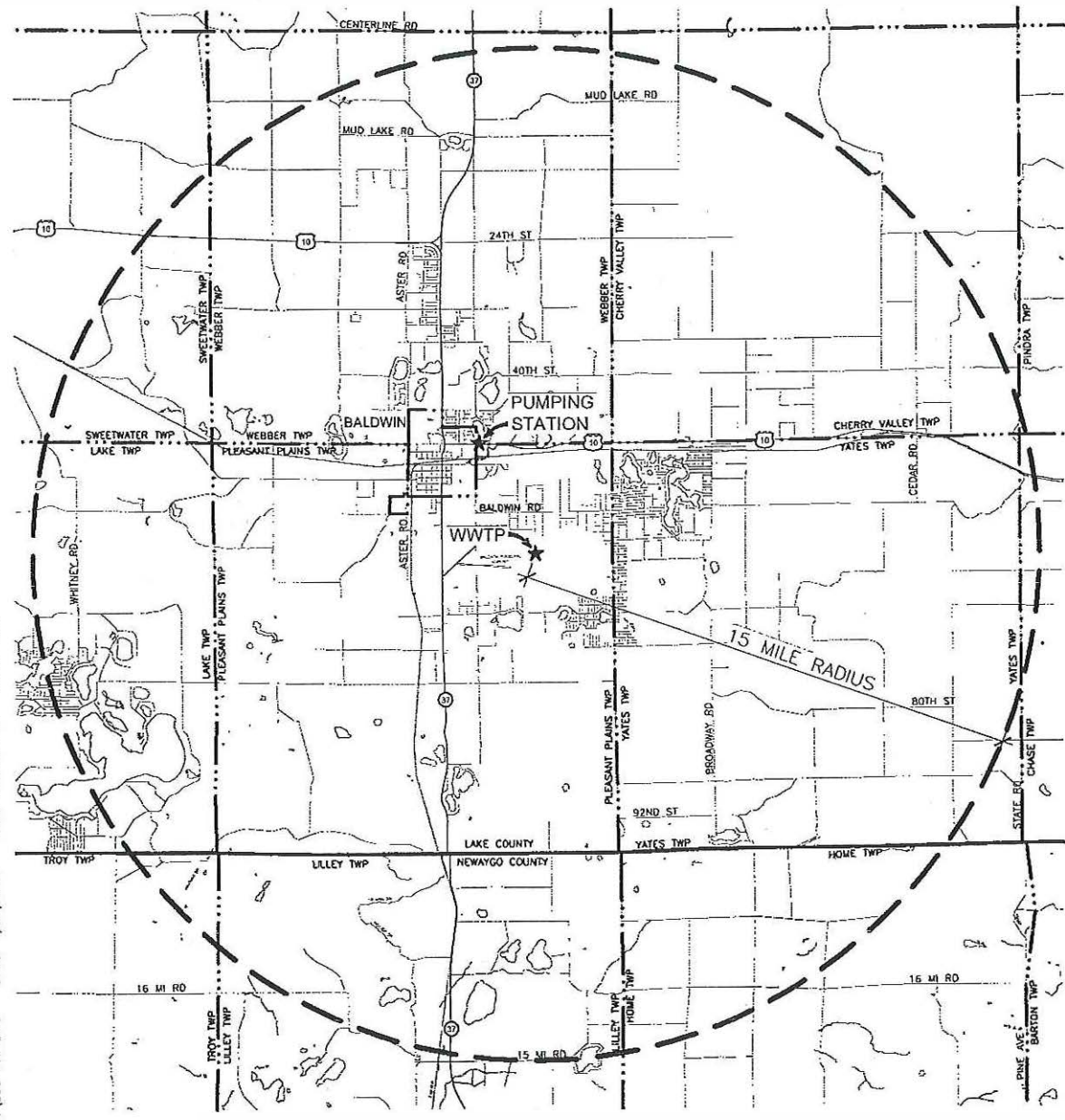

**SERVICE AREA MAP**  
 NO SCALE

PROJECT NO.  
 090129

FIGURE NO.  
**1**

PLOT INFO: N:\080436\SUPPORT\LOC MAP.DWG DATE: 4/27/2009 TIME: 10:40:17 AM USER: RS2  
 ©Copyright 2009 All Rights Reserved



**ftc&h**

engineers  
scientists  
architects  
constructors

fishbeck, thompson,  
carr & huber, inc.

Hard copy is  
intended to be  
8.5"x11" when  
plotted. Scale(s)  
indicated and  
graphic quality may  
not be accurate for  
any other size.

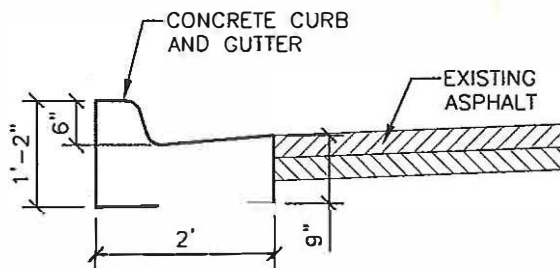

**CONCRETE CURB DETAIL**  
NO SCALE

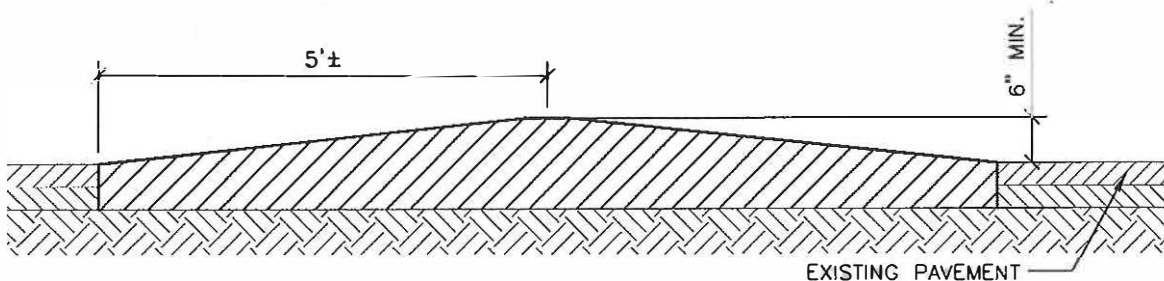

**ASPHALT CURB DETAIL**  
NO SCALE

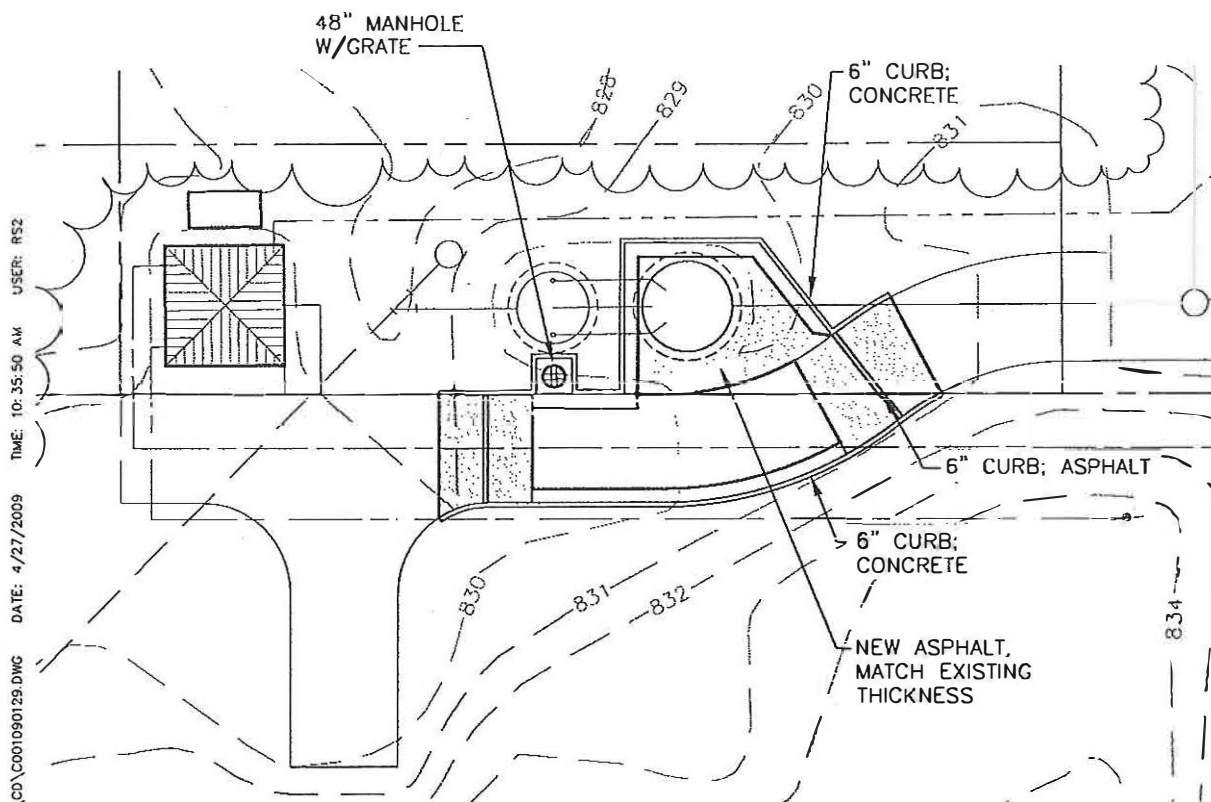

**TRUCK CONTAINMENT AREA**

SCALE: 1" = 20'  
0 10 20

**Village of Baldwin**  
Baldwin, Michigan

Septage Waste Receiving Facility Operating Plan

PROJECT NO.  
090129

FIGURE NO.

**2**

PLOT INFO: U:\CADD\090129\CD\001090129.DWG DATE: 4/27/2009 TIME: 10:35:50 AM USER: RS2