

Former Gelman Property Area

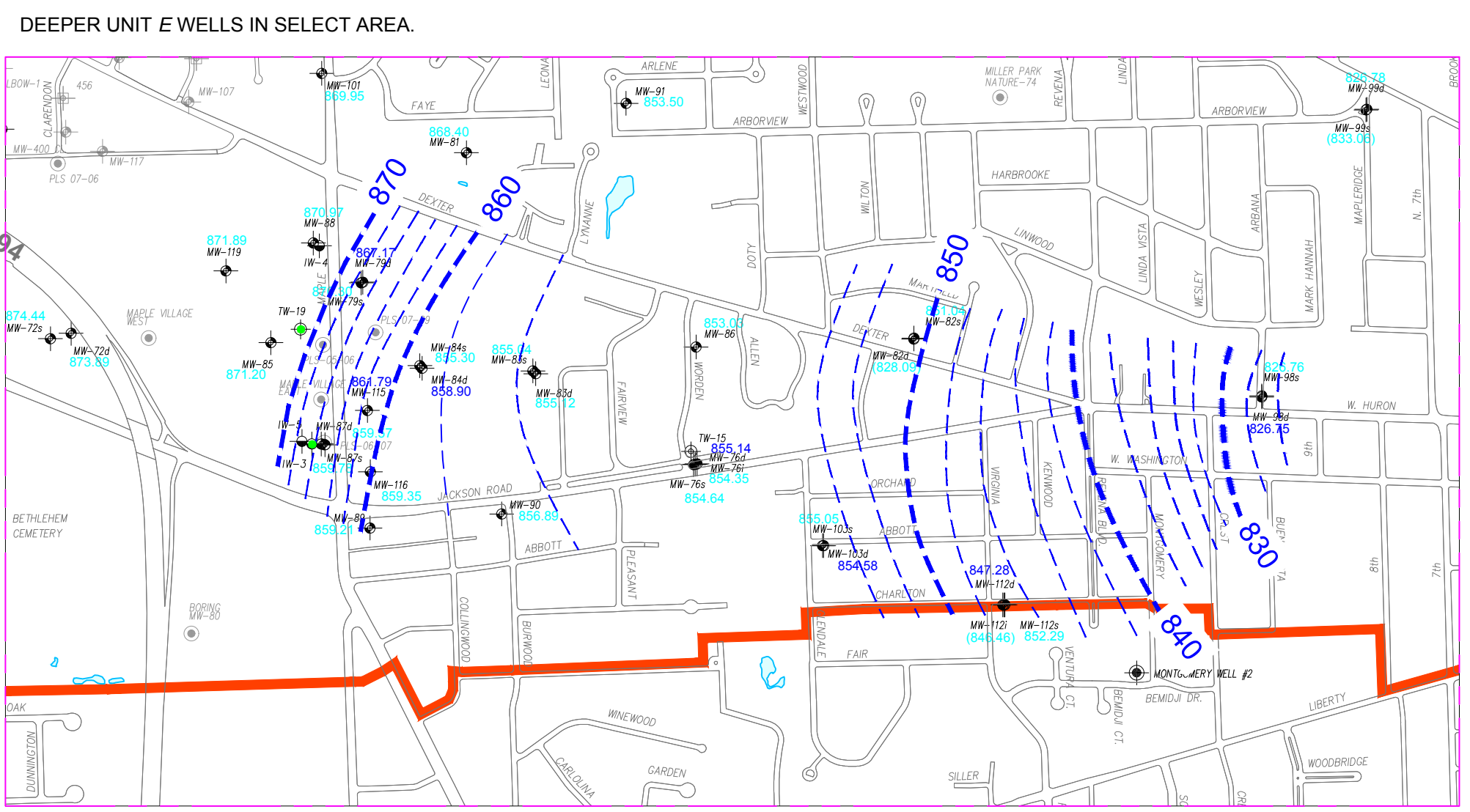

- DEEPER UNIT E POTENTIOMETRIC CONTOUR (SELECTED AREA)
 865.81 - DEEPER UNIT E POTENTIOMETRIC ELEVATION (SELECTED AREA)
 865.81 - UNIT E POTENTIOMETRIC ELEVATION (SELECTED AREA)

LEGEND

- NOTES:
- MAP COMBINES DATA FROM WELLS COMPLETED AT MULTIPLE DEPTHS. INTERPRETATION OF THIS MAP REQUIRES FAMILIARITY WITH THE GEOLOGY AND THE GROUNDWATER FLOW REGIME.
 - POTENTIOMETRIC SURFACE ELEVATION DATA ARE IN FEET NAVD88.
 - DATA COLLECTED SEPTEMBER 21, 2016.
- MONITOR WELL
 - EXTRACTION WELL
 - UNIT E EXTRACTION WELL OPERATING DURING SAMPLING
 - FORMER RESIDENTIAL WELL ROUTINELY MONITORED
 - INJECTION WELL
 - PROHIBITION ZONE (PZ) BOUNDARY
 - UNIT E POTENTIOMETRIC CONTOUR
 - 865.81 - UNIT E POTENTIOMETRIC ELEVATION
 - (858.46) - DATA NOT USED
 - 865.81 - DEEPER UNIT E POTENTIOMETRIC ELEVATION
 - MW-xx - COMPLIANCE MONITOR WELL
 - MW-xx - LITTLE LAKE AREA COMPLIANCE MONITOR WELL

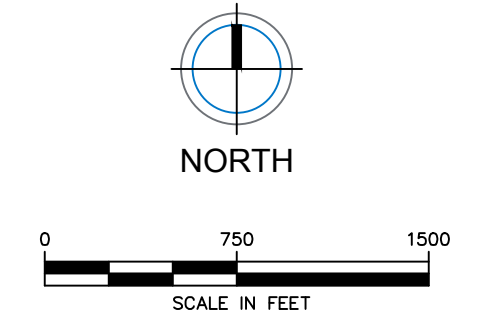

PROJECT MGR.	DATE
JWB	10/17/16
DRAWN BY	DATE
AJP	10/17/16
GEOLOGIST	DATE
AJP	10/17/16
CAD FILE	
(15)1016_E_PSC	
EDIT	
omberp	101416
SCALE	1"=750'
	DRAWING