

# BENONA TOWNSHIP

## HIGH RISK EROSION AREAS & CRITICAL DUNE AREAS

OCEANA COUNTY

T14N,R18W

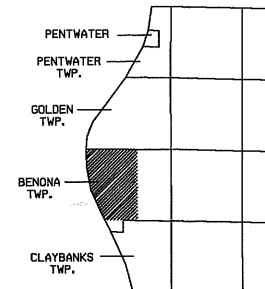

### HIGH RISK EROSION AREAS

THE NUMBER REPRESENTS, IN FEET, THE 30 YEAR PROJECTED RECESSION DISTANCE.  
 THE NUMBER REPRESENTS, IN FEET, THE 60 YEAR PROJECTED RECESSION DISTANCE.

HIGH RISK EROSION AREA (shading alongshore)

THESE AREAS ARE LEGALLY DEFINED BY PART 323, SHORELANDS PROTECTION AND MANAGEMENT, OF THE NATURAL RESOURCE & ENVIRONMENTAL PROTECTION ACT 1994 PA 451 BEING GREAT LAKES SHORELAND AREAS DOCUMENTED TO REcede AN AVERAGE OF ONE FOOT OR MORE PER YEAR.

### CRITICAL DUNE AREAS

BARRIER DUNES  
 BARRIER DUNE FORMATIONS DESIGNATED PURSUANT TO PART 323, SAND DUNE PROTECTION & MANAGEMENT, OF THE NATURAL RESOURCE & ENVIRONMENTAL PROTECTION ACT 1994 PA 451.

AREAS NOT INCLUDED IN DESIGNATED BARRIER DUNE FORMATIONS THAT ARE COMPOSED PRIMARILY OF DUNE SAND AND EXHIBIT SEVERAL DUNE-LIKE CHARACTERISTICS.

EXEMPLARY DUNE ASSOCIATED PLANT COMMUNITIES OUTSIDE DESIGNATED DUNE FORMATIONS. MICHIGAN NATURAL FEATURES INVENTORY REFERENCE CODE INDICATED.

### SOURCE

STATE OF MICHIGAN RECESSION RATE MAPS & ATLAS OF CRITICAL DUNE AREAS

### INFORMATION

MICHIGAN DEPARTMENT OF ENVIRONMENTAL QUALITY  
 LAND AND WATER MANAGEMENT DIVISION  
 P.O. BOX 30458  
 LANSING, MI 48909-7958  
 (517) 373-1950

**GLIS**

GREAT LAKES INFORMATION SYSTEM  
 MICHIGAN DEPARTMENT OF NATURAL RESOURCES  
 LAND AND WATER MANAGEMENT DIVISION

11-04-94  
 Amended 02-29-96

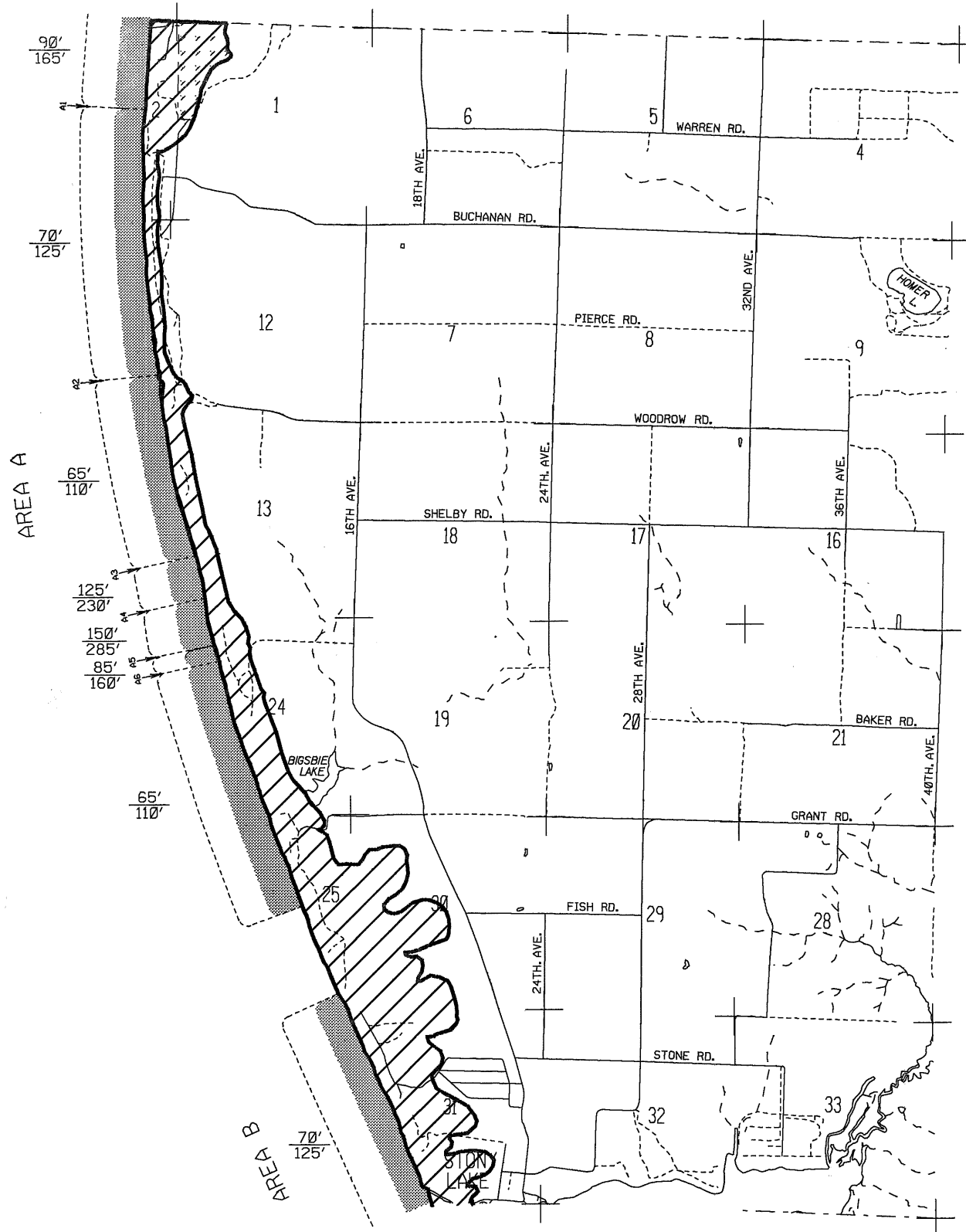
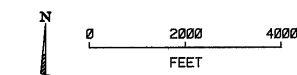

# Parcels in High Risk Erosion Areas of Benona Township, Oceana County

HREAs identified North to South      Date of Designation: November 23, 1994

HREA*	Sequence No.	Parcel Identification Number	Rate (feet/year)	30 yr PRD*	60 yr PRD*
A1	1	64-011-270-001-00	2.5	90	165
A1	2	64-011-270-002-00	2.5	90	165
A1	3	64-011-270-003-00	2.5	90	165
A1	4	64-011-270-004-00	2.5	90	165
A1	5	64-011-270-005-00	2.5	90	165
A1	6	64-011-270-006-00	2.5	90	165
A1	7	64-011-270-007-00	2.5	90	165
A1	8	64-011-270-008-00	2.5	90	165
A1	9	64-011-270-009-00	2.5	90	165
A1	10	64-011-270-010-00	2.5	90	165
A1	11	64-011-270-011-00	2.5	90	165
A1	12	64-011-270-012-00	2.5	90	165
A1	13	64-011-270-013-00	2.5	90	165
A1	14	64-011-102-200-01	2.5	90	165
A1	15	64-011-102-200-03	2.5	90	165
A1	16	64-011-102-200-08 northern 610 feet	2.5	90	165
A1	16.1	64-011-102-200-14	2.5	90	165
A1	17	64-011-102-200-09	2.5	90	165
A1	18	64-011-102-200-10	2.5	90	165

HREA\* - Some parcels may be in multiple HREAs due to their large size.

30 yr PRD\* is the Projected Recession Distance (feet) landward from the Erosion Hazard Line for readily moveable structures including those structures 3,500 square feet or less and built on a basement, crawlspace or pilings. Additional restrictions may apply per Administrative Rules 281.21-22.

60 yr PRD\* is the Projected Recession Distance (feet) landward from the Erosion Hazard Line for non-readily moveable structures such as large structures and septic systems.

**Designation runs with the land including subsequent splits. Absence of a property number does not guarantee the property is located outside of an HREA. Contact the Great Lakes Shorelands Unit, Water Resources Division, DEQ in Lansing or the local DEQ field office for assistance.**

# Parcels in High Risk Erosion Areas of Benona Township, Oceana County

HREAs identified North to South      Date of Designation: November 23, 1994

HREA*	Sequence No.	Parcel Identification Number	Rate (feet/year)	30 yr PRD*	60 yr PRD*
A1	19	64-011-102-200-12	2.5	90	165
A2	20	64-011-102-200-13	1.8	70	125
A2	20.2	64-011-102-200-10 southern 215 feet	1.8	70	125
A2	20.3	64-011-102-200-08 southern 320 feet	1.8	70	125
A2	21	64-011-502-139-00	1.8	70	125
A2	22	64-011-502-138-50	1.8	70	125
A2	23	64-011-502-138-01	1.8	70	125
A2	25	64-011-502-136-50	1.8	70	125
A2	26	64-011-502-136-00	1.8	70	125
A2	27	64-011-502-145-00	1.8	70	125
A2	28	64-011-502-156-00	1.8	70	125
A2	29	64-011-502-132-00	1.8	70	125
A2	30	64-011-502-131-00	1.8	70	125
A2	31	64-011-500-017-00	1.8	70	125
A2	32	64-011-500-016-00	1.8	70	125
A2	33	64-011-500-015-00	1.8	70	125
A2	34	64-011-500-013-00	1.8	70	125
A2	35	64-011-500-012-00	1.8	70	125

HREA\* - Some parcels may be in multiple HREAs due to their large size.

30 yr PRD\* is the Projected Recession Distance (feet) landward from the Erosion Hazard Line for readily moveable structures including those structures 3,500 square feet or less and built on a basement, crawlspace or pilings. Additional restrictions may apply per Administrative Rules 281.21-22.

60 yr PRD\* is the Projected Recession Distance (feet) landward from the Erosion Hazard Line for non-readily moveable structures such as large structures and septic systems.

**Designation runs with the land including subsequent splits. Absence of a property number does not guarantee the property is located outside of an HREA. Contact the Great Lakes Shorelands Unit, Water Resources Division, DEQ in Lansing or the local DEQ field office for assistance.**

# Parcels in High Risk Erosion Areas of Benona Township, Oceana County

HREAs identified North to South      Date of Designation: November 23, 1994

HREA*	Sequence No.	Parcel Identification Number	Rate (feet/year)	30 yr PRD*	60 yr PRD*
A2	36	64-011-500-011-00	1.8	70	125
A2	37	64-011-500-010-00	1.8	70	125
A2	38	64-011-500-008-00	1.8	70	125
A2	39	64-011-500-007-00	1.8	70	125
A2	40	64-011-500-006-00	1.8	70	125
A2	41	64-011-500-005-00	1.8	70	125
A2	42	64-011-500-004-00	1.8	70	125
A2	43	64-011-500-003-00	1.8	70	125
A2	44	64-011-500-002-00	1.8	70	125
A2	45	64-011-500-001-00	1.8	70	125
A2	46	64-011-530-001-00	1.8	70	125
A2	47	64-011-530-002-00	1.8	70	125
A2	48	64-011-530-003-00	1.8	70	125
A2	49	64-011-530-004-00	1.8	70	125
A2	50	64-011-530-006-00	1.8	70	125
A2	51	64-011-530-007-00	1.8	70	125
A2	52	64-011-530-008-00	1.8	70	125
A2	53	64-011-530-009-00	1.8	70	125
A2	53.1	64-011-530-010-00	1.8	70	125

HREA\* - Some parcels may be in multiple HREAs due to their large size.

30 yr PRD\* is the Projected Recession Distance (feet) landward from the Erosion Hazard Line for readily moveable structures including those structures 3,500 square feet or less and built on a basement, crawlspace or pilings. Additional restrictions may apply per Administrative Rules 281.21-22.

60 yr PRD\* is the Projected Recession Distance (feet) landward from the Erosion Hazard Line for non-readily moveable structures such as large structures and septic systems.

**Designation runs with the land including subsequent splits. Absence of a property number does not guarantee the property is located outside of an HREA. Contact the Great Lakes Shorelands Unit, Water Resources Division, DEQ in Lansing or the local DEQ field office for assistance.**

# Parcels in High Risk Erosion Areas of Benona Township, Oceana County

HREAs identified North to South      Date of Designation: November 23, 1994

HREA*	Sequence No.	Parcel Identification Number	Rate (feet/year)	30 yr PRD*	60 yr PRD*
A2	53.11	64-011-530-011-10	1.8	70	125
A2	54	64-011-530-013-00	1.8	70	125
A2	55	64-011-111-100-01	1.8	70	125
A2	55.1	64-011-390-013-00	1.8	70	125
A2	56	64-011-390-012-00	1.8	70	125
A2	57	64-011-390-011-00	1.8	70	125
A2	58	64-011-390-010-00	1.8	70	125
A2	59	64-011-390-009-00	1.8	70	125
A2	60	64-011-390-008-00	1.8	70	125
A2	61	64-011-390-007-00	1.8	70	125
A2	62	64-011-390-006-00	1.8	70	125
A2	64	64-011-390-005-00	1.8	70	125
A2	65	64-011-390-003-00	1.8	70	125
A2	66	64-011-390-002-00	1.8	70	125
A2	67	64-011-390-001-00	1.8	70	125
A3	68	64-011-505-001-00	1.6	65	110
A3	69	64-011-505-002-00	1.6	65	110
A3	70	64-011-505-003-00	1.6	65	110
A3	71	64-011-505-004-00	1.6	65	110

HREA\* - Some parcels may be in multiple HREAs due to their large size.

30 yr PRD\* is the Projected Recession Distance (feet) landward from the Erosion Hazard Line for readily moveable structures including those structures 3,500 square feet or less and built on a basement, crawlspace or pilings. Additional restrictions may apply per Administrative Rules 281.21-22.

60 yr PRD\* is the Projected Recession Distance (feet) landward from the Erosion Hazard Line for non-readily moveable structures such as large structures and septic systems.

**Designation runs with the land including subsequent splits. Absence of a property number does not guarantee the property is located outside of an HREA. Contact the Great Lakes Shorelands Unit, Water Resources Division, DEQ in Lansing or the local DEQ field office for assistance.**

# Parcels in High Risk Erosion Areas of Benona Township, Oceana County

HREAs identified North to South      Date of Designation: November 23, 1994

HREA*	Sequence No.	Parcel Identification Number	Rate (feet/year)	30 yr PRD*	60 yr PRD*
A3	72	64-011-505-005-00	1.6	65	110
A3	73	64-011-505-006-00	1.6	65	110
A3	74	64-011-505-007-00	1.6	65	110
A3	75	64-011-505-009-00	1.6	65	110
A3	76	64-011-505-009-50	1.6	65	110
A3	77	64-011-505-010-00	1.6	65	110
A3	78	64-011-505-011-00	1.6	65	110
A3	79	64-011-505-012-00	1.6	65	110
A3	80	64-011-505-013-00	1.6	65	110
A3	81	64-011-505-014-00	1.6	65	110
A3	82	64-011-505-015-00	1.6	65	110
A3	83	64-011-505-015-50	1.6	65	110
A3	84	64-011-505-017-00	1.6	65	110
A3	85	64-011-350-001-00	1.6	65	110
A3	86	64-011-350-003-00	1.6	65	110
A3	87	64-011-350-005-00	1.6	65	110
A3	88	64-011-350-007-00	1.6	65	110
A3	89	64-011-350-008-00	1.6	65	110
A3	90	64-011-113-100-01	1.6	65	110

HREA\* - Some parcels may be in multiple HREAs due to their large size.

30 yr PRD\* is the Projected Recession Distance (feet) landward from the Erosion Hazard Line for readily moveable structures including those structures 3,500 square feet or less and built on a basement, crawlspace or pilings. Additional restrictions may apply per Administrative Rules 281.21-22.

60 yr PRD\* is the Projected Recession Distance (feet) landward from the Erosion Hazard Line for non-readily moveable structures such as large structures and septic systems.

**Designation runs with the land including subsequent splits. Absence of a property number does not guarantee the property is located outside of an HREA. Contact the Great Lakes Shorelands Unit, Water Resources Division, DEQ in Lansing or the local DEQ field office for assistance.**

# Parcels in High Risk Erosion Areas of Benona Township, Oceana County

HREAs identified North to South      Date of Designation: November 23, 1994

HREA*	Sequence No.	Parcel Identification Number	Rate (feet/year)	30 yr PRD*	60 yr PRD*
A3	91	64-011-540-001-00	1.6	65	110
A3	92	64-011-540-003-00	1.6	65	110
A3	93	64-011-540-004-00	1.6	65	110
A3	94	64-011-113-100-18	1.6	65	110
A3	94.1	64-011-113-100-17	1.6	65	110
A3	94.11	64-011-113-100-23	1.6	65	110
A3	95	64-011-113-100-03	1.6	65	110
A3	96	64-011-113-100-20	1.6	65	110
A3	96.1	64-011-113-100-21	1.6	65	110
A3	97	64-011-113-100-16	1.6	65	110
A3	98	64-011-113-100-13	1.6	65	110
A3	99	64-011-113-100-15	1.6	65	110
A3	100	64-011-113-100-05	1.6	65	110
A3	101	64-011-113-100-10	1.6	65	110
A3	103	64-011-113-100-11	1.6	65	110
A3	104	64-011-113-300-05	1.6	65	110
A4	106	64-011-113-300-05	3.6	125	230
A4	107	64-011-113-300-02	3.6	125	230
A4	108	64-011-400-020-00	3.6	125	230

HREA\* - Some parcels may be in multiple HREAs due to their large size.

30 yr PRD\* is the Projected Recession Distance (feet) landward from the Erosion Hazard Line for readily moveable structures including those structures 3,500 square feet or less and built on a basement, crawlspace or pilings. Additional restrictions may apply per Administrative Rules 281.21-22.

60 yr PRD\* is the Projected Recession Distance (feet) landward from the Erosion Hazard Line for non-readily moveable structures such as large structures and septic systems.

**Designation runs with the land including subsequent splits. Absence of a property number does not guarantee the property is located outside of an HREA. Contact the Great Lakes Shorelands Unit, Water Resources Division, DEQ in Lansing or the local DEQ field office for assistance.**

# Parcels in High Risk Erosion Areas of Benona Township, Oceana County

HREAs identified North to South      Date of Designation: November 23, 1994

HREA*	Sequence No.	Parcel Identification Number	Rate (feet/year)	30 yr PRD*	60 yr PRD*
A5	109	64-011-400-019-00	4.5	150	285
A5	110	64-011-400-018-00	4.5	150	285
A5	111	64-011-400-017-00	4.5	150	285
A5	112	64-011-400-016-00	4.5	150	285
A5	113	64-011-400-015-00	4.5	150	285
A5	114	64-011-400-014-00	4.5	150	285
A5	115	64-011-400-013-00	4.5	150	285
A5	116	64-011-400-012-00	4.5	150	285
A5	117	64-011-400-011-00	4.5	150	285
A5	118	64-011-400-010-00	4.5	150	285
A5	119	64-011-400-009-00	4.5	150	285
A5	120	64-011-400-008-00	4.5	150	285
A5	121	64-011-400-007-00	4.5	150	285
A5	122	64-011-400-006-00	4.5	150	285
A5	123	64-011-400-005-00	4.5	150	285
A5	124	64-011-400-004-00	4.5	150	285
A5	125	64-011-400-002-00	4.5	150	285
A5	126	64-011-400-001-00	4.5	150	285
A5	127	64-011-420-028-00	4.5	150	285

HREA\* - Some parcels may be in multiple HREAs due to their large size.

30 yr PRD\* is the Projected Recession Distance (feet) landward from the Erosion Hazard Line for readily moveable structures including those structures 3,500 square feet or less and built on a basement, crawlspace or pilings. Additional restrictions may apply per Administrative Rules 281.21-22.

60 yr PRD\* is the Projected Recession Distance (feet) landward from the Erosion Hazard Line for non-readily moveable structures such as large structures and septic systems.

**Designation runs with the land including subsequent splits. Absence of a property number does not guarantee the property is located outside of an HREA. Contact the Great Lakes Shorelands Unit, Water Resources Division, DEQ in Lansing or the local DEQ field office for assistance.**



# Parcels in High Risk Erosion Areas of Benona Township, Oceana County

HREAs identified North to South      Date of Designation: November 23, 1994

HREA*	Sequence No.	Parcel Identification Number	Rate (feet/year)	30 yr PRD*	60 yr PRD*
A5	128	64-011-420-027-00	4.5	150	285
A5	129	64-011-420-027-20	4.5	150	285
A5	130	64-011-420-027-30	4.5	150	285
A5	131	64-011-420-026-00	4.5	150	285
A5	132	64-011-420-025-00	4.5	150	285
A5	133	64-011-420-024-00	4.5	150	285
A5	134	64-011-420-023-00	4.5	150	285
A5	135	64-011-420-022-00	4.5	150	285
A5	136	64-011-420-021-00	4.5	150	285
A5	137	64-011-420-020-00	4.5	150	285
A5	138	64-011-420-019-00	4.5	150	285
A6	139	64-011-420-018-00	2.4	85	160
A6	140	64-011-420-017-00	2.4	85	160
A6	141	64-011-420-016-00	2.4	85	160
A6	142	64-011-420-015-00	2.4	85	160
A6	143	64-011-420-014-00	2.4	85	160
A7	144	64-011-420-012-00	1.6	65	110
A7	145	64-011-420-011-00	1.6	65	110
A7	146	64-011-420-010-00	1.6	65	110

HREA\* - Some parcels may be in multiple HREAs due to their large size.

30 yr PRD\* is the Projected Recession Distance (feet) landward from the Erosion Hazard Line for readily moveable structures including those structures 3,500 square feet or less and built on a basement, crawlspace or pilings. Additional restrictions may apply per Administrative Rules 281.21-22.

60 yr PRD\* is the Projected Recession Distance (feet) landward from the Erosion Hazard Line for non-readily moveable structures such as large structures and septic systems.

**Designation runs with the land including subsequent splits. Absence of a property number does not guarantee the property is located outside of an HREA. Contact the Great Lakes Shorelands Unit, Water Resources Division, DEQ in Lansing or the local DEQ field office for assistance.**

# Parcels in High Risk Erosion Areas of Benona Township, Oceana County

HREAs identified North to South      Date of Designation: November 23, 1994

HREA*	Sequence No.	Parcel Identification Number	Rate (feet/year)	30 yr PRD*	60 yr PRD*
A7	147	64-011-420-007-00	1.6	65	110
A7	148	64-011-420-005-00	1.6	65	110
A7	149	64-011-420-004-00	1.6	65	110
A7	150	64-011-420-003-00	1.6	65	110
A7	151	64-011-420-002-00	1.6	65	110
A7	152	64-011-420-001-00	1.6	65	110
A7	153	64-011-620-001-00	1.6	65	110
A7	154	64-011-620-002-00	1.6	65	110
A7	155	64-011-620-003-00	1.6	65	110
A7	156	64-011-620-004-00	1.6	65	110
A7	157	64-011-620-005-00	1.6	65	110
A7	158	64-011-620-006-00	1.6	65	110
A7	159	64-011-620-007-00	1.6	65	110
A7	160	64-011-620-008-00	1.6	65	110
A7	161	64-011-620-009-00	1.6	65	110
A7	162	64-011-620-010-00	1.6	65	110
A7	163	64-011-620-011-00	1.6	65	110
A7	164	64-011-620-012-00	1.6	65	110
A7	165	64-011-620-013-00	1.6	65	110

HREA\* - Some parcels may be in multiple HREAs due to their large size.

30 yr PRD\* is the Projected Recession Distance (feet) landward from the Erosion Hazard Line for readily moveable structures including those structures 3,500 square feet or less and built on a basement, crawlspace or pilings. Additional restrictions may apply per Administrative Rules 281.21-22.

60 yr PRD\* is the Projected Recession Distance (feet) landward from the Erosion Hazard Line for non-readily moveable structures such as large structures and septic systems.

**Designation runs with the land including subsequent splits. Absence of a property number does not guarantee the property is located outside of an HREA. Contact the Great Lakes Shorelands Unit, Water Resources Division, DEQ in Lansing or the local DEQ field office for assistance.**

# Parcels in High Risk Erosion Areas of Benona Township, Oceana County

HREAs identified North to South      Date of Designation: November 23, 1994

HREA*	Sequence No.	Parcel Identification Number	Rate (feet/year)	30 yr PRD*	60 yr PRD*
A7	166	64-011-620-014-00	1.6	65	110
A7	167	64-011-124-300-02	1.6	65	110
A7	168	64-011-430-001-00	1.6	65	110
A7	169	64-011-430-002-00	1.6	65	110
A7	170	64-011-430-003-00	1.6	65	110
A7	171	64-011-430-004-00	1.6	65	110
A7	172	64-011-430-005-00	1.6	65	110
A7	173	64-011-430-006-00	1.6	65	110
A7	174	64-011-430-007-00	1.6	65	110
A7	175	64-011-430-008-00	1.6	65	110
A7	176	64-011-430-009-00	1.6	65	110
A7	177	64-011-430-010-00	1.6	65	110
A7	177.1	64-011-430-011-00	1.6	65	110
A7	178	64-011-430-012-00	1.6	65	110
A7	179	64-011-430-013-00	1.6	65	110
A7	180	64-011-430-014-00	1.6	65	110
A7	181	64-011-430-015-00	1.6	65	110
A7	182	64-011-430-016-00	1.6	65	110
A7	183	64-011-430-017-00	1.6	65	110

HREA\* - Some parcels may be in multiple HREAs due to their large size.

30 yr PRD\* is the Projected Recession Distance (feet) landward from the Erosion Hazard Line for readily moveable structures including those structures 3,500 square feet or less and built on a basement, crawlspace or pilings. Additional restrictions may apply per Administrative Rules 281.21-22.

60 yr PRD\* is the Projected Recession Distance (feet) landward from the Erosion Hazard Line for non-readily moveable structures such as large structures and septic systems.

**Designation runs with the land including subsequent splits. Absence of a property number does not guarantee the property is located outside of an HREA. Contact the Great Lakes Shorelands Unit, Water Resources Division, DEQ in Lansing or the local DEQ field office for assistance.**

# Parcels in High Risk Erosion Areas of Benona Township, Oceana County

HREAs identified North to South      Date of Designation: November 23, 1994

HREA*	Sequence No.	Parcel Identification Number	Rate (feet/year)	30 yr PRD*	60 yr PRD*
A7	184	64-011-430-018-00	1.6	65	110
A7	185	64-011-430-019-00	1.6	65	110
A7	186	64-011-430-020-00	1.6	65	110
A7	186.1	64-011-430-021-00	1.6	65	110
A7	187	64-011-430-022-00	1.6	65	110
A7	188	64-011-430-023-00	1.6	65	110
A7	189	64-011-430-024-00	1.6	65	110
A7	190	64-011-430-025-00	1.6	65	110
A7	191	64-011-430-026-00	1.6	65	110
A7	192	64-011-430-027-00	1.6	65	110
A7	193	64-011-430-029-00	1.6	65	110
A7	194	64-011-430-030-00	1.6	65	110
A7	195	64-011-430-031-00	1.6	65	110
A7	196	64-011-430-032-00	1.6	65	110
A7	197	64-011-430-033-00	1.6	65	110
A7	198	64-011-430-034-00	1.6	65	110
A7	199	64-011-430-035-00	1.6	65	110
A7	200	64-011-430-037-00	1.6	65	110
A7	201	64-011-430-038-00	1.6	65	110

HREA\* - Some parcels may be in multiple HREAs due to their large size.

30 yr PRD\* is the Projected Recession Distance (feet) landward from the Erosion Hazard Line for readily moveable structures including those structures 3,500 square feet or less and built on a basement, crawlspace or pilings. Additional restrictions may apply per Administrative Rules 281.21-22.

60 yr PRD\* is the Projected Recession Distance (feet) landward from the Erosion Hazard Line for non-readily moveable structures such as large structures and septic systems.

**Designation runs with the land including subsequent splits. Absence of a property number does not guarantee the property is located outside of an HREA. Contact the Great Lakes Shorelands Unit, Water Resources Division, DEQ in Lansing or the local DEQ field office for assistance.**

# Parcels in High Risk Erosion Areas of Benona Township, Oceana County

HREAs identified North to South      Date of Designation: November 23, 1994

HREA*	Sequence No.	Parcel Identification Number	Rate (feet/year)	30 yr PRD*	60 yr PRD*
A7	202	64-011-430-039-00	1.6	65	110
A7	203	64-011-430-040-00	1.6	65	110
A7	204	64-011-430-041-00	1.6	65	110
A7	204.1	64-011-430-042-00	1.6	65	110
A7	205	64-011-430-043-00	1.6	65	110
A7	206	64-011-430-044-00	1.6	65	110
A7	207	64-011-430-045-00	1.6	65	110
A7	208	64-011-430-046-00	1.6	65	110
A7	209	64-011-430-047-00	1.6	65	110
A7	210	64-011-430-048-00	1.6	65	110
A7	211	64-011-430-049-00	1.6	65	110
A7	211.1	64-011-430-050-00	1.6	65	110
A7	212	64-011-430-051-00	1.6	65	110
A7	214	64-011-430-053-00	1.6	65	110
A7	215	64-011-430-054-00	1.6	65	110
A7	216	64-011-430-055-00	1.6	65	110
A7	217	64-011-430-056-00	1.6	65	110
A7	218	64-011-430-057-00	1.6	65	110
A7	219	64-011-430-058-00	1.6	65	110

HREA\* - Some parcels may be in multiple HREAs due to their large size.

30 yr PRD\* is the Projected Recession Distance (feet) landward from the Erosion Hazard Line for readily moveable structures including those structures 3,500 square feet or less and built on a basement, crawlspace or pilings. Additional restrictions may apply per Administrative Rules 281.21-22.

60 yr PRD\* is the Projected Recession Distance (feet) landward from the Erosion Hazard Line for non-readily moveable structures such as large structures and septic systems.

**Designation runs with the land including subsequent splits. Absence of a property number does not guarantee the property is located outside of an HREA. Contact the Great Lakes Shorelands Unit, Water Resources Division, DEQ in Lansing or the local DEQ field office for assistance.**

# Parcels in High Risk Erosion Areas of Benona Township, Oceana County

HREAs identified North to South      Date of Designation: November 23, 1994

HREA*	Sequence No.	Parcel Identification Number	Rate (feet/year)	30 yr PRD*	60 yr PRD*
A7	220	64-011-430-060-00	1.6	65	110
A7	221	64-011-430-062-00	1.6	65	110
B1	222	64-011-030-300-03	1.8	70	125
B1	223	64-011-030-300-04	1.8	70	125
B1	223.1	64-011-030-300-06	1.8	70	125
B1	224	64-011-030-300-05	1.8	70	125
B1	225	64-011-411-277-00	1.8	70	125
B1	226	64-011-411-276-00	1.8	70	125
B1	227	64-011-411-275-00	1.8	70	125
B1	228	64-011-411-274-00	1.8	70	125
B1	229	64-011-411-273-00	1.8	70	125
B1	230	64-011-411-272-00	1.8	70	125
B1	231	64-011-411-271-00	1.8	70	125
B1	232	64-011-411-270-00	1.8	70	125
B1	233	64-011-411-269-00	1.8	70	125
B1	234	64-011-411-268-00	1.8	70	125
B1	235	64-011-411-267-00	1.8	70	125
B1	236	64-011-411-266-00	1.8	70	125
B1	237	64-011-411-265-00	1.8	70	125

HREA\* - Some parcels may be in multiple HREAs due to their large size.

30 yr PRD\* is the Projected Recession Distance (feet) landward from the Erosion Hazard Line for readily moveable structures including those structures 3,500 square feet or less and built on a basement, crawlspace or pilings. Additional restrictions may apply per Administrative Rules 281.21-22.

60 yr PRD\* is the Projected Recession Distance (feet) landward from the Erosion Hazard Line for non-readily moveable structures such as large structures and septic systems.

**Designation runs with the land including subsequent splits. Absence of a property number does not guarantee the property is located outside of an HREA. Contact the Great Lakes Shorelands Unit, Water Resources Division, DEQ in Lansing or the local DEQ field office for assistance.**

# Parcels in High Risk Erosion Areas of Benona Township, Oceana County

HREAs identified North to South      Date of Designation: November 23, 1994

HREA*	Sequence No.	Parcel Identification Number	Rate (feet/year)	30 yr PRD*	60 yr PRD*
B1	238	64-011-411-264-00	1.8	70	125
B1	239	64-011-411-263-00	1.8	70	125
B1	240	64-011-411-262-00	1.8	70	125
B1	241	64-011-411-261-00	1.8	70	125
B1	242	64-011-411-259-00	1.8	70	125
B1	243	64-011-411-258-00	1.8	70	125
B1	244	64-011-411-257-00	1.8	70	125
B1	245	64-011-410-022-00	1.8	70	125
B1	246	64-011-410-021-00	1.8	70	125
B1	247	64-011-410-020-00	1.8	70	125
B1	248	64-011-410-018-00	1.8	70	125
B1	249	64-011-410-017-00	1.8	70	125
B1	250	64-011-410-015-00	1.8	70	125
B1	251	64-011-410-014-00	1.8	70	125
B1	252	64-011-410-013-00	1.8	70	125
B1	253	64-011-410-012-00	1.8	70	125
B1	254	64-011-410-011-00	1.8	70	125
B1	255	64-011-410-010-00	1.8	70	125
B1	256	64-011-410-009-00	1.8	70	125

HREA\* - Some parcels may be in multiple HREAs due to their large size.

30 yr PRD\* is the Projected Recession Distance (feet) landward from the Erosion Hazard Line for readily moveable structures including those structures 3,500 square feet or less and built on a basement, crawlspace or pilings. Additional restrictions may apply per Administrative Rules 281.21-22.

60 yr PRD\* is the Projected Recession Distance (feet) landward from the Erosion Hazard Line for non-readily moveable structures such as large structures and septic systems.

**Designation runs with the land including subsequent splits. Absence of a property number does not guarantee the property is located outside of an HREA. Contact the Great Lakes Shorelands Unit, Water Resources Division, DEQ in Lansing or the local DEQ field office for assistance.**

# Parcels in High Risk Erosion Areas of Benona Township, Oceana County

HREAs identified North to South      Date of Designation: November 23, 1994

HREA*	Sequence No.	Parcel Identification Number	Rate (feet/year)	30 yr PRD*	60 yr PRD*
B1	257	64-011-410-008-00	1.8	70	125
B1	258	64-011-410-007-00	1.8	70	125
B1	259	64-011-410-006-00	1.8	70	125
B1	260	64-011-410-004-00	1.8	70	125
B1	261	64-011-410-003-00	1.8	70	125
B1	262	64-011-410-002-00	1.8	70	125
B1	263	64-011-410-001-00 parcel not mapped in GIS	1.8	70	125
B1	263.1	64-011-410-044-01	1.8	70	125
B1	264	64-011-480-014-00	1.8	70	125
B1	265	64-011-480-013-00	1.8	70	125
B1	266	64-011-480-012-00	1.8	70	125
B1	267	64-011-480-011-00	1.8	70	125
B1	268	64-011-480-010-00	1.8	70	125
B1	269	64-011-480-009-00	1.8	70	125
B1	270	64-011-480-008-00	1.8	70	125
B1	271	64-011-480-007-00	1.8	70	125
B1	272	64-011-480-006-00	1.8	70	125
B1	273	64-011-480-005-00	1.8	70	125
B1	274	64-011-480-004-00	1.8	70	125

HREA\* - Some parcels may be in multiple HREAs due to their large size.

30 yr PRD\* is the Projected Recession Distance (feet) landward from the Erosion Hazard Line for readily moveable structures including those structures 3,500 square feet or less and built on a basement, crawlspace or pilings. Additional restrictions may apply per Administrative Rules 281.21-22.

60 yr PRD\* is the Projected Recession Distance (feet) landward from the Erosion Hazard Line for non-readily moveable structures such as large structures and septic systems.

**Designation runs with the land including subsequent splits. Absence of a property number does not guarantee the property is located outside of an HREA. Contact the Great Lakes Shorelands Unit, Water Resources Division, DEQ in Lansing or the local DEQ field office for assistance.**



# Parcels in High Risk Erosion Areas of Benona Township, Oceana County

HREAs identified North to South      Date of Designation: November 23, 1994

HREA*	Sequence No.	Parcel Identification Number	Rate (feet/year)	30 yr PRD*	60 yr PRD*
B1	275	64-011-480-003-00	1.8	70	125
B1	276	64-011-480-002-00	1.8	70	125
B1	277	64-011-480-001-00	1.8	70	125
B1	278	64-011-031-300-11	1.8	70	125
B1	279	64-011-375-004-00	1.8	70	125
B1	280	64-011-375-005-00	1.8	70	125
B1	281	64-011-375-006-00	1.8	70	125
B1	282	64-011-375-007-00	1.8	70	125
B1	283	64-011-375-008-00	1.8	70	125
B1	284	64-011-375-009-00	1.8	70	125
B1	285	64-011-375-010-00	1.8	70	125
B1	286	64-011-375-011-00	1.8	70	125
B1	287	64-011-031-300-02	1.8	70	125
B1	287.1	64-011-206-200-01	1.8	70	125
B1	288	64-011-206-200-02	1.8	70	125
B1	290	64-011-206-200-05 parcel not mapped in GIS	1.8	70	125

HREA\* - Some parcels may be in multiple HREAs due to their large size.

30 yr PRD\* is the Projected Recession Distance (feet) landward from the Erosion Hazard Line for readily moveable structures including those structures 3,500 square feet or less and built on a basement, crawlspace or pilings. Additional restrictions may apply per Administrative Rules 281.21-22.

60 yr PRD\* is the Projected Recession Distance (feet) landward from the Erosion Hazard Line for non-readily moveable structures such as large structures and septic systems.

**Designation runs with the land including subsequent splits. Absence of a property number does not guarantee the property is located outside of an HREA. Contact the Great Lakes Shorelands Unit, Water Resources Division, DEQ in Lansing or the local DEQ field office for assistance.**