

VAN BUREN STATE PARK

COVERT TWP.

COVERT TOWNSHIP

HIGH RISK EROSION AREAS & CRITICAL DUNE AREAS

VAN BUREN COUNTY
T2S,R17W

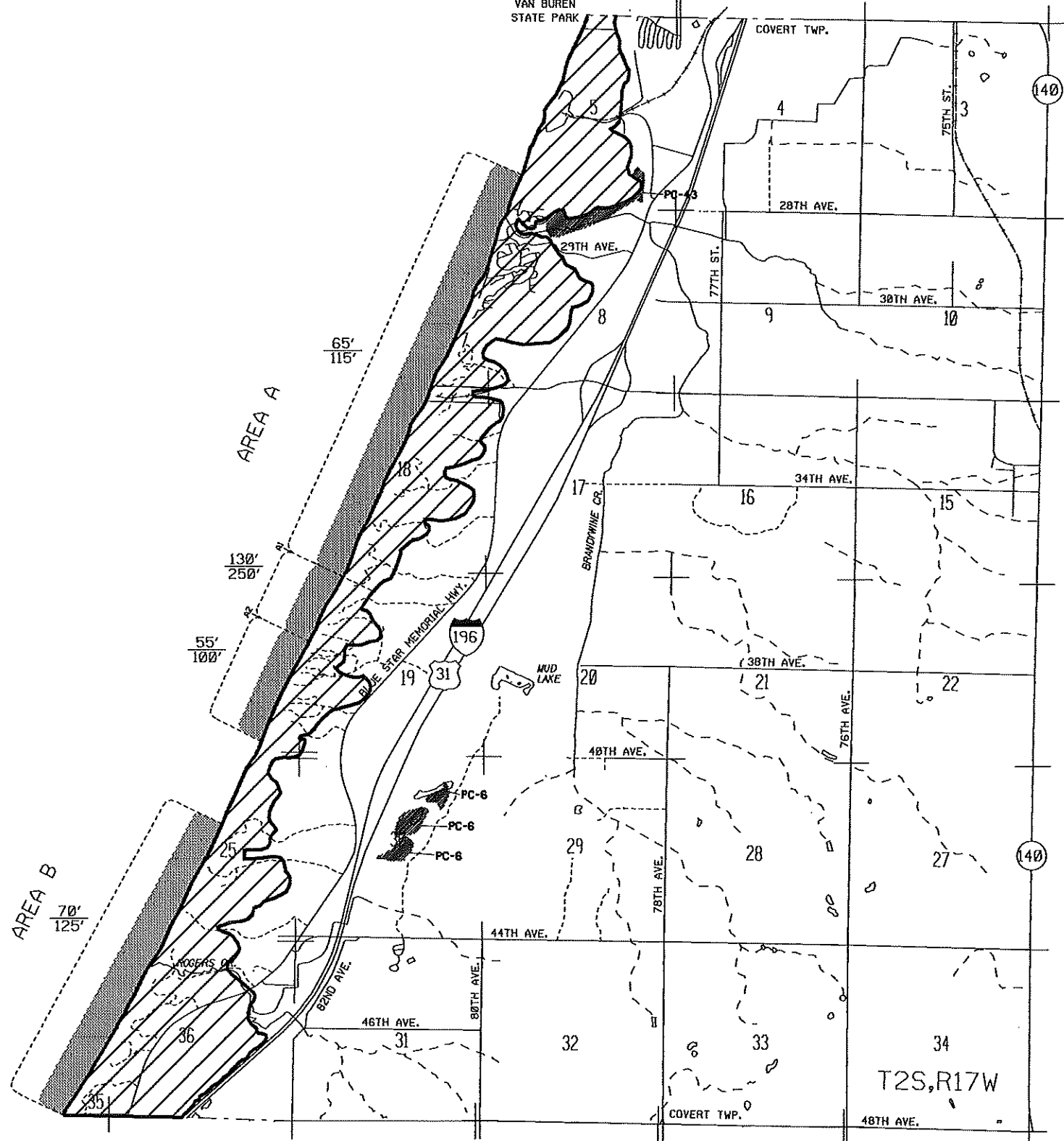
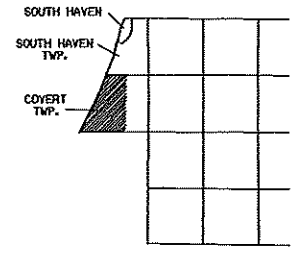

HIGH RISK EROSION AREAS

THE NUMBER REPRESENTS, IN FEET, THE 30 YEAR PROJECTED RECESSION DISTANCE.
 $\frac{65'}{115'}$ THE NUMBER REPRESENTS, IN FEET, THE 60 YEAR PROJECTED RECESSION DISTANCE.
 HIGH RISK EROSION AREA (shading alongshore)

THESE AREAS ARE LEGALLY DEFINED BY PART 323, SHORELANDS PROTECTION AND MANAGEMENT, OF THE NATURAL RESOURCE & ENVIRONMENTAL PROTECTION ACT 1994 PA 451 BEING GREAT LAKES SHORELAND AREAS DOCUMENTED TO RECEDE AN AVERAGE OF ONE FOOT OR MORE PER YEAR.

CRITICAL DUNE AREAS

- BARRIER DUNES
BARRIER DUNE FORMATIONS DESIGNATED PURSUANT TO PART 353, SAND DUNE PROTECTION & MANAGEMENT, OF THE NATURAL RESOURCE & ENVIRONMENTAL PROTECTION ACT 1994 PA 451.
- AREAS NOT INCLUDED IN DESIGNATED BARRIER DUNE FORMATIONS THAT ARE COMPOSED PRIMARILY OF DUNE SAND AND EXHIBIT SEVERAL DUNE-LIKE CHARACTERISTICS.
- EXEMPLARY DUNE ASSOCIATED PLANT COMMUNITIES OUTSIDE DESIGNATED DUNE FORMATIONS, MICHIGAN NATURAL FEATURES INVENTORY REFERENCE CODE INDICATED.

SOURCE

STATE OF MICHIGAN RECESSION RATE MAPS & ATLAS OF CRITICAL DUNE AREAS

INFORMATION

MICHIGAN DEPARTMENT OF ENVIRONMENTAL QUALITY
 LAND AND WATER MANAGEMENT DIVISION
 P.O. BOX 30458
 LANSING, MI 48909-7958
 (517) 373-1958



GREAT LAKES INFORMATION SYSTEM
 MICHIGAN DEPARTMENT OF NATURAL RESOURCES
 LAND AND WATER MANAGEMENT DIVISION

88-15-94
 Approved 88-21-96

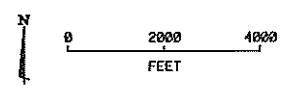



Parcels in High Risk Erosion Areas of Covert Township, Van Buren County

Date of Designation: August 19, 1996

Parcel Identification No.	Address	HREA*	Rate (feet/year)	30 yr PRD*	60 yr PRD*
80-07-019-001-00	36100 Blue Star Hwy	A2	3.9	130	250
80-07-019-002-00	36190 Blue Star Hwy	A2	3.9	130	250
80-07-019-005-00	Blue Star Hwy	A2	3.9	130	250
80-07-019-003-00	36262 Blue Star Hwy	A2	3.9	130	250
80-07-019-004-00	36334 Blue Star Hwy	A2	3.9	130	250
80-07-019-006-00	36404 Blue Star Hwy	A2	3.9	130	250
80-07-019-007-00	36476 Blue Star Hwy	A2	3.9	130	250
80-07-019-009-00	36762 Blue Star Hwy	A2	3.9	130	250
80-07-019-010-00	37678 Blue Star Hwy	A2	3.9	130	250
80-07-019-013-00	Blue Star Hwy	A2	3.9	130	250
80-07-019-011-00	38210 Blue Star Hwy	A2	3.9	130	250
80-07-019-012-00	38270 Blue Star Hwy	A2	3.9	130	250

HREA* - Some parcels may be in multiple HREAs due to their large size.

30 yr PRD* is the Projected Recession Distance (feet) landward from the Erosion Hazard Line for readily moveable structures including those structures 3,500 square feet or less and built on a basement, crawlspace or pilings. Additional restrictions may apply per Administrative Rules 281.21-22.

60 yr PRD* is the Projected Recession Distance (feet) landward from the Erosion Hazard Line for non-readily moveable structures such as large structures and septic systems.

Designation runs with the land including subsequent splits. Absence of a property number does not guarantee the property is located outside of an HREA. Contact Great Lakes Shorelands staff, Water Resources Division, EGLE in Lansing or the local EGLE field office for assistance.



Parcels in High Risk Erosion Areas of Covert Township, Van Buren County

Date of Designation: November 18, 1994

Parcel Identification No.	Address	HREA*	Rate (feet/year)	30 yr PRD*	60 yr PRD*
80-07-005-002-00 Entenergy Palisades	27780 Blue Star Hwy	A1	1.7	65	115
80-07-005-002-00	27780 Blue Star Hwy	A1	1.7	65	115
80-07-005-002-00	27780 Blue Star Hwy	A1	1.7	65	115
80-07-005-002-00	27780 Blue Star Hwy	A1	1.7	65	115
80-07-Vacant Lot		A1	1.7	65	115
80-07-222-004-00	Shorewood Walk	A1	1.7	65	115
80-07-222-020-00	27901 Shorewood Dr	A1	1.7	65	115
80-07-222-001-00	27842 Shorewood Walk	A1	1.7	65	115
80-07-221-015-00	27856 Shorewood Walk	A1	1.7	65	115
80-07-221-010-00	27868 Shorewood Walk	A1	1.7	65	115
80-07-221-002-00	27884 Shorewood Walk	A1	1.7	65	115
80-07-221-002-50	27895 Shorewood Walk	A1	1.7	65	115
80-07-471-010-00	79210 Edgewater Rd	A1	1.7	65	115
80-07-474-001-01		A1	1.7	65	115
80-07-474-002-00	28312 Sturtevant Walk	A1	1.7	65	115
80-07-401-001-00	28312 Sturtevant Walk	A1	1.7	65	115
80-07-402-009-00	28386 Sturtevant Walk	A1	1.7	65	115
80-07-402-019-00	28410 Shorewood Dr	A1	1.7	65	115
80-07-402-008-00	28400 Sturtevant Walk	A1	1.7	65	115

HREA* - Some parcels may be in multiple HREAs due to their large size.

30 yr PRD* is the Projected Recession Distance (feet) landward from the Erosion Hazard Line for readily moveable structures including those structures 3,500 square feet or less and built on a basement, crawlspace or pilings. Additional restrictions may apply per Administrative Rules 281.21-22.

60 yr PRD* is the Projected Recession Distance (feet) landward from the Erosion Hazard Line for non-readily moveable structures such as large structures and septic systems.

Designation runs with the land including subsequent splits. Absence of a property number does not guarantee the property is located outside of an HREA. Contact Great Lakes Shorelands staff, Water Resources Division, EGLE in Lansing or the local EGLE field office for assistance.



Parcels in High Risk Erosion Areas of Covert Township, Van Buren County

Date of Designation: November 18, 1994

Parcel Identification No.	Address	HREA*	Rate (feet/year)	30 yr PRD*	60 yr PRD*
80-07-402-018-00	28420 Shorewood Dr	A1	1.7	65	115
80-07-402-006-01	28410 Sturtevant Walk	A1	1.7	65	115
80-07-402-017-00	28430 Shorewood Dr	A1	1.7	65	115
80-07-402-014-00	28440 Shorewood Dr	A1	1.7	65	115
80-07-402-005-00	28430 Sturtevant Walk	A1	1.7	65	115
80-07-402-015-00	28435 Sturtevant Walk	A1	1.7	65	115
80-07-402-004-00	28440 Sturtevant Walk	A1	1.7	65	115
80-07-402-002-00	79940 Arthur Quick Circle	A1	1.7	65	115
80-07-402-003-00	28450 Sturtevant Walk	A1	1.7	65	115
80-07-402-001-00	79880 Arthur Quick Circle	A1	1.7	65	115
80-07-402-002-10	Arthur Quick Circle	A1	1.7	65	115
80-07-Ravine Way		A1	1.7	65	115
80-07-403-003-00	28925 Ballou Walk	A1	1.7	65	115
80-07-403-002-00	79939 Arthur Quick Circle	A1	1.7	65	115
80-07-403-016-00	79955 Fernwood Walk	A1	1.7	65	115
80-07-403-001-00	79929 Arthur Quick Circle	A1	1.7	65	115
80-07-403-005-00	28935 Ballou Walk	A1	1.7	65	115
80-07-403-015-00	Fernwood Crescent	A1	1.7	65	115

HREA* - Some parcels may be in multiple HREAs due to their large size.

30 yr PRD* is the Projected Recession Distance (feet) landward from the Erosion Hazard Line for readily moveable structures including those structures 3,500 square feet or less and built on a basement, crawlspace or pilings. Additional restrictions may apply per Administrative Rules 281.21-22.

60 yr PRD* is the Projected Recession Distance (feet) landward from the Erosion Hazard Line for non-readily moveable structures such as large structures and septic systems.

Designation runs with the land including subsequent splits. Absence of a property number does not guarantee the property is located outside of an HREA. Contact Great Lakes Shorelands staff, Water Resources Division, EGLE in Lansing or the local EGLE field office for assistance.



Parcels in High Risk Erosion Areas of Covert Township, Van Buren County

Date of Designation: November 18, 1994

Parcel Identification No.	Address	HREA*	Rate (feet/year)	30 yr PRD*	60 yr PRD*
80-07-403-004-00	28945 Ballou Walk	A1	1.7	65	115
80-07-403-007-00	28955 Ballou Walk	A1	1.7	65	115
80-07-403-011-00	79848 Fernwood Crescent	A1	1.7	65	115
80-07-403-013-00	79856 Fernwood Crescent	A1	1.7	65	115
80-07-403-010-50	79864 Fernwood Crescent	A1	1.7	65	115
80-07-403-010-00	79879 Fernwood Crescent	A1	1.7	65	115
80-07-Palisades Drive		A1	1.7	65	115
80-07-431-001-00	Ramblewood Dr	A1	1.7	65	115
80-07-453-001-01	Thunder Mountain Dr	A1	1.7	65	115
80-07-431-002-00	80024 Ramblewood Dr	A1	1.7	65	115
80-07-500-018-00	80024 Ramblewood Dr	A1	1.7	65	115
80-07-500-017-00	80030 Ramblewood Dr	A1	1.7	65	115
80-07-500-015-00	80036 Ramblewood Dr	A1	1.7	65	115
80-07-500-014-00	80042 Ramblewood Dr	A1	1.7	65	115
80-07-500-013-00	80048 Ramblewood Dr	A1	1.7	65	115
80-07-500-012-00	80054 Ramblewood Dr	A1	1.7	65	115
80-07-500-011-00	80060 Ramblewood Dr	A1	1.7	65	115
80-07-500-010-00	80066 Ramblewood Dr	A1	1.7	65	115

HREA* - Some parcels may be in multiple HREAs due to their large size.

30 yr PRD* is the Projected Recession Distance (feet) landward from the Erosion Hazard Line for readily moveable structures including those structures 3,500 square feet or less and built on a basement, crawlspace or pilings. Additional restrictions may apply per Administrative Rules 281.21-22.

60 yr PRD* is the Projected Recession Distance (feet) landward from the Erosion Hazard Line for non-readily moveable structures such as large structures and septic systems.

Designation runs with the land including subsequent splits. Absence of a property number does not guarantee the property is located outside of an HREA. Contact Great Lakes Shorelands staff, Water Resources Division, EGLE in Lansing or the local EGLE field office for assistance.



Parcels in High Risk Erosion Areas of Covert Township, Van Buren County

Date of Designation: November 18, 1994

Parcel Identification No.	Address	HREA*	Rate (feet/year)	30 yr PRD*	60 yr PRD*
80-07-500-009-00	80072 Ramblewood Dr	A1	1.7	65	115
80-07-500-007-00	80078 Ramblewood Dr	A1	1.7	65	115
80-07-500-006-00	80084 Ramblewood Dr	A1	1.7	65	115
80-07-500-005-00	29836 Lake Bluff Walk	A1	1.7	65	115
80-07-500-004-00	29844 Lake Bluff Walk	A1	1.7	65	115
80-07-500-003-00	29886 Lake Bluff Walk	A1	1.7	65	115
80-07-500-002-00	29869 Lake Bluff Walk	A1	1.7	65	115
80-07-999-802-30	80230 Linden Hills	A1	1.7	65	115
80-07-500-001-00	Lake Bluff Walk	A1	1.7	65	115
80-07-182-006-00	30018 Lake Bluff Dr	A1	1.7	65	115
80-07-182-007-00	30010 Lake Bluff Dr	A1	1.7	65	115
80-07-182-015-01	30034 Lake Bluff Dr	A1	1.7	65	115
80-07-182-002-10	30048 Lake Bluff Dr	A1	1.7	65	115
80-07-182-012-00	30056 Lake Bluff Dr	A1	1.7	65	115
80-07-182-001-00	30066 Lake Bluff Dr	A1	1.7	65	115
80-07-181-031-00	30078 Lake Bluff Dr	A1	1.7	65	115
80-07-181-030-01	30092 Lake Bluff Dr	A1	1.7	65	115
80-07-181-005-00	30100 Lake Bluff Dr	A1	1.7	65	115
80-07-181-014-00	30100 Lake Bluff Dr	A1	1.7	65	115
80-07-181-001-00	Lake Bluff Dr	A1	1.7	65	115

HREA* - Some parcels may be in multiple HREAs due to their large size.

30 yr PRD* is the Projected Recession Distance (feet) landward from the Erosion Hazard Line for readily moveable structures including those structures 3,500 square feet or less and built on a basement, crawlspace or pilings. Additional restrictions may apply per Administrative Rules 281.21-22.

60 yr PRD* is the Projected Recession Distance (feet) landward from the Erosion Hazard Line for non-readily moveable structures such as large structures and septic systems.

Designation runs with the land including subsequent splits. Absence of a property number does not guarantee the property is located outside of an HREA. Contact Great Lakes Shorelands staff, Water Resources Division, EGLE in Lansing or the local EGLE field office for assistance.



Parcels in High Risk Erosion Areas of Covert Township, Van Buren County

Date of Designation: November 18, 1994

Parcel Identification No.	Address	HREA*	Rate (feet/year)	30 yr PRD*	60 yr PRD*
80-07-181-017-00	Lake Bluff Dr	A1	1.7	65	115
80-07-183-100-01	32nd Ave	A1	1.7	65	115
80-07-017-026-00	80540 32nd Ave	A1	1.7	65	115
80-07-017-027-00	80574 32nd Ave	A1	1.7	65	115
80-07-017-025-00	80490 32nd Ave	A1	1.7	65	115
80-07-017-028-00	80600 32nd Ave	A1	1.7	65	115
80-07-017-024-00	80559 32nd Ave	A1	1.7	65	115
80-07-017-029-00	33010 Blue Star Hwy	A1	1.7	65	115
80-07-017-030-00	33706 Blue Star Hwy	A1	1.7	65	115
80-07-017-031-00	33790 Blue Star Hwy	A1	1.7	65	115
80-07-017-032-00	33938 Blue Star Hwy	A1	1.7	65	115
80-07-017-033-00	33972 Blue Star Hwy	A1	1.7	65	115
80-07-017-034-00	34004 Blue Star Hwy	A1	1.7	65	115
80-07-017-035-00	34482 Blue Star Hwy	A1	1.7	65	115
80-07-017-036-10	34540 Blue Star Hwy	A1	1.7	65	115
80-07-017-036-01	34628 Blue Star Hwy	A1	1.7	65	115
80-07-017-037-00	34802 Blue Star Hwy	A1	1.7	65	115
80-07-017-038-00	Blue Star Hwy	A1	1.7	65	115
80-07-017-039-00	35110 Blue Star Hwy	A1	1.7	65	115
80-07-017-040-00	35178 Blue Star Hwy	A1	1.7	65	115

HREA* - Some parcels may be in multiple HREAs due to their large size.

30 yr PRD* is the Projected Recession Distance (feet) landward from the Erosion Hazard Line for readily moveable structures including those structures 3,500 square feet or less and built on a basement, crawlspace or pilings. Additional restrictions may apply per Administrative Rules 281.21-22.

60 yr PRD* is the Projected Recession Distance (feet) landward from the Erosion Hazard Line for non-readily moveable structures such as large structures and septic systems.

Designation runs with the land including subsequent splits. Absence of a property number does not guarantee the property is located outside of an HREA. Contact Great Lakes Shorelands staff, Water Resources Division, EGLE in Lansing or the local EGLE field office for assistance.



Parcels in High Risk Erosion Areas of Covert Township, Van Buren County

Date of Designation: November 18, 1994

Parcel Identification No.	Address	HREA*	Rate (feet/year)	30 yr PRD*	60 yr PRD*
80-07-017-041-02	35240 Blue Star Hwy	A1	1.7	65	115
80-07-017-042-02	35446 Blue Star Hwy	A1	1.7	65	115
80-07-018-001-00	35404 Blue Star Hwy	A1	1.7	65	115
80-07-018-003-00	35518 Blue Star Hwy	A1	1.7	65	115
80-07-018-002-00	35528 Blue Star Hwy	A1	1.7	65	115
80-07-018-004-00	35528 Blue Star Hwy	A1	1.7	65	115
80-07-018-005-00	35646 Blue Star Hwy	A1	1.7	65	115
80-07-018-006-00	35750 Blue Star Hwy	A1	1.7	65	115
80-07-018-007-02	35800 Blue Star Hwy	A1	1.7	65	115
80-07-018-007-21	35850 Blue Star Hwy	A1	1.7	65	115
80-07-018-008-01	35950 Blue Star Hwy	A1	1.7	65	115
80-07-019-016-00	37788 Blue Star Hwy	A3	1.4	55	100
80-07-019-017-00	38340 Blue Star Hwy	A3	1.4	55	100
80-07-019-018-00	38502 Blue Star Hwy	A3	1.4	55	100
80-07-019-019-00	38600 Blue Star Hwy	A3	1.4	55	100
80-07-019-020-00	38620 Blue Star Hwy	A3	1.4	55	100
80-07-019-021-00	38634 Blue Star Hwy	A3	1.4	55	100
80-07-019-022-00	38816 Blue Star Hwy	A3	1.4	55	100
80-07-019-023-00	38816 Blue Star Hwy	A3	1.4	55	100
80-07-019-024-00	39200 Blue Star Hwy	A3	1.4	55	100

HREA* - Some parcels may be in multiple HREAs due to their large size.

30 yr PRD* is the Projected Recession Distance (feet) landward from the Erosion Hazard Line for readily moveable structures including those structures 3,500 square feet or less and built on a basement, crawlspace or pilings. Additional restrictions may apply per Administrative Rules 281.21-22.

60 yr PRD* is the Projected Recession Distance (feet) landward from the Erosion Hazard Line for non-readily moveable structures such as large structures and septic systems.

Designation runs with the land including subsequent splits. Absence of a property number does not guarantee the property is located outside of an HREA. Contact Great Lakes Shorelands staff, Water Resources Division, EGLE in Lansing or the local EGLE field office for assistance.



Parcels in High Risk Erosion Areas of Covert Township, Van Buren County

Date of Designation: November 18, 1994

Parcel Identification No.	Address	HREA*	Rate (feet/year)	30 yr PRD*	60 yr PRD*
80-07-019-025-00	39466 Blue Star Hwy	A3	1.4	55	100
80-07-570-001-00	39292 Wilderness Dunes Ln	A3	1.4	55	100
80-07-570-002-00	Wilderness Dunes Ln	A3	1.4	55	100
80-07-570-003-00	39532 Wilderness Dunes Ln	A3	1.4	55	100
80-07-075-008-00	41582 Wilderness Dunes Ln	B1	1.8	70	125
80-07-075-012-02	41610 Wilderness Dunes Ln	B1	1.8	70	125
80-07-075-012-10	41636 Wilderness Dunes Ln	B1	1.8	70	125
80-07-019-028-00		B1	1.8	70	125
80-07-075-010-00	41818 Blue Star Hwy	B1	1.8	70	125
80-07-075-009-00	42270 Blue Star Hwy	B1	1.8	70	125
80-07-075-004-00	42380 Blue Star Hwy	B1	1.8	70	125
80-07-075-002-32	44560 Blue Star Hwy	B1	1.8	70	125
80-07-075-002-40	Blue Star Hwy	B1	1.8	70	125
80-07-075-002-11	45280 Blue Star Hwy	B1	1.8	70	125
80-07-075-002-20	Blue Star Hwy	B1	1.8	70	125
80-07-100-112-25	45292 Blue Star Hwy	B1	1.8	70	125
80-07-100-112-50	45304 Blue Star Hwy	B1	1.8	70	125
80-07-100-112-75	45316 Blue Star Hwy	B1	1.8	70	125

HREA* - Some parcels may be in multiple HREAs due to their large size.

30 yr PRD* is the Projected Recession Distance (feet) landward from the Erosion Hazard Line for readily moveable structures including those structures 3,500 square feet or less and built on a basement, crawlspace or pilings. Additional restrictions may apply per Administrative Rules 281.21-22.

60 yr PRD* is the Projected Recession Distance (feet) landward from the Erosion Hazard Line for non-readily moveable structures such as large structures and septic systems.

Designation runs with the land including subsequent splits. Absence of a property number does not guarantee the property is located outside of an HREA. Contact Great Lakes Shorelands staff, Water Resources Division, EGLE in Lansing or the local EGLE field office for assistance.



Parcels in High Risk Erosion Areas of Covert Township, Van Buren County

Date of Designation: November 18, 1994

Parcel Identification No.	Address	HREA*	Rate (feet/year)	30 yr PRD*	60 yr PRD*
80-07-100-112-00	45328 Blue Star Hwy	B1	1.8	70	125
80-07-100-020-00	45342 Blue Star Hwy	B1	1.8	70	125
80-07-100-019-00	45352 Blue Star Hwy	B1	1.8	70	125
80-07-100-018-00	45364 Blue Star Hwy	B1	1.8	70	125
80-07-100-017-00	45372 Blue Star Hwy	B1	1.8	70	125
80-07-100-016-00	45388 Blue Star Hwy	B1	1.8	70	125
80-07-100-015-00	45400 Blue Star Hwy	B1	1.8	70	125
80-07-100-014-00	45412 Blue Star Hwy	B1	1.8	70	125
80-07-100-013-00	45436 Blue Star Hwy	B1	1.8	70	125
80-07-100-011-00	45448 Blue Star Hwy	B1	1.8	70	125
80-07-100-010-00	45460 Blue Star Hwy	B1	1.8	70	125
80-07-100-009-00	45472 Blue Star Hwy	B1	1.8	70	125
80-07-100-008-50	45484 Blue Star Hwy	B1	1.8	70	125
80-07-100-007-00	45508 Blue Star Hwy	B1	1.8	70	125
80-07-100-006-00	45520 Blue Star Hwy	B1	1.8	70	125
80-07-100-005-00	45532 Blue Star Hwy	B1	1.8	70	125
80-07-100-004-00	45544 Blue Star Hwy	B1	1.8	70	125
80-07-100-003-00	45556 Blue Star Hwy	B1	1.8	70	125
80-07-100-002-00	45568 Blue Star Hwy	B1	1.8	70	125
80-07-100-001-00	Blue Star Hwy	B1	1.8	70	125

HREA* - Some parcels may be in multiple HREAs due to their large size.

30 yr PRD* is the Projected Recession Distance (feet) landward from the Erosion Hazard Line for readily moveable structures including those structures 3,500 square feet or less and built on a basement, crawlspace or pilings. Additional restrictions may apply per Administrative Rules 281.21-22.

60 yr PRD* is the Projected Recession Distance (feet) landward from the Erosion Hazard Line for non-readily moveable structures such as large structures and septic systems.

Designation runs with the land including subsequent splits. Absence of a property number does not guarantee the property is located outside of an HREA. Contact Great Lakes Shorelands staff, Water Resources Division, EGLE in Lansing or the local EGLE field office for assistance.



Parcels in High Risk Erosion Areas of Covert Township, Van Buren County

Date of Designation: November 18, 1994

Parcel Identification No.	Address	HREA*	Rate (feet/year)	30 yr PRD*	60 yr PRD*
80-07-200-001-03	Blue Star Hwy	B1	1.8	70	125
80-07-200-001-20	46012 Blue Star Hwy	B1	1.8	70	125
80-07-200-004-00	46064 Blue Star Hwy	B1	1.8	70	125
80-07-200-006-00	46200 Blue Star Hwy	B1	1.8	70	125
80-07-200-007-00	46350 Blue Star Hwy	B1	1.8	70	125
80-07-200-009-00	46468 Blue Star Hwy	B1	1.8	70	125
80-07-200-010-00	46530 Blue Star Hwy	B1	1.8	70	125
80-07-200-011-00	46610 Blue Star Hwy	B1	1.8	70	125
80-07-200-012-00	46692 Blue Star Hwy	B1	1.8	70	125
80-07-200-013-00	Blue Star Hwy	B1	1.8	70	125
80-07-200-014-50	46840 Blue Star Hwy	B1	1.8	70	125
80-07-200-015-00	Blue Star Hwy	B1	1.8	70	125
80-07-200-017-50	Blue Star Hwy	B1	1.8	70	125
80-07-200-017-00	Blue Star Hwy	B1	1.8	70	125
80-07-200-018-51	47130 Blue Star Hwy	B1	1.8	70	125
80-07-200-019-01	47290 Blue Star Hwy	B1	1.8	70	125
80-07-200-002-00	47350 Blue Star Hwy	B1	1.8	70	125
80-07-200-002-10	47390 Blue Star Hwy	B1	1.8	70	125
80-07-200-022-01	47480 Blue Star Hwy	B1	1.8	70	125
80-07-200-024-00	Blue Star Hwy	B1	1.8	70	125

HREA* - Some parcels may be in multiple HREAs due to their large size.

30 yr PRD* is the Projected Recession Distance (feet) landward from the Erosion Hazard Line for readily moveable structures including those structures 3,500 square feet or less and built on a basement, crawlspace or pilings. Additional restrictions may apply per Administrative Rules 281.21-22.

60 yr PRD* is the Projected Recession Distance (feet) landward from the Erosion Hazard Line for non-readily moveable structures such as large structures and septic systems.

Designation runs with the land including subsequent splits. Absence of a property number does not guarantee the property is located outside of an HREA. Contact Great Lakes Shorelands staff, Water Resources Division, EGLE in Lansing or the local EGLE field office for assistance.



Parcels in High Risk Erosion Areas of Covert Township, Van Buren County

Date of Designation: November 18, 1994

Parcel Identification No.	Address	HREA*	Rate (feet/year)	30 yr PRD*	60 yr PRD*
80-07-200-026-00	47810 Blue Star Hwy	B1	1.8	70	125
80-07-200-027-10	47860 Blue Star Hwy	B1	1.8	70	125
80-07-200-028-52	47950 Blue Star Hwy	B1	1.8	70	125
80-07-200-027-52	47988 Blue Star Hwy	B1	1.8	70	125

HREA* - Some parcels may be in multiple HREAs due to their large size.

30 yr PRD* is the Projected Recession Distance (feet) landward from the Erosion Hazard Line for readily moveable structures including those structures 3,500 square feet or less and built on a basement, crawlspace or pilings. Additional restrictions may apply per Administrative Rules 281.21-22.

60 yr PRD* is the Projected Recession Distance (feet) landward from the Erosion Hazard Line for non-readily moveable structures such as large structures and septic systems.

Designation runs with the land including subsequent splits. Absence of a property number does not guarantee the property is located outside of an HREA. Contact Great Lakes Shorelands staff, Water Resources Division, EGLE in Lansing or the local EGLE field office for assistance.