



MICHIGAN DEPARTMENT OF ENVIRONMENT, GREAT LAKES, AND ENERGY
OIL, GAS AND MINERALS DIVISION

CLASS II WELL PERMIT APPLICATION NOTIFICATION

By authority of Part 615 of Act 451 PA 1994, as amended

Date of Notice: July 25, 2024

The Michigan Department of Environment, Great Lakes, and Energy (EGLE), Oil, Gas, and Minerals Division (OGMD) has received a permit application for a Class II Well. In compliance with Rule 324.803(1) of Part 615, EGLE, OGMD shall mail notice to surface owners of record, and permittees of each oil, gas, and injection well within 1,320 feet of the proposed injection well, and the township supervisor or municipal manager where the well is located.

The permit applicant is:

West Bay Exploration Company
13685 S West Bayshore Dr
Traverse City, MI 49684

Proposed Class II well information and location:

West Bay 1-13 SWD
Section 13, T03S, R01E
Leoni Township, Jackson County

The proposed well is located approximately 489 feet southeast of the intersection of South Portage Road and Dorrell Road.

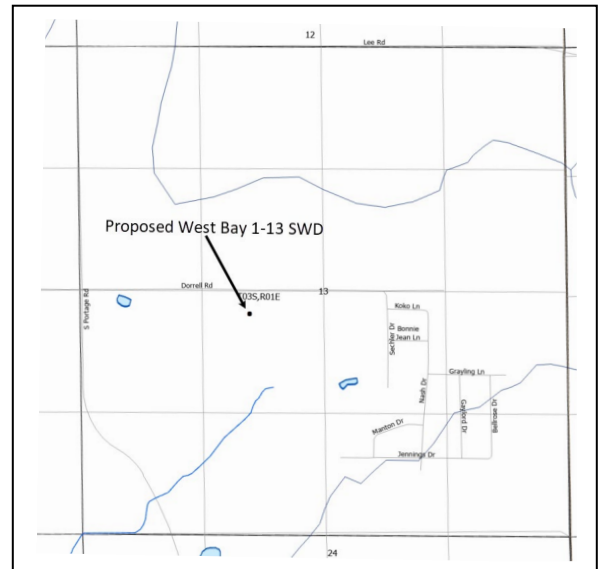

This is a proposed conversion of an existing oil well to a Class II well for the purpose of brine disposal.

The injection interval is known as the Niagaran Formation. The injection interval is found at a depth of 2,872 feet below the surface. The maximum anticipated injection pressure at the well head is 350 psi, with a maximum anticipated daily injection rate of 2,500 barrels per day.

How to submit questions or comments:

Submit via email to EGLE at:

EGLE-OGMDpubliccomments@michigan.gov

Or mail to the following address:

EGLE
Oil, Gas, and Minerals Division
RE: West Bay 1-13 SWD
P.O. Box 30256
Lansing, MI 48909-7756

Any comments or objections on an application, or a request to obtain additional information about the application, must be received by the supervisor within 30 days after the date of notice set forth herein.