



Michigan Department of  
Environment, Great Lakes, and Energy  
Oil, Gas and Minerals Division

PERMIT LIST

05/23/2022 THRU 05/27/2022



Permit Number      Issue Date      Permittee Number      Permittee Name      Page 1

61616      5/24/2022      6310      CORE ENERGY LLC  
1011 NOTEWARE DRIVE  
TRAVERSE CITY, MI 49686

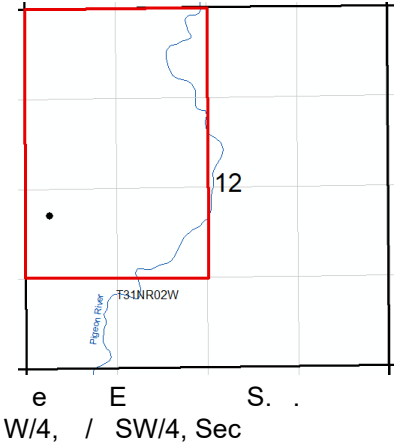

API Well No: 21-137-62015-00-00

Prev Permit:

Well Name: BENSINGER 3-12

Surface Owner: BCT Farm LLC

Well Type: Oil Well

True Vertical Depth: 5000FT

Permit Type: Drill

Target Formation: NIAGARAN BROWN

H2S Present? No

Deepest Formation: NIAGARAN BROWN

Location:	QT QT QT	Sec	Township	Range	Township Name	County	Feet From Section Line	Feet From DRLG Unit Line
SL:	NWNWSW	12	31N	2W	DOVER	OTSEGO	2233 S 392 W	
BHL:	NWNWSW	12	31N	2W	DOVER	OTSEGO	2233 S 392 W	918 S 392 W

61617      5/24/2022      6498      WOLVERINE GAS AND OIL  
COMPANY OF MICHIGAN LLC  
ONE RIVERFRONT PLAZA  
55 CAMPAU, NW  
GRAND RAPIDS, MI 49503

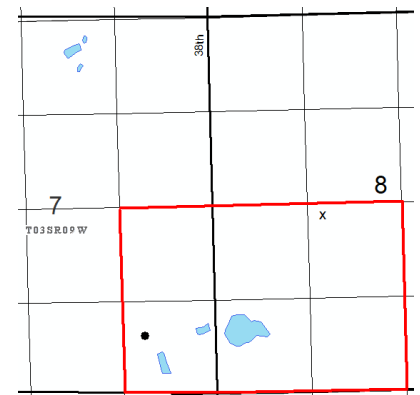

API Well No: 21-077-62038-00-00

Prev Permit:

Well Name: METTY 8-1 HD1

Surface Owner: Marilyn Metty

Well Type: Oil Well

True Vertical Depth: 3490FT

Permit Type: Drill

Target Formation: TRENTON

H2S Present? Yes

Deepest Formation: TRENTON

240 Acre R303 Drilling Unit E/2 SE/4  
Sec 7, SW/4 Sec 8

Location:	QT QT QT	Sec	Township	Range	Township Name	County	Feet From Section Line	Feet From DRLG Unit Line
SL:	NWNESW	8	3S	9W	CLIMAX	KALAMAZOO	2497 S 1523 W	
BHL:	NWSESE	7	3S	9W	CLIMAX	KALAMAZOO	839 S 990 E	839 S 340 W

Michigan Department of  
Environment, Great Lakes, and Energy  
Oil, Gas and Minerals Division

PERMIT LIST

05/23/2022 THRU 05/27/2022



Permit Number      Issue Date      Permittee Number      Permittee Name      Page 2

61618      5/24/2022      6498      WOLVERINE GAS AND OIL  
COMPANY OF MICHIGAN LLC  
ONE RIVERFRONT PLAZA 55  
CAMPAU, NW  
GRAND RAPIDS, MI 49503

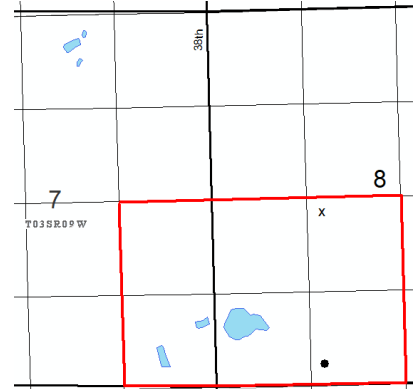

240-Acre R303 Drilling Unit (2nd well),  
E/2 SE/4 Sec 7; SW/4 Sec 8

API Well No: 21-077-62039-00-00

Prev Permit:

Well Name: METTY 8-2 HD1

Surface Owner: Marilyn Metty

Well Type: Oil Well

True Vertical Depth: 3509FT

Permit Type: Drill

Target Formation: TRENTON

H2S Present? Yes

Deepest Formation: TRENTON

Location:	QT QT QT	Sec	Township	Range	Township Name	County	Feet From Section Line	Feet From DRLG Unit Line
SL:	NWNESW	8	3S	9W	CLIMAX	KALAMAZOO	2347 S 1522 W	
BHL:	SWSESW	8	3S	9W	CLIMAX	KALAMAZOO	340 S 1547 W	340 S 1097 E

61619      5/25/2022      80      BAILER AND DESHAW  
PO BOX 366  
KAWKAWLIN, MI 48631

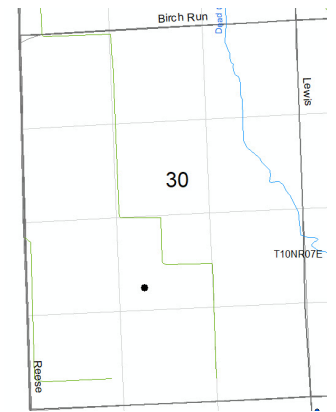

Non-producing well, no drilling unit

API Well No: 21-157-20667-01-00

Prev Permit: 20667

Well Name: HARRISON-MURPHY A-1  
BDW

Surface Owner: Gayle Taylor

Well Type: Brine Disposal Well

True Vertical Depth: 2534FT

Permit Type: Convert

Target Formation: DUNDEE

H2S Present? No

Deepest Formation: DUNDEE

Location:	QT QT QT	Sec	Township	Range	Township Name	County	Feet From Section Line	Feet From DRLG Unit Line
SL:	SWNWSW	30	10N	7E	ARBELA	TUSCOLA	1650 S 990 E	
BHL:	SWNWSW	30	10N	7E	ARBELA	TUSCOLA	1650 S 990 E	

Michigan Department of  
Environment, Great Lakes, and Energy  
Oil, Gas and Minerals Division

PERMIT LIST

05/23/2022 THRU 05/27/2022



Permit Number      Issue Date      Permittee Number      Permittee Name      Page 3

61620      5/26/2022      6310      CORE ENERGY LLC  
1011 NOTEWARE DRIVE  
TRAVERSE CITY, MI 49686

API Well No: 21-137-62016-00-00

Prev Permit:

Well Name: MCKENZIE 4-11

Well Type: Oil Well

Permit Type: Drill

H2S Present? No

Surface Owner: KENNETH  
MCKENZIE

True Vertical Depth: 6070FT

Target Formation: NIAGARAN BROWN

Deepest Formation: NIAGARAN GRAY

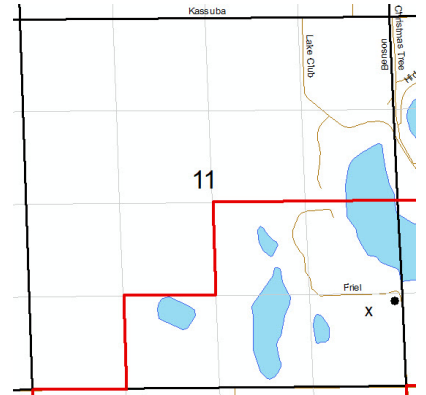

Bagley Salina-Niagaran 11-14-23  
(EOR) Unit, S.O. (A) 10-3-90

Location:	QT QT QT	Sec	Township	Range	Township Name	County	Feet From Section Line	Feet From DRLG Unit Line
SL:	NESESE	11	30N	3W	BAGLEY	OTSEGO	1139 S 479 E	
BHL:	NESESE	11	30N	3W	BAGLEY	OTSEGO	1215 S 114 E	1395 N 1437 E

Michigan Department of  
Environment, Great Lakes, and Energy  
Oil, Gas and Minerals Division

UPDATED PERMITS

05/23/2022 THRU 05/27/2022



Permit Number      Permittee Number      Permittee Name

**PLUGGING INSTRUCTIONS ISSUED:**

22814                  14                                  D T E GAS COMPANY  
ONE ENERGY PLAZA, WCB 1782  
DETROIT, MI 48226

API Well Number: 21-147-22814-00-00

Well Name: DOUGLASS, URBAN 1

Plug Inst. Issue Date: 4/12/2022

Location	QT QT QT	Sec	Township	Range	Township Name	County	Feet From Section Line	Feet From DRLG Unit
SL:	NWSENE	15	4N	16E	CHINA	SAINT CLAIR	1013 S 850 E	330 N 850 E
BHL:	NWSENE	15	4N	16E	CHINA	SAINT CLAIR		

Comment: App to P&A expires on 3/31/2023

42148                  6371                                  BREITBURN OPERATING  
LIMITED PARTNERSHIP  
1111 BAGBY STREET, SUITE 1600  
HOUSTON, TX 77002

API Well Number: 21-137-42148-00-00

Well Name: WALKER 7-35 SWD

Plug Inst. Issue Date: 5/25/2022

Location	QT QT QT	Sec	Township	Range	Township Name	County	Feet From Section Line	Feet From DRLG Unit
SL:	SWNESW	35	31N	4W	ELMIRA	OTSEGO	1189 N 660 E	160 S 655 W
BHL:	SWNESW	35	31N	4W	ELMIRA	OTSEGO		

Comment: App to P&A expires on 5/25/2023

Michigan Department of  
Environment, Great Lakes, and Energy  
Oil, Gas and Minerals Division

UPDATED PERMITS  
05/23/2022 THRU 05/27/2022



Permit Number      Permittee Number      Permittee Name

4304                      2545                      UNION OIL CO OF CALIFORNIA  
  
2210 WEST PINE RIVER DRIVE  
BRECKENRIDGE MI 48615

API Well Number: 21-073-04304-00-00

Well Name: EMBREY, ROY J B-1

Plug Inst. Issue Date: 5/24/2022

Location	QT QT QT	Sec	Township	Range	Township Name	County	Feet From Section Line	Feet From DRLG Unit
SL:	NWNWNW	3	14N	6W	BROOMFIELD	ISABELLA	330 N 330 W	
BHL:	NWNWNW	3	14N	6W	BROOMFIELD	ISABELLA		

Comment: App to Re-P&A expires on 5/24/2023

43230                      6371                      BREITBURN OPERATING  
LIMITED PARTNERSHIP  
1111 BAGBY STREET, SUITE 1600  
HOUSTON, TX 77002

API Well Number: 21-137-43230-00-00

Well Name: CHUDZINSKI 2-29

Plug Inst. Issue Date: 5/25/2022

Location	QT QT QT	Sec	Township	Range	Township Name	County	Feet From Section Line	Feet From DRLG Unit
SL:	NENENW	29	31N	4W	ELMIRA	OTSEGO	330 N 330 E	
BHL:	NENENW	29	31N	4W	ELMIRA	OTSEGO		

Comment: App to P&A expires on 5/25/2023

Michigan Department of  
Environment, Great Lakes, and Energy  
Oil, Gas and Minerals Division

UPDATED PERMITS

05/23/2022 THRU 05/27/2022



Permit Number      Permittee Number      Permittee Name

46624      6371      BREITBURN OPERATING LIMITED  
PARTNERSHIP  
1111 BAGBY STREET, SUITE 1600  
HOUSTON, TX 77002

API Well Number: 21-137-46624-02-00

Well Name: PRUSAKIEWICZ 12-5 HDL1      True Vertical Depth: 1109

Plug Inst. Issue Date: 5/25/2022

Location	QT QT QT	Sec	Township	Range	Township Name	County	Feet From Section Line	Feet From DRLG Unit
SL:	SWNWSW	5	31N	3W	LIVINGSTON	OTSEGO	1685 S 455 W	
BHL:	SESESW	5	31N	3W	LIVINGSTON	OTSEGO	350 S 1991 W	

Comment: App to P&A expires on 5/25/2023

48034      6361      RIVERSIDE ENERGY MICHIGAN LLC  
10691 EAST CARTER ROAD  
SUITE 201  
TRAVERSE CITY, MI 49684

API Well Number: 21-119-48034-00-00

Well Name: C C LAND B2-10 SWD

Plug Inst. Issue Date: 5/25/2022

Location	QT QT QT	Sec	Township	Range	Township Name	County	Feet From Section Line	Feet From DRLG Unit
SL:	SWSENW	10	29N	4E	RUST	MONTMORENCY	204 S 1216 E	
BHL:	SWSENW	10	29N	4E	RUST	MONTMORENCY		

Comment: App to P&A expires on 5/25/2023

Michigan Department of  
Environment, Great Lakes, and Energy  
Oil, Gas and Minerals Division

UPDATED PERMITS

05/23/2022 THRU 05/27/2022



Permit Number      Permittee Number      Permittee Name

59238      6310      CORE ENERGY LLC  
1011 NOTEWARE DRIVE  
TRAVERSE CITY, MI 49686

API Well Number: 21-137-37324-02-00

Well Name: POMARZYNSKI 5-35A      True Vertical Depth: 5577

Plug Inst. Issue Date: 5/23/2022

Location	QT QT QT	Sec	Township	Range	Township Name	County	Feet From Section Line	Feet From DRLG Unit
SL:	NWNESW	35	31N	2W	DOVER	OTSEGO	2216 S 1600 W	
BHL:	SWSENW	35	31N	2W	DOVER	OTSEGO	2456 N 1660 W	2456 N 961 E

Comment: App to P&A expires on 4/29/2023

6604      8372      G R-KENT FIELD LLC  
0-21 FENNESSY STREET SW  
GRAND RAPIDS, MI 49534

API Well Number: 21-081-06604-00-00

Well Name: WIRTH, ALBERT 1

Plug Inst. Issue Date: 5/26/2022

Location	QT QT QT	Sec	Township	Range	Township Name	County	Feet From Section Line	Feet From DRLG Unit
SL:	W2SEW	30	7N	12W	WALKER	KENT	660 S 1155 E	
BHL:	W2SEW	30	7N	12W	WALKER	KENT		

Comment: App to P&A expires on 5/26/2023



Michigan Department of  
Environment, Great Lakes, and Energy  
Oil, Gas and Minerals Division

UPDATED PERMITS

05/23/2022 THRU 05/27/2022



Permit Number      Permittee Number      Permittee Name

6821      8372      G R-KENT FIELD LLC  
0-21 FENNESSY STREET SW  
GRAND RAPIDS, MI 49534

API Well Number: 21-081-06821-00-00

Well Name: WIRTH, ALBERT 2

Plug Inst. Issue Date: 5/26/2022

Location	QT QT QT	Sec	Township	Range	Township Name	County	Feet From Section Line	Feet From DRLG Unit
SL:	NWNENW	30	7N	12W	WALKER	KENT	660 N 1155 E	660 N 165 E
BHL:	NWNENW	30	7N	12W	WALKER	KENT		

Comment: App to P&A expires on 5/26/2023

Michigan Department of  
Environment, Great Lakes, and Energy  
Oil, Gas and Minerals Division

UPDATED PERMITS

05/23/2022 THRU 05/27/2022



Permit Number      Permittee Number      Permittee Name

**APPLICATIONS TO CHANGE WELL STATUS:**

56157      6361      RIVERSIDE ENERGY MICHIGAN LLC  
10691 EAST CARTER ROAD  
SUITE 201  
TRAVERSE CITY, MI 49684

API Well Number: 21-009-56157-00-00

Well Name: HUNTER B1-5

Approval Date: 5/26/2022

Location	QT QT QT	Sec	Township	Range	Township Name	County	Feet From Section Line	Feet From DRLG Unit
SL:	NWSWNW	5	30N	7W	KEARNEY	ANTRIM	1989 N 120 W	
BHL:	NWSWNW	5	30N	7W	KEARNEY	ANTRIM		

Proposed Rework: ACOWS for Miscellaneous

Comment: ACOWS to squeeze Norwood perms and plugback to produce the Lachine expires on 5/26/2023

59265      7739      LAYLINE OIL AND GAS LLC 820  
GESSNER ROAD, SUITE 1145  
HOUSTON, TX 77024 USA

API Well Number: 21-035-17919-01-00

Well Name: STATE WINTERFIELD 13-12A      True Vertical Depth: 5260

Approval Date: 4/15/2022

Location	QT QT QT	Sec	Township	Range	Township Name	County	Feet From Section Line	Feet From DRLG Unit
SL:	NWSENE	12	20N	6W	WINTERFIELD	CLARE	1655 N 987 E	
BHL:	NWSENE	12	20N	6W	WINTERFIELD	CLARE	1661 N 987 E	330 N 330 W

Proposed Rework: ACOWS to Perforate and Test Current Formation

Comment: ACOWS to add perms to the lower Detroit River expires on 4/15/2023

Michigan Department of  
Environment, Great Lakes, and Energy  
Oil, Gas and Minerals Division

UPDATED PERMITS

05/23/2022 THRU 05/27/2022



Permit Number      Permittee Number      Permittee Name

**RECORD OF CHANGE OF WELL STATUS:**

59265                      7739                      LAYLINE OIL AND GAS LLC 820  
GESSNER ROAD, SUITE 1145  
HOUSTON, TX 77024 USA

API Well Number: 21-035-17919-01-00

Well Name: STATE WINTERFIELD 13-12A                      True Vertical Depth: 5260

Change Date: 4/28/2022

Location	QT QT QT	Sec	Township	Range	Township Name	County	Feet From Section Line	Feet From DRLG Unit
SL:	NWSENE	12	20N	6W	WINTERFIELD	CLARE	1655 N 987 E	
BHL:	NWSENE	12	20N	6W	WINTERFIELD	CLARE	1661 N 987 E	330 N 330 W

Proposed Rework:                      Reworked to Perforate & Test Current Formation

Comment:                      Reworked to perf and stimulate F/ 4804' T/ 4808' and F/ 4822' T/ 4830'