

Michigan Department of
Environment, Great Lakes, and Energy
Oil, Gas and Minerals Division

PERMIT APPLICATIONS

09/12/2022 THRU 09/16/2022



759 09/12/2022 5320 SAVOY ENERGY LP
920 HASTINGS STREET, SUITE A
PO BOX 1560
TRAVERSE CITY, MI 49685-1560

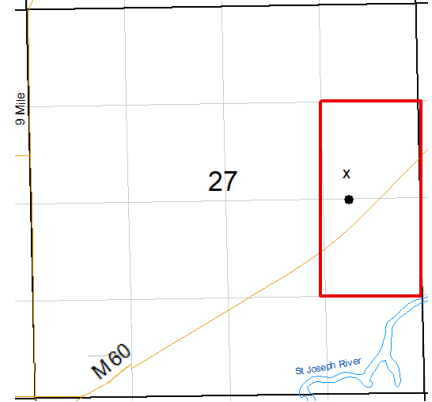

Prev Permit: 38580

Well Name: ARCO & CASE 1-27A Surface Owner: Case, Thomas & Cynthia

True Vertical Depth: 3925

Well Type: OIL Target Formation: TRENTON-BLACK RIVER

Permit Type: Reentry Deepest Formation: PRAIRIE DU CHIEN

80-Acre R303 Drilling Unit, SE/4 NE/4, NE/4 SE/4 Sec 27

H2S Present? No

Location:	QT QT QT	Sec	Township	Range	Township Name	County	Feet From Section Line	Feet From DRLG Unit Line
SL:	SWSENE	27	4S	7W	BURLINGTON	CALHOUN	2314 N 978 E	981 N 354 W
BHL:	NWNESE	27	4S	7W	BURLINGTON	CALHOUN	2640 N 977 E	1306 SN 356 W

771 09/16/2022 491 CONSUMERS ENERGY CO
1945 W PARNALL RD
JACKSON, MI 49201

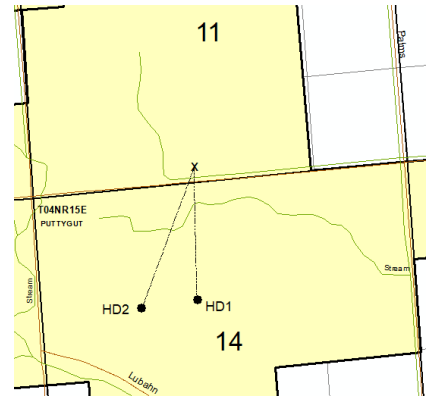

Prev Permit:

Well Name: P 302 HD1 Surface Owner: Consumers Energy True

Vertical Depth: 2612

Well Type: GS Target Formation: NIAGARAN BROWN

Permit Type: Drill Deepest Formation: NIAGARAN BROWN

No Drilling Unit, Puttygut Gas Storage Field

Location:	QT QT QT	Sec	Township	Range	Township Name	County	Feet From Section Line	Feet From DRLG Unit Line
SL:	SESESW	11	4N	15E	CASCO	SAINT CLAIR	211 S 2363 W	
BHL:	NWSENW	14	4N	15E	CASCO	SAINT CLAIR	1746 N 2224 W	

Michigan Department of
Environment, Great Lakes, and Energy
Oil, Gas and Minerals Division

PERMIT APPLICATIONS

09/12/2022 THRU 09/16/2022



Application Number Date Received Permittee Number Permittee Name

771 09/16/2022 491 CONSUMERS ENERGY CO
1945 W PARNALL RD
JACKSON, MI 49201

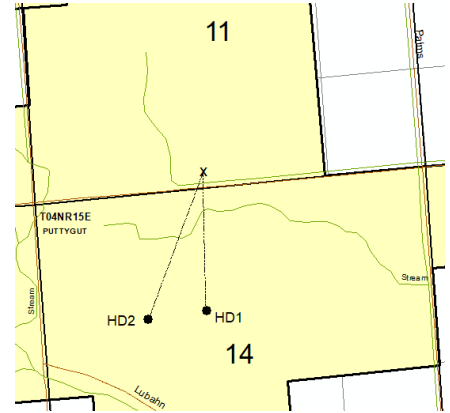

Prev Permit: Pending

Well Name: P -302 HD2

Surface Owner: Consumers Energy

Well Type: GS

True Vertical Depth: 2531

Permit Type: Reentry

Target Formation: NIAGARAN BROWN

H2S Present? No

Deepest Formation: NIAGARAN BROWN

No Drilling Unit, Puttygut Gas Storage Field

Location:	QT QT QT	Sec	Township	Range	Township Name	County	Feet From Section Line	Feet From DRLG Unit Line
SL:	SESESW	11	4N	15E	CASCO	SAINT CLAIR	211 S 2363 W	
BHL:	NWSENW	14	4N	15E	CASCO	SAINT CLAIR	1695 N 1413 W	

Michigan Department of
Environment, Great Lakes, and Energy
Oil, Gas and Minerals Division

UPDATED PERMITS

09/12/2022 THRU 09/16/2022



Permit Number Permittee Number Permittee Name

PLUGGING INSTRUCTIONS ISSUED:

17607 491 CONSUMERS ENERGY CO
1945 W PARNALL RD
JACKSON, MI 49201

API Well Number: 21-113-17607-00-00

Well Name: MICHIGAN GAS STORAGE CO 125

Plug Inst. Issue Date: 9/14/2022

Location	QT QT QT	Sec	Township	Range	Township Name	County	Feet From Section Line	Feet From DRLG Unit
SL:	SESWNE	22	21N	7W	RIVERSIDE	MISSAUKEE	637 S 790 W	660 S 653 W
BHL:	SESWNE	22	21N	7W	RIVERSIDE	MISSAUKEE		

Comment: App to P&A expires on 9/14/2023

17645 491 CONSUMERS ENERGY CO
1945 W PARNALL RD
JACKSON, MI 49201

API Well Number: 21-113-17645-00-00

Well Name: MGSC 150

Plug Inst. Issue Date: 9/14/2022

Location	QT QT QT	Sec	Township	Range	Township Name	County	Feet From Section Line	Feet From DRLG Unit
SL:	NWNESW	23	21N	7W	RIVERSIDE	MISSAUKEE	75 N 1245 E	75 N 1245 E
BHL:	NWNESW	23	21N	7W	RIVERSIDE	MISSAUKEE		

Comment: App to P&A expires on 9/14/2023

Michigan Department of
Environment, Great Lakes, and Energy
Oil, Gas and Minerals Division

UPDATED PERMITS

09/12/2022 THRU 09/16/2022



Permit Number Permittee Number Permittee Name

Page 2

17699 491 CONSUMERS ENERGY
CO1945 W PARNALL RD
JACKSON, MI 49201

API Well Number: 21-113-17699-00-00

Well Name: MICHIGAN GAS STORAGE
COMPANY 165

Plug Inst. Issue Date: 9/14/2022

Location	QT QT QT	Sec	Township	Range	Township Name	County	Feet From Section Line	Feet From DRLG Unit
SL:	NWSWNE	22	21N	7W	RIVERSIDE	MISSAUKEE	1370 N 50 W	
BHL:	NWSWNE	22	21N	7W	RIVERSIDE	MISSAUKEE		

Comment: App to P&A expires on 9/14/2023

17713 491 CONSUMERS ENERGY CO
1945 W PARNALL RD
JACKSON, MI 49201

API Well Number: 21-113-17713-00-00

Well Name: M G S C 146

Plug Inst. Issue Date: 9/14/2022

Location	QT QT QT	Sec	Township	Range	Township Name	County	Feet From Section Line	Feet From DRLG Unit
SL:	SWSWNE	22	21N	7W	RIVERSIDE	MISSAUKEE	150 S 50 W	150 S 50 W
BHL:	SWSWNE	22	21N	7W	RIVERSIDE	MISSAUKEE		

Comment: App to P&A expires on 9/14/2023

Michigan Department of
Environment, Great Lakes, and Energy
Oil, Gas and Minerals Division

UPDATED PERMITS

09/12/2022 THRU 09/16/2022



33982	5934	MERIDIAN PRODUCTION SERVICES LLC P.O. BOX 610 HASLETT, MI 48840
-------	------	---

API Well Number: 21-065-33926-02-00

Well Name: WALKER 1-29B

True Vertical Depth: 4276

Plug Inst. Issue Date: 9/13/2022

Location	QT QT QT	Sec	Township	Range	Township Name	County	Feet From Section Line	Feet From DRLG Unit
SL:	SWNWSW	29	2N	2E	WHITE OAK	INGHAM	860 N 460 W	
BHL:	SENESE	30	2N	2E	WHITE OAK	INGHAM	926 N 45 E	394 S 1275 W

Comment: App to P&A expires on 10/15/2022

54788	6361	RIVERSIDE ENERGY MICHIGAN LLC 10691 EAST CARTER ROAD SUITE 201 TRAVERSE CITY, MI 49684
-------	------	---

API Well Number: 21-137-54788-00-00

Well Name: FONTINALIS CLUB D2-24

Plug Inst. Issue Date: 9/12/2022

Location	QT QT QT	Sec	Township	Range	Township Name	County	Feet From Section Line	Feet From DRLG Unit
SL:	NWSESW	24	32N	3W	CORWITH	OTSEGO	1260 S 1785 W	
BHL:	NWSESW	24	32N	3W	CORWITH	OTSEGO		

Comment: App to P&A expires on 3/31/2023

Michigan Department of
Environment, Great Lakes, and Energy
Oil, Gas and Minerals Division

UPDATED PERMITS

09/12/2022 THRU 09/16/2022



Permit Number Permittee Number Permittee Name

7954 6352 CHRISTIAN OIL CO INC
2589 30TH STREET
ALLEGAN, MI 49010

API Well Number: 21-081-07954-00-00

Well Name: BURGESS, GREEN 2

Plug Inst. Issue Date: 9/14/2022

Location	QT QT QT	Sec	Township	Range	Township Name	County	Feet From Section Line	Feet From DRLG Unit
SL:	SESENW	32	7N	12W	WALKER	KENT	330 S 330 E	
BHL:	SESENW	32	7N	12W	WALKER	KENT		

Comment: App to P&A expires on 9/14/2023

Michigan Department of
Environment, Great Lakes, and Energy
Oil, Gas and Minerals Division

UPDATED PERMITS

09/12/2022 THRU 09/16/2022



Permit Number Permittee Number Permittee Name

RECORD OF WELL PLUGGING:

15345 4428 MID MICHIGAN GAS STORAGE CO
P.O. BOX 2446
HOUSTON, TX 77252-2446 USA

API Well Number: 21-133-15345-01-00

Well Name: MCGC 73

Plugging Date: 7/20/2022

Location	QT QT QT	Sec	Township	Range	Township Name	County	Feet From Section Line	Feet From DRLG Unit
SL:	NESWSE	19	18N	10W	LINCOLN	OSCEOLA	1270 S 1270 W	610 S 610 W
BHL:	NESWSE	19	18N	10W	LINCOLN	OSCEOLA		

21107 4428 MID MICHIGAN GAS STORAGE CO
P.O. BOX 2446
HOUSTON, TX 77252-2446 USA

API Well Number: 21-133-21107-00-00

Well Name: CLARK, H J 3

Plugging Date: 8/18/2022

Location	QT QT QT	Sec	Township	Range	Township Name	County	Feet From Section Line	Feet From DRLG Unit
SL:	CNNWSW	4	17N	10W	RICHMOND	OSCEOLA	640 N 660 W	680 S 660 W
BHL:	CNNWSW	4	17N	10W	RICHMOND	OSCEOLA		

Michigan Department of
Environment, Great Lakes, and Energy
Oil, Gas and Minerals Division

UPDATED PERMITS

09/12/2022 THRU 09/16/2022



Permit Number Permittee Number Permittee Name

38925 47 MILLER ENERGY COMPANY II LLC
10850 E TRAVERSE HWY
SUITE 3375
TRAVERSE CITY, MI 49684

API Well Number: 21-111-38925-00-00

Well Name: HORNSBY ET AL 1-28

True Vertical Depth: 2593

Plugging Date: 8/18/2022

Location	QT QT QT	Sec	Township	Range	Township Name	County	Feet From Section Line	Feet From DRLG Unit
SL:	NWNENW	28	15N	2E	LARKIN	MIDLAND	550 N 826 E	
BHL:	NENENW	28	15N	2E	LARKIN	MIDLAND	471 N 455 E	471 N 455 E

44852 25 DELTA OIL CO INC
125 WINDSOR DR STE 101
OAK BROOK, IL 60523

API Well Number: 21-137-44852-00-00

Well Name: BOUGHNER A3-31

Plugging Date: 7/10/2017

Location	QT QT QT	Sec	Township	Range	Township Name	County	Feet From Section Line	Feet From DRLG Unit
SL:	SEWNNE	31	31N	1W	CHARLTON	OTSEGO	993 N 939 W	350 S 376 E
BHL:	SEWNNE	31	31N	1W	CHARLTON	OTSEGO		

Michigan Department of
Environment, Great Lakes, and Energy
Oil, Gas and Minerals Division

UPDATED PERMITS

09/12/2022 THRU 09/16/2022



Permit Number Permittee Number Permittee Name

56139 4605 SCHMUDE OIL INC
P.O. BOX 1008
TRAVERSE CITY, MI 49685-1008

API Well Number: 21-055-56139-00-00

Well Name: PLOSHCHANSKY 9-20 HD True Vertical Depth: 5848

Plugging Date: 9/2/2022

Location	QT QT QT	Sec	Township	Range	Township Name	County	Feet From Section Line	Feet From DRLG Unit
SL:	NENESE	20	25N	12W	GRANT	GRAND TRAVERSE	2156 S 133 E	
BHL:	NWNWSE	20	25N	12W	GRANT	GRAND TRAVERSE	2124 S 2170 E	486 N 482 W

60465 47 MILLER ENERGY COMPANY II LLC
10850 E TRAVERSE HWY
SUITE 3375
TRAVERSE CITY, MI 49684

API Well Number: 21-073-60465-00-00

Well Name: CUMMINS 1-20

Plugging Date: 4/30/2016

Location	QT QT QT	Sec	Township	Range	Township Name	County	Feet From Section Line	Feet From DRLG Unit
SL:	NESESW	20	15N	6W	SHERMAN	ISABELLA	660 S 330 E	656 N 330 E
BHL:	NESESW	20	15N	6W	SHERMAN	ISABELLA		

Michigan Department of
Environment, Great Lakes, and Energy
Oil, Gas and Minerals Division

UPDATED PERMITS

09/12/2022 THRU 09/16/2022



Permit Number Permittee Number Permittee Name

8502 4428 MID MICHIGAN GAS STORAGE CO
P.O. BOX 2446
HOUSTON, TX 77252-2446 USA

API Well Number: 21-133-08502-00-00

Well Name: RADER-GINGRICH 6

Plugging Date: 8/18/2022

Location	QT QT QT	Sec	Township	Range	Township Name	County	Feet From Section Line	Feet From DRLG Unit
SL:	CNSW	30	18N	10W	LINCOLN	OSCEOLA	1320 S 1320 W	
BHL:		30	18N	10W	LINCOLN	OSCEOLA		

8816 4428 MID MICHIGAN GAS STORAGE CO
P.O. BOX 2446
HOUSTON, TX 77252-2446 USA

API Well Number: 21-133-08816-00-00

Well Name: LOMP, MARY 3

Plugging Date: 7/20/2022

Location	QT QT QT	Sec	Township	Range	Township Name	County	Feet From Section Line	Feet From DRLG Unit
SL:	S2NENE	31	18N	10W	LINCOLN	OSCEOLA	990 N 660 E	330 S 660 E
BHL:	S2NENE	31	18N	10W	LINCOLN	OSCEOLA		

Michigan Department of
Environment, Great Lakes, and Energy
Oil, Gas and Minerals Division

UPDATED PERMITS

09/12/2022 THRU 09/16/2022



Permit Number Permittee Number Permittee Name

8974 4428 MID MICHIGAN GAS STORAGE CO
P.O. BOX 2446
HOUSTON, TX 77252-2446 USA

API Well Number: 21-133-08974-00-00

Well Name: GABEL, LOUIE B-1

Plugging Date: 8/3/2022

Location	QT QT QT	Sec	Township	Range	Township Name	County	Feet From Section Line	Feet From DRLG Unit
SL:	N2NWSW	31	18N	10W	LINCOLN	OSCEOLA	330 N 660 W	330 N 660 W
BHL:	N2NWSW	31	18N	10W	LINCOLN	OSCEOLA		

9139 4428 MID MICHIGAN GAS STORAGE CO
P.O. BOX 2446
HOUSTON, TX 77252-2446 USA

API Well Number: 21-133-09139-00-00

Well Name: RICHARDS, DAN B-1

Plugging Date: 8/23/2022

Location	QT QT QT	Sec	Township	Range	Township Name	County	Feet From Section Line	Feet From DRLG Unit
SL:	S2NWNE	19	18N	10W	LINCOLN	OSCEOLA	990 N 660 W	330 S 660 E
BHL:	S2NWNE	19	18N	10W	LINCOLN	OSCEOLA		

Michigan Department of
Environment, Great Lakes, and Energy
Oil, Gas and Minerals Division

UPDATED PERMITS

09/12/2022 THRU 09/16/2022



Permit Number Permittee Number Permittee Name

9143 4428 MID MICHIGAN GAS STORAGE CO
P.O. BOX 2446
HOUSTON, TX 77252-2446 USA

API Well Number: 21-133-09143-00-00

Well Name: STATE 27

Plugging Date: 8/25/2022

Location	QT QT QT	Sec	Township	Range	Township Name	County	Feet From Section Line	Feet From DRLG Unit
SL:	CNSE	17	18N	10W	LINCOLN	OSCEOLA	1320 S 1320 W	1320 N 1320 E
BHL:		17	18N	10W	LINCOLN	OSCEOLA		

9184 4428 MID MICHIGAN GAS STORAGE CO
P.O. BOX 2446
HOUSTON, TX 77252-2446 USA

API Well Number: 21-133-09184-00-00

Well Name: EICHENBERG & JOHNSON 28

Plugging Date: 8/10/2022

Location	QT QT QT	Sec	Township	Range	Township Name	County	Feet From Section Line	Feet From DRLG Unit
SL:	CNNW	17	18N	10W	LINCOLN	OSCEOLA	1320 S 1320 W	1320 N 1320 E
BHL:		17	18N	10W	LINCOLN	OSCEOLA		

Michigan Department of
Environment, Great Lakes, and Energy
Oil, Gas and Minerals Division

UPDATED PERMITS

09/12/2022 THRU 09/16/2022



Permit Number Permittee Number Permittee Name

9356 4428 MID MICHIGAN GAS STORAGE CO
P.O. BOX 2446
HOUSTON, TX 77252-2446 USA

API Well Number: 21-133-09356-00-00

Well Name: KENT 34

Plugging Date: 8/25/2022

Location	QT QT QT	Sec	Township	Range	Township Name	County	Feet From Section Line	Feet From DRLG Unit
SL:	CNSW	18	18N	10W	LINCOLN	OSCEOLA	1320 S 1320 W	1320 N 1320 E
BHL:		18	18N	10W	LINCOLN	OSCEOLA		



Michigan Department of
Environment, Great Lakes, and Energy
Oil, Gas and Minerals Division

UPDATED PERMITS

09/12/2022 THRU 09/16/2022



Permit Number Permittee Number Permittee Name

APPLICATIONS TO CHANGE WELL STATUS:

20650 491 CONSUMERS ENERGY CO
1945 W PARNALL RD
JACKSON, MI 49201

API Well Number: 21-035-20650-00-00

Well Name: M G S C 910

Approval Date: 9/15/2022

Location	QT QT QT	Sec	Township	Range	Township Name	County	Feet From Section Line	Feet From DRLG Unit
SL:	SESENE	19	20N	6W	WINTERFIELD	CLARE	50 S 100 E	50 S 100 E
BHL:	SESENE	19	20N	6W	WINTERFIELD	CLARE		

Proposed Rework: ACOWS for Miscellaneous

Comment: ACOWS to clean well, log, underream, perf F/ 1323' T/ 1328', acidize, and return well to service expires 9/15/2023

39796 47 MILLER ENERGY COMPANY II LLC
10850 E TRAVERSE HWY
SUITE 3375
TRAVERSE CITY, MI 49684

API Well Number: 21-073-39796-00-00

Well Name: MT PLEASANT UNIT TR 120 1 True Vertical Depth: 3693

Approval Date: 9/9/2022

Location	QT QT QT	Sec	Township	Range	Township Name	County	Feet From Section Line	Feet From DRLG Unit
SL:	NWSWSW	1	14N	3W	CHIPPEWA	ISABELLA	1026 S 542 W	
BHL:	SWNWSW	1	14N	3W	CHIPPEWA	ISABELLA	1067 N 563 W	

Proposed Rework: ACOWS to Perforate and Test Current Formation

Comment: ACOWS to perf and stimulate current formation (Michigan Stray) F/ 1167' T/ 1173' expires on 9/9/2023