

Michigan Department of  
Environment, Great Lakes, and Energy  
Oil, Gas and Minerals Division

PERMIT APPLICATIONS

11/07/2022 THRU 11/11/2022



Application Number    Date Received    Permittee Number    Permittee Name

797                    11/09/2022            5320                    SAVOY ENERGY LP  
920 HASTINGS STREET, SUITE A  
P.O. BOX 1560  
TRAVERSE CITY, MI 49685-1560

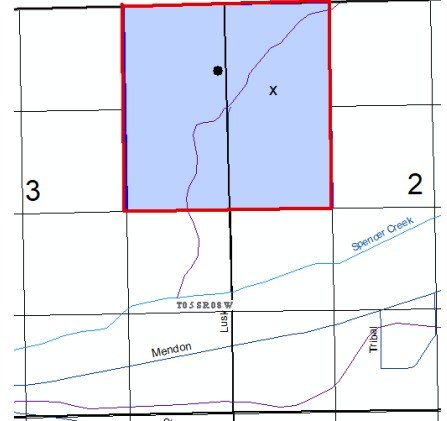

160-Acre R303 Drilling Unit, E/2  
NE/4 Sec 3, W/2 NW/4 Sec 2

Prev Permit: 61656

Well Name: Riddle 1-2A

Surface Owner: Riddle, Freeman & Anita L.

Well Type: OIL

True Vertical Depth: 3750

Permit Type: Reentry

Target Formation: TRENTON

H2S Present? No

Deepest Formation: PRAIRIE DU CHIEN

Location:	QT QT QT	Sec	Township	Range	Township Name	County	Feet From Section Line	Feet From DRLG Unit Line
SL:	SWNWNW	2	5S	8W	SHERWOOD	BRANCH	1125 N 607 W	
BHL:	SENE NE	3	5S	8W	SHERWOOD	BRANCH	868 N 134 E	868 N 134 E

Michigan Department of  
Environment, Great Lakes, and Energy  
Oil, Gas and Minerals Division

UPDATED PERMITS

11/07/2022 THRU 11/11/2022



Permit Number      Permittee Number      Permittee Name

**PLUGGING INSTRUCTIONS ISSUED:**

60385      104      WEST BAY EXPLORATION COMPANY  
13685 S WEST BAYSHORE DR  
TRAVERSE CITY, MI 49684

API Well Number: 21-075-60385-01-00

Well Name: WEST BAY 1-35 HD1      True Vertical Depth: 4189

Plug Inst. Issue Date: 11/1/2022

Location	QT QT QT	Sec	Township	Range	Township Name	County	Feet From Section Line	Feet From DRLG Unit
SL:	SWSENW	35	4S	2E	NORVELL	JACKSON	2630 N 1437 W	
BHL:	SWSENW	35	4S	2E	NORVELL	JACKSON	2310 N 1654 W	331 N 332 W

Comment: App to P&A expires on 11/1/2023

60435      104      WEST BAY EXPLORATION COMPANY  
13685 S WEST BAYSHORE DR  
TRAVERSE CITY, MI 49684

API Well Number: 21-075-60435-01-00

Well Name: WEST BAY 1-34 HD2      True Vertical Depth: 4217

Plug Inst. Issue Date: 11/1/2022

Location	QT QT QT	Sec	Township	Range	Township Name	County	Feet From Section Line	Feet From DRLG Unit
SL:	NWNESW	35	4S	2E	NORVELL	JACKSON	76 N 1209 E	
BHL:	SWSENE	34	4S	2E	NORVELL	JACKSON	2328 N 1007 E	343 N 333 W

Comment: App to P&A expires on 11/1/2023

Michigan Department of  
Environment, Great Lakes, and Energy  
Oil, Gas and Minerals Division

UPDATED PERMITS

11/07/2022 THRU 11/11/2022



Permit Number      Permittee Number      Permittee Name

60517      104      WEST BAY EXPLORATION COMPANY  
13685 S WEST BAYSHORE DR  
TRAVERSE CITY, MI 49684

API Well Number: 21-075-60517-00-00

Well Name: HARDCASTLE 2-26 HD1      True Vertical Depth: 4254

Plug Inst. Issue Date: 11/1/2022

Location	QT QT QT	Sec	Township	Range	Township Name	County	Feet From Section Line	Feet From DRLG Unit
SL:	SEENW	26	4S	2E	NORVELL	JACKSON	895 N 2250 W	
BHL:	NESENW	26	4S	2E	NORVELL	JACKSON	1782 N 2377 W	851 S 411 W

Comment: App to P&A expires on 11/1/2023

Michigan Department of  
Environment, Great Lakes, and Energy  
Oil, Gas and Minerals Division

UPDATED PERMITS

11/07/2022 THRU 11/11/2022



Permit Number      Permittee Number      Permittee Name

**RECORD OF WELL PLUGGING:**

12284      4428      MID MICHIGAN GAS STORAGE CO  
P.O. BOX 2446  
HOUSTON, TX 77252-2446 USA

API Well Number: 21-107-12284-00-00

Well Name: MCGC 13

Plugging Date: 10/4/2022

Location	QT QT QT	Sec	Township	Range	Township Name	County	Feet From Section Line	Feet From DRLG Unit
SL:	CNNENE	4	14N	9W	AUSTIN	MECOSTA	660 N 660 E	660 N 660 E
BHL:	CNNENE	4	14N	9W	AUSTIN	MECOSTA		

13177      4428      MID MICHIGAN GAS STORAGE CO  
P.O. BOX 2446  
HOUSTON, TX 77252-2446 USA

API Well Number: 21-107-13177-00-00

Well Name: AUSTIN 29

Plugging Date: 10/4/2022

Location	QT QT QT	Sec	Township	Range	Township Name	County	Feet From Section Line	Feet From DRLG Unit
SL:	CNNENW	3	14N	9W	AUSTIN	MECOSTA	660 N 660 E	660 N 660 E
BHL:	CNNENW	3	14N	9W	AUSTIN	MECOSTA		

Michigan Department of  
Environment, Great Lakes, and Energy  
Oil, Gas and Minerals Division

UPDATED PERMITS

11/07/2022 THRU 11/11/2022



Permit Number      Permittee Number      Permittee Name

17049      4428      MID MICHIGAN GAS STORAGE CO  
P.O. BOX 2446  
HOUSTON, TX 77252-2446 USA

API Well Number: 21-107-17049-00-00

Well Name: MCGC 42

Plugging Date: 10/4/2022

Location	QT QT QT	Sec	Township	Range	Township Name	County	Feet From Section Line	Feet From DRLG Unit
SL:	N2SESW	11	14N	9W	AUSTIN	MECOSTA	990 S 660 E	660 S 660 E
BHL:	N2SESW	11	14N	9W	AUSTIN	MECOSTA		

17070      4428      MID MICHIGAN GAS STORAGE CO  
P.O. BOX 2446  
HOUSTON, TX 77252-2446 USA

API Well Number: 21-107-17070-00-00

Well Name: MCGC 53

Plugging Date: 10/4/2022

Location	QT QT QT	Sec	Township	Range	Township Name	County	Feet From Section Line	Feet From DRLG Unit
SL:	CNSW	3	14N	9W	AUSTIN	MECOSTA	1320 N 1320 W	660 N 660 W
BHL:		3	14N	9W	AUSTIN	MECOSTA		

Michigan Department of  
Environment, Great Lakes, and Energy  
Oil, Gas and Minerals Division

UPDATED PERMITS

11/07/2022 THRU 11/11/2022



Permit Number      Permittee Number      Permittee Name

17589      491      CONSUMERS ENERGY CO  
1945 W PARNALL RD  
JACKSON, MI 49201

API Well Number: 21-113-17589-00-00

Well Name: M G S C 139

Plugging Date: 10/21/2022

Location	QT QT QT	Sec	Township	Range	Township Name	County	Feet From Section Line	Feet From DRLG Unit
SL:	CNWSW	23	21N	7W	RIVERSIDE	MISSAUKEE	660 N 660 W	660 N 660 W
BHL:	CNWSW	23	21N	7W	RIVERSIDE	MISSAUKEE		

17645      491      CONSUMERS ENERGY CO  
1945 W PARNALL RD  
JACKSON, MI 49201

API Well Number: 21-113-17645-00-00

Well Name: MGSC 150

Plugging Date: 10/7/2022

Location	QT QT QT	Sec	Township	Range	Township Name	County	Feet From Section Line	Feet From DRLG Unit
SL:	NWNESW	23	21N	7W	RIVERSIDE	MISSAUKEE	75 N 1245 E	75 N 1245 E
BHL:	NWNESW	23	21N	7W	RIVERSIDE	MISSAUKEE		

Michigan Department of  
Environment, Great Lakes, and Energy  
Oil, Gas and Minerals Division

UPDATED PERMITS

11/07/2022 THRU 11/11/2022



Permit Number      Permittee Number      Permittee Name

2384                      4428                      MID MICHIGAN GAS STORAGE CO  
P.O. BOX 2446  
HOUSTON, TX 77252-2446 USA

API Well Number: 21-107-02384-00-00

Well Name: MICH CONSERVATION 11

Plugging Date: 10/21/2022

Location	QT QT QT	Sec	Township	Range	Township Name	County	Feet From Section Line	Feet From DRLG Unit
SL:	CNNESW	11	14N	9W	AUSTIN	MECOSTA	660 N 660 E	
BHL:	CNNESW	11	14N	9W	AUSTIN	MECOSTA		

27277                      4428                      MID MICHIGAN GAS STORAGE CO  
P.O. BOX 2446  
HOUSTON, TX 77252-2446 USA

API Well Number: 21-107-27277-00-00

Well Name: MCGC A-135

Plugging Date: 10/21/2022

Location	QT QT QT	Sec	Township	Range	Township Name	County	Feet From Section Line	Feet From DRLG Unit
SL:	S2N2NE	11	14N	9W	AUSTIN	MECOSTA	1070 N 1230 W	250 S 1230 W
BHL:	S2N2NE	11	14N	9W	AUSTIN	MECOSTA		

Michigan Department of  
Environment, Great Lakes, and Energy  
Oil, Gas and Minerals Division

UPDATED PERMITS

11/07/2022 THRU 11/11/2022



Permit Number      Permittee Number      Permittee Name

27279      4428      MID MICHIGAN GAS STORAGE CO  
P.O. BOX 2446  
HOUSTON, TX 77252-2446 USA

API Well Number: 21-107-27279-00-00

Well Name: MCGC A-137

Plugging Date: 10/21/2022

Location	QT QT QT	Sec	Township	Range	Township Name	County	Feet From Section Line	Feet From DRLG Unit
SL:	SENWSW	12	14N	9W	AUSTIN	MECOSTA	840 N 1190 W	480 S 130 E
BHL:	SENWSW	12	14N	9W	AUSTIN	MECOSTA		

31364      7772      LAMBDA ENERGY RESOURCES LLC  
12012 Wickchester  
Suite 300  
Houston, TX 77079 USA

API Well Number: 21-055-31364-00-00

Well Name: STATE UNION UNIT "M" 1-21

Plugging Date: 10/11/2022

Location	QT QT QT	Sec	Township	Range	Township Name	County	Feet From Section Line	Feet From DRLG Unit
SL:	NWSWSE	21	26N	9W	UNION	GRAND TRAVERSE	1275 S 0 W	1275 S 1330 E
BHL:	NWSWSE	21	26N	9W	UNION	GRAND TRAVERSE		



Michigan Department of  
Environment, Great Lakes, and Energy  
Oil, Gas and Minerals Division

UPDATED PERMITS

11/07/2022 THRU 11/11/2022



Permit Number      Permittee Number      Permittee Name

39457      7772      LAMBDA ENERGY RESOURCES LLC  
12012 Wickchester  
Suite 300  
Houston, TX 77079 USA

API Well Number: 21-055-39457-00-00

Well Name: STATE UNION "AH" 2-28

Plugging Date: 10/11/2022

Location	QT QT QT	Sec	Township	Range	Township Name	County	Feet From Section Line	Feet From DRLG Unit
SL:	NWSWNW	28	26N	9W	UNION	GRAND TRAVERSE	860 S 644 W	460 N 644 W
BHL:	NWSWNW	28	26N	9W	UNION	GRAND TRAVERSE		

42153      25      DELTA OIL CO INC  
125 WINDSOR DR STE 101  
OAK BROOK, IL 60523

API Well Number: 21-137-42153-00-00

Well Name: SCHRADER B4-23

Plugging Date: 2/15/2022

Location	QT QT QT	Sec	Township	Range	Township Name	County	Feet From Section Line	Feet From DRLG Unit
SL:	NESENE	23	31N	2W	DOVER	OTSEGO	939 S 350 E	356 N 350 E
BHL:	NESENE	23	31N	2W	DOVER	OTSEGO		

Michigan Department of  
Environment, Great Lakes, and Energy  
Oil, Gas and Minerals Division

UPDATED PERMITS

11/07/2022 THRU 11/11/2022



Permit Number      Permittee Number      Permittee Name

42276      25      DELTA OIL CO INC  
125 WINDSOR DR STE 101  
OAK BROOK, IL 60523

API Well Number: 21-137-42276-00-00

Well Name: BLANZY B3-22

Plugging Date: 12/21/2021

Location	QT QT QT	Sec	Township	Range	Township Name	County	Feet From Section Line	Feet From DRLG Unit
SL:	NESWNE	22	31N	2W	DOVER	OTSEGO	665 S 852 W	634 N 467 E
BHL:	NESWNE	22	31N	2W	DOVER	OTSEGO		

42426      25      DELTA OIL CO INC  
125 WINDSOR DR STE 101  
OAK BROOK, IL 60523

API Well Number: 21-137-42426-00-00

Well Name: BLANZY A3-22

Plugging Date: 12/27/2021

Location	QT QT QT	Sec	Township	Range	Township Name	County	Feet From Section Line	Feet From DRLG Unit
SL:	NWNWNE	22	31N	2W	DOVER	OTSEGO	340 N 340 W	340 N 340 W
BHL:	NWNWNE	22	31N	2W	DOVER	OTSEGO		

Michigan Department of  
Environment, Great Lakes, and Energy  
Oil, Gas and Minerals Division

UPDATED PERMITS

11/07/2022 THRU 11/11/2022



Permit Number      Permittee Number      Permittee Name

42427      25      DELTA OIL CO INC  
125 WINDSOR DR STE 101  
OAK BROOK, IL 60523

API Well Number: 21-137-42427-00-00

Well Name: BLANZY A4-22

Plugging Date: 12/29/2021

Location	QT QT QT	Sec	Township	Range	Township Name	County	Feet From Section Line	Feet From DRLG Unit
SL:	NWNENE	22	31N	2W	DOVER	OTSEGO	549 N 924 E	549 N 399 W
BHL:	NWNENE	22	31N	2W	DOVER	OTSEGO		

42506      25      DELTA OIL CO INC  
125 WINDSOR DR STE 101  
OAK BROOK, IL 60523

API Well Number: 21-137-42506-00-00

Well Name: GORING B1-24

Plugging Date: 1/14/2022

Location	QT QT QT	Sec	Township	Range	Township Name	County	Feet From Section Line	Feet From DRLG Unit
SL:	SESWNW	24	31N	2W	DOVER	OTSEGO	330 S 988 W	330 S 330 E
BHL:	SESWNW	24	31N	2W	DOVER	OTSEGO		

Michigan Department of  
Environment, Great Lakes, and Energy  
Oil, Gas and Minerals Division

UPDATED PERMITS

11/07/2022 THRU 11/11/2022



Permit Number      Permittee Number      Permittee Name

43272      25      DELTA OIL CO INC  
125 WINDSOR DR STE 101  
OAK BROOK, IL 60523

API Well Number: 21-137-43272-00-00

Well Name: ANCEL D3-16

Plugging Date: 11/10/2021

Location	QT QT QT	Sec	Township	Range	Township Name	County	Feet From Section Line	Feet From DRLG Unit
SL:	NESWSE	16	31N	2W	DOVER	OTSEGO	981 S 732 W	333 N 580 E
BHL:	NESWSE	16	31N	2W	DOVER	OTSEGO		

43730      25      DELTA OIL CO INC  
125 WINDSOR DR STE 101  
OAK BROOK, IL 60523

API Well Number: 21-137-43730-00-00

Well Name: MATUSIK D2-21

Plugging Date: 10/26/2021

Location	QT QT QT	Sec	Township	Range	Township Name	County	Feet From Section Line	Feet From DRLG Unit
SL:	SESESW	21	31N	2W	DOVER	OTSEGO	350 S 350 E	350 S 350 E
BHL:	SESESW	21	31N	2W	DOVER	OTSEGO		

Michigan Department of  
Environment, Great Lakes, and Energy  
Oil, Gas and Minerals Division

UPDATED PERMITS

11/07/2022 THRU 11/11/2022



Permit Number      Permittee Number      Permittee Name

43757      25      DELTA OIL CO INC  
125 WINDSOR DR STE 101  
OAK BROOK, IL 60523

API Well Number: 21-137-43757-00-00

Well Name: FORTERRA D1-15

Plugging Date: 11/12/2021

Location	QT QT QT	Sec	Township	Range	Township Name	County	Feet From Section Line	Feet From DRLG Unit
SL:	NESWSW	15	31N	2W	DOVER	OTSEGO	669 S 980 W	651 N 335 E
BHL:	NESWSW	15	31N	2W	DOVER	OTSEGO		

43799      25      DELTA OIL CO INC  
125 WINDSOR DR STE 101  
OAK BROOK, IL 60523

API Well Number: 21-137-43799-00-00

Well Name: LAWNICHAK A2-33

Plugging Date: 10/19/2021

Location	QT QT QT	Sec	Township	Range	Township Name	County	Feet From Section Line	Feet From DRLG Unit
SL:	SEENW	33	31N	2W	DOVER	OTSEGO	785 N 345 E	521 S 345 E
BHL:	SEENW	33	31N	2W	DOVER	OTSEGO		

Michigan Department of  
Environment, Great Lakes, and Energy  
Oil, Gas and Minerals Division

UPDATED PERMITS

11/07/2022 THRU 11/11/2022



Permit Number      Permittee Number      Permittee Name

43865      25      DELTA OIL CO INC  
125 WINDSOR DR STE 101  
OAK BROOK, IL 60523

API Well Number: 21-137-43865-00-00

Well Name: KUBACKI A4-26

Plugging Date: 1/10/2022

Location	QT QT QT	Sec	Township	Range	Township Name	County	Feet From Section Line	Feet From DRLG Unit
SL:	NWNENE	26	31N	2W	DOVER	OTSEGO	636 N 986 E	636 N 330 W
BHL:	NWNENE	26	31N	2W	DOVER	OTSEGO		

44153      25      DELTA OIL CO INC  
125 WINDSOR DR STE 101  
OAK BROOK, IL 60523

API Well Number: 21-137-44153-00-00

Well Name: BOUGHNER C2-28

Plugging Date: 10/21/2021

Location	QT QT QT	Sec	Township	Range	Township Name	County	Feet From Section Line	Feet From DRLG Unit
SL:	SWNESW	28	31N	2W	DOVER	OTSEGO	668 N 918 E	616 S 395 W
BHL:	SWNESW	28	31N	2W	DOVER	OTSEGO		

Michigan Department of  
Environment, Great Lakes, and Energy  
Oil, Gas and Minerals Division

UPDATED PERMITS

11/07/2022 THRU 11/11/2022



Permit Number      Permittee Number      Permittee Name

45494      25      DELTA OIL CO INC  
125 WINDSOR DR STE 101  
OAK BROOK, IL 60523

API Well Number: 21-137-45494-00-00

Well Name: SNOWDAY D1-22

Plugging Date: 10/8/2021

Location	QT QT QT	Sec	Township	Range	Township Name	County	Feet From Section Line	Feet From DRLG Unit
SL:	SESWSW	22	31N	2W	DOVER	OTSEGO	540 S 914 W	540 S 398 E
BHL:	SESWSW	22	31N	2W	DOVER	OTSEGO		

45495      25      DELTA OIL CO INC  
125 WINDSOR DR STE 101  
OAK BROOK, IL 60523

API Well Number: 21-137-45495-00-00

Well Name: SNOWDAY D2-22

Plugging Date: 10/12/2021

Location	QT QT QT	Sec	Township	Range	Township Name	County	Feet From Section Line	Feet From DRLG Unit
SL:	NESESW	22	31N	2W	DOVER	OTSEGO	737 S 340 E	563 N 340 E
BHL:	NESESW	22	31N	2W	DOVER	OTSEGO		

Michigan Department of  
Environment, Great Lakes, and Energy  
Oil, Gas and Minerals Division

UPDATED PERMITS

11/07/2022 THRU 11/11/2022



Permit Number      Permittee Number      Permittee Name

46058      25      DELTA OIL CO INC  
125 WINDSOR DR STE 101  
OAK BROOK, IL 60523

API Well Number: 21-137-46058-00-00

Well Name: BOUGHNER B4-28

True Vertical Depth: 1281

Plugging Date: 10/14/2021

Location	QT QT QT	Sec	Township	Range	Township Name	County	Feet From Section Line	Feet From DRLG Unit
SL:	NENESE	28	31N	2W	DOVER	OTSEGO	160 N 350 E	
BHL:	SESENE	28	31N	2W	DOVER	OTSEGO	664 S 529 E	656 N 529 E

46449      25      DELTA OIL CO INC  
125 WINDSOR DR STE 101  
OAK BROOK, IL 60523

API Well Number: 21-137-46449-00-00

Well Name: STATE DOVER A1-25

Plugging Date: 2/24/2022

Location	QT QT QT	Sec	Township	Range	Township Name	County	Feet From Section Line	Feet From DRLG Unit
SL:	SWNWNW	25	31N	2W	DOVER	OTSEGO	900 N 587 W	395 S 587 W
BHL:	SWNWNW	25	31N	2W	DOVER	OTSEGO		



Michigan Department of  
Environment, Great Lakes, and Energy  
Oil, Gas and Minerals Division

UPDATED PERMITS

11/07/2022 THRU 11/11/2022



Permit Number      Permittee Number      Permittee Name

48034      6361      RIVERSIDE ENERGY MICHIGAN LLC  
10691 EAST CARTER ROAD  
SUITE 201  
TRAVERSE CITY, MI 49684

API Well Number: 21-119-48034-00-00

Well Name: C C LAND B2-10 SWD

Plugging Date: 10/24/2022

Location	QT QT QT	Sec	Township	Range	Township Name	County	Feet From Section Line	Feet From DRLG Unit
SL:	SWSEW	10	29N	4E	RUST	MONTMORENCY	204 S 1216 E	
BHL:	SWSEW	10	29N	4E	RUST	MONTMORENCY		

49105      6361      RIVERSIDE ENERGY MICHIGAN LLC  
10691 EAST CARTER ROAD  
SUITE 201  
TRAVERSE CITY, MI 49684

API Well Number: 21-009-49105-00-00

Well Name: GREEN RIVER SOUTH A3-2

Plugging Date: 10/24/2022

Location	QT QT QT	Sec	Township	Range	Township Name	County	Feet From Section Line	Feet From DRLG Unit
SL:	NWNWNE	2	29N	6W	MANCELONA	ANTRIM	660 N 330 W	660 N 330 W
BHL:	NWNWNE	2	29N	6W	MANCELONA	ANTRIM		

Michigan Department of  
Environment, Great Lakes, and Energy  
Oil, Gas and Minerals Division

UPDATED PERMITS

11/07/2022 THRU 11/11/2022



Permit Number      Permittee Number      Permittee Name

49255      25      DELTA OIL CO INC  
125 WINDSOR DR STE 101  
OAK BROOK, IL 60523

API Well Number: 21-137-34215-01-00

Well Name: STATE DOVER & HOUSE 1-33A      True Vertical Depth: 5279

Plugging Date: 11/22/2021

Location	QT QT QT	Sec	Township	Range	Township Name	County	Feet From Section Line	Feet From DRLG Unit
SL:	SWSWSW	28	31N	2W	DOVER	OTSEGO	373 S 630 W	947 N 630 W
BHL:	SWNWNW	33	31N	2W	DOVER	OTSEGO	857 N 208 W	857 N 1101 E

50158      25      DELTA OIL CO INC  
125 WINDSOR DR STE 101  
OAK BROOK, IL 60523

API Well Number: 21-137-50158-00-00

Well Name: STATE DOVER A2-3

Plugging Date: 1/3/2022

Location	QT QT QT	Sec	Township	Range	Township Name	County	Feet From Section Line	Feet From DRLG Unit
SL:	NENENW	3	31N	2W	DOVER	OTSEGO	390 N 360 E	390 N 360 E
BHL:	NENENW	3	31N	2W	DOVER	OTSEGO		

Michigan Department of  
Environment, Great Lakes, and Energy  
Oil, Gas and Minerals Division

UPDATED PERMITS

11/07/2022 THRU 11/11/2022



Permit Number      Permittee Number      Permittee Name

51141      6361      RIVERSIDE ENERGY MICHIGAN LLC  
10691 EAST CARTER ROAD  
SUITE 201  
TRAVERSE CITY, MI 49684

API Well Number: 21-029-51141-00-00

Well Name: THAYER C4-36

Plugging Date: 10/7/2022

Location	QT QT QT	Sec	Township	Range	Township Name	County	Feet From Section Line	Feet From DRLG Unit
SL:	NWNESE	36	32N	7W	SOUTH ARM	CHARLEVOIX	345 N 917 E	345 N 917 E
BHL:	NWNESE	36	32N	7W	SOUTH ARM	CHARLEVOIX		

51151      6361      RIVERSIDE ENERGY MICHIGAN LLC  
10691 EAST CARTER ROAD  
SUITE 201  
TRAVERSE CITY, MI 49684

API Well Number: 21-029-51151-00-00

Well Name: AUSTIN B4-31

Plugging Date: 10/7/2022

Location	QT QT QT	Sec	Township	Range	Township Name	County	Feet From Section Line	Feet From DRLG Unit
SL:	SESENE	31	32N	6W	WILSON	CHARLEVOIX	570 S 494 E	470 S 494 E
BHL:	SESENE	31	32N	6W	WILSON	CHARLEVOIX		

Michigan Department of  
Environment, Great Lakes, and Energy  
Oil, Gas and Minerals Division

UPDATED PERMITS

11/07/2022 THRU 11/11/2022



Permit Number      Permittee Number      Permittee Name

51471      6361      RIVERSIDE ENERGY MICHIGAN LLC  
10691 EAST CARTER ROAD  
SUITE 201  
TRAVERSE CITY, MI 49684

API Well Number: 21-029-51471-00-00

Well Name: OLSTROM A3-32

Plugging Date: 10/7/2022

Location	QT QT QT	Sec	Township	Range	Township Name	County	Feet From Section Line	Feet From DRLG Unit
SL:	SWNWNW	32	32N	6W	WILSON	CHARLEVOIX	950 N 400 W	950 N 400 W
BHL:	SWNWNW	32	32N	6W	WILSON	CHARLEVOIX		

51475      6361      RIVERSIDE ENERGY MICHIGAN LLC  
10691 EAST CARTER ROAD  
SUITE 201  
TRAVERSE CITY, MI 49684

API Well Number: 21-029-51475-00-00

Well Name: RICHARDS C1-32

Plugging Date: 10/7/2022

Location	QT QT QT	Sec	Township	Range	Township Name	County	Feet From Section Line	Feet From DRLG Unit
SL:	NENWSW	32	32N	6W	WILSON	CHARLEVOIX	500 N 970 W	500 N 350 E
BHL:	NENWSW	32	32N	6W	WILSON	CHARLEVOIX		

Michigan Department of  
Environment, Great Lakes, and Energy  
Oil, Gas and Minerals Division

UPDATED PERMITS

11/07/2022 THRU 11/11/2022



Permit Number      Permittee Number      Permittee Name

53532      25      DELTA OIL CO INC  
125 WINDSOR DR STE 101  
OAK BROOK, IL 60523

API Well Number: 21-137-53532-00-00

Well Name: SCHRADER D3-14

Plugging Date: 1/12/2022

Location	QT QT QT	Sec	Township	Range	Township Name	County	Feet From Section Line	Feet From DRLG Unit
SL:	SESWSE	14	31N	2W	DOVER	OTSEGO	630 S 1570 E	630 S 1070 W
BHL:	SESWSE	14	31N	2W	DOVER	OTSEGO		

53798      25      DELTA OIL CO INC  
125 WINDSOR DR STE 101  
OAK BROOK, IL 60523

API Well Number: 21-137-53798-00-00

Well Name: STATE DOVER C2-24

Plugging Date: 2/18/2022

Location	QT QT QT	Sec	Township	Range	Township Name	County	Feet From Section Line	Feet From DRLG Unit
SL:	SENESEW	24	31N	2W	DOVER	OTSEGO	1873 S 2109 W	737 N 510 E
BHL:	SENESEW	24	31N	2W	DOVER	OTSEGO		

Michigan Department of  
Environment, Great Lakes, and Energy  
Oil, Gas and Minerals Division

UPDATED PERMITS

11/07/2022 THRU 11/11/2022



Permit Number      Permittee Number      Permittee Name

59627      6361      RIVERSIDE ENERGY MICHIGAN LLC  
10691 EAST CARTER ROAD  
SUITE 201  
TRAVERSE CITY, MI 49684

API Well Number: 21-009-59627-00-00

Well Name: GEBHARD B3-19

Plugging Date: 10/6/2022

Location	QT QT QT	Sec	Township	Range	Township Name	County	Feet From Section Line	Feet From DRLG Unit
SL:	SWSWNE	19	31N	7W	ECHO	ANTRIM	2175 N 2089 E	865 N 553 W
BHL:	SWSWNE	19	31N	7W	ECHO	ANTRIM		

59628      6361      RIVERSIDE ENERGY MICHIGAN LLC  
10691 EAST CARTER ROAD  
SUITE 201  
TRAVERSE CITY, MI 49684

API Well Number: 21-009-59628-00-00

Well Name: SCOTT C4-19

Plugging Date: 10/6/2022

Location	QT QT QT	Sec	Township	Range	Township Name	County	Feet From Section Line	Feet From DRLG Unit
SL:	NENESE	19	31N	7W	ECHO	ANTRIM	2289 S 340 E	348 N 340 E
BHL:	NENESE	19	31N	7W	ECHO	ANTRIM		

Michigan Department of  
Environment, Great Lakes, and Energy  
Oil, Gas and Minerals Division

UPDATED PERMITS

11/07/2022 THRU 11/11/2022



Permit Number      Permittee Number      Permittee Name

59629      6361      RIVERSIDE ENERGY MICHIGAN LLC  
10691 EAST CARTER ROAD  
SUITE 201  
TRAVERSE CITY, MI 49684

API Well Number: 21-009-59629-00-00

Well Name: STATE ECHO & WILLSON D4-20

Plugging Date: 10/11/2022

Location	QT QT QT	Sec	Township	Range	Township Name	County	Feet From Section Line	Feet From DRLG Unit
SL:	SWSESE	20	31N	7W	ECHO	ANTRIM	330 S 825 E	330 S 482 W
BHL:	SWSESE	20	31N	7W	ECHO	ANTRIM		

59659      6361      RIVERSIDE ENERGY MICHIGAN LLC  
10691 EAST CARTER ROAD  
SUITE 201  
TRAVERSE CITY, MI 49684

API Well Number: 21-009-59659-00-00

Well Name: STATE ECHO & WILLSON D3-20

Plugging Date: 10/11/2022

Location	QT QT QT	Sec	Township	Range	Township Name	County	Feet From Section Line	Feet From DRLG Unit
SL:	SWSWSE	20	31N	7W	ECHO	ANTRIM	590 S 2204 E	590 S 416 W
BHL:	SWSWSE	20	31N	7W	ECHO	ANTRIM		

Michigan Department of  
Environment, Great Lakes, and Energy  
Oil, Gas and Minerals Division

UPDATED PERMITS

11/07/2022 THRU 11/11/2022



Permit Number      Permittee Number      Permittee Name

59855      6361      RIVERSIDE ENERGY MICHIGAN LLC  
10691 EAST CARTER ROAD  
SUITE 201  
TRAVERSE CITY, MI 49684

API Well Number: 21-009-59855-00-00

Well Name: STATE CENTRAL LAKE ET AL C3-14

Plugging Date: 10/11/2022

Location	QT QT QT	Sec	Township	Range	Township Name	County	Feet From Section Line	Feet From DRLG Unit
SL:	NENWSE	14	31N	8W	CENTRAL LAKE	ANTRIM	2190 S 1436 E	444 N 1216 W
BHL:	NENWSE	14	31N	8W	CENTRAL LAKE	ANTRIM		

59908      5320      SAVOY ENERGY LP  
920 HASTINGS STREET, SUITE A  
P.O. BOX 1560  
TRAVERSE CITY, MI 49685-1560

API Well Number: 21-137-59908-00-00

Well Name: STATE DOVER ET AL 3-1 HD1      True Vertical Depth: 701

Plugging Date: 9/28/2022

Location	QT QT QT	Sec	Township	Range	Township Name	County	Feet From Section Line	Feet From DRLG Unit
SL:	SESENE	2	31N	2W	DOVER	OTSEGO	2240 N 192 E	
BHL:	NESENE	1	31N	2W	DOVER	OTSEGO	1814 N 376 E	547 N 376 E



Michigan Department of  
Environment, Great Lakes, and Energy  
Oil, Gas and Minerals Division

UPDATED PERMITS

11/07/2022 THRU 11/11/2022



Permit Number      Permittee Number      Permittee Name

59945      6361      RIVERSIDE ENERGY MICHIGAN LLC  
10691 EAST CARTER ROAD  
SUITE 201  
TRAVERSE CITY, MI 49684

API Well Number: 21-009-59945-00-00

Well Name: STATE ECHO & PORTER  
MINERAL TRUST B2-20

Plugging Date: 10/11/2022

Location	QT QT QT	Sec	Township	Range	Township Name	County	Feet From Section Line	Feet From DRLG Unit
SL:	NESENW	20	31N	7W	ECHO	ANTRIM	1696 N 2261 W	377 N 956 W
BHL:	NESENW	20	31N	7W	ECHO	ANTRIM		

Michigan Department of  
Environment, Great Lakes, and Energy  
Oil, Gas and Minerals Division

UPDATED PERMITS

11/07/2022 THRU 11/11/2022



Permit Number      Permittee Number      Permittee Name

**APPLICATIONS TO CHANGE WELL STATUS:**

29207      6361      RIVERSIDE ENERGY MICHIGAN LLC  
10691 EAST CARTER ROAD  
SUITE 201  
TRAVERSE CITY, MI 49684

API Well Number: 21-137-29207-00-00

Well Name: NORTH MICHIGAN LAND AND  
OIL CORP 1-29

Approval Date: 11/7/2022

Location	QT QT QT	Sec	Township	Range	Township Name	County	Feet From Section Line	Feet From DRLG Unit
SL:	NESESW	29	29N	4W	HAYES	OTSEGO	790 S 460 E	530 N 460 E
BHL:	NESESW	29	29N	4W	HAYES	OTSEGO		

Proposed Rework: ACOWS to Repair Casing or Squeeze Cement

Comment: ACOWS to cement 5.5" casing to surface expires 11/7/2023

29713      6361      RIVERSIDE ENERGY MICHIGAN LLC  
10691 EAST CARTER ROAD  
SUITE 201  
TRAVERSE CITY, MI 49684

API Well Number: 21-137-29713-00-00

Well Name: NORTH MICHIGAN LAND AND  
OIL CO 3-29

Approval Date: 11/7/2022

Location	QT QT QT	Sec	Township	Range	Township Name	County	Feet From Section Line	Feet From DRLG Unit
SL:	SWSWNE	29	29N	4W	HAYES	OTSEGO	499 S 107 W	499 S 1213 E
BHL:	SWSWNE	29	29N	4W	HAYES	OTSEGO		

Proposed Rework: ACOWS to Repair Casing or Squeeze Cement

Comment: ACOWS to cement 5.5" casing to surface expires 11/7/2023

Michigan Department of  
Environment, Great Lakes, and Energy  
Oil, Gas and Minerals Division

UPDATED PERMITS

11/07/2022 THRU 11/11/2022



Permit Number      Permittee Number      Permittee Name

33112      7772      LAMBDA ENERGY RESOURCES LLC  
12012 Wickchester  
Suite 300  
Houston, TX 77079 USA

API Well Number: 21-079-33112-00-00

Well Name: STATE KALKASKA "F" 2-24

Approval Date: 11/4/2022

Location	QT QT QT	Sec	Township	Range	Township Name	County	Feet From Section Line	Feet From DRLG Unit
SL:	SENWNW	24	27N	8W	KALKASKA	KALKASKA	700 N 700 W	700 N 700 W
BHL:	SENWNW	24	27N	8W	KALKASKA	KALKASKA		

Proposed Rework:      Temporarily Abandoned

Comment: ACOWS for TA expires on 3/31/2023

34084      7772      LAMBDA ENERGY RESOURCES LLC  
12012 Wickchester  
Suite 300  
Houston, TX 77079 USA

API Well Number: 21-019-34084-02-00

Well Name: STATE COLFAX 2-25 HD2      True Vertical Depth: 5722

Approval Date: 11/4/2022

Location	QT QT QT	Sec	Township	Range	Township Name	County	Feet From Section Line	Feet From DRLG Unit
SL:	SENWSW	25	25N	13W	COLFAX	BENZIE	1955 S 849 W	
BHL:	NENESE	26	25N	13W	COLFAX	BENZIE	2704 N 130 E	1227 S 2517 W

Proposed Rework:      Temporarily Abandoned

Comment: ACOWS for TA expires on 3/31/2023.

Michigan Department of  
Environment, Great Lakes, and Energy  
Oil, Gas and Minerals Division

UPDATED PERMITS

11/07/2022 THRU 11/11/2022



Permit Number      Permittee Number      Permittee Name

**RECORD OF CHANGE OF WELL STATUS:**

13059      4428      MID MICHIGAN GAS STORAGE CO  
P.O. BOX 2446  
HOUSTON, TX 77252-2446 USA

API Well Number: 21-107-13059-00-00

Well Name: EAST AUSTIN 12

Change Date: 10/17/2022

Location	QT QT QT	Sec	Township	Range	Township Name	County	Feet From Section Line	Feet From DRLG Unit
SL:	CWLSW	12	14N	9W	AUSTIN	MECOSTA	1320 N 0 W	660 N 660 W
BHL:	CWLSW	12	14N	9W	AUSTIN	MECOSTA		

Proposed Rework: Reworked to Observation Well

Comment: Reworked to convert to observation well.

17050      4428      MID MICHIGAN GAS STORAGE CO  
P.O. BOX 2446  
HOUSTON, TX 77252-2446 USA

API Well Number: 21-107-17050-00-00

Well Name: MCGC 43

Change Date: 10/17/2022

Location	QT QT QT	Sec	Township	Range	Township Name	County	Feet From Section Line	Feet From DRLG Unit
SL:	NESESW	11	14N	9W	AUSTIN	MECOSTA	1320 S 0 E	660 S 660 E
BHL:	NESESW	11	14N	9W	AUSTIN	MECOSTA		

Proposed Rework: Reworked to Observation Well

Comment: Reworked to convert to observation well.

Michigan Department of  
Environment, Great Lakes, and Energy  
Oil, Gas and Minerals Division

UPDATED PERMITS

11/07/2022 THRU 11/11/2022



Permit Number      Permittee Number      Permittee Name

61448      4934      FEDERATED OIL AND GAS  
PROPERTIES INC  
P.O. BOX 946  
TRAVERSE CITY, MI 49685-0946

API Well Number: 21-045-39357-05-00

Well Name: WHITING 1-35D HD-2

True Vertical Depth: 3793

Change Date: 10/19/2022

Location	QT QT QT	Sec	Township	Range	Township Name	County	Feet From Section Line	Feet From DRLG Unit
SL:	NWNENW	35	2N	4W	EATON	EATON	602 N 1505 W	
BHL:	SESENW	35	2N	4W	EATON	EATON	2176 N 2000 W	464 S 671 W

Proposed Rework: Reworked to Continue Drilling - HDH

Comment: Whiting 1-35 HD1 reworked to plugback and drill HD2 leg under same permit.

