

Michigan Department of
Environment, Great Lakes, and Energy
Oil, Gas and Minerals Division

PERMIT APPLICATIONS

11/14/2022 THRU 11/18/2022



Application Number Date Received Permittee Number Permittee Name Page 1

798 11/14/2022 5320 SAVOY ENERGY LP
920 HASTINGS STREET, SUITE A
PO BOX 1560
TRAVERSE CITY, MI 49685-1560

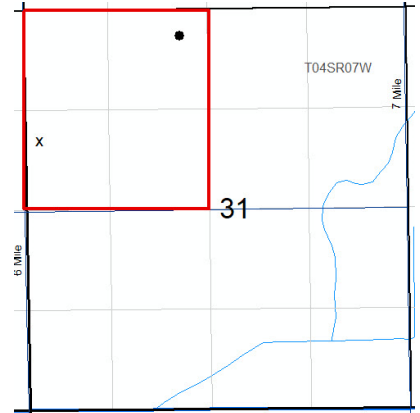

160-Acre R303 Drilling Unit, NW/4 Section 31

Prev Permit: 61535, 61579

Well Name: KORN 1-31 HD4

Surface Owner: Korn, Norman & Linda

Well Type: OIL

True Vertical Depth: 3430

Permit Type: Reentry

Target Formation: TRENTON

H2S Present? No

Deepest Formation: TRENTON

Location:	QT QT QT	Sec	Township	Range	Township Name	County	Feet From Section Line	Feet From DRLG Unit Line
SL:	NWSWNW	31	4S	7W	BURLINGTON	CALHOUN	1755 N 168 W	
BHL:	NENENW	31	4S	7W	BURLINGTON	CALHOUN	331 N 2026 W	331 N 331 E

Michigan Department of
Environment, Great Lakes, and Energy
Oil, Gas and Minerals Division

PERMIT APPLICATIONS

11/14/2022 THRU 11/18/2022



Application Number Date Received Permittee Number Permittee Name

795 11/18/2022 6498 WOLVERINE GAS AND OIL
COMPANY OF MICHIGAN LLC
ONE RIVERFRONT PLAZA
55 CAMPAU, NW
GRAND RAPIDS, MI 49503

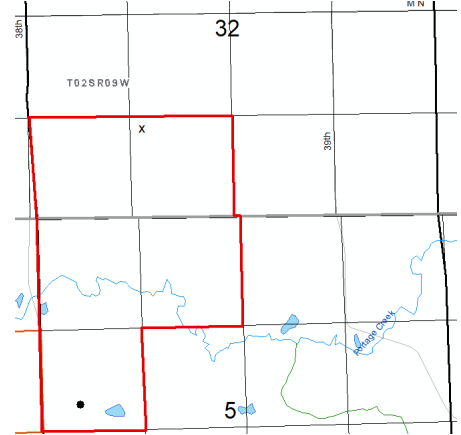

200-Acre R303 Drilling Unit, S/2 SW/4 Sec 32, N/2 NW/4, SW/4 NW/4 Sec 5

Prev Permit:

Well Name: Cook 32-1 HD1

Surface Owner: Stacey R. Marlowe-Cook

Well Type: OIL

True Vertical Depth: 3559

Permit Type: Drill

Target Formation: TRENTON

H2S Present? Yes

Deepest Formation: TRENTON

Location:	QT QT QT	Sec	Township	Range	Township Name	County	Feet From Section Line	Feet From DRLG Unit Line
SL:	NWSESW	32	2S	9W	CHARLESTON	KALAMAZOO	1144 S 1493 W	
BHL:	SWSWNW	5	3S	9W	CLIMAX	KALAMAZOO	2402 N 491 W	330 S 491 W

Michigan Department of
Environment, Great Lakes, and Energy
Oil, Gas and Minerals Division

PERMIT APPLICATIONS

11/14/2022 THRU 11/18/2022



Application Number Date Received Permittee Number Permittee Name

803 11/18/2022 6498 WOLVERINE GAS AND OIL
COMPANY OF MICHIGAN LLC
ONE RIVERFRONT PLAZA
55 CAMPAU, NW
GRAND RAPIDS, MI 49503

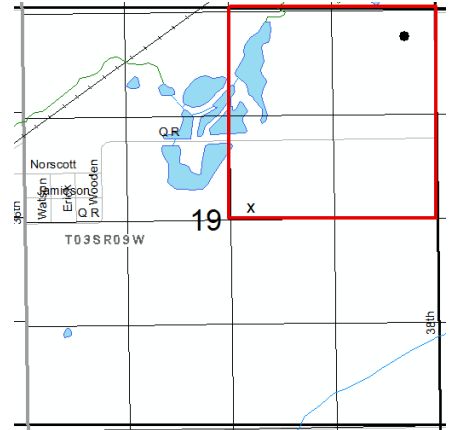

Prev Permit:

Well Name: Stephenson 19-1 HD1

Surface Owner: Chad Stephenson

Well Type: OIL

True Vertical Depth: 3390

Permit Type: Drill

Target Formation: TRENTON

H2S Present? Yes

Deepest Formation: TRENTON

160-Acre R303 Drilling Unit, NE/4
Section 19

Location:	QT QT QT	Sec	Township	Range	Township Name	County	Feet From Section Line	Feet From DRLG Unit Line
SL:	SWSWNE	19	3S	9W	CLIMAX	KALAMAZOO	2472 N 2401 E	
BHL:	NENENE	19	3S	9W	CLIMAX	KALAMAZOO	330 N 414 E	330 N 414 E

Michigan Department of
Environment, Great Lakes, and Energy
Oil, Gas and Minerals Division

PERMIT LIST

11/14/2022 THRU 11/18/2022



Permit Number Issue Date Permittee Number Permittee Name Page 1

61661 11/15/2022 5320 SAVOY ENERGY LP
920 HASTINGS STREET, SUITE A
PO BOX 1560
TRAVERSE CITY, MI 49685-1560

API Well No: 21-025-62032-02-00

Prev Permit: 61593, 61641

Well Name: HIGGINS 1-27A Surface Owner: Higgins, Dennis A.

Well Type: Oil Well True Vertical Depth: 3800FT

Permit Type: Reentry Target Formation: TRENTON-BLACK RIVER

H2S Present? No Deepest Formation: PRAIRIE DU CHIEN

Location:	QT QT QT	Sec	Township	Range	Township Name	County	Feet From Section Line	Feet From DRLG Unit Line
SL:	SENESE	27	4S	8W	ATHENS	CALHOUN	1477 S 96 E	
BHL:	NESENE	27	4S	8W	ATHENS	CALHOUN	1901 N 575 E	1901 N 575 E

61662 11/18/2022 5320 SAVOY ENERGY LP
920 HASTINGS STREET, SUITE A
PO BOX 1560
TRAVERSE CITY, MI 49685-1560

API Well No: 21-025-62007-02-00

Prev Permit: 61401, 61416

Well Name: TRAISTER 1-21B Surface Owner: Traister, Timothy J.

Well Type: Oil Well True Vertical Depth: 4075FT

Permit Type: Reentry Target Formation: TRENTON-BLACK RIVER

H2S Present? No Deepest Formation: PRAIRIE DU CHIEN

Location:	QT QT QT	Sec	Township	Range	Township Name	County	Feet From Section Line	Feet From DRLG Unit Line
SL:	NESWNE	21	3S	8W	LEROY	CALHOUN	1730 N 1970 E	
BHL:	SESWNE	21	3S	8W	LEROY	CALHOUN	2625 N 1637 E	1295 N 969 E

Michigan Department of
Environment, Great Lakes, and Energy
Oil, Gas and Minerals Division

PERMIT LIST

11/14/2022 THRU 11/18/2022



Permit Number Issue Date Permittee Number Permittee Name Page 2

61663 11/18/2022 5320 SAVOY ENERGY LP
920 HASTINGS STREET, SUITE A
PO BOX 1560
TRaverse CITY, MI 49685-1560

API Well No: 21-023-62000-01-00

Prev Permit: 61656

Well Name: RIDDLE 1-2A Surface Owner: Riddle, Freeman & Anita L.

True Vertical Depth: 3750FT

Well Type: Oil Well

Target Formation: TRENTON

Permit Type: Reentry

Deepest Formation: PRAIRIE DU CHIEN

H2S Present? No

Location:	QT QT QT	Sec	Township	Range	Township Name	County	Feet From Section Line	Feet From DRLG Unit Line
SL:	SWNWNW		2 5S	8W	SHERWOOD	BRANCH	1125 N 607 W	
BHL:	SENE		3 5S	8W	SHERWOOD	BRANCH	868 N 134 E	868 N 134 E

Michigan Department of
Environment, Great Lakes, and Energy
Oil, Gas and Minerals Division

UPDATED PERMITS

11/14/2022 THRU 11/18/2022



Permit Number Permittee Number Permittee Name

RECORD OF WELL PLUGGING:

17588 491 CONSUMERS ENERGY CO
1945 W PARNALL RD
JACKSON, MI 49201

API Well Number: 21-113-17588-00-00

Well Name: M G S C 140

Plugging Date: 10/14/2022

Location	QT QT QT	Sec	Township	Range	Township Name	County	Feet From Section Line	Feet From DRLG Unit
SL:	NWNWSW	23	21N	7W	RIVERSIDE	MISSAUKEE	100 N 100 W	100 N 100 W
BHL:	NWNWSW	23	21N	7W	RIVERSIDE	MISSAUKEE		

17974 40 MUSKEGON DEVELOPMENT
COMPANY
1425 S MISSION RD
MOUNT PLEASANT, MI 48858

API Well Number: 21-143-17974-00-00

Well Name: STATE ROSCOMMON RL-4

Plugging Date: 11/1/2022

Location	QT QT QT	Sec	Township	Range	Township Name	County	Feet From Section Line	Feet From DRLG Unit
SL:	N2NWSW	29	21N	3W	ROSCOMMON	ROSCOMMON	330 N 660 W	330 N 660 E
BHL:	N2NWSW	29	21N	3W	ROSCOMMON	ROSCOMMON		

Michigan Department of
Environment, Great Lakes, and Energy
Oil, Gas and Minerals Division

UPDATED PERMITS

11/14/2022 THRU 11/18/2022



Permit Number Permittee Number Permittee Name

19732 40 MUSKEGON DEVELOPMENT
COMPANY
1425 S MISSION RD
MOUNT PLEASANT, MI 48858

API Well Number: 21-143-19732-00-00

Well Name: STATE ROSCOMMON FA-2

Plugging Date: 11/9/2022

Location	QT QT QT	Sec	Township	Range	Township Name	County	Feet From Section Line	Feet From DRLG Unit
SL:	N2SENW	29	21N	3W	ROSCOMMON	ROSCOMMON	990 S 660 E	330 N 660 E
BHL:	N2SENW	29	21N	3W	ROSCOMMON	ROSCOMMON		

33961 7772 LAMBDA ENERGY RESOURCES LLC
12012 Wickchester
Suite 300
Houston, TX 77079 USA

API Well Number: 21-055-33961-00-00

Well Name: STATE UNION "S" 2-29

Plugging Date: 11/3/2022

Location	QT QT QT	Sec	Township	Range	Township Name	County	Feet From Section Line	Feet From DRLG Unit
SL:	NESWSW	29	26N	9W	UNION	GRAND TRAVERSE	1290 S 845 W	1290 S 460 E
BHL:	NESWSW	29	26N	9W	UNION	GRAND TRAVERSE		

Michigan Department of
Environment, Great Lakes, and Energy
Oil, Gas and Minerals Division

UPDATED PERMITS

11/14/2022 THRU 11/18/2022



Permit Number Permittee Number Permittee Name

34654 7772 LAMBDA ENERGY RESOURCES LLC
12012 Wickchester
Suite 300
Houston, TX 77079 USA

API Well Number: 21-055-34574-01-00

Well Name: STATE UNION "U" 3A-29 True Vertical Depth: 7061

Plugging Date: 11/3/2022

Location	QT QT QT	Sec	Township	Range	Township Name	County	Feet From Section Line	Feet From DRLG Unit
SL:	NWSENE	29	26N	9W	UNION	GRAND TRAVERSE	933 S 850 E	
BHL:	NWSENE	29	26N	9W	UNION	GRAND TRAVERSE	1314 S 905 E	1314 S 415 W

39818 7772 LAMBDA ENERGY RESOURCES LLC
12012 Wickchester
Suite 300
Houston, TX 77079 USA

API Well Number: 21-055-39818-00-00

Well Name: STATE UNION UNIT "Y" 1-10

Plugging Date: 11/7/2022

Location	QT QT QT	Sec	Township	Range	Township Name	County	Feet From Section Line	Feet From DRLG Unit
SL:	SENEW	10	26N	9W	UNION	GRAND TRAVERSE	1220 N 330 E	1220 N 330 E
BHL:	SENEW	10	26N	9W	UNION	GRAND TRAVERSE		

Michigan Department of
Environment, Great Lakes, and Energy
Oil, Gas and Minerals Division

UPDATED PERMITS

11/14/2022 THRU 11/18/2022



Permit Number Permittee Number Permittee Name

39964 8080 V C P MICHIGAN, LLC
P. O. Box 977
Gaylord, MI 49734

API Well Number: 21-137-39964-00-00

Well Name: STEVENS 2-12

Plugging Date: 8/20/2022

Location	QT QT QT	Sec	Township	Range	Township Name	County	Feet From Section Line	Feet From DRLG Unit
SL:	SESWSW	12	30N	3W	BAGLEY	OTSEGO	430 S 890 W	430 S 430 E
BHL:	SESWSW	12	30N	3W	BAGLEY	OTSEGO		

40322 7772 LAMBDA ENERGY RESOURCES LLC
12012 Wickchester
Suite 300
Houston, TX 77079 USA

API Well Number: 21-055-40228-02-00

Well Name: STATE UNION 1-21B True Vertical Depth: 6847

Plugging Date: 11/3/2022

Location	QT QT QT	Sec	Township	Range	Township Name	County	Feet From Section Line	Feet From DRLG Unit
SL:	SWSWSW	21	26N	9W	UNION	GRAND TRAVERSE	261 S 649 W	
BHL:	NWSWSW	21	26N	9W	UNION	GRAND TRAVERSE	734 S 430 W	587 N 430 W

Michigan Department of
Environment, Great Lakes, and Energy
Oil, Gas and Minerals Division

UPDATED PERMITS

11/14/2022 THRU 11/18/2022



Permit Number Permittee Number Permittee Name

42566 8080 V C P MICHIGAN, LLC
P. O. Box 977
Gaylord, MI 49734

API Well Number: 21-137-42566-02-00

Well Name: MUMMERT A2-11

Plugging Date: 8/20/2022

Location	QT QT QT	Sec	Township	Range	Township Name	County	Feet From Section Line	Feet From DRLG Unit
SL:	SWNENW	11	30N	4W	HAYES	OTSEGO	975 N 886 E	350 S 431 W
BHL:	SWNENW	11	30N	4W	HAYES	OTSEGO		

43230 6361 RIVERSIDE ENERGY MICHIGAN LLC
10691 EAST CARTER ROAD
SUITE 201
TRAVERSE CITY, MI 49684

API Well Number: 21-137-43230-00-00

Well Name: CHUDZINSKI 2-29

Plugging Date: 11/4/2022

Location	QT QT QT	Sec	Township	Range	Township Name	County	Feet From Section Line	Feet From DRLG Unit
SL:	NENENW	29	31N	4W	ELMIRA	OTSEGO	330 N 330 E	
BHL:	NENENW	29	31N	4W	ELMIRA	OTSEGO		

Michigan Department of
Environment, Great Lakes, and Energy
Oil, Gas and Minerals Division

UPDATED PERMITS

11/14/2022 THRU 11/18/2022



Permit Number Permittee Number Permittee Name

47502 8080 V C P MICHIGAN, LLC
P. O. Box 977
Gaylord, MI 49734

API Well Number: 21-101-39151-01-00

Well Name: MEISTER 5-1

True Vertical Depth: 1229

Plugging Date: 8/16/2022

Location	QT QT QT	Sec	Township	Range	Township Name	County	Feet From Section Line	Feet From DRLG Unit
SL:	NWSWNW	1	23N	15W	BEAR LAKE	MANISTEE	674 S 425 W	646 N 425 W
BHL:	NWSWNW	1	23N	15W	BEAR LAKE	MANISTEE	655 S 537 W	655 N 537 W

48966 8080 V C P MICHIGAN, LLC
P. O. Box 977
Gaylord, MI 49734

API Well Number: 21-101-31551-01-00

Well Name: OSBORN 14-11

Plugging Date: 8/16/2022

Location	QT QT QT	Sec	Township	Range	Township Name	County	Feet From Section Line	Feet From DRLG Unit
SL:	SESESW	11	23N	15W	BEAR LAKE	MANISTEE	331 S 337 E	331 S 337 E
BHL:	SESESW	11	23N	15W	BEAR LAKE	MANISTEE		

Michigan Department of
Environment, Great Lakes, and Energy
Oil, Gas and Minerals Division

UPDATED PERMITS

11/14/2022 THRU 11/18/2022



Permit Number Permittee Number Permittee Name

51166 8080 V C P MICHIGAN, LLC
P. O. Box 977
Gaylord, MI 49734

API Well Number: 21-101-51166-00-00

Well Name: BEAR LAKE A2-14

Plugging Date: 8/16/2022

Location	QT QT QT	Sec	Township	Range	Township Name	County	Feet From Section Line	Feet From DRLG Unit
SL:	SEENW	14	23N	15W	BEAR LAKE	MANISTEE	803 N 544 E	517 S 544 E
BHL:	SEENW	14	23N	15W	BEAR LAKE	MANISTEE		

51478 6361 RIVERSIDE ENERGY MICHIGAN LLC
10691 EAST CARTER ROAD
SUITE 201
TRAVERSE CITY, MI 49684

API Well Number: 21-007-51478-00-00

Well Name: TRELFA 16-4

Plugging Date: 11/1/2022

Location	QT QT QT	Sec	Township	Range	Township Name	County	Feet From Section Line	Feet From DRLG Unit
SL:	NESESE	4	30N	7E	WILSON	ALPENA	826 S 543 E	826 S 543 E
BHL:	NESESE	4	30N	7E	WILSON	ALPENA		

Michigan Department of
Environment, Great Lakes, and Energy
Oil, Gas and Minerals Division

UPDATED PERMITS

11/14/2022 THRU 11/18/2022



Permit Number Permittee Number Permittee Name

52501 6361 RIVERSIDE ENERGY MICHIGAN LLC
10691 EAST CARTER ROAD
SUITE 201
TRAVERSE CITY, MI 49684

API Well Number: 21-009-52501-00-00

Well Name: SHATTOCK C1-34

Plugging Date: 11/7/2022

Location	QT QT QT	Sec	Township	Range	Township Name	County	Feet From Section Line	Feet From DRLG Unit
SL:	NENWSW	34	31N	7W	ECHO	ANTRIM	359 N 867 W	359 N 443 E
BHL:	NENWSW	34	31N	7W	ECHO	ANTRIM		

52639 6361 RIVERSIDE ENERGY MICHIGAN LLC
10691 EAST CARTER ROAD
SUITE 201
TRAVERSE CITY, MI 49684

API Well Number: 21-007-52639-00-00

Well Name: CHEATHAM D1-16

Plugging Date: 11/4/2022

Location	QT QT QT	Sec	Township	Range	Township Name	County	Feet From Section Line	Feet From DRLG Unit
SL:	NESWSW	16	30N	7E	WILSON	ALPENA	955 S 730 W	370 N 730 W
BHL:	NESWSW	16	30N	7E	WILSON	ALPENA		

Michigan Department of
Environment, Great Lakes, and Energy
Oil, Gas and Minerals Division

UPDATED PERMITS

11/14/2022 THRU 11/18/2022



Permit Number Permittee Number Permittee Name

52642 6361 RIVERSIDE ENERGY MICHIGAN LLC
10691 EAST CARTER ROAD
SUITE 201
TRAVERSE CITY, MI 49684

API Well Number: 21-007-52642-00-00

Well Name: KING B1-9

Plugging Date: 11/1/2022

Location	QT QT QT	Sec	Township	Range	Township Name	County	Feet From Section Line	Feet From DRLG Unit
SL:	NWSWNW	9	30N	7E	WILSON	ALPENA	950 S 330 W	372 N 330 W
BHL:	NWSWNW	9	30N	7E	WILSON	ALPENA		

52646 6361 RIVERSIDE ENERGY MICHIGAN LLC
10691 EAST CARTER ROAD
SUITE 201
TRAVERSE CITY, MI 49684

API Well Number: 21-007-52646-00-00

Well Name: PEASLEY C3-8

Plugging Date: 11/4/2022

Location	QT QT QT	Sec	Township	Range	Township Name	County	Feet From Section Line	Feet From DRLG Unit
SL:	NWNWSE	8	30N	7E	WILSON	ALPENA	395 N 395 W	395 N 934 E
BHL:	NWNWSE	8	30N	7E	WILSON	ALPENA		

Michigan Department of
Environment, Great Lakes, and Energy
Oil, Gas and Minerals Division

UPDATED PERMITS

11/14/2022 THRU 11/18/2022



Permit Number Permittee Number Permittee Name

52647 6361 RIVERSIDE ENERGY MICHIGAN LLC
10691 EAST CARTER ROAD
SUITE 201
TRAVERSE CITY, MI 49684

API Well Number: 21-007-52647-00-00

Well Name: PEASLEY A2-8

Plugging Date: 11/4/2022

Location	QT QT QT	Sec	Township	Range	Township Name	County	Feet From Section Line	Feet From DRLG Unit
SL:	SENENW	8	30N	7E	WILSON	ALPENA	1320 N 575 E	1320 N 575 E
BHL:	SENENW	8	30N	7E	WILSON	ALPENA		

52648 6361 RIVERSIDE ENERGY MICHIGAN LLC
10691 EAST CARTER ROAD
SUITE 201
TRAVERSE CITY, MI 49684

API Well Number: 21-007-52648-00-00

Well Name: ZBYTOWSKI B3-9

Plugging Date: 11/1/2022

Location	QT QT QT	Sec	Township	Range	Township Name	County	Feet From Section Line	Feet From DRLG Unit
SL:	NESWNE	9	30N	7E	WILSON	ALPENA	1042 S 692 W	1042 S 645 E
BHL:	NESWNE	9	30N	7E	WILSON	ALPENA		

Michigan Department of
Environment, Great Lakes, and Energy
Oil, Gas and Minerals Division

UPDATED PERMITS

11/14/2022 THRU 11/18/2022



Permit Number Permittee Number Permittee Name

52649 6361 RIVERSIDE ENERGY MICHIGAN LLC
10691 EAST CARTER ROAD
SUITE 201
TRAVERSE CITY, MI 49684

API Well Number: 21-007-52649-00-00

Well Name: ZBYTOWSKI C1-9

Plugging Date: 11/1/2022

Location	QT QT QT	Sec	Township	Range	Township Name	County	Feet From Section Line	Feet From DRLG Unit
SL:	NENWSW	9	30N	7E	WILSON	ALPENA	330 N 912 W	330 N 912 W
BHL:	NENWSW	9	30N	7E	WILSON	ALPENA		

52674 6361 RIVERSIDE ENERGY MICHIGAN LLC
10691 EAST CARTER ROAD
SUITE 201
TRAVERSE CITY, MI 49684

API Well Number: 21-007-52674-00-00

Well Name: ZBYTOWSKI A4-8

Plugging Date: 11/1/2022

Location	QT QT QT	Sec	Township	Range	Township Name	County	Feet From Section Line	Feet From DRLG Unit
SL:	NWNE	8	30N	7E	WILSON	ALPENA	420 N 890 E	420 N 437 W
BHL:	NWNE	8	30N	7E	WILSON	ALPENA		

Michigan Department of
Environment, Great Lakes, and Energy
Oil, Gas and Minerals Division

UPDATED PERMITS

11/14/2022 THRU 11/18/2022



Permit Number Permittee Number Permittee Name

52677 6361 RIVERSIDE ENERGY MICHIGAN LLC
10691 EAST CARTER ROAD
SUITE 201
TRAVERSE CITY, MI 49684

API Well Number: 21-007-52677-00-00

Well Name: WERTH B3-17

Plugging Date: 11/4/2022

Location	QT QT QT	Sec	Township	Range	Township Name	County	Feet From Section Line	Feet From DRLG Unit
SL:	SESWNE	17	30N	7E	WILSON	ALPENA	480 S 730 W	480 S 730 W
BHL:	SESWNE	17	30N	7E	WILSON	ALPENA		

52715 6361 RIVERSIDE ENERGY MICHIGAN LLC
10691 EAST CARTER ROAD
SUITE 201
TRAVERSE CITY, MI 49684

API Well Number: 21-007-52715-00-00

Well Name: WERTH D4-8

Plugging Date: 11/4/2022

Location	QT QT QT	Sec	Township	Range	Township Name	County	Feet From Section Line	Feet From DRLG Unit
SL:	NWSESE	8	30N	7E	WILSON	ALPENA	990 S 885 E	347 N 885 E
BHL:	NWSESE	8	30N	7E	WILSON	ALPENA		

Michigan Department of
Environment, Great Lakes, and Energy
Oil, Gas and Minerals Division

UPDATED PERMITS

11/14/2022 THRU 11/18/2022



Permit Number Permittee Number Permittee Name

52716 6361 RIVERSIDE ENERGY MICHIGAN LLC
10691 EAST CARTER ROAD
SUITE 201
TRAVERSE CITY, MI 49684

API Well Number: 21-007-52716-00-00

Well Name: WERTH D1-9

Plugging Date: 11/1/2022

Location	QT QT QT	Sec	Township	Range	Township Name	County	Feet From Section Line	Feet From DRLG Unit
SL:	NESWSW	9	30N	7E	WILSON	ALPENA	760 S 1330 W	595 N 1330 W
BHL:	NESWSW	9	30N	7E	WILSON	ALPENA		

52740 6361 RIVERSIDE ENERGY MICHIGAN LLC
10691 EAST CARTER ROAD
SUITE 201
TRAVERSE CITY, MI 49684

API Well Number: 21-007-52740-00-00

Well Name: WERTH A3-17

Plugging Date: 11/4/2022

Location	QT QT QT	Sec	Township	Range	Township Name	County	Feet From Section Line	Feet From DRLG Unit
SL:	SWNWNE	17	30N	7E	WILSON	ALPENA	685 N 395 W	643 S 395 W
BHL:	SWNWNE	17	30N	7E	WILSON	ALPENA		

Michigan Department of
Environment, Great Lakes, and Energy
Oil, Gas and Minerals Division

UPDATED PERMITS

11/14/2022 THRU 11/18/2022



Permit Number Permittee Number Permittee Name

53412 6361 RIVERSIDE ENERGY MICHIGAN LLC
10691 EAST CARTER ROAD
SUITE 201
TRAVERSE CITY, MI 49684

API Well Number: 21-007-53412-00-00

Well Name: ZBYTOWSKI C3-9

Plugging Date: 11/1/2022

Location	QT QT QT	Sec	Township	Range	Township Name	County	Feet From Section Line	Feet From DRLG Unit
SL:	NWNWSE	9	30N	7E	WILSON	ALPENA	2025 S 2138 E	650 N 530 W
BHL:	NWNWSE	9	30N	7E	WILSON	ALPENA		

57959 6361 RIVERSIDE ENERGY MICHIGAN LLC
10691 EAST CARTER ROAD
SUITE 201
TRAVERSE CITY, MI 49684

API Well Number: 21-007-57959-00-00

Well Name: KING A1-9

Plugging Date: 11/1/2022

Location	QT QT QT	Sec	Township	Range	Township Name	County	Feet From Section Line	Feet From DRLG Unit
SL:	NENWNW	9	30N	7E	WILSON	ALPENA	620 N 705 W	620 N 705 W
BHL:	NENWNW	9	30N	7E	WILSON	ALPENA		

Michigan Department of
Environment, Great Lakes, and Energy
Oil, Gas and Minerals Division

UPDATED PERMITS

11/14/2022 THRU 11/18/2022



Permit Number Permittee Number Permittee Name

59134 6361 RIVERSIDE ENERGY MICHIGAN LLC
10691 EAST CARTER ROAD
SUITE 201
TRAVERSE CITY, MI 49684

API Well Number: 21-009-59134-00-00

Well Name: WILLSON 15-24 SWD

Plugging Date: 11/14/2022

Location	QT QT QT	Sec	Township	Range	Township Name	County	Feet From Section Line	Feet From DRLG Unit
SL:	NWSWSE	24	31N	8W	CENTRAL LAKE	ANTRIM	1169 S 2172 E	
BHL:	NWSWSE	24	31N	8W	CENTRAL LAKE	ANTRIM		

Michigan Department of
Environment, Great Lakes, and Energy
Oil, Gas and Minerals Division

UPDATED PERMITS

11/14/2022 THRU 11/18/2022



Permit Number Permittee Number Permittee Name

APPLICATIONS TO CHANGE WELL STATUS:

33232 7772 LAMBDA ENERGY RESOURCES LLC
12012 Wickchester
Suite 300
Houston, TX 77079 USA

API Well Number: 21-031-33232-00-00

Well Name: STATE FOREST 1-24

Approval Date: 11/15/2022

Location	QT QT QT	Sec	Township	Range	Township Name	County	Feet From Section Line	Feet From DRLG Unit
SL:	NWSESW	24	33N	1E	FOREST	CHEBOYGAN	851 S 1245 E	460 N 1245 E
BHL:	NWSESW	24	33N	1E	FOREST	CHEBOYGAN		

Proposed Rework: ACOWS to Repair Casing or Squeeze Cement

Comment: ACOWS to run 5.5" casing and cement in place expires 11/15/2023.

3610 47 MILLER ENERGY COMPANY II LLC
10850 E TRAVERSE HWY
SUITE 3375
TRAVERSE CITY, MI 49684

API Well Number: 21-111-03610-00-00

Well Name: CAMPBELL J W 10

Approval Date: 11/16/2022

Location	QT QT QT	Sec	Township	Range	Township Name	County	Feet From Section Line	Feet From DRLG Unit
SL:	NENENW	17	13N	1W	PORTER	MIDLAND	545 N 400 E	
BHL:	NENENW	17	13N	1W	PORTER	MIDLAND		

Proposed Rework: ACOWS to Repair Casing or Squeeze Cement

Comment: ACOWS to install 4.5" liner and return well to service expires 11/16/2023

Michigan Department of
Environment, Great Lakes, and Energy
Oil, Gas and Minerals Division

UPDATED PERMITS

11/14/2022 THRU 11/18/2022



Permit Number Permittee Number Permittee Name

RECORD OF CHANGE OF WELL STATUS:

13059 4428 MID MICHIGAN GAS STORAGE CO
PO BOX 2446
HOUSTON, TX 77252-2446 USA

API Well Number: 21-107-13059-00-00

Well Name: EAST AUSTIN 12

Change Date: 10/17/2022

Location	QT QT QT	Sec	Township	Range	Township Name	County	Feet From Section Line	Feet From DRLG Unit
SL:	CWLSW	12	14N	9W	AUSTIN	MECOSTA	1320 N 0 W	
BHL:	CWLSW	12	14N	9W	AUSTIN	MECOSTA		

Proposed Rework: Reworked to Observation Well

Comment: Reworked to convert to gas storage observation well.

17050 4428 MID MICHIGAN GAS STORAGE CO
PO BOX 2446
HOUSTON, TX 77252-2446 USA

API Well Number: 21-107-17050-00-00

Well Name: MCGC 43

Change Date: 10/17/2022

Location	QT QT QT	Sec	Township	Range	Township Name	County	Feet From Section Line	Feet From DRLG Unit
SL:	NESESW	11	14N	9W	AUSTIN	MECOSTA	1320 S 0 E	
BHL:	NESESW	11	14N	9W	AUSTIN	MECOSTA		

Proposed Rework: Reworked to Observation Well

Comment: Reworked to convert to gas storage observation well.

Michigan Department of
Environment, Great Lakes, and Energy
Oil, Gas and Minerals Division

UPDATED PERMITS

11/14/2022 THRU 11/18/2022



Permit Number Permittee Number Permittee Name

39796 47 MILLER ENERGY COMPANY II LLC
10850 E TRAVERSE HWY
SUITE 3375
TRAVERSE CITY, MI 49684

API Well Number: 21-073-39796-00-00

Well Name: MT PLEASANT UNIT TR 120 1 True Vertical Depth: 3693

Change Date: 10/10/2022

Location	QT QT QT	Sec	Township	Range	Township Name	County	Feet From Section Line	Feet From DRLG Unit
SL:	NWSWSW	1	14N	3W	CHIPPEWA	ISABELLA	1026 S 542 W	
BHL:	SWNWSW	1	14N	3W	CHIPPEWA	ISABELLA	1067 N 563 W	

Proposed Rework: Reworked to Perforate & Test Current Formation

Comment: Reworked to perf F/ 1167' T/ 1173', test production, and return well to service.

