

Michigan Department of
Environment, Great Lakes, and Energy
Oil, Gas, and Minerals Division

PERMIT LIST

11/21/2022 THRU 11/25/2022



Permit Number	Issue Date	Permittee Number	Permittee Name
61664	11/23/2022	6418	W B OSBORN OIL AND GAS OPERATIONS LTD P O BOX 8C SAN ANTONIO, TX 78217
API Well No: 21-117-62022-00-00			
Prev Permit:			
Well Name: WILSON 1-22		Surface Owner: James and Diane Wilson	
Well Type: Oil Well		True Vertical Depth: 3150FT	
Permit Type: Drill		Target Formation: TRAVERSE LIMESTONE	
H2S Present? No		Deepest Formation: TRAVERSE LIMESTONE	

Page 1

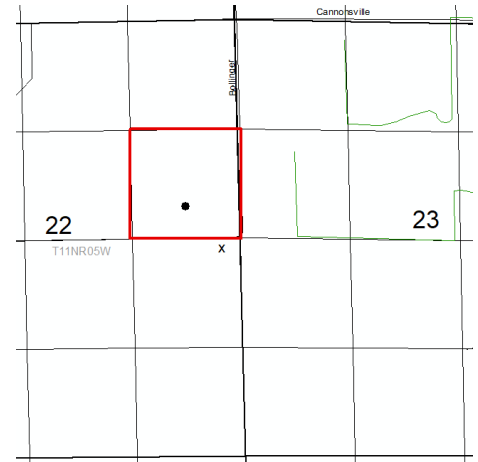

40-Acre Drilling Unit, SE/4 NE/4 Section 22

Location:	QT QT QT	Sec	Township	Range	Township Name	County	Feet From Section Line	Feet From DRLG Unit Line
SL:	NENESE	22	11N	5W	FERRIS	MONTCALM	2407 S 459 E	
BHL:	SESENE	22	11N	5W	FERRIS	MONTCALM	2324 N 659 E	332 S 659 E

Michigan Department of
Environment, Great Lakes, and Energy
Oil, Gas, and Minerals Division

Updated Permits

11/21/2022 THRU 11/25/2022



Permit Number Permittee Number Permittee Name

RECORD OF WELL PLUGGING:

25900 491 CONSUMERS ENERGY CO

1945 W PARNALL RD
JACKSON, MI 49201

API Well Number: 21-147-25900-00-00

Well Name: C P C I-103

Plugging Date: 10/17/2022

Location	QT QT QT	Sec	Township	Range	Township Name	County	Feet From Section Line	Feet From DRLG Unit
SL:	NESENE	2	3N	15E	IRA	SAINT CLAIR	990 S 230 E	990 S 230 E
BHL:	NESENE	2	3N	15E	IRA	SAINT CLAIR		

27704 100 APOLLO EXPLORATION AND
DEVELOPMENT INC

PO BOX 190
MOUNT PLEASANT, MI 48804-0190
USA

API Well Number: 21-147-27704-00-00

Well Name: KLEBBA ET AL 1

Plugging Date: 10/25/2022

Location	QT QT QT	Sec	Township	Range	Township Name	County	Feet From Section Line	Feet From DRLG Unit
SL:	SESENW	5	5N	15E	COLUMBUS	SAINT CLAIR	445 S 336 E	445 S 330 W
BHL:	SESENW	5	5N	15E	COLUMBUS	SAINT CLAIR		