

Michigan Department of
Environment, Great Lakes, and Energy
Oil, Gas and Minerals Division

PERMIT APPLICATIONS

02/20/2023 THRU 02/24/2023



814 02/24/2023 7772 LAMBDA ENERGY RESOURCES LLC
12012 Wickchester Lane
Suite 300
Houston, TX 77079

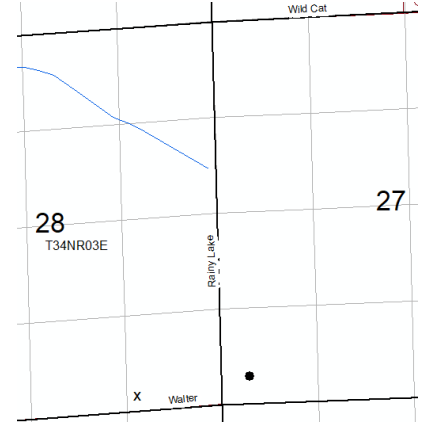

Prev Permit: 39942

Well Name: STATE CASE & HAACK 1-27A Surface Owner: STATE OF MICHIGAN

Well Type: BDW True Vertical Depth: 3590

Permit Type: Convert Target Formation: NIAGARAN GRAY

H2S Present? No Deepest Formation: NIAGARAN GRAY

No Drilling Unit, non-producing well

Location:	QT QT QT	Sec	Township	Range	Township Name	County	Feet From Section Line	Feet From DRLG Unit Line
SL:	SWSESE	28	34N	3E	CASE	PRESQUE ISLE	183 S 1145 E	
BHL:	SWSWSW	27	34N	3E	CASE	PRESQUE ISLE	378 S 406 E	

826 02/23/2023 5320 SAVOY ENERGY LP
P.O. BOX 1560
TRAVERSE CITY, MI 49685-1560

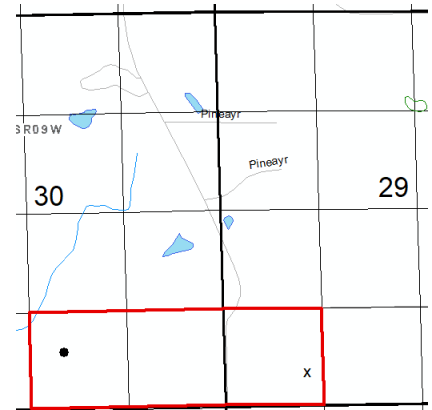

Prev Permit:

Well Name: Bolhuis 1-29 HD1 Surface Owner: Bolhuis Farms, Inc

Well Type: OIL True Vertical Depth: 3602

Permit Type: Drill Target Formation: TRENTON

H2S Present? No Deepest Formation: TRENTON

120-Acre R303 Drilling Unit, S/2 SE/4 Sec 30, SW/4 SW/4 Sec 29

Location:	QT QT QT	Sec	Township	Range	Township Name	County	Feet From Section Line	Feet From DRLG Unit Line
SL:	SESWSW	29	2S	9W	CHARLESTON	KALAMAZOO	450 S 1069 W	450 S 150 E
BHL:	NWSWSE	30	2S	9W	CHARLESTON	KALAMAZOO	754 S 2207 W	575 N 439 W

Michigan Department of
Environment, Great Lakes, and Energy
Oil, Gas and Minerals Division

PERMIT APPLICATIONS

02/20/2023 THRU 02/24/2023



Application Number Date Received Permittee Number Permittee Name

827 02/23/2023 6040 NU ENERGY OPERATING INC
P.O. BOX 1122
GAYLORD, MI 49734

Prev Permit:

Well Name: CRAMER RIDDLE A2-35

Well Type: OIL

Permit Type: Drill

H2S Present? No

Surface Owner: Dewayne and Angela Cramer

True Vertical Depth: 3750

Target Formation: DUNDEE

Deepest Formation: DUNDEE

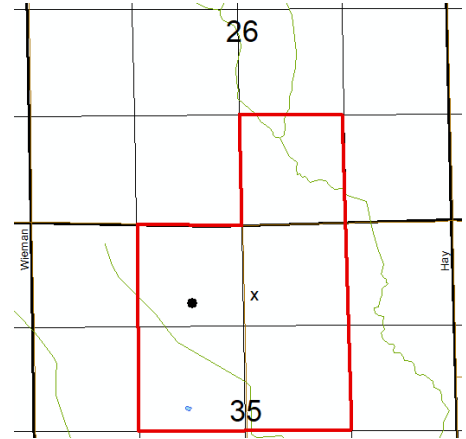

200-Acre Drilling Unit with statutory pooling (petition pending), E/2 NW/4, W/2 NE/4 Sec 35, SW/4 SE/4 Sec 26

Location:	QT QT QT	Sec	Township	Range	Township Name	County	Feet From Section Line	Feet From DRLG Unit Line
SL:	SWNWNE	35	18N	1E	HAY	GLADWIN	863 N 2499 E	1705 S 140W
BHL:	SEENW	35	18N	1E	HAY	GLADWIN	981 N 1997 E	1599 S 646 E

Michigan Department of
Environment, Great Lakes, and Energy
Oil, Gas and Minerals Division

PERMIT APPLICATIONS

02/20/2023 THRU 02/24/2023



Application Number Date Received Permittee Number Permittee Name

831 02/23/2023 6040 NU ENERGY OPERATING INC
P.O. BOX 1122
GAYLORD, MI 49734

Prev Permit:

Well Name: CRAMER MAXWELL A3-35

Surface Owner: Dewayne and Angela Cramer

Well Type: OIL

True Vertical Depth: 3750

Permit Type: Drill

Target Formation: DUNDEE

H2S Present? No

Deepest Formation: DUNDEE

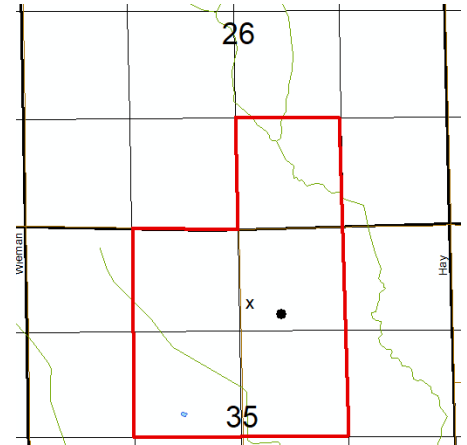

200-Acre Drilling Unit with statutory pooling (petition pending), E/2 NW/4, W/2 NE/4 Sec 35, SW/4 SE/4 Sec 26

Location:	QT QT QT	Sec	Township	Range	Township Name	County	Feet From Section Line	Feet From DRLG Unit Line
SL:	SWNWNE	35	18N	1E	HAY	GLADWIN	939 N 2499 E	1629 S 140 W
BHL:	SWNWNE	35	18N	1E	HAY	GLADWIN	1056 N 2154 E	1522 S 485 W

Michigan Department of
Environment, Great Lakes, and Energy
Oil, Gas and Minerals Division

PERMIT APPLICATIONS

02/20/2023 THRU 02/24/2023



Application Number Date Received Permittee Number Permittee Name Page 4

802 02/23/2023 8139 MUSKEGON OPERATING COMPANY LLC
1425 S MISSION RD

MOUNT PLEASANT, MI 48858

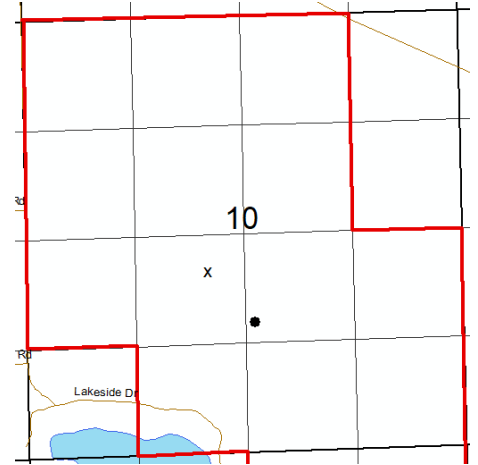

Prev Permit: 61364

Well Name: Straub Unit 2-10

Well Type: OTI

Permit Type: Convert

H2S Present? Yes

Surface Owner: John Kreiger, Gail Kreiger, and Joseph Kreiger

True Vertical Depth: 5473

Target Formation: LUCAS

Deepest Formation: AMHERSTBURG

Straub (EOR) Unit, Order 03-2015

Location:	QT QT QT	Sec	Township	Range	Township Name	County	Feet From Section Line	Feet From DRLG Unit Line
SL:	NENESW	10	20N	3W	FRANKLIN	CLARE	2189 S 2208 W	2189 S 2208 W
BHL:	SWNWSE	10	20N	3W	FRANKLIN	CLARE	1568 S 2563 W	2888 S 2563 E

Michigan Department of
Environment, Great Lakes, and Energy
Oil, Gas and Minerals Division

UPDATED PERMITS

02/20/2023 THRU 02/24/2023



Permit Number Permittee Number Permittee Name

PLUGGING INSTRUCTIONS ISSUED:

60358 7729 SALT CITY LLC
775 NORTH 2ND STREET
BRIGHTON, MI 48116

API Well Number: 21-065-55614-03-00

Well Name: BRIGGS 1-15C

True Vertical Depth: 4417

Plug Inst. Issue Date: 8/22/2022

Location	QT QT QT	Sec	Township	Range	Township Name	County	Feet From Section Line	Feet From DRLG Unit
SL:	SENWSE	15	2N	2E	WHITE OAK	INGHAM	1908 S 1580 E	
BHL:	SENWSE	15	2N	2E	WHITE OAK	INGHAM	1563 S 1562 E	1096 N 1051 W

Comment: App to P&A expires on 11/30/2022.

.....

Michigan Department of
Environment, Great Lakes, and Energy
Oil, Gas and Minerals Division

UPDATED PERMITS

02/20/2023 THRU 02/24/2023



Permit Number Permittee Number Permittee Name

RECORD OF WELL PLUGGING:

42879 6361 RIVERSIDE ENERGY MICHIGAN LLC
10691 EAST CARTER ROAD
SUITE 201
TRAVERSE CITY, MI 49684

API Well Number: 21-009-42879-00-00

Well Name: GREEN RIVER D4-7

Plugging Date: 1/9/2023

Location	QT QT QT	Sec	Township	Range	Township Name	County	Feet From Section Line	Feet From DRLG Unit
SL:	SESESE	7	30N	6W	CHESTONIA	ANTRIM	442 S 421 E	442 S 421 E
BHL:	SESESE	7	30N	6W	CHESTONIA	ANTRIM		

61375 6310 CORE ENERGY LLC
1011 NOTEWARE DRIVE
TRAVERSE CITY, MI 49686

API Well Number: 21-137-29298-01-00

Well Name: BUTKA 1-10A

Plugging Date: 1/31/2023

Location	QT QT QT	Sec	Township	Range	Township Name	County	Feet From Section Line	Feet From DRLG Unit
SL:	NWNESE	10	30N	2W	CHESTER	OTSEGO	2103 S 934 E	
BHL:	NWNESE	10	30N	2W	CHESTER	OTSEGO	2103 S 934 E	507 N 934 E

Michigan Department of
Environment, Great Lakes, and Energy
Oil, Gas and Minerals Division

UPDATED PERMITS

02/20/2023 THRU 02/24/2023



Permit Number Permittee Number Permittee Name

61573 8139 MUSKEGON OPERATING COMPANY LLC
1425 S MISSION RD
MOUNT PLEASANT, MI 48858 USA

API Well Number: 21-035-62018-00-00

Well Name: YODER 1-20

True Vertical Depth: 3732

Plugging Date: 8/19/2022

Location	QT QT QT	Sec	Township	Range	Township Name	County	Feet From Section Line	Feet From DRLG Unit
SL:	SESWNE	20	17N	3W	SHERIDAN	CLARE	2461 N 1842 E	1138 N 802 W
BHL:	SESWNE	20	17N	3W	SHERIDAN	CLARE	2461 N 1842 E	1138 N 802 W

Michigan Department of
Environment, Great Lakes, and Energy
Oil, Gas and Minerals Division

UPDATED PERMITS

02/20/2023 THRU 02/24/2023



Permit Number Permittee Number Permittee Name

APPLICATIONS TO CHANGE WELL STATUS:

53919 171 OSOSKI EDWARD D DBA FEDERAL OIL COMPANY
704 E MICHIGAN
MOUNT PLEASANT, MI 48858

API Well Number: 21-165-34582-04-00

Well Name: STATE WEXFORD & BORAK 1-6 HD2 True Vertical Depth: 5830

Approval Date: 2/23/2023

Location	QT QT QT	Sec	Township	Range	Township Name	County	Feet From Section Line	Feet From DRLG Unit
SL:	SENENW	6	24N	12W	WEXFORD	WEXFORD	1022 N 2082 W	
BHL:	SWNWNE	6	24N	12W	WEXFORD	WEXFORD	1151 N 2103 E	1151 N 1823 W

Proposed Rework: ACOWS to Continue Drilling - HDH

Comment: ACOWS to isolate HD1 and HD2 and drill HD3 expires on 2/23/2024

Michigan Department of
Environment, Great Lakes, and Energy
Oil, Gas and Minerals Division

UPDATED PERMITS

02/20/2023 THRU 02/24/2023



Permit Number Permittee Number Permittee Name

RECORD OF CHANGE OF WELL STATUS:

29958 6310 CORE ENERGY LLC
1011 NOTEWARE DRIVE
TRAVERSE CITY, MI 49686

API Well Number: 21-137-29958-01-00

Well Name: WOLF, CARL ET AL "C" 1 HD1 True Vertical Depth: 5779

Change Date: 9/1/2022

Location	QT QT QT	Sec	Township	Range	Township Name	County	Feet From Section Line	Feet From DRLG Unit
SL:	NWNWNW	11	30N	2W	CHESTER	OTSEGO	460 N 460 W	
BHL:	SWSWSW	2	30N	2W	CHESTER	OTSEGO	364 S 113 W	2250 N 1202 E

Proposed Rework: Reworked to Observation Well

Comment: Reworked from Oil well to Observation well.

30113 7772 LAMBDA ENERGY RESOURCES LLC
12012 Wickchester Lane
Suite 300
Houston, TX 77079 USA

API Well Number: 21-055-30038-01-00

Well Name: BIERMACHER STATE BLAIR 2-26A True Vertical Depth: 6020

Change Date: 1/27/2023

Location	QT QT QT	Sec	Township	Range	Township Name	County	Feet From Section Line	Feet From DRLG Unit
SL:	SESESW	26	26N	11W	BLAIR	GRAND TRAVERSE	613 S 235 E	
BHL:	SWNESW	26	26N	11W	BLAIR	GRAND TRAVERSE	1117 N 949 E	1117 N 371 W

Proposed Rework: Reworked to Perforate & Test Current Formation

Comment: Reworked to add perfs to the Niagaran.

Michigan Department of
Environment, Great Lakes, and Energy
Oil, Gas and Minerals Division

UPDATED PERMITS

02/20/2023 THRU 02/24/2023



Permit Number Permittee Number Permittee Name

37794 6310 CORE ENERGY LLC
1011 NOTEWARE DRIVE
TRAVERSE CITY, MI 49686

API Well Number: 21-137-37794-00-00

Well Name: JANIK & MACKOWIAC 1-11 True Vertical Depth: 6084

Change Date: 9/1/2022

Location	QT QT QT	Sec	Township	Range	Township Name	County	Feet From Section Line	Feet From DRLG Unit
SL:	NEESE	11	30N	3W	BAGLEY	OTSEGO	1155 S 562 E	
BHL:	NESWSE	11	30N	3W	BAGLEY	OTSEGO	710 S 703 W	610 N 617 E

Proposed Rework: Reworked to Observation Well

Comment: Reworked from Oil well to Observation well.

60596 6310 CORE ENERGY LLC
1011 NOTEWARE DRIVE
TRAVERSE CITY, MI 49686

API Well Number: 21-137-60596-01-00

Well Name: CARGAS 3-2 HD2 True Vertical Depth: 5806

Change Date: 9/1/2022

Location	QT QT QT	Sec	Township	Range	Township Name	County	Feet From Section Line	Feet From DRLG Unit
SL:	SWSWSW	2	30N	2W	CHESTER	OTSEGO	290 S 279 W	
BHL:	SWNESE	3	30N	2W	CHESTER	OTSEGO	1391 S 699 E	1250 N 612 W

Proposed Rework: Reworked to Observation Well

Comment: Reworked from Oil well to Observation well.

Michigan Department of
Environment, Great Lakes, and Energy
Oil, Gas and Minerals Division

UPDATED PERMITS

02/20/2023 THRU 02/24/2023



Permit Number Permittee Number Permittee Name

60833 6310 CORE ENERGY LLC
1011 NOTEWARE DRIVE
TRAVERSE CITY, MI 49686

API Well Number: 21-137-29265-01-00

Well Name: PIASECKI 1-7A

Change Date: 9/1/2022

Location	QT QT QT	Sec	Township	Range	Township Name	County	Feet From Section Line	Feet From DRLG Unit
SL:	SWNENE	7	30N	2W	CHESTER	OTSEGO	849 N 660 E	1806 S 1933 E
BHL:	SWNENE	7	30N	2W	CHESTER	OTSEGO		

Proposed Rework: Reworked to Observation Well

Comment: Reworked from Oil well to Observation well.

