

Michigan Department of  
Environment, Great Lakes, and Energy  
Oil, Gas and Minerals Division

PERMIT APPLICATIONS

04/03/2023 THRU 04/07/2023



MICHIGAN DEPARTMENT OF  
ENVIRONMENT, GREAT LAKES, AND ENERGY

Application Number

Date Received

Permittee  
Number

Permittee  
Name

Page 1

845                      04/3/2023                      8139                      MUSKEGON OPERATING  
COMPANY LLC  
1425 S MISSION RD  
  
MOUNT PLEASANT, MI 48858

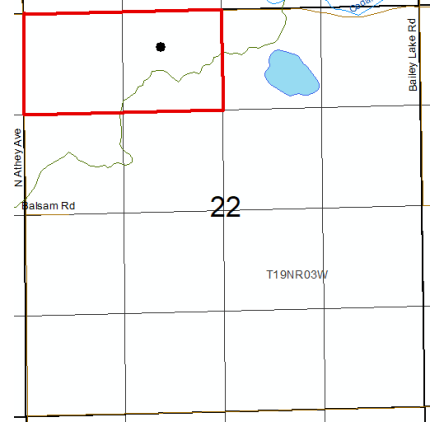

80-Acre R303 Drilling Unit (Petition for EOR pending), N/2 NW/4 Sec 22

Prev Permit: 59345

Well Name: Holcomb 1-22

Well Type: WIW

Permit Type: Convert

H2S Present? No

Surface Owner: Ashley Cripps

True Vertical Depth: 5202

Target Formation: RICHFIELD

Deepest Formation: AMHERSTBURG

Location:	QT QT QT	Sec	Township	Range	Township Name	County	Feet From Section Line	Feet From DRLG Unit Line
SL:	NWNENW	22	19N	3W	HAMILTON	CLARE	490 N 1826 W	490 N 782 E
BHL:	NWNENW	22	19N	3W	HAMILTON	CLARE	490 N 1826 W	490 N 782 E

Michigan Department of  
Environment, Great Lakes, and Energy  
Oil, Gas and Minerals Division

PERMIT LIST

04/03/2023 THRU 04/07/2023



Permit Number      Issue Date      Permittee Number      Permittee Name      Page 1

61686      4/3/2023      70      TRENDWELL ENERGY CORPORATION  
10 E BRIDGE ST STE 200  
ROCKFORD, MI 49341

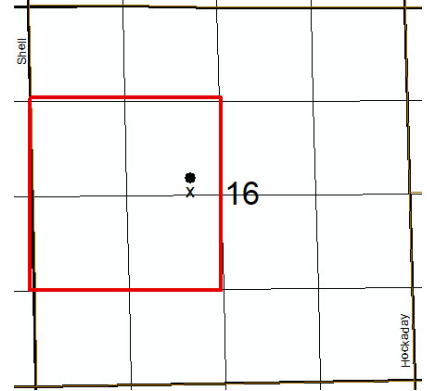

API Well No: 21-051-62020-00-00

Prev Permit:

Well Name: BEECHY 1-16

Surface Owner: ROBERT J. BEECHY

Well Type: Oil Well

True Vertical Depth: 4050FT

Permit Type: Drill

Target Formation: DUNDEE

H2S Present? Yes

Deepest Formation: DUNDEE

160-Acre R303 Drilling Unit, N/2 SW/4, S/2 NW/4 Sec 16

Location:	QT QT QT	Sec	Township	Range	Township Name	County	Feet From Section Line	Feet From DRLG Unit Line
SL:	NENESW	16	19N	1W	GLADWIN	GLADWIN	2512 S 2220 W	
BHL:	SESENW	16	19N	1W	GLADWIN	GLADWIN	2620 N 2215 W	1290 N 430 E

61687      4/7/2023      80      BAILER AND DESHAW  
P.O. BOX 366  
KAWKAWLIN, MI 48631

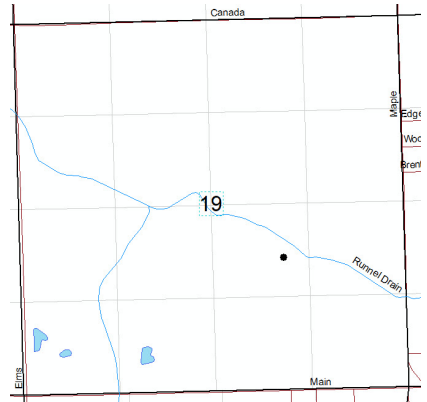

API Well No: 21-145-20798-01-00

Prev Permit: 20798

Well Name: WOLOHAN ESTATE B-1 BDW

Surface Owner: Kloss Partners, LLC

Well Type: Brine Disposal Well

True Vertical Depth:

Permit Type: Convert

Target Formation: DUNDEE

H2S Present? No

Deepest Formation: DUNDEE

Non-producing well, no drilling unit

Location:	QT QT QT	Sec	Township	Range	Township Name	County	Feet From Section Line	Feet From DRLG Unit Line
SL:	SENWSE	19	10N	6E	BIRCH RUN	SAGINAW	755 N 920 W	
BHL:	SENWSE	19	10N	6E	BIRCH RUN	SAGINAW	755 N 920 W	

Michigan Department of  
Environment, Great Lakes, and Energy  
Oil, Gas and Minerals Division

UPDATED PERMITS

04/03/2023 THRU 04/07/2023



Permit Number      Permittee Number      Permittee Name

**PLUGGING INSTRUCTIONS ISSUED:**

43178      6361      RIVERSIDE ENERGY MICHIGAN LLC  
10691 EAST CARTER ROAD  
SUITE 201  
TRAVERSE CITY, MI 49684

API Well Number: 21-137-43178-00-00

Well Name: BERSCHBACH 33 SWD

Plug Inst. Issue Date: 4/5/2023

Location	QT QT QT	Sec	Township	Range	Township Name	County	Feet From Section Line	Feet From DRLG Unit
SL:	NESWSW	33	31N	2W	DOVER	OTSEGO	710 S 1200 W	
BHL:	NESWSW	33	31N	2W	DOVER	OTSEGO		

Comment: App to P&A expires on 4/5/2024

43888      6361      RIVERSIDE ENERGY MICHIGAN LLC  
10691 EAST CARTER ROAD  
SUITE 201  
TRAVERSE CITY, MI 49684

API Well Number: 21-137-43888-00-00

Well Name: AMEJKA 1-34

Plug Inst. Issue Date: 4/5/2023

Location	QT QT QT	Sec	Township	Range	Township Name	County	Feet From Section Line	Feet From DRLG Unit
SL:	NWSWSW	34	31N	2W	DOVER	OTSEGO	720 S 484 W	600 N 484 W
BHL:	NWSWSW	34	31N	2W	DOVER	OTSEGO		

Comment: App to P&A expires on 4/5/2024

Michigan Department of  
Environment, Great Lakes, and Energy  
Oil, Gas and Minerals Division

UPDATED PERMITS

04/03/2023 THRU 04/07/2023



Permit Number      Permittee Number      Permittee Name

8495      4428      MID MICHIGAN GAS STORAGE CO  
P.O. BOX 2446  
HOUSTON, TX 77252-2446 USA

API Well Number: 21-133-08495-00-00

Well Name: HEYNOR & BADERSCHNEIDER 5

Plug Inst. Issue Date: 4/5/2023

Location	QT QT QT	Sec	Township	Range	Township Name	County	Feet From Section Line	Feet From DRLG Unit
SL:	CNNW	30	18N	10W	LINCOLN	OSCEOLA	1320 N 1320 W	
BHL:		30	18N	10W	LINCOLN	OSCEOLA		

Comment: App to P&A expires on 4/5/2024

8987      4428      MID MICHIGAN GAS STORAGE CO  
PO.. BOX 2446  
HOUSTON, TX 77252-2446 USA

API Well Number: 21-133-08987-00-00

Well Name: JEWETT, J B-2

Plug Inst. Issue Date: 4/5/2023

Location	QT QT QT	Sec	Township	Range	Township Name	County	Feet From Section Line	Feet From DRLG Unit
SL:	S2SESE	31	18N	10W	LINCOLN	OSCEOLA	321 S 660 E	321 S 660 E
BHL:	S2SESE	31	18N	10W	LINCOLN	OSCEOLA		

Comment: App to P&A expires on 4/5/2024

Michigan Department of  
Environment, Great Lakes, and Energy  
Oil, Gas and Minerals Division

UPDATED PERMITS

04/03/2023 THRU 04/07/2023



Permit Number      Permittee Number      Permittee Name

9140                      4428                      MID MICHIGAN GAS STORAGE CO  
P.O. BOX 2446  
HOUSTON, TX 77252-2446 USA

API Well Number: 21-133-09140-00-00

Well Name: RICHARD, M L 1

Plug Inst. Issue Date: 4/5/2023

Location	QT QT QT	Sec	Township	Range	Township Name	County	Feet From Section Line	Feet From DRLG Unit
SL:	S2NESE	19	18N	10W	LINCOLN	OSCEOLA	990 N 660 E	990 N 660 E
BHL:	S2NESE	19	18N	10W	LINCOLN	OSCEOLA		

Comment: App to P&A expires on 4/5/2024

9282                      4428                      MID MICHIGAN GAS STORAGE CO  
P.O. BOX 2446  
HOUSTON, TX 77252-2446 USA

API Well Number: 21-133-09282-00-00

Well Name: GRILL & KINGSBURY 31

Plug Inst. Issue Date: 4/5/2023

Location	QT QT QT	Sec	Township	Range	Township Name	County	Feet From Section Line	Feet From DRLG Unit
SL:	CNSW	16	18N	10W	LINCOLN	OSCEOLA	1320 S 1320 W	1320 N 1320 E
BHL:		16	18N	10W	LINCOLN	OSCEOLA		

Comment: App to P&A expires on 4/5/2024

Michigan Department of  
Environment, Great Lakes, and Energy  
Oil, Gas and Minerals Division

UPDATED PERMITS

04/03/2023 THRU 04/07/2023



Permit Number      Permittee Number      Permittee Name

**RECORD OF WELL PLUGGING:**

50060      25      DELTA OIL CO INC  
125 WINDSOR DR STE 101  
OAK BROOK, IL 60523

API Well Number: 21-137-50060-00-00

Well Name: HOWARD D1-35

Plugging Date: 1/5/2022

Location	QT QT QT	Sec	Township	Range	Township Name	County	Feet From Section Line	Feet From DRLG Unit
SL:	SWSWSW	35	32N	2W	CORWITH	OTSEGO	340 S 340 W	340 S 340 W
BHL:	SWSWSW	35	32N	2W	CORWITH	OTSEGO		

Michigan Department of  
Environment, Great Lakes, and Energy  
Oil, Gas and Minerals Division

UPDATED PERMITS

04/03/2023 THRU 04/07/2023



Permit Number      Permittee Number      Permittee Name

**APPLICATIONS TO CHANGE WELL STATUS:**

35360      47      MILLER ENERGY COMPANY II LLC  
P.O. BOX 632  
TRAVERSE CITY, MI 49685 USA

API Well Number: 21-143-35360-00-00

Well Name: SAINT HELEN UNIT TRACT 20 4

Approval Date: 4/4/2023

Location	QT QT QT	Sec	Township	Range	Township Name	County	Feet From Section Line	Feet From DRLG Unit
SL:	SWSWSW	20	24N	1W	AU SABLE	ROSCOMMON	330 S 83 W	
BHL:	SWSWSW	20	24N	1W	AU SABLE	ROSCOMMON		

Proposed Rework: ACOWS to Perforate and Test Current Formation

Comment: ACOWS to perf and test additional Richfield pay expires on 4/4/2024

58281      104      WEST BAY EXPLORATION COMPANY  
13685 S WEST BAYSHORE DR  
TRAVERSE CITY, MI 49684

API Well Number: 21-025-58281-00-00

Well Name: DOUBLE EAGLE FARMS 2-12      True Vertical Depth: 4754

Approval Date: 4/3/2023

Location	QT QT QT	Sec	Township	Range	Township Name	County	Feet From Section Line	Feet From DRLG Unit
SL:	NWNENW	12	2S	5W	MARENGO	CALHOUN	660 N 1650 W	
BHL:	NWNENW	12	2S	5W	MARENGO	CALHOUN	340 N 1650 W	340 N 330 W

Proposed Rework: Temporarily Abandoned

Comment: ACOWS for TA expires on 3/31/2024.

Michigan Department of  
Environment, Great Lakes, and Energy  
Oil, Gas and Minerals Division

UPDATED PERMITS

04/03/2023 THRU 04/07/2023



Permit Number      Permittee Number      Permittee Name

58627      104      WEST BAY EXPLORATION COMPANY  
13685 S WEST BAYSHORE DR TRAVERSE  
CITY, MI 49684

API Well Number: 21-025-58627-00-00

Well Name: DOUBLE EAGLE FARMS 4-12

Approval Date: 4/3/2023

Location	QT QT QT	Sec	Township	Range	Township Name	County	Feet From Section Line	Feet From DRLG Unit
SL:	SENEW	12	2S	5W	MARENGO	CALHOUN	930 N 2311 W	396 S 330 E
BHL:	SENEW	12	2S	5W	MARENGO	CALHOUN		

Proposed Rework:      Temporarily Abandoned

Comment: ACOWS for TA expires on 3/31/2024.

58983      104      WEST BAY EXPLORATION COMPANY  
13685 S WEST BAYSHORE DR  
TRAVERSE CITY, MI 49684

API Well Number: 21-025-58983-00-00

Well Name: RIGELMAN 1-2      True Vertical Depth: 4486

Approval Date: 4/3/2023

Location	QT QT QT	Sec	Township	Range	Township Name	County	Feet From Section Line	Feet From DRLG Unit
SL:	SESENE	2	2S	5W	MARENGO	CALHOUN	2487 N 406 E	
BHL:	NWNESE	2	2S	5W	MARENGO	CALHOUN	2456 S 984 E	1129 S 350 W

Proposed Rework:      Temporarily Abandoned

Comment: ACOWS for TA expires on 3/31/2024



Michigan Department of  
Environment, Great Lakes, and Energy  
Oil, Gas and Minerals Division

UPDATED PERMITS

04/03/2023 THRU 04/07/2023



Permit Number      Permittee Number      Permittee Name

59060      104      WEST BAY EXPLORATION COMPANY  
13685 S WEST BAYSHORE DR  
TRAVERSE CITY, MI 49684

API Well Number: 21-025-58452-01-00

Well Name: KILBOURN FARM 2-2A      True Vertical Depth: 4441

Approval Date: 4/3/2023

Location	QT QT QT	Sec	Township	Range	Township Name	County	Feet From Section Line	Feet From DRLG Unit
SL:	SEWSE	2	2S	5W	MARENGO	CALHOUN	1657 S 1668 E	330 S 333 E
BHL:	SWNWSE	2	2S	5W	MARENGO	CALHOUN	1752 S 2329 E	425 S 340 W

Proposed Rework:      Temporarily Abandoned

Comment: ACOWS for TA expires on 3/31/2024

59853      104      WEST BAY EXPLORATION COMPANY  
13685 S WEST BAYSHORE DR TRAVERSE  
CITY, MI 49684

API Well Number: 21-075-59853-00-00

Well Name: HILDEN-ROVSEK ET AL 1-16

Approval Date: 4/3/2023

Location	QT QT QT	Sec	Township	Range	Township Name	County	Feet From Section Line	Feet From DRLG Unit
SL:	SWNWSE	16	4S	2E	NORVELL	JACKSON	1496 S 2038 E	472 N 596 W
BHL:	SWNWSE	16	4S	2E	NORVELL	JACKSON		

Proposed Rework:      Temporarily Abandoned

Comment: ACOWS for TA expires on 3/31/2024

Michigan Department of  
Environment, Great Lakes, and Energy  
Oil, Gas and Minerals Division

UPDATED PERMITS

04/03/2023 THRU 04/07/2023



Permit Number      Permittee Number      Permittee Name

59957      104      WEST BAY EXPLORATION COMPANY  
13685 S WEST BAYSHORE DR  
TRAVERSE CITY, MI 49684

API Well Number: 21-025-58602-01-00

Well Name: RUGG 1-7A HD1      True Vertical Depth: 4360

Approval Date: 4/3/2023

Location	QT QT QT	Sec	Township	Range	Township Name	County	Feet From Section Line	Feet From DRLG Unit
SL:	SWSWSE	7	2S	4W	SHERIDAN	CALHOUN	525 S 1127 W	
BHL:	NENESW	7	2S	4W	SHERIDAN	CALHOUN	2077 S 439 W	582 N 439 W

Proposed Rework:      Temporarily Abandoned

Comment: ACOWS for TA expires on 3/31/2024

60055      104      WEST BAY EXPLORATION COMPANY  
13685 S WEST BAYSHORE DR TRAVERSE  
CITY, MI 49684

API Well Number: 21-075-60055-00-00

Well Name: LENNOX TRUST ET AL 1-15      True Vertical Depth: 4199

Approval Date: 4/3/2023

Location	QT QT QT	Sec	Township	Range	Township Name	County	Feet From Section Line	Feet From DRLG Unit
SL:	SWSESW	15	4S	2E	NORVELL	JACKSON	172 S 1772 W	
BHL:	NESWSW	15	4S	2E	NORVELL	JACKSON	961 S 733 W	355 N 576 E

Proposed Rework:      Temporarily Abandoned

Comment: ACOWS for TA expires on 3/31/2024

Michigan Department of  
Environment, Great Lakes, and Energy  
Oil, Gas and Minerals Division

UPDATED PERMITS

04/03/2023 THRU 04/07/2023



Permit Number      Permittee Number      Permittee Name

60078      104      WEST BAY EXPLORATION COMPANY  
13685 S WEST BAYSHORE DR  
TRAVERSE CITY, MI 49684

API Well Number: 21-075-60078-00-00

Well Name: HAYSTEAD 3-9 HD1      True Vertical Depth: 4202

Approval Date: 4/3/2023

Location	QT QT QT	Sec	Township	Range	Township Name	County	Feet From Section Line	Feet From DRLG Unit
SL:	NENWSW	9	4S	2E	NORVELL	JACKSON	2445 S 1293 W	
BHL:	NENESW	9	4S	2E	NORVELL	JACKSON	2282 S 2274 W	336 N 345 E

Proposed Rework:      Temporarily Abandoned

Comment: ACOWS for TA expires on 3/31/2024

60385      104      WEST BAY EXPLORATION COMPANY  
13685 S WEST BAYSHORE DR  
TRAVERSE CITY, MI 49684

API Well Number: 21-075-60385-01-00

Well Name: WEST BAY 1-35 HD1      True Vertical Depth: 4189

Approval Date: 4/3/2023

Location	QT QT QT	Sec	Township	Range	Township Name	County	Feet From Section Line	Feet From DRLG Unit
SL:	SWSENW	35	4S	2E	NORVELL	JACKSON	2630 N 1437 W	
BHL:	SWSENW	35	4S	2E	NORVELL	JACKSON	2310 N 1654 W	331 N 332 W

Proposed Rework:      Temporarily Abandoned

Comment: ACOWS for TA expires on 3/31/2024

Michigan Department of  
Environment, Great Lakes, and Energy  
Oil, Gas and Minerals Division

UPDATED PERMITS

04/03/2023 THRU 04/07/2023



Permit Number      Permittee Number      Permittee Name

60435      104      WEST BAY EXPLORATION COMPANY  
13685 S WEST BAYSHORE DR  
TRAVERSE CITY, MI 49684

API Well Number: 21-075-60435-01-00

Well Name: WEST BAY 1-34 HD2      True Vertical Depth: 4217

Approval Date: 4/3/2023

Location	QT QT QT	Sec	Township	Range	Township Name	County	Feet From Section Line	Feet From DRLG Unit
SL:	NWNESW	35	4S	2E	NORVELL	JACKSON	76 N 1209 E	
BHL:	SWSENE	34	4S	2E	NORVELL	JACKSON	2328 N 1007 E	343 N 333 W

Proposed Rework:      Temporarily Abandoned

Comment: ACOWS for TA expires on 3/31/2024

60517      104      WEST BAY EXPLORATION COMPANY  
13685 S WEST BAYSHORE DR  
TRAVERSE CITY, MI 49684

API Well Number: 21-075-60517-00-00

Well Name: HARDCASTLE 2-26 HD1      True Vertical Depth: 4254

Approval Date: 4/3/2023

Location	QT QT QT	Sec	Township	Range	Township Name	County	Feet From Section Line	Feet From DRLG Unit
SL:	SENEW	26	4S	2E	NORVELL	JACKSON	895 N 2250 W	
BHL:	NESENW	26	4S	2E	NORVELL	JACKSON	1782 N 2377 W	851 S 411 W

Proposed Rework:      Temporarily Abandoned

Comment: ACOWS for TA expires on 3/31/2024

Michigan Department of  
Environment, Great Lakes, and Energy  
Oil, Gas and Minerals Division

UPDATED PERMITS

04/03/2023 THRU 04/07/2023



Permit Number      Permittee Number      Permittee Name

60609      104      WEST BAY EXPLORATION COMPANY  
13685 S WEST BAYSHORE DR  
TRAVERSE CITY, MI 49684

API Well Number: 21-075-60609-00-00

Well Name: SHELL 2-35

True Vertical Depth: 4247

Approval Date: 4/3/2023

Location	QT QT QT	Sec	Township	Range	Township Name	County	Feet From Section Line	Feet From DRLG Unit
SL:	SENWNW	35	4S	2E	NORVELL	JACKSON	902 N 907 W	
BHL:	NESWNW	35	4S	2E	NORVELL	JACKSON	1324 N 931 W	653 S 931 W

Proposed Rework:      Temporarily Abandoned

Comment: ACOWS for TA expires on 3/31/2024

60863      5320      SAVOY ENERGY LP  
P.O. BOX 1560  
TRAVERSE CITY, MI 49685-1560 USA

API Well Number: 21-075-60831-01-00

Well Name: BOYCE 1-24A HD1

True Vertical Depth: 4227

Approval Date: 4/3/2023

Location	QT QT QT	Sec	Township	Range	Township Name	County	Feet From Section Line	Feet From DRLG Unit
SL:	NWNWSW	24	4S	1E	COLUMBIA	JACKSON	2671 S 331 W	
BHL:	SESWNW	24	4S	1E	COLUMBIA	JACKSON	2499 N 978 W	496 N 350 E

Proposed Rework:      Temporarily Abandoned

Comment: ACOWS for TA expires on 3/31/2024

Michigan Department of  
Environment, Great Lakes, and Energy  
Oil, Gas and Minerals Division

UPDATED PERMITS

04/03/2023 THRU 04/07/2023



Permit Number      Permittee Number      Permittee Name

**TRANSFER OF OWNERSHIP:**

46677      6361      RIVERSIDE ENERGY MICHIGAN LLC  
10691 EAST CARTER ROAD  
SUITE 201  
TRAVERSE CITY, MI 49684

API Well Number: 21-119-46677-00-00

Well Name: MEIER 2-16

Transfer Date: 4/7/2023

Previous Owner: TAI INC dba TRENDWELL  
ANTRIM INC

Location	QT QT QT	Sec	Township	Range	Township Name	County	Feet From Section Line	Feet From DRLG Unit
SL:	SWSWSW	16	30N	2E	BRILEY	MONTMORENCY	330 S 330 W	
BHL:	SWSWSW	16	30N	2E	BRILEY	MONTMORENCY		