

Michigan Department of
Environment, Great Lakes, and Energy
Oil, Gas and Minerals Division

PERMIT APPLICATIONS

07/17/2023 THRU 07/21/2023



876 07/19/2023 104 WEST BAY EXPLORATION COMPANY
13685 S WEST BAYSHORE DR
TRAVERSE CITY, MI 49684

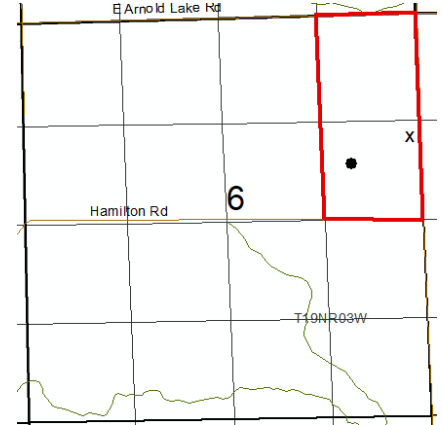

80-Acre R303 Drilling Unit, E/2 NE/4 Section 6

Prev Permit:

Well Name: IUTZI 1-6

Well Type: OIL

Permit Type: Drill

H2S Present? Yes

Surface Owner: Bernard & Mary Iutzi

True Vertical Depth: 4058

Target Formation: DUNDEE

Deepest Formation: DUNDEE

Location:	QT QT QT	Sec	Township	Range	Township Name	County	Feet From Section Line	Feet From DRLG Unit Line
SL:	NESENE	6	19N	3W	HAMILTON	CLARE	1670 N 175 E	1092 S 175 E
BHL:	NWSENE	6	19N	3W	HAMILTON	CLARE	1980 N 960 E	765 S 345 W

Michigan Department of
Environment, Great Lakes, and Energy
Oil, Gas and Minerals Division

PERMIT APPLICATIONS

07/17/2023 THRU 07/21/2023



Application Number Date Received Permittee Number Permittee Name Page 2

887 07/17/2023 4934 FEDERATED OIL AND GAS
PROPERTIES INC
PO BOX 946
TRAVERSE CITY, MI 49685-0946

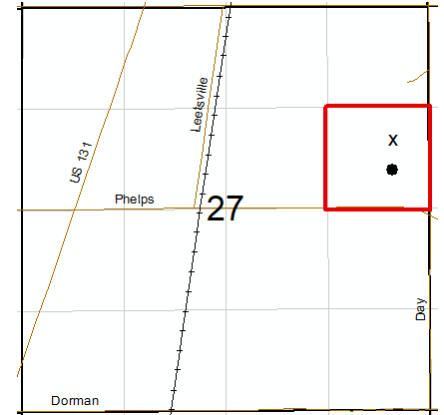

Prev Permit: 29244

Well Name: HILL & FINSTERWALD 1-27
HD2

Surface Owner: WENDELL H.
STOOPS

Well Type: OIL

True Vertical Depth: 6560

Permit Type: Reentry

Target Formation: NIAGARAN BROWN

H2S Present? No

Deepest Formation: NIAGARAN BROWN

40-Acre Drilling Unit (S.O. 45-8-72),
SE/4 NE/4 Section 27

Location:	QT QT QT	Sec	Township	Range	Township Name	County	Feet From Section Line	Feet From DRLG Unit Line
SL:	NESENE	27	28N	7W	RAPID RIVER	KALKASKA	1770 N 455 E	851 S 455 E
BHL:	SESENE	27	28N	7W	RAPID RIVER	KALKASKA	2151 N 471 E	472 S 471 E

889 07/21/2023 6310 CORE ENERGY LLC
1011 NOTEWARE DRIVE
TRAVERSE CITY, MI 49686

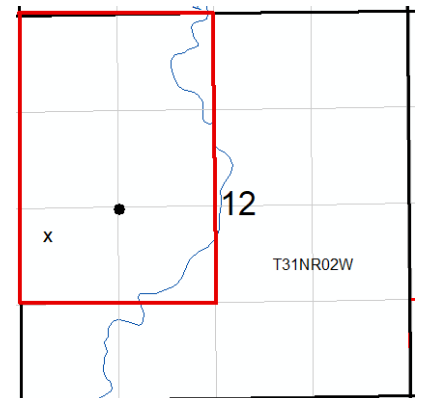

Prev Permit: 61616, 61677

Well Name: BENSINGER 3-12B HD1

Surface Owner: BCT FARM LLC

Well Type: OIL

True Vertical Depth: 4941

Permit Type: Reentry

Target Formation: A-1 CARBONATE

H2S Present? No

Deepest Formation: A-1 CARBONATE

Dover 12 (EOR) Unit, S.O.
03-2020

Location:	QT QT QT	Sec	Township	Range	Township Name	County	Feet From Section Line	Feet From DRLG Unit Line
SL:	NWNWSW	12	31N	2W	DOVER	OTSEGO	2233 S 392 W	
BHL:	NW NESW	12	31N	2W	DOVER	OTSEGO	2565 S 1331 W	1250 S 1316 E

Michigan Department of
Environment, Great Lakes, and Energy
Oil, Gas and Minerals Division

PERMIT LIST

07/17/2023 THRU 07/21/2023



Permit Number Issue Date Permittee Number Permittee Name Page 1

61720 7/20/2023 70 TRENDWELL ENERGY CORPORATION
10 E BRIDGE ST STE 200
ROCKFORD, MI 49341

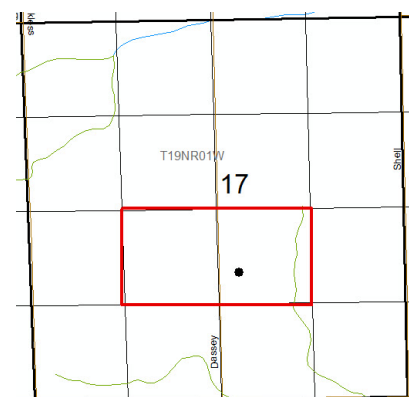

80-Acre R303 Drilling Unit, NE/4 SW/4, NW/4 SE/4 Sec 17

API Well No: 21-051-62021-00-00

Prev Permit:

Well Name: GLICK 1-17

Surface Owner: ORVA P. GLICK

Well Type: Oil Well

True Vertical Depth: 4000FT

Permit Type: Drill

Target Formation: DUNDEE

H2S Present? Yes

Deepest Formation: DUNDEE

Location:	QT QT QT	Sec	Township	Range	Township Name	County	Feet From Section Line	Feet From DRLG Unit Line
SL:	SWNWSE	17	19N	1W	GLADWIN	GLADWIN	1776 S 2347 E	
BHL:	SWNWSE	17	19N	1W	GLADWIN	GLADWIN	1776 S 2347 E	438 S 1032 E

61721 7/21/2023 8139 MUSKEGON OPERATING COMPANY LLC
1425 S MISSION RD
MOUNT PLEASANT, MI 48858

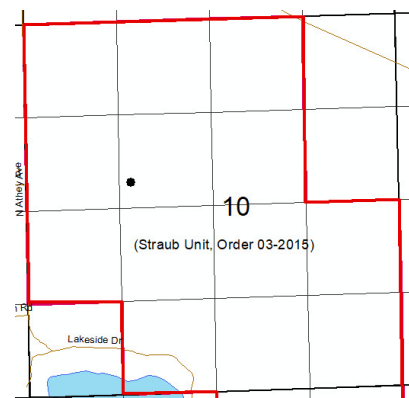

Straub EOR Unit, S.O. 03-2015

API Well No: 21-035-62007-01-00

Prev Permit: 61348

Well Name: STRAUB UNIT 1-10

Surface Owner: MARSH RIVER LLC

Well Type: Water Injection Well

True Vertical Depth: 5548FT

Permit Type: Convert

Target Formation: LUCAS

H2S Present? Yes

Deepest Formation: AMHERSTBURG

Location:	QT QT QT	Sec	Township	Range	Township Name	County	Feet From Section Line	Feet From DRLG Unit Line
SL:	SWSENW	10	20N	3W	FRANKLIN	CLARE	2295 N 1495 W	
BHL:	SWSENW	10	20N	3W	FRANKLIN	CLARE	2295 N 1495 W	2295 N 1495 W

Michigan Department of
Environment, Great Lakes, and Energy
Oil, Gas and Minerals Division

UPDATED PERMITS

07/17/2023 THRU 07/21/2023



Permit Number Permittee Number Permittee Name

TRANSFER OF OWNERSHIP:

35137 100 APOLLO EXPLORATION AND
DEVELOPMENT INC
PO BOX 190
MOUNT PLEASANT, MI
48804-0190 USA

API Well Number: 21-101-34789-01-00

Well Name: RECKOW-HOWES 1-26A

Transfer Date: 7/20/2023

Previous Owner: RIVERSIDE ENERGY MICHIGAN LLC

Location	QT QT QT	Sec	Township	Range	Township Name	County	Feet From Section Line	Feet From DRLG Unit
SL:	SENENE	26	23N	15W	BEAR LAKE	MANISTEE	970 N 330 E	330 S 330 E
BHL:	SENENE	26	23N	15W	BEAR LAKE	MANISTEE		

