

Michigan Department of
Environment, Great Lakes, and Energy
Oil, Gas and Minerals Division

PERMIT APPLICATIONS

08/14/2023 THRU 08/18/2023



Application Number Date Received Permittee Number Permittee Name

886 08/14/2023 104 WEST BAY EXPLORATION COMPANY
13685 S WEST BAYSHORE DR!
TRAVERSE CITY, MI 49684

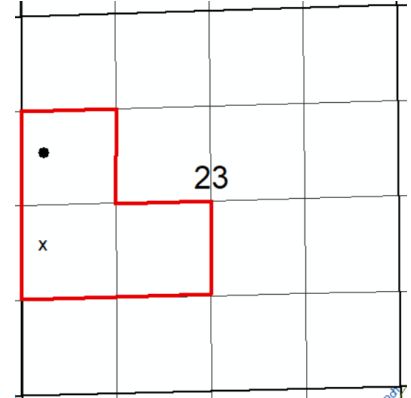

Prev Permit:

Well Name: Little 3-23

Surface Owner: Sherman & Diane Little

Well Type: OIL

True Vertical Depth: 4150

Permit Type: Drill

Target Formation: DUNDEE

H2S Present? Yes

Deepest Formation: DUNDEE

120-Acre R303 Drilling Unit, SW/4 NW/4, N/2 SW/4 Section 23

Location:	QT QT QT	Sec	Township	Range	Township Name	County	Feet From Section Line	Feet From DRLG Unit Line
SL:	NWNWSW	23	20N	3W	FRANKLIN	CLARE	2140 S 362 W	798 S 362 W
BHL:	NWSWNW	23	20N	3W	FRANKLIN	CLARE	1965 N 350 W	626 N 350 W

Michigan Department of
Environment, Great Lakes, and Energy
Oil, Gas and Minerals Division

PERMIT APPLICATIONS

08/14/2023 THRU 08/18/2023



Application Number Date Received Permittee Number Permittee Name

893 08/18/2023 7772 LAMBDA ENERGY RESOURCES LLC
12012 Wickchester Lane
Suite 300
Houston, TX 77079

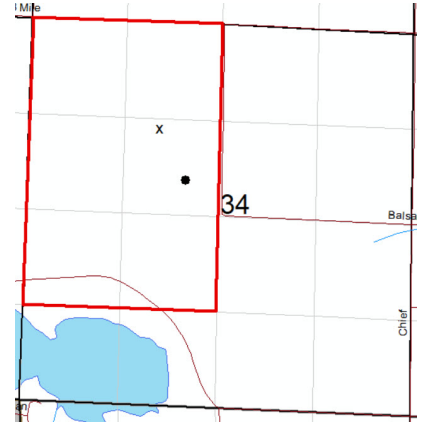

Prev Permit: 30584

Well Name: Mattison Johnson 1-34 HD1

Surface Owner: Gail Mattison
(Formerly Josephine Mattison Trust)

Well Type: GIW

True Vertical Depth: 4872

Permit Type: Convert

Target Formation: NIAGARAN

H2S Present? No

Deepest Formation: NIAGARAN

Bear Lake 34 (EOR) Unit,
Cause 02-2023

Location:	QT QT QT	Sec	Township	Range	Township Name	County	Feet From Section Line	Feet From DRLG Unit Line
SL:	NWSEW	34	23N	15W	BEAR LAKE	MANISTEE	1183 S 864 E	
BHL:	SESEW	34	23N	15W	BEAR LAKE	MANISTEE	490 S 465 E	

Michigan Department of
Environment, Great Lakes, and Energy
Oil, Gas and Minerals Division

PERMIT LIST

08/14/2023 THRU 08/18/2023



Permit Number Issue Date Permittee Number Permittee Name Page 1

61731 8/14/2023 70 TRENDWELL ENERGY CORPORATION
10 E BRIDGE ST STE 200
ROCKFORD, MI 49341

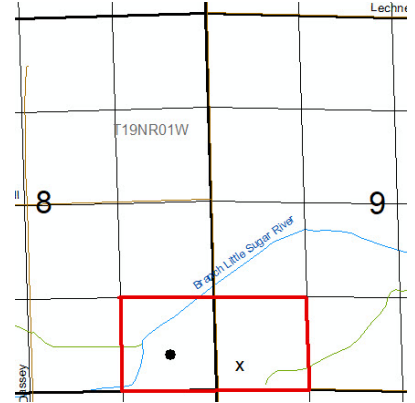

80-Acre R303 Drilling Unit, SE/4
SE/4 Sec 8, SW/4 SW/4 Sec 9

API Well No: 21-051-60696-01-00

Prev Permit: 60696

Well Name: GREER 1-9A

Surface Owner: STANLEY AND ROBIN GREER

Well Type: Oil Well

True Vertical Depth: 4150FT

Permit Type: Reentry

Target Formation: DUNDEE

H2S Present? Yes

Deepest Formation: DETROIT RIVER ANHY

Location:	QT QT QT	Sec	Township	Range	Township Name	County	Feet From Section Line	Feet From DRLG Unit Line
SL:	SWSWSW	9	19N	1W	GLADWIN	GLADWIN	331 S 331 W	
BHL:	SESESE	8	19N	1W	GLADWIN	GLADWIN	495 S 647 E	495 S 671 W

61732 8/16/2023 6361 RIVERSIDE ENERGY MICHIGAN LLC
10691 EAST CARTER ROAD SUITE 201
TRAVERSE CITY, MI 49684

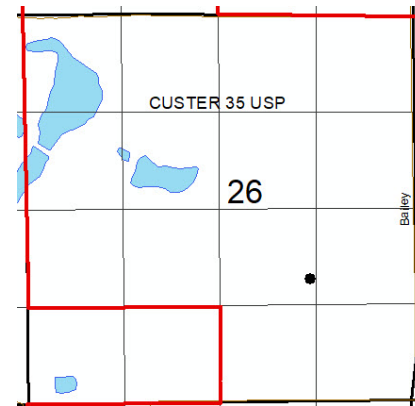

Custer 35 USP, CO2 EGR unit,
Order 08-2022

API Well No: 21-009-54178-01-00

Prev Permit: 54178

Well Name: OTTGEN C3-26

Surface Owner: DOLPH OTTGEN &
STEPHEN OTTGEN

Well Type: CO2 Injection Well

True Vertical Depth: 1842FT

Permit Type: Convert

Target Formation: ANTRIM

H2S Present? No

Deepest Formation: TRAVERSE
LIMESTONE

Location:	QT QT QT	Sec	Township	Range	Township Name	County	Feet From Section Line	Feet From DRLG Unit Line
SL:	SENWSE	26	29N	7W	CUSTER	ANTRIM	1635 S 1435 E	
BHL:	SENWSE	26	29N	7W	CUSTER	ANTRIM	1635 S 1435 E	

Michigan Department of
Environment, Great Lakes, and Energy
Oil, Gas and Minerals Division

PERMIT LIST

08/14/2023 THRU 08/18/2023



Permit Number Issue Date Permittee Number Permittee Name Page 2

61733 8/18/2023 6498 WOLVERINE GAS AND OIL COMPANY OF MICHIGAN LLC!
ONE RIVERFRONT PLAZA!
55 CAMPAU AVE, NW!
GRAND RAPIDS, MI 49503

API Well No: 21-077-62055-00-00

Prev Permit:

Well Name: STOUT 36-1 HD1

Surface Owner: Robert David Stout

Well Type: Oil Well

True Vertical Depth: 3412FT

Permit Type: Drill

Target Formation: TRENTON

H2S Present? Yes

Deepest Formation: TRENTON

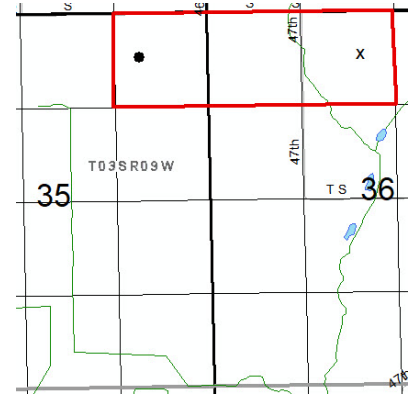

120-Acre R303 Drilling Unit, NE/4 NE/4 Sec 35, N/2 NW/4 Sec 36

Location:	QT QT QT	Sec	Township	Range	Township Name	County	Feet From Section Line	Feet From DRLG Unit Line
SL:	NENENW	36	3S	9W	CLIMAX	KALAMAZOO	617 N 2167 W	
BHL:	NWNENE	35	3S	9W	CLIMAX	KALAMAZOO	601 N 974 E	601 N 330 W

Michigan Department of
Environment, Great Lakes, and Energy
Oil, Gas and Minerals Division

UPDATED PERMITS

08/14/2023 THRU 08/18/2023



Permit Number Permittee Number Permittee Name

TRANSFER OF OWNERSHIP:

43802 7772 LAMBDA ENERGY RESOURCES LLC
12012 Wickchester Lane
Suite 300
Houston, TX 77079 USA

API Well Number: 21-101-34028-01-00

Well Name: ANDERSON-LUTZ 1-27A True Vertical Depth: 4822

Transfer Date: 8/16/2023

Previous Owner: MISSAUKEE OIL AND GAS
COMPANY LLC

Location	QT QT QT	Sec	Township	Range	Township Name	County	Feet From Section Line	Feet From DRLG Unit
SL:	NESESW	27	23N	15W	BEAR LAKE	MANISTEE	850 S 330 E	
BHL:	NESESW	27	23N	15W	BEAR LAKE	MANISTEE	922 S 467 E	922 S 467 E