

Michigan Department of  
Environment, Great Lakes, and Energy  
Oil, Gas and Minerals Division

PERMIT LIST

01/15/2024 THRU 01/19/2024



Permit Number      Issue Date      Permittee Number      Permittee Name      Page 1

61759      1/18/2024      8139      MUSKEGON OPERATING COMPANY LLC  
1425 S MISSION RD  
MOUNT PLEASANT, MI 48858

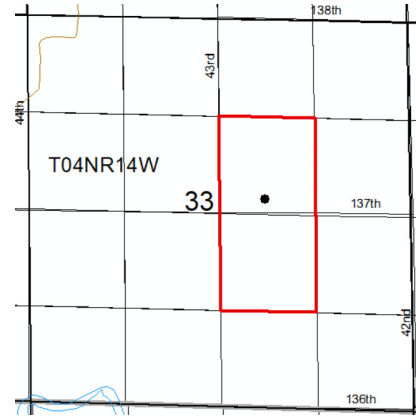

API Well No: 21-005-62000-00-00

Prev Permit:

Well Name: KLINGENBERG 1-33

Well Type: Oil Well

Permit Type: Drill

H2S Present? No

Surface Owner: Norma M. Klingenberg Trust

True Vertical Depth: 1700FT

Target Formation: TRAVERSE LIMESTONE

Deepest Formation: TRAVERSE LIMESTONE

80-Acre R303 Drilling Unit, NW/4  
SE/4, SW/4 NE/4, Sec 33

Location:	QT QT QT	Sec	Township	Range	Township Name	County	Feet From Section Line	Feet From DRLG Unit Line
SL:	SESWNE	33	4N	14W	OVERISEL	ALLEGAN	2489 N 2019 E	
BHL:	SESWNE	33	4N	14W	OVERISEL	ALLEGAN	2489 N 2019 E	1150 N 601W