

Michigan Department of
Environment, Great Lakes, and Energy
Oil, Gas and Minerals Division

PERMIT LIST

03/04/2024 THRU 03/08/2024



Permit Number Issue Date Permittee Number Permittee Name Page 1

61764 3/5/2024 6498 WOLVERINE GAS AND OIL COMPANY OF MICHIGAN LLC
ONE RIVERFRONT PLAZA
55 CAMPAU AVE, NW
GRAND RAPIDS, MI 49503

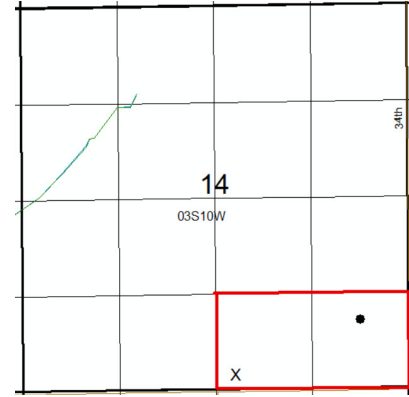

API Well No: 21-077-62058-00-00

Prev Permit:

Well Name: VANKRUININGEN 14-1 HD1

Surface Owner: Mitchell VanKruiningen III, Trustee

Well Type: Oil Well

True Vertical Depth: 3343FT

Permit Type: Drill

Target Formation: TRENTON

H2S Present? Yes

Deepest Formation: TRENTON

80-Acre R303 Drilling Unit, S/2 SE/4 Section 14

Location:	QT QT QT	Sec	Township	Range	Township Name	County	Feet From Section Line	Feet From DRLG Unit Line
SL:	SWSWSE	14	3S	10W	PAVILION	KALAMAZOO	180 S 2393 E	
BHL:	NWSESE	14	3S	10W	PAVILION	KALAMAZOO	987 S 665 E	330 N 665 E

61765 3/5/2024 6498 WOLVERINE GAS AND OIL COMPANY OF MICHIGAN LLC
ONE RIVERFRONT PLAZA
55 CAMPAU AVE, NW
GRAND RAPIDS, MI 49503

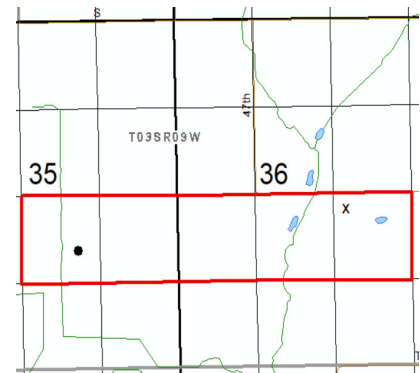

API Well No: 21-077-62059-00-00

Prev Permit:

Well Name: VANMIDDLESWORTH 36-1 HD1

Surface Owner: Rodney & Sue VanMiddlesworth

Well Type: Oil Well

True Vertical Depth: 3429FT

Permit Type: Drill

Target Formation: TRENTON

H2S Present? Yes

Deepest Formation: TRENTON

200-Acre R303 Drilling Unit, N/2 SE/4 Sec 35, N/2 SW/4, NW/4 SE/4 Sec 36

Location:	QT QT QT	Sec	Township	Range	Township Name	County	Feet From Section Line	Feet From DRLG Unit Line
SL:	NWNWSE	36	3S	9W	CLIMAX	KALAMAZOO	2366 S 2452 E	
BHL:	SENWSE	35	3S	9W	CLIMAX	KALAMAZOO	1835 S 1708 E	505 S 944 W

Michigan Department of
Environment, Great Lakes, and Energy
Oil, Gas and Minerals Division

UPDATED PERMITS

03/04/2024 THRU 03/08/2024



Permit Number Permittee Number Permittee Name

PLUGGING INSTRUCTIONS ISSUED:

44372 6361 RIVERSIDE ENERGY MICHIGAN LLC
10691 EAST CARTER ROAD
SUITE 201
TRAVERSE CITY, MI 49684

API Well Number: 21-137-44372-00-00

Well Name: SADDLER 15-35

Plug Inst. Issue Date: 2/26/2024

Location	QT QT QT	Sec	Township	Range	Township Name	County	Feet From Section Line	Feet From DRLG Unit
SL:	SESWSE	35	31N	2W	DOVER	OTSEGO	366 S 949 W	366 S 365 E
BHL:	SESWSE	35	31N	2W	DOVER	OTSEGO		

Comment: App to P&A expires on 2/26/2025

45791 6361 RIVERSIDE ENERGY MICHIGAN LLC
10691 EAST CARTER ROAD
SUITE 201
TRAVERSE CITY, MI 49684

API Well Number: 21-137-45791-00-00

Well Name: WOLFE TRUSTS B3-14

Plug Inst. Issue Date: 2/26/2024

Location	QT QT QT	Sec	Township	Range	Township Name	County	Feet From Section Line	Feet From DRLG Unit
SL:	SWSWNE	14	30N	2W	CHESTER	OTSEGO	551 S 432 W	551 S 432 W
BHL:	SWSWNE	14	30N	2W	CHESTER	OTSEGO		

Comment: App to P&A expires on 2/26/2025

Michigan Department of
Environment, Great Lakes, and Energy
Oil, Gas and Minerals Division

UPDATED PERMITS

03/04/2024 THRU 03/08/2024



Permit Number Permittee Number Permittee Name

48604 6361 RIVERSIDE ENERGY MICHIGAN LLC
10691 EAST CARTER ROAD
SUITE 201
TRAVERSE CITY, MI 49684

API Well Number: 21-119-48604-00-00

Well Name: COOLEY B4-25 SWD

Plug Inst. Issue Date: 2/26/2024

Location	QT QT QT	Sec	Township	Range	Township Name	County	Feet From Section Line	Feet From DRLG Unit
SL:	NESENE	25	31N	3E	HILLMAN	MONTMORENCY	1170 S 171 E	
BHL:	NESENE	25	31N	3E	HILLMAN	MONTMORENCY		

Comment: App to P&A expires on 2/26/2025

5305 3072 BRUCE ALAN ENTERPRISES INC
4590 28TH ST SW
BYRON CENTER, MI 49315

API Well Number: 21-005-05305-00-00

Well Name: RIGTERINK, HENRY A-1

Plug Inst. Issue Date: 2/28/2023

Location	QT QT QT	Sec	Township	Range	Township Name	County	Feet From Section Line	Feet From DRLG Unit
SL:	SWSWNW	22	4N	14W	OVERISEL	ALLEGAN	330 S 330 W	
BHL:	SWSWNW	22	4N	14W	OVERISEL	ALLEGAN		

Comment: App to P&A expires on 2/28/2024

Michigan Department of
Environment, Great Lakes, and Energy
Oil, Gas and Minerals Division

UPDATED PERMITS

03/04/2024 THRU 03/08/2024



Permit Number Permittee Number Permittee Name

5404 3072 BRUCE ALAN ENTERPRISES INC
4590 28TH ST SW
BYRON CENTER, MI 49315

API Well Number: 21-005-05404-00-00

Well Name: RIGTERINK, HENRY A-2

Plug Inst. Issue Date: 2/28/2023

Location	QT QT QT	Sec	Township	Range	Township Name	County	Feet From Section Line	Feet From DRLG Unit
SL:	SESWNW	22	4N	14W	OVERISEL	ALLEGAN	330 S 990 W	
BHL:	SESWNW	22	4N	14W	OVERISEL	ALLEGAN		

Comment: App to P&A expires on 2/28/2024

55538 6361 RIVERSIDE ENERGY MICHIGAN LLC
10691 EAST CARTER ROAD
SUITE 201
TRAVERSE CITY, MI 49684

API Well Number: 21-137-55538-00-00

Well Name: MIDDLE EARTH B4-15

Plug Inst. Issue Date: 2/26/2024

Location	QT QT QT	Sec	Township	Range	Township Name	County	Feet From Section Line	Feet From DRLG Unit
SL:	NWSENE	15	31N	3W	LIVINGSTON	OTSEGO	1855 N 1206 E	545 N 1206 E
BHL:	NWSENE	15	31N	3W	LIVINGSTON	OTSEGO		

Comment: App to P&A expires on 2/26/2025

Michigan Department of
Environment, Great Lakes, and Energy
Oil, Gas and Minerals Division

UPDATED PERMITS

03/04/2024 THRU 03/08/2024



Permit Number Permittee Number Permittee Name

RECORD OF WELL COMPLETION:

60375 5312 PAXTON RESOURCES LLC
132 N. OTSEGO AVENUE
GAYLORD, MI 49735 USA

API Well Number: 21-161-60375-01-00

Well Name: LUCKHARDT B1-22 HD2 True Vertical Depth: 3123

Date Well Completed: 8/11/2023

Location	QT QT QT	Sec	Township	Range	Township Name	County	Feet From Section Line	Feet From DRLG Unit
SL:	NWNWNW	22	4S	5E	SALINE	WASHTENAW	182 N 365 W	
BHL:	SENWNW	22	4S	5E	SALINE	WASHTENAW	1075 N 1006 W	1075 N 1006 W

61594 5320 SAVOY ENERGY LP
PO BOX 1560
TRAVERSE CITY, MI 49685-1560 USA

API Well Number: 21-025-62027-03-00

Well Name: KORN 5-30 HD4 True Vertical Depth: 3461

Date Well Completed: 1/9/2024

Location	QT QT QT	Sec	Township	Range	Township Name	County	Feet From Section Line	Feet From DRLG Unit
SL:	NESWSE	30	4S	7W	BURLINGTON	CALHOUN	800 S 1671 E	
BHL:	NWSWNW	31	4S	7W	BURLINGTON	CALHOUN	1361 N 537 W	1288 S 537 W

Michigan Department of
Environment, Great Lakes, and Energy
Oil, Gas and Minerals Division

UPDATED PERMITS

03/04/2024 THRU 03/08/2024



Permit Number Permittee Number Permittee Name

RECORD OF WELL PLUGGING:

27186 8407 WHITE PINE PRODUCTION LLC
124 SOUTH MAIN STREET SUITE 203
BURLESON, TX 76028 USA

API Well Number: 21-039-27186-00-00

Well Name: BEAVER CREEK B 8

Plugging Date: 2/21/2024

Location	QT QT QT	Sec	Township	Range	Township Name	County	Feet From Section Line	Feet From DRLG Unit
SL:	W2NENW	21	25N	4W	BEAVER CREEK	CRAWFORD	660 N 990 E	660 N 990 E
BHL:	W2NENW	21	25N	4W	BEAVER CREEK	CRAWFORD		

Michigan Department of
Environment, Great Lakes, and Energy
Oil, Gas and Minerals Division

UPDATED PERMITS

03/04/2024 THRU 03/08/2024



Permit Number Permittee Number Permittee Name

APPLICATIONS TO CHANGE WELL STATUS:

29207 6361 RIVERSIDE ENERGY MICHIGAN LLC
10691 EAST CARTER ROAD
SUITE 201
TRAVERSE CITY, MI 49684

API Well Number: 21-137-29207-00-00

Well Name: NORTH MICHIGAN LAND AND
OIL CORP 1-29

Approval Date: 2/26/2024

Location	QT QT QT	Sec	Township	Range	Township Name	County	Feet From Section Line	Feet From DRLG Unit
SL:	NESESW	29	29N	4W	HAYES	OTSEGO	790 S 460 E	530 N 460 E
BHL:	NESESW	29	29N	4W	HAYES	OTSEGO		

Proposed Rework: Temporarily Abandoned

Comment: ACOWS for TA expires on 3/31/2025

29713 6361 RIVERSIDE ENERGY MICHIGAN LLC
10691 EAST CARTER ROAD
SUITE 201
TRAVERSE CITY, MI 49684

API Well Number: 21-137-29713-00-00

Well Name: NORTH MICHIGAN LAND AND
OIL CO 3-29

Approval Date: 2/26/2024

Location	QT QT QT	Sec	Township	Range	Township Name	County	Feet From Section Line	Feet From DRLG Unit
SL:	SWSWNE	29	29N	4W	HAYES	OTSEGO	499 S 107 W	499 S 1213 E
BHL:	SWSWNE	29	29N	4W	HAYES	OTSEGO		

Proposed Rework: Temporarily Abandoned

Comment: ACOWS for TA expires on 3/31/2025

Michigan Department of
Environment, Great Lakes, and Energy
Oil, Gas and Minerals Division

UPDATED PERMITS

03/04/2024 THRU 03/08/2024



Permit Number Permittee Number Permittee Name

43591 6361 RIVERSIDE ENERGY MICHIGAN LLC
10691 EAST CARTER ROAD
SUITE 201
TRAVERSE CITY, MI 49684

API Well Number: 21-137-43591-00-00

Well Name: COGSWELL C1-27

Approval Date: 2/26/2024

Location	QT QT QT	Sec	Township	Range	Township Name	County	Feet From Section Line	Feet From DRLG Unit
SL:	SWNWSW	27	30N	4W	HAYES	OTSEGO	808 N 538 W	512 S 538 W
BHL:	SWNWSW	27	30N	4W	HAYES	OTSEGO		

Proposed Rework: Temporarily Abandoned

Comment: ACOWS for TA expires on 2/26/2025



Michigan Department of
Environment, Great Lakes, and Energy
Oil, Gas and Minerals Division

UPDATED PERMITS

03/04/2024 THRU 03/08/2024



Permit Number Permittee Number Permittee Name

RECORD OF CHANGE OF WELL STATUS:

14248 8407 WHITE PINE PRODUCTION LLC
124 SOUTH MAIN STREET SUITE 203
BURLESON, TX 76028 USA

API Well Number: 21-079-14248-00-00

Well Name: STATE GARFIELD 3

Change Date: 11/17/2022

Location	QT QT QT	Sec	Township	Range	Township Name	County	Feet From Section Line	Feet From DRLG Unit
SL:	W2SENE	13	25N	5W	GARFIELD	KALKASKA	660 S 990 E	1980 N 330 W
BHL:	W2SENE	13	25N	5W	GARFIELD	KALKASKA		

Proposed Rework: Reworked to Oil Producing Well

Comment: Reworked to convert Detroit River Zone from WIW to production.

61594 5320 SAVOY ENERGY LP
PO BOX 1560
TRAVERSE CITY, MI 49685-1560 USA

API Well Number: 21-025-62027-03-00

Well Name: KORN 5-30 HD4

True Vertical Depth: 3461

Change Date: 12/12/2023

Location	QT QT QT	Sec	Township	Range	Township Name	County	Feet From Section Line	Feet From DRLG Unit
SL:	NESWSE	30	4S	7W	BURLINGTON	CALHOUN	800 S 1671 E	
BHL:	NWSWNW	31	4S	7W	BURLINGTON	CALHOUN	1361 N 537 W	1288 S 537 W

Proposed Rework: Reworked to Continue Drilling - HDH

Comment: Reworked to plugback HD3 and drill HD4 under same permit.