

Michigan Department of  
Environment, Great Lakes, and Energy  
Oil, Gas and Minerals Division

PERMIT APPLICATIONS

03/11/2024 THRU 03/15/2024



MICHIGAN DEPARTMENT OF  
ENVIRONMENT, GREAT LAKES, AND ENERGY

Application Number    Date Received    Permittee Number    Permittee Name

967                    03/11/2024            6310                    CORE ENERGY LLC  
1011 NOTEWARE DRIVE  
TRAVERSE CITY, MI 49686

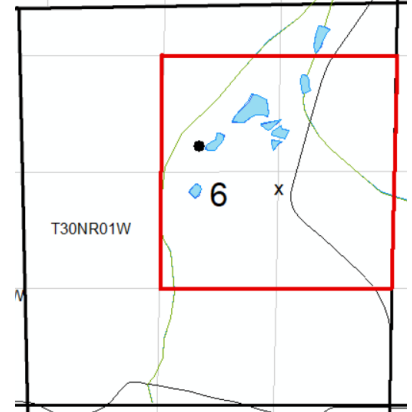

Prev Permit: 59086

Well Name: STATE CHARLTON & BOEVE  
2-6A

Surface Owner: Robert & Sally Boeve

Well Type: OIL

True Vertical Depth: 6036

Permit Type: Reentry

Target Formation: NIAGARAN

H2S Present? No

Deepest Formation: NIAGARAN

Charlton 6 (EOR) Unit, SO (A)  
12-6-06, S/2 NE/4, N/2 SE/4 Sec 6

Location:	QT QT QT	Sec	Township	Range	Township Name	County	Feet From Section Line	Feet From DRLG Unit Line
SL:	NENWSE	6	30N	1W	CHARLTON	OTSEGO	2147 N 1333 E	
BHL:	SWSWNE	6	30N	1W	CHARLTON	OTSEGO	1619 N 2005 E	1025 N 403 W

Michigan Department of  
Environment, Great Lakes, and Energy  
Oil, Gas and Minerals Division

PERMIT APPLICATIONS

03/11/2024 THRU 03/15/2024



MICHIGAN DEPARTMENT OF  
ENVIRONMENT, GREAT LAKES, AND ENERGY

972                      03/14/2024                      5320                      SAVOY ENERGY LP  
PO BOX 1560  
TRAVERSE CITY, MI 49685-1560

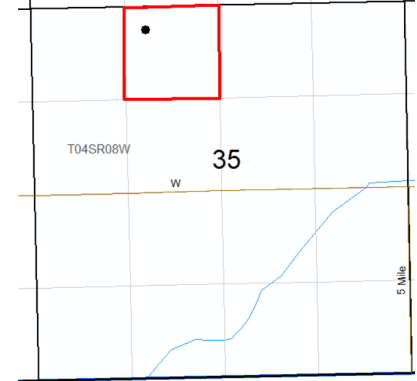

Prev Permit:

Well Name: Harrison Family Farms 1-35

Well Type: OIL

Permit Type: Drill

H2S Present? No

Surface Owner: Harrison Family Farms, LLC

True Vertical Depth: 3850

Target Formation: TRENTON-BLACK RIVER

Deepest Formation: PRAIRIE DU CHIEN

40-Acre Drilling Unit, NE/4 NW/4  
Section 35

Location:	QT QT QT	Sec	Township	Range	Township Name	County	Feet From Section Line	Feet From DRLG Unit Line
SL:	NWNENW	35	4S	8W	ATHENS	CALHOUN	331 N 1658 W	331 N 331 W
BHL:	NWNENW	35	4S	8W	ATHENS	CALHOUN	331 N 1658 W	331 N 331 W

Michigan Department of  
Environment, Great Lakes, and Energy  
Oil, Gas and Minerals Division

PERMIT LIST

03/11/2024 THRU 03/15/2024



Permit Number      Issue Date      Permittee Number      Permittee Name      Page 1

61766      3/14/2024      6498      WOLVERINE GAS AND OIL  
COMPANY OF MICHIGAN LLC  
ONE RIVERFRONT PLAZA  
55 CAMPAU AVE, NW  
GRAND RAPIDS, MI 49503

API Well No: 21-073-62016-00-00

Prev Permit:

Well Name: KRANTZ 1-5      Surface Owner: Barbara A. Krantz

Well Type: Oil Well      True Vertical Depth: 4163FT

Permit Type: Drill      Target Formation: DUNDEE

H2S Present? Yes      Deepest Formation: DETROIT RIVER

Location:	QT QT QT	Sec	Township	Range	Township Name	County	Feet From Section Line	Feet From DRLG Unit Line
SL:	NWNWNW	5	16N	4W	VERNON	ISABELLA	225 N 2281 E	
BHL:	NWNWNW	5	16N	4W	VERNON	ISABELLA	664 N 2539 E	664 N 1217 E

61767      3/14/2024      5280      JORDAN DEVELOPMENT  
COMPANY LLC  
1503 GARFIELD RD NORTH  
TRAVERSE CITY, MI 49696

API Well No: 21-011-62002-01-00

Prev Permit:

Well Name: STATE ADAMS & CLARK 5-8      Surface Owner: State of Michigan

Well Type: Oil Well      True Vertical Depth: 3093FT

Permit Type: Drill      Target Formation: DUNDEE

H2S Present? No      Deepest Formation: DUNDEE

Location:	QT QT QT	Sec	Township	Range	Township Name	County	Feet From Section Line	Feet From DRLG Unit Line
SL:	SWSWNW	8	19N	3E	ADAMS	ARENAC	2505 N 489 W	
BHL:	NESENE	7	19N	3E	ADAMS	ARENAC	1516 N 166 E	1123 S 1150 W