

Michigan Department of
Environment, Great Lakes, and Energy
Oil, Gas and Minerals Division

PERMIT APPLICATIONS

04/15/2024 THRU 04/19/2024



MICHIGAN DEPARTMENT OF
ENVIRONMENT, GREAT LAKES, AND ENERGY

984 04/19/2024 70 TRENDWELL ENERGY CORPORATION
10 E BRIDGE ST STE 200
ROCKFORD, MI 49341

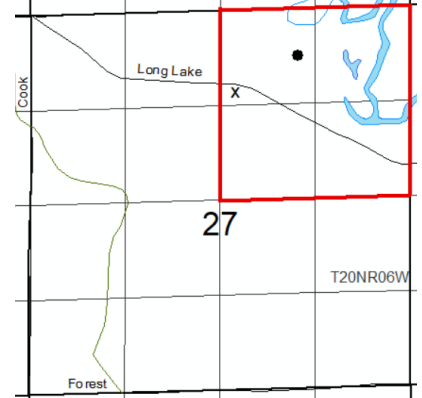

Prev Permit:

Well Name: STATE WINTERFIELD &
BARTLETT 1-27

Well Type: OIL

Permit Type: Drill

H2S Present? Yes

Surface Owner: STATE OF MICHIGAN

True Vertical Depth: 4109

Target Formation: DUNDEE

Deepest Formation: DETROIT RIVER

160-Acre R303 Drilling Unit,
NE/4 Section 27 (Winterfield gas
storage field)

Location:	QT QT QT	Sec	Township	Range	Township Name	County	Feet From Section Line	Feet From DRLG Unit Line
SL:	SWNWNE	27	20N	6W	WINTERFIELD	CLARE	1115 N 2435 E	1115 N 203 W
BHL:	NENWNE	27	20N	6W	WINTERFIELD	CLARE	642 N 1590 E	642 N 1049 W

Michigan Department of
Environment, Great Lakes, and Energy
Oil, Gas and Minerals Division

PERMIT APPLICATIONS

04/15/2024 THRU 04/19/2024



MICHIGAN DEPARTMENT OF
ENVIRONMENT, GREAT LAKES, AND ENERGY

Application Number Date Received Permittee Number Permittee Name

986 04/15/2024 6418 W B OSBORN OIL AND
GAS OPERATIONS LTD
P O BOX 8C
SAN ANTONIO, TX 78217

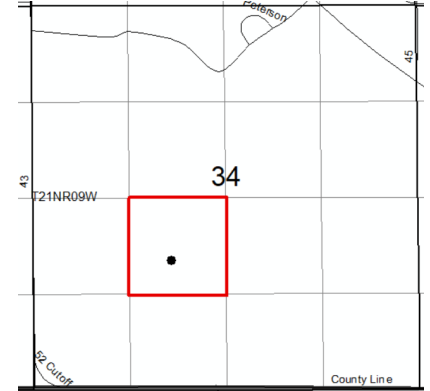

Prev Permit:

Well Name: HASKIN 1-34

Well Type: OIL

Permit Type: Drill

H2S Present? Yes

Surface Owner: William & Jaime Haskin

True Vertical Depth: 4100

Target Formation: DUNDEE

Deepest Formation: DUNDEE

40-Acre Drilling Unit, NE/4 SW/4
Section 34

Location:	QT QT QT	Sec	Township	Range	Township Name	County	Feet From Section Line	Feet From DRLG Unit Line
SL:	SWNESW	34	21N	9W	CLAM LAKE	WEXFORD	1778 S 1886 W	456 S 564 W
BHL:	SWNESW	34	21N	9W	CLAM LAKE	WEXFORD	1778 S 1886 W	456 S 564 W