

Michigan Department of  
Environment, Great Lakes, and Energy  
Oil, Gas and Minerals Division

PERMIT LIST

06/24/2024 THRU 06/28/2024



61779      6/25/2024      5320      SAVOY ENERGY LP  
PO BOX 1560  
TRAVERSE CITY, MI 49685-1560

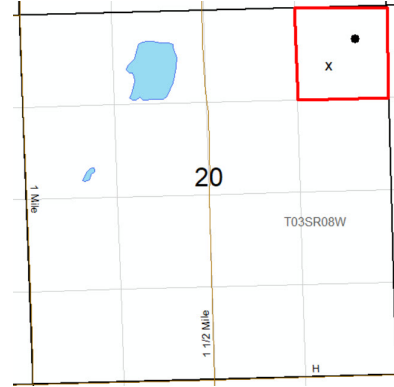

API Well No: 21-025-62044-00-00

Prev Permit:

Well Name: VANMIDDLESWORTH 1-20

Surface Owner: Nettie A. VanMiddlesworth

Well Type: Oil Well

True Vertical Depth: 4075FT

Permit Type: Drill

Target Formation: TRENTON-BLACK RIVER

H2S Present? No

Deepest Formation: PRAIRIE DU CHIEN

40-Acre Drilling Unit, NE/4 NE/4 Section 20

Location:	QT QT QT	Sec	Township	Range	Township Name	County	Feet From Section Line	Feet From DRLG Unit Line
SL:	SWNE	20	3S	8W	LEROY	CALHOUN	816 N 798 E	
BHL:	NENE	20	3S	8W	LEROY	CALHOUN	443 N 417 E	443 N 417 E

61780      6/28/2024      6418      W B OSBORN OIL AND GAS  
OPERATIONS LTD  
P O BOX 8C  
SAN ANTONIO, TX 78217

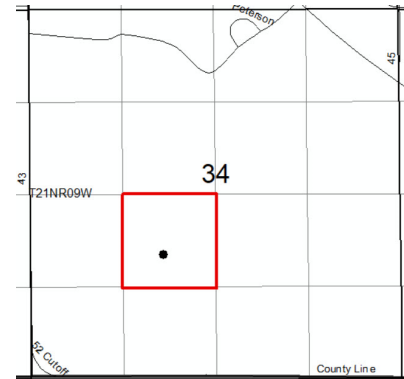

API Well No: 21-165-62002-00-00

Prev Permit:

Well Name: HASKIN 1-34

Surface Owner: William & Jaime Haskin

Well Type: Oil Well

True Vertical Depth: 4100FT

Permit Type: Drill

Target Formation: DUNDEE

H2S Present? Yes

Deepest Formation: DUNDEE

40-Acre Drilling Unit, NE/4 SW/4 Section 34

Location:	QT QT QT	Sec	Township	Range	Township Name	County	Feet From Section Line	Feet From DRLG Unit Line
SL:	SWNE	34	21N	9W	CLAM LAKE	WEXFORD	1778 S 1886 W	
BHL:	SWNE	34	21N	9W	CLAM LAKE	WEXFORD	1778 S 1886 W	456 S 564 W

Michigan Department of  
Environment, Great Lakes, and Energy  
Oil, Gas and Minerals Division

UPDATED PERMITS

06/24/2024 THRU 06/28/2024



Permit Number      Permittee Number      Permittee Name

**PLUGGING INSTRUCTIONS ISSUED:**

11935                  6542                  HERRICK PRODUCTIONS LLC  
6466 LUND ROAD SW  
FIFE LAKE, MI 49633

API Well Number: 21-117-11935-00-00

Well Name: TOWLE, D ET AL 1

Plug Inst. Issue Date: 6/12/2024

Location	QT QT QT	Sec	Township	Range	Township Name	County	Feet From Section Line	Feet From DRLG Unit
SL:	NESENW	14	12N	6W	HOME	MONTCALM	1314 S 6 E	1326 N 1314 W
BHL:	NESENW	14	12N	6W	HOME	MONTCALM		

Comment: App to P&A expires 6/12/2025

18359                  14                  D T E GAS COMPANY  
ONE ENERGY PLAZA, WCB 1782  
DETROIT, MI 48226

API Well Number: 21-117-03457-01-00

Well Name: MCGC S-307

Plug Inst. Issue Date: 6/7/2024

Location	QT QT QT	Sec	Township	Range	Township Name	County	Feet From Section Line	Feet From DRLG Unit
SL:	CNNWNE	5	12N	7W	BELVIDERE	MONTCALM	660 N 660 W	660 N 660 W
BHL:	CNNWNE	5	12N	7W	BELVIDERE	MONTCALM		

Comment: App to Re-P&A expires 6/7/2025

Michigan Department of  
Environment, Great Lakes, and Energy  
Oil, Gas and Minerals Division

UPDATED PERMITS

06/24/2024 THRU 06/28/2024



Permit Number      Permittee Number      Permittee Name

23131      5260      GOODALE ENTERPRISES LLC  
21 FENNESSY RD SW  
GRAND RAPIDS, MI 49534

API Well Number: 21-139-23131-00-00

Well Name: TURNEY COMM., DONALD 1

Plug Inst. Issue Date: 6/26/2024

Location	QT QT QT	Sec	Township	Range	Township Name	County	Feet From Section Line	Feet From DRLG Unit
SL:	SESENW	36	7N	13W	TALLMADGE	OTTAWA	330 S 390 E	330 S 390 E
BHL:	SESENW	36	7N	13W	TALLMADGE	OTTAWA		

Comment: App to P&A expires 6/26/2025

29682      7772      LAMBDA ENERGY RESOURCES LLC  
12012 WICKCHESTER LANE  
SUITE 300  
HOUSTON, TX 77079 USA

API Well Number: 21-055-29682-00-00

Well Name: WEBER, NORINE E 1-21

Plug Inst. Issue Date: 6/20/2024

Location	QT QT QT	Sec	Township	Range	Township Name	County	Feet From Section Line	Feet From DRLG Unit
SL:	CN2SE	21	25N	11W	MAYFIELD	GRAND TRAVERSE	715 N 1323 W	611 S 1323 W
BHL:	CN2SE	21	25N	11W	MAYFIELD	GRAND TRAVERSE		

Comment: App to P&A expires 12/31/2024

Michigan Department of  
Environment, Great Lakes, and Energy  
Oil, Gas and Minerals Division

UPDATED PERMITS

06/24/2024 THRU 06/28/2024



Permit Number      Permittee Number      Permittee Name

30180      5095      OMIMEX ENERGY INC  
P.O. BOX 352  
WEST BRANCH, MI 48661 USA

API Well Number: 21-025-30180-00-00

Well Name: CHRISTOPHEL, HAROLD UNIT 1

Plug Inst. Issue Date: 6/21/2024

Location	QT QT QT	Sec	Township	Range	Township Name	County	Feet From Section Line	Feet From DRLG Unit
SL:	SWNWSW	36	1S	7W	PENNFIELD	CALHOUN	860 N 460 W	460 S 460 W
BHL:	SWNWSW	36	1S	7W	PENNFIELD	CALHOUN		

Comment: App to P&A expires 12/31/2025

30456      7772      LAMBDA ENERGY RESOURCES LLC  
12012 WICKCHESTER LANE  
SUITE 300  
HOUSTON, TX 77079 USA

API Well Number: 21-165-30456-00-00

Well Name: SCHROEDER 2-6

Plug Inst. Issue Date: 6/18/2024

Location	QT QT QT	Sec	Township	Range	Township Name	County	Feet From Section Line	Feet From DRLG Unit
SL:	NESWNW	6	24N	12W	WEXFORD	WEXFORD	895 S 784 W	895 S 536 E
BHL:	NESWNW	6	24N	12W	WEXFORD	WEXFORD		

Comment: App to P&A expires 12/31/2024

Michigan Department of  
Environment, Great Lakes, and Energy  
Oil, Gas and Minerals Division

UPDATED PERMITS

06/24/2024 THRU 06/28/2024



Permit Number      Permittee Number      Permittee Name

31022      7772      LAMBDA ENERGY RESOURCES LLC  
12012 WICKCHESTER LANE  
SUITE 300  
HOUSTON, TX 77079 USA

API Well Number: 21-039-31022-00-00

Well Name: TALBOT ET AL 1-6

Plug Inst. Issue Date: 6/26/2024

Location	QT QT QT	Sec	Township	Range	Township Name	County	Feet From Section Line	Feet From DRLG Unit
SL:	CNSWNW	6	28N	3W	MAPLE FOREST	CRAWFORD	777 S 460 W	777 S 460 W
BHL:	CNSWNW	6	28N	3W	MAPLE FOREST	CRAWFORD		

Comment: App to P&A expires 12/31/2024

3193      14      D T E GAS COMPANY  
ONE ENERGY PLAZA, WCB 1782  
DETROIT, MI 48226

API Well Number: 21-117-03193-00-00

Well Name: FOUTS W H 1

Plug Inst. Issue Date: 6/24/2024

Location	QT QT QT	Sec	Township	Range	Township Name	County	Feet From Section Line	Feet From DRLG Unit
SL:	CNSWNW	3	12N	7W	BELVIDERE	MONTCALM	660 S 660 W	
BHL:	CNSWNW	3	12N	7W	BELVIDERE	MONTCALM		

Comment: App to re-P&A expires 6/24/2025

Michigan Department of  
Environment, Great Lakes, and Energy  
Oil, Gas and Minerals Division

UPDATED PERMITS

06/24/2024 THRU 06/28/2024



Permit Number      Permittee Number      Permittee Name

32550      7772      LAMBDA ENERGY RESOURCES LLC  
12012 WICKCHESTER LANE  
SUITE 300  
HOUSTON, TX 77079 USA

API Well Number: 21-055-32474-03-00

Well Name: WEBER ET AL 5-21C      True Vertical Depth: 6527

Plug Inst. Issue Date: 6/20/2024

Location	QT QT QT	Sec	Township	Range	Township Name	County	Feet From Section Line	Feet From DRLG Unit
SL:	SWNWSW	22	25N	11W	MAYFIELD	GRAND TRAVERSE	1027 N 68 W	
BHL:	SENESE	21	25N	11W	MAYFIELD	GRAND TRAVERSE	828 N 563 E	497 S 762 W

Comment: App to P&A expires 12/31/2024

55073      7772      LAMBDA ENERGY RESOURCES LLC  
12012 WICKCHESTER LANE  
SUITE 300  
HOUSTON, TX 77079 USA

API Well Number: 21-039-32358-03-00

Well Name: POST NEWBERRY 1-28A      True Vertical Depth: 7559

Plug Inst. Issue Date: 6/25/2024

Location	QT QT QT	Sec	Township	Range	Township Name	County	Feet From Section Line	Feet From DRLG Unit
SL:	NESWSW	21	28N	4W	FREDERIC	CRAWFORD	701 S 884 W	
BHL:	NENWNW	28	28N	4W	FREDERIC	CRAWFORD	29 N 845 W	1294 S 845 W

Comment: App to P&A expires 12/31/2024

Michigan Department of  
Environment, Great Lakes, and Energy  
Oil, Gas and Minerals Division

UPDATED PERMITS

06/24/2024 THRU 06/28/2024



Permit Number      Permittee Number      Permittee Name

59898      5312      PAXTON RESOURCES LLC  
132 N. OTSEGO AVENUE  
GAYLORD, MI 49735 USA

API Well Number: 21-025-59898-00-00

Well Name: KIBLER 2-3

Plug Inst. Issue Date: 5/22/2024

Location	QT QT QT	Sec	Township	Range	Township Name	County	Feet From Section Line	Feet From DRLG Unit
SL:	NESWNE	3	2S	5W	MARENGO	CALHOUN	1687 N 1900 E	367 N 578 E
BHL:	NESWNE	3	2S	5W	MARENGO	CALHOUN		

Comment: App to P&A expires 5/22/2025

60002      7739      LAYLINE OIL AND GAS LLC  
P.O. BOX 310  
MARION, MI 49665

API Well Number: 21-107-40215-01-00

Well Name: STATE MECOSTA & ALBER 1-23A      True Vertical Depth: 8680

Plug Inst. Issue Date: 6/12/2024

Location	QT QT QT	Sec	Township	Range	Township Name	County	Feet From Section Line	Feet From DRLG Unit
SL:	SESWSW	23	14N	10W	MECOSTA	MECOSTA	611 S 1143 W	
BHL:	SWNWSE	23	14N	10W	MECOSTA	MECOSTA	1599 S 2407 E	1599 S 2407 E

Comment: App to P&A expires 6/12/2025

Michigan Department of  
Environment, Great Lakes, and Energy  
Oil, Gas and Minerals Division

UPDATED PERMITS

06/24/2024 THRU 06/28/2024



Permit Number      Permittee Number      Permittee Name

61743      103      A N R PIPELINE CO  
5250 CORPORATE DRIVE  
TROY, MI 48098

API Well Number: 21-035-62030-00-90

Well Name: LINCOLN 165HD LHL

Plug Inst. Issue Date: 6/5/2024

Location	QT QT QT	Sec	Township	Range	Township Name	County	Feet From Section Line	Feet From DRLG Unit
SL:	NESWNE	20	18N	5W	LINCOLN	CLARE	1940 N 1420 E	
BHL:	NESWNE	20	18N	5W	LINCOLN	CLARE	1940 N 1420 E	

Comment: App to P&A expires 7/5/2024

61744      103      A N R PIPELINE CO  
5250 CORPORATE DRIVE  
TROY, MI 48098

API Well Number: 21-035-62031-00-90

Well Name: LINCOLN 166HD LHL

Plug Inst. Issue Date: 5/3/2024

Location	QT QT QT	Sec	Township	Range	Township Name	County	Feet From Section Line	Feet From DRLG Unit
SL:	NWSWNW	19	18N	5W	LINCOLN	CLARE	1830 N 320 W	
BHL:	NWSWNW	19	18N	5W	LINCOLN	CLARE	1830 N 320 W	

Comment: App to P&A expires 11/3/2024



Michigan Department of  
Environment, Great Lakes, and Energy  
Oil, Gas and Minerals Division

UPDATED PERMITS

06/24/2024 THRU 06/28/2024



Permit Number      Permittee Number      Permittee Name

61759      8139      MUSKEGON OPERATING COMPANY LLC  
1425 S MISSION RD  
MOUNT PLEASANT, MI 48858 USA

API Well Number: 21-005-62000-00-00

Well Name: KLINGENBERG 1-33

Plug Inst. Issue Date: 6/10/2024

Location	QT QT QT	Sec	Township	Range	Township Name	County	Feet From Section Line	Feet From DRLG Unit
SL:	SESWNE	33	4N	14W	OVERISEL	ALLEGAN	2489 N 2019 E	1150 N 601 W
BHL:	SESWNE	33	4N	14W	OVERISEL	ALLEGAN	2489 N 2019 E	1150 N 601 W

Comment: App to P&A expires 9/10/2024



Michigan Department of  
Environment, Great Lakes, and Energy  
Oil, Gas and Minerals Division

UPDATED PERMITS

06/24/2024 THRU 06/28/2024



Permit Number      Permittee Number      Permittee Name

**RECORD OF WELL DRILLING OR DEEPENING:**

61728      6498      WOLVERINE GAS AND OIL  
COMPANY OF MICHIGAN LLC  
ONE RIVERFRONT PLAZA  
55 CAMPAU AVE, NW  
GRAND RAPIDS, MI 49503

API Well Number: 21-077-62054-00-00

Well Name: CLOUGH 32-1 HD1

True Vertical Depth: 3579

Date Drilling Completed: 2/2/2024

Location	QT QT QT	Sec	Township	Range	Township Name	County	Feet From Section Line	Feet From DRLG Unit
SL:	SENWSW	32	2S	9W	CHARLESTON	KALAMAZOO	1490 S 1170 W	163 S 155 E
BHL:	NENWNW	32	2S	9W	CHARLESTON	KALAMAZOO	330 N 661 W	330 N 653 E

61743      103      A N R PIPELINE CO  
5250 CORPORATE DRIVE  
TROY, MI 48098

API Well Number: 21-035-62030-00-90

Well Name: LINCOLN 165HD LHL

Date Drilling Completed: 6/7/2024

Location	QT QT QT	Sec	Township	Range	Township Name	County	Feet From Section Line	Feet From DRLG Unit
SL:	NESWNE	20	18N	5W	LINCOLN	CLARE	1940 N 1420 E	
BHL:	NESWNE	20	18N	5W	LINCOLN	CLARE	1940 N 1420 E	

Michigan Department of  
Environment, Great Lakes, and Energy  
Oil, Gas and Minerals Division

UPDATED PERMITS

06/24/2024 THRU 06/28/2024



Permit Number      Permittee Number      Permittee Name

61744      103      A N R PIPELINE CO  
5250 CORPORATE DRIVE  
TROY, MI 48098

API Well Number: 21-035-62031-00-90

Well Name: LINCOLN 166HD LHL

Date Drilling Completed: 5/4/2024

Location	QT QT QT	Sec	Township	Range	Township Name	County	Feet From Section Line	Feet From DRLG Unit
SL:	NWSWNW	19	18N	5W	LINCOLN	CLARE	1830 N 320 W	
BHL:	NWSWNW	19	18N	5W	LINCOLN	CLARE	1830 N 320 W	

Michigan Department of  
Environment, Great Lakes, and Energy  
Oil, Gas and Minerals Division

UPDATED PERMITS

06/24/2024 THRU 06/28/2024



Permit Number      Permittee Number      Permittee Name

**RECORD OF WELL COMPLETION:**

61728      6498      WOLVERINE GAS AND OIL  
COMPANY OF MICHIGAN LLC  
ONE RIVERFRONT PLAZA  
55 CAMPAU AVE, NW  
GRAND RAPIDS, MI 49503

API Well Number: 21-077-62054-00-00

Well Name: CLOUGH 32-1 HD1      True Vertical Depth: 3579

Date Well Completed: 3/8/2024

Location	QT QT QT	Sec	Township	Range	Township Name	County	Feet From Section Line	Feet From DRLG Unit
SL:	SENWSW	32	2S	9W	CHARLESTON	KALAMAZOO	1490 S 1170 W	163 S 155 E
BHL:	NENWNW	32	2S	9W	CHARLESTON	KALAMAZOO	330 N 661 W	330 N 653 E

61743      103      A N R PIPELINE CO  
5250 CORPORATE DRIVE  
TROY, MI 48098

API Well Number: 21-035-62030-00-90

Well Name: LINCOLN 165HD LHL

Date Well Completed: 6/7/2024

Location	QT QT QT	Sec	Township	Range	Township Name	County	Feet From Section Line	Feet From DRLG Unit
SL:	NESWNE	20	18N	5W	LINCOLN	CLARE	1940 N 1420 E	
BHL:	NESWNE	20	18N	5W	LINCOLN	CLARE	1940 N 1420 E	

Michigan Department of  
Environment, Great Lakes, and Energy  
Oil, Gas and Minerals Division

UPDATED PERMITS

06/24/2024 THRU 06/28/2024



Permit Number      Permittee Number      Permittee Name

61744      103      A N R PIPELINE CO  
5250 CORPORATE DRIVE  
TROY, MI 48098

API Well Number: 21-035-62031-00-90

Well Name: LINCOLN 166HD LHL

Date Well Completed: 5/4/2024

Location	QT QT QT	Sec	Township	Range	Township Name	County	Feet From Section Line	Feet From DRLG Unit
SL:	NWSWNW	19	18N	5W	LINCOLN	CLARE	1830 N 320 W	
BHL:	NWSWNW	19	18N	5W	LINCOLN	CLARE	1830 N 320 W	

Michigan Department of  
Environment, Great Lakes, and Energy  
Oil, Gas and Minerals Division

UPDATED PERMITS

06/24/2024 THRU 06/28/2024



Permit Number      Permittee Number      Permittee Name

**RECORD OF WELL PLUGGING:**

15951      8139      MUSKEGON OPERATING COMPANY LLC  
1425 S MISSION RD  
MOUNT PLEASANT, MI 48858 USA

API Well Number: 21-051-15951-00-00

Well Name: MC CRANDELL, B & G B-3

Plugging Date: 6/3/2024

Location	QT QT QT	Sec	Township	Range	Township Name	County	Feet From Section Line	Feet From DRLG Unit
SL:	SWNWSW	2	17N	1E	BILLINGS	GLADWIN	990 N 330 W	330 S 2310 E
BHL:	SWNWSW	2	17N	1E	BILLINGS	GLADWIN		

19985      103      A N R PIPELINE CO  
5250 CORPORATE DRIVE  
TROY, MI 48098

API Well Number: 21-117-19985-01-00

Well Name: MCGC 2

Plugging Date: 6/3/2024

Location	QT QT QT	Sec	Township	Range	Township Name	County	Feet From Section Line	Feet From DRLG Unit
SL:	SESWNE	6	12N	9W	WINFIELD	MONTCALM	330 S 990 W	
BHL:	SESWNE	6	12N	9W	WINFIELD	MONTCALM		

Michigan Department of  
Environment, Great Lakes, and Energy  
Oil, Gas and Minerals Division

UPDATED PERMITS

06/24/2024 THRU 06/28/2024



Permit Number      Permittee Number      Permittee Name

28758      103      A N R PIPELINE CO  
5250 CORPORATE DRIVE  
TROY, MI 48098

API Well Number: 21-117-28758-00-00

Well Name: MWPLC W-42

Plugging Date: 6/17/2024

Location	QT QT QT	Sec	Township	Range	Township Name	County	Feet From Section Line	Feet From DRLG Unit
SL:	SWNWNE	7	12N	9W	WINFIELD	MONTCALM	990 N 330 W	990 N 330 W
BHL:	SWNWNE	7	12N	9W	WINFIELD	MONTCALM		

29198      103      A N R PIPELINE CO  
5250 CORPORATE DRIVE  
TROY, MI 48098

API Well Number: 21-117-29198-00-00

Well Name: MWPLC W-62

Plugging Date: 6/3/2024

Location	QT QT QT	Sec	Township	Range	Township Name	County	Feet From Section Line	Feet From DRLG Unit
SL:	NESESW	7	12N	9W	WINFIELD	MONTCALM	1115 S 200 E	1115 S 200 E
BHL:	NESESW	7	12N	9W	WINFIELD	MONTCALM		

Michigan Department of  
Environment, Great Lakes, and Energy  
Oil, Gas and Minerals Division

UPDATED PERMITS

06/24/2024 THRU 06/28/2024



Permit Number      Permittee Number      Permittee Name

47530      2821      FAIR ENERGIES INC  
2380 N M-30  
GLADWIN, MI 48624

API Well Number: 21-017-47530-00-00

Well Name: KINNANE 1-7

Plugging Date: 4/10/2024

Location	QT QT QT	Sec	Township	Range	Township Name	County	Feet From Section Line	Feet From DRLG Unit
SL:	NENWNE	7	14N	5E	BANGOR	BAY	330 N 996 W	330 N 330 E
BHL:	NENWNE	7	14N	5E	BANGOR	BAY		

5113      103      A N R PIPELINE CO  
5250 CORPORATE DRIVE  
TROY, MI 48098

API Well Number: 21-117-05113-01-00

Well Name: JACKS & SCHNICK 4

Plugging Date: 6/17/2024

Location	QT QT QT	Sec	Township	Range	Township Name	County	Feet From Section Line	Feet From DRLG Unit
SL:	CNNE	7	12N	9W	WINFIELD	MONTCALM	1320 N 1320 E	
BHL:		7	12N	9W	WINFIELD	MONTCALM		



Michigan Department of  
Environment, Great Lakes, and Energy  
Oil, Gas and Minerals Division

UPDATED PERMITS

06/24/2024 THRU 06/28/2024



Permit Number      Permittee Number      Permittee Name

61743      103      A N R PIPELINE CO  
5250 CORPORATE DRIVE  
TROY, MI 48098

API Well Number: 21-035-62030-00-90

Well Name: LINCOLN 165HD LHL

Plugging Date: 6/7/2024

Location	QT QT QT	Sec	Township	Range	Township Name	County	Feet From Section Line	Feet From DRLG Unit
SL:	NESWNE	20	18N	5W	LINCOLN	CLARE	1940 N 1420 E	
BHL:	NESWNE	20	18N	5W	LINCOLN	CLARE	1940 N 1420 E	

61744      103      A N R PIPELINE CO  
5250 CORPORATE DRIVE  
TROY, MI 48098

API Well Number: 21-035-62031-00-90

Well Name: LINCOLN 166HD LHL

Plugging Date: 5/3/2024

Location	QT QT QT	Sec	Township	Range	Township Name	County	Feet From Section Line	Feet From DRLG Unit
SL:	NWSWNW	19	18N	5W	LINCOLN	CLARE	1830 N 320 W	
BHL:	NWSWNW	19	18N	5W	LINCOLN	CLARE	1830 N 320 W	

Michigan Department of  
Environment, Great Lakes, and Energy  
Oil, Gas and Minerals Division

UPDATED PERMITS

06/24/2024 THRU 06/28/2024



Permit Number      Permittee Number      Permittee Name

**APPLICATIONS TO CHANGE WELL STATUS:**

10110                      7905                      MISSAUKEE OIL AND  
GAS COMPANY LLC  
PO BOX 720  
LAKE CITY, MI 49651

API Well Number: 21-113-10110-00-00

Well Name: WILSON, EDNA CORNELL ET AL  
1

Approval Date: 6/12/2024

Location	QT QT QT	Sec	Township	Range	Township Name	County	Feet From Section Line	Feet From DRLG Unit
SL:	S2SESE	11	23N	5W	ENTERPRISE	MISSAUKEE	330 S 660 E	990 N 1980 W
BHL:	S2SESE	11	23N	5W	ENTERPRISE	MISSAUKEE		

Proposed Rework: ACOWS for Miscellaneous

Comment: ACOWS to plugback, perf and test the Dundee formation expires on 6/12/2025

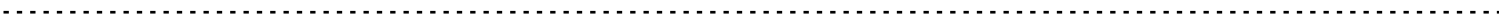

Michigan Department of  
Environment, Great Lakes, and Energy  
Oil, Gas and Minerals Division

UPDATED PERMITS

06/24/2024 THRU 06/28/2024



Permit Number      Permittee Number      Permittee Name

**PERMIT TERMINATIONS:**

61405      5320      SAVOY ENERGY LP  
PO BOX 1560  
TRAVERSE CITY, MI 49685-1560 USA

API Well Number: 21-157-62002-00-00

Well Name: ABKE 1-18

Termination Date: 5/2/2021

Location	QT QT QT	Sec	Township	Range	Township Name	County	Feet From Section Line	Feet From DRLG Unit
SL:	NWSESE	18	14N	9E	COLUMBIA	TUSCOLA	995 S 991 E	
BHL:	NWSESE	18	14N	9E	COLUMBIA	TUSCOLA	995 S 991 E	331 N 331 W

61485      5320      SAVOY ENERGY LP  
PO BOX 1560  
TRAVERSE CITY, MI 49685-1560 USA

API Well Number: 21-025-62022-00-00

Well Name: MOTZ 2-19 SWD

Termination Date: 5/11/2024

Location	QT QT QT	Sec	Township	Range	Township Name	County	Feet From Section Line	Feet From DRLG Unit
SL:	SWSWSW	19	4S	7W	BURLINGTON	CALHOUN	651 S 360 W	651 S 360 W
BHL:	SWSWSW	19	4S	7W	BURLINGTON	CALHOUN	651 S 360 W	

Michigan Department of  
Environment, Great Lakes, and Energy  
Oil, Gas and Minerals Division

UPDATED PERMITS

06/24/2024 THRU 06/28/2024



Permit Number      Permittee Number      Permittee Name

61541      6040      NU ENERGY OPERATING INC  
PO BOX 1122  
GAYLORD, MI 49734 USA

API Well Number: 21-025-62030-00-00

Well Name: WARE C4-34

Termination Date: 6/15/2023

Location	QT QT QT	Sec	Township	Range	Township Name	County	Feet From Section Line	Feet From DRLG Unit
SL:	NWNESE	34	1S	5W	LEE	CALHOUN	2129 S 1170 E	528 N 1170 E
BHL:	NWNESE	34	1S	5W	LEE	CALHOUN	2129 S 1170 E	528 N 1170 E

61589      7772      LAMBDA ENERGY RESOURCES LLC  
12012 WICKCHESTER LANE  
SUITE 300  
HOUSTON, TX 77079 USA

API Well Number: 21-141-62302-00-00

Well Name: FREEL-FLEMMING ACRES 1-35

Termination Date: 12/20/2023

Location	QT QT QT	Sec	Township	Range	Township Name	County	Feet From Section Line	Feet From DRLG Unit
SL:	SENESE	35	34N	3E	CASE	PRESQUE ISLE	661 N 215 E	657 N 1108 W
BHL:	SENESE	35	34N	3E	CASE	PRESQUE ISLE	661 N 215 E	657 N 1108 W