

Michigan Department of  
Environment, Great Lakes, and Energy  
Geologic Resources Management Division

PERMIT APPLICATIONS

08/12/2024 THRU 08/16/2024



Application Number    Date Received    Permittee Number    Permittee Name    Page 2

1027                      08/12/2024                      5320                      SAVOY ENERGY LP  
PO BOX 1560  
TRAVERSE CITY, MI 49685-1560

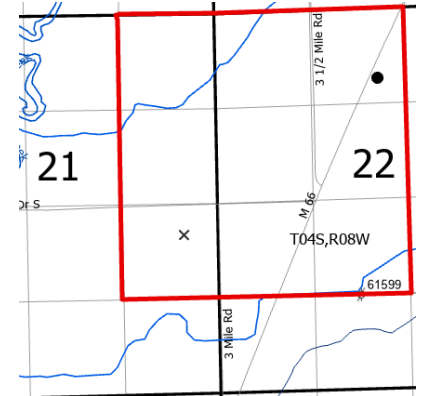

Prev Permit: 61599

Well Name: Brunner 1-21 HD2

Surface Owner: Stefanie D. Murphy

Well Type: OIL

True Vertical Depth: 3420

Permit Type: Reentry

Target Formation: TRENTON

H2S Present? No

Deepest Formation: TRENTON

360-Acre R303 Drilling Unit, E/2 NE/4, NE/4 SE/3 Sec 21; NW/4, N/2 SW/4 Sec 22

Location:	QT QT QT	Sec	Township	Range	Township Name	County	Feet From Section Line	Feet From DRLG Unit Line
SL:	NENESE	21	4S	8W	ATHENS	CALHOUN	2213 S 474 E	893 S 851 W
BHL:	SEENW	22	4S	8W	ATHENS	CALHOUN	956 N 2234 E	956 N 414 E

1026                      08/13/2024                      5320                      SAVOY ENERGY LP  
PO BOX 1560  
TRAVERSE CITY, MI 49685-1560

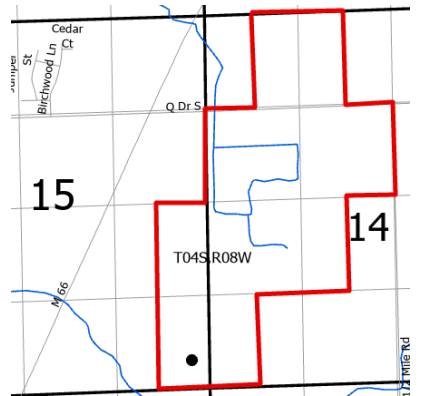

Prev Permit: 61552, 61570

Well Name: Bennett 1-14 HD2

Surface Owner: Sharon L. Bates

Well Type: OIL

True Vertical Depth: 3480

Permit Type: Reentry

Target Formation: TRENTON

H2S Present? No

Deepest Formation: TRENTON

240-Acre R303 Drilling Unit, E/2 E/2 SE/4 Sec 15; W/2 NE/4 NW/4, E/2 NW/4 NW/4, S/2 NW/4, W/2 NE/4 SW/4, NW/4 SW/4, W/2 SW/4 SW/4 Sec 14

Location:	QT QT QT	Sec	Township	Range	Township Name	County	Feet From Section Line	Feet From DRLG Unit Line
SL:	SWNENW	14	4S	8W	ATHENS	CALHOUN	974 N 1480 W	974 N 519 E
BHL:	SESESE	15	4S	8W	ATHENS	CALHOUN	394 S 236 W	394 S 425 W

Michigan Department of  
Environment, Great Lakes, and Energy  
Geologic Resources Management Division

UPDATED PERMITS  
08/12/2024 THRU 08/16/2024



Permit Number      Permittee Number      Permittee Name

**RECORD OF WELL PLUGGING:**

55709            5509            NORTHSTAR ENERGY LLC  
616 S MAIN ST  
SUITE 109  
TULSA, OK 74119

API Well Number: 21-029-55709-00-00

Well Name: SEVENSKI A1-32

Plugging Date: 7/1/2024

Location	QT QT QT	Sec	Township	Range	Township Name	County	Feet From Section Line	Feet From DRLG Unit
SL:	SWNWNW	32	32N	4W	HUDSON	CHARLEVOIX	670 N 570 W	635 S 570 W
BHL:	SWNWNW	32	32N	4W	HUDSON	CHARLEVOIX		

55711            5509            NORTHSTAR ENERGY LLC  
616 S MAIN ST  
SUITE 109  
TULSA, OK 74119

API Well Number: 21-029-55711-00-00

Well Name: STATE HUDSON &  
WASYLEWSKI C3-28

Plugging Date: 5/2/2024

Location	QT QT QT	Sec	Township	Range	Township Name	County	Feet From Section Line	Feet From DRLG Unit
SL:	NWNWSE	28	32N	4W	HUDSON	CHARLEVOIX	2351 S 2123 E	1032 S 474 W
BHL:	NWNWSE	28	32N	4W	HUDSON	CHARLEVOIX		

Michigan Department of  
Environment, Great Lakes, and Energy  
Geologic Resources Management Division

UPDATED PERMITS  
08/12/2024 THRU 08/16/2024



Permit Number      Permittee Number      Permittee Name

55749      5509      NORTHSTAR ENERGY LLC  
616 S MAIN ST  
SUITE 109  
TULSA, OK 74119

API Well Number: 21-029-55749-00-00

Well Name: STATE HUDSON A1-29

Plugging Date: 6/27/2024

Location	QT QT QT	Sec	Township	Range	Township Name	County	Feet From Section Line	Feet From DRLG Unit
SL:	NENWNW	29	32N	4W	HUDSON	CHARLEVOIX	461 N 972 W	461 N 972 W
BHL:	NENWNW	29	32N	4W	HUDSON	CHARLEVOIX		

55754      5509      NORTHSTAR ENERGY LLC  
616 S MAIN ST  
SUITE 109  
TULSA, OK 74119

API Well Number: 21-029-55754-00-00

Well Name: FRONTIER SHR B2-27

Plugging Date: 5/1/2024

Location	QT QT QT	Sec	Township	Range	Township Name	County	Feet From Section Line	Feet From DRLG Unit
SL:	SESENW	27	32N	4W	HUDSON	CHARLEVOIX	2277 N 2440 W	
BHL:	SESENW	27	32N	4W	HUDSON	CHARLEVOIX		

Michigan Department of  
Environment, Great Lakes, and Energy  
Geologic Resources Management Division

UPDATED PERMITS  
08/12/2024 THRU 08/16/2024



Permit Number      Permittee Number      Permittee Name

55851      5509      NORTHSTAR ENERGY LLC  
616 S MAIN ST  
SUITE 109  
TULSA, OK 74119

API Well Number: 21-029-55851-00-00

Well Name: FRONTIER SHR C1-30

Plugging Date: 6/6/2024

Location	QT QT QT	Sec	Township	Range	Township Name	County	Feet From Section Line	Feet From DRLG Unit
SL:	SENWSW	30	32N	4W	HUDSON	CHARLEVOIX	1475 S 912 W	1165 N 470 E
BHL:	SENWSW	30	32N	4W	HUDSON	CHARLEVOIX		

56044      5509      NORTHSTAR ENERGY LLC  
616 S MAIN ST  
SUITE 109  
TULSA, OK 74119

API Well Number: 21-029-56044-00-00

Well Name: STATE HUDSON & BELL D2-29

Plugging Date: 6/5/2024

Location	QT QT QT	Sec	Township	Range	Township Name	County	Feet From Section Line	Feet From DRLG Unit
SL:	SESESW	29	32N	4W	HUDSON	CHARLEVOIX	330 S 2513 W	330 S 1194 W
BHL:	SESESW	29	32N	4W	HUDSON	CHARLEVOIX		

Michigan Department of  
Environment, Great Lakes, and Energy  
Geologic Resources Management Division

UPDATED PERMITS  
08/12/2024 THRU 08/16/2024



Permit Number      Permittee Number      Permittee Name

56083      5509      NORTHSTAR ENERGY LLC  
616 S MAIN ST  
SUITE 109  
TULSA, OK 74119

API Well Number: 21-029-56083-00-00

Well Name: FRONTIER SHR A3-23

Plugging Date: 4/23/2024

Location	QT QT QT	Sec	Township	Range	Township Name	County	Feet From Section Line	Feet From DRLG Unit
SL:	NENWNE	23	32N	4W	HUDSON	CHARLEVOIX	330 N 1425 E	
BHL:	NENWNE	23	32N	4W	HUDSON	CHARLEVOIX		

56247      5509      NORTHSTAR ENERGY LLC  
616 S MAIN ST  
SUITE 109  
TULSA, OK 74119

API Well Number: 21-029-56247-00-00

Well Name: FRONTIER SHR A4-22

Plugging Date: 5/13/2024

Location	QT QT QT	Sec	Township	Range	Township Name	County	Feet From Section Line	Feet From DRLG Unit
SL:	SENESE	22	32N	4W	HUDSON	CHARLEVOIX	926 N 479 E	
BHL:	SENESE	22	32N	4W	HUDSON	CHARLEVOIX		

Michigan Department of  
Environment, Great Lakes, and Energy  
Geologic Resources Management Division

UPDATED PERMITS  
08/12/2024 THRU 08/16/2024



Permit Number      Permittee Number      Permittee Name

56249      5509      NORTHSTAR ENERGY LLC  
616 S MAIN ST  
SUITE 109  
TULSA, OK 74119

API Well Number: 21-029-56249-00-00

Well Name: FRONTIER SHR A2-23

Plugging Date: 4/25/2024

Location	QT QT QT	Sec	Township	Range	Township Name	County	Feet From Section Line	Feet From DRLG Unit
SL:	NWNENW	23	32N	4W	HUDSON	CHARLEVOIX	330 N 1374 W	
BHL:	NWNENW	23	32N	4W	HUDSON	CHARLEVOIX		

56250      5509      NORTHSTAR ENERGY LLC  
616 S MAIN ST  
SUITE 109  
TULSA, OK 74119

API Well Number: 21-029-56250-00-00

Well Name: FRONTIER SHR B2-23

Plugging Date: 4/24/2024

Location	QT QT QT	Sec	Township	Range	Township Name	County	Feet From Section Line	Feet From DRLG Unit
SL:	NESENW	23	32N	4W	HUDSON	CHARLEVOIX	1760 N 2202 W	
BHL:	NESENW	23	32N	4W	HUDSON	CHARLEVOIX		

Michigan Department of  
Environment, Great Lakes, and Energy  
Geologic Resources Management Division

UPDATED PERMITS  
08/12/2024 THRU 08/16/2024



Permit Number      Permittee Number      Permittee Name

56251      5509      NORTHSTAR ENERGY LLC  
616 S MAIN ST  
SUITE 109  
TULSA, OK 74119

API Well Number: 21-029-56251-00-00

Well Name: STATE HUDSON & FRONTIER  
SHR C4-23

Plugging Date: 5/2/2024

Location	QT QT QT	Sec	Township	Range	Township Name	County	Feet From Section Line	Feet From DRLG Unit
SL:	SENESE	23	32N	4W	HUDSON	CHARLEVOIX	1460 S 334 E	
BHL:	SENESE	23	32N	4W	HUDSON	CHARLEVOIX		

56319      5509      NORTHSTAR ENERGY LLC  
616 S MAIN ST  
SUITE 109  
TULSA, OK 74119

API Well Number: 21-029-56319-00-00

Well Name: STATE HUDSON C1-29

Plugging Date: 6/24/2024

Location	QT QT QT	Sec	Township	Range	Township Name	County	Feet From Section Line	Feet From DRLG Unit
SL:	NENWSW	29	32N	4W	HUDSON	CHARLEVOIX	2499 S 861 W	
BHL:	NENWSW	29	32N	4W	HUDSON	CHARLEVOIX		

Michigan Department of  
Environment, Great Lakes, and Energy  
Geologic Resources Management Division

UPDATED PERMITS  
08/12/2024 THRU 08/16/2024



Permit Number      Permittee Number      Permittee Name

56320      5509      NORTHSTAR ENERGY LLC  
616 S MAIN ST  
SUITE 109  
TULSA, OK 74119

API Well Number: 21-029-56320-00-00

Well Name: FRONTIER SHR A2-30

Plugging Date: 6/10/2024

Location	QT QT QT	Sec	Township	Range	Township Name	County	Feet From Section Line	Feet From DRLG Unit
SL:	SWNENW	30	32N	4W	HUDSON	CHARLEVOIX	733 N 1910 W	
BHL:	SWNENW	30	32N	4W	HUDSON	CHARLEVOIX		

56322      5509      NORTHSTAR ENERGY LLC  
616 S MAIN ST  
SUITE 109  
TULSA, OK 74119

API Well Number: 21-029-56322-00-00

Well Name: FRONTIER SHR B4-30

Plugging Date: 6/28/2024

Location	QT QT QT	Sec	Township	Range	Township Name	County	Feet From Section Line	Feet From DRLG Unit
SL:	NWSENE	30	32N	4W	HUDSON	CHARLEVOIX	1752 N 953 E	
BHL:	NWSENE	30	32N	4W	HUDSON	CHARLEVOIX		



Michigan Department of  
Environment, Great Lakes, and Energy  
Geologic Resources Management Division

UPDATED PERMITS  
08/12/2024 THRU 08/16/2024



Permit Number      Permittee Number      Permittee Name

56324      5509      NORTHSTAR ENERGY LLC  
616 S MAIN ST  
SUITE 109  
TULSA, OK 74119

API Well Number: 21-029-56324-00-00

Well Name: BOYNE VALLEY ESTATES D4-30

Plugging Date: 6/5/2024

Location	QT QT QT	Sec	Township	Range	Township Name	County	Feet From Section Line	Feet From DRLG Unit
SL:	NWSESE	30	32N	4W	HUDSON	CHARLEVOIX	1219 S 717 E	
BHL:	NWSESE	30	32N	4W	HUDSON	CHARLEVOIX		

56325      5509      NORTHSTAR ENERGY LLC  
616 S MAIN ST  
SUITE 109  
TULSA, OK 74119

API Well Number: 21-029-56325-00-00

Well Name: FRONTIER SHR A1-31

Plugging Date: 6/21/2024

Location	QT QT QT	Sec	Township	Range	Township Name	County	Feet From Section Line	Feet From DRLG Unit
SL:	SENWNW	31	32N	4W	HUDSON	CHARLEVOIX	1072 N 971 W	
BHL:	SENWNW	31	32N	4W	HUDSON	CHARLEVOIX		

Michigan Department of  
Environment, Great Lakes, and Energy  
Geologic Resources Management Division

UPDATED PERMITS  
08/12/2024 THRU 08/16/2024



Permit Number      Permittee Number      Permittee Name

56326      5509      NORTHSTAR ENERGY LLC  
616 S MAIN ST  
SUITE 109  
TULSA, OK 74119

API Well Number: 21-029-56326-00-00

Well Name: STATE HUDSON A3-31

Plugging Date: 6/11/2024

Location	QT QT QT	Sec	Township	Range	Township Name	County	Feet From Section Line	Feet From DRLG Unit
SL:	NWNWNE	31	32N	4W	HUDSON	CHARLEVOIX	361 N 2095 E	
BHL:	NWNWNE	31	32N	4W	HUDSON	CHARLEVOIX		

56329      5509      NORTHSTAR ENERGY LLC  
616 S MAIN ST  
SUITE 109  
TULSA, OK 74119

API Well Number: 21-029-56329-00-00

Well Name: CZERKIES A4-32

Plugging Date: 6/3/2024

Location	QT QT QT	Sec	Township	Range	Township Name	County	Feet From Section Line	Feet From DRLG Unit
SL:	SWNE	32	32N	4W	HUDSON	CHARLEVOIX	965 N 1241 E	
BHL:	SWNE	32	32N	4W	HUDSON	CHARLEVOIX		

Michigan Department of  
Environment, Great Lakes, and Energy  
Geologic Resources Management Division

UPDATED PERMITS  
08/12/2024 THRU 08/16/2024



Permit Number      Permittee Number      Permittee Name

56379      5509      NORTHSTAR ENERGY LLC  
616 S MAIN ST  
SUITE 109  
TULSA, OK 74119

API Well Number: 21-029-56379-00-00

Well Name: FRONTIER SHR B2-23 SWD

Plugging Date: 4/25/2024

Location	QT QT QT	Sec	Township	Range	Township Name	County	Feet From Section Line	Feet From DRLG Unit
SL:	NESEW	23	32N	4W	HUDSON	CHARLEVOIX	1863 N 2235 W	
BHL:	NESEW	23	32N	4W	HUDSON	CHARLEVOIX		

56503      5509      NORTHSTAR ENERGY LLC  
616 S MAIN ST  
SUITE 109  
TULSA, OK 74119

API Well Number: 21-029-56503-00-00

Well Name: FRONTIER SHR B4-28

Plugging Date: 5/1/2024

Location	QT QT QT	Sec	Township	Range	Township Name	County	Feet From Section Line	Feet From DRLG Unit
SL:	SWSENE	28	32N	4W	HUDSON	CHARLEVOIX	2412 N 867 E	
BHL:	SWSENE	28	32N	4W	HUDSON	CHARLEVOIX		

Michigan Department of  
Environment, Great Lakes, and Energy  
Geologic Resources Management Division

UPDATED PERMITS  
08/12/2024 THRU 08/16/2024



Permit Number      Permittee Number      Permittee Name

56504      5509      NORTHSTAR ENERGY LLC  
616 S MAIN ST  
SUITE 109  
TULSA, OK 74119

API Well Number: 21-029-56504-00-00

Well Name: FRONTIER SHR A1-27

Plugging Date: 5/20/2024

Location	QT QT QT	Sec	Township	Range	Township Name	County	Feet From Section Line	Feet From DRLG Unit
SL:	NWNWNW	27	32N	4W	HUDSON	CHARLEVOIX	559 N 357 W	
BHL:	NWNWNW	27	32N	4W	HUDSON	CHARLEVOIX		

56588      5509      NORTHSTAR ENERGY LLC  
616 S MAIN ST  
SUITE 109  
TULSA, OK 74119

API Well Number: 21-029-56588-00-00

Well Name: FRONTIER SHR A4-33

Plugging Date: 5/31/2024

Location	QT QT QT	Sec	Township	Range	Township Name	County	Feet From Section Line	Feet From DRLG Unit
SL:	NWNE	33	32N	4W	HUDSON	CHARLEVOIX	95 N 1128 E	
BHL:	NWNE	33	32N	4W	HUDSON	CHARLEVOIX		

Michigan Department of  
Environment, Great Lakes, and Energy  
Geologic Resources Management Division

UPDATED PERMITS  
08/12/2024 THRU 08/16/2024



Permit Number      Permittee Number      Permittee Name

56795      5509      NORTHSTAR ENERGY LLC  
616 S MAIN ST  
SUITE 109  
TULSA, OK 74119

API Well Number: 21-029-56795-00-00

Well Name: FRONTIER SHR D1-20

Plugging Date: 4/15/2024

Location	QT QT QT	Sec	Township	Range	Township Name	County	Feet From Section Line	Feet From DRLG Unit
SL:	SESWSW	20	32N	4W	HUDSON	CHARLEVOIX	629 S 948 W	629 S 948 W
BHL:	SESWSW	20	32N	4W	HUDSON	CHARLEVOIX		

56796      5509      NORTHSTAR ENERGY LLC  
616 S MAIN ST  
SUITE 109  
TULSA, OK 74119

API Well Number: 21-029-56796-00-00

Well Name: FRONTIER SHR C1-20

Plugging Date: 4/17/2024

Location	QT QT QT	Sec	Township	Range	Township Name	County	Feet From Section Line	Feet From DRLG Unit
SL:	NWNWSW	20	32N	4W	HUDSON	CHARLEVOIX	2295 S 455 W	331 N 455 W
BHL:	NWNWSW	20	32N	4W	HUDSON	CHARLEVOIX		

Michigan Department of  
Environment, Great Lakes, and Energy  
Geologic Resources Management Division

UPDATED PERMITS  
08/12/2024 THRU 08/16/2024



Permit Number      Permittee Number      Permittee Name

56871      5509      NORTHSTAR ENERGY LLC  
616 S MAIN ST  
SUITE 109  
TULSA, OK 74119

API Well Number: 21-029-56871-00-00

Well Name: FRONTIER SHR B2-30

Plugging Date: 6/6/2024

Location	QT QT QT	Sec	Township	Range	Township Name	County	Feet From Section Line	Feet From DRLG Unit
SL:	SESENW	30	32N	4W	HUDSON	CHARLEVOIX	2221 N 2337 W	
BHL:	SESENW	30	32N	4W	HUDSON	CHARLEVOIX		

56872      5509      NORTHSTAR ENERGY LLC  
616 S MAIN ST  
SUITE 109  
TULSA, OK 74119

API Well Number: 21-029-56872-00-00

Well Name: FRONTIER SHR B1-30

Plugging Date: 6/11/2024

Location	QT QT QT	Sec	Township	Range	Township Name	County	Feet From Section Line	Feet From DRLG Unit
SL:	NWSWNW	30	32N	4W	HUDSON	CHARLEVOIX	1448 N 427 W	
BHL:	NWSWNW	30	32N	4W	HUDSON	CHARLEVOIX		

Michigan Department of  
Environment, Great Lakes, and Energy  
Geologic Resources Management Division

UPDATED PERMITS  
08/12/2024 THRU 08/16/2024



Permit Number      Permittee Number      Permittee Name

56873      5509      NORTHSTAR ENERGY LLC  
616 S MAIN ST  
SUITE 109  
TULSA, OK 74119

API Well Number: 21-029-56873-00-00

Well Name: FRONTIER SHR B2-31

Plugging Date: 6/21/2024

Location	QT QT QT	Sec	Township	Range	Township Name	County	Feet From Section Line	Feet From DRLG Unit
SL:	NESENW	31	32N	4W	HUDSON	CHARLEVOIX	1556 N 2317 W	
BHL:	NESENW	31	32N	4W	HUDSON	CHARLEVOIX		

56874      5509      NORTHSTAR ENERGY LLC  
616 S MAIN ST  
SUITE 109  
TULSA, OK 74119

API Well Number: 21-029-56874-00-00

Well Name: FRONTIER SHR A3-30

Plugging Date: 6/27/2024

Location	QT QT QT	Sec	Township	Range	Township Name	County	Feet From Section Line	Feet From DRLG Unit
SL:	NENWNE	30	32N	4W	HUDSON	CHARLEVOIX	617 N 1793 E	
BHL:	NENWNE	30	32N	4W	HUDSON	CHARLEVOIX		

Michigan Department of  
Environment, Great Lakes, and Energy  
Geologic Resources Management Division

UPDATED PERMITS  
08/12/2024 THRU 08/16/2024



Permit Number      Permittee Number      Permittee Name

56877      5509      NORTHSTAR ENERGY LLC  
616 S MAIN ST  
SUITE 109  
TULSA, OK 74119

API Well Number: 21-029-56877-00-00

Well Name: MEAD C4-32

Plugging Date: 7/2/2024

Location	QT QT QT	Sec	Township	Range	Township Name	County	Feet From Section Line	Feet From DRLG Unit
SL:	SWNESE	32	32N	4W	HUDSON	CHARLEVOIX	1643 S 1239 E	
BHL:	SWNESE	32	32N	4W	HUDSON	CHARLEVOIX		

56886      5509      NORTHSTAR ENERGY LLC  
616 S MAIN ST  
SUITE 109  
TULSA, OK 74119

API Well Number: 21-029-56886-00-00

Well Name: STATE HUDSON B1-32

Plugging Date: 6/28/2024

Location	QT QT QT	Sec	Township	Range	Township Name	County	Feet From Section Line	Feet From DRLG Unit
SL:	SESWNW	32	32N	4W	HUDSON	CHARLEVOIX	1976 N 828 W	
BHL:	SESWNW	32	32N	4W	HUDSON	CHARLEVOIX		



Michigan Department of  
Environment, Great Lakes, and Energy  
Geologic Resources Management Division

UPDATED PERMITS  
08/12/2024 THRU 08/16/2024



Permit Number      Permittee Number      Permittee Name

56908      5509      NORTHSTAR ENERGY LLC  
616 S MAIN ST  
SUITE 109  
TULSA, OK 74119

API Well Number: 21-029-56908-00-00

Well Name: SUPERIOR REAL ESTATE B2-28      True Vertical Depth: 987

Plugging Date: 5/31/2024

Location	QT QT QT	Sec	Township	Range	Township Name	County	Feet From Section Line	Feet From DRLG Unit
SL:	SESWNW	28	32N	4W	HUDSON	CHARLEVOIX	2491 N 1131 W	
BHL:	SWSENW	28	32N	4W	HUDSON	CHARLEVOIX	2049 N 1597 W	

56913      5509      NORTHSTAR ENERGY LLC  
616 S MAIN ST  
SUITE 109  
TULSA, OK 74119

API Well Number: 21-029-56913-00-00

Well Name: FRONTIER SHR A4-20

Plugging Date: 4/18/2024

Location	QT QT QT	Sec	Township	Range	Township Name	County	Feet From Section Line	Feet From DRLG Unit
SL:	SWNENE	20	32N	4W	HUDSON	CHARLEVOIX	798 N 953 E	513 S 953 E
BHL:	SWNENE	20	32N	4W	HUDSON	CHARLEVOIX		

Michigan Department of  
Environment, Great Lakes, and Energy  
Geologic Resources Management Division

UPDATED PERMITS  
08/12/2024 THRU 08/16/2024



Permit Number      Permittee Number      Permittee Name

56914      5509      NORTHSTAR ENERGY LLC  
616 S MAIN ST  
SUITE 109  
TULSA, OK 74119

API Well Number: 21-029-56914-00-00

Well Name: FRONTIER SHR B3-20

Plugging Date: 4/17/2024

Location	QT QT QT	Sec	Township	Range	Township Name	County	Feet From Section Line	Feet From DRLG Unit
SL:	SESWNE	20	32N	4W	HUDSON	CHARLEVOIX	2409 N 1661 E	1099 N 344 E
BHL:	SESWNE	20	32N	4W	HUDSON	CHARLEVOIX		

56915      5509      NORTHSTAR ENERGY LLC  
616 S MAIN ST  
SUITE 109  
TULSA, OK 74119

API Well Number: 21-029-56915-00-00

Well Name: FRONTIER SHR B3-20 SWD

Plugging Date: 4/17/2024

Location	QT QT QT	Sec	Township	Range	Township Name	County	Feet From Section Line	Feet From DRLG Unit
SL:	SESWNE	20	32N	4W	HUDSON	CHARLEVOIX	2491 N 1667 E	
BHL:	SESWNE	20	32N	4W	HUDSON	CHARLEVOIX		

Michigan Department of  
Environment, Great Lakes, and Energy  
Geologic Resources Management Division

UPDATED PERMITS  
08/12/2024 THRU 08/16/2024



Permit Number      Permittee Number      Permittee Name

56917      5509      NORTHSTAR ENERGY LLC  
616 S MAIN ST  
SUITE 109  
TULSA, OK 74119

API Well Number: 21-029-56917-00-00

Well Name: FRONTIER SHR D3-23

Plugging Date: 4/25/2024

Location	QT QT QT	Sec	Township	Range	Township Name	County	Feet From Section Line	Feet From DRLG Unit
SL:	SESWSE	23	32N	4W	HUDSON	CHARLEVOIX	428 S 1497 E	
BHL:	SESWSE	23	32N	4W	HUDSON	CHARLEVOIX		

56934      5509      NORTHSTAR ENERGY LLC  
616 S MAIN ST  
SUITE 109  
TULSA, OK 74119

API Well Number: 21-029-56934-00-00

Well Name: FRONTIER SHR A3-22

Plugging Date: 4/30/2024

Location	QT QT QT	Sec	Township	Range	Township Name	County	Feet From Section Line	Feet From DRLG Unit
SL:	SWNWNE	22	32N	4W	HUDSON	CHARLEVOIX	1731 S 357 W	
BHL:	SWNWNE	22	32N	4W	HUDSON	CHARLEVOIX		

Michigan Department of  
Environment, Great Lakes, and Energy  
Geologic Resources Management Division

UPDATED PERMITS  
08/12/2024 THRU 08/16/2024



Permit Number      Permittee Number      Permittee Name

57832      5509      NORTHSTAR ENERGY LLC  
616 S MAIN ST  
SUITE 109  
TULSA, OK 74119

API Well Number: 21-029-57832-00-00

Well Name: FRONTIER SHR A4-27

Plugging Date: 4/30/2024

Location	QT QT QT	Sec	Township	Range	Township Name	County	Feet From Section Line	Feet From DRLG Unit
SL:	NWNENE	27	32N	4W	HUDSON	CHARLEVOIX	349 N 1194 E	349 N 1194 E
BHL:	NWNENE	27	32N	4W	HUDSON	CHARLEVOIX		

57833      5509      NORTHSTAR ENERGY LLC  
616 S MAIN ST  
SUITE 109  
TULSA, OK 74119

API Well Number: 21-029-57833-00-00

Well Name: FRONTIER SHR C2-16

Plugging Date: 5/13/2024

Location	QT QT QT	Sec	Township	Range	Township Name	County	Feet From Section Line	Feet From DRLG Unit
SL:	SWNESW	16	32N	4W	HUDSON	CHARLEVOIX	1514 S 1667 W	1128 N 350 W
BHL:	SWNESW	16	32N	4W	HUDSON	CHARLEVOIX		

Michigan Department of  
Environment, Great Lakes, and Energy  
Geologic Resources Management Division

UPDATED PERMITS  
08/12/2024 THRU 08/16/2024



Permit Number      Permittee Number      Permittee Name

59044      8407      WHITE PINE PRODUCTION LLC  
124 SOUTH MAIN STREET SUITE 203  
BURLESON, TX 76028 USA

API Well Number: 21-079-59044-00-00

Well Name: STATE GARFIELD (DRZ3) B2-10

Plugging Date: 6/28/2024

Location	QT QT QT	Sec	Township	Range	Township Name	County	Feet From Section Line	Feet From DRLG Unit
SL:	NWSEW	10	25N	5W	GARFIELD	KALKASKA	1788 N 1800 W	470 N 470 W
BHL:	NWSEW	10	25N	5W	GARFIELD	KALKASKA		

59176      8407      WHITE PINE PRODUCTION LLC  
124 SOUTH MAIN STREET SUITE 203  
BURLESON, TX 76028 USA

API Well Number: 21-079-59176-00-00

Well Name: STATE GARFIELD (RICHFIELD)  
D1-9

Plugging Date: 7/10/2024

Location	QT QT QT	Sec	Township	Range	Township Name	County	Feet From Section Line	Feet From DRLG Unit
SL:	NWSWSW	9	25N	5W	GARFIELD	KALKASKA	993 S 330 W	330 N 330 W
BHL:	NWSWSW	9	25N	5W	GARFIELD	KALKASKA		

Michigan Department of  
Environment, Great Lakes, and Energy  
Geologic Resources Management Division

UPDATED PERMITS  
08/12/2024 THRU 08/16/2024



Permit Number      Permittee Number      Permittee Name

**APPLICATIONS TO CHANGE WELL STATUS:**

28161      7772      LAMBDA ENERGY RESOURCES LLC  
12012 WICKCHESTER LANE  
SUITE 300  
HOUSTON, TX 77079 USA

API Well Number: 21-055-28161-00-00

Well Name: STATE UNION 1-8

Approval Date: 8/8/2024

Location	QT QT QT	Sec	Township	Range	Township Name	County	Feet From Section Line	Feet From DRLG Unit
SL:	SWNWSE	8	26N	9W	UNION	GRAND TRAVERSE	890 N 330 W	890 N 330 W
BHL:	SWNWSE	8	26N	9W	UNION	GRAND TRAVERSE		

Proposed Rework:      Temporarily Abandoned

Comment:      ACOWS for TA expires 3/31/2025

28388      7772      LAMBDA ENERGY RESOURCES LLC  
12012 WICKCHESTER LANE  
SUITE 300  
HOUSTON, TX 77079 USA

API Well Number: 21-079-28388-00-00

Well Name: STATE RAPID RIVER 1-24

Approval Date: 8/8/2024

Location	QT QT QT	Sec	Township	Range	Township Name	County	Feet From Section Line	Feet From DRLG Unit
SL:	CNNWSE	24	28N	7W	RAPID RIVER	KALKASKA	660 N 660 W	660 N 660 W
BHL:	CNNWSE	24	28N	7W	RAPID RIVER	KALKASKA		

Proposed Rework:      Temporarily Abandoned

Comment:      ACOWS for TA expires on 3/31/2025

Michigan Department of  
Environment, Great Lakes, and Energy  
Geologic Resources Management Division

UPDATED PERMITS  
08/12/2024 THRU 08/16/2024



Permit Number      Permittee Number      Permittee Name

28691      7772      LAMBDA ENERGY RESOURCES LLC  
12012 WICKCHESTER LANE  
SUITE 300  
HOUSTON, TX 77079 USA

API Well Number: 21-079-28691-00-00

Well Name: STATE BLUE LAKE 1-27-A

Approval Date: 8/8/2024

Location	QT QT QT	Sec	Township	Range	Township Name	County	Feet From Section Line	Feet From DRLG Unit
SL:	NENENE	27	28N	5W	BLUE LAKE	KALKASKA	520 N 490 E	
BHL:	NENENE	27	28N	5W	BLUE LAKE	KALKASKA		

Proposed Rework:      Temporarily Abandoned

Comment: ACOWS for TA expires on 3/31/2025

29564      7772      LAMBDA ENERGY RESOURCES LLC  
12012 WICKCHESTER LANE  
SUITE 300  
HOUSTON, TX 77079 USA

API Well Number: 21-101-29564-00-00

Well Name: MAUE, JAMES & LINDEMAN ET  
AL 2-6

Approval Date: 8/8/2024

Location	QT QT QT	Sec	Township	Range	Township Name	County	Feet From Section Line	Feet From DRLG Unit
SL:	W2E2SE	6	22N	15W	BROWN	MANISTEE	1319 N 850 E	1319 N 470 W
BHL:	W2E2SE	6	22N	15W	BROWN	MANISTEE		

Proposed Rework:      Temporarily Abandoned

Comment: ACOWS for TA expires on 3/31/2025

Michigan Department of  
Environment, Great Lakes, and Energy  
Geologic Resources Management Division

UPDATED PERMITS  
08/12/2024 THRU 08/16/2024



Permit Number      Permittee Number      Permittee Name

29577      7772      LAMBDA ENERGY RESOURCES LLC  
12012 WICKCHESTER LANE  
SUITE 300  
HOUSTON, TX 77079 USA

API Well Number: 21-055-29496-02-00

Well Name: KOCHEVAR DRACKA 3-16B      True Vertical Depth: 6463

Approval Date: 8/8/2024

Location	QT QT QT	Sec	Township	Range	Township Name	County	Feet From Section Line	Feet From DRLG Unit
SL:	CNSWSW	16	25N	11W	MAYFIELD	GRAND TRAVERSE	797 S 699 W	
BHL:	SWSWSW	16	25N	11W	MAYFIELD	GRAND TRAVERSE	308 S 477 W	1012 N 477 W

Proposed Rework:      Temporarily Abandoned

Comment: ACOWS for TA expires on 3/31/2025

29619      7772      LAMBDA ENERGY RESOURCES LLC  
12012 WICKCHESTER LANE  
SUITE 300  
HOUSTON, TX 77079 USA

API Well Number: 21-055-29619-00-00

Well Name: STATE PARADISE 1-23

Approval Date: 8/8/2024

Location	QT QT QT	Sec	Township	Range	Township Name	County	Feet From Section Line	Feet From DRLG Unit
SL:	SENESE	23	26N	10W	PARADISE	GRAND TRAVERSE	800 N 460 E	800 N 460 E
BHL:	SENESE	23	26N	10W	PARADISE	GRAND TRAVERSE		

Proposed Rework:      Temporarily Abandoned

Comment: ACOWS for TA expires on 3/31/2025



Michigan Department of  
Environment, Great Lakes, and Energy  
Geologic Resources Management Division

UPDATED PERMITS  
08/12/2024 THRU 08/16/2024



Permit Number      Permittee Number      Permittee Name

29887      7772      LAMBDA ENERGY RESOURCES LLC  
12012 WICKCHESTER LANE  
SUITE 300  
HOUSTON, TX 77079 USA

API Well Number: 21-055-29887-00-00

Well Name: STINEBACH 2-10

True Vertical Depth: 6351

Approval Date: 8/8/2024

Location	QT QT QT	Sec	Township	Range	Township Name	County	Feet From Section Line	Feet From DRLG Unit
SL:	SWNWSE	10	25N	11W	MAYFIELD	GRAND TRAVERSE	1074 N 460 W	
BHL:	NWSWSE	10	25N	11W	MAYFIELD	GRAND TRAVERSE	1235 S 538 W	1235 S 538 W

Proposed Rework:      Temporarily Abandoned

Comment: ACOWS for TA expires on 3/31/2025

29906      7772      LAMBDA ENERGY RESOURCES LLC  
12012 WICKCHESTER LANE  
SUITE 300  
HOUSTON, TX 77079 USA

API Well Number: 21-101-29906-00-00

Well Name: RUDY ET AL 1-24

True Vertical Depth: 1186

Approval Date: 8/8/2024

Location	QT QT QT	Sec	Township	Range	Township Name	County	Feet From Section Line	Feet From DRLG Unit
SL:	SESENE	24	23N	15W	BEAR LAKE	MANISTEE	198 S 302 E	
BHL:	SENENE	24	23N	15W	BEAR LAKE	MANISTEE	1290 N 591 E	1290 N 591 E

Proposed Rework:      Temporarily Abandoned

Comment: ACOWS for TA expires on 3/31/2025

Michigan Department of  
Environment, Great Lakes, and Energy  
Geologic Resources Management Division

UPDATED PERMITS  
08/12/2024 THRU 08/16/2024



Permit Number      Permittee Number      Permittee Name

29946      7772      LAMBDA ENERGY RESOURCES LLC  
12012 WICKCHESTER LANE  
SUITE 300  
HOUSTON, TX 77079 USA

API Well Number: 21-055-29946-00-00

Well Name: STATE UNION & PIKE 1-6      True Vertical Depth: 6400

Approval Date: 8/8/2024

Location	QT QT QT	Sec	Township	Range	Township Name	County	Feet From Section Line	Feet From DRLG Unit
SL:	NWNWSW	6	26N	9W	UNION	GRAND TRAVERSE	375 N 550 W	
BHL:	SWNWSW	6	26N	9W	UNION	GRAND TRAVERSE	848 N 584 W	848 N 584 W

Proposed Rework:      Temporarily Abandoned

Comment: ACOWS for TA expires on 3/31/2025

30017      7772      LAMBDA ENERGY RESOURCES LLC  
12012 WICKCHESTER LANE  
SUITE 300  
HOUSTON, TX 77079 USA

API Well Number: 21-055-30017-00-00

Well Name: STATE BLAIR & WEAVER 1-26      True Vertical Depth: 6064

Approval Date: 8/8/2024

Location	QT QT QT	Sec	Township	Range	Township Name	County	Feet From Section Line	Feet From DRLG Unit
SL:	SWSWSW	25	26N	11W	BLAIR	GRAND TRAVERSE	385 S 54 W	
BHL:	SENESE	26	26N	11W	BLAIR	GRAND TRAVERSE	909 N 525 E	909 N 525 E

Proposed Rework:      Temporarily Abandoned

Comment: ACOWS for TA expires on 3/31/2025

Michigan Department of  
Environment, Great Lakes, and Energy  
Geologic Resources Management Division

UPDATED PERMITS  
08/12/2024 THRU 08/16/2024



Permit Number      Permittee Number      Permittee Name

30065      7772      LAMBDA ENERGY RESOURCES LLC  
12012 WICKCHESTER LANE  
SUITE 300  
HOUSTON, TX 77079 USA

API Well Number: 21-101-30065-00-00

Well Name: HOPWOOD 1-12

Approval Date: 8/8/2024

Location	QT QT QT	Sec	Township	Range	Township Name	County	Feet From Section Line	Feet From DRLG Unit
SL:	SEWSE	12	22N	16W	MANISTEE	MANISTEE	760 N 1001 W	760 N 1001 W
BHL:	SEWSE	12	22N	16W	MANISTEE	MANISTEE		

Proposed Rework:      Temporarily Abandoned

Comment: ACOWS for TA expires on 3/31/2025

30112      7772      LAMBDA ENERGY RESOURCES LLC  
12012 WICKCHESTER LANE  
SUITE 300  
HOUSTON, TX 77079 USA

API Well Number: 21-101-30112-00-00

Well Name: MODJESKI, A E 2-16

Approval Date: 8/8/2024

Location	QT QT QT	Sec	Township	Range	Township Name	County	Feet From Section Line	Feet From DRLG Unit
SL:	SESWNE	16	22N	16W	MANISTEE	MANISTEE	224 S 840 W	1096 N 460 E
BHL:	SESWNE	16	22N	16W	MANISTEE	MANISTEE		

Proposed Rework:      Temporarily Abandoned

Comment: ACOWS for TA expires on 3/31/2025

Michigan Department of  
Environment, Great Lakes, and Energy  
Geologic Resources Management Division

UPDATED PERMITS  
08/12/2024 THRU 08/16/2024



Permit Number      Permittee Number      Permittee Name

30140      7772      LAMBDA ENERGY RESOURCES LLC  
12012 WICKCHESTER LANE  
SUITE 300  
HOUSTON, TX 77079 USA

API Well Number: 21-101-30140-00-00

Well Name: BOWLING HOFFMAN 2-23

Approval Date: 8/8/2024

Location	QT QT QT	Sec	Township	Range	Township Name	County	Feet From Section Line	Feet From DRLG Unit
SL:	SWSESW	23	23N	15W	BEAR LAKE	MANISTEE	115 S 747 E	1165 N 573 W
BHL:	SWSESW	23	23N	15W	BEAR LAKE	MANISTEE		

Proposed Rework:      Temporarily Abandoned

Comment: ACOWS for TA expires on 3/31/2025

30362      7772      LAMBDA ENERGY RESOURCES LLC  
12012 WICKCHESTER LANE  
SUITE 300  
HOUSTON, TX 77079 USA

API Well Number: 21-055-30362-00-00

Well Name: STATE PARADISE ET AL 2-24

Approval Date: 8/8/2024

Location	QT QT QT	Sec	Township	Range	Township Name	County	Feet From Section Line	Feet From DRLG Unit
SL:	CNW2NW	24	26N	10W	PARADISE	GRAND TRAVERSE	670 N 426 W	670 N 894 E
BHL:	CNW2NW	24	26N	10W	PARADISE	GRAND TRAVERSE		

Proposed Rework:      Temporarily Abandoned

Comment: ACOWS for TA expires on 3/31/2025

Michigan Department of  
Environment, Great Lakes, and Energy  
Geologic Resources Management Division

UPDATED PERMITS  
08/12/2024 THRU 08/16/2024



Permit Number      Permittee Number      Permittee Name

30790      7772      LAMBDA ENERGY RESOURCES LLC  
12012 WICKCHESTER LANE  
SUITE 300  
HOUSTON, TX 77079 USA

API Well Number: 21-079-30790-00-00

Well Name: STATE COLD SPRINGS 1-29

Approval Date: 8/8/2024

Location	QT QT QT	Sec	Township	Range	Township Name	County	Feet From Section Line	Feet From DRLG Unit
SL:	CNSWSE	29	28N	6W	COLD SPRINGS	KALKASKA	676 S 695 W	660 N 695 W
BHL:	CNSWSE	29	28N	6W	COLD SPRINGS	KALKASKA		

Proposed Rework:      Temporarily Abandoned

Comment: ACOWS for TA expires on 3/31/2025

31136      7772      LAMBDA ENERGY RESOURCES LLC  
12012 WICKCHESTER LANE  
SUITE 300  
HOUSTON, TX 77079 USA

API Well Number: 21-079-31136-00-00

Well Name: SIMPSON UNIT L 2-29      True Vertical Depth: 7029

Approval Date: 8/8/2024

Location	QT QT QT	Sec	Township	Range	Township Name	County	Feet From Section Line	Feet From DRLG Unit
SL:	SWNWSE	29	28N	6W	COLD SPRINGS	KALKASKA	814 N 411 W	
BHL:	SENWSE	29	28N	6W	COLD SPRINGS	KALKASKA	799 N 636 W	521 S 636 W

Proposed Rework:      Temporarily Abandoned

Comment: ACOWS for TA expires on 3/31/2025

Michigan Department of  
Environment, Great Lakes, and Energy  
Geologic Resources Management Division

UPDATED PERMITS  
08/12/2024 THRU 08/16/2024



Permit Number      Permittee Number      Permittee Name

31517      7772      LAMBDA ENERGY RESOURCES LLC  
12012 WICKCHESTER LANE  
SUITE 300  
HOUSTON, TX 77079 USA

API Well Number: 21-079-31517-00-00

Well Name: STATE BLUE LAKE "G" 2-17

Approval Date: 8/8/2024

Location	QT QT QT	Sec	Township	Range	Township Name	County	Feet From Section Line	Feet From DRLG Unit
SL:	SWSWNE	17	28N	5W	BLUE LAKE	KALKASKA	100 S 460 W	1238 N 460 W
BHL:	SWSWNE	17	28N	5W	BLUE LAKE	KALKASKA		

Proposed Rework:      Temporarily Abandoned

Comment:      ACOWS for TA expires on 3/31/2025

31913      7772      LAMBDA ENERGY RESOURCES LLC  
12012 WICKCHESTER LANE  
SUITE 300  
HOUSTON, TX 77079 USA

API Well Number: 21-101-31913-00-00

Well Name: STATE MANISTEE 1-23 SWD

Approval Date: 8/8/2024

Location	QT QT QT	Sec	Township	Range	Township Name	County	Feet From Section Line	Feet From DRLG Unit
SL:	SEnwSE	23	22N	16W	MANISTEE	MANISTEE	1010 N 690 W	
BHL:	SEnwSE	23	22N	16W	MANISTEE	MANISTEE		

Proposed Rework:      Temporarily Abandoned

Comment:      ACOWS for TA expires on 3/31/2025

Michigan Department of  
Environment, Great Lakes, and Energy  
Geologic Resources Management Division

UPDATED PERMITS  
08/12/2024 THRU 08/16/2024



Permit Number      Permittee Number      Permittee Name

31970      7772      LAMBDA ENERGY RESOURCES LLC  
12012 WICKCHESTER LANE  
SUITE 300  
HOUSTON, TX 77079 USA

API Well Number: 21-079-31970-00-00

Well Name: RICHMAN STATE BLUE LAKE 1-23

Approval Date: 8/8/2024

Location	QT QT QT	Sec	Township	Range	Township Name	County	Feet From Section Line	Feet From DRLG Unit
SL:	SWSENE	23	28N	5W	BLUE LAKE	KALKASKA	517 S 1152 E	517 S 1152 E
BHL:	SWSENE	23	28N	5W	BLUE LAKE	KALKASKA		

Proposed Rework:      Temporarily Abandoned

Comment:      ACOWS for TA expires on 3/31/2025

32019      7772      LAMBDA ENERGY RESOURCES LLC  
12012 WICKCHESTER LANE  
SUITE 300  
HOUSTON, TX 77079 USA

API Well Number: 21-101-31980-01-00

Well Name: STURT & SMITH 1-28A      True Vertical Depth: 5794

Approval Date: 8/8/2024

Location	QT QT QT	Sec	Township	Range	Township Name	County	Feet From Section Line	Feet From DRLG Unit
SL:	NENESE	28	24N	13W	CLEON	MANISTEE	571 N 569 E	
BHL:	NWNESE	28	24N	13W	CLEON	MANISTEE	379 N 940 E	379 N 381 W

Proposed Rework:      Temporarily Abandoned

Comment:      ACOWS for TA expires on 3/31/2025

Michigan Department of  
Environment, Great Lakes, and Energy  
Geologic Resources Management Division

UPDATED PERMITS  
08/12/2024 THRU 08/16/2024



Permit Number      Permittee Number      Permittee Name

32273      7772      LAMBDA ENERGY RESOURCES LLC  
12012 WICKCHESTER LANE  
SUITE 300  
HOUSTON, TX 77079 USA

API Well Number: 21-055-32273-00-00

Well Name: STATE WHITEWATER "H" 4-22

Approval Date: 8/8/2024

Location	QT QT QT	Sec	Township	Range	Township Name	County	Feet From Section Line	Feet From DRLG Unit
SL:	NESWSW	22	27N	9W	WHITEWATER	GRAND TRAVERSE	810 S 670 W	460 N 652 E
BHL:	NESWSW	22	27N	9W	WHITEWATER	GRAND TRAVERSE		

Proposed Rework:      Temporarily Abandoned

Comment: ACOWS for TA expires on 3/31/2025

32275      7772      LAMBDA ENERGY RESOURCES LLC  
12012 WICKCHESTER LANE  
SUITE 300  
HOUSTON, TX 77079 USA

API Well Number: 21-101-32275-00-00

Well Name: SMITH ET AL 3-27

Approval Date: 8/8/2024

Location	QT QT QT	Sec	Township	Range	Township Name	County	Feet From Section Line	Feet From DRLG Unit
SL:	SWSWNW	27	24N	13W	CLEON	MANISTEE	400 S 500 W	400 S 804 E
BHL:	SWSWNW	27	24N	13W	CLEON	MANISTEE		

Proposed Rework:      Temporarily Abandoned

Comment: ACOWS for TA expires on 3/31/2025



Michigan Department of  
Environment, Great Lakes, and Energy  
Geologic Resources Management Division

UPDATED PERMITS  
08/12/2024 THRU 08/16/2024



Permit Number      Permittee Number      Permittee Name

32438      7772      LAMBDA ENERGY RESOURCES LLC  
12012 WICKCHESTER LANE  
SUITE 300  
HOUSTON, TX 77079 USA

API Well Number: 21-055-32438-00-00

Well Name: STATE WHITEWATER 1-20

Approval Date: 8/8/2024

Location	QT QT QT	Sec	Township	Range	Township Name	County	Feet From Section Line	Feet From DRLG Unit
SL:	SENE	20	27N	9W	WHITEWATER	GRAND TRAVERSE	1250 N 460 E	1250 N 460 E
BHL:	SENE	20	27N	9W	WHITEWATER	GRAND TRAVERSE		

Proposed Rework:      Temporarily Abandoned

Comment:      ACOWS for TA expires on 3/31/2025

32511      7772      LAMBDA ENERGY RESOURCES LLC  
12012 WICKCHESTER LANE  
SUITE 300  
HOUSTON, TX 77079 USA

API Well Number: 21-055-32511-00-00

Well Name: COATES 2-26

Approval Date: 8/8/2024

Location	QT QT QT	Sec	Township	Range	Township Name	County	Feet From Section Line	Feet From DRLG Unit
SL:	CNW2SW	26	25N	12W	GRANT	GRAND TRAVERSE	1306 N 666 W	1306 N 660 E
BHL:	CNW2SW	26	25N	12W	GRANT	GRAND TRAVERSE		

Proposed Rework:      Temporarily Abandoned

Comment:      ACOWS for TA expires on 3/31/2025

Michigan Department of  
Environment, Great Lakes, and Energy  
Geologic Resources Management Division

UPDATED PERMITS  
08/12/2024 THRU 08/16/2024



Permit Number      Permittee Number      Permittee Name

32773      7772      LAMBDA ENERGY RESOURCES LLC  
12012 WICKCHESTER LANE  
SUITE 300  
HOUSTON, TX 77079 USA

API Well Number: 21-055-31896-03-00

Well Name: STATE UNION 3-18A HD-1      True Vertical Depth: 6316

Approval Date: 8/8/2024

Location	QT QT QT	Sec	Township	Range	Township Name	County	Feet From Section Line	Feet From DRLG Unit
SL:	SWNENW	18	26N	9W	UNION	GRAND TRAVERSE	1117 N 1780 W	
BHL:	SENENW	18	26N	9W	UNION	GRAND TRAVERSE	1051 N 2218 W	1051 N 511 E

Proposed Rework:      Temporarily Abandoned

Comment: ACOWS for TA expires on 3/31/2025

32826      7772      LAMBDA ENERGY RESOURCES LLC  
12012 WICKCHESTER LANE  
SUITE 300  
HOUSTON, TX 77079 USA

API Well Number: 21-101-32826-00-00

Well Name: STATE MAPLE GROVE 4-8

Approval Date: 8/8/2024

Location	QT QT QT	Sec	Township	Range	Township Name	County	Feet From Section Line	Feet From DRLG Unit
SL:	NESWSE	8	23N	14W	MAPLE GROVE	MANISTEE	851 S 780 W	460 N 460 E
BHL:	NESWSE	8	23N	14W	MAPLE GROVE	MANISTEE		

Proposed Rework:      Temporarily Abandoned

Comment: ACOWS for TA expires on 3/31/2025

Michigan Department of  
Environment, Great Lakes, and Energy  
Geologic Resources Management Division

UPDATED PERMITS  
08/12/2024 THRU 08/16/2024



Permit Number      Permittee Number      Permittee Name

32988      7772      LAMBDA ENERGY RESOURCES LLC  
12012 WICKCHESTER LANE  
SUITE 300  
HOUSTON, TX 77079 USA

API Well Number: 21-079-32988-00-00

Well Name: BROWN, R.G. ET AL 2-34

Approval Date: 8/8/2024

Location	QT QT QT	Sec	Township	Range	Township Name	County	Feet From Section Line	Feet From DRLG Unit
SL:	SWNWSW	34	28N	5W	BLUE LAKE	KALKASKA	860 N 460 W	460 S 460 W
BHL:	SWNWSW	34	28N	5W	BLUE LAKE	KALKASKA		

Proposed Rework:      Temporarily Abandoned

Comment: ACOWS for TA expires on 3/31/2025

32989      7772      LAMBDA ENERGY RESOURCES LLC  
12012 WICKCHESTER LANE  
SUITE 300  
HOUSTON, TX 77079 USA

API Well Number: 21-079-32989-00-00

Well Name: STATE BLUE LAKE "G" 5-17

Approval Date: 8/8/2024

Location	QT QT QT	Sec	Township	Range	Township Name	County	Feet From Section Line	Feet From DRLG Unit
SL:	SESESE	17	28N	5W	BLUE LAKE	KALKASKA	600 S 460 E	600 S 460 E
BHL:	SESESE	17	28N	5W	BLUE LAKE	KALKASKA		

Proposed Rework:      Temporarily Abandoned

Comment: ACOWS for TA expires on 3/31/2025

Michigan Department of  
Environment, Great Lakes, and Energy  
Geologic Resources Management Division

UPDATED PERMITS  
08/12/2024 THRU 08/16/2024



Permit Number      Permittee Number      Permittee Name

33112      7772      LAMBDA ENERGY RESOURCES LLC  
12012 WICKCHESTER LANE  
SUITE 300  
HOUSTON, TX 77079 USA

API Well Number: 21-079-33112-00-00

Well Name: STATE KALKASKA "F" 2-24

Approval Date: 8/8/2024

Location	QT QT QT	Sec	Township	Range	Township Name	County	Feet From Section Line	Feet From DRLG Unit
SL:	SENWNW	24	27N	8W	KALKASKA	KALKASKA	700 N 700 W	700 N 700 W
BHL:	SENWNW	24	27N	8W	KALKASKA	KALKASKA		

Proposed Rework:      Temporarily Abandoned

Comment: ACOWS for TA expires on 3/31/2025

33242      7772      LAMBDA ENERGY RESOURCES LLC  
12012 WICKCHESTER LANE  
SUITE 300  
HOUSTON, TX 77079 USA

API Well Number: 21-101-33242-01-00

Well Name: STATE CLEON 4-19 HD-1      True Vertical Depth: 5280

Approval Date: 8/8/2024

Location	QT QT QT	Sec	Township	Range	Township Name	County	Feet From Section Line	Feet From DRLG Unit
SL:	NWSWNE	19	24N	13W	CLEON	MANISTEE	1940 N 2179 E	
BHL:	SESWSE	19	24N	13W	CLEON	MANISTEE	460 S 1775 E	460 S 460 E

Proposed Rework:      Temporarily Abandoned

Comment: ACOWS for TA expires on 3/31/2025

Michigan Department of  
Environment, Great Lakes, and Energy  
Geologic Resources Management Division

UPDATED PERMITS  
08/12/2024 THRU 08/16/2024



Permit Number      Permittee Number      Permittee Name

33828      7772      LAMBDA ENERGY RESOURCES LLC  
12012 WICKCHESTER LANE  
SUITE 300  
HOUSTON, TX 77079 USA

API Well Number: 21-101-33828-00-00

Well Name: STATE CLEON ET AL 3-28

Approval Date: 8/8/2024

Location	QT QT QT	Sec	Township	Range	Township Name	County	Feet From Section Line	Feet From DRLG Unit
SL:	NWSWNW	28	24N	13W	CLEON	MANISTEE	750 S 341 W	556 N 970 E
BHL:	NWSWNW	28	24N	13W	CLEON	MANISTEE		

Proposed Rework:      Temporarily Abandoned

Comment: ACOWS for TA expires on 3/31/2025

34752      7772      LAMBDA ENERGY RESOURCES LLC  
12012 WICKCHESTER LANE  
SUITE 300  
HOUSTON, TX 77079 USA

API Well Number: 21-079-34613-02-00

Well Name: STATE BLUE LAKE 3-23A      True Vertical Depth: 7373

Approval Date: 8/8/2024

Location	QT QT QT	Sec	Township	Range	Township Name	County	Feet From Section Line	Feet From DRLG Unit
SL:	NENWNW	23	28N	5W	BLUE LAKE	KALKASKA	550 N 1300 W	
BHL:	NWNENW	23	28N	5W	BLUE LAKE	KALKASKA	580 N 724 E	580 N 724 E

Proposed Rework:      Temporarily Abandoned

Comment: ACOWS for TA expires on 3/31/2025

Michigan Department of  
Environment, Great Lakes, and Energy  
Geologic Resources Management Division

UPDATED PERMITS  
08/12/2024 THRU 08/16/2024



Permit Number      Permittee Number      Permittee Name

34832      7772      LAMBDA ENERGY RESOURCES LLC  
12012 WICKCHESTER LANE  
SUITE 300  
HOUSTON, TX 77079 USA

API Well Number: 21-101-34774-01-00

Well Name: STATE MAPLE GROVE 4-9A      True Vertical Depth: 5122

Approval Date: 8/8/2024

Location	QT QT QT	Sec	Township	Range	Township Name	County	Feet From Section Line	Feet From DRLG Unit
SL:	NESWNW	9	23N	14W	MAPLE GROVE	MANISTEE	821 S 660 W	
BHL:	NWSWNW	9	23N	14W	MAPLE GROVE	MANISTEE	629 S 473 W	629 S 473 W

Proposed Rework:      Temporarily Abandoned

Comment: ACOWS for TA expires on 3/31/2025

34876      7772      LAMBDA ENERGY RESOURCES LLC  
12012 WICKCHESTER LANE  
SUITE 300  
HOUSTON, TX 77079 USA

API Well Number: 21-101-34876-00-00

Well Name: STATE MAPLE GROVE 2-20

Approval Date: 8/8/2024

Location	QT QT QT	Sec	Township	Range	Township Name	County	Feet From Section Line	Feet From DRLG Unit
SL:	NENWSW	20	23N	14W	MAPLE GROVE	MANISTEE	460 N 860 W	460 N 860 W
BHL:	NENWSW	20	23N	14W	MAPLE GROVE	MANISTEE		

Proposed Rework:      Temporarily Abandoned

Comment: ACOWS for TA expires on 3/31/2025

Michigan Department of  
Environment, Great Lakes, and Energy  
Geologic Resources Management Division

UPDATED PERMITS  
08/12/2024 THRU 08/16/2024



Permit Number      Permittee Number      Permittee Name

34887      7772      LAMBDA ENERGY RESOURCES LLC  
12012 WICKCHESTER LANE  
SUITE 300  
HOUSTON, TX 77079 USA

API Well Number: 21-079-34738-01-00

Well Name: STATE BLUE LAKE 1-9A      True Vertical Depth: 7159

Approval Date: 8/8/2024

Location	QT QT QT	Sec	Township	Range	Township Name	County	Feet From Section Line	Feet From DRLG Unit
SL:	NESESE	9	28N	5W	BLUE LAKE	KALKASKA	660 S 460 E	
BHL:	SESESE	9	28N	5W	BLUE LAKE	KALKASKA	293 S 347 E	293 S 347 E

Proposed Rework:      Temporarily Abandoned

Comment: ACOWS for TA expires on 3/31/2025

35181      7772      LAMBDA ENERGY RESOURCES LLC  
12012 WICKCHESTER LANE  
SUITE 300  
HOUSTON, TX 77079 USA

API Well Number: 21-055-29870-02-00

Well Name: STATE WHITEWATER 2-29A      True Vertical Depth: 6200

Approval Date: 8/8/2024

Location	QT QT QT	Sec	Township	Range	Township Name	County	Feet From Section Line	Feet From DRLG Unit
SL:	NESWSE	29	27N	9W	WHITEWATER	GRAND TRAVERSE	810 S 1115 W	
BHL:	NESWSE	29	27N	9W	WHITEWATER	GRAND TRAVERSE	840 S 1122 W	484 N 1122 W

Proposed Rework:      Temporarily Abandoned

Comment: ACOWS for TA expires on 3/31/2025

Michigan Department of  
Environment, Great Lakes, and Energy  
Geologic Resources Management Division

UPDATED PERMITS  
08/12/2024 THRU 08/16/2024



Permit Number      Permittee Number      Permittee Name

37220      7772      LAMBDA ENERGY RESOURCES LLC  
12012 WICKCHESTER LANE  
SUITE 300  
HOUSTON, TX 77079 USA

API Well Number: 21-101-37220-00-00

Well Name: SCHIMKE 6-1

Approval Date: 8/8/2024

Location	QT QT QT	Sec	Township	Range	Township Name	County	Feet From Section Line	Feet From DRLG Unit
SL:	NENWNE	1	22N	16W	MANISTEE	MANISTEE	460 N 1075 W	460 N 1075 W
BHL:	NENWNE	1	22N	16W	MANISTEE	MANISTEE		

Proposed Rework:      Temporarily Abandoned

Comment: ACOWS for TA expires on 3/31/2025

37581      7772      LAMBDA ENERGY RESOURCES LLC  
12012 WICKCHESTER LANE  
SUITE 300  
HOUSTON, TX 77079 USA

API Well Number: 21-079-37581-00-00

Well Name: BROWN 3-34

Approval Date: 8/8/2024

Location	QT QT QT	Sec	Township	Range	Township Name	County	Feet From Section Line	Feet From DRLG Unit
SL:	SESWSW	34	28N	5W	BLUE LAKE	KALKASKA	460 S 660 W	460 S 660 W
BHL:	SESWSW	34	28N	5W	BLUE LAKE	KALKASKA		

Proposed Rework:      Temporarily Abandoned

Comment: ACOWS for TA expires on 3/31/2025



Michigan Department of  
Environment, Great Lakes, and Energy  
Geologic Resources Management Division

UPDATED PERMITS  
08/12/2024 THRU 08/16/2024



Permit Number      Permittee Number      Permittee Name

38527      7772      LAMBDA ENERGY RESOURCES LLC  
12012 WICKCHESTER LANE  
SUITE 300  
HOUSTON, TX 77079 USA

API Well Number: 21-055-38452-01-00

Well Name: OTIS-STATE BLAIR 2-13A      True Vertical Depth: 5903

Approval Date: 8/8/2024

Location	QT QT QT	Sec	Township	Range	Township Name	County	Feet From Section Line	Feet From DRLG Unit
SL:	SWNWSW	13	26N	11W	BLAIR	GRAND TRAVERSE	1159 N 332 W	
BHL:	NESWSW	13	26N	11W	BLAIR	GRAND TRAVERSE	1293 S 924 W	1293 S 396 E

Proposed Rework:      Temporarily Abandoned

Comment: ACOWS for TA expires on 3/31/2025

39827      7772      LAMBDA ENERGY RESOURCES LLC  
12012 WICKCHESTER LANE  
SUITE 300  
HOUSTON, TX 77079 USA

API Well Number: 21-055-29810-01-00

Well Name: BANCROFT & BISARD 2-1 HD1      True Vertical Depth: 6309

Approval Date: 8/8/2024

Location	QT QT QT	Sec	Township	Range	Township Name	County	Feet From Section Line	Feet From DRLG Unit
SL:	NESENW	1	25N	11W	MAYFIELD	GRAND TRAVERSE	1096 S 201 E	
BHL:	NESWNE	1	25N	11W	MAYFIELD	GRAND TRAVERSE	743 S 836 W	743 S 484 E

Proposed Rework:      Temporarily Abandoned

Comment: ACOWS for TA expires on 3/31/2025

Michigan Department of  
Environment, Great Lakes, and Energy  
Geologic Resources Management Division

UPDATED PERMITS  
08/12/2024 THRU 08/16/2024



Permit Number      Permittee Number      Permittee Name

39884      7772      LAMBDA ENERGY RESOURCES LLC  
12012 WICKCHESTER LANE  
SUITE 300  
HOUSTON, TX 77079 USA

API Well Number: 21-055-32177-02-00

Well Name: PARCELLS 2-9

Approval Date: 8/8/2024

Location	QT QT QT	Sec	Township	Range	Township Name	County	Feet From Section Line	Feet From DRLG Unit
SL:	NESESW	9	25N	12W	GRANT	GRAND TRAVERSE	721 S 487 E	721 S 487 E
BHL:	NESESW	9	25N	12W	GRANT	GRAND TRAVERSE		

Proposed Rework:      Temporarily Abandoned

Comment: ACOWS for TA expires on 3/31/2025

40339      7772      LAMBDA ENERGY RESOURCES LLC  
12012 WICKCHESTER LANE  
SUITE 300  
HOUSTON, TX 77079 USA

API Well Number: 21-055-40339-00-00

Well Name: BABER ET AL 5-21

True Vertical Depth: 6067

Approval Date: 8/8/2024

Location	QT QT QT	Sec	Township	Range	Township Name	County	Feet From Section Line	Feet From DRLG Unit
SL:	SWSESW	16	26N	10W	EAST BAY	GRAND TRAVERSE	210 S 1045 E	
BHL:	NENWNW	21	26N	10W	PARADISE	GRAND TRAVERSE	66 N 981 W	1386 N 2979 E

Proposed Rework:      Temporarily Abandoned

Comment: ACOWS for TA expires on 3/31/2025

Michigan Department of  
Environment, Great Lakes, and Energy  
Geologic Resources Management Division

UPDATED PERMITS  
08/12/2024 THRU 08/16/2024



Permit Number      Permittee Number      Permittee Name

40888      7772      LAMBDA ENERGY RESOURCES LLC  
12012 WICKCHESTER LANE  
SUITE 300  
HOUSTON, TX 77079 USA

API Well Number: 21-055-40831-01-00

Well Name: FOX 7-17A

True Vertical Depth: 6511

Approval Date: 8/8/2024

Location	QT QT QT	Sec	Township	Range	Township Name	County	Feet From Section Line	Feet From DRLG Unit
SL:	SESENW	17	25N	11W	MAYFIELD	GRAND TRAVERSE	203 S 164 E	
BHL:	SWSENW	17	25N	11W	MAYFIELD	GRAND TRAVERSE	190 S 778 E	1502 S 1862 W

Proposed Rework:      Temporarily Abandoned

Comment: ACOWS for TA expires on 3/31/2025

43837      7772      LAMBDA ENERGY RESOURCES LLC  
12012 WICKCHESTER LANE  
SUITE 300  
HOUSTON, TX 77079 USA

API Well Number: 21-101-38550-01-00

Well Name: MARSHALL ENTERPRISES 6-19A

True Vertical Depth: 5187

Approval Date: 8/8/2024

Location	QT QT QT	Sec	Township	Range	Township Name	County	Feet From Section Line	Feet From DRLG Unit
SL:	NESESE	19	23N	14W	MAPLE GROVE	MANISTEE	1150 S 173 E	
BHL:	SESESE	19	23N	14W	MAPLE GROVE	MANISTEE	188 S 635 E	1119 N 635 E

Proposed Rework:      Temporarily Abandoned

Comment: ACOWS for TA expires on 3/31/2025

Michigan Department of  
Environment, Great Lakes, and Energy  
Geologic Resources Management Division

UPDATED PERMITS  
08/12/2024 THRU 08/16/2024



Permit Number      Permittee Number      Permittee Name

48863      7772      LAMBDA ENERGY RESOURCES LLC  
12012 WICKCHESTER LANE  
SUITE 300  
HOUSTON, TX 77079 USA

API Well Number: 21-055-35493-04-00

Well Name: PHOENIX PETROLEUM 6-28D      True Vertical Depth: 6585

Approval Date: 8/8/2024

Location	QT QT QT	Sec	Township	Range	Township Name	County	Feet From Section Line	Feet From DRLG Unit
SL:	NENWNW	28	25N	11W	MAYFIELD	GRAND TRAVERSE	455 N 692 W	
BHL:	SENWNW	28	25N	11W	MAYFIELD	GRAND TRAVERSE	706 N 836 W	609 S 486 E

Proposed Rework:      Temporarily Abandoned

Comment: ACOWS for TA expires on 3/31/2025

48873      7772      LAMBDA ENERGY RESOURCES LLC  
12012 WICKCHESTER LANE  
SUITE 300  
HOUSTON, TX 77079 USA

API Well Number: 21-055-48873-00-00

Well Name: PHOENIX PETROLEUM 1-21      True Vertical Depth: 6614

Approval Date: 8/8/2024

Location	QT QT QT	Sec	Township	Range	Township Name	County	Feet From Section Line	Feet From DRLG Unit
SL:	SWSESW	21	25N	11W	MAYFIELD	GRAND TRAVERSE	520 S 821 E	
BHL:	SWSESW	21	25N	11W	MAYFIELD	GRAND TRAVERSE	86 S 846 E	1240 N 474 W

Proposed Rework:      Temporarily Abandoned

Comment: ACOWS for TA expires on 3/31/2025

Michigan Department of  
Environment, Great Lakes, and Energy  
Geologic Resources Management Division

UPDATED PERMITS  
08/12/2024 THRU 08/16/2024



Permit Number      Permittee Number      Permittee Name

49460      7772      LAMBDA ENERGY RESOURCES LLC  
12012 WICKCHESTER LANE  
SUITE 300  
HOUSTON, TX 77079 USA

API Well Number: 21-079-29263-02-00

Well Name: STATE KALKASKA "G" 1-26B      True Vertical Depth: 6967

Approval Date: 8/8/2024

Location	QT QT QT	Sec	Township	Range	Township Name	County	Feet From Section Line	Feet From DRLG Unit
SL:	SWSWNE	26	27N	8W	KALKASKA	KALKASKA	460 S 460 W	
BHL:	NESWNE	26	27N	8W	KALKASKA	KALKASKA	1034 S 1163 W	1600 N 1471 E

Proposed Rework:      Temporarily Abandoned

Comment: ACOWS for TA expires on 3/31/2025

50932      7772      LAMBDA ENERGY RESOURCES LLC  
12012 WICKCHESTER LANE  
SUITE 300  
HOUSTON, TX 77079 USA

API Well Number: 21-079-32926-04-00

Well Name: STATE KALKASKA 3-26 HD1      True Vertical Depth: 6698

Approval Date: 8/8/2024

Location	QT QT QT	Sec	Township	Range	Township Name	County	Feet From Section Line	Feet From DRLG Unit
SL:	SENWSW	26	27N	8W	KALKASKA	KALKASKA	1200 N 858 W	
BHL:	NESWSW	26	27N	8W	KALKASKA	KALKASKA	1310 S 799 W	1310 S 521 E

Proposed Rework:      Temporarily Abandoned

Comment: ACOWS for TA expires on 3/31/2025

Michigan Department of  
Environment, Great Lakes, and Energy  
Geologic Resources Management Division

UPDATED PERMITS  
08/12/2024 THRU 08/16/2024



Permit Number      Permittee Number      Permittee Name

51186      7772      LAMBDA ENERGY RESOURCES LLC  
12012 WICKCHESTER LANE  
SUITE 300  
HOUSTON, TX 77079 USA

API Well Number: 21-055-44377-02-00

Well Name: MCMANUS 8-7 HD-1      True Vertical Depth: 5646

Approval Date: 8/8/2024

Location	QT QT QT	Sec	Township	Range	Township Name	County	Feet From Section Line	Feet From DRLG Unit
SL:	SESENW	7	26N	10W	EAST BAY	GRAND TRAVERSE	461 S 461 E	
BHL:	SWNESW	7	26N	10W	EAST BAY	GRAND TRAVERSE	854 N 890 E	464 S 890 E

Proposed Rework:      Temporarily Abandoned

Comment: ACOWS for TA expires on 3/31/2025

51363      7772      LAMBDA ENERGY RESOURCES LLC  
12012 WICKCHESTER LANE  
SUITE 300  
HOUSTON, TX 77079 USA

API Well Number: 21-039-51363-01-00

Well Name: STATE FREDERIC & WOOD 1-2 HD-1      True Vertical Depth: 6772

Approval Date: 8/8/2024

Location	QT QT QT	Sec	Township	Range	Township Name	County	Feet From Section Line	Feet From DRLG Unit
SL:	NWNWSE	2	28N	4W	FREDERIC	CRAWFORD	2006 S 2513 E	
BHL:	NENWSE	2	28N	4W	FREDERIC	CRAWFORD	482 N 876 W	482 N 444 E

Proposed Rework:      Temporarily Abandoned

Comment: ACOWS for TA expires on 3/31/2025

Michigan Department of  
Environment, Great Lakes, and Energy  
Geologic Resources Management Division

UPDATED PERMITS  
08/12/2024 THRU 08/16/2024



Permit Number      Permittee Number      Permittee Name

51701      7772      LAMBDA ENERGY RESOURCES LLC  
12012 WICKCHESTER LANE  
SUITE 300  
HOUSTON, TX 77079 USA

API Well Number: 21-055-30595-02-00

Well Name: EDWARDS 1-22A HD-1      True Vertical Depth: 6161

Approval Date: 8/8/2024

Location	QT QT QT	Sec	Township	Range	Township Name	County	Feet From Section Line	Feet From DRLG Unit
SL:	SENWSE	22	26N	10W	PARADISE	GRAND TRAVERSE	1417 S 1776 E	
BHL:	NWSWSE	22	26N	10W	PARADISE	GRAND TRAVERSE	723 S 2116 E	723 S 520 W

Proposed Rework:      Temporarily Abandoned

Comment: ACOWS for TA expires on 3/31/2025

53868      7772      LAMBDA ENERGY RESOURCES LLC  
12012 WICKCHESTER LANE  
SUITE 300  
HOUSTON, TX 77079 USA

API Well Number: 21-079-53725-02-00

Well Name: BROWN 4-34B      True Vertical Depth: 7485

Approval Date: 8/8/2024

Location	QT QT QT	Sec	Township	Range	Township Name	County	Feet From Section Line	Feet From DRLG Unit
SL:	NENWSW	34	28N	5W	BLUE LAKE	KALKASKA	2048 S 800 W	
BHL:	SWNESW	34	28N	5W	BLUE LAKE	KALKASKA	1672 S 1360 W	972 N 1283 E

Proposed Rework:      Temporarily Abandoned

Comment: ACOWS for TA expires on 3/31/2025

Michigan Department of  
Environment, Great Lakes, and Energy  
Geologic Resources Management Division

UPDATED PERMITS  
08/12/2024 THRU 08/16/2024



Permit Number      Permittee Number      Permittee Name

54762      7772      LAMBDA ENERGY RESOURCES LLC  
12012 WICKCHESTER LANE  
SUITE 300  
HOUSTON, TX 77079 USA

API Well Number: 21-039-54762-01-00

Well Name: SALLING HANSON 3-1 HD1      True Vertical Depth: 6664

Approval Date: 8/8/2024

Location	QT QT QT	Sec	Township	Range	Township Name	County	Feet From Section Line	Feet From DRLG Unit
SL:	NESENE	1	28N	4W	FREDERIC	CRAWFORD	1725 N 620 E	
BHL:	NENESE	1	28N	4W	FREDERIC	CRAWFORD	2222 S 536 E	896 S 536 E

Proposed Rework:      Temporarily Abandoned

Comment: ACOWS for TA expires on 3/31/2025

58615      7772      LAMBDA ENERGY RESOURCES LLC  
12012 WICKCHESTER LANE  
SUITE 300  
HOUSTON, TX 77079 USA

API Well Number: 21-079-58615-01-00

Well Name: STATE BLUE LAKE 11-19 HD-1      True Vertical Depth: 7010

Approval Date: 8/8/2024

Location	QT QT QT	Sec	Township	Range	Township Name	County	Feet From Section Line	Feet From DRLG Unit
SL:	SWSENE	19	28N	5W	BLUE LAKE	KALKASKA	2606 N 1087 E	
BHL:	SESENE	19	28N	5W	BLUE LAKE	KALKASKA	2636 N 380 E	1283 N 380 E

Proposed Rework:      Temporarily Abandoned

Comment: ACOWS for TA expires 3/31/2025



Michigan Department of  
Environment, Great Lakes, and Energy  
Geologic Resources Management Division

UPDATED PERMITS  
08/12/2024 THRU 08/16/2024



Permit Number      Permittee Number      Permittee Name

60270      7772      LAMBDA ENERGY RESOURCES LLC  
12012 WICKCHESTER LANE  
SUITE 300  
HOUSTON, TX 77079 USA

API Well Number: 21-079-59961-03-00

Well Name: STATE KALKASKA 1-19A      True Vertical Depth: 6627

Approval Date: 8/8/2024

Location	QT QT QT	Sec	Township	Range	Township Name	County	Feet From Section Line	Feet From DRLG Unit
SL:	SENESE	19	27N	7W	KALKASKA	KALKASKA	1907 S 457 E	
BHL:	NENESE	19	27N	7W	KALKASKA	KALKASKA	2233 S 482 E	937 S 841 W

Proposed Rework:      Temporarily Abandoned

Comment:      ACOWS for TA expires on 3/31/2025



Michigan Department of  
Environment, Great Lakes, and Energy  
Geologic Resources Management Division

UPDATED PERMITS  
08/12/2024 THRU 08/16/2024



Permit Number      Permittee Number      Permittee Name

**MISCELLANEOUS:**

34084                      7772                      LAMBDA ENERGY RESOURCES LLC  
12012 WICKCHESTER LANE  
SUITE 300  
HOUSTON, TX 77079 USA

API Well Number: 21-019-34084-03-00

Well Name: STATE COLFAX 2-25 HD3

Miscellaneous Action Date: 8/12/2024

Location	QT QT QT	Sec	Township	Range	Township Name	County	Feet From Section Line	Feet From DRLG Unit
SL:	SENWSW	25	25N	13W	COLFAX	BENZIE	1955 S 849 W	
BHL:	NWNWSW	25	25N	13W	COLFAX	BENZIE	2430 S 26 W	1488 N 2620 E

Comment: Create API for this LDH approved through ACOWS dated 8/2/24.

37303                      7772                      LAMBDA ENERGY RESOURCES LLC  
12012 WICKCHESTER LANE  
SUITE 300  
HOUSTON, TX 77079 USA

API Well Number: 21-019-37303-02-00

Well Name: WALTER 2-26 HD2

Miscellaneous Action Date: 8/12/2024

Location	QT QT QT	Sec	Township	Range	Township Name	County	Feet From Section Line	Feet From DRLG Unit
SL:	SENESE	26	25N	13W	COLFAX	BENZIE	1854 S 574 E	
BHL:	NWNWSW	25	25N	13W	COLFAX	BENZIE	2138 S 131 W	1780 N 2516 E

Comment: Create API for this LDH approved through ACOWS dated 8/2/24.