

Michigan Department of
Environment, Great Lakes, and Energy
Oil, Gas and Minerals Division
PERMIT APPLICATIONS
8/18/2019 THRU 8/24/2019



Application Number Date Received Permittee Number Permittee Name Page 1

406 08/20/2019 104 WEST BAY EXPLORATION COMPANY
13685 S WEST BAYSHORE DR
TRAVERSE CITY, MI49684

Prev Permit: 61417

Well Name: Clare Northern 1-23 A Surface Owner: Clare Northern Group LLC

Well Type: OIL True Vertical Depth: 3848

Permit Type: Drill Target Formation: DUNDEE

H2S Present? Yes Deepest Formation: DUNDEE

Location:	QT QT QT	Sec	Township	Range	Township Name	County	Feet From Section Line	Feet From DRLG Unit Line
SL:	SENE SW	23	17N	4W	GRANT	CLARE	1462 S 2006 W	
BHL:	SESW NW	23	17N	4W	GRANT	CLARE	2400 N 900 W	1078 N 421 E

408 08/20/2019 40 MUSKEGON DEVELOPMENT COMPANY
1425 S MISSION RD
MOUNT PLEASANT, MI 48858

Prev Permit:

Well Name: State Foster RCU 3-28 Surface Owner: State of Michigan

Well Type: OIL True Vertical Depth: 4650

Permit Type: Drill Target Formation: RICHFIELD

H2S Present? Yes Deepest Formation: SYLVANIA

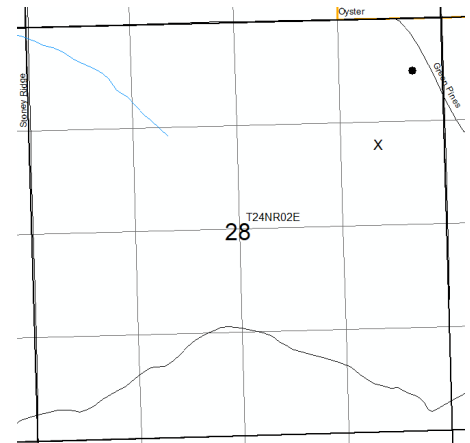

Rose City Unit, Order 197-6

Location:	QT QT QT	Sec	Township	Range	Township Name	County	Feet From Section Line	Feet From DRLG Unit Line
SL:	NWSE NE	28	24N	2E	FOSTER	OGEMAW	1691 N 905 E	
BHL:	SENE NE	28	24N	2E	FOSTER	OGEMAW	723 N 370 E	593 S 370 E

Michigan Department of
Environment, Great Lakes, and Energy
Oil, Gas and Minerals Division
PERMIT APPLICATIONS
8/18/2019 THRU 8/24/2019



409 08/20/2019 40 MUSKEGON DEVELOPMENT COMPANY

1425 S MISSION RD
MOUNT PLEASANT, MI 48858

Prev Permit:
Well Name: State Foster RCU 2-28 Surface Owner: State of Michigan
Well Type: OIL True Vertical Depth: 4586
Permit Type: Drill Target Formation: RICHFIELD
H2S Present? Yes Deepest Formation: SYLVANIA

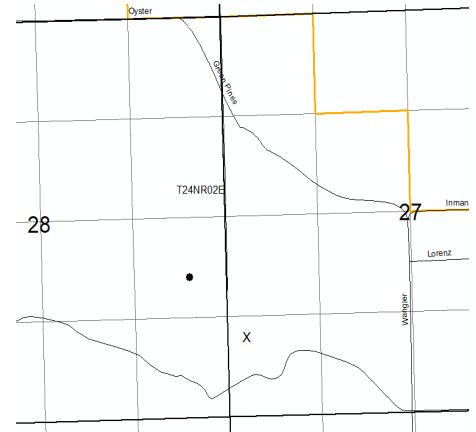

Rose City Unit, Order 197-6

Location:	QT QT QT	Sec	Township	Range	Township Name	County	Feet From Section Line	Feet From DRLG Unit Line
SL:	NWSWSW	27	24N	2E	ROSE	OGEMAW	1003 S 239 W	
BHL:	SENESE	28	24N	2E	FOSTER	OGEMAW	1796 S 547 W	486 S 547 E

410 08/21/2019 40 MUSKEGON DEVELOPMENT COMPANY

1425 S MISSION RD
MOUNT PLEASANT, MI 48858

Prev Permit:
Well Name: State Rose RCU 2-27 Surface Owner: State of Michigan
Well Type: OIL True Vertical Depth: 4595
Permit Type: Drill Target Formation: RICHFIELD
H2S Present? Yes Deepest Formation: SYLVANIA

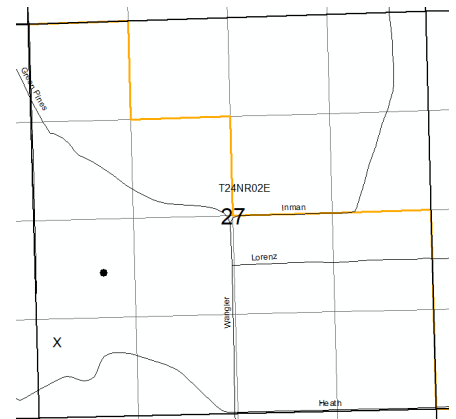

Rose City Unit, Order 197-6

Location:	QT QT QT	Sec	Township	Range	Township Name	County	Feet From Section Line	Feet From DRLG Unit Line
SL:	NWSWSW	27	24N	2E	ROSE	OGEMAW	1012 S 257 W	
BHL:	SENWSW	27	24N	2E	ROSE	OGEMAW	1928 S 898 W	619 S 392 E

Michigan Department of
 Environment, Great Lakes, and Energy
 Oil, Gas and Minerals Division
 PERMIT APPLICATIONS
 8/18/2019 THRU 8/24/2019



Application Number Date Received Permittee Number Permittee Name Page 3

411 08/22/2019 5320 SAVOY ENERGY LP
 920 HASTINGS STREET, SUITE A
 PO BOX 1560
 TRAVERSE CITY, MI49685-1560

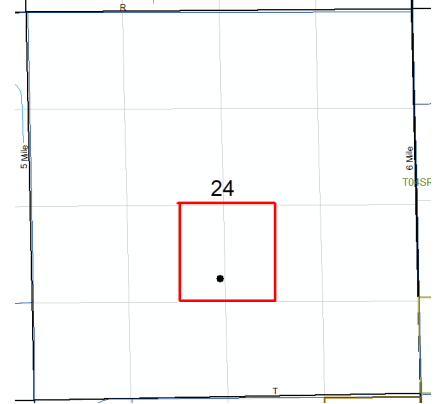

Prev Permit:

Well Name: Renshaw 1-24

Surface Owner: Renshaw, Steven D.

Well Type: OIL

True Vertical Depth: 4000

Permit Type: Drill

Target Formation: TRENTON-BLACK RIVER

H2S Present? No

Deepest Formation: PRAIRIE DU CHIEN

40-Acre drilling unit, E/2 NE/4 SW/4, W/2 NW/4 SE/4 Section 24

Location:	QT QT QT	Sec	Township	Range	Township Name	County	Feet From Section Line	Feet From DRLG Unit Line
SL:	SENE SW	24	4S	8W	ATHENS	CALHOUN	1647 S 2587 W	
BHL:	SENE SW	24	4S	8W	ATHENS	CALHOUN	1647 S 2587 W	331 S 600 W

Michigan Department of
Environment, Great Lakes, and Energy
Oil, Gas and Minerals Division
PERMIT LIST
8/18/2019 THRU 8/24/2019



Permit Number Issue Date Permittee Number Permittee Name Page 1

61434 8/19/2019 6418 W B OSBORN OIL AND GAS
OPERATIONS LTD
1250 NORTH EAST LOOP 410
SUITE 600
SAN ANTONIO, TX 78209

API Well No: 21-107-62003-00-00

Prev Permit:

Well Name: MCNEILLY-SANGER 1-17 Surface Owner: River Ridge Farms, Inc.
Well Type: Oil Well True Vertical Depth: 4000FT
Permit Type: Drill Target Formation: DUNDEE
H2S Present? Yes Deepest Formation: DUNDEE

Location:	QT QT QT	Sec	Township	Range	Township Name	County	Feet From Section Line	Feet From DRLG Unit Line
SL:	NWSESW	17	16N	7W	FORK	MECOSTA	990 S 1650 W	
BHL:	NWSESW	17	16N	7W	FORK	MECOSTA	990 S 1650 W	330 N 330 W

61435 8/22/2019 6040 NU ENERGY OPERATING INC.

P O BOX 1122

GAYLORD, MI 49735

API Well No: 21-025-62012-00-00

Prev Permit:

Well Name: BENNETT D2-34 Surface Owner: Larry & Leon Bennett.
Well Type: Oil Well True Vertical Depth: 4900FT
Permit Type: Drill Target Formation: TRENTON
H2S Present? No Deepest Formation: BLACK RIVER

Location:	QT QT QT	Sec	Township	Range	Township Name	County	Feet From Section Line	Feet From DRLG Unit Line
SL:	NESESW	34	1S	5W	LEE	CALHOUN	772 S 2497 W	
BHL:	NESESW	34	1S	5W	LEE	CALHOUN	771 S 2318 W	557 N 331 E

Michigan Department of Environment, Great
Lakes, and Energy

Oil, Gas and Minerals Division

Updated Permits

8/18/2019 THRU 8/24/2019



Permit Number Permittee Number Permittee Name

BOTTOM HOLE LOCATION CORRECTIONS:

29791 7772 LAMBDA ENERGY RESOURCES LLC
12012 Wickchester
Suite 300
Houston, TX 77055 USA

API Well Number: 21-055-29791-02-00

Well Name: WOLF & OLSZEWSKI 2-17 HD2

Correction Date: 8/22/2019

Location	QT QT QT	Sec	Township	Range	Township Name	County	Feet From Section Line	Feet From DRLG Unit
SL:		17	25N	11W	MAYFIELD	GRAND TRAVERSE	1786 N 2516 E	
BHL:	SEWNNE	17	25N	11W	MAYFIELD	GRAND TRAVERSE	1116 N 1770 E	1116 N 457 E

