

Michigan Department of  
Environment, Great Lakes, and Energy  
Oil, Gas and Minerals Division

PERMIT LIST

8/25/2019 THRU 8/31/2019



Permit Number      Issue Date      Permittee Number      Permittee Name      Page 1

61436      8/26/2019      6418      W B OSBORN OIL AND GAS  
OPERATIONS LTD  
P O BOX 8C  
  
SAN ANTONIO, TX 78217

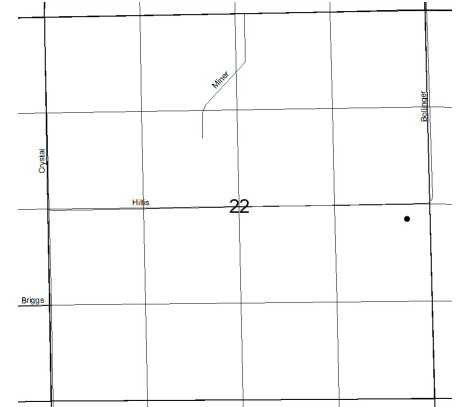

API Well No: 21-117-62009-00-00

Prev Permit:

Well Name: WB OSBORN 1-22 SWD

Surface Owner: W.B. Osborn Oil & Gas Operations

Well Type: Brine Disposal Well

True Vertical Depth: 3500FT

Permit Type: Drill

Target Formation: DUNDEE

H2S Present? Yes

Deepest Formation: DUNDEE

Location:	QT QT QT	Sec	Township	Range	Township Name	County	Feet From Section Line	Feet From DRLG Unit Line
SL:	NENESE	22	11N	5W	FERRIS	MONTCALM	2426 S 314 E	
BHL:	NENENE	22	11N	5W	FERRIS	MONTCALM	2426 S 314 E	

61437      8/27/2019      5312      PAXTON RESOURCES LLC  
  
132 N OTSEGO AVE  
GAYLORD, MI 49735

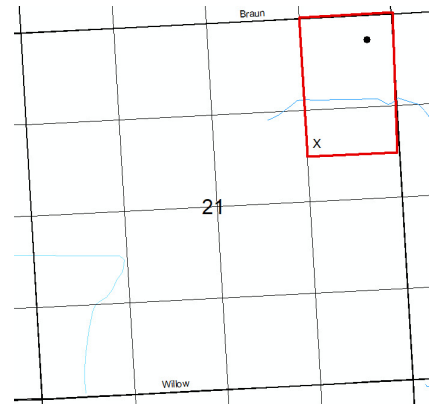

API Well No: 21-161-62003-00-00

Prev Permit:

Surface Owner: Timothy Dwyer, et ux

Well Name: DWYER B4-21 HD1

True Vertical Depth: 3135FT

Well Type: Oil Well

Target Formation: TRENTON-BLACK RIVER

Permit Type: Drill

Deepest Formation: TRENTON-BLACK RIVER

H2S Present? No

Location:	QT QT QT	Sec	Township	Range	Township Name	County	Feet From Section Line	Feet From DRLG Unit Line
SL:	NWSENE	21	4S	5E	SALINE	WASHTENAW	1828 N 1210 E	
BHL:	NENENE	21	4S	5E	SALINE	WASHTENAW	362 N 355 E	362 N 355 E

Michigan Department of  
Environment, Great Lakes, and Energy  
Oil, Gas and Minerals Division

PERMIT LIST

8/25/2019 THRU 8/31/2019



Permit Number      Issue Date      Permittee Number      Permittee Name      Page 2

61439      8/29/2019      4429      WARD M HAGGARD OIL AND GAS  
EXPLORATION INC  
  
PO BOX 56248  
HOUSTON, TX 77256-6248

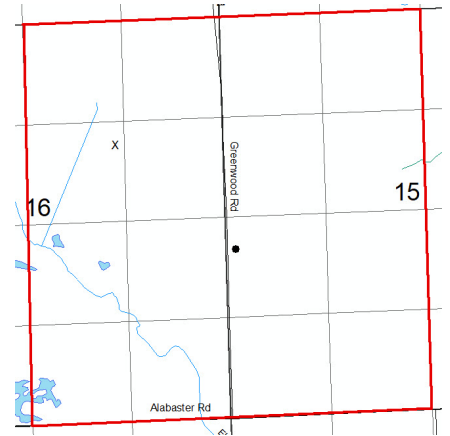

API Well No: 21-069-42424-02-00

Prev Permit: 42424, 61105

Well Name: STATE SHERMAN 1-16A

Surface Owner: National Gypsum  
Company

Well Type: Oil Well

True Vertical Depth: 11000FT

Permit Type: Deepen

Target Formation: GLENWOOD

H2S Present? No

Deepest Formation: PRAIRIE DU  
CHIEN

Location:	QT QT QT	Sec	Township	Range	Township Name	County	Feet From Section Line	Feet From DRLG Unit Line
SL:	NESWNE	16	21N	6E	SHERMAN	IOSCO	1633 N 1469 E	
BHL:	NWNWSW	15	21N	6E	SHERMAN	IOSCO	2135 S 69 W	2135 S 2569 E

61440      8/30/2019      5320

SAVOY ENERGY LP  
920 HASTINGS STREET, SUITE A  
PO BOX 1560  
TRAVERSE CITY, MI49685-1560

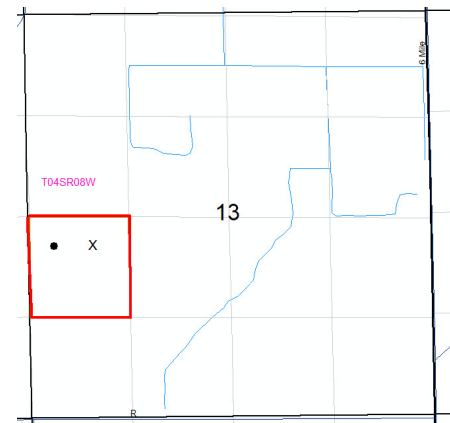

API Well No: 21-025-62013-00-00

Prev Permit:

Surface Owner: Bottomley, Susan D.

Well Name: BOTTOMLEY 1-13

True Vertical Depth: 4000FT

Well Type: Oil Well

Target Formation: TRENTON-BLACK  
RIVER

Permit Type: Drill

Deepest Formation: PRAIRIE DU  
CHIEN

H2S Present? No

Location:	QT QT QT	Sec	Township	Range	Township Name	County	Feet From Section Line	Feet From DRLG Unit Line
SL:	NWNWSW	13	4S	8W	ATHENS	CALHOUN	2276 S 110 W	
BHL:	NWNWSW	13	4S	8W	ATHENS	CALHOUN	2276 S 110 W	375 N 550 E

Michigan Department of Environment,  
Great Lakes, and Energy  
Oil, Gas and Minerals Division  
Updated Permits  
8/25/2019 THRU 8/31/2019



Permit Number      Permittee Number      Permittee Name

**RECORD OF WELL PLUGGING:**

24195      5951      PAN GAS STORAGE LLC DBA  
SOUTHWEST GAS  
  
1300 MAIN STREET  
HOUSTON, TX 77002

API Well Number: 21-093-24195-00-00

Well Name: DENKHAUS, NORMAN ET UX ET  
AL 1-2

Plugging Date: 7/17/2019

Location	QT QT QT	Sec	Township	Range	Township Name	County	Feet From Section Line	Feet From DRLG Unit
SL:	NESENE	2	2N	4E	MARION	LIVINGSTON	1240 S 220 E	120 S 40 E

26094      5951      PAN GAS STORAGE LLC DBA  
SOUTHWEST GAS  
  
1300 MAIN STREET  
HOUSTON, TX 77002

API Well Number: 21-093-26094-00-00

Well Name: LOUNSBERY 2-7

Plugging Date: 5/20/2019

Location	QT QT QT	Sec	Township	Range	Township Name	County	Feet From Section Line	Feet From DRLG Unit
SL:	SWSESE	7	2N	5E	GENOA	LIVINGSTON	400 S 980 E	400 S 980 E

Michigan Department of Environment,  
Great Lakes, and Energy  
Oil, Gas and Minerals Division  
Updated Permits  
8/25/2019 THRU 8/31/2019  
**EGL**

Permit Number      Permittee Number      Permittee Name

26103      5951      PAN GAS STORAGE LLC DBA  
SOUTHWEST GAS  
  
1300 MAIN STREET  
HOUSTON, TX 77002

API Well Number: 21-093-26103-00-00

Well Name: HAINE 1-8

Plugging Date: 6/4/2019

Location	QT QT QT	Sec	Township	Range	Township Name	County	Feet From Section Line	Feet From DRLG Unit
SL:	S2SESW	8	2N	5E	GENOA	LIVINGSTON	50 S 994 E	50 S 309 W

26104      5951      PAN GAS STORAGE LLC DBA  
SOUTHWEST GAS  
  
1300 MAIN STREET  
HOUSTON, TX 77002

API Well Number: 21-093-26104-00-00

Well Name: KUHNS 1-5

Plugging Date: 7/16/2019

Location	QT QT QT	Sec	Township	Range	Township Name	County	Feet From Section Line	Feet From DRLG Unit
SL:	CNSWSW	5	2N	5E	GENOA	LIVINGSTON	532 S 695 W	532 S 695 W

Michigan Department of Environment,

Great Lakes, and Energy

Oil, Gas and Minerals Division

Updated Permits

8/25/2019 THRU 8/31/2019



Permit Number      Permittee Number      Permittee Name

26105      5951      PAN GAS STORAGE LLC DBA  
SOUTHWEST GAS

1300 MAIN STREET  
HOUSTON, TX 77002

API Well Number: 21-093-26105-00-00

Well Name: KUHNS 2-8

Plugging Date: 7/16/2019

Location	QT QT QT	Sec	Township	Range	Township Name	County	Feet From Section Line	Feet From DRLG Unit
SL:	SENWNW	8	2N	5E	GENOA	LIVINGSTON	960 N 964 W	960 N 964 W

26106      5951      PAN GAS STORAGE LLC DBA  
SOUTHWEST GAS

1300 MAIN STREET  
HOUSTON, TX 77002

API Well Number: 21-093-26106-00-00

Well Name: LOUNSBERRY 1-18

Plugging Date: 7/16/2019

Location	QT QT QT	Sec	Township	Range	Township Name	County	Feet From Section Line	Feet From DRLG Unit
SL:	NENENE	18	2N	5E	GENOA	LIVINGSTON	10 N 130 E	590 N 70 W

Michigan Department of Environment,  
Great Lakes, and Energy  
Oil, Gas and Minerals Division  
Updated Permits  
8/25/2019 THRU 8/31/2019  
**EGL**

Permit Number      Permittee Number      Permittee Name

26107      5951      PAN GAS STORAGE LLC DBA  
SOUTHWEST GAS  
  
1300 MAIN STREET  
HOUSTON, TX 77002

API Well Number: 21-093-26107-00-00

Well Name: LOUNSBERY 1-7

Plugging Date: 5/20/2019

Location	QT QT QT	Sec	Township	Range	Township Name	County	Feet From Section Line	Feet From DRLG Unit
SL:	W2SWSE	7	2N	5E	GENOA	LIVINGSTON	734 S 440 W	734 S 440 W

26116      5951      PAN GAS STORAGE LLC DBA  
SOUTHWEST GAS  
  
1300 MAIN STREET  
HOUSTON, TX 77002

API Well Number: 21-093-26116-00-00

Well Name: MERRELL 1-2

Plugging Date: 6/4/2019

Location	QT QT QT	Sec	Township	Range	Township Name	County	Feet From Section Line	Feet From DRLG Unit
SL:	NWNENW	2	2N	4E	MARION	LIVINGSTON	123 N 1115 E	123 N 1115 E

Michigan Department of Environment,

Great Lakes, and Energy

Oil, Gas and Minerals Division

Updated Permits

8/25/2019 THRU 8/31/2019



Permit Number      Permittee Number      Permittee Name

26774      5951      PAN GAS STORAGE LLC DBA  
SOUTHWEST GAS

1300 MAIN STREET  
HOUSTON, TX 77002

API Well Number: 21-093-26774-00-00

Well Name: RICHARDS, PHANETTE E 2-6

Plugging Date: 6/4/2019

Location	QT QT QT	Sec	Township	Range	Township Name	County	Feet From Section Line	Feet From DRLG Unit
SL:	NEESE	6	2N	5E	GENOA	LIVINGSTON	1100 S 75 E	1100 S 75 E

58155      5095      OMIMEX ENERGY INC

7950 JOHN T. WHITE ROAD  
FT WORTH, TX 76120

API Well Number: 21-105-58155-00-00

Well Name: RUBA 5-20

Plugging Date: 4/15/2019

Location	QT QT QT	Sec	Township	Range	Township Name	County	Feet From Section Line	Feet From DRLG Unit
SL:	SESWNE	20	19N	17W	VICTORY	MASON	2119 N 1821 E	495 S 495 E

Michigan Department of Environment,  
Great Lakes, and Energy  
Oil, Gas and Minerals Division  
Updated Permits  
8/25/2019 THRU 8/31/2019



Permit Number      Permittee Number      Permittee Name

41393      5095      OMIMEX ENERGY INC  
7950 JOHN T. WHITE ROAD  
FT WORTH, TX 76120

API Well Number: 21-127-41319-01-00

Well Name: DYKSTRA 1-8A

Plugging Date: 4/26/2019

Location	QT QT QT	Sec	Township	Range	Township Name	County	Feet From Section Line	Feet From DRLG Unit
SL:	NESESW	8	13N	17W	GRANT	OCEANA	758 S 464 E	
BHL:	SESWSW	8	13N	17W	GRANT	OCEANA	427 S 965 W	427 S 965 W

56957      5095      OMIMEX ENERGY INC  
7950 JOHN T. WHITE ROAD  
FT WORTH, TX 76120

API Well Number: 21-127-56957-00-00

Well Name: NEUMAN 4-27

Plugging Date: 5/3/2019

Location	QT QT QT	Sec	Township	Range	Township Name	County	Feet From Section Line	Feet From DRLG Unit
SL:	NWNWNW	27	14N	18W	BENONA	OCEANA	650 N 600 W	650 N 600 W



Permit Number      Permittee Number      Permittee Name

**APPLICATIONS TO CHANGE WELL STATUS:**

58431      7739      LAYLINE OIL AND GAS LLC  
820 GESSNER ROAD, SUITE 1145  
  
HOUSTON, TX 77024 USA

API Well Number: 21-035-58431-00-00  
  
Well Name: A BLEVINS TRUST ET AL 3-11  
  
Approval Date: 8/20/2019

Location	QT QT QT	Sec	Township	Range	Township Name	County	Feet From Section Line	Feet From DRLG Unit
SL:	SWNE	11	20N	6W	WINTERFIELD	CLARE	1240 N 870 E	1432 S 1743 W

Proposed Rework: ACOWS to Plugback      Comment: ACOWS to Plugback, Reperf, and Stimulate Expires on 8/20/2020

36115      4750      WESTERN RESERVES OIL CO INC  
AND SULLIVAN AND CO  
  
PO BOX 993  
MIDLAND, TX 77002

API Well Number: 21-079-36115-00-00  
  
Well Name: STATE BLUE LAKE 1-4  
  
Approval Date: 8/15/2019

Location	QT QT QT	Sec	Township	Range	Township Name	County	Feet From Section Line	Feet From DRLG Unit
SL:	NESENW	4	28N	5W	BLUE LAKE	KALKASKA	749 S 540 E	598 N 752 W

Proposed Rework: ACOWS to Plugback      Comment: ACOWS to plug back for new lateral kickoff expires on 8/15/2020