

HOW MOST FIRE EXTINGUISHERS WORK

3. Squeeze

Squeeze or press the handle.

1. Pull

Pull the pin or release other locking devices.

2. Aim

Aim the extinguisher nozzle (horn or hose) at the base of the fire.

4. Sweep

Sweep from side to side at the base of the fire. Watch for re-flash. Discharge the contents of the extinguisher. Foam and water extinguishers require slightly different action. Read the instructions.

Remember:

- If there's a fire, call the fire department first.
- Get everyone outside.
- Then fight a small fire only.
- If the fire gets too large, get away from the area.
- Close doors to slow the fire's spread.

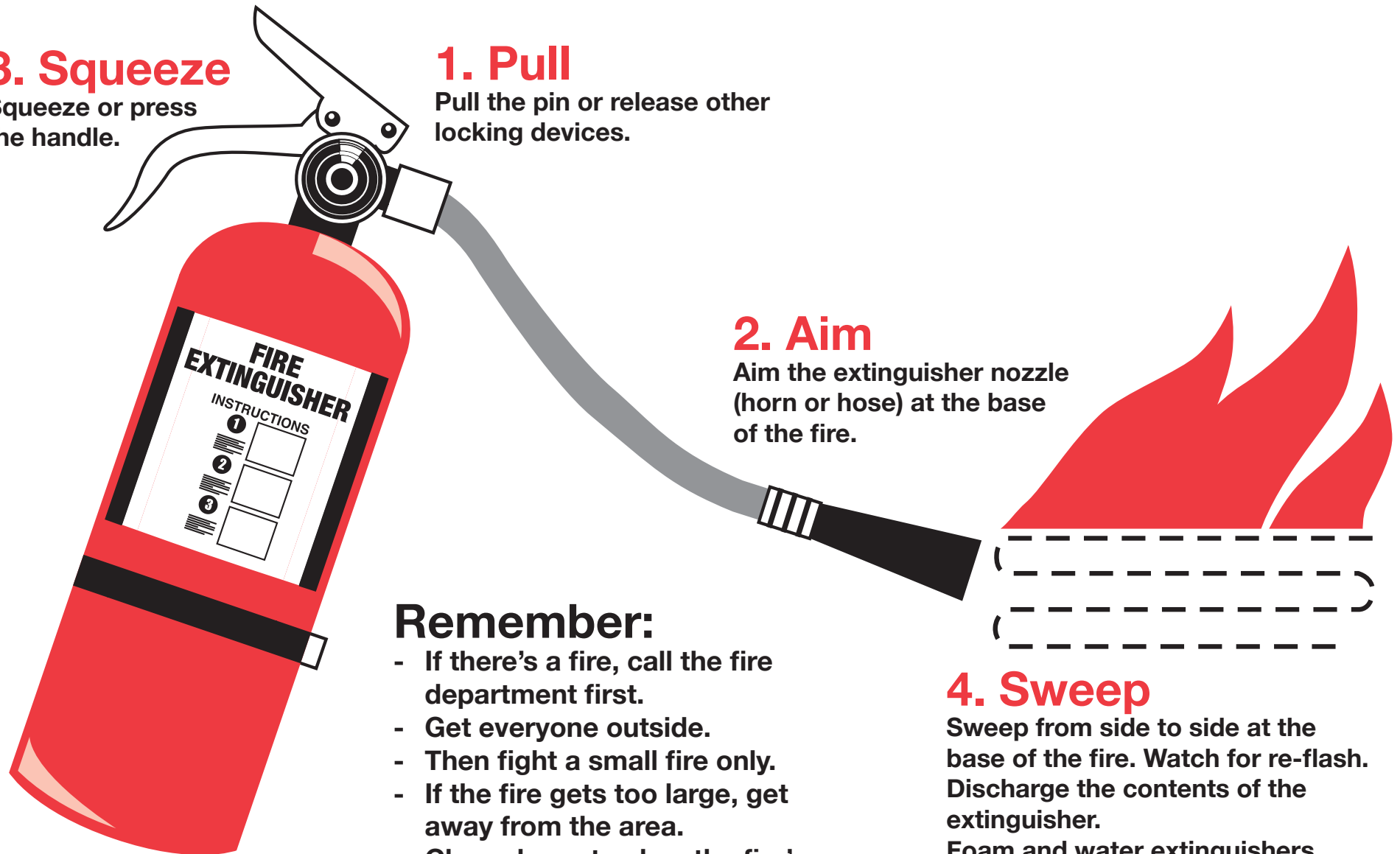

MICHIGAN DEPARTMENT OF
LABOR & ECONOMIC
OPPORTUNITY

A SAFETY MESSAGE FROM
MIOSHA Consultation Education and Training Division
and the National Fire Protection Association
Paid in part with federal OSHA funds.

The Michigan Department of Labor and Economic Opportunity is an equal opportunity employer/program.



MIOSHA/CET #0304 (Rev. 1/24)