

Figure 1 - Area Base Map, Wurtsmith Air Force Base, Oscoda, Michigan
 (Figure Adapted from Air Force 1993)

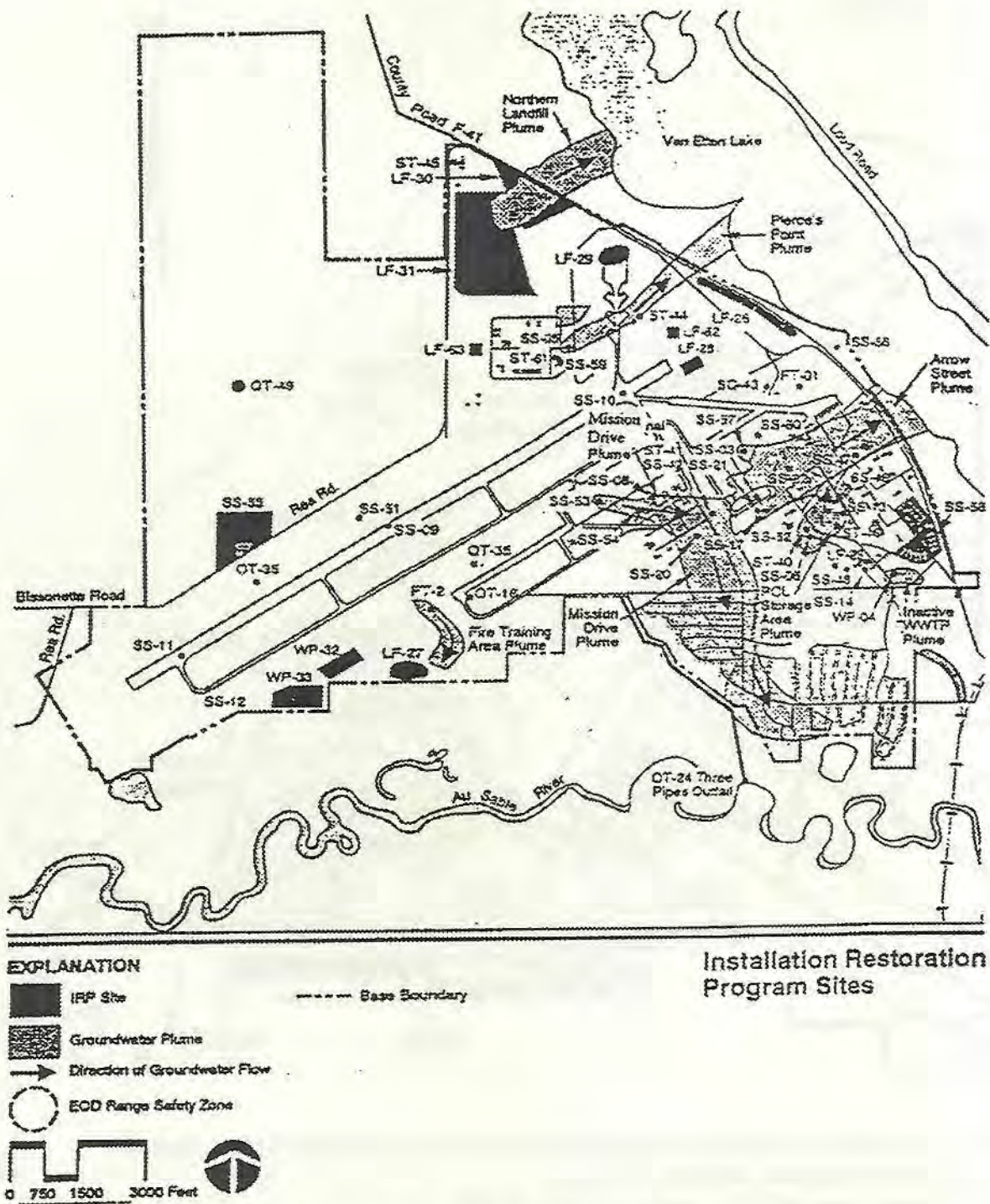

Figure 2 - IRP Sites Wurtsmith Air Force Base, Oscoda, Michigan
 Figure adapted from Air Force 1993

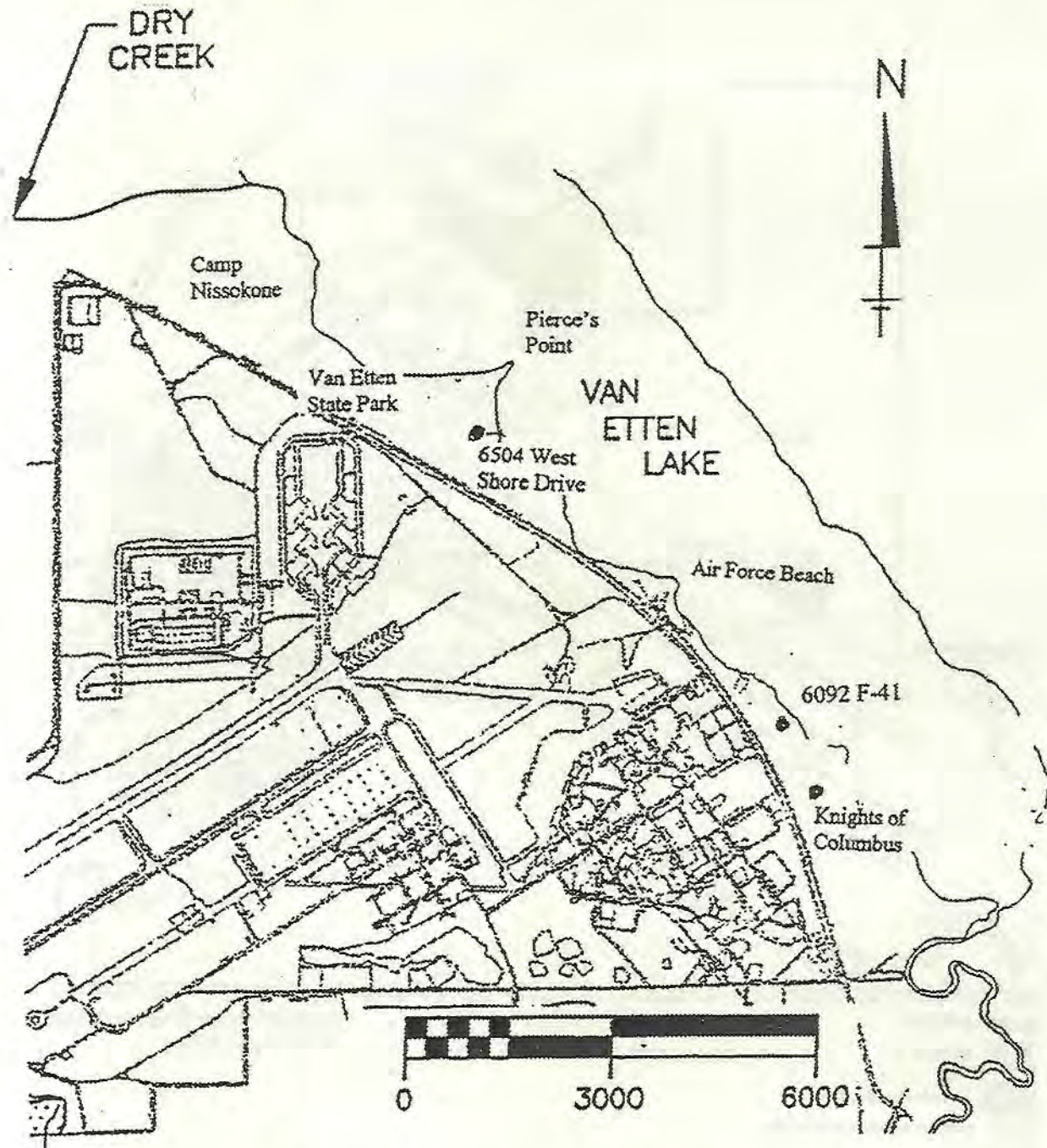

Figure 3 - Locations of Off-base Properties Situated Along Van Etten Lake's Shoreline, Wurtsmith Air Force Base, Oscoda, Michigan
 Figure adapted from AFBCA, 1999j; AFCEE, 1996b)
 Note: Locations depicted for off-base properties are approximate.)

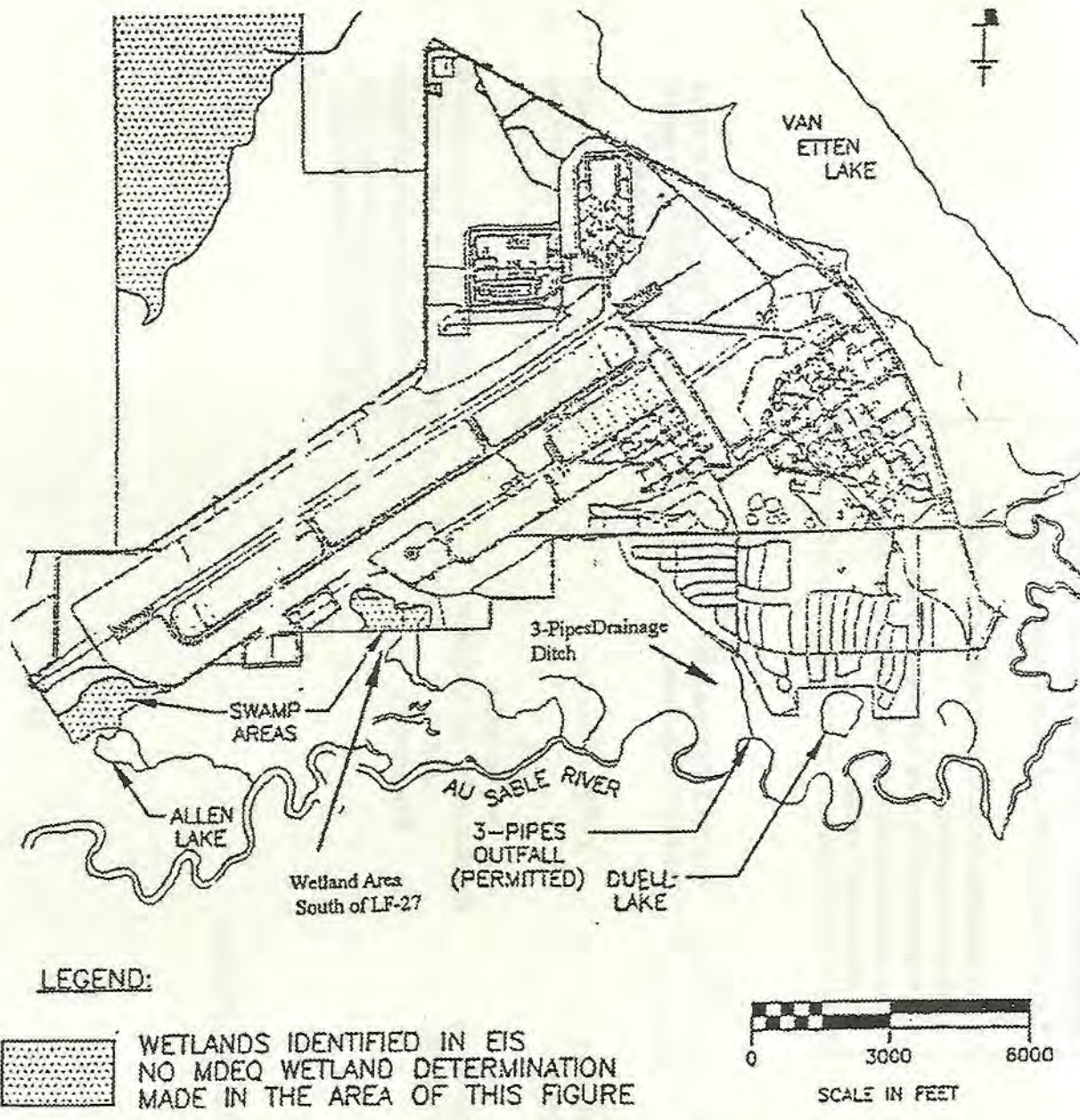

Figure 4 - Surface Water Bodies, Wurtsmith Air Force Base, Oscoda, Michigan
 (Figure adapted from AFCEE 1996b)

REMEMBER: For a public health threat to exist, the following three conditions must all be met:

- People must come into contact with areas that have potential contamination
- Contaminants must exist in the environment
- The amount of contamination must be sufficient to affect people's health

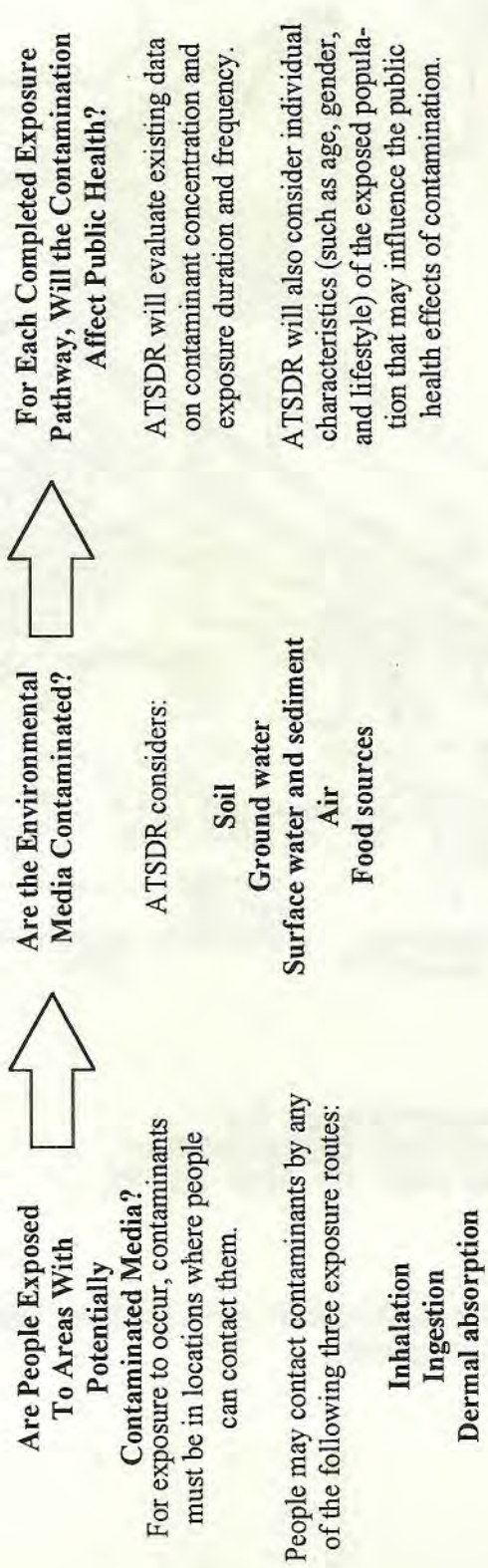

Figure 5 - ATSDR's Exposure Evaluation Process

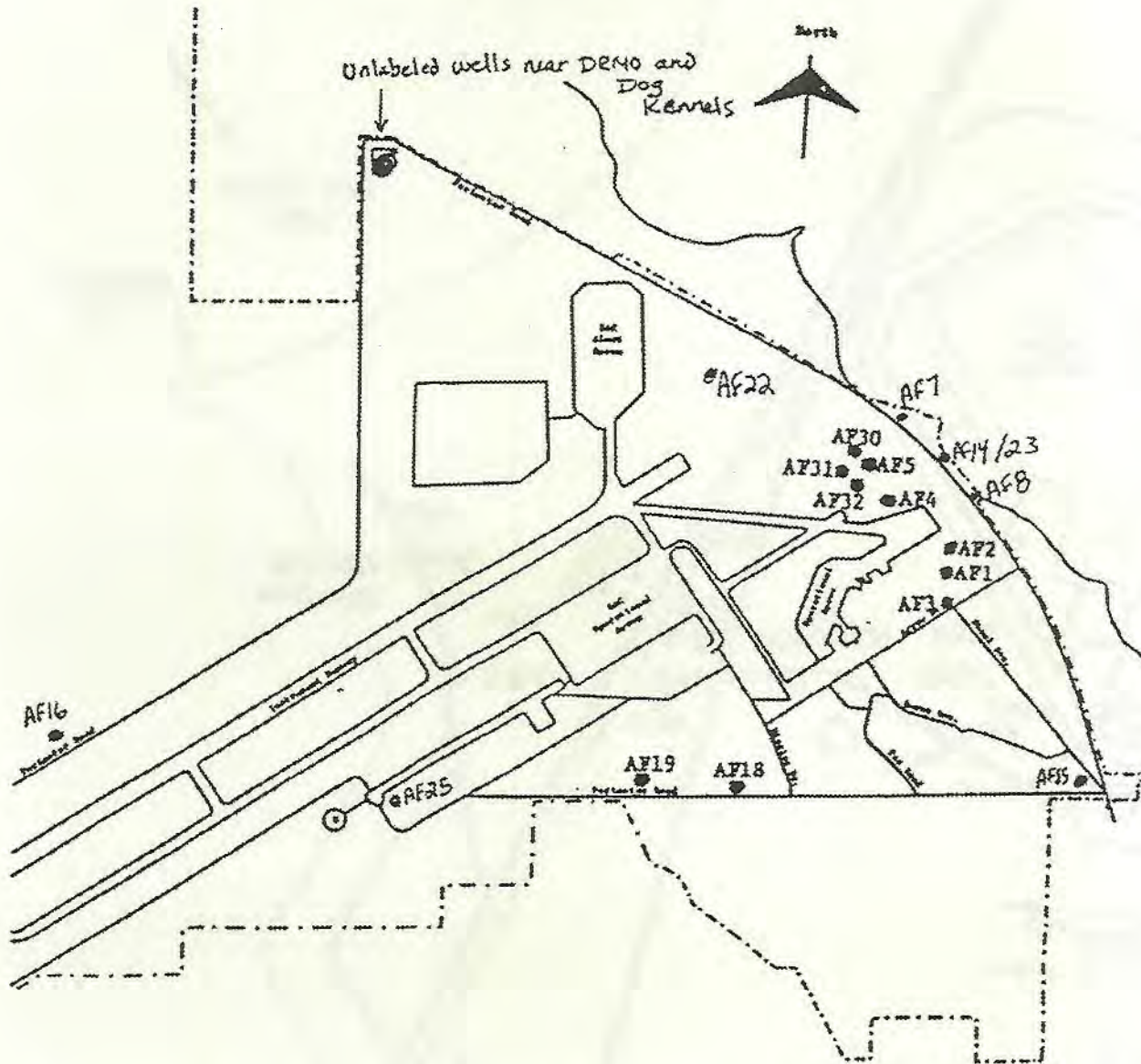

Figure 6 - USAF's Water Supply Wells, Main Water Supply Wells and Area-Specific Wells, Wurtsmith Air Force Base, Oscoda, Michigan
Figure adapted from Ayres, 1990)

Note:

1. Approximate locations of supply wells are depicted.
2. USAF's main water supply wells: AF1, AF2, AF3, AF5, AF18, AF19, AF30, AF31 and AF32.
3. USAF's area-specific wells: AF7, AF8, AF14, AF15, AF16, AF22, AF23, and two unlabelled wells.

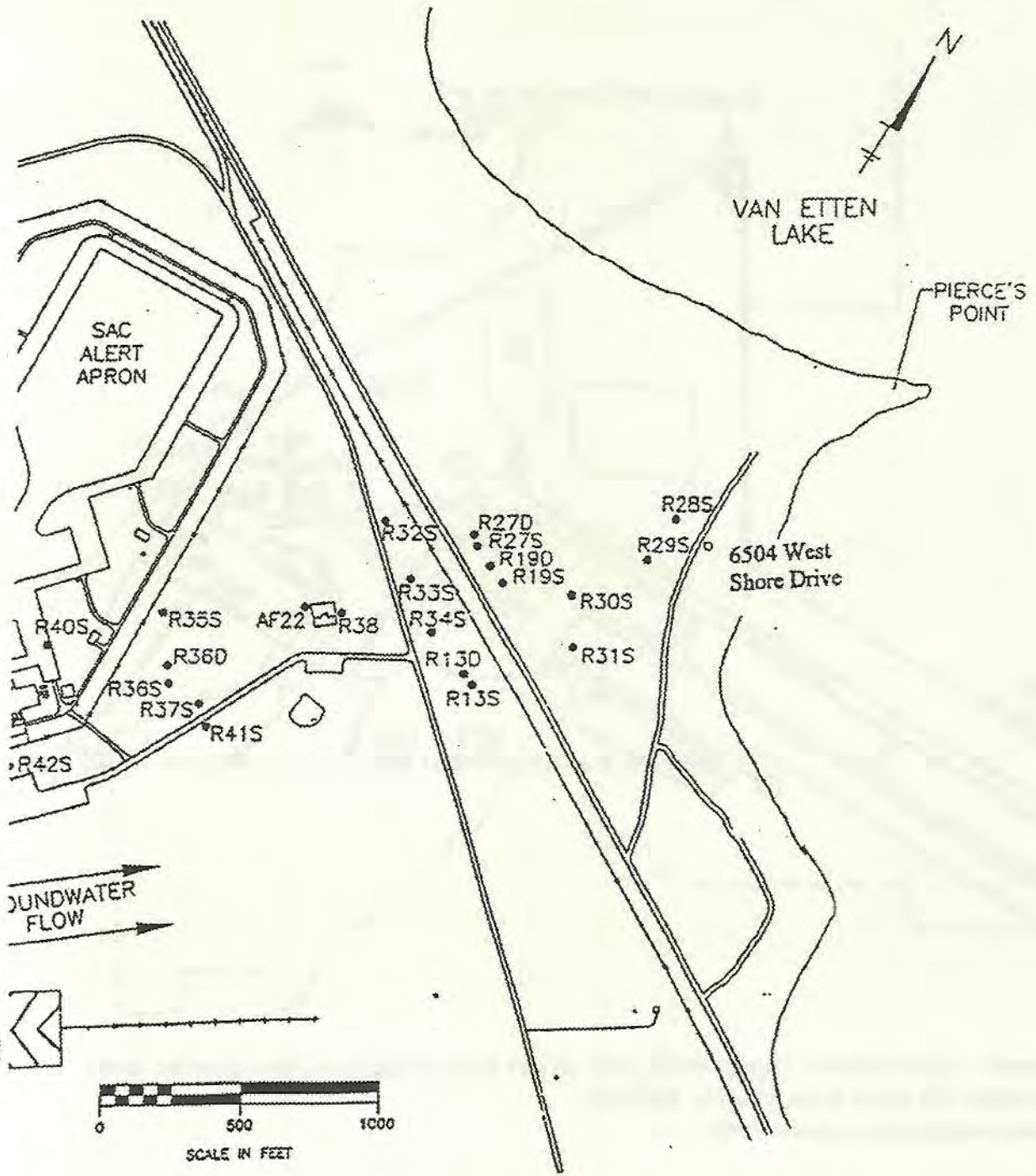

Figure 7 - Monitoring Wells Located Near Pierce's Point, Wurtsmith Air Force Base, Oscoda, Michigan
 Figure adapted from AFCEE, 1996e

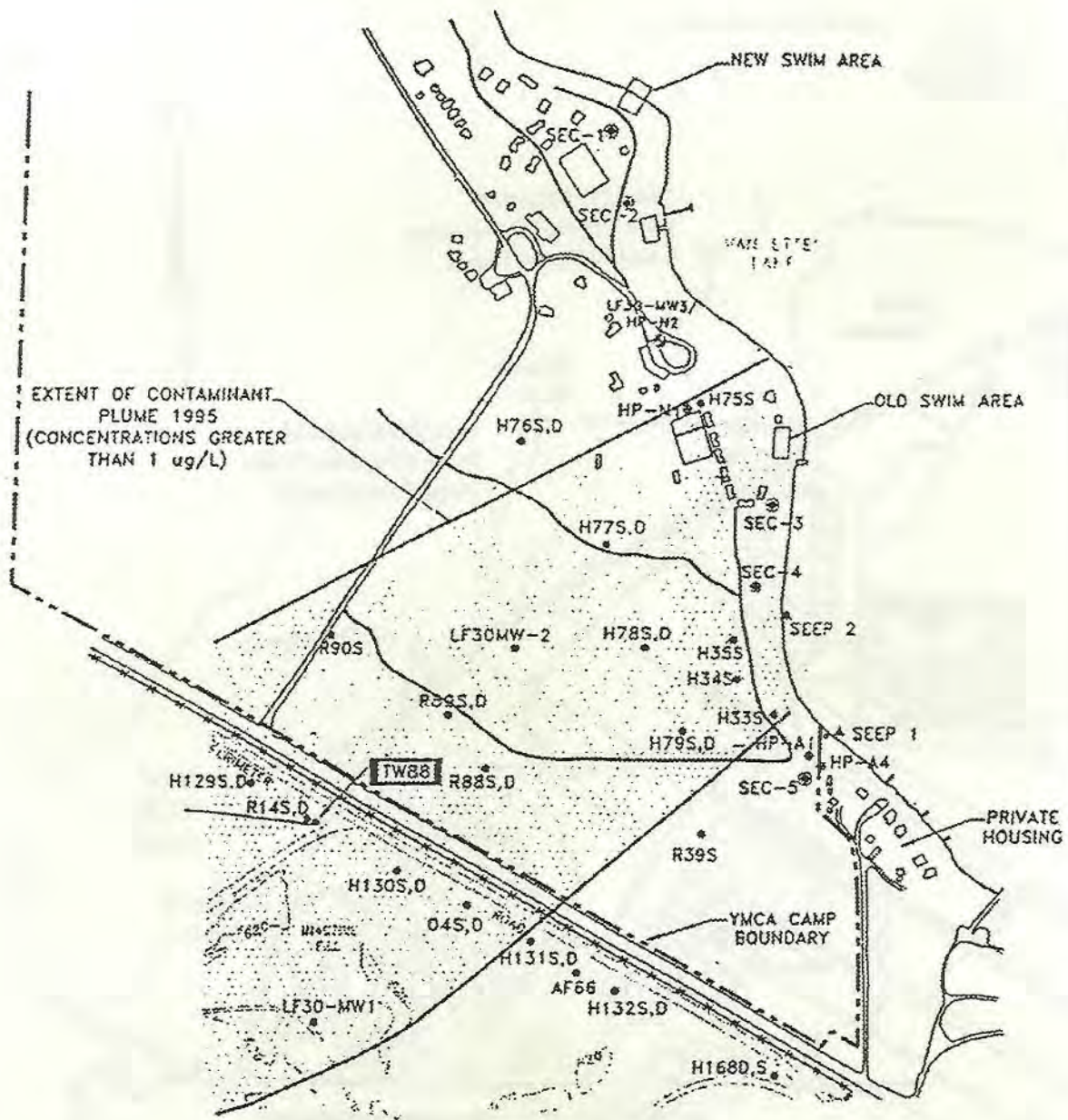

Figure 8 - Camp Nisskone's Swimming Areas and Seep Areas, Wurtsmith Air Force Base, Oscoda, Michigan
 Figure adapted from AFBCA 1999h

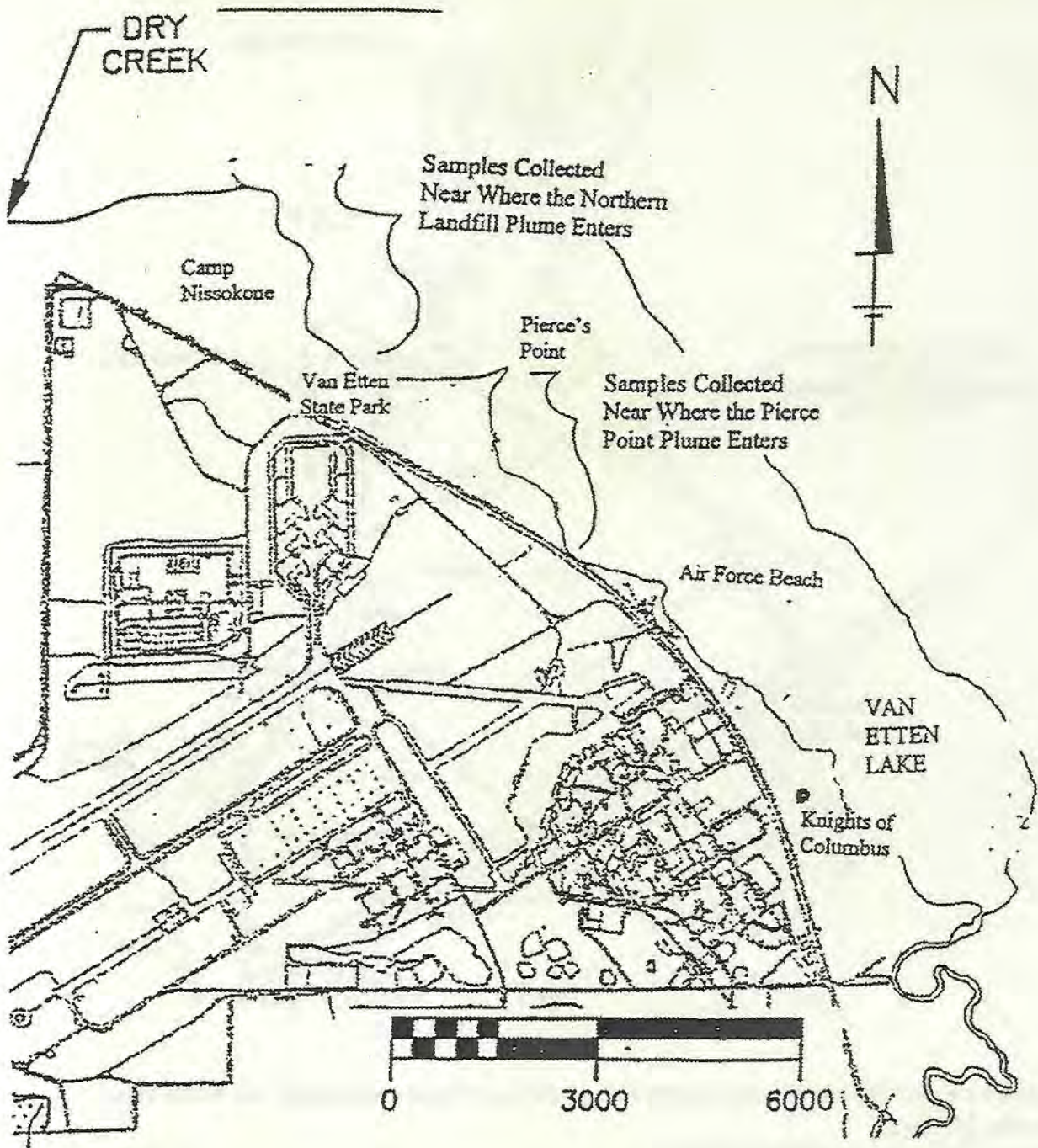

Figure 9 - Sampling Locations at Van Etten Lake, Wurtsmith Air Force Base, Oscoda, Michigan
 Figure adapted from AFCEE, 1996b