

**PLAN OF DECK**

(ANGLE OF CROSSING 70° OR GREATER)

Δ 5" FOR SIDE BY SIDE BOX BEAM ONLY

**PLAN OF DECK**

(ANGLE OF CROSSING LESS THAN 70°)

\* FOR SIDE BY SIDE BOX BEAMS WHERE ANGLE OF CROSSING < 70° AND SPAN LENGTH < DECK WIDTH, PLACE TRANSVERSE BARS PARALLEL TO REF LINE

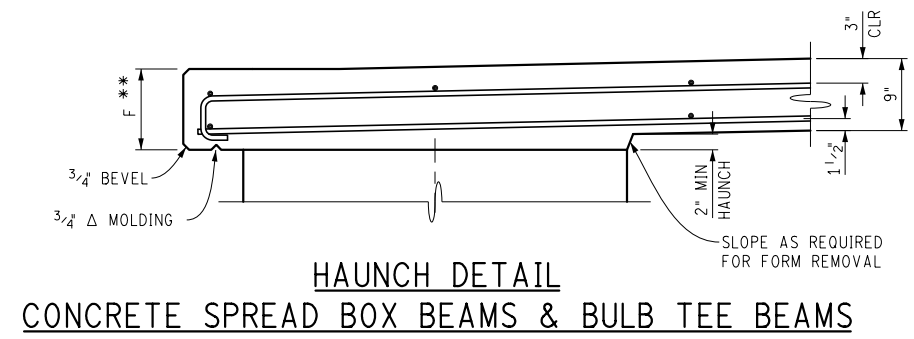

**HAUNCH DETAIL**

**CONCRETE SPREAD BOX BEAMS & BULB TEE BEAMS**

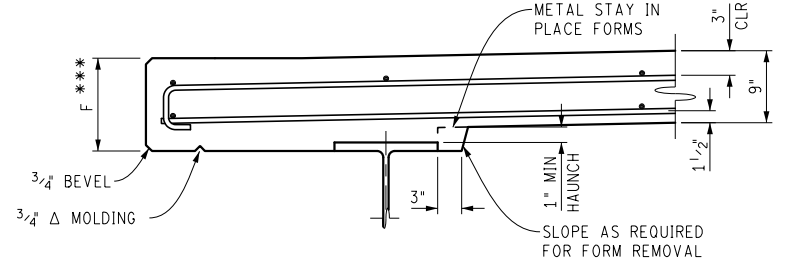

**HAUNCH DETAIL**

**STEEL BEAMS**

**FOR INFORMATION ONLY:**

\*\* FASCIA THICKNESS (F) = 9" + HAUNCH + 1/2" + AMOUNT OF FASCIA BEAM DROP REQUIRED TO MAINTAIN MINIMUM SLAB THICKNESS AT CURB LINE.

\*\*\* FASCIA THICKNESS (F) = 9" + HAUNCH + THICKEST FASCIA BEAM FLANGE + 1/2" + AMOUNT OF FASCIA BEAM DROP REQUIRED TO MAINTAIN MINIMUM SLAB THICKNESS AT CURB LINE.

IF "F" BECOMES GREATER THAN 12" USE A HAUNCH DETAIL ON THE FASCIA SIDE OF THE BEAM SIMILAR TO THE HAUNCH DETAIL ON THE INTERIOR SIDE. ADDITIONAL REINFORCEMENT MAY BE REQUIRED IN THE AREA OVER THE BEAM FLANGE IF THE HAUNCH BECOMES EXCESSIVE.

THE ABOVE NOTES ARE FOR INFORMATION ONLY AND SHOULD NOT BE INCLUDED ON THIS SHEET.

FINAL ROW PLAN REVISIONS (SUBMITTAL DATE: )								<b>NO SCALE</b>	DATE: 05/09/18	CS:	SUPERSTRUCTURE DETAILS		DRAWING	SHEET
NO.	DATE	AUTH	DESCRIPTION	NO.	DATE	AUTH	DESCRIPTION		DESIGN UNIT:	JN:			DECK	SECT
									TSC:			001		