

SECTION A-A

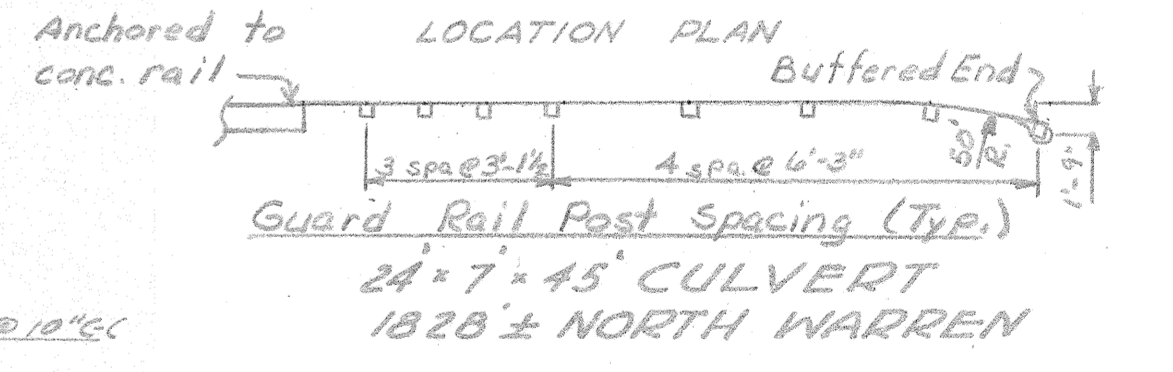
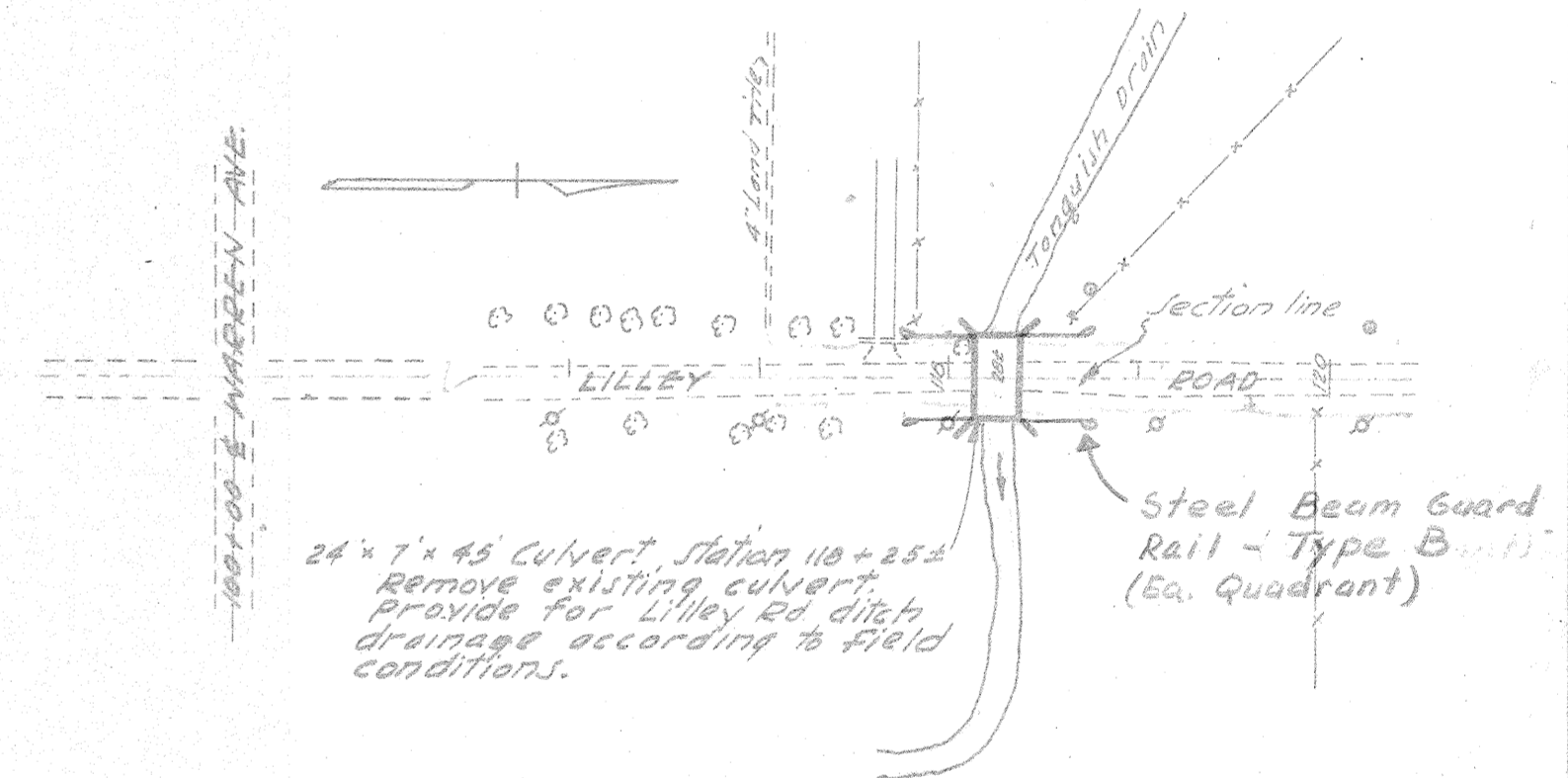
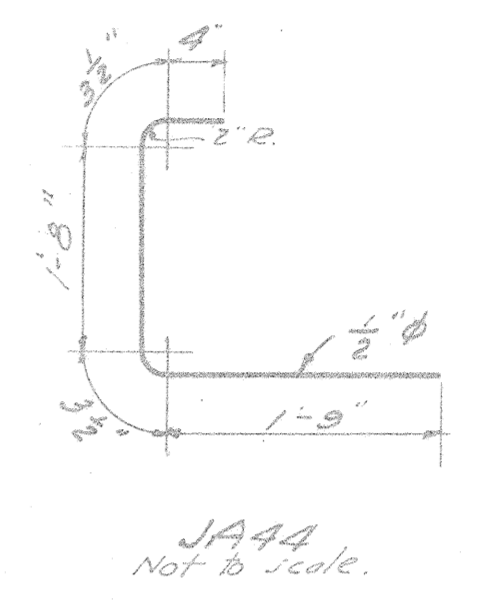
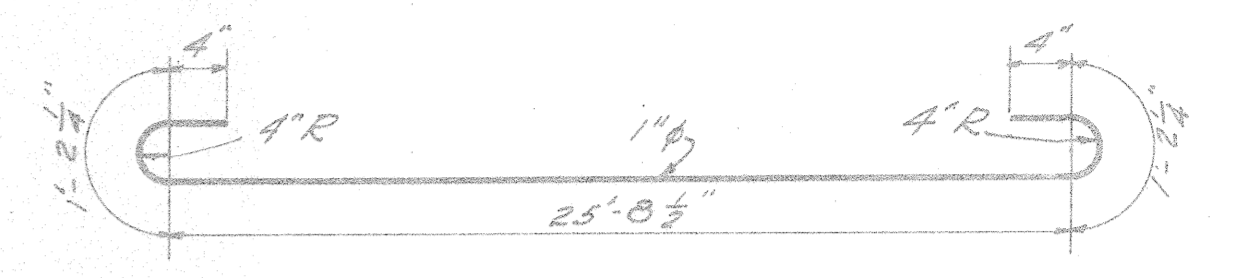

BILL OF REINFORCING BARS				
MARK NO	SIZE	LENGTH	SPACING	LOCATION
D 266	3/4"	26'-6"	10" CC	Transverse in Slab
DA 289	1"	28'-9"	10" CC	"
F 169	3/4"	16'-9"	14" CC	Longitudinal in Slab
F 30	3/4"	3'-0"	As shown	Vertical dowels to deck
J 260	3/4"	26'-0"	"	Longitudinal in curb
JA 44	3/4"	4'-8"	12" CC	Vertical in Curb
Total weight reinforcing steel - 10,550#				
16 Pieces 2" Gal. I.P. 3' long for weepers.				

QUANTITIES		
MATERIAL	UNIT	AMOUNT
Concrete	Cubic Yards	153
Sand	"	26
Stone	"	15.5
Cement	Barrels	289

NOTE: All exposed edges shall be bevelled with a 3/4" moulding. Backfill with material approved by the Engineer.

BENCH MARK, EL. 682.54
Spike in 24" Maple
27 Rk. Station 117+37

REVISIONS					
NO.	ITEM	BY	DATE	NO.	ITEM
1	CONC. PARAPET	RA	6-5-24		
	ST. BRIDGE	K.R.	6-5-24		

BOARD OF WAYNE COUNTY ROAD COMMISSIONERS
DETROIT 26, MICHIGAN
PRESCOTT B. BROWN, CHAIRMAN
MICHAEL J. O'BRIEN, COMMISSIONER

SCALE 1/8" = 1'
DATE 11-30-45
DRAWN BY J. STANER
CORRECTED BY J. STANER
JOB 416